



# SPORTSMEN<sup>®</sup>



*Come home to KZ!*

[www.kz-rv.com](http://www.kz-rv.com)



# SPORTSMEN®

A great value that will  
build a lifetime of  
wonderful memories.



## S300BH

This design incorporates a great kitchen, roomy bath and rear bunks the kids really love.



A large comfortable bed awaits mom and dad and the family will enjoy the room expanding slide out with a large dinette and jiffy sofa.



## S331BH

Need more privacy? The entertainment center doubles as a room divider, separating the large bed and dual mirrored wardrobes.



Kitchen and dinette areas are attractive and comfortable. Four rear bunks and loads of cabinet storage.

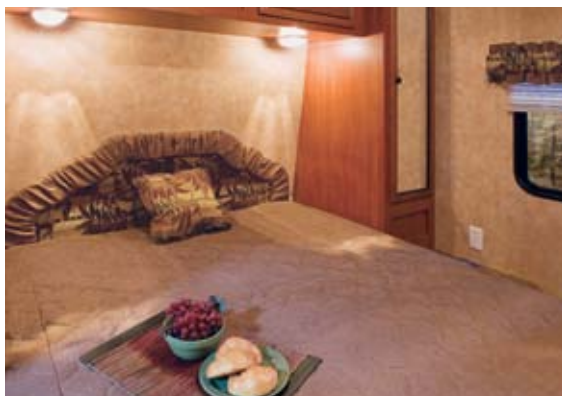

- 1 13,500 BTU A/C
- 2 Seamless 1-Piece Roofing Material
- 3 3/8" Decking
- 4 Vinyl Interior Ceiling Panel
- 5 4 1/2" Wood Truss Rafters, 16" O.C.
- 6 R-7 Batten Insulation
- 7 Insulated Ductwork
- 8 Exterior Clearance Lights
- 9 2x2 Wood Frame Front and End Walls
- 10 2x2 Wood Studs, 16" O.C.
- 11 Extra-Thick .024 Metal Siding
- 12 R-7 Batten Insulation
- 13 Decorative Luan Wall Board
- 14 Exterior Brake Lights
- 15 Darco® Moisture Barrier Underbelly
- 16 Extra-Large Radius Exterior Baggage Doors
- 17 Heavy Duty I-beam Frame Construction
- 18 R-7 Batten Insulation
- 19 Fully Welded Out Riggers
- 20 Heavy Duty Leaf Spring Axles
- 21 Heavy Duty Steel Wheels
- 22 Residential Style Carpet Pad
- 23 Rack and Pinion Electric Slide with Manual Override
- 24 Residential Carpet or Linoleum
- 25 Triple Sealed Slide Outs
- 26 Radius Entrance Door
- 27 Tinted Windows
- 28 Easy-Lube Axles
- 29 Extra Long Drip Spouts
- 30 Diamond Plate Front Plate
- 31 Heated Fresh Water Tank
- 32 Cable Hook Up
- 33 Plywood Floors
- 34 Floor Joists, 16" O.C.



## Coach-Net®

RV Membership Plans

*One Year FREE Road Side Assistance courtesy of KZ!*

## FIFTH WHEELS

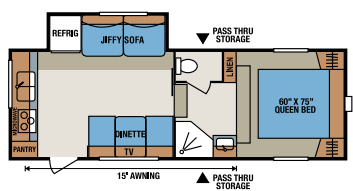

**S235RK**

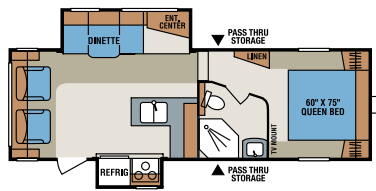

**S245SB • Closet Slide Option – see right**

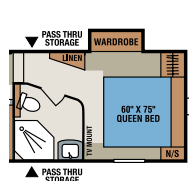

**S245SB**  
Closet Slide Option

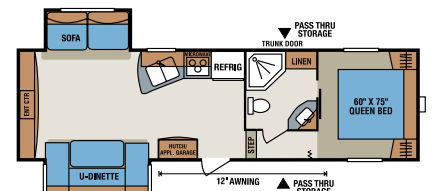

**S265RE**

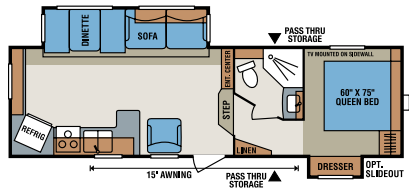

**S265RK**

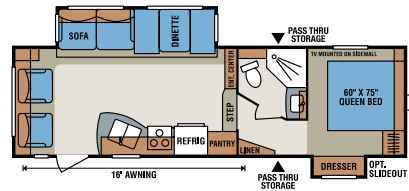

**S265RL**

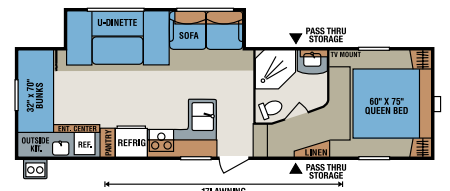

**S295BH**

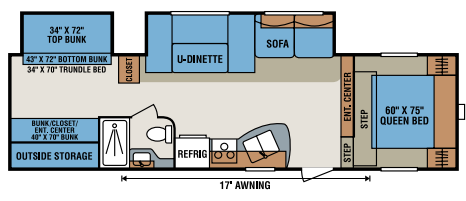

**S315BH**

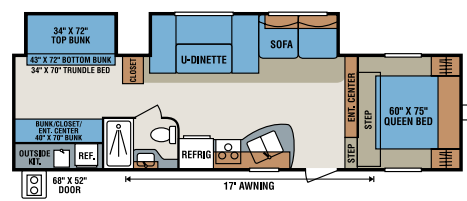

**S315BHK**

# TRAVEL TRAILERS

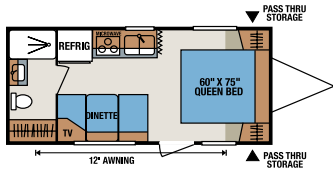

**S202RB** • Twin Beds Option – see below

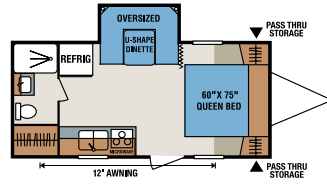

**S202SRB** • Twin Beds Option – see below

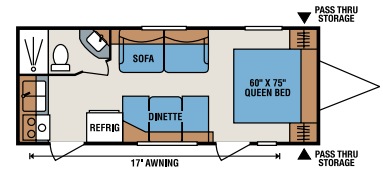

**S2303**

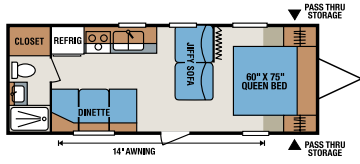

**S240FB** • Twin Beds Option – see below

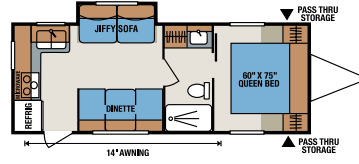

**S241RKS** • Twin Beds Option – see below

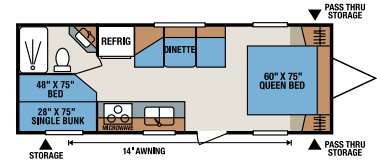

**S242BH** • Twin Beds Option – see below

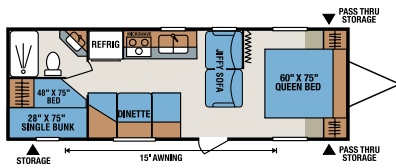

**S272BH** • Twin Beds Option – see below

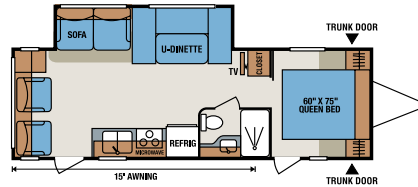

**S280RL**

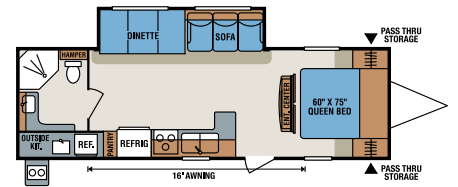

**S290RBK**

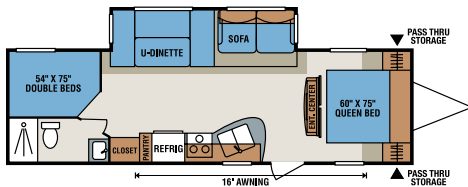

**S301BH**

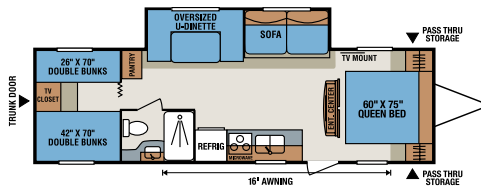

**S314BH**

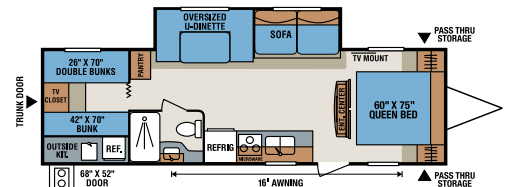

**S314BHK**

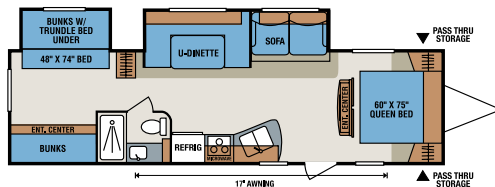

**S321BHS**

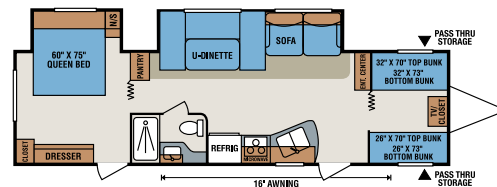

**S330BH** • Bunk/Dinette and Queen Bed Options – see right

## TRAVEL TRAILERS

	S202RB	S202SRB	S2303	S2303S	S231BHS	S240FB	S241RKS	S242BH	S242SBH	S261RK	S272BH	S280RL	S290RBK	S290RBS
UVW (Unloaded Vehicle Wt.)*	3,711	4,070	4,150	4,520	4,690	4,305	4,575	4,323	4,628	5,627	4,736	5,878	6,150	5,785
Dry Hitch Weight*	456	491	390	450	660	527	502	505	579	558	570	683	656	733
Dry Axle Weight*	3,255	3,579	3,760	4,070	4,030	3,778	4,073	3,818	4,049	5,069	4,166	5,195	5,494	5,052
NCC (Net Carrying Capacity)	1,289	930	1,350	980	1,310	1,695	1,425	1,677	1,372	1,373	2,264	1,122	850	1,215
GVWR	5,000	5,000	5,500	5,500	6,000	6,000	6,000	6,000	6,000	7,000	7,000	7,000	7,000	7,000
Interior Height	78"	78"	78"	78"	78"	78"	78"	78"	78"	82"	78"	82"	82"	82"
Exterior Height w/AC	10' 1"	10' 1"	10' 2"	10' 2"	10' 2"	10' 1"	10' 1"	10' 1"	10' 1"	11' 1"	10' 1"	11' 1"	11' 1"	11' 1"
Exterior Width	96"	96"	96"	96"	96"	96"	96"	96"	96"	96"	96"	96"	96"	96"
Exterior Length	21' 11"	22' 5"	24' 11"	24' 11"	25' 11"	26' 3"	26'	26' 6"	26' 9"	28' 9"	29' 11"	30'	31'	31'
Refrigerator (cu. feet)	5	5	5	5	5	5	5	5	5	5	5	5	5	5
Water Htr. Cap. (gal. G/E w/DSI)	6	6	6	6	6	6	6	6	6	6	6	6	6	6
Fresh Water Cap. (gal.)	40	40	40	40	40	40	40	40	40	40	40	40	40	40
Waste Water Cap. (gal.)	32	32	32	32	32	32	32	32	32	32	32	32	32	32
Gray Water Cap. (gal.)	32	32	32	32	32	32	32	32	32	64	32	32	32	32
LP Gas Cap. (lbs.)	40	40	40	40	40	40	40	40	40	40	40	40	40	40
Furnace BTUs (1,000s)	16	16	20	20	20	20	20	20	20	25	20	25	25	25
Tire Size	14"	14"	14"	14"	14"	14"	14"	14"	14"	14"	14"	14"	14"	14"
Awning	12'	12'	17'	17'	16'	14'	14'	14'	14'	16'	15'	15'	16'	16'

\*This weight reflects the rolling average unit weight for each model. Your trailer weight will vary according to optional equipment.

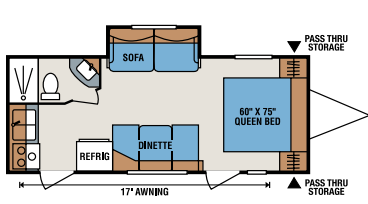

**S2303S**

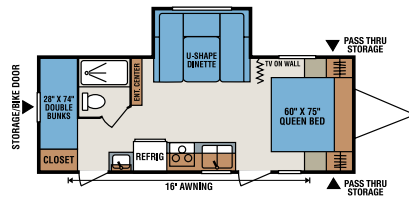

**S231BH**

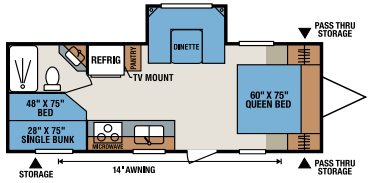

**S242SBH** • Twin Beds Option – see below

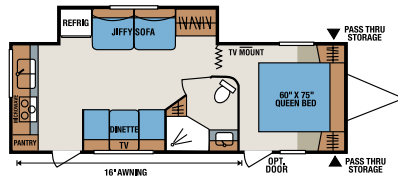

**S261RK**

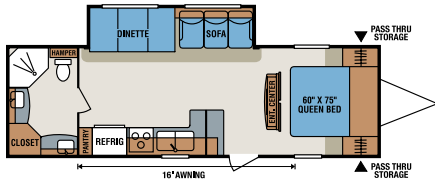

**S290RBS**

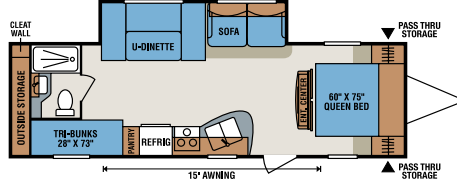

**S300BH**

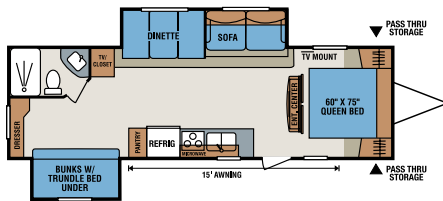

**S318BH**

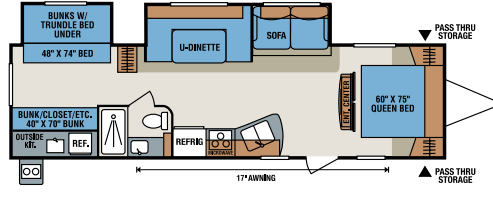

**S321BHK**

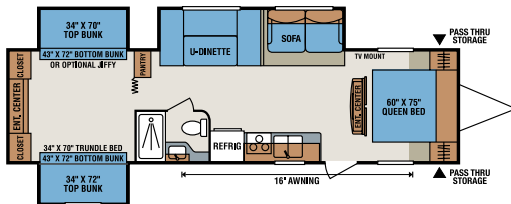

**S331BH**

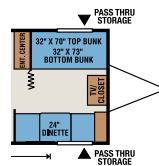

**S330BH**  
Bunk/Dinette Option

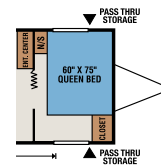

**S330BH**  
Queen Bed Option

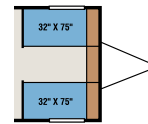

**S202RB, S202SRB, S240FB, S241RKS, S242BH, S242SBH, S272BH**  
Twin Beds Option



**FIFTH WHEELS**

S300BH	301BH	S314BH	S314BHK	S318BH	S321BHK	S321BHS	S330BH	S331BH	S235RK	S245SB	S265RE	S265RK	S265RL	S295BH	S315BH	S315BHK
6,064	6,280	6,222	6,510	6,455	7,170	7,040	7,115	7,550	5,925	6,840	7,273	7,230	7,370	7,250	7,650	7,830
810	760	684	589	595	583	665	773	760	860	1,318	1,505	1,310	1,450	1,323	1,480	1,420
5,254	5,520	5,538	5,921	5,860	6,587	6,375	6,342	6,790	5,065	5,522	5,768	5,920	5,920	5,927	6,170	6,410
936	1,720	998	710	765	1,630	1,760	1,685	1,250	1,875	1,960	1,727	1,770	1,630	1,550	1,850	1,670
7,000	8,000	7,220	7,220	7,220	8,800	8,800	8,800	8,800	7,800	8,800	9,000	9,000	9,000	8,800	9,500	9,500
82"	82"	82"	82"	82"	82"	82"	82"	82"	90"	90"	90"	91"	91"	90"	91"	91"
11' 1"	11' 4"	11' 1"	11' 1"	11' 1"	11' 1"	11' 1"	11' 1"	11' 4"	10' 7"	12' 2"	10' 10"	12' 3"	12' 3"	12' 5"	11' 11"	11' 11"
96"	96"	96"	96"	96"	96"	96"	96"	96"	96"	96"	96"	96"	96"	96"	96"	96"
31' 9"	32' 6"	33'	33'	31' 11"	34' 3"	34' 3"	35' 2"	35' 6"	25' 3"	27' 10"	30' 9"	30' 6"	30' 6"	32' 3"	33' 1"	33' 1"
5	5	5	5	5	5	5	5	5	5	5	5	5	5	5	5	5
6	6	6	6	6	6	6	6	6	6	6	6	6	6	6	6	6
40	40	40	40	40	40	40	40	40	40	40	40	40	50	40	40	40
32	32	32	32	32	32	32	32	32	57	57	57	57	57	57	32	32
64	32	32	32	32	32	32	32	32	57	57	57	89	57	57	32	32
40	40	40	40	40	40	40	40	40	40	40	40	40	40	40	40	40
30	30	30	30	30	30	30	30	30	25	25	25	25	25	30	30	30
14"	15"	14"	14"	14"	15"	15"	15"	15"	14"	15"	15"	15"	15"	15"	15"	15"
15'	16'	16'	16'	15'	16'	16'	18'	16'	15'	18'	12'	15'	16'	17'	17'	17'



Mesa Décor



Flax Décor



**Standards**

- Awning with Drip Rail and Spouts
- Microwave with Turntable
- AM/FM CD Player
- 13,500 BTU A/C
- 6 Gallon Gas DSI Water Heater
- Bedspread
- Headboard
- Monitor Panel
- Power Vent in Bath
- Tinted Windows
- 5 Cubic Foot Refrigerator
- TV Antenna with Booster
- Acrylic Sink
- Solid Wood Framed Mortise and Tenon Cabinet Doors
- 20 lb. Gas Bottles
- Patio Door Light
- Large Overhead Cabinets
- Built-In Medicine Cabinet with Mirror in Bath
- Range Hood with 12V Light and Exhaust Fan
- 30 Amp Service
- 3 Burner Cook Top
- 1 Piece Seamless Roof

- Rear Bumper with Sewer Hose Storage
- Gas Struts on Bed Base
- Cable Hook Up
- Radius Entry Door
- Mini Blinds
- Innerspring Mattress
- Roller Ball Bearing Drawer Guides
- Border Accent Tape
- Sink Cover
- Heated Fresh Water Tank
- Roof Vent in Main Bedroom
- Enclosed Pin Box (FW)
- Smooth Screwless Baggage Doors
- Decorative Bolsters on Jiffy Sofas

**Options**

- 15,000 BTU A/C Upgrade
- 2/4 Stabilizer Jacks
- 30# Gas Bottles
- 6 Cubic Foot Refrigerator
- Twin Bed ipo Island Queen (S202RB, S202SRB, S240FB, S241RKS, S242BH, S242SBH, and S272BH)
- Closet Slide (S245SB, S265RK, and S265RL)
- Fiberglass Sidewalls on Fifth Wheels (Forced)

- Hide-A-Bed
- Assist Grab Handle
- Black Tank Flush
- Bottle Cover
- Bunk Ladder & Railing (Where Available)
- Fan-Tastic Vent®
- Ducted A/C (Forced on S241RKS) (Available on 202, 240, 242, 272 and Standard on All Other Models)
- Flip Jiffy at End of Queen Bed (S202RB, S202SRB, S242BH, and S242SBH Only)
- Jiffy in Bunk Slide (S331BH DS Only)
- Gas/Electric DSI Water Heater
- Ladder
- Power Tongue Jack
- 19"/26" LCD TV
- Outside Grill (N/A with Outside Kitchen)
- Outside Shower (N/A with Outside Kitchen)
- Outside Speakers
- Oven
- Power Awning
- Recliner – 1 or 2
- Satellite Preparation
- Skylight Over Tub
- Spare Tire/Carrier/Cover

- Stereo with DVD Player
- Table and Chairs with Leaf
- Bike Rack/Cargo Carrier
- Katching ZZ's Mattress Upgrade
- Windows at End of Slide Outs (Select Models)
- Winter By-Pass Kit

**Standard Run Package Option**

- 6 Cubic Foot Refrigerator
- Spare Tire/Carrier/Cover
- Oven
- 2/4 Stabilizer Jacks
- 30# Gas Bottle with Cover
- Assist Grab Handle
- Skylight Over Tub
- 2 Exterior Speakers
- Outside Shower (N/A with Outside Kitchen Models)
- Gas/Electric DSI Water Heater

**S330BH Front Bedroom Options**

- (Four Bunks Standard)
- Bunk/Dinette
- Queen Bed



Bike Rack



Cargo Carrier



The optional Bike Rack/Cargo Carrier offers you even greater versatility for those "extra" items you don't want to leave at home.

**ASK ABOUT OUR 2-YEAR LIMITED WARRANTY!**



**Dealer Satisfaction Index:** Ratings of manufacturers, by dealers, have consistently awarded KZ top honors for excellence of design, reliability, overall quality and value, communications and dealer support.

Dealer: \_\_\_\_\_



Portions of this brochure were used with the expressed authority of Dexter Axle, but Dexter Axle is not responsible for the accuracy of the information contained herein.

For more product details and in-depth information, visit us on the web at **www.kz-rv.com**

0985 N 900 W • Shipshewana, IN 46565  
E-mail [kz@kz-rv.com](mailto:kz@kz-rv.com) • [www.kz-rv.com](http://www.kz-rv.com)

*Due to continual research and advances, manufacturer reserves the right to change specifications, design, price and equipment without notice, and assumes no responsibility for any error in this literature. Some items shown are not included as standard or optional equipment.*