

*"The Original"*

# ARCTIC FOX

NORTHWOOD MFG

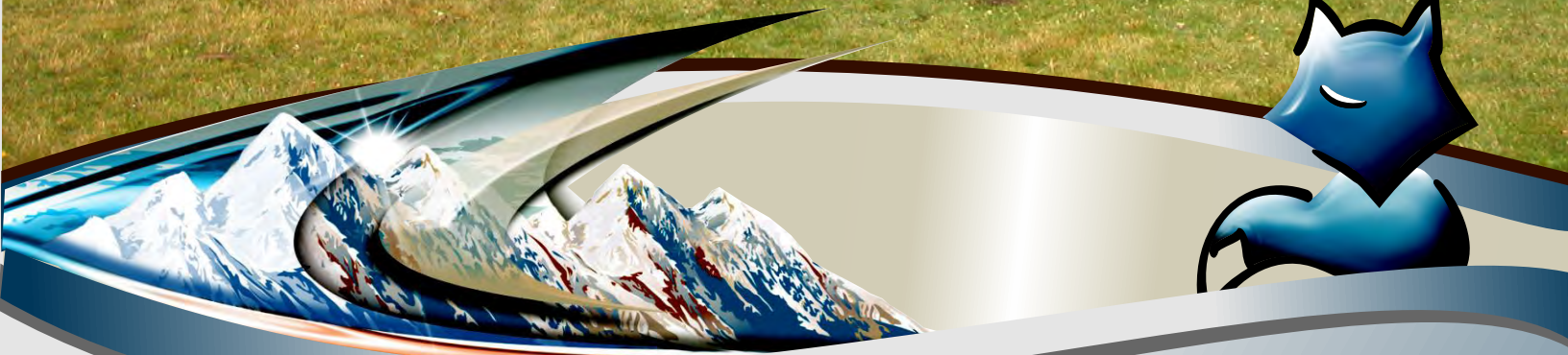

*"Home is where you park it"*



*'Quality You Can See'*



# ARCTIC FOX

NORTHWOOD MFG



**Taupe - Model 1140**

For years, Northwood has been the industry leader in slide out truck campers and this year is no exception! Like all Arctic Fox Campers, these new Foxes are durable enough for extended cross-country and off-road travel! Our transverse floor structure offers a wider main floor giving a spacious feel that is immediately apparent upon entering the coach. Check out the new features such as the comfortable and convenient Dream Dinette, with no table legs to negotiate around, and the new larger dinette window to enhance your view of the outdoors while dining or relaxing. Arctic Fox is the leader in slide out truck camper design.



**Typical Dry Bath**



**Typical Wet Bath**



**Taupe - Model 992**

Many manufacturers are building aluminum frame truck campers nowadays, but aluminum frames are not all the same. We are proud of the quality materials we use and the construction methods we employ to build America's best selling full wall slide out truck camper. There's no doubt that our Arctic Fox truck campers are attractive, but what really sets us apart from the competition is how beautifully they're constructed. From our heavy gauge aluminum with continuous welded joints and solid fill anchor blocking, to our bonded full walk on roof (that will support 29 employees), the Arctic Fox Truck Camper is truly a thing of beauty. Once you've owned an Arctic Fox, you'll never be satisfied with less. That's why we say... "Beauty is more than skin deep!"



**Northwood** is pleased to introduce you to the Arctic Fox Truck Camper. With eight plans to choose from, there is an Arctic Fox to fit the needs of nearly every camper buyer. You can purchase your Fox Camper with confidence because Northwood builds more slide out truck campers than any other manufacturer! Arctic Fox offers a wide variety of features and options sure to satisfy your truck camper needs. That's because The Fox was designed with the informed camper purchaser in mind. We invite you to take a closer look and you'll see why Arctic Fox is the truck camper of choice for the experienced buyer.



**Chestnut - Model 992**



**Taupe**

**Chestnut**



**Taupe - Model 990**

When you compare the specifications of our slide out with the competition, you will see why Arctic Fox continues to be the industry leader. Our full wall slides are up to 26" deep, and our aluminum super structure slide out operates under heavier load conditions than competitors. We build our slide outs right, using dual ram rack and pinion slide mechanisms. Many competitors rely on a single slide mechanism. The dual rams carry the slide-out room smoothly even under full load weights. Five separate seals insure against water intrusion. The slide room is completely insulated for your comfort in all weather conditions. We will continue to lead the industry in innovative slide out camper engineering.



**Chestnut - Model 811**

Feature fabrics enhance the Presidential Cherry finish hardwoods and textured wall boards. You have your choice of a number of beautiful interior decor colors. We use only commercial grade vinyl floor covering and you also have the option of a removable carpet kit. (Carpet kit not available in the 865 and 992 model.)



# ARCTIC FOX

NORTHWOOD MFG

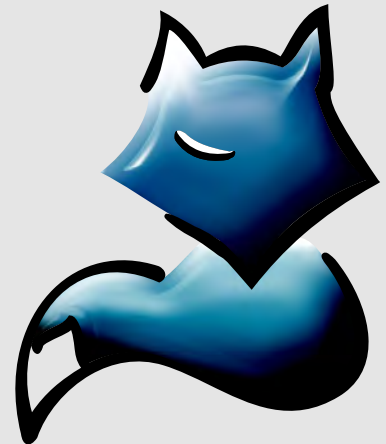

**TV** Indicates pre wired locations where TVs can be installed

865 & 811 are available for  
6 1/2' truck box or 8' truck box



## Approximate Overall Weight and Measure Specifications For Arctic Fox Campers:

Description	Arctic Fox Truck Campers (*) Designates NON Slide-out					
Model Number	811	865*	990	992	1140	1150
Dry Weight Lbs.	2873	2641	3010	3235	3465	3358
Dry Weight Kgs.	1303	1198	1365	1467	1571	1523
Width	96 1/2"	96 1/2"	96 1/2"	96 1/2"	96 1/2"	96 1/2"
Exterior Height	102"-112"w/AC	102"-112"w/AC	102"-112"w/AC	102"-112"w/AC	102"-112"w/AC	102"-112"w/AC
Interior Height	79"	79"	79"	79"	79"	79"
Floor Length	9' 0"	9' 4"	9' 10"	10' 2"	11' 4"	11' 4"
Overall Length	16' 8"	17'	17' 6"	17' 10"	19'	19'
Fresh Water w/Water Heater	45	34	55	47	55	55
Grey Water	41	32	44	29	44	44
Black Water	25	31	43	37	43	43
LPG Capacity (approx. gallons)	14	14	14	14	14	14

Weights include slide-out (if applicable). Some options are not included in the weights displayed. See the list of features that are included in the calculation table.

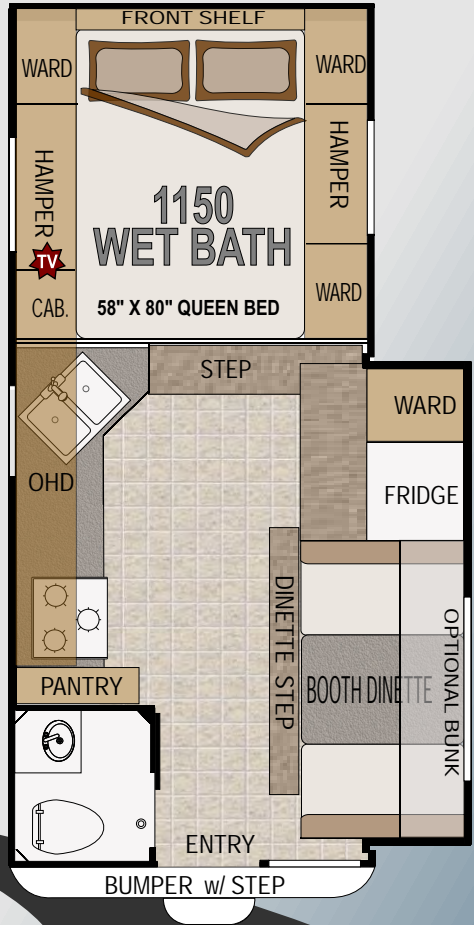



# Features & Options

	811	865	990	992	1140	1150
<b>FOX VALUE PACK CONSTRUCTION</b>	0	0	0	0	0	0
Thermal Pane Windows	0	0	0	0	0	0
Storm Windows	0	0	0	0	0	0
Front Cab-Over Window	0	0	0	0	0	0
<b>ELECTRICAL</b>	0	0	0	0	0	0
50 Watt Solar Panel w/ Controller	0	0	0	0	0	0
100 Watt Solar Panel w/ Controller	0	0	0	0	0	0
Combo Satellite Dish	0	0	0	0	0	0
Auto Scan Satellite Dish	0	0	0	0	0	0
2.5 Onan Generator (Short Box Only 865 / 811)	0	0	0	0	0	0
11K BTU Air Conditioner	0	0	0	0	0	0
<b>KITCHEN / GALLEY</b>	0	0	0	0	0	0
2-way Double Door 6 Cu. Ft Fridge	0	0	0	0	0	0
2-way Double Door 8 Cu. Ft Fridge	N	N	N	N	0	N
3 Burner Range with 22" Oven	0	0	0	0	N	0
3 Burner Range with 16" Oven	N	N	N	N	0	N
<b>PLUMBING &amp; LAVY</b>	0	0	0	0	0	0
DSI Gas Electric Water Heater	S	S	S	S	S	S
<b>INTERIOR</b>	0	0	0	0	0	0
LCD Flat Screen TV	0	0	0	0	0	0
DVD Player	0	0	0	0	0	0
Overhead Bunk in Dinette	0	0	0	0	0	0
Full Wall Wardrobe	0	0	0	0	0	0
Removable Livingroom Carpet	0	N	0	N	0	0
<b>EXTERIOR</b>	0	0	0	0	0	0
Diamond Plate Front Panel	0	0	0	0	0	0
Side Box Awning	0	0	0	0	0	0
Full Wall Slide Out Awnings	0	0	0	0	0	0
Swing Out Brackets For Dually	0	0	0	0	S	S
Add-a-Step	0	0	0	0	0	0
LP Barbeque	0	0	0	0	0	0
Remote Power Jacks	0	0	0	0	0	0

**KEY:** **S** Standard Equipment (no charge)  
**O** Option Available on Request  
**N** Not Available in this Model

**Full 12 Month Warranty** (All Models)

## Value Pack

Fox Value Pack is a mandatory option bundle that includes all of the following high value features:

Rear Awning
Sliding Battery Tray
Rieco Titan® Electric Jacks
Dual 30 lb. LP Tanks
Exterior "Marine Speakers"
Roof Rack and Ladder
Sliding Storage "Joey" Tray
Diamond Plate Armor- Basement Siding
Large 22" Oven
Microwave Oven
LP/110 - 6 Cu Ft Dbl Door Refrigerator
Pull-Out Pantry
Deluxe Refrigerator Doors
Fantastic Fan® - Multi-Speed/Reversible
TV Antenna
Dinette Storage Door
Dinette Storage Drawer
Bedsprad/Shams
Bedroom Front Shelf

**Weight: 595 lbs.**

## Option Weights

Approximate weight of specific additional features:

Feature	Est. Weight	
Weight Unit of Measure	Lbs.	Kgs.
OHD Bunk	40	18
Swing Out Brackets	21	10
11M BTU Air Cond.	90	41
Solar Panel 50W	22	10
Solar Panel 95W	32	15
Removable Carpet	10	5
Side Box Awning	63	29
Generator Ready	25	11
2.5 Generator	78	35
Barbeque	22	10
One Battery	30	14
Typical Water Full (8.3 Lb/Gal)	458	208
Propane Full	60	27

Use these figures to estimate the total weight of the coach with added options:  
 ...camper weight + options

## Items Included In Unit Weight Estimation

**All Unit Weights Include All of The Following Features Below:**

Fiberglass Exterior; Heavy-Duty Camper Tie Downs; Exterior Rinse Station; 20 M BTU Auto Ignition Furnace with Thermostat Control; 60x80 Pillow Top Inner Spring Mattress; Pre-wire for Solar and Satellite; Pre-wire for TV antenna; Pre-wire for microwave oven; Pre-wire for Air Conditioner; Large 3-burner Range; Range Cover; Range Hood w/ Light and Exhaust Fan; DSI Gas Electric Water Heater with Insulated Porcelain Tank; Water Heater By-pass Valve; Semi-Automatic Winterization System; Night/Privacy Shades; Galley Skylight w/Shade; 25 Watt Speakers; Fire Extinguisher; LPG Leak, Smoke and CO Detectors.

Northwood Manufacturing reserves the right to modify options, change feature availabilities and plan configurations at any time. Please note that weights are approximate and for estimation purposes only. Specifications and weights are subject to change without notice.

## Camper Safety Tips

For your safety while driving, use mirrors that allow you to view past the camper to the rear on both sides. Trucks can be purchased with extended mirror options or you may purchase mirror extensions. Truck manufacturers state that you should not exceed the GVRW for the vehicle that carries your camper. The configuration of your truck will determine what size camper your vehicle can carry. A dual rear wheel truck is advisable for Arctic Fox Campers over 10 ft. Adjustable air bags will help to level your vehicle transfer rear axle weight forward

for comfort and safety and are recommended for all Arctic Fox applications.

Some states allow passengers to ride in the camper, but it is not recommended as there are no seat belts available.

When driving in any adverse weather condition it is always best to reduce your speed.

The pickup should be outfitted with a durable rubber mat liner to reduce shifting while traveling. The mat will also protect the truck bed and camper from scratching while loading and unloading.



Use **TORKLIFT** frame mounted camper tie downs for greatest safety.

[www.torklift.com](http://www.torklift.com)

## 111 Reasons To Buy An Arctic Fox



### Construction

Aluminum Superstructure  
Welded Aluminum Framing (.060" - .125")  
2 lb. Virgin Block Foam Insulation  
Full Walk-On Roof  
Crowned Roof: 3-1/2" Tapered to 1-1/2"  
Thick Seamless One Piece Roof Membrane  
Transverse Floor Maximizes Floor Space  
Continuous 1 Piece Fiberglass Cabover  
Rack and Pinion Slide Out Mechanism



### Exterior

LED Running Lights  
LED Tail Lights - Recessed Automotive Style  
Large 1" Thick, Insulated Compartment Doors  
Metal Latches, Catches, and Pulls  
Automotive Bulb Seals Around All Doors  
12V Light in Termination Compartment  
Removable 110V Power Cord (25' Length)  
Outdoor High Pressure Rinse Station  
5/8" Cast Iron Gas Manifold  
Diamond Plate Armor Above Bumper  
Entry Door w/ 2 View Windows  
Aluminum Bumper w/ Dual Access  
3 Position Step Mount  
Entry Door/ Patio Light  
Exterior Convenience Light (Non-slide Side)  
Black Tank Flush  
Exterior 110 Volt Outlets (GFI Protected)  
Rain Gutters and Drip Spouts  
LP Hookup for BBQ  
White Frame Torque/Jalousie Windows  
Large Tinted Safety Glass Windows  
Thermal Pane Window Option

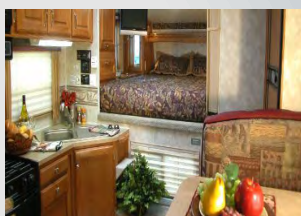

### Interior

Presidential Cherry Finish Cabinets  
Face Frame Cabinet Construction  
3 Interior Color Décor Choices  
AM/FM CD Player w/ 6 Speakers  
Rheostat Adjustable Lighting  
Recessed Halogen Lighting  
Wood Trim Accents  
Ozite Ceiling Liner  
2 Fluorescent Lights  
Night/Privacy Shades  
Direct Spark Ignition LP/110 Water Htr  
Adjustable Heat Vents  
Systems Monitor Panel  
12 Volt Disconnect Switch  
8 -110 Volt Outlets (9 -Dry Bath Models)  
Large Capacity Holding Tanks  
Enclosed Heated Holding Tanks  
Enclosed Heater Termination Valves  
Pre-Wired for Solar Panel  
Pre-Wired for Satellite Receiver  
Power Converter with Charger  
Charge Wizard © Battery Maint. System  
Generator Ready (Most Models)  
Generator Transfer Switch (Most Models)  
Optional Carpet Kit

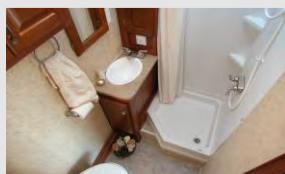

### Bathroom

Fiberglass Shower Stall  
Bathroom Skylight  
Fold-Away Clothes Hanger  
Vanity Cabinet & Mirror  
Freeze Resistant Waterlines



### Kitchen

Galley Overhead Cabinets w/ Shelves  
Solid Wood Doors  
Full Extension Ball Bearing Drawer Glides  
Single Lever Faucet w/ Pullout Sprayer  
Counter Extension  
Galley Backsplash  
Large Kitchen Skylight w/ Shade  
20 Mil Wear Surface Linoleum



### Bedroom

Pillow Top, Inner Spring Mattress  
20" Flat Panel TV Option  
Amplified TV Antenna Hookup  
Park Cable Connection  
110 Volt Outlets  
12 Volt Outlet  
Large Wardrobe Cabinet  
Cabover Hampers  
Swivel Accent Reading Lights  
Mirrored Closet Doors  
Padded Headboard  
Full Wall Wardrobe Option  
Optional Front Window



### Slide Out

Full Wall Slide  
26" Deep Slide (Most Models)  
Oversized Dinette Window  
Dream Dinette  
Longer/Wider Dinette Table  
Dinette Converts to 43 x 76 Bed  
5 Seals on Slide-Out  
Below Seat Storage  
High Density Foam Seat Cushions  
Optional Fold Down Overhead Bunk  
w/ Pad  
Below Step Storage



### Fox Value Package

Rieco Titan © Electric Jacks (w/ Remote)  
Large Rear Awning (7'x 8') Carefree ©  
Sliding Storage "Joey" Tray  
7 Gal LP Tanks (2 Stand-up)  
Dual Battery Compartment w/ Slideout Tray  
Diamond Plate Armor - Basement Siding  
Roof Access Ladder  
7" Tall Roof Rack  
Rear Exterior "Marine" Speakers  
3 Burner Hi-Output Range w/ 22" Oven (most models)  
Microwave  
6 CU FT. Refrigerator (LP/110)  
Deluxe Refrigerator Doors  
Dinette Storage Drawer  
Dinette Storage Door  
Pull-Out Pantry  
TV Antenna  
FANTASTIC © Reversible, Multi-Speed Fan  
Coordinated Bedspread & Shams  
Bedroom Front Shelf

### THE BENEFITS OF LOCALLY PURCHASING YOUR RV :

\* You enjoy valuable relationship building with Dealer Representatives, close to your home, who will explain the features and benefits of the product.  
\* You receive a full product orientation prior to delivery, which includes hands-on directions for many of the coach's systems and functions. You are also introduced to the Dealership's Service/Parts/Warranty personnel who are at the ready to help you with any issues you may encounter, now and in the future.

\* You enjoy customer PRIORITY. Dealerships generally service their purchasing customers first - others may experience long delays and miss opportunities to use their RV. What is it worth for you to have a dealership's full attention and motivation to satisfy you when you need service - in a timely manner?

\* Valuable TAX dollars and jobs stay in YOUR community which pays for your roads, schools, police and fire departments.

*Thank you!*

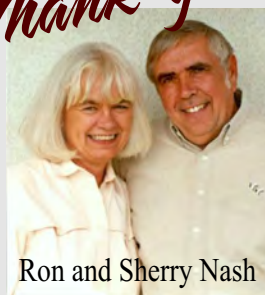

Ron and Sherry Nash

*Thank you for taking a moment to check out our Northwood products. Our highest priority is to offer you the best combination of quality and value in an RV and we are confident you will appreciate and thoroughly enjoy your Northwood RV purchase for many years to come.*



# ARCTIC FOX

NORTHWOOD MFG

Still more reasons why  
you should buy Arctic Fox



## Aluminum Superstructure with Solid Core Blocking

### Aluminum Superstructure with Solid Core Anchor Blocking

Anchor blocking gives substantial strength  
at main connection points.



### Solid Core Anchor Blocking

CONTINUOUS  
BEAD  
WELDS

ALL THREADS  
ARE SECURING  
THE FASTENER

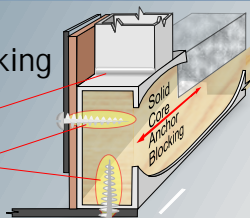

### other brands

SPOT WELDS

ONLY ONE OR  
TWO THREADS  
ARE SECURING  
THE FASTENER

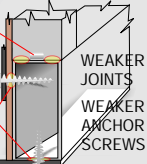

## Full Walk On Roof - 29 Employees On Board!



Now that's a FULL walk-on roof!

When Northwood advertises a "Full Walk-On Roof" for our slide out truck campers, you not only can walk everywhere on the roof, but you could also invite a couple dozen of your friends to join you!

We tested the strength of our 1150 full-wall slide model by loading the roof with 29 of our camper line employees (a good testimonial for our camper jacks too!).

## Structural Aluminum Basement Floor Frame



Big holding tanks require a  
'Big' floor structure...  
**That's the Arctic Fox floor!**

Thick wall aluminum  
basement floor joists support  
our holding tanks under the  
basement of every Arctic Fox  
Truck Camper.

## Fully Insulated Holding Tank Compartments



You'll appreciate the large tank capacities in the Arctic Fox too:  
Up to 55 gallon fresh, 44 gallon gray, and 43 gallon black tank capacities.

## Dual Rams - Dual Battery Rack - Dual LPG Tanks

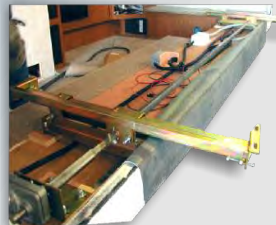

Dual Ram Rack and Pinion  
Slide Assembly in All Slide Outs



Sliding Dual Battery Tray  
Holds **Two** Group 29  
Batteries  
420 Amp Total Capacity



Dual 30 LPG Tanks  
w/Auto Change-over  
Regulator

Your Local Fox Truck Camper Dealer is:



Apr 2011



PO BOX 3359  
59948 Downs Road  
La Grande, OR 97850

Phone 541.962.6274  
Fax 541.963.4392  
www.northwoodmfg.com