

ASPEN TRAIL

DSI
10th Annual RVDA DEALER
SATISFACTION INDEX



ASPEN TRAIL

ASPEN TRAIL



Model 2810BHS French Roast Decor
Solid Surface Counter Tops are part of the Touring Edition Package

**Where high-end looks
and features meet
affordability.**

Our residential style furniture
and two-toned walls add
comfort and warmth.

Aspen Trail's mega-slide rooms
are over a foot wider and offers
a 6" interior height.

Our spacious slide rooms
include an oversized 83" x 48"
U-Shaped convertible dinette
and 68" wide fold down sofa!



Model 2810BHS
French Roast Decor





Model 2810BHS



Lots of storage space. Larger cabinets with multiple drawers, 2 door pantry and lots of counter space make this a very versatile kitchen.



Heavy Duty Steel
Roller Ball-Bearing
Drawer Guides



Solid Wood Cherry-Glazed
Cabinet Doors



Hanging wardrobe closets and true queen walk around bed with 60" x 80" Evergreen™ mattress.



Model 2810BHS

Spacious bathroom with angled sink for more space, large bath tub with shower surround, skylight and foot flush toilet.

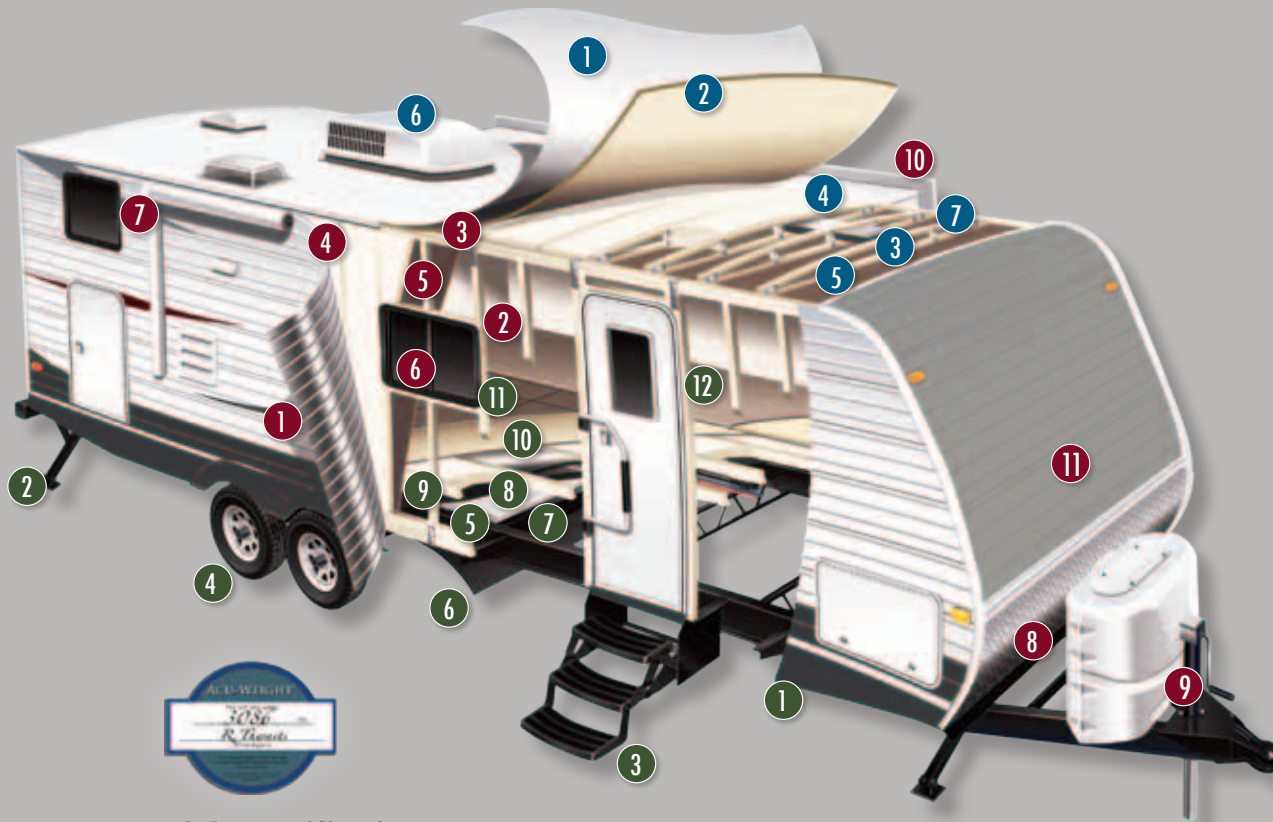

Acu-Weight Certification

All Units Weighed
at the Factory –
Includes Options!

PREMIUM CONSTRUCTION

WALL CONSTRUCTION

- 1 .024 Gauge Heavy Duty Aluminum Finish
- 2 16" on Center Wall Studs
- 3 Steel Hurricane Straps - Tie Walls to Roof & Floor
- 4 R7 Fiberglass Insulation
- 5 Durable Vinyl Decor Board
- 6 Deep Tint Safety Glass Windows
- 7 Patio Awning
- 8 Diamond Plate Rock Guard
- 9 ABS LP Bottle Cover with Quick Access (Option)
- 10 "Super Slide" - 40" Deep Slide Rooms (See Floor Plans)
- 11 Aerodynamic Front Profile

ROOF CONSTRUCTION

- 1 TPO Roof with 12 Year Manufacturer's Warranty
- 2 3/8" "Walk-On" Roof Decking
- 3 5" Truss-Style Crowned Roof Rafters - 16" on Center
- 4 R7 Fiberglass Insulation
- 5 Vinyl Decorator Ceiling Board
- 6 13,500 BTU Roof Ducted A/C
- 7 Foam Core A/C Ducting System

Includes:
**Radial Tires &
E-Z Lube Axles**

FLOOR CONSTRUCTION

- 1 10" Steel I-Beam Powder Coated Chassis on Deep Slides
- 2 Rear Stabilizer Jacks
- 3 Folding Entry Door Steps
- 4 Radial Tires (Mandatory Option)
- 5 Heated and Enclosed Underbelly
- 6 Water Resistant Floor Liner
- 7 12" on Center Floor Joists
- 8 Aluminum Heat Ducting in Floor
- 9 R7 Fiberglass Insulation
- 10 5/8" Tongue and Groove Floor Decking
- 11 Beauflor® Residential Vinyl Flooring
- 12 Residential Carpeting

MEGA STORAGE



Our pass-thru storage compartments are up to 3 times larger than the competition.

AERODYNAMIC FRONT PROFILE



Aspen Trail's aerodynamic profile is designed to push air up the front wall and over the roof to improve towability and fuel economy.

**Improves
Aerodynamics
Protects Tanks
and Floor**

**Enclosed &
Heated Underbelly**



ASPEN TRAIL UNIQUE FLOOR PLANS WITH DISTINCT FEATURES

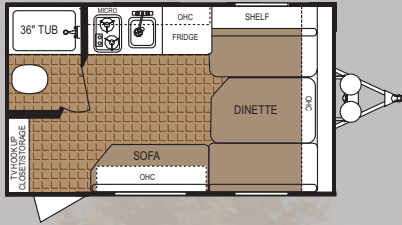

1400RB

Hitch Weight (lbs)	300	Fresh Water Capacity	20.5
Unloaded Weight (lbs)	2,596	Black Water Tank(s)	28
Cargo Capacity (lbs)	804	Grey Water Tank(s)	28
Overall Height w/Opt AC	9' 7"	Furnace BTU Output	18,000
Overall Length	17' 6"		

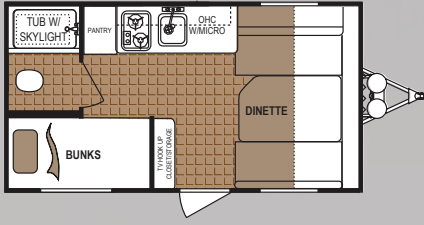

1500BH

Hitch Weight (lbs)	326	Fresh Water Capacity	20.5
Unloaded Weight (lbs)	2,715	Black Water Tank(s)	28
Cargo Capacity (lbs)	1,085	Grey Water Tank(s)	28
Overall Height w/Opt AC	9' 11"	Furnace BTU Output	18,000
Overall Length	18' 9"		

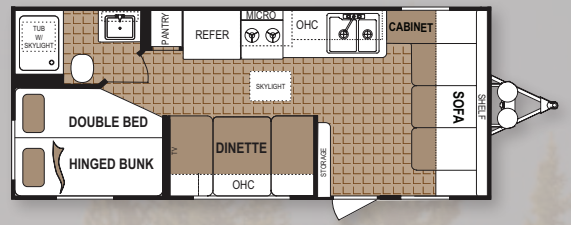

1700DB

Hitch Weight (lbs)	464	Fresh Water Capacity	52
Unloaded Weight (lbs)	4,052	Black Water Tank(s)	42
Cargo Capacity (lbs)	3,548	Grey Water Tank(s)	42
Overall Height w/AC	10' 7"	Furnace BTU Output	18,000
Overall Length	23' 10"		

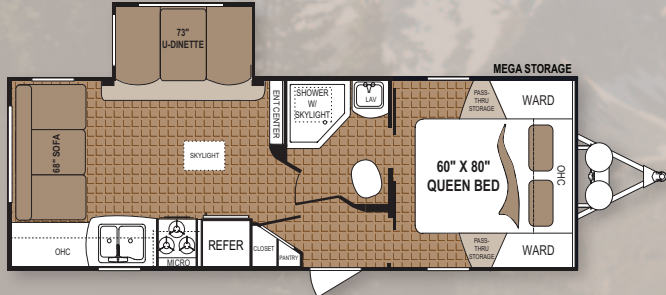

2460RLS

Hitch Weight (lbs)	526	Fresh Water Capacity	52
Unloaded Weight (lbs)	5,479	Black Water Tank(s)	42
Cargo Capacity (lbs)	2,121	Grey Water Tank(s)	42
Overall Height w/AC	11' 2"	Furnace BTU Output	25,000
Overall Length	27' 8"		

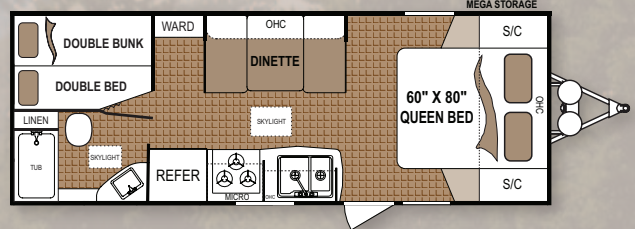

2500BH

Hitch Weight (lbs)	554	Fresh Water Capacity	52
Unloaded Weight (lbs)	4,290	Black Water Tank(s)	42
Cargo Capacity (lbs)	3,310	Grey Water Tank(s)	42
Overall Height w/AC	10' 7"	Furnace BTU Output	18,000
Overall Length	25' 7"		

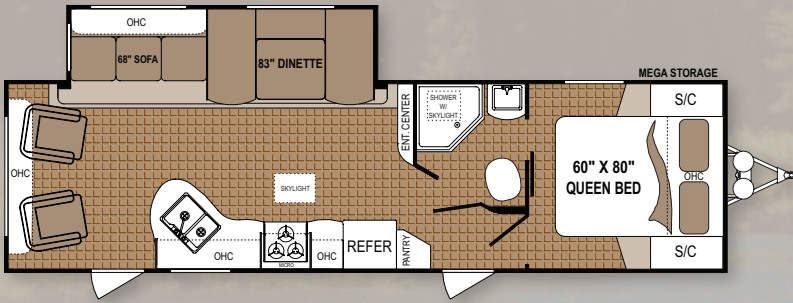

2910RLS

Hitch Weight (lbs)	682	Fresh Water Capacity	52
Unloaded Weight (lbs)	6,776	Black Water Tank(s)	42
Cargo Capacity (lbs)	2,904	Grey Water Tank(s)	42
Overall Height w/AC	11' 5"	Furnace BTU Output	34,000
Overall Length	32' 10"		

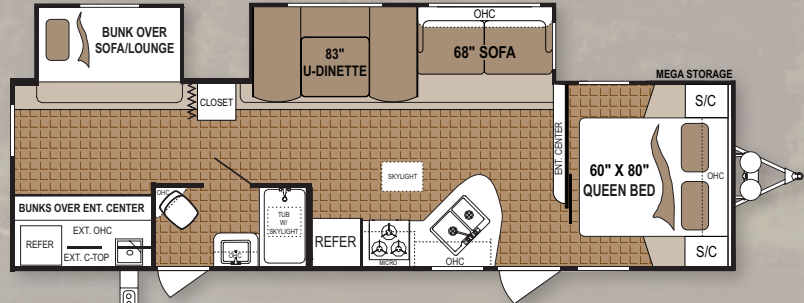

3010BHS

Hitch Weight (lbs)	944	Fresh Water Capacity	52
Unloaded Weight (lbs)	7,778	Black Water Tank(s)	42
Cargo Capacity (lbs)	1,902	Grey Water Tank(s)	42
Overall Height w/AC	11' 7"	Furnace BTU Output	34,000
Overall Length	35' 9"		

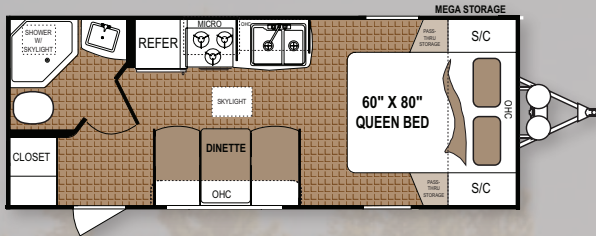

1900RB

Hitch Weight (lbs)	504	Fresh Water Capacity	52
Unloaded Weight (lbs)	4,096	Black Water Tank(s)	42
Cargo Capacity (lbs)	3,504	Grey Water Tank(s)	42
Overall Height w/AC	10' 8"	Furnace BTU Output	18,000
Overall Length	24' 8"		

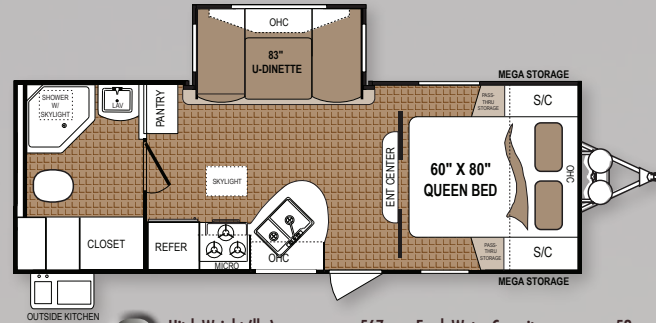

2100BS

Hitch Weight (lbs)	567	Fresh Water Capacity	52
Unloaded Weight (lbs)	5,446	Black Water Tank(s)	42
Cargo Capacity (lbs)	2,154	Grey Water Tank(s)	42
Overall Height w/AC	11' 3"	Furnace BTU Output	25,000
Overall Length	26' 6"		

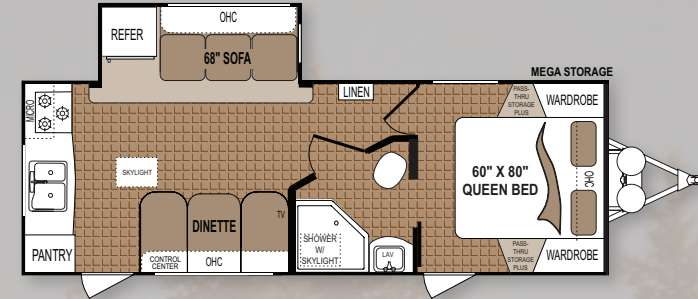

2390RK

Hitch Weight (lbs)	782	Fresh Water Capacity	52
Unloaded Weight (lbs)	5,494	Black Water Tank(s)	42
Cargo Capacity (lbs)	2,106	Grey Water Tank(s)	42
Overall Height w/AC	11' 4"	Furnace BTU Output	25,000
Overall Length	27' 2"		

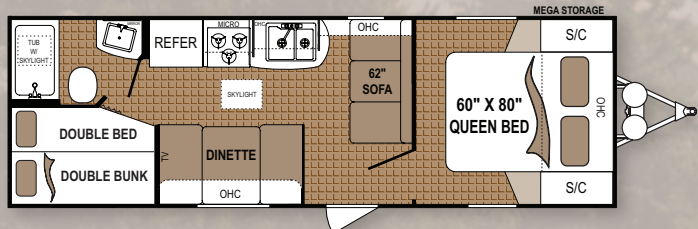

2710BH

Hitch Weight (lbs)	543	Fresh Water Capacity	52
Unloaded Weight (lbs)	4,624	Black Water Tank(s)	42
Cargo Capacity (lbs)	2,976	Grey Water Tank(s)	42
Overall Height w/AC	10' 7"	Furnace BTU Output	25,000
Overall Length	28' 7"		

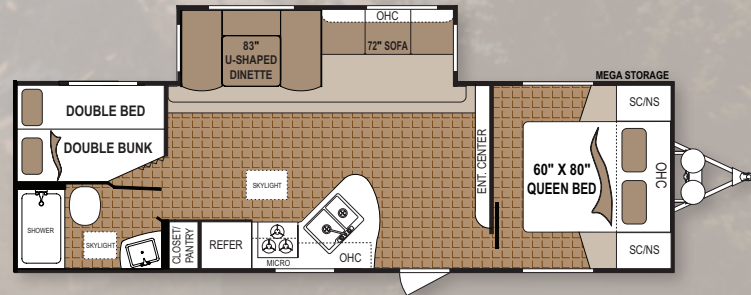

2810BS

Hitch Weight (lbs)	814	Fresh Water Capacity	52
Unloaded Weight (lbs)	6,512	Black Water Tank(s)	42
Cargo Capacity (lbs)	3,168	Grey Water Tank(s)	42
Overall Height w/AC	11' 4"	Furnace BTU Output	34,000
Overall Length	32' 4"		

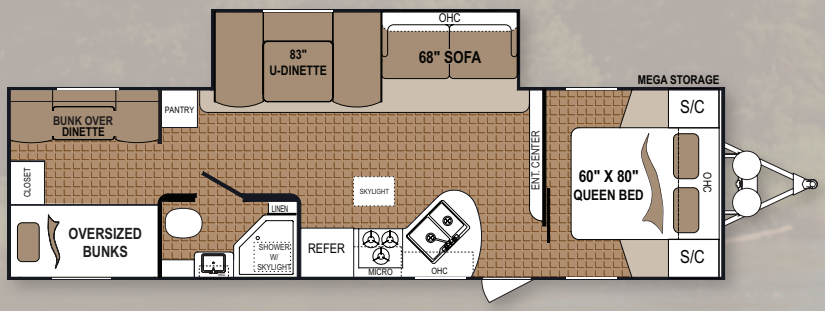

3130QBS

Hitch Weight (lbs)	827	Fresh Water Capacity	52
Unloaded Weight (lbs)	6,888	Black Water Tank(s)	42
Cargo Capacity (lbs)	2,792	Grey Water Tank(s)	42
Overall Height w/AC	11' 6"	Furnace BTU Output	34,000
Overall Length	34'		

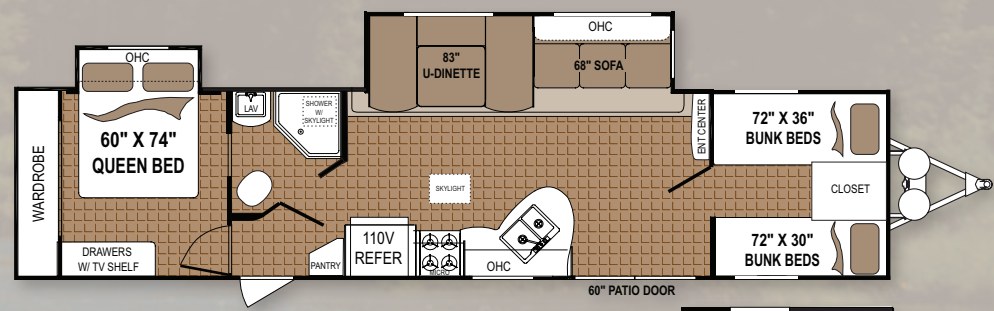

3600QBS

Hitch Weight (lbs)	1,071	Fresh Water Capacity	52
Unloaded Weight (lbs)	8,184	Black Water Tank(s)	42
Cargo Capacity (lbs)	2,992	Grey Water Tank(s)	78
Overall Height w/AC	11' 5"	Furnace BTU Output	34,000
Overall Length	39' 3"		

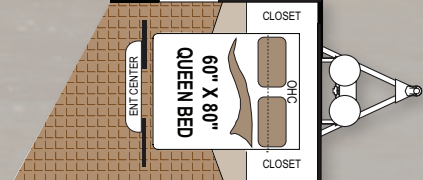

Queen Bed Option

STANDARD AND OPTIONAL FEATURES

ASPEN TRAIL VALUE ADDED PACKAGE
Aerodynamic Front Profile
Front Diamond Plate Rock Guard
Touch Screen 12V AM/FM/CD/DVD in Wall Stereo with MP3/IPOD® Input
Interior and Exterior Speakers
Central Command Center
Full Extension Roller Ball Bearing Drawer Guides in Galley
Cherry Glazed Hardwood Cabinet Doors
Laundry Chute (See Floor Plans) - Slide Models Only
Evergreen 60" x 80" Deluxe Quilted Mattress
Beauflor® Wood Plank Premium Vinyl Flooring
"Mega Storage" Pass Thru Storage Compartment (See Floor Plans)
82" Interior Ceiling Height
"Super Slide" Slide Room with 72" Interior Height

INTERIOR FEATURES
KITCHEN
Residential Microwave Oven with Carousel
Auto Ignition 3 Burner Range with Oven (Slide Models)
3 Burner Cook Top (Non Slide Models)
Large 6 Cubic Foot Double Door Gas/Electric Refrigerator
Extra Large, Double Bowl Sink with High Rise Faucet
Power Range Hood with 12 Volt Light and Exhaust Fan

LIVING AREA FEATURES
Premium Residential Furniture
Large Radius Corner Slide-Out Overhead Cabinets
Premium Slide-Out Fascia
12 Volt Lights Over Dinette
Designer Window Treatments with Mini Blinds Throughout
Swivel Chairs (See Floor Plans)
Fold-Down Sofa (See Floor Plans)
83" U-Shaped Convertible Dinette (See Floor Plans)
Wall Switches for Overhead Lights

BEDROOM FEATURES
TV Hook-Ups In Bedroom (See Floor Plans)
Lift-Up Bed Storage (See Floor Plans)
Designer Bedding Package with Bedspread Reading Lights
Privacy Curtain for Bunks
Sliding Bedroom Doors

BATHROOM FEATURES
ABS Tub & Shower Surround
Shower/Exhaust Fan
Glass Shower Door (See Floor Plans)
Designer Mirror
110V GFI Outlet
GFI Protected 110 Volt
Duplex Receptacles
Towel Hooks
Foot Flush Toilet

"STORE MORE" CABINETRY
Radius Corner - Full Access Cabinet
Cherry Glazed Hardwood Panel Drawer Fronts and Cabinet Doors in Galley
Deep Slide Room Cabinets with Decorative Glass Inserts

APPLIANCES AND SAFETY EQUIPMENT
6 Gallon Gas DSI Water Heater
Water Heater By-Pass
34K BTU Furnace (Most Models - See Floor Plans)
13.5 BTU Roof Ducted Air Conditioning (Most Models - See Floor Plans)
Premium 12 Volt Water Pump
55 Amp Electronic Converter
Digital TV Antenna with Booster
Wired for Cable
Monitor Panel
Smoke Detector
Carbon Monoxide Detector
LP Leak Detector

CONSTRUCTION
CHASSIS
Heavy Duty Steel I-Beam Frame
Dual Battery Tray
2 5/16" Coupler
Break-Away Trailer Switch
Heavy Duty Safety Chains
(2) 20 lb. LP Bottles
Rear Stabilizer Jacks
Easy Lube Axles
Steel Rims
Folding Entry Steps
Rear Bumper
46 Gallon Fresh Water Tank

FLOOR
16" on Center Studs
5/8" Tongue and Groove Floor Decking

ROOF
Walk-On Roof with Fiberglass Insulation R-7
Seamless TPO Roof with 12 Year Mfg. Warranty
3/8" Roof Decking
Roof Ducted Air Conditioning (Most Models - See Floor Plans)
Extended Rain Gutters

WALLS
Manual Awning with Adjustable Legs
Detachable 30 Amp Power Cord
Hurricane Straps Integrate Walls to Roof and Floor
Heavy Duty .024" Mesa Sidewall Metal
R7 Fiberglass Insulation
Key-Locking, Radius Corner Exterior
"Mega Storage" Compartments
Pebble Finish Entry Door
Patio Light
Tinted Safety Glass Windows
Large Picture Window at Dinette
120V Exterior Outlet

ACU-WEIGHT CERTIFICATION
Real Weights - All Units Weighed Before Leaving the Factory
Weights Include Options - See Acu-Weight Decal on Unit

OPTIONAL FEATURES
15,000 BTU A/C Upgrade
Radial Tires (Mandatory)
Spare Tire and Cover
Front Stabilizer Jacks
Sink Covers
Oven (Non Slides)
6 Gallon Quick Recovery Gas/Electric/DSI Water Heater
Exterior Wash Station
30 lb. LP Bottles with Deluxe ABS LP Bottle Cover
Power Stabilizer Jacks
Power Awning



DSI
18th Annual RVDA DEALER SATISFACTION INDEX

Product information, specifications, and photography in this brochure were as accurate as possible at time of printing. Photographs may contain some features that are optional on your vehicle. Since we continually strive to improve our products, actual products may differ. Prices and specifications are subject to change without notice. All capacities are approximate and dimensions are nominal. Some features shown are optional and may be different or unavailable in Canada. Vehicles are designed for recreational use only and not intended for use as a primary residence.

www.AspenTrailRV.com
Dutchmen Manufacturing, Inc.
2164 Caragana Court
Goshen, Indiana 46526
Sales: 574.537.0600 Fax: 574.975.6274



FABRICS

FRENCH ROAST



PAOLA PEBBLE



PEPPERCORN



Your Local Dealer

Follow "DutchmenRV" on