

Springdale

Adventure

Begins Here.



Springdale



Summerland

Eastern Edition



Keystone RV
Company

Springdale Travel Trailer



282BH wardrobe



282BH bunks

Springdale has so many features that offer the best value in the market and the best floorplans to fit your specific camping needs. Take a look at these action packed campers that offer exactly what you are looking for in front living spaces, bunks for the kids, plenty of storage, Super Slide Rooms (SSR), and roomy open spaces. If you have a need or a want, Springdale has the camper for your next Adventure!



Adventure Begins Here.



Full Extension Drawers
in all Springdales



Oversized and Deep High Impact
Acrylic sinks found in all Springdales



275FL Bedroom
shown here in Cordavan

At Springdale we know that convenience and comfort are very important when you are on your Adventure and we strive to make that a reality for you. The Galley's make prep work to cleanup effortless. All Springdales have full extension pull out drawers and deep sinks that make the most experienced camper happy. Large bedrooms and room to roam in the main living areas make the Springdale easy to navigate for the entire camping crew!



Springdale Travel Trailer



You not only want to feel good while camping you want to look good too, Springdale went all out for this Adventure. Our interiors capture the true essence of modern and contemporary style blended with progressive accents that will make you the envy of the campsite. Form and function do meet with Springdale. Whether it's large bunkrooms, or large



303BH Bunkroom - it's for the kids!



Outside Kitchen



Front Kitchen of the 299FK

Adventure Begins Here.



galleys inside and out, Springdale will exceed your expectations. Shown above in Palm Canyon, you can see what makes Springdale the travel trailer you want for your next adventure.

Decor Options



Palm Canyon



Cordovan



Sedona Sunrise

www.keystone-springdale.com

Summerland

Travel Trailer



Why not have exactly what you want to go camping and do it with style and grace? Summerland by Springdale offers a great look and awesome features at a price that will fit any budget. Versatile floorplans, a variety of sizes, and packed with so many features you will not want to stay home! Summerland has what you want to begin your Adventure!



"Summerlounge" in the 2800BH...



...Conveniently converts to bunk room

Adventure Begins Here.



As you can see, we made the new Summerland both beautiful and functional. With an abundance of cabinets, overheads, and closets, there is plenty of room to stow all your gear. And the Super Slide Room is spacious enough for you to stretch out and relax. The Summerland 2800BH shown here in Cordovan décor will whisk you into an adventure and memories you will not soon forget.



www.keystone-summerland.com

Springdale

Fifth Wheel



Floor Plans



242FWRLSSR



247FWRLLS



249FWBHSSR



253FWRLLS



280FWIKSSR



284FWBHSSR

Specifications

www.keystone-springdale.com

Fifth Wheel

Fifth Wheels	242FWRLSSR	247FWRLLS	249FWBHSSR	253FWRLLS	280FWIKSSR	284FWBHSSR
Shipping Weight	6215	6415	6318	6939	7241	7902
Carrying Capacity	1765	1560	1787	1276	2884	2553
Hitch Weight	980	975	1105	1215	1185	1355
Exterior Length	26' 3"	27' 8"	27' 2"	29' 9"	31' 3"	32' 5"
Ext Height	11' 4"	11' 11"	11' 4"	11' 4"	11' 11"	11' 11"
Fresh Water	50	50	50	50	50	50
Waste Water	34	34	30	34	34	34
Grey Water	34	64	64	34	64	64
LPG Capacity	60	60	60	60	60	60
Tire Size	ST205/75R15C	ST205/75R15C	225/75R15C	ST225/75R15C	ST225/75R15D	ST225/75R15D

Travel Trailer

Travel Trailers	1790QB	1890FL	2100RB
Shipping Weight	3928	4059	5247
Carrying Capacity	2062	2351	2273
Hitch Weight	490	410	520
Exterior Length	20' 10"	23' 7"	25' 11"
Ext Height	10' 6"	10' 6"	10' 6"
Fresh Water	50	50	50
Waste Water	30	34	34
Grey Water	30	30	64
LPG Capacity	40	40	40
Tire Size	ST205/75R15C	ST205/75R15C	ST205/75R15C

Product information is as accurate as possible at the date of publication of this brochure. Features, floor plans, and specifications are subject to change without notice. Please also consult Keystone's web site at keystonerv.com for more current product information and specifications. Tow Vehicle Disclaimer. CAUTION: Owners of Keystone recreational vehicles are solely responsible for the selection and proper use of tow vehicles. All customers should consult with a motor vehicle manufacturer or their dealer concerning the purchase and use of suitable tow vehicles for Keystone products. Keystone disclaims any liability or damages suffered as a result of the selection, operation, use or misuse of a tow vehicle.

Summerland

Travel Trailer



1790QB



1890FL



2100RB



2560RL



2570RL



2600TB



2670RL



2800BH



2980BHGS



3030BHGS

2560RL	2570RL	2600TB	2670RL	2800BH	2980BHGS	3030BHGS
4657	5628	4712	5820	6320	6328	7310
2958	1977	2833	1825	2060	3187	2345
615	605	545	645	730	715	855
27' 11"	28' 8"	28' 10"	28' 11"	31' 9"	32' 7"	34' 11"
10' 6"	10' 6"	10' 6"	10' 11"	10' 11"	10' 11"	10' 11"
50	50	50	50	50	50	50
34	34	34	30	34	30	30
34	30	30	34	60	34	34
40	40	40	40	40	40	40
225/75R15D	ST225/75R15C	ST225/75R15C	ST225/75R15C	ST225/75R15D	ST225/75R15D	ST225/75R15D

KEYSTONE'S LIMITED WARRANTY DOES NOT COVER DAMAGE TO THE RECREATIONAL VEHICLE OR THE TOW VEHICLE AS A RESULT OF THE SELECTION, OPERATION, USE OR MISUSE OF THE TOW VEHICLE. 02/2012



266RLSSR



267BHSSR

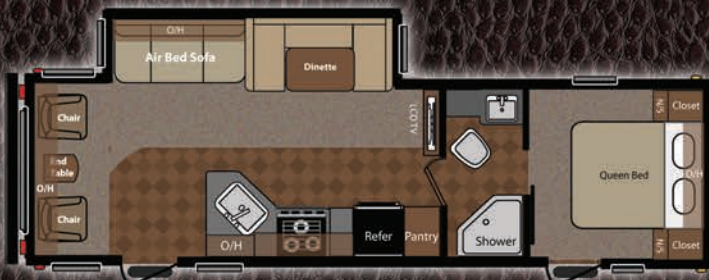

292RLSSR



293RKSSR



296BHSSR

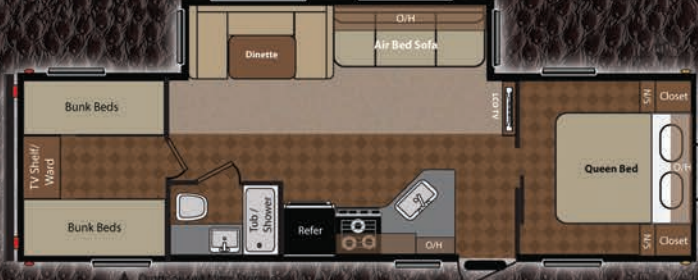

298BHSSR

Specifications

Travel Trailers	266RLSSR	267BHSSR	275FL	282BHSSR	292RLSSR	293RKSSR	294BHSSR	295RBSSR	296BHSSR	298BHSSR
Shipping Weight	6220	6166	7205	6730	6871	6805	6950	6940	6820	6756
Carrying Capacity	1555	1614	2450	2830	2619	2700	2565	2585	2770	2799
Hitch Weight	775	780	855	760	690	705	715	785	790	755
Exterior Length	28' 11"	28' 11"	32' 8"	31' 11"	32' 11"	32' 11"	32' 7"	32' 1"	33'	32' 7"
Ext Height	10' 11"	10' 11"	10' 11"	10' 11"	10' 11"	10' 11"	10' 11"	10' 11"	10' 11"	10' 11"
Fresh Water	50	50	50	50	50	50	50	50	50	50
Waste Water	34	30	30	30	34	34	30	30	30	30
Grey Water	34	64	34	64	34	64	34	64	34	34
LPG Capacity	60	60	60	60	60	60	60	60	60	60
Tire Size	ST205/75R15C	ST205/75R15C	225/75R15D	225/75R15D	ST225/75R15D	ST225/75R15D	ST225/75R15D	ST225/75R15D	ST225/75R15D	ST225/75R15D

Product information is as accurate as possible at the date of publication of this brochure. Features, floor plans, and specifications are subject to change without notice. Please also consult Keystone's web site at keystonerv.com for more current product information and specifications. Tow Vehicle Disclaimer. CAUTION: Owners of Keystone recreational vehicles are solely responsible for the selection and proper use of tow vehicles. All customers should consult with a motor vehicle manufacturer or their dealer concerning the purchase and use of suitable tow vehicles for Keystone products. Keystone disclaims any liability or damages suffered as a result of the selection, operation, use or misuse of a tow vehicle. KEYSTONE'S LIMITED WARRANTY DOES NOT COVER DAMAGE TO THE RECREATIONAL VEHICLE OR THE TOW VEHICLE AS A RESULT OF THE SELECTION, OPERATION, USE OR MISUSE OF THE TOW VEHICLE. 02/2012

Floor Plans



275FL



282BHSSR



295RBSSR



294BHSSR



303BHSSR



299FKSSR



311RESSR

299FKSSR	303BHSSR	311RESSR	372BHGL	373QBGL
7382	7725	7710	8220	8177
2273	1900	1865	2825	2868
855	825	775	910	885
32' 11"	34' 11"	35' 5"	38' 6"	38' 6"
11' 3"	11' 3"	11' 3"	11' 3"	11' 3"
50	50	50	50	50
30	30	34	34	34
64	34	68	64	64
60	60	60	60	60
ST225/75R15D	ST225/75R15D	ST225/75R15D	ST225/75R15D	ST225/75R15D



372BHGL



373QBGL

Standards & Options

Springdale
Fifth Wheel
Summerland

CONSTRUCTION

	Springdale	Fifth Wheel	Summerland
2 - 30# LP Bottles w/ auto change over (with cover TT)	●	●	
Manual Stabilizer Jacks (4)*			●
Stablizer Jacks (2)*		●	
Electric Front Landing Gear		●	
Fiberglass Exterior*			●
Spread Axle (models w/Slides)	●	●	●
E-Z Open Entry Step	●	●	●
Radial Tires	●	●	●
13.5K Ducted A/C (all Springdale most Summerland models)	●	●	●
Tub Surround	●	●	
2x3 Floor Construction 12" OC with 5/8ths Decking	●	●	●
16" On Center Side Walls	●	●	●
16" On Center Raised Roof Truss System	●	●	●
R-7 Insulation Floor, Roof, Walls	●	●	●
Fully Enclosed Underbelly	●	●	
Powder Coated I-Beam Frame	●	●	●
Diamond Plate*	●		
Tinted Safety Glass	●	●	●

ENTERTAINMENT

	Springdale	Fifth Wheel	Summerland
2 Exterior Speakers*	●	●	●
4 Interior Speakers*	●	●	
2 Interior Speakers			●
AM/FM/CD/DVD MP3 Player*	●	●	
AM/FM/CD Player			●
Cable and Satellite Prep	●	●	●
26" LCD HD TV*	●	●	

KITCHEN

	Springdale	Fifth Wheel	Summerland
Wallpaper Border	●	●	●
High Impact Acrylic Sink	●	●	●
Steel Ball Bearing Drawer Guides	●	●	●
Residential Lighting in Slide	●	●	
Spice Rack below sink	●	●	●
22" Oven with 3 Burner Cootop	●	●	
18" Oven with 3 Burner Cooktop			●
6 cu. ft. 110V /LP Fridge	●	●	●
Microwave	●	●	●
Do More Dinette Table	●	●	
Plantation blinds in Galley area	●	●	
Vented Range hood w/light	●	●	●
Sink Cover*	●	●	
Stove Cover*	●	●	
Outside Shower*	●	●	
Fabric pleated Night Shades thru out	●	●	

BED BATH & MORE

	Springdale	Fifth Wheel	Summerland
Night Stand w/Drawer in Bedroom		●	●
Night Stand			●
Skylight Over Tub/Shower	●	●	●
Forced Air DSI Furnace w/Thermostat (ducted most models)	●	●	●
6 Gal. Gas/Electric DSI Water Heater	●	●	
55 amp converter	●	●	●
Water Heater Bypass	●	●	●
Manual Patio Awning			●
Jack Knife Sofa Bed			●
Porcelain Foot Flush Toilet	●	●	●

SUMMERLAND

	Springdale	Fifth Wheel	Summerland
Summer Package*			●
Tub Surround			●
6 Gal. Gas DSI Water Heater			●
2-30# LP Bottles w/ Cover			●
Outside Shower			●

SPRINGDALE

	Springdale	Fifth Wheel	Summerland
One Touch Plus Package*(N/A 372, 373)	●		
Electric Awning		●	●
Power Stabilizer Jacks		●	
Power Tongue Jack		●	
Sofa with Air Mattress Hide-a-bed		●	●
Aluminum Rims		●	
XL Entry Assist Handle		●	

SAFETY

	Springdale	Fifth Wheel	Summerland
Fire Extinguisher	●	●	●
Smoke Detector	●	●	●
LP Detector	●	●	●
CO Detector	●	●	●
Safety Chains	●	●	●
Emergency Brake-a-way switch	●	●	●

* Standard Build or Forced option

● Package

Springdale Popular Options

15K BTU A/C
Spare Tire

372 and 373 Options

Extra Large Refer
10 Gal Gas/Electric DSI Water Heater
Washer/Dryer Prep w/ 50 amp service

Your Local Dealer is:

www.keystone-springdale.com

www.keystone-summerland.com