

Copper Canyon

BY SPRINTER

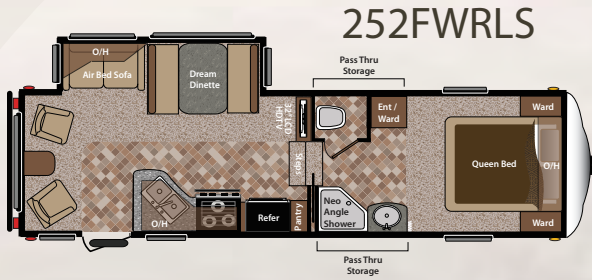

252FWRLS

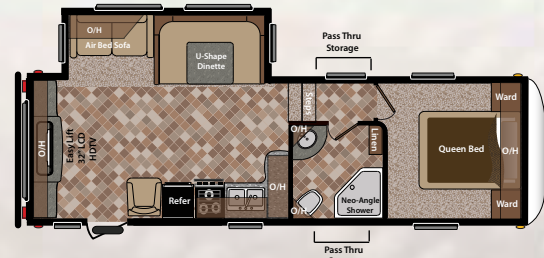

270FWRET

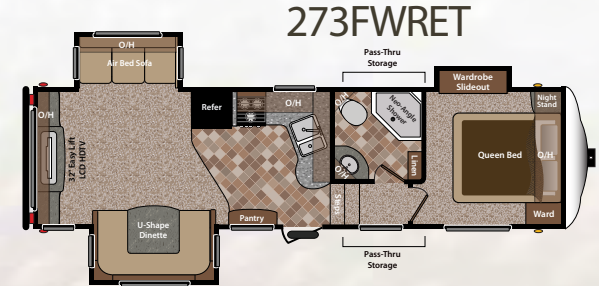

273FWRET



275FWBHS

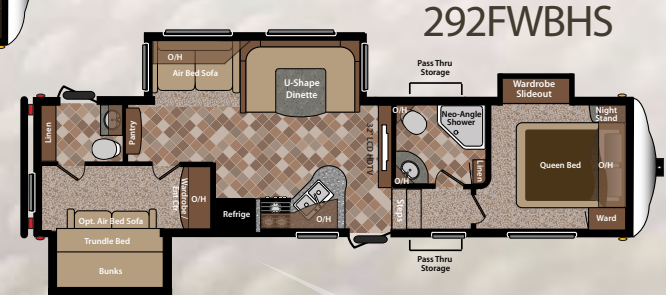

292FWBHS

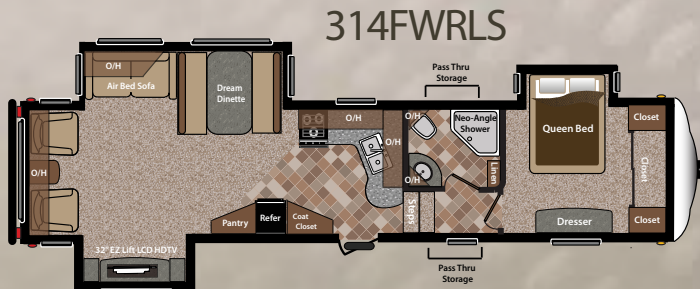

314FWRLS

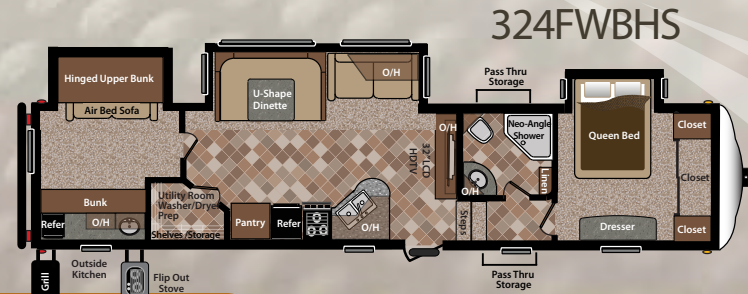

324FWBHS

FIFTH WHEELS

MODEL	252FWRLS	270FWRET	273FWRET	275FWBHS	292FWBHS	314FWRLS	324FWBHS
WEIGHT	7,168	7,195	8,010	TBD	9,185	9,673	10,652
CARRY CAPACITY	2,952	2,955	2,375	TBD	2,720	2,827	3,508
HITCH	1,320	1,350	1,585	TBD	1,745	1,920	2,160
LENGTH	28' 11"	30'	30' 11"	31'	34' 7"	36'	38' 6"
EXT. HGT. - AC TOP	12'	12'	12'	12'	12'	12' 8"	12' 8"
FRESH WTR	44	47	47	44	47	47	47
WASTE WTR	32	32	32	32	64	32	32
GREY WTR	64	32	32	64	64	32	96

Scan & See

View features, photos and more! Get your free app at: <http://gettag.mobi>



Copper Canyon

BY SPRINTER



KEYSTONE-COPPERCANYON.COM

EXTERIOR FEATURES

- Laminated aluminum framed sidewalls
- Enclosed underbelly w/ direct vent heat
- Fiberglass front cap w/mirror and lights
- E-Z Lube® axles
- One touch electric awning
- Friction Hinge Entry Door
- Bus Style Slam Baggage Doors
- Rear bumper storage
- Easy opening triple entry step
- Entry step light
- Extra large Folding Grab Handle
- Tough guard painted skirt metal
- Patio light
- Extra long rain gutters and spouts
- Two 30 LBS LP bottles with automatic change-over
- Battery disconnect system
- Roto-cast seamless holding tanks
- Keystone Original space maker 47 gallon fresh water system
- Docking Station
- Black Tank Flush System in Docking Station
- Spray port with hot and cold water in Docking Station
- City water connection in Docking Station
- Fresh water tank fill in Docking Station
- Cable and satellite hook-up in Docking Station
- 30' 30 Amp power cord
- LP gas BBQ hook-up
- Electric front jacks
- Radial Tires
- Outside speakers
- Light at termination points
- Rear ladder
- Wire and frame for a second A/C (324FWBHS, 314FWRLS 292FWBHS only)
- 50 amp service (324FWBHS, 314FWRLS, 292FWBHS only)
- Picnic Table in pass through
- Back-up light
- Toylok® Security System

- Upgraded two burner cooktop (Outside Kitchen models only)
- Bumper mounted grill (Outside Kitchen models only)
- 12V Power plug (Outside Kitchen models only)
- TV hook up in pass thru storage for outside viewing
- Easy access winterization
- Jealousy windows
- 80% tint windows

INTERIOR FEATURES

- 13,500 BTU ducted air conditioner with "Quick Cool" (15K std in 292, 314 and 324)
- 30 amp electrical distribution panel (50 Amp std in 292, 314 and 324)
- 12 Volt, 55 amp converter
- 30,000 BTU auto-ignition furnace
- Windows in both slide room end walls
- Digital Thermostat
- Water heater bypass for easy winterization
- Residential cabinet hardware
- Large picture window at the dinette
- 6' 3" interior slide room height
- 12 volt slide room lights for dry camping
- Overhead slide room cabinets
- Screwed cabinetry w/ lumber core stiles
- Beau-flor linoleum
- Home Theater Surround Sound® system
- In floor ducted heat
- Command Center for awning, slide-outs, tank monitors, lights and battery
- Full extension ball bearing drawer guides
- Residential slide out pantry
- LED floor lighting
- Easy find light switches
- Washer/Dryer prep (324FWBHS only)

LIVING ROOM FEATURES

- Cable TV hook-up with antenna and signal booster

- Satellite prep w/ RG6 cable
- High grade carpeting with pad
- Residential fabric-covered valances
- Angled overhead storage in the slide room
- Home theater DVD / CD / AM / FM / MP3 hook-up
- Air bed sofa w/ storage drawer
- 32" HD LCD television
- Ceiling fan (314 and 324)

BATH FEATURES

- Large vanity sink
- Porcelain foot flush toilet
- Residential medicine cabinet with mirror
- ABS one piece tub surround
- Neo angle glass shower
- Skylight over tub
- Retractable clothes line in the shower/tub
- Reinforced tub support
- Power roof vent fan
- GFI receipts in the bathroom

KITCHEN FEATURES

- 6 gallon gas and electric DSI auto ignition water heater w/ 16.2 gph recovery
- 3 burner high output gas range
- American Stonecast under-mount deep 60/40 residential sink w/ Corian sink covers
- Corian counter tops
- Full extension ball bearing drawer guides
- Metal pull-out sprayer faucet
- Waste basket storage
- Lighted range hood with exhaust fan
- Microwave with carousel
- 17" oven
- Reversible dinette seat cushions
- Double door refrigerator
- Six panel wood refrigerator front (option)
- Raised panel cabinet doors throughout
- Overhead cabinets above the sink
- Two oversized pots and pan drawers

BEDROOM FEATURES

- Cable TV hook-up
- High grade carpeting with pad
- Under bed storage with gas struts
- Color matched bedspread
- Bedroom reading lights
- Electrical Outlets near the bed
- Dream Collection Mattress
- Headboard niche with puck lighting

"CUSTOMER FIRST"

SAFETY PACKAGE

- Tinted safety glass windows
- Dual hitch safety chains
- Easy Access manual override for the slide rooms
- Fire extinguisher
- Smoke detector
- Carbon monoxide detector
- Egress windows
- LP gas leak detector
- Break away safety brake
- 4 wheel electric brakes
- Hitch light
- Door side and off door side clearance lights
- Security light

POPULAR OPTIONS

- Spare tire
- 10 gallon water heater (252, 270 and 273. STD in 292,314,324)
- Upgraded 15,000 BTU air conditioner (252, 270 and 273. STD in 292,314,324)
- Free standing dinette with four chairs
- Extra large refrigerator (252, 270 and 273. STD in 292,314,324)
- 2 gliders ipo rockers (252, 314)
- 68" air bed sofa ipo lower bunk and trundle (292 only)

"CAMPING MADE EASY" PACKAGE

- E-Z Lube axles
- Electric Awning
- Battery Disconnect
- Back-Up Light
- Easy Access manual override for the slide rooms
- Docking Station (Includes city water, fresh water tank fill, Black Tank Flush, Spray Port with hot and cold water, Cable and Satellite Hook-up)
- Bumper mount grill (Outside Kitchen models only)
- LED floor lighting
- Dream Collection Mattress
- Gas/electric water heater with 16.2 gph recovery
- DVD theatre system with outside speakers
- Friction Hinge Entry Door
- Toylok® Security System
- Picnic Table in pass through
- Exterior BBQ hook-up
- Exterior speakers
- Easy find light switches
- 12V Plug in Outside Kitchen models



YOUR LOCAL DEALER:



2642 Hackberry Drive, PO Box 2000
Goshen, IN 46527-2000
keystonerv.com | (574) 535-2100

Go RVing



Product information is as accurate as possible as of the date of publication of this brochure. Features, floor plans, and specifications are subject to change without notice. Please also consult Keystone's web site at www.keystonerv.com for more current product information and specifications. Tow Vehicle Disclaimer. CAUTION: Owners of Keystone recreational vehicles are solely responsible for the selection and proper use of tow vehicles. All customers should consult with a motor vehicle manufacturer or their dealer concerning the purchase and use of suitable tow vehicles for Keystone products. Keystone disclaims any liability or damages suffered as a result of the selection, operation, use or misuse of a tow vehicle. KEYSTONE'S LIMITED WARRANTY DOES NOT COVER DAMAGE TO THE RECREATIONAL VEHICLE OR THE TOW VEHICLE AS A RESULT OF THE SELECTION, OPERATION, USE OR MISUSE OF THE TOW VEHICLE. 9/2011