

# XLR HYPER LITE

*Always On The Go!*



XLR HYPER LITE





HyperLite travel trailers are as rugged as you are, inside and out... HyperLites are constructed with lightweight, vacuum bonded aluminum sidewalls and gel coated fiberglass. ALL HyperLite floorplans are half-ton towable. *XLR – Customer driven!*



**24HFS** When it's time to pack up, these fold-over sofas secure to the sidewall, allowing plenty of space for your quads, a couple of full-dressed motorcycles or any gear that fits your lifestyle.

**24HFS** This HyperLite's spacious bathroom features a corner shower complete with a skylight.



**HYPER LITE**

All HyperLite floorplans are half-ton towable!

PLATINUM

ONYX

BRONZE



## XLR HYPERLITE FEATURES

### INTERIOR FEATURES

- AM/FM CD Stereo w/Auxiliary Jack & USB Charger
- 12V Battery Disconnect
- Dometic 6 Cu. Ft. Double Door Refer
- 2 Burner Cooktop
- Microwave
- Kitchen Sink Covers
- Cognac Maple Cabinetry
- TV Antenna w/Booster
- Night Shades in Living Room & Bedroom
- Shower/Tub Surround
- Skylight Over Shower/Tub
- Pillow Top Mattress
- 6 Gal. Gas/Electric/DSI Water Heater
- 50 AMP Converter
- 20,000 BTU Furnace

### EXTERIOR

- Reverse Activated Rear Flood Lights
- Security Patio Light
- Black Framed Windows w/Tinted Safety Glass
- Front Diamond Plate Rock Guard
- Radius Black Framed Entry Door
- Radius Baggage Doors
- 3,500 lb E-Z Lube Axles
- 15" Nitro-Fill Radial Tires w/Black Steel Wheels
- 30 AMP Service w/Power Cord
- Dual 20 lb. LP Bottles
- Four Corner Crank Down Stabilizer Jacks
- 96" Wide Construction
- 8" Powder Coated, I-Beam Chassis
- 3/4" Marine Grade Plywood Floor
- POLYDET® HG Gel Coated Fiberglass
- Vacuum Bonded Sidewalls w/Block Foam Insulation

### CARGO AREA

- 7' Insulated, Spring Assist Ramp Door
- Keyed Compression Lock Ramp Door
- Gas/Oil Resistant Flooring
- Ram Air Vents
- 5,000 lb Flush Mount Tie Downs
- Diamond Plate Tire Guard

### OPTIONAL EQUIPMENT

- Kick Start Package (Mandatory - 13.5K BTU ducted A/C, spare tire, LP quick disconnect, A-frame generator storage & double battery location, blackout features)
- Extreme Package (12V Heated holding tanks, dual pane windows, double insulation in roof)
- Premium Off Road Package (15" All terrain tires w/spare, Toy Lok, spray port, flood lights)
- Power Tongue Jack
- Hot and Cold Outside Shower
- Cargo Entry Door (27HFS only)
- Aluminum Wheels
- Frame Mounted Toy Lok
- Generator Prep
- 4.0kW Onan CARB EVAP Generator (Must order gen prep)
- Mobile Fuel Station (Must order gen prep)
- 15K BTU A/C IPO 13.5K
- 26" Living Room TV w/Exterior Bracket
- Fantastic Fan IPO Std 12V Fan - Bathroom
- Sport Rockers (2) IPO Roadside Sofa (25HFK only)
- Removable Cargo Carpet Kit
- Vinyl Cargo Screen Wall
- Retractable Hid-N-Screen
- Queen Single Electric Bed (24HFS, 27HFS)



**27HFS** XLR customers asked for it, we delivered. This sofa/dinette completely opens up the living area, providing an impressive amount of living space in a half ton towable trailer.

**27HFS** is a two bedroom bunk house.



**27HFS** Rest easy with all the comforts of home in this front bedroom with a queen bed.



After unloading your equipment, the garage area converts to a second private bedroom with the push of a button.



# HYPER LITE

Choose the HyperLite that fits your active lifestyle from five travel trailer floorplans available with or without slide out or a garage. Plan an extreme sporting excursion or a fully equipped family outing. The possibilities are unlimited. These versatile floorplans grow with your family and can accommodate any lifestyle.

**ALL FLOORPLANS ARE 1/2 TON TOWABLE!**

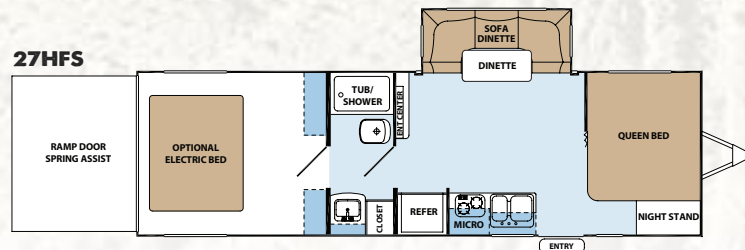
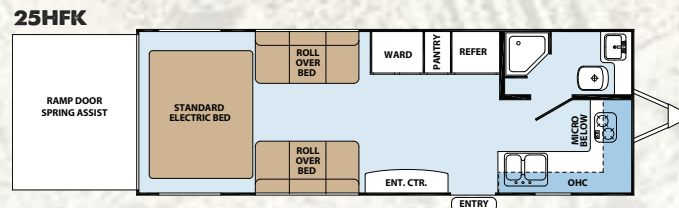
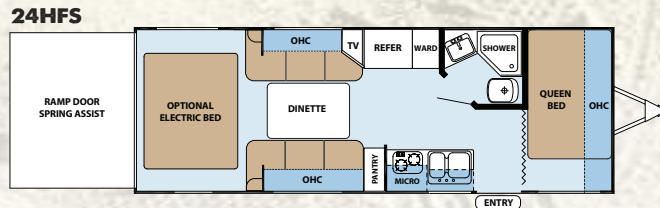
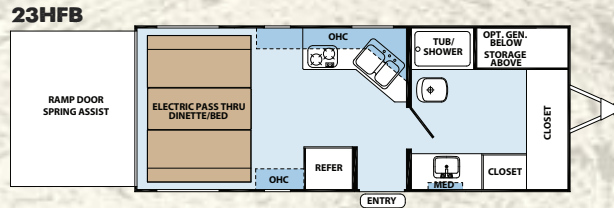
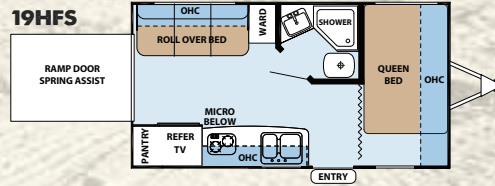

## XLR HYPERLITE TRAVEL TRAILER SPECIFICATIONS

Model	Hitch Weight	Ship Weight	GVWR	Cargo Capacity	Exterior Length	Exterior Height	Exterior Width	Fresh Water	Gray Water	Black Water	Awning Size
19HFS	532	4372	7532	3160	21'6"	11'0"	96"	60	32	28	13
23HFB	691	4853	7691	2838	23'10"	11'0"	96"	60	32	32	12'
24HFS	577	5675	7577	1452	27'5"	11'0"	96"	60	32	28	18'
25HFK	669	4728	7669	2491	27'1"	11'0"	96"	60	32	28	15'
27HFS	876	5578	7876	1848	30'0"	11'0"	96"	60	63	32	18'

Actual towing capacity is dependent on your particular loading and towing circumstances, which includes GVWR, GAWR and GCWR, as well as adequate trailer brakes. Please refer to the Owners Manual of your vehicle for further information. Floor plans, features and specifications are subject to change without notice. 11/11/10K ©2011 XLR



### PRE-DELIVERY INSPECTION FACILITY

20,000 square feet of quality assurance. The bare essentials for a premium product. This state-of-the-art facility gives immediate daily feedback to production for quality assurance in every unit built.



- 1) Forest River, Inc. dealers are independently owned and operated businesses so priority service and scheduling is at their discretion and is often provided to customers that purchased their unit at that dealership.
- 2) Purchasing locally allows customers to establish meaningful relationships with a dealer, enhancing the RV experience through assistance with product questions, user tips or RV regulations for your state or country, and much more!
- 3) Canadian customers must meet requirements to bring an RV purchased out of the country to their home. These requirements may involve additional inspections and certifications, taxes and fees. Your local Canadian Dealer is a professional at meeting these requirements.
- 4) Scheduling timely warranty repairs and adjustments through a local dealership provides far greater flexibility and convenience to you, the customer!

Forest River, Inc. encourages our customers to purchase their Forest River products from a local dealership whenever possible for the following reasons:

It is the goal of Forest River, Inc. that all of our RV owners fully enjoy the RV experience and that customer satisfaction meets or exceeds their expectations!



Learn More  
Scan this barcode using a QR Reader on your smart phone to learn more about Forest River.



A Berkshire Hathaway company.

YOUR XLR HYPERLITE DEALER

# HYPER LITE

CHECK US OUT ON:

## FOREST RIVER

2431 E. Kercher Road ■ Goshen, IN 46526 ■ E-mail: XLRinfo@forestriverinc.com  
Phone: 574-975-0279 ■ Fax: 574-343-5909  
www.forestriverinc.com/XLR ■ www.forestriveraccessories.com