

Flagstaff

SUPER LITE, MICRO LITE, SHAMROCK



Flagstaff

SUPER LITE, MICRO LITE, SHAMROCK



27BESS
Sante Fe with Cherry



Flagstaff

SUPER LITE SERIES

Our trailers are packed full of quality features in order to bring to you one of the best values in the light weight market. When you explore our floorplans, you will notice spacious flush floor slides, distinctive decors with solid wood door and drawer fronts, utilizing free standing tables with easily adjustable legs. We use only the best inside our "Super Lite Series."

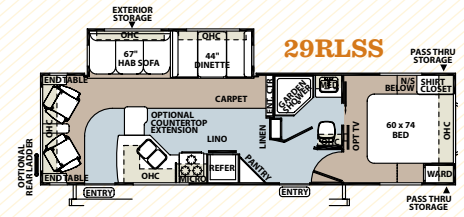
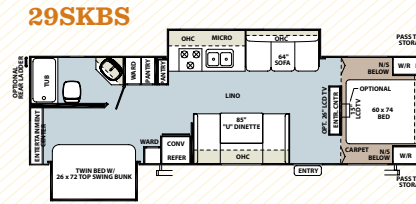
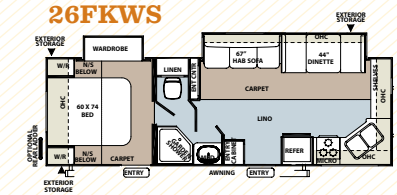
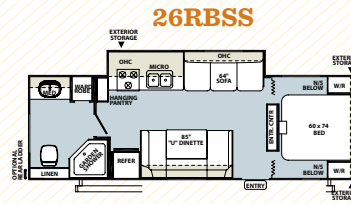
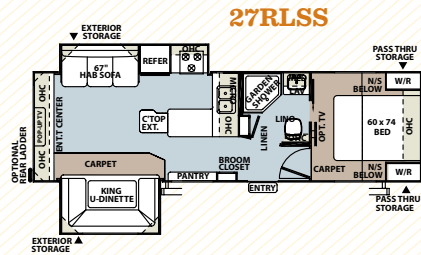
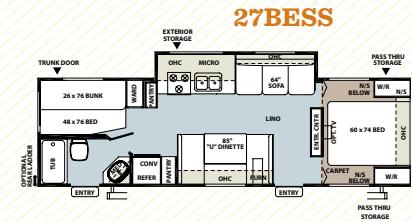
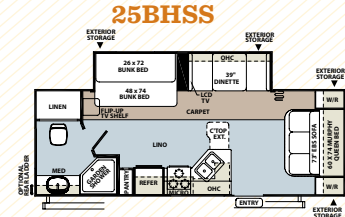
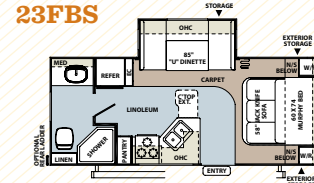
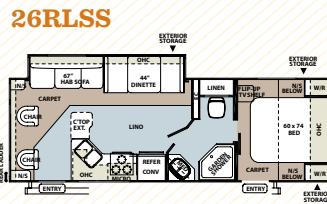
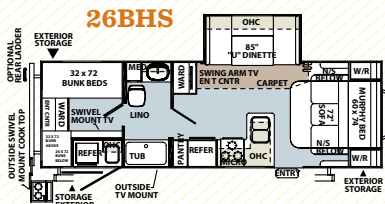

29QBSS

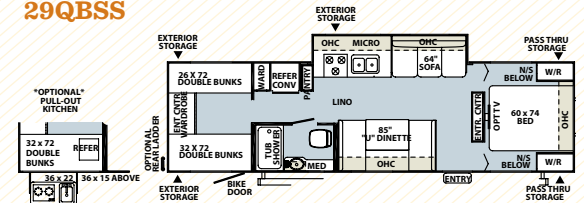

SPECIFICATIONS

Model number of any particular unit does not necessarily reflect the overall length of the unit itself. Dry weight are estimates

MODEL	23FBS	25BHSS	26RLSS	26BHS	26RBS	26FKWS	27BESS	27RLSS	29SKBS	29RLSS	29QBSS
GVWR (Gross Vehicle Weight Rating)	6594	6653	6603	6767	6580	6698	6594	7474	7703	7683	7384
BASE/DRY UNIT WEIGHT	4688	5231	5535	5255	4900	5675	5263	6048	5644	5889	5384
BASE DRY HITCH WEIGHT	678	653	603	767	580	698	594	474	703	683	641
BASE DRY AXLE WEIGHT	4010	4578	4932	4488	4320	4977	4669	5574	4941	5206	4743
CARGO CAPACITY	1833	1384	1030	1474	1642	985	1293	1388	1833	1756	1833
LENGTH	23' 9"	27' 5"	29' 7"	29' 5"	29' 7"	29' 7"	31' 11"	31' 11"	33' 5"	33' 5"	33' 5"
WIDTH	96"	96"	96"	96"	96"	96"	96"	96"	96"	96"	96"
HEIGHT W/O A/C	115"	118"	118"	118"	114"	120"	114"	114"	115"	115"	115"
INTERIOR HEIGHT	78"	78"	78"	78"	78"	78"	78"	78"	78"	78"	78"
FRESH WATER CAPACITY	36 gal	36 gal	36 gal	36 gal	36 gal	36 gal	36 gal	36 gal	36 gal	36 gal	36 gal
GRAY WATER CAPACITY	37 gal	37 gal	37 gal	37 gal	37 gal	74 gal	37 gal	37 gal	37 gal	74 gal	37 gal
BLACK WATER CAPACITY	37 gal	37 gal	37 gal	37 gal	37 gal	37 gal	37 gal	37 gal	37 gal	37 gal	37 gal



Flagstaff

MICRO LITE SERIES

With every series designed by Flagstaff, a premium is placed on superior craftsmanship and unmatched value. By combining lightweight towable floor plans with many residential features you wouldn't expect to find, the Micro Lite surpasses other products in its class. Compare and you will find, the Micro Lite is the best choice.

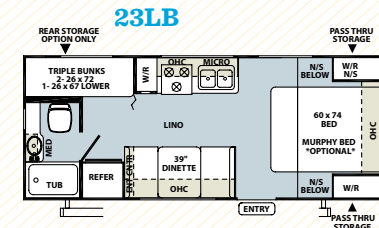
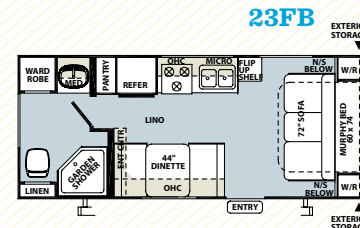
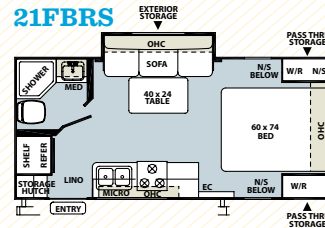
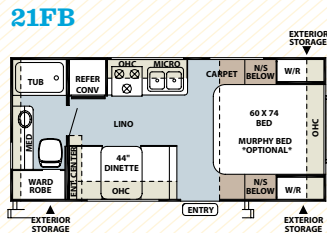
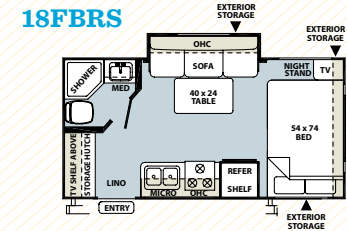
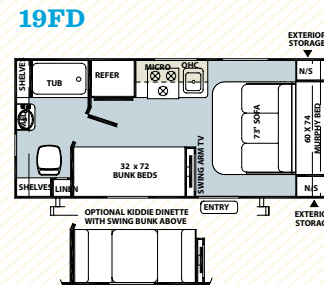
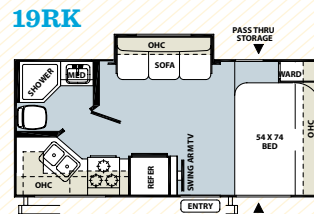
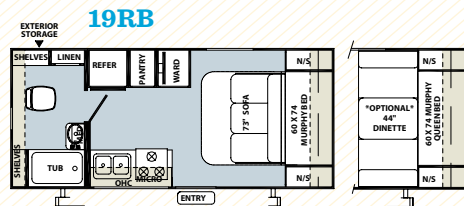

SPECIFICATIONS

Model number of any particular unit does not necessarily reflect the overall length of the unit itself. Dry weight are estimates

MODEL	19RB	19RK	19FD	18FBRS	21FB	21FBRS	23FB	23LB	25DS	25KS
GVWR (Gross Vehicle Weight Rating)	3846	3874	3892	4636	4786	4777	4951	4718	6119	6192
BASE/DRY UNIT WEIGHT	2785	2827	2761	3344	3419	3637	3717	3646	4136	4211
BASE DRY HITCH WEIGHT	346	374	392	236	386	377	551	318	325	425
BASE DRY AXLE WEIGHT	2439	2453	2369	3108	3033	3260	3166	3328	3811	3786
CARGO CAPACITY	1233	1233	1233	1233	1233	1233	1233	1233	1833	1833
LENGTH	20' 4"	20' 4"	20' 4"	19' 11"	21' 8"	21' 6"	23' 7"	23' 7"	25' 8"	25' 8"
WIDTH	90"	90"	90"	90"	96"	96"	96"	96"	96"	96"
HEIGHT W/O A/C	110"	110"	110"	109"	107"	111"	109"	109"	112"	112"
INTERIOR HEIGHT	78"	78"	78"	78"	78"	78"	78"	78"	78"	78"
FRESH WATER CAPACITY	36 gal	36 gal	36 gal	36 gal	36 gal	36 gal	36 gal	36 gal	36 gal	36 gal
GRAY WATER CAPACITY	30 gal	30 gal	30 gal	30 gal	30 gal	30 gal	30 gal	30 gal	30 gal	30 gal
BLACK WATER CAPACITY	30 gal	30 gal	30 gal	30 gal	30 gal	30 gal	30 gal	30 gal	30 gal	30 gal

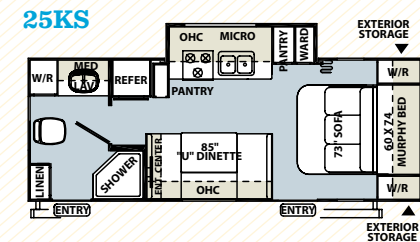
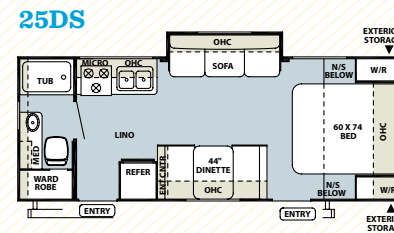

21FBRS

Seabury with Cherry



19FD

Sante Fe with Tuscan



19RB, 19RK, 19FD Exterior Profile



Rear Bunks w/
Storage below.



Sofa Accessible w/
Murphy Bed in Stored Position



Murphy Bed Shown in the Down Position.

Flagstaff FEATURES

Flagstaff takes pride in packing the most value possible into our Super Lite, Micro Lite and Shamrock series. While coming standard with many features, you still have the flexibility to incorporate as many options as you choose to fit your camping preferences.



- A** Power Awning with Adjustable Rain Dump *(Opt.)*
- B** Wood Door & Drawer Fronts
- C** 26" & 32" LCD w/ 5.1 Dolby Speaker System and Satellite Radio. *(Opt. SL: Select Models)*
- D** Aluminum Wheels *(Opt.)*



A



B



C



D

Luxurious Residential Fabrics



Sante Fe



Savannah



Seabury

Standard Floor
Covering



Cherry Décor
Option

Hickory Décor
Option



Tuscan Décor
Option

Wood-Look Floor
Covering Only avail-
able with Tuscan
& Combo Décor

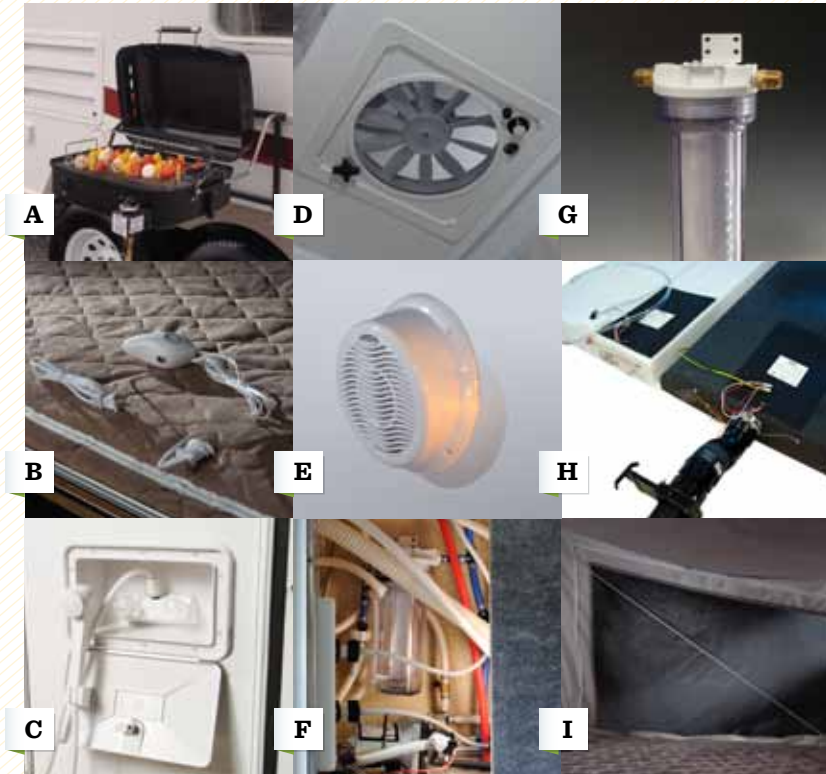

A RVQ grill (Opt.)

B Heated Innerspring Mattresses
(Std. Opt.)

C Outside Shower (Std.)

D Fantastic Fan (Std. Opt)

E Outside Speakers
(Std. 19RB, 19RK, 19FD Opt. All Other
Models)

F Outside Antifreeze Inlet with Easy Access
to Water Pump in Storage Compartment
for convenient Winterizing. (Std.)

G Water Filter (Std. Opt.)

H Heated holding tanks with 12 volt
heat pads. (Opt.)

I Shamrock Bunk Cables – No Support
Poles Needed
(N/A with Rear Slide Models)

Flagstaff CONSTRUCTION

Quality built trailers always bring the same results: long-lasting products you can depend on to enjoy with your family year after year. These are some of our highlights.



- A** Glued and screwed wood cabinetry
- B** Extra large dinette storage drawers
- C** Dexter® Axles & Easy Lube Hubs
 - Independent wheel suspension and self-damping action
 - Rubber cushioning eliminates metal-to-metal contact.
 - Forged torsion arm for maximum strength
- D** Aluminum dinette frames for added strength and weight savings
- E** Full extension metal drawer guides in the kitchen
- F** Fiberglass exterior with deluxe graphics
- G** Vacuum-bonded floor with 16" on center aluminum floor joists (*Std. Super Lite, select Shamrock models*)
- H** Enclosed underbelly protects trailer components as well as increasing aerodynamics (*Super Lite only*)

Wall Strength



Structurally engineered materials makes our vacuum-bonded walls some of the strongest in the industry.

Vacuum-Bonded Laminated Construction



Flagstaff is one of the few light weight manufacturers that is a fully 6 sided vacuum-bonded trailer. Our walls, floors, roof, fronts and backs are all built vacuum-bonded to ensure a light weight strong structural trailer.

Roof Construction



- A** Vacuum-bonded roof with 2" radius
- B** Radius roof foam with built in insulated A/C ducts
- C** 4.5" thick roof foam

233S

Savannah with Hickory



The 233S has a third 60" x 80" fold down bunk.

Flagstaff

SHAMROCK

Shamrock continues to provide industry-first achievements as a hallmark to their dedication to serve you with the best products. The expansive, triple bunk unit provides plenty of room for any family to spread out. It's no wonder Shamrock is the top choice for expandable trailers.

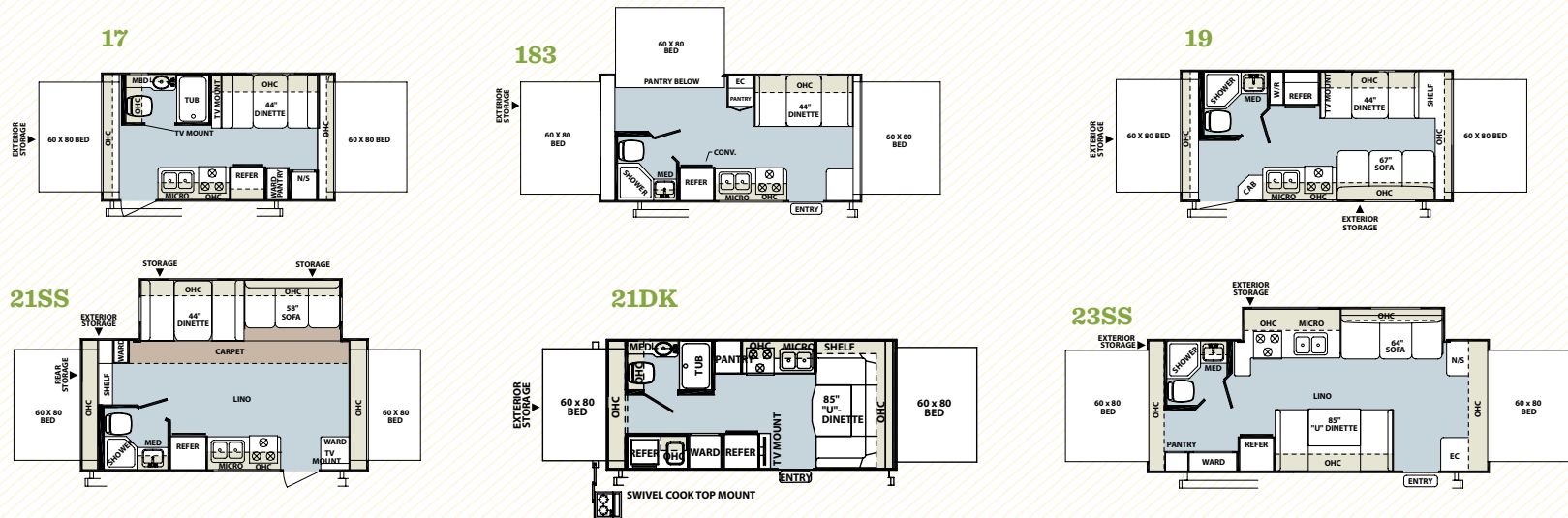

SPECIFICATIONS

Model number of any particular unit does not necessarily reflect the overall length of the unit itself. Dry weight are estimates

MODEL	17	183	19	21DK	2155	2355	2335
GVWR (Gross Vehicle Weight Rating)	3841	4774	4770	4867	5743	6347	5764
BASE/DRY UNIT WEIGHT	3063	3391	3383	3638	4311	4254	4351
BASE DRY HITCH WEIGHT	341	374	370	467	570	458	647
BASE DRY AXLE WEIGHT	2722	3017	3013	3171	3741	3796	3704
CARGO CAPACITY	740	1345	1349	1191	1233	1833	1833
LENGTH	18' 9"	20' 9"	20' 9"	21' 9"	21' 9"	24' 9"	23' 9"
TRAILER LENGTH (OPEN)	22' 11"	24' 9"	24' 9"	22' 4"	25' 6"	28' 9"	27' 9"
WIDTH	96"	96"	96"	96"	96"	96"	96"
HEIGHT W/O A/C	110"	111"	112"	120"	120"	115"	114"
INTERIOR HEIGHT	78"	78"	78"	78"	78"	78"	78"
FRESH WATER CAPACITY	36 gal	36 gal	36 gal	36 gal	36 gal	36 gal	36 gal
GRAY WATER CAPACITY	30 gal	30 gal	30 gal	30 gal	30 gal	30 gal	30 gal
BLACK WATER CAPACITY	30 gal	30 gal	30 gal	30 gal	30 gal	30 gal	30 gal

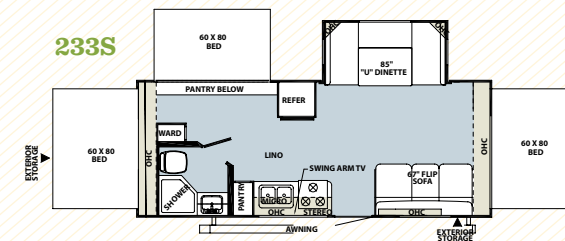

Flagstaff

SHAMROCK

There is more to the Shamrock series than first meets the eye. Flagstaff has designed specific models to meet individual needs. From the front deck models that allow you to bring your ATV's or golf carts along, to the rear slide models that provide expandability with solid walls for the feel of a traditional trailer, Flagstaff's Shamrock series has the model for you.



Rear Slide Models

21RS

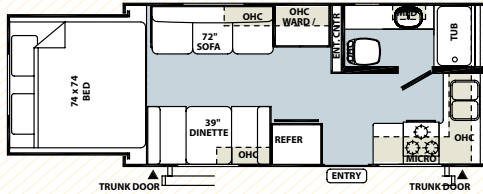

23RS

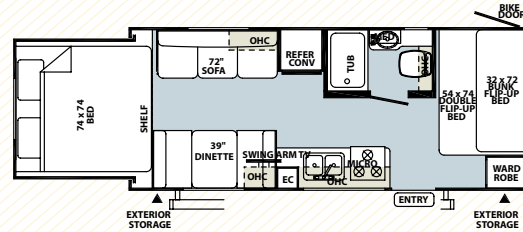

25RS

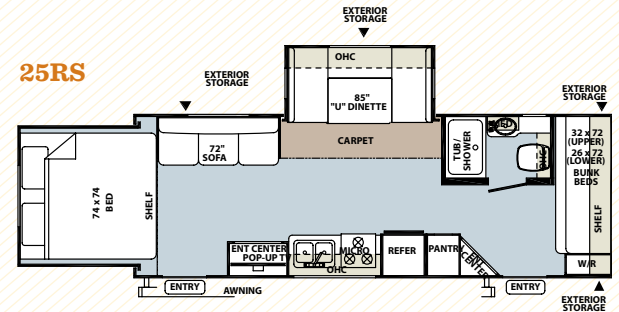

SPECIFICATIONS

Model number of any particular unit does not necessarily reflect the overall length of the unit itself. Dry weight are estimates

MODEL	FRONT DECK STORAGE		REAR SLIDE		
	19L	21SSL	21RS	23RS	25RS
GVWR (Gross Vehicle Weight Rating)	7321	7322	5450	6145	6502
BASE DRY UNIT WEIGHT	4432	4883	4048	4143	4841
BASE DRY HITCH WEIGHT	321	322	482	499	502
BASE DRY AXLE WEIGHT	4111	4561	3566	3644	4339
CARGO CAPACITY	2900	2401	1233	1833	1624
LENGTH	30' 1"	31' 1"	21' 9"	23' 10"	27' 5"
TRAILER LENGTH (OPEN)	33' 5"	35' 6"	25' 2"	28' 5"	32'
WIDTH	96"	96"	96"	96"	96"
HEIGHT W/O A/C	118"	120"	116"	116"	116"
INTERIOR HEIGHT	78"	78"	78"	78"	78"
FRESH WATER CAPACITY	36 gal	36 gal	36 gal	36 gal	36 gal
GRAY WATER CAPACITY	30 gal	30 gal	30 gal	30 gal	30 gal
BLACK WATER CAPACITY	30 gal	30 gal	30 gal	30 gal	30 gal



96" Front Storage Deck:
Shamrock 19L, 21SSL.

Front Deck Storage Models

19L

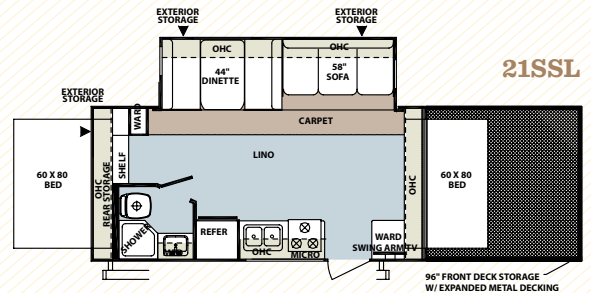
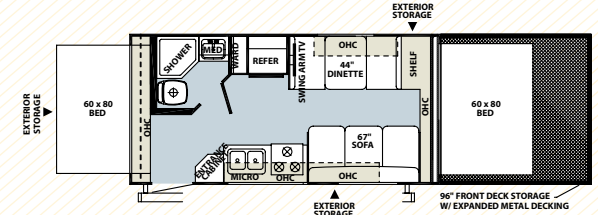

23RS

Seabury with Cherry

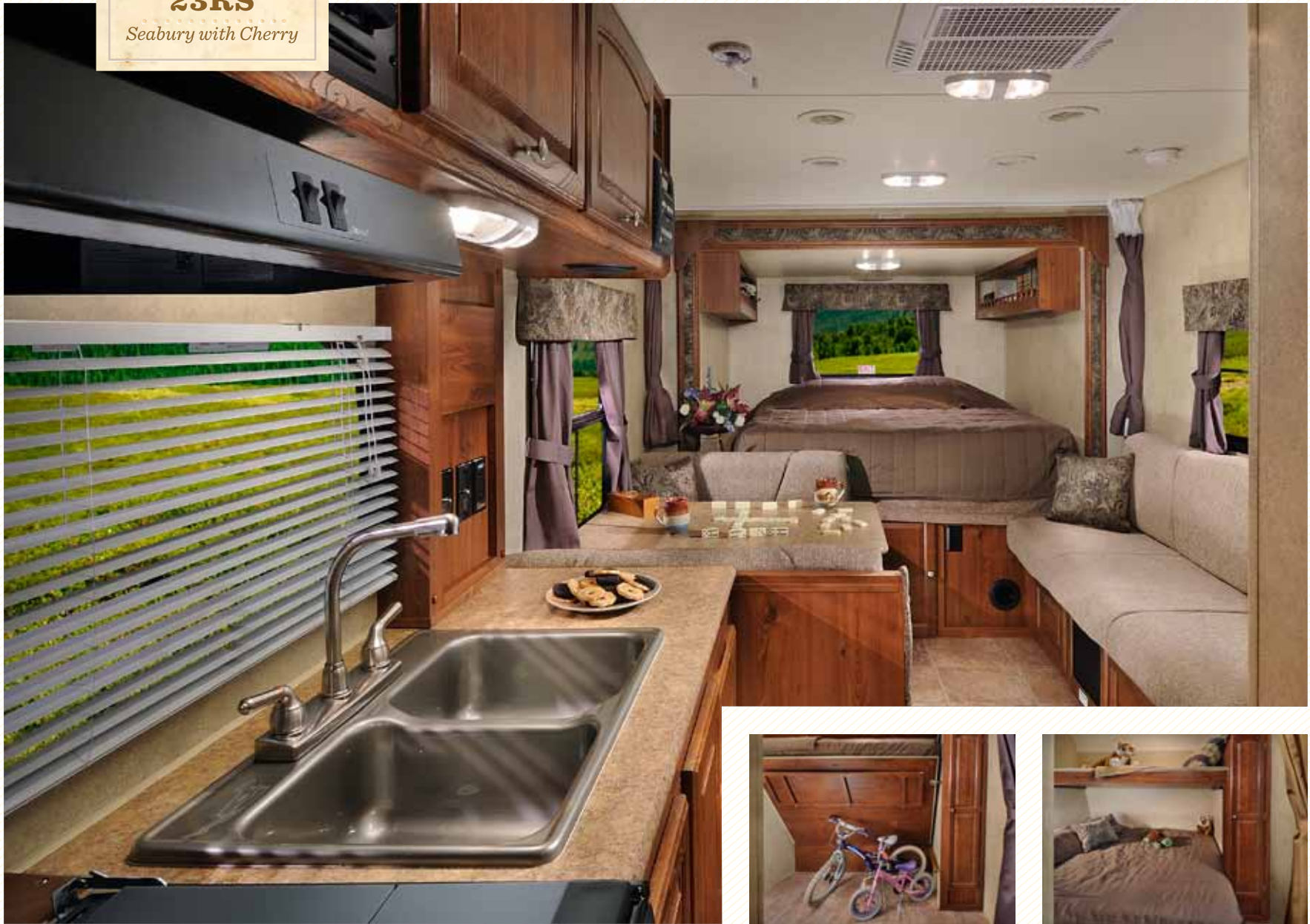

Front Bunks in
Storage Position.



Front Bunks in
Sleeping Position.

Flagstaff Super Lite, Micro Lite & Shamrock

STANDARDS & OPTIONS

Standards & Options are subject to change.

Models	SL	ML	S
INTERIOR FEATURES			
· Tuscan, Hickory or Cherry Interior	0	0	0
· Solid Wood and Raised Panel Doors and Drawers	S	S	S
· Screwed and Glued Wood Cabinetry	S	S	S
· Residential Full Extension Metal Drawer Guides in Kitchen	S	S	S
· Flooring: Carpet and an Engineered Mold and Mildew Resistant Floor Covering (S: 21SS, 21SSL, 233S Only SL: All Models)	S	--	S*
· Engineered Mold and Mildew Resistant Floor Covering	S	S	S*
· Minimum Carpet	0	--	--
· Ducted Furnace	--	S	S
· Floor Ducted Furnace	S	--	--
· 13,500 BTU Ducted Air (ML: 25DS, 25KS S: 21SS, 21SSL, 233S, 233S, 21RS, 23RS SL: All Models)	CPB	CPA*	CPC*
· 15,000 BTU Ducted Roof Air (ML: 25DS, 25KS Only)	0	0*	--
· 13,500 Roof A/C (ML: All Except 25DS, 25KS S: 17, 183, 19, 19L, 21DK)	--	0*/CPA*CPC*	--
· Carbon Monoxide Detector	SO	SO	SO
· 12 Volt Power Plug Hook-up	S	S	S
· CSA	0	0	0
· Monitor Panel Switch Station	S	S	S
· 55 Amp Converter With Charger	S	S	S
· Battery Disconnect Switch	S	S	S
· Directional Reading Lights on Sofa Slides	S	S	S
· Bunk Fan/Light Combination with Each Bed	--	--	S
· Mounted 22" LCD TV	CPB	0*/CPA	CPC
· Bedroom Mounted 22" LCD TV (SL: 26RLSS, 26FKWS, 26BHS, 27RLSS, 29RLSS, 29QBSS Only)	S*/0*	--	--

Models	SL	ML	S
· 26" LCD TV With 5.1 Digital Dolby Surround Sound Speaker System (N/A W/ SL: 23FBS)	0	--	--
· 32" LCD TV With 5.1 Digital Dolby Surround Sound Speaker System (SL: Std. 27RLSS Opt. 29RLSS, 29QBSS)	S*/0*	--	--
· Digital AM/FM/CD/DVD w/ Remote	CPB	S*/CPA	S
· MP3 Player Hook-Up	S	S	S
· Satellite Radio (SL: Included w/ 26" & 32" LCD TV Opt.)	0	--	--
· Decorative Valances	--	S	S
· Designer Valances w/ Lambrequin Arms	S	--	--
· Mini Blinds	S	--	--
· Day/Night Shades	0	--	--
· Swivel Chairs (Std. SL: 26RLSS Only)	S*	--	--
· Serta Recliners (Std. SL: 29RLSS Only)	S*	--	--
· End Table with Attached Lamp (Std. SL: 26RLSS, 29RLSS)	S*	--	--
· Air Hide-A-Bed Sofa w/ Storage (Std. w/ SL: 26RLSS, 26FKWS, 27RLSS, 29RLSS)(Opt. S: 21SS/21SSL)	S*	--	0*
· Jack Knife Sofa (29SKBS Only)	0*	--	--
· Aluminum Bed and Dinette Frames	S	S	S
· 44" Family Dinette (N/A w/ SL: 23FBS, 26BHS, 26RBSS, 27BESS, 27RLSS, 29SKBS, 29QBSS)	S*	S	S
· 48" X 84" Spacious King-U-Style Dinette (Std. w/ SL: 23FBS, 26BHS, 26RBSS, 27BESS, 27RLSS, 29SKBS, 29QBSS)	S*	--	--
· 44" Dinette ILO Sofa (ML: 19RB Only)	--	0*	--
· Kiddie Dinette With Upper Swing Bunk (ML: 19FD)	--	0*	--
· Free Standing High Pressure Laminated Table with Swing Level Legs (ML: Swing Level Legs N/A 19RB, 19RK, 19FD, 18FBRS, 21FBRS)	S	S*	S

Models	SL	ML	S
· Free Standing Table and Chairs (SL: 26RLSS, 26FKWS, 29RLSS Only)	S*	--	--
· Stainless Steel Appliances	0	0	0
· Raised Refrigerator Panels	0	0	0
· Auto Gas/Electric Refrigerator	S	S	S
· Three Burner High Output Gas Range	S	S	S
· Upgraded 22" Gas Oven (Required S: 23SS)	CPB	OP/CPA	0*
· Microwave	CPB	OP/CPA	CPC
· Double Bowl Sink w/ Residential Style Faucet (ML: N/A 19FD)	S	S	S
· Residential One-Piece Sink Cover	S	--	--
· Cutting Board	S	S	S
· Counter Top Extension (Available SL: 23FBS, 25BHSS, 26RLSS, 29RLSS S Only)	0	--	--
· Water-Pur Filtration System	SO	SO	SO
· Tub Surround	S	S	S
· Bathroom Skylight	S	S	S
· 110 DSI Gas/Electric Six Gallon "Quick Recovery" Water Heater	CPB	OP/CPA	CPC
· Water Heater By-Pass Kit	S	S	S
· Foot Flush Toilets	S	S	S
· Create-A-Breeze Three Speed Fantastic Vent	SO	SO	SO
· Extra Create-a-Breeze Fan (N/A w/ S: 17, 19, 19L)	0	0	0*
· Murphy Bed System for Unmatched Floor Plan Flexibility (Opt. ML: 21FB, 23LB Only)(Std. ML: 23FB, 25KS, 19RB, 19FD, SL: 23FBS, 25BHSS, 26BHS)	S*	0*/S*	--
· Twin Beds (26RLSS Only)	0*	--	--
· Heated Mattress	SO	SO	SO

SL = SUPER LITE
ML = MICRO LITE

S = SHAMROCK
S = STANDARD

SO = STANDARD OPTION
O = OPTIONAL

-- NOT AVAILABLE
OP = OPTIONAL PACKAGE

CP = CONVENIENCE PACKAGE
* = SELECTED MODELS



Models	SL	ML	S
EXTERIOR FEATURES			
· Fully Laminated Aluminum Frame (Floor, Sidewall, & Roof)	S	S	S
· Insulation Factors R-7 Side Wall, R-12 Floor and R-14 Ceiling	S	S	S
· Radius Roofs	S	S	S
· Vinyl / Rubber Composite Roofing Membrane	S	S	S
· TV Antenna w/ Cable & Satellite Hook-Up	CPB	OP/CPA	CPC
· Laminated Lamilux 1000 Fiberglass Sidewalls	S	S	S
· Electric Slide-Out (All Slide Out Models)	S	S	S
· Decorative Frame Skirting	S	--	S
· Industrial Lockable Bed Latches	--	--	S
· Easy Step Assist to Access Bed Latches	--	--	S
· Bed Cable System (No Poles)	--	--	S
· Rear Ladder (SL: Only)	0	--	--
· Power Awning With Adjustable Rain Dump	CPB	0	0
· Awning	--	OP/CPA	CPC
· Awning Slide Topper	0	0	0
· Entrance / Screen Door	S	S	S
· Grab Handle Next to Entrance Door	--	S	S
· Large Assist Grab Handles	CPB	--	--
· Radius Corner Windows and Doors	S	S	S
· Windows w/ Tinted Safety Glass	CPB	CPA	CPC
· Storm Windows available	0	0	0
· Large Dinette Picture Window	S	S	S
· Outside Grill Prep	S	S	S
· Outside Gas Grill and Worktable	CPB	CPA	0
· Outside Kitchen (SL: 29QBSS Only)	0*	--	--
· Outside Speakers (Std. ML: 19RB, 19RK, 19FD)	CPB	OPG/CPA	CPC
· Outside Shower	S	S	S
· 1/2 Sliding Storage Tray (N/A ML: 19RB, 19FD, 23FB, Models w/ Murphy Bed Opt, S: 17, 183, 19, 19L, 23SS SL:23FBS)	0	0	0
· Outside Antifreeze Stations in Storage Compartments	S	S	S
· Two-20 Lb Gas Bottles	S	S	S

Models	SL	ML	S
· Molded Bottle Cover	S	S	S
· Surface Coated Steel I-Beam Frame	S	S	S
· 96" Front Storage Deck (S: 19L, 21SSL Only)	--	--	S*
· Power Tongue Jack	0	0	0
· Stabilizer Jacks	S	S	S
· Power Stabilizer Jacks	0	--	--
· Torsion Axle, Rubber-Ryde Suspension	S	S	S
· Easy Lube Axles	S	S	S
· Automotive Radial Tires	S	S	S
· 14" Tires with Double Step	S	S	S
· Off Road Package (Includes: 15" Off Road Tires and Aluminum Wheels) (S: 19L, 21SSL Only)	--	--	0*
· Chrome-look Wheel Covers	0	0	0
· Aluminum Wheels	0	0	0
· Spare Tire Carrier & Cover	CPB	OP/CPA	0
· Electronically Controlled Heated Holding Tanks	0	0	0
· Enclosed Holding Tanks	S	--	--
· Black Water Flush	S	--	--
OPTION PKG. G (19RB, 19RK, 19FD ONLY) INCLUDES:			
Gas Oven	--	0*	--
Microwave	--	0*	--
110 DSI Gas/Electric Six Gallon "Quick Recovery" Water Heater	--	0*	--
TV Antenna w/ Cable & Satellite Hook-up	--	0*	--
Spare Tire Carrier & Cover	--	0*	--
Outside Speakers	--	0*	--
CONVENIENCE PKG. A (N/A 19RB, 19RK, 19FD) INCLUDES:			
13,500 BTU Roof A/C (All Except 25DS, 25KS)	--	0*	--
13,500 BTU Ducted Air (ML: 25DS, 25KS)	--	0*	--
Mounted 22" LCD TV w/ AM/FM Stereo, CD, DVD Player	--	0*	--
Gas Oven	--	0*	--
Microwave	--	0*	--

Models	SL	ML	S
110 DSI Gas/Electric Six Gallon "Quick Recovery" Water Heater	--	--	--
Awning	--	--	--
Windows w/ Tinted Safety Glass	--	--	--
Outside Grill and Worktable	--	--	--
Outside Speakers	--	--	--
Spare Tire Carrier & Cover	--	--	--
CONVENIENCE PKG. B INCLUDES:			
13,500 BTU Ducted Air	0	--	--
Mounted 22" LCD TV w/ AM/FM Stereo, CD, DVD Player	0	--	--
Gas Oven	0	--	--
Microwave	0	--	--
110 DSI Gas/Electric Six Gallon "Quick Recovery" Water Heater	0	--	--
Power Awning	0	--	--
Large Assist Grab Handle	0	--	--
Windows w/ Tinted Safety Glass	0	--	--
Outside Grill and Worktable	0	--	--
Outside Speakers	0	--	--
Spare Tire Carrier & Cover	0	--	--
CONVENIENCE PACKAGE C INCLUDES:			
13,500 BTU Roof A/C (17, 183, 19, 19L, 21DK)	--	--	0
13,500 BTU Ducted Air (21SS, 21SSL, 23SS, 23SS, 21RS, 23RS)	--	--	0
Mounted 22" LCD TV w/ TV Antenna & Cable Hook-up	--	--	0
Microwave	--	--	0
110 DSI Gas/Electric Six Gallon "Quick Recovery" Water Heater	--	--	0
Awning	--	--	0
Windows w/ Tinted Safety Glass	--	--	0
Outside Speakers	--	--	0



PRE-DELIVERY INSPECTION FACILITY

20,000 square feet of quality assurance. The bare essentials for a premium product. This state-of-the-art facility gives immediate daily feedback to production for quality assurance in every unit built.



Forest River, Inc. encourages our customers to purchase their Forest River products from a local dealership whenever possible for the following reasons:

It is the goal of Forest River, Inc. that all of our RV owners fully enjoy the RV experience and that customer satisfaction meets or exceeds their expectations!

- 1) Forest River, Inc. dealers are independently owned and operated businesses so priority service and scheduling is at their discretion and is often provided to customers that purchased their unit at that dealership.
- 2) Purchasing locally allows customers to establish meaningful relationships with a dealer, enhancing the RV experience through assistance with product questions, user tips or RV regulations for your state or country, and much more!
- 3) Canadian customers must meet requirements to bring an RV purchased out of the country to their home. These requirements may involve additional inspections and certifications, taxes and fees. Your local Canadian Dealer is a professional at meeting these requirements.
- 4) Scheduling timely warranty repairs and adjustments through a local dealership provides far greater flexibility and convenience to you, the customer!

YOUR FLAGSTAFF DEALER



Flagstaff WARRANTY

For details on Flagstaff's complete warranty program, see your Flagstaff dealer. When it comes to backing products with the same quality and commitment it does when it begins the manufacturing process, the only name you have to remember when you're looking for a recreational vehicle is Flagstaff. Flagstaff offers the following additional limited warranties to the original purchasers. Consult written warranty for details.

1. Twelve-year vinyl roof warranty, 2. Two-year fiberglass warranty, 3. Five-year axle warranty, 4. Five-year tent warranty, 5. One-year bumper to bumper warranty, 6. Available second-year warranty



Learn More
Scan this barcode using a QR Reader on your smart phone to learn more about Forest River.



A Berkshire Hathaway company.

201 West Elm Millersburg, IN 46543 www.forestriverinc.com/flagstaff 574.642.2640

All specifications contained herein are based on the latest product information at time of printing. Forest River reserves the right to make changes in colors, materials, equipment and specifications at any time without notice and assumes no responsibility for any errors in this brochure. Litho. U.S.A. FOR 0910