

# SALEM *Villa* SERIES DESTINATION TRAILERS

SALEM  
**VILLA**  
*Classic*

SALEM  
**VILLA**  
*Estate*

SALEM  
**Grand Villa**



DESIGNED FOR COMFORTABLE LIVING





402QBQ in Soapstone

Shown with optional TV



402QBQ  
Bedroom

372REDS in La-Z-Boy® Chocolate

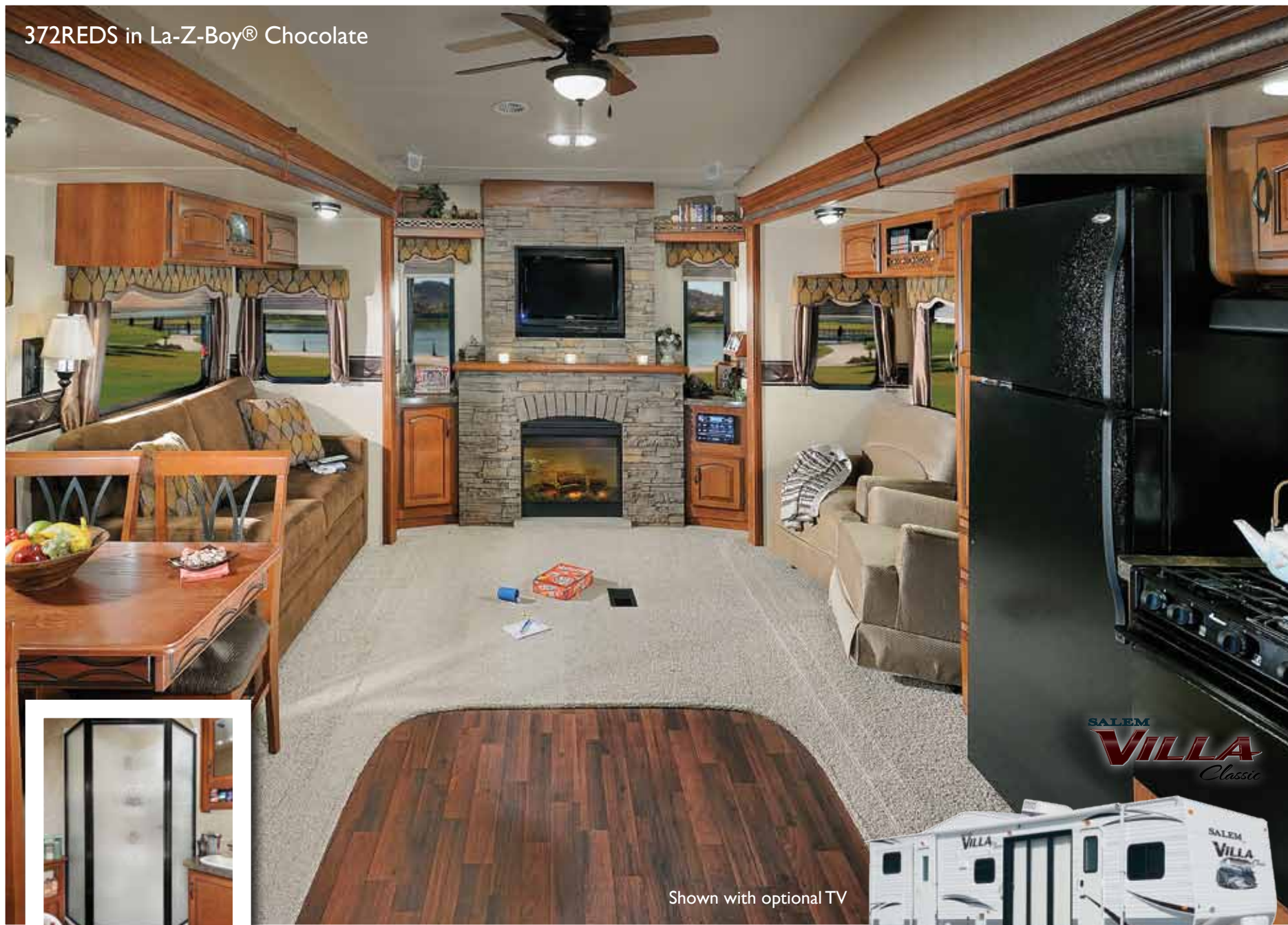

SALEM  
**VILLA**  
*Classic*

Shown with optional TV



402QBQ  
Bathroom

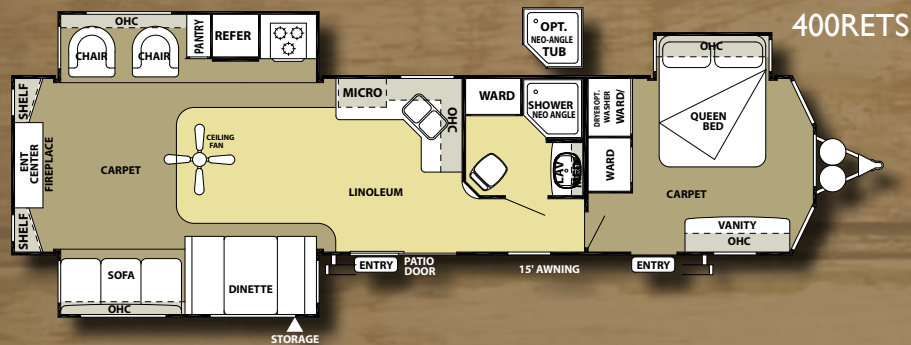
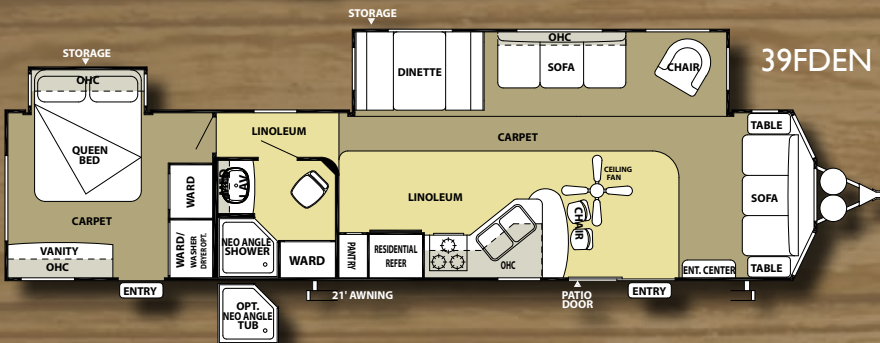
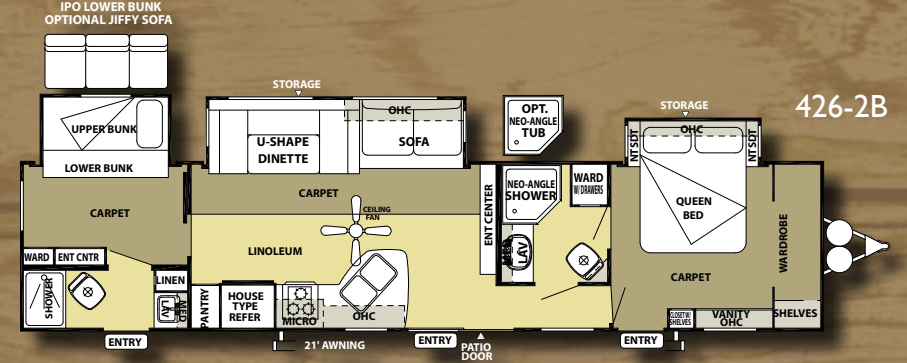
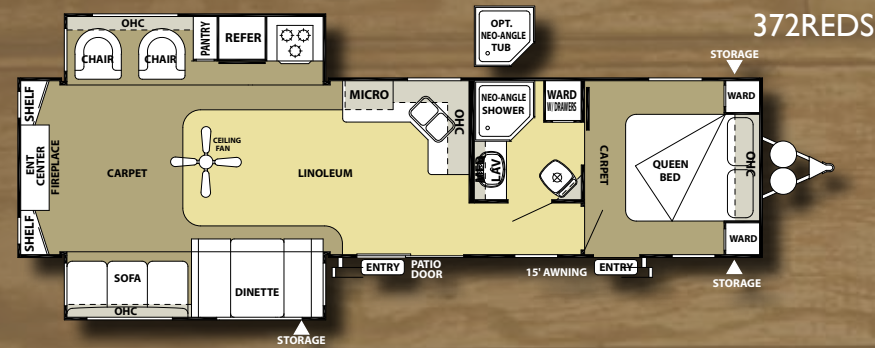
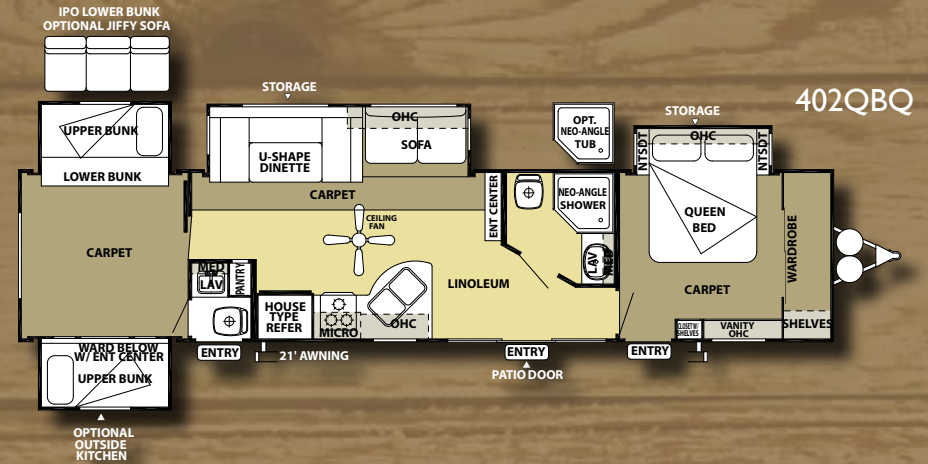
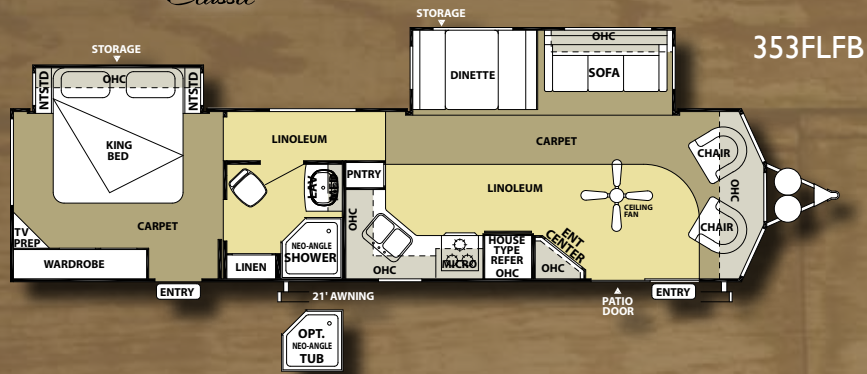

MODEL	353FLFB	372REDS	39FDEN	400RETS	402QBQ	426-2B
Hitch Weight (lb)	1290	1005	1490	TBD	1035	1365
Axle Weight	7330	8035	8235	TBD	9550	8810
Dry Ship Weight	8620	9040	9725	TBD	10585	10175
CCC (Cargo Capacity)	2770	2066	1866	TBD	2390	1290
Ext Length	38'6"	38'7"	40'10"	40'11"	40'8"	40'5"
Ext. Height	10'9"	10'1"	12'3"	10'9"	12'3"	12'3"
Int Height (inches)	84"	84"	84"	84"	84"	84"
Fresh Water Cap (gal)	42	42	50	42	42	50
Black Water Cap (gal)	43	43	38	43	54	77
Grey Water Cap (gal)	43	43	38	43	74	77
Tire Size (in)	15"	15"	15"	15"	16"	15"
Manual Awning Size (ft)	21'	15'	21'	15'	21'	21'

# VILLA CLASSIC STANDARDS AND OPTIONS

## COMFORT AND CONVENIENCE

- 84" interior height
- Black framed tinted safety glass windows
- Powered self supporting slide rooms
- Pleated night shades
- Triple sealed slide outs
- Water heater by-pass
- 6-gallon gas/electric DSI water heater
- Large pass thru storage (per floorplan)
- Ducted Dometic® 13,500 BTU central air conditioner w/ quick cool feature
- In-floor ducted heat with 35K BTU furnace
- Stain resistant carpet with padding
- Flush-floor slide rooms
- Systems monitor panel
- 6' 2" tall slide rooms
- Ultra lube axles
- Solid wood drawer fronts with ball bearing drawer glides
- 2 outside speakers
- Ceramic tile pattern Beauflor™ Durabac flooring w/ 7 yr. limited warranty.

## KITCHEN

- Extra large overhead cabinets
- Raised panel overhead cabinet doors
- 18.5 cu. ft. residential refrigerator with ice maker
- 12-volt power range hood with light
- Microwave with carousel
- Acrylic 60/40 residential style kitchen sink
- Built in knife holder behind stove
- 3 burner Piezo ignition range oven
- Pull out sprayer faucet at kitchen sink
- Kitchen waste basket
- Pantry with shelves

## LIVING ROOM

- Swivel rocker chair (per floorplan)
- Jensen™ DVD/CD/AM/FM stereo w/ mp3 hook-up
- Cathedral ceiling with ceiling fan
- Surround sound with TV hook-up
- Digital TV antenna w/ booster
- Cable and satellite ready
- Extra large picture window at dinette
- Extra large dinette for more comfortable dining and sleeping
- Decorative lights in slide-out
- Cell phone caddy

## BEDROOM

- Serta Bradley Mattress
- Fitted bedspreads and headboard
- Lift-up beds with gas struts
- Cable TV hook-up
- Stain resistant carpet with padding
- Solid privacy doors

## BATHROOM

- Built-in wood medicine cabinet and mirror
- Ceiling light with convenient wall switch
- China foot flush toilet(s)
- ABS tub or shower with one-piece surround

## EXTERIOR

- Smooth fiberglass radius baggage doors with thumb pulls and holdbacks
- Large A & E one piece vinyl awning
- Diamond plate rock guard
- Patio door with screen
- Steel framed 30" smooth fiberglass radius entry door
- 15" radial tires
- Entry assist handle
- 2-30 lb. LP tanks with

- automatic change over
- EZ access LP tank cover
- City water fill

## CONSTRUCTION

- 10" Extruded I-beam frame
- Cambered chassis
- Fresh water tank
- 2" x 3" floor joists 12" on center
- 5/8" 5-ply tongue and groove plywood floor decking
- 2" wall studs maximum 16" on center
- 5" bowed truss roof rafters
- 3/8" walk-on roof decking
- Seamless one-piece rubber roof w/ 12 year warranty
- R-7 insulation

## SECURITY AND SAFETY

- Smoke detector
- Fire extinguisher
- Carbon monoxide detector
- LP gas leak detector
- Amber porch light with interior switch
- Screen door with safety latch
- GFI receptacles and covered patio outlet
- Welded heavy duty safety chains
- Hitch light
- Lockable fiberglass radius baggage doors
- ANSI 119.5
- Certified to meet all National Highway Traffic Safety Administration Specifications

## POPULAR OPTIONS

- Gel coat fiberglass exterior
- 10-gallon gas/electric DSI water heater
- Skylight over tub

- Air hide-a-bed sofa
- Outside kitchen (402QBQ only)
- Free standing dinette with 4 chairs
- Outside shower

## Decors

Birch Interior



L A Z B O Y

Chocolate Interior

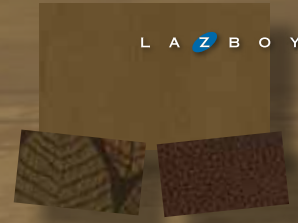

L A Z B O Y

Canyon Interior



Soapstone Interior



Rest assured your coach is built with pride and integrity by our team of qualified craftsmen.



Shown with optional TV

392FLFB Kitchen



SALEM  
**VILLA**  
*Estate*



SALEM

# Grand Villa

408FLFB in La-Z-Boy® Chocolate



“There’s no place like home.”

We, at Salem, understand the importance of bringing residential living to the outdoors. That’s why you’ll find a plethora of amenities aimed at providing the most comfortable experience possible. Aside from our spacious 102” wide body design with 96” interior heights, raised panel cabinetry and such luxuries like our deluxe window package. Grand Villa boasts a dishwasher, garbage disposal, residential refrigerator, free standing 4-burner range and exclusive Serta® mattress. With multiple floorplans to choose from let Salem’s Grand Villa be your “home away from home.”



408FLFB Bedroom



SALEM  
*Grand Villa*



SALEM

# Grand Villa

408REDS in La-Z-Boy® Chocolate



408REDS  
Bedroom

408REDS Kitchen



408REDS  
Bathroom

## VILLA ESTATE and GRAND VILLA FEATURES

A. Whole Unit Water Filtration System

B. Full Extension Ball Bearing Drawer Guides

C. Weather Proof Exterior Speakers

D. Cloth Night Shades

E. Satellite/Cable Hook-up

F. Comfort Flex™ Bed Frame

G. 5/8" Tongue in Groove Floor Decking

H. Self Edged Countertops

I. Single Lever Pull-Out Sprayer Faucet

J. Triple Radius Entry Steps

K. Residential 18 Cu.Ft. Refrigerator with Ice Maker

L. Free Standing Dinette

M. Beauflor™ Linoleum Flooring

N. Serta® Dreamscape Mattress

O. Porcelain Foot Flush Toilet

P. Fantastic™ Fan

Q. Patio Door with Amber Safety Light

R. Black Framed Tinted Windows with Safety Glass

S. Free Standing Range with 20" X 20" Oven Door

T. 20 Gallon Electric Water Heater

U. Frost Resistant Water Spigot

### GRAND VILLA UPGRADES

V. Standard Ceiling Fan(s)

W. Whirlpool® Dishwasher

X. Electric Fireplace

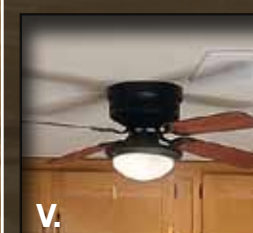
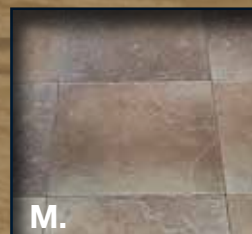
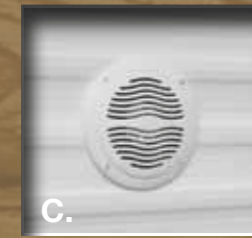

SALEM

# Villa SERIES

# CONSTRUCTION



Rest assured your coach is built with pride and integrity by our team of qualified craftsmen.

- A. Triple Entry Steps
- B. 102 in. Exterior Width for Increased Living Space (96" Villa Classic)
- C. Tinted Windows
- D. Hitch Light
- E. Standard Patio Door
- F. 15" Radial Tires (16" with Optional Fiberglass Exterior)

- G. 12" I-Beam Powder-Coated Frame with Cambered Chassis
- H. 5/8" Tongue & Groove Plywood Flooring
- I. Carpet w/ Padding
- J. Fender Skirt
- K. 2" Wall Studs 16" on Center
- L. 2" X 3" Floor Joists 12" on Center
- M. 15K BTU Ducted A/C (13.5K on Classic)

- N. Seamless Rubber Roof (12 yr. Warranty)
- O. 3/8" Roof Decking (Full Walk-On Roof)
- P. R-7 Fiberglass insulation Throughout
- Q. Dual Bottle cover w Easy Access
- R. 5" Truss Roof Rafters (16" On Center)
- S. Flood Light (Villa Estate, Grand Villa Only)
- T. .024 Aluminum Siding (Fiberglass Opt.)
- U. 84" Interior Height Villa Classic/Estate, 96" in Grand Villa

## VILLA ESTATE AND GRAND VILLA STANDARDS AND OPTIONS

### COMFORT AND CONVENIENCE

- 102" exterior width for increased living space
- 84" interior height
- Ceramic tile pattern Beauflor linoleum with 7 yr. limited warranty
- Frost proof garden hose spigot (off door side)
- Black framed tinted glass windows
- WaterPur™ whole house water filtration system
- Water heater by-pass
- Wired and braced for second A/C
- Pleated night shades
- 20-gallon electric water heater
- Ducted Dometic® 15,000 BTU central air conditioner w/ quick cool feature
- In-floor ducted heat w/ 40K BTU furnace
- Shaw stain resistant carpet w/ padding
- Flush-floor hydraulic slide rooms w/ manual override
- Systems monitor panel
- 50 amp electrical service and 65 amp 12 volt converter
- Solid hardwood drawer fronts

### KITCHEN

- Free standing dinette with 4 chairs
- Deluxe window package at dinette
- Extra large raised panel overhead cabinets
- Full extension ball bearing drawer guides
- 20" freestanding 4 burner gas range w/ oven (black)
- 18.5 cu. ft. residential electric refrigerator w/ icemaker (black)
- Microwave with carousel and range hood (black)
- Hidden storage beneath dinette seat cushions
- Undermount stonecast 60/40 residential style sink
- Pull out sprayer faucet
- Pantry with shelves
- Self edge countertops throughout

### LIVING ROOM

- Swivel rocker chair(s) (per floorplan)
- Surround sound TV hook-up
- Jensen™ DVD/CD/AM/FM stereo w/ mp3 hook-up
- 4 cube speakers and sub woofer
- Digital TV antenna w/ booster
- Cable and satellite door side hookup
- Glass sliding patio door w/ vertical blinds and screen door
- Coordinating wallpaper border
- Ceiling fan with wall switch
- Cell phone caddy

### BEDROOM

- Serta® mattress
- Bedspread and headboard
- Bedroom roof vent
- Ceiling fan with wall switch
- Comfort Flex (box spring) bed frame
- Under bed storage
- Cable TV hook-up
- Shaw Stain resistant carpet w/ padding
- Solid privacy doors

### BATHROOM

- Neo-Angle shower with glass door
- Built-in wood medicine cabinet and mirror
- Ceiling light w/ convenient wall switch
- Full extension ball bearing drawer guides
- China foot flush toilet(s)
- ABS shower w/ one-piece surround
- 12" 10-blade Fantastic Bath Fan™
- Toothbrush holder and towel ring

### EXTERIOR

- Smooth fiberglass radius baggage doors
- Large A & E one-piece vinyl awning
- 15" radial tires (per floorplan)
- 30 lb. double LP tanks w/ automatic change over
- EZ access LP tank cover
- City water fill w/ brass valve
- Swing out assist handle

### CONSTRUCTION

- 12" forged I-beam frame
- Cambered chassis
- Seamless holding tanks
- Color coded water lines
- 2" x 3" floor joists 12" on center
- 5/8" 5-ply tongue and groove plywood floor decking
- 2" wall studs maximum 16" on center
- 5" bowed truss roof rafters
- 3/8" walk-on roof decking
- Seamless one-piece rubber roof w/ 12 year warranty
- Triple sealed slide outs
- R-7 insulation throughout (floors, walls, ceilings, and slide-outs)

### SECURITY AND SAFETY

- Smoke detector
- Fire extinguisher
- Carbon monoxide detector
- LP gas leak detector
- Door latch w/ integral dead bolt lock
- Lighted main entry step w/ interior switch
- Amber porch light w/ interior switch
- Main entry doorside flood light
- GFI receptacles and covered patio outlet
- Welded heavy duty safety chains
- Hitch light
- Lockable fiberglass radius baggage doors
- ANSI 119.5
- Certified to meet all National Highway Traffic Safety Administration Specifications

### POPULAR OPTIONS

- Gelcoat fiberglass exterior
- Skylight over tub
- Garden tub with glass door (per floorplan)
- La-Z-Boy® living room furniture (a Forest River exclusive)
- Air hide-a-bed sofa
- Detachable hitch
- Outside shower
- 10-gallon gas/electric DSI water heater (IPO 20 gal electric)

SALEM

Grand Villa

## UPGRADES OVER VILLA ESTATE

- 96" (8') interior height
- Cathedral slide (main slide room)
- Dishwasher in kitchen
- Coffee maker
- Knife holder and spice rack behind oven
- Garbage disposal at kitchen sink
- Under mount bathroom sink
- Fluorescent lighting in kitchen
- 3 ceiling paddle fans w/ light kits (110v)
- 110v lighting in coach area ceiling
- Skylights in main slide above dinette w/ shades
- Window above main patio door
- Stone facade around fireplace
- Residential porch light
- Air hide-a-bed in main slide
- Lighting in kitchen soffit
- Wine rack above refrigerator
- Custom designed linen window valances
- Residential master bed comforter
- Decorative pillows
- Washer/Dryer prep (standard 408FLFB, optional 408REDS)

### OPTIONAL EQUIPMENT

- La-Z-Boy recliners
- La-Z-Boy sofa w/hide-a-bed (Must choose Birch or Chocolate decor)
- Detachable hitch
- Gel coat exterior upgrade

## Decors

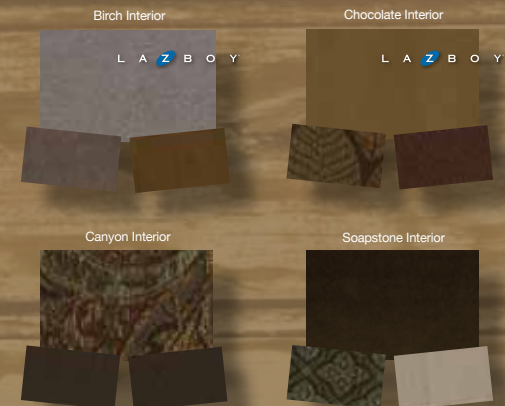

**SALEM**  
**VILLA**  
*Estate*

**SALEM**  
*Grand Villa*

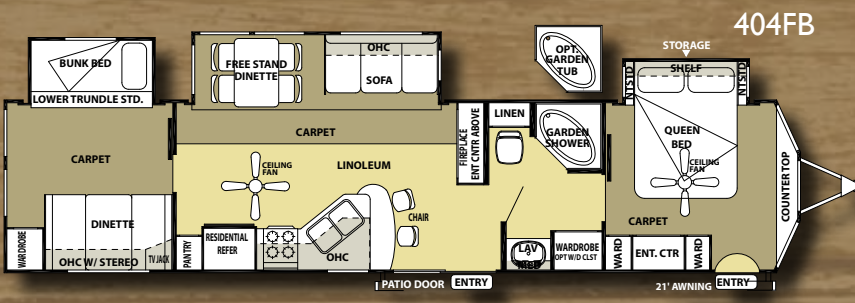
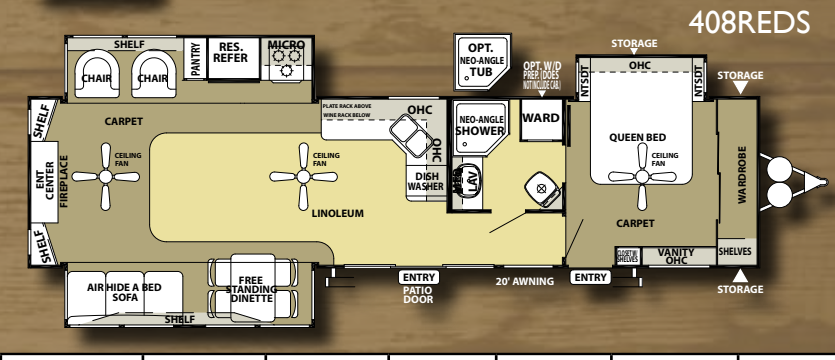
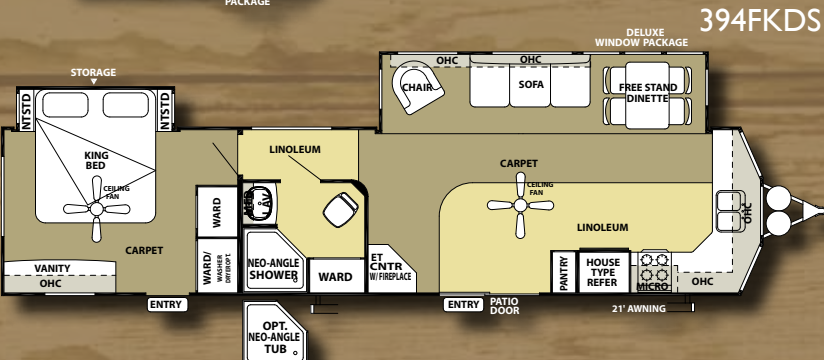
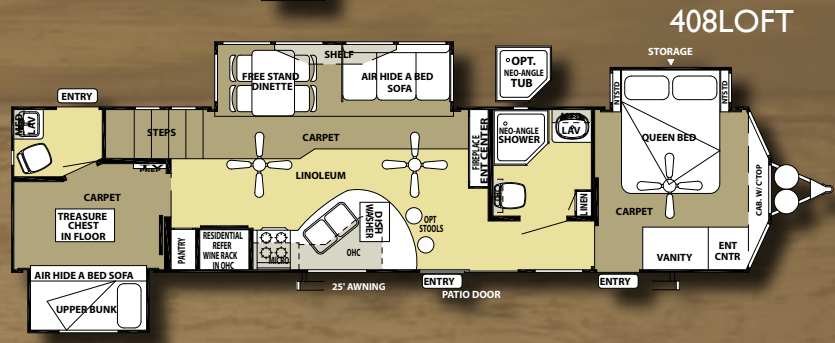
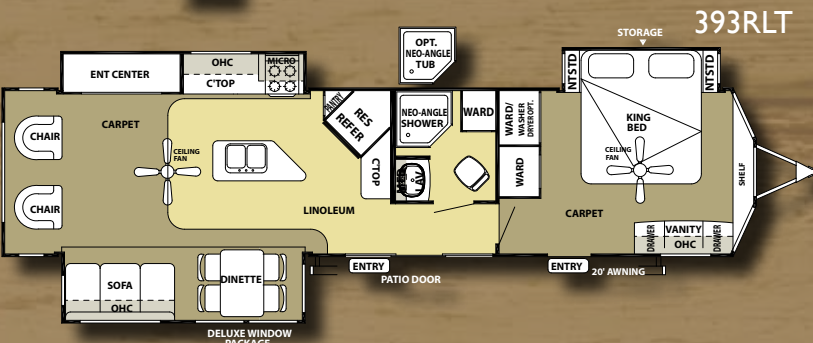
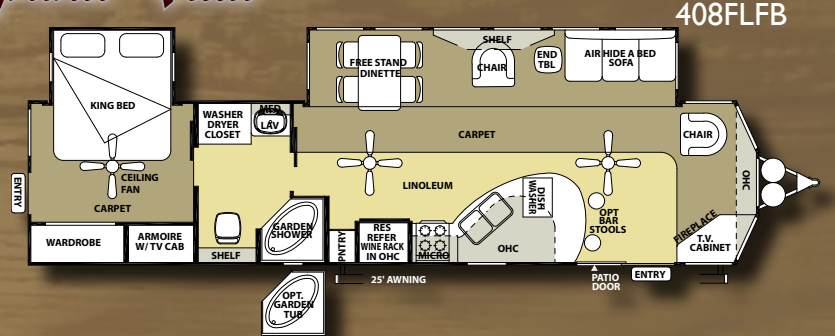
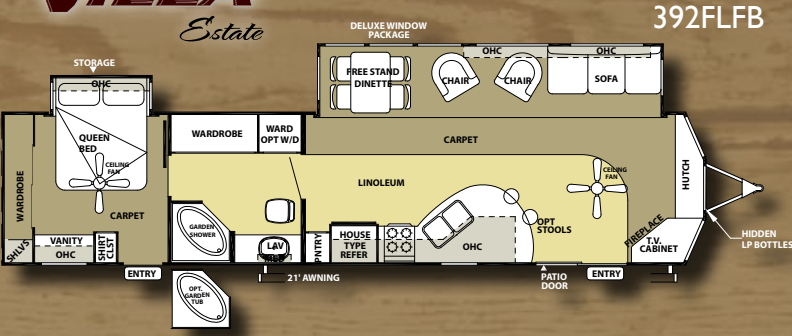

MODEL	392FLFB	393RLT	394FKDS	404FB	408FLFB	408LOFT	408REDS
Hitch Weight (lb)	1500	1615	1555	1385	1790	1515	1295
Axle Weight	8700	9045	8520	9315	9405	10685	9990
Dry Ship Weight	10200	10660	10075	10700	11195	12200	11285
CCC (Cargo Capacity)	1400	2896	1581	2626	2536	1255	1950
Ext Length	42'	40'5"	40'10"	41'11"	40'5"	41'6"	39'9"
Ext Height	10' 9"	10'9"	11'9"	10'9"	10'9"	10'9"	10'9"
Int Height (inches)	84"	84"	84"	84"	96"	96"	96"
Fresh Water Cap (gal)	42	92	42	92	42	42	42
Black Water Cap (gal)	27	40	43	40	27	27	43
Grey Water Cap (gal)	38	40	43	40	38	38	43
Tire Size (in)	15"	16"	15"	16"	16"	16"	16"
Manual Awning Size (ft)	21'	20'	21'	21'	25'	25'	20'

# JOIN THE SALEM FAMILY OF QUALITY BUILT AND AFFORDABLE RV'S



Forest River, Inc. encourages our customers to purchase their Forest River products from a local dealership whenever possible for the following reasons:

It is the goal of Forest River, Inc. that all of our RV owners fully enjoy the RV experience and that customer satisfaction meets or exceeds their expectations!

- 1) Forest River, Inc. dealers are independently owned and operated businesses so priority service and scheduling is at their discretion and is often provided to customers that purchased their unit at that dealership.
- 2) Purchasing locally allows customers to establish meaningful relationships with a dealer, enhancing the RV experience through assistance with product questions, user tips or RV regulations for your state or country, and much more!
- 3) Canadian customers must meet requirements to bring an RV purchased out of the country to their home. These requirements may involve additional inspections and certifications, taxes and fees. Your local Canadian Dealer is a professional at meeting these requirements.
- 4) Scheduling timely warranty repairs and adjustments through a local dealership provides far greater flexibility and convenience to you, the customer!



## PRE-DELIVERY INSPECTION FACILITY

20,000 square feet of quality assurance. The bare essentials for a premium product. This state-of-the-art facility gives immediate daily feedback to production for quality assurance in every unit built.

## PEACE OF MIND.

Forest River has yet another exclusive feature to offer: One year of free roadside assistance will be given to every new Salem customer. This is just one more way to say "Thank you" and to ensure an enjoyable traveling experience.



### Learn More

Scan this barcode using a QR Reader on your smart phone to learn more about Forest River.



A Berkshire Hathaway company.

Forest River, Inc.  
55470 C.R. 1  
Elkhart, IN 46514  
(574) 389-4600  
[www.forestriverinc.com/Salem](http://www.forestriverinc.com/Salem)  
[www.forestriveraccessories.com](http://www.forestriveraccessories.com)

