

2011

# Jay Flight Swift

TRAVEL TRAILERS BY JAYCO



JAY FLIGHT SWIFT SLX

JAY FLIGHT SWIFT



AMERICA'S MOST LIVEABLE RVs.

# Jay Flight Swift

The new Jay Flight Swift® offers all the essentials at a price that makes camping in style even more affordable, featuring:

- 2-year industry-leading Co-Pilot warranty
- Real-wood cherry-stained cabinetry throughout (select models)
- Aerodynamic front profile and skirting
- Fully decked roof with 3/8" plywood
- 15" radial tires with galvanized-steel wheel wells
- 13,500 or 15,000-BTU air conditioning (Customer Value Package, select models)
- 312-coil innerspring mattress with 1" padding (select models)

 **CERTIFIED GREEN**

All Jayco products are green certified by TRA Certification Inc., an independent, third-party certification agency. Jay Flight earned gold certification through the use of sustainable materials, environmentally-friendly production methods, energy-efficient components and reduction of waste.



Jay Flight Swift SLX



Jay Flight Swift



JAY FLIGHT SWIFT SLX 145RB



JAY FLIGHT SWIFT 264BH



|   | SWIFT | SWIFT SLX |
|---|-------|-----------|
| <b>STANDARD BATHROOM EQUIPMENT</b>                                    |       |           |
| Bar and towel ring  | •     | •         |
| Bath skylight   | •     | •         |
| Bathroom exhaust fan  | •     | •         |
| Bathroom mirror   | •     | •         |
| Large sink in bathroom  | •     | •         |
| Marine toilet with hand flush   | •     | •         |
| Medicine cabinet with mirror  | •     | •         |
| Shower curtain with curved shower track (select models)               | •     | •         |
| Toilet paper holder   | •     | •         |
| Vinyl flooring  | •     | •         |
| <b>STANDARD BEDROOM EQUIPMENT</b>                                     |       |           |
| 312-coil innerspring mattress with 1" padding                         | •     | •         |
| Privacy curtain (select models)                                       | •     | •         |
| Shirt wardrobe in bedroom   | •     | •         |
| Under-bed storage   | •     | •         |
| <b>STANDARD KITCHEN EQUIPMENT</b>                                     |       |           |
| 2-burner range  | •     | •         |
| 3-burner range with 9,000-BTU SuperBurner                             | •     | •         |
| 3 cu. ft. refrigerator  | •     | •         |
| 6 cu. ft. refrigerator  | •     | •         |
| Extra large picture window at dinette                                 | •     | •         |
| Indoor/outdoor dinette table  | •     | •         |
| Large pedestal dinette table  | •     | •         |
| Microwave oven  | •     | •         |
| Mixing high-rise faucet with brass connectors                         | •     | •         |
| Offset double-bowl kitchen sink                                       | •     | •         |
| Range hood with light and exhaust fan                                 | •     | •         |
| <b>STANDARD CONSTRUCTION FEATURES</b>                                 |       |           |
| .024" aluminum exterior skin  | •     | •         |
| 1/2" plywood dinette, bed and bunk platforms                          | •     | •         |
| 5/8" tongue-and-groove plywood main floor decking                     | •     | •         |
| 2" x 3" longitudinal floor joists on 16" x 18" centers                | •     | •         |
| 4" cambered steel-tube frame  | •     | •         |
| 81" living room ceiling height  | •     | •         |
| Fully decked roof with 3/8" plywood                                   | •     | •         |
| I-Class cambered structural steel I-beam frame                        | •     | •         |
| Integrated A-frame  | •     | •         |
| One-piece seamless rubber roof material                               | •     | •         |
| Poly Flex one-piece underbelly covering                               | •     | •         |
| R-7 fiberglass insulation in sidewall, roof and floor                 | •     | •         |
| Roof rafters, constructed of residential-style tapered trusses        | •     | •         |
| Screwed and glued cabinet stiles                                      | •     | •         |
| Seamless marine grade floor decking                                   | •     | •         |
| Wall studs on 16" centers   | •     | •         |
| <b>STANDARD EXTERIOR EQUIPMENT</b>                                    |       |           |
| 15" radial tires  | •     | •         |
| Aerodynamic front profile   | •     | •         |
| Amber patio light with inside switch                                  | •     | •         |
| Bumper with drain hose carrier and end caps                           | •     | •         |
| Carefree patio awning   | •     | •         |
| Diamond plate rock guard  | •     | •         |
| Durable fender skirts   | •     | •         |
| E-Z Lube axles  | •     | •         |
| Galvanized-steel wheel wells  | •     | •         |
| Lockable baggage doors with radius corners                            | •     | •         |
| Molded rain gutters   | •     | •         |
| White plastic grab handle   | •     | •         |
| <b>STANDARD INTERIOR EQUIPMENT</b>                                    |       |           |
| Ball bearing drawer guides 50-lb. capacity with full-drawer extension | •     | •         |
| Cable/satellite TV hookup   | •     | •         |
| Cherry-stained hardwood cabinetry                                     | •     | •         |

|   |   |
|---|---|
| Concord Cherry doors and drawers  | • |
| J-Steel convertible sofa  | • |
| Marine-grade table leg and pedestal base  | • |
| Multi-Media sound system with MP3/iPod input jacks                                    | • |
| Overhead cabinetry above sofa   | • |
| Pleated night shades  | • |
| Residential furniture, designed and made by Jayco                                     | • |
| Reversible dinette, sofa and bunk cushions  | • |
| Roof-mounted antenna for radio  | • |
| TV antenna with digital tuner   | • |
| <b>STANDARD HEAT, POWER &amp; WATER EQUIPMENT</b>                                     |   |
| 6-gal. gas water heater   | • |
| 12V demand water pump   | • |
| 12V electrical system with deluxe 120V, 45-amp power converter                        | • |
| 30-amp power cord   | • |
| 120V G.F.C.I. protected exterior receptacle   | • |
| ABS holding tanks   | • |
| Double 20-lb. propane gas bottles with regulator                                      | • |
| Hookup for city water   | • |
| In-floor ducted heat  | • |
| Metal alloy faucet fittings   | • |
| Single 20-lb. propane gas bottle with regulator                                       | • |
| Systems monitor panel   | • |
| Tuff-Pex water lines  | • |
| Wall-mounted air conditioner  | • |
| Water heater bypass system  | • |
| Water system winterization kit  | • |
| <b>STANDARD SAFETY EQUIPMENT</b>  |   |
| Breakaway switch  | • |
| Deadbolt lock on entrance door  | • |
| Dual hitch safety chains  | • |
| Egress window   | • |
| Fire extinguisher   | • |
| Propane/carbon monoxide alarm   | • |
| Safety-glass windows  | • |
| Smoke alarm   | • |
| <b>OPTIONS (N/A ON SLX)</b>   |   |
| Customer Value Package  | • |
| Customer Value Package with 15,000-BTU A/C  | • |
| Spare tire and tire carrier   | • |
| <b>CUSTOMER CONVENIENCE PACKAGE (N/A ON SLX)</b>                                      |   |
| 6-gal. gas/electric water heater  | • |
| 6.3 cu. ft. double-door refrigerator  | • |
| Outside shower  | • |
| Oven  | • |
| Stabilizer jacks (4)  | • |
| TV surround   | • |
| <b>CUSTOMER VALUE PACKAGE (N/A ON SLX)</b>  |   |
| 13,500 or 15,000-BTU A/C with wall thermostat with louvered-directional ceiling vents | • |
| Carefree patio awning   | • |
| Cable/satellite TV hookup   | • |
| Microwave oven with carousel  | • |
| Multi-Media Sound System AM/FM/CD stereo with MP3 input jack                          | • |
| Quilted bedspread   | • |
| TV antenna with digital tuner   | • |
| Water heater bypass system  | • |

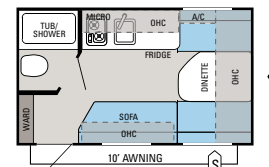

**JAY FLIGHT SWIFT SLX | 145RB**  
Ext. Lgth: 16' 6" Ext. Ht: 99" Unloaded Wt (lbs.): 2,305

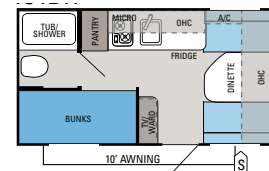

**JAY FLIGHT SWIFT SLX | 154BH**  
Ext. Lgth: TBD Ext. Ht: TBD Unloaded Wt (lbs.): TBD

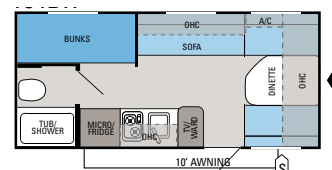

**JAY FLIGHT SWIFT SLX | 184BH**  
Ext. Lgth: 20' Ext. Ht: 101" Unloaded Wt (lbs.): 2,735

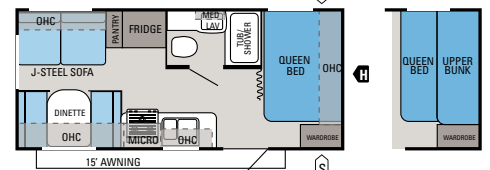

**JAY FLIGHT SWIFT | 198RD**  
Ext. Lgth: 23' 1" Ext. Ht: 127" Unloaded Wt (lbs.): 3,915

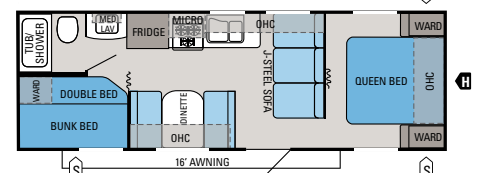

**JAY FLIGHT SWIFT | 264BH**  
Ext. Lgth: 29' 1" Ext. Ht: 127" Unloaded Wt (lbs.): 4,550

- S OUTSIDE STORAGE
- H TRAILER HITCH
- LAV BATHROOM SINK
- MICRO MICROWAVE
- OHC OVERHEAD CABINETS
- FRIDGE REFRIGERATOR
- WARD WARDROBE

Jay Flight Swift | SPECIFICATIONS

|           | FLOORPLAN | EXTERIOR LENGTH | EXTERIOR HEIGHT (WITH A/C) | INTERIOR HEIGHT | UNLOADED VEHICLE WEIGHT (LBS.) | DRY HITCH WEIGHT (LBS.) | GROSS VEHICLE WEIGHT RATING (LBS.) | CARGO CARRYING CAPACITY (LBS.) | FRESH WATER CAPACITY (GAL.) (WITH WATER HEATER) | GRAY WASTEWATER CAPACITY (GAL.) | TOILET/BLACK WASTEWATER CAPACITY (GAL.) |
|-----------|-----------|-----------------|----------------------------|-----------------|--------------------------------|-------------------------|------------------------------------|--------------------------------|---|---------------------------------|---|
| SWIFT SLX | 145RB     | 16' 6"          | 99"                        | 73"             | 2,305                          | 230                     | 2,950                              | 645                            | 16  | 15                              | 9                                       |
|           | 154BH     | TBD             | TBD                        | TBD             | TBD                            | TBD                     | TBD                                | TBD                            | TBD   | TBD                             | TBD                                     |
| SWIFT     | 184BH     | 20'             | 101"                       | 73"             | 2,735                          | 280                     | 3,500                              | 765                            | 26  | 15                              | 9                                       |
|           | 198RD     | 23' 1"          | 127"                       | 81"             | 3,915                          | 505                     | 5,900                              | 1,985                          | 48  | 32.5                            | 32.5                                    |
|           | 264BH     | 29' 1"          | 127"                       | 81"             | 4,550                          | 540                     | 6,500                              | 1,950                          | 48  | 32.5                            | 32.5                                    |



AMERICA'S MOST **LIVEABLE** RVs.



### INDUSTRY-LEADING WARRANTY

The Jayco Co-Pilot Warranty is a manufacturer's limited warranty. It comes from the people who build Jayco recreation vehicles to the people who buy them. Each Jayco is warranted to the original purchaser for twenty-four (24) months or twenty-four thousand (24,000) miles (mileage limitation applies to motorized products only), whichever occurs first, from the original date of purchase against defects in materials and workmanship. Jayco's limited warranty is not transferable. Go ahead and compare the Jayco warranty with other manufacturers' warranties. You'll find it's the best in the business!

For a copy of the limited warranty with full terms and conditions, ask your local Jayco dealer.



### OVER 300 LOCAL DEALERS

Establishing a solid relationship with your local Jayco dealer is a key component in the enjoyment of your new Jayco. By purchasing from a local dealer, you will have a convenient location for sales, parts and service support.

Jayco dealers are required to deliver all products at the site of the sale to provide a full product orientation and walkthrough at the time of delivery. It's a good way to become familiar with your Jayco and to meet the service, parts and warranty staff members who will be assisting you. If you live in Canada, there are regulations that must be met when buying a Jayco RV. Your local Canadian dealer is a professional at meeting these requirements and regulations. There simply is no substitute for a good relationship with your local Jayco dealer.



### 1-YEAR ROADSIDE ASSISTANCE

Travel worry-free with Jayco's Customer First Roadside Assistance program, yours at no cost during your first year of ownership. This program is offered through Coach-Net, the largest RV emergency road service in the country, and gives you immediate access to dependable roadside assistance and support services with a simple phone call.

- Free jump starts
- Free tire changes
- Free fuel delivery
- Free lockout service
- Free travelers checks
- Toll-free nationwide service appointment assistance
- 24-hour toll-free emergency message service
- Free custom trip routing and full-color map service
- Free dispatch of on-site mechanical service
- \$2,000 trip-interruption reimbursement
- RV technical assistance hotline
- Free towing to nearest qualified service

#### Your Jayco Dealer



Jayco proudly sponsors Tread Lightly!, a nonprofit organization whose mission is to empower generations to enjoy the outdoors responsibly through education and restoration.



From RV insurance to extended warranties, JayPlus has it covered. Ask your Jayco dealer about our exclusive JayPlus program today.



As a Jayco owner, you can be part of the Jayco Jafari International Travel Club. Ask your dealer about the Jafari "flight" in your area, write Jayco or visit our website.

**Unloaded Vehicle Weight (UVW):** Sometimes referred to as "Dry Weight," UVW means the typical weight of this trailer as built at the factory. The UVW, as used in product literature and other promotional materials, does not include cargo, fresh water, propane, options or dealer-installed accessories.

**Gross Vehicle Weight Rating (GVWR):** GVWR means the maximum permissible weight of the trailer, including the UVW plus passengers, personal items, all cargo, fluids, options, and dealer-installed accessories. The GVWR is equal to or greater than the sum of the UVW and the CCC.

**Cargo Carrying Capacity (CCC):** CCC means the maximum weight of all passengers, personal items, food, fresh water, propane, tools, other cargo and dealer-installed accessories that can be carried by the trailer. CCC is equal to or less than GVWR minus UVW. The addition of options will decrease the CCC.

**Hitch Weight (HW):** The hitch weight, as used in product literature and other promotional materials, does not include cargo, fresh water, propane gas, options or dealer-installed accessories. The addition of these types of items will either add to or subtract from the stated hitch weight.

It is important for your safety and enjoyment that your tow vehicle be adequately sized and equipped to tow and handle the GVWR of the RV you select. Review weights and rating of your tow vehicle and consult a competent advisor for questions or advice. Whether you are new to RVing or a veteran, get a feel for the performance of your tow vehicle before heading out on the roadways. When you tow an RV, you must drive differently than when you drive a single vehicle. Practice hooking up, driving, backing up and braking in a safe environment or seek out professional instruction. Jayco affixes a weight label to each RV which lists weight information for that vehicle. See specifications chart inside.

Jayco, Inc., P.O. Box 460, Middlebury, IN 46540, [www.jayco.com](http://www.jayco.com) 

See dealer for further information and prices. All information in this brochure is the latest available at the time of publication approval. Jayco reserves the right to make changes and to discontinue models without notice or obligation. Photos in this brochure may show optional equipment and props for photography purposes. RVs built for sale in Canada may differ to conform to Canadian codes. ©2011 Jayco, Inc. 11-JFSW-PL 0211-30K Printed in U.S.A.