

Pacific Ridge

By KOMFORT



BUILT IN THE WEST FOR THE WEST!



Pacific Ridge
By KOMFORT

STANDARD FEATURES

EXTERIOR

- Comprehensive 1-Year Warranty
- LAMILUX 1000 Gloss Gelcoat Fiberglass Exterior
- ALUMAKAGE Five-Sided Aluminum Structural Framing
- Aerodynamic Gel-Coat Front Cap w/Radius Corners & Recessed Hitch Lights
- Adjustable Axle Spring Hangers for easy height adjustment
- Load Range D tires for increased payload capacity (except P24RK)
- Deluxe Aluminum Alloy Wheels
- TrailAir EQUA-FLEX Rubber Cushioned Suspension
- Heavy Duty "SuperLube" Axles
- Spare Tire and Hidden Under-Chassis Carrier
- Rack & Pinion 12V Electric Slide System w/Manual Backup (n/a on P24RK, P25FL)
- Upgrade 55 amp Electronic Power Center w/3 stage Battery Charger (35 amp on P24RK)
- Power-Saver Battery Disconnect Switch 3 Outside Area Lights - Patio, Hitch, & Roadside
- Polyethylene one piece Roto-molded Fresh & Waste water tanks
- Black Tank Flush System
- 2" Quick-Dump Valve for Fresh Water Tank Drain
- High Visibility LED Running Lights and Flush mounted Tail Lights
- Heavy Duty Detachable Power Cord w/LED Monitor Lights
- Solar Panel Prewire for Easy Installation w/Waterproof Connector
- Fold-Away Exterior Grab Handle & Rear Ladder
- LPG System plumbed for Outdoor Barbeque
- Outside Shower w/Hot & Cold Taps and Hands-free holder
- Radius Triple "Easy Step"
- 15,000 BTU Air Conditioner
- A & E 9100 12V Power Awning
- 1 3/4" Bike Rack Ready Receiver Hitch
- Maxx-Air Roof Vent Covers on ALL vents

INTERIOR

- Beauflor slip resistant linoleum w/10 year Ltd. Warranty
- Raised Panel Hardwood Cabinet Doors
- Easy Glide Roller Bearing Drawer Guides
- 7-layer Baltic Birch Plywood Drawers (No particleboard or MDF)
- Recessed Halogen Ceiling Lamps
- Night Shades throughout
- E- Stone Kitchen Countertop w/under mount deep sink
- Extra large 8.3 ft. Refrigerator w/adjustable thermostat
- 22" Range w/Hi-output Burner & Rangetop cover
- Jensen DVD/AM/FM/DC/MP3 Stereo
- Upgrade 8" "Komfort Zone" Luxury Innerspring Mattress
- Hair Dryer with Night Light
- Fresh Air Bathroom Vent Fan
- LED Rechargeable Walk Away Flashlight
- Fantastic Vent Fan
- Extra-Large 2-pane Skylight in Living Area w/blackout shade
- All-in-One Electrical Command Center
- Gas/Elec DSI 6 gal. Water Heater w/quick recovery
- Komfort's exclusive Hanger Locks in Wardrobes
- **And Many, Many More Features...**

THERMAL MAX - The "ULTIMATE ALL-WEATHER PACKAGE"



- Fully Enclosed & Heated Underbelly **NEW**
- Hi-Output 30,000 BTU Furnace
- Upgrade Insulation - R9 Sidewall, R17 Roof, R26 Floor **NEW**
- Water Heater Bypass System for easy Winterization
- Panoramic Dark Tinted Windows
- R-15 AstroFoil Enhanced Slideroom Floor Insulation **NEW**



Travel Trailers

Fifth Wheels

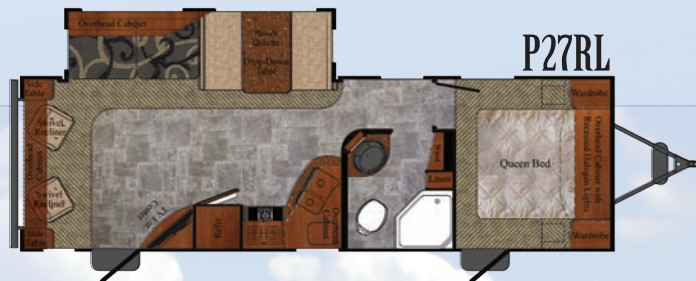

MORE FLOOR PLANS TO COME!

OPTIONS

- Slam Latch Baggage Doors*
- 32" Flat Panel LCD HDTV (w/art. Bracket)*
- Thermal Max All-Weather Package*
- Outside LPG BBQ
- Air Sofa Hide-a-Bed* (select models)
- Holding Tank 12-Volt Heat Pad
- Fresh Water Tank 12-Volt Heat Pad
- Electric Stabilizer Jacks
- Power Front Jack
- Dark-Tint Thermalpane Windows
- "Kamp-N-Komfort" Remote
- Bedroom TV

*Denotes mandatory option

PACIFIC RIDGE SPECIFICATIONS

Specifications	P24RK	P25FL	P27RL	P28RK	P27FRL	P28FRK	R33FRL
Total Shipping (Dry) Weight*	5,818	6,208	6,716	TBD	TBD	TBD	TBD
Dry Hitch Weight*	736	494	616	TBD	TBD	TBD	TBD
GVWR*	9,536	9,294	9,416	TBD	TBD	TBD	TBD
Fresh Water Capacity (+WH)(gal.)*	58	58	58	58	62	62	62
Grey Water Capacity (gal.)*	64	46	46	64**	46**	64**	64
Black Water Capacity (gal.)*	46	46	46	46	46	46	46
LP Capacity (gal. @ 80%)*	13	13	13	13	12	12	12
Cargo Carrying Capacity (Dry)*	3,718	3,086	2,700	TBD	TBD	TBD	TBD
Unit Length* (Hitch to Bumper)	27'	29'-8"	30'-11"	TBD	TBD	TBD	35'-3"
Height w/ A/C*	11'-3"	11'-3"	11'-3"	11'-3"	12'-9"	12'-9"	12'-9"
Furnace (BTU)	34K	34K	34K	34K	34K	34K	34K
Tires	205 75R15C	225 75R15D	225 75R15D	225 75R15D	235 80R16D	235 80R16D	235 80R16D
Awning Length	19'	20'	20'	20'*	TBD	TBD	16'

*All weights and measurements are approximate. Specifications are subject to change without notice.

** Estimated



Pacific Ridge

By KOMFORT



Komfort started in 1967 with a modest operation in Riverside, CA. It quickly gained a reputation for building quality travel trailers with distinct interiors and floor plans. When the company outgrew its facility in California, it opened an Oregon plant in the 1970's, not far from the current location in Clackamas, OR. Joining the THOR

"family" in 1995, Komfort began enjoying the benefits of being part of the nation's largest RV manufacturer. In 2001, THOR built Komfort a new, 120,000 sq. ft. modern facility, which now includes laminate bonding capabilities, expansive cabinet making, and full chassis prep departments. These changes allow Komfort to continue a great legacy of quality Travel Trailer and Fifth Wheels.

Built in the West for the West!

Komfort Encourages Buying from YOUR Local Dealer!



- Komfort Trailers & Fifth Wheels are standard-size trailers designed and built for durability and maximum living comfort.
- Product information, specifications, and photography in this brochure were as accurate as possible at the time of printing. Actual products may differ. Prices and specifications are subject to change without notice. All capacities are approximate and dimensions are nominal.
- Warning: This information is intended as a guide only. Weights of individual vehicles may vary. Consult your owner's manual for complete loading, weighing and towing instructions.
- This brochure is printed on recycled paper as part of Thor's corporate effort to minimize waste and conserve our natural resources. Providing safe, fuel-efficient recreational vehicles is Thor's way of further demonstrating our role as the industry leader in safeguarding our environment.



12628 SE Jennifer St
 PO Box 2515, Clackamas, OR 97015
 Phone: 503.722.5199 Fax: 503-722-5193
www.Komfort-rv.com