

HURRICANE

**HURRICANE** *Class A Gas* **SPECIFICATIONS**





# HURRICANE

LET YOUR ADVENTURE START HERE *Class A Gas*

See how you can enjoy the first-class comfort and elegant style of a Hurricane Class A Motorhome. A variety of basement and semi-basement models makes it easy to choose the floorplan that is right for you.



**CHERRY**  
(STANDARD)



**GLAZED MAPLE**  
(OPTIONAL)

MODEL	30Q	31G	31J	32A	32D	34T
Chassis	Ford V-10	Ford V-10	Ford V-10	Ford V-10	Ford V-10	Ford V-10
Gross Vehicle (GVWR)	16,000	18,000	18,000	18,000	18,000	22,000
Gross Combined (GCWR)	26,000	26,000	26,000	26,000	26,000	26,000
Wheel Base	190"	208"	208"	208"	208"	228"
Exterior Length (w/o ladder)	31' 11"	32' 8"	32' 8"	33'	33' 1"	35' 5"
Exterior Height (w/ AC)	11' 7"	11' 7"	11' 7"	11' 7"	11' 7"	11' 7"
Exterior Width (w/o mirrors)	99"	99"	99"	99"	99"	99"
Interior Height	80"	80"	80"	80"	80"	80"
Awning Size	16'	12'	16'	18'	16'	14'
Fuel (gal)	80	80	80	80	80	80
LPG (lbs)	63.5	88	88	88	63.5	88
Fresh/Waste/Grey Water (gal)	50/32/44	50/44/44	50/44/66	50/32/44	50/32/44	50/32/44
Water Heater (gal)	6	6	6	6	6	6
Furnace (BTUs)	35,000	35,000	35,000	35,000	35,000	35,000
Exterior Storage Capacity (cu. ft.)	128	63	125	62	134	56



**CHESTNUT**



**MILANO BROWN**



**SIZZLE GREY**



**STANDARD**



**PARTIAL PAINT**



**BRAZILWOOD**

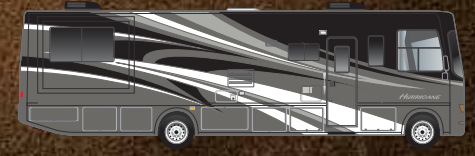

**CINDERWOOD**



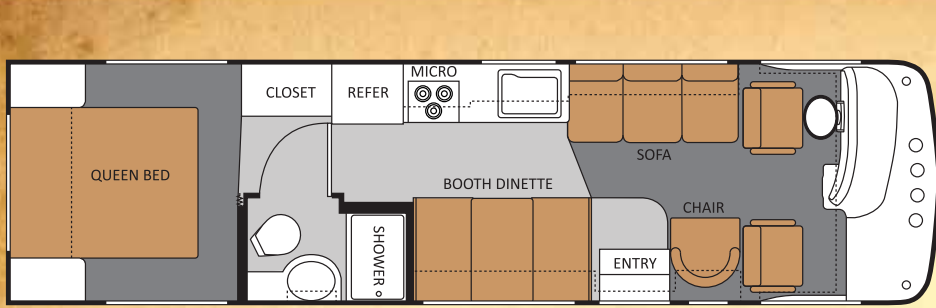

30Q

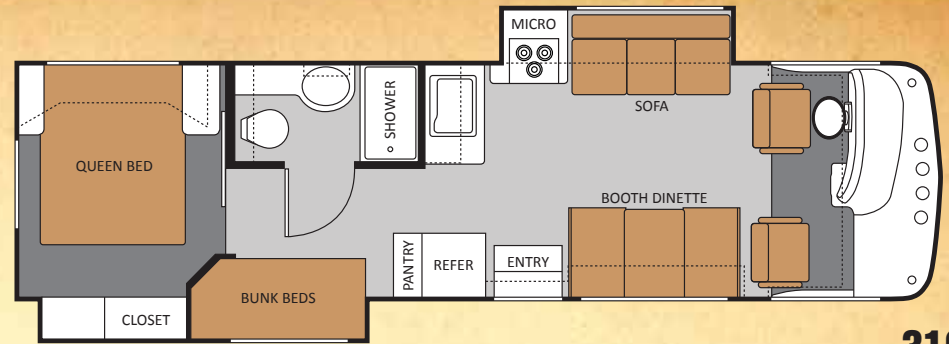

31G

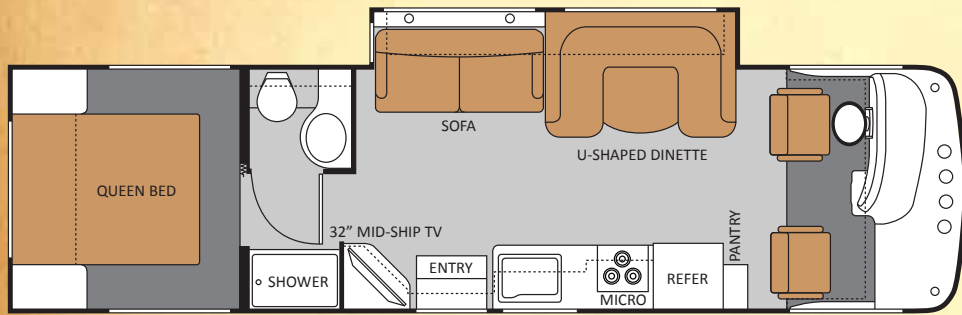

31J

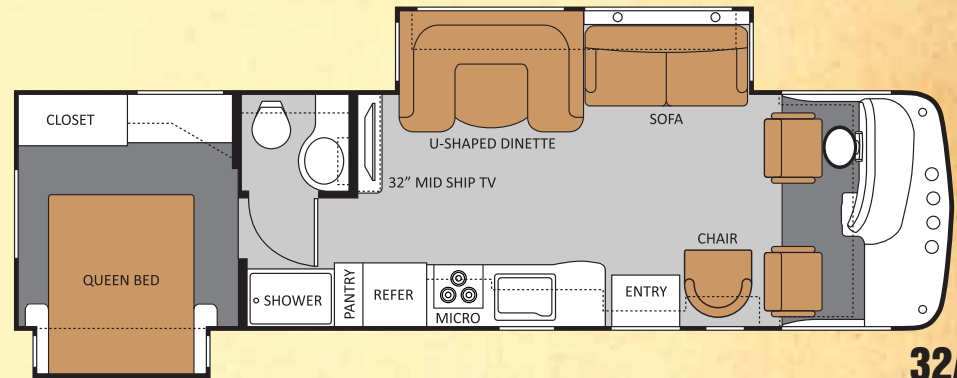

32A

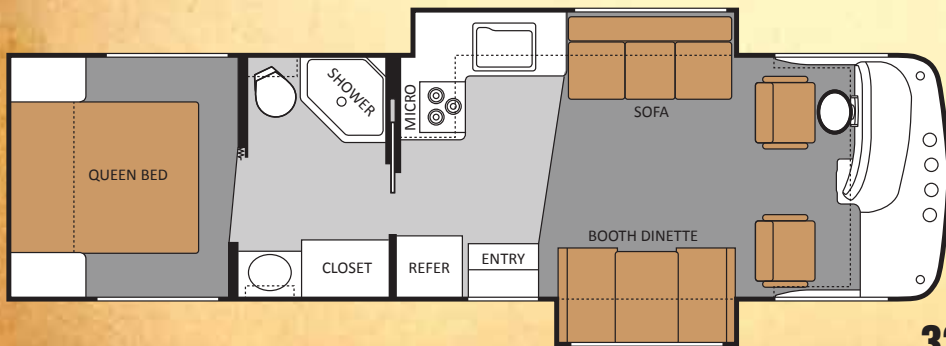

32D

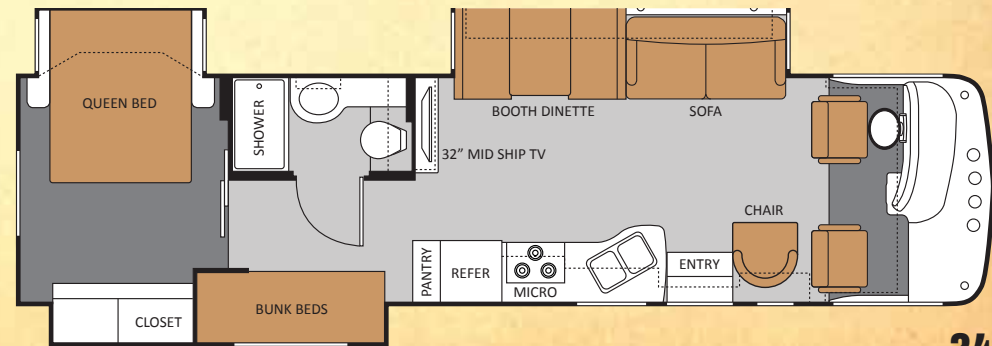

34T

**IMPORTANT - PLEASE READ:** Information published within this brochure reflects product design, fabrication, material, components and specifications at the date of printing. If your vehicle was manufactured before this brochure was published this information may not be accurate because vehicles assembled before the brochure was published may not have the same design, fabrication, materials, components and specification as represented in the brochure. If your vehicle was manufactured after this sales brochure was published the representations may not be accurate because, for product improvement reasons, we reserve the unilateral right, at any time, without prior notice, to make changes in product design, material, components and specifications. The date the brochure was published [i.e. "Julian date"] is set forth on the last page of the brochure. IF CERTAIN INFORMATION PUBLISHED WITHIN THIS BROCHURE IS SIGNIFICANT TO YOUR PURCHASING DECISION, PLEASE CONSULT WITH YOUR SELLING DEALERSHIP TO CONFIRM THAT THE INFORMATION IS ACCURATE WITH RESPECT TO THE VEHICLE YOU ARE CONSIDERING PURCHASING. Photographs in the brochure may depict optional equipment or may only be available in certain floor plans. We reserve the right to make changes in prices and models and to discontinue models without notice or obligation. Components, appliances and the chassis may have been manufactured in a calendar year before the vehicle's designated model year. All capacities are approximate. The actual length of the vehicle may differ from that indicated in the brochure due to variances in the manufacturing processes and/or installed components. All dry weights are based on standard model features and do not include optional features or equipment. Components, appliances and features may differ to conform to local codes. Due to EPA environmental restrictions, engine power and torque ratings may change during any model year. The Thor Motor Coach logo and its design are registered trademarks. Other products and company names are trademarks and/or registered trademarks of their respective manufacturer. While the color of the motorhome's exterior and the interior fabrics depicted in this brochure are fair and reasonable depictions, the colors depicted may not be exact match of the actual colors because of variances in photo processing and printing. Component part and appliance manufacturers issue limited warranties covering portions of the vehicle not covered under the limited warranty we issue. To learn specific details regarding warranty coverage please consult your selling dealership or review the warranty packet inside the vehicle.

# STANDARD FEATURES AND OPTIONS

## CONSTRUCTION & EXTERIOR

- Fully welded tubular steel welded floor system
- Vacu-bond laminated, tubular aluminum roof and sidewall cage construction
- One-piece fiberglass front and rear caps
- One-piece windshield
- Slick fiberglass exterior with vinyl graphics
- Exterior rear MEGA storage compartment (30Q,31J,32D)
- Seamless roto-cast storage compartments
- Side hinged flush mount radius luggage doors (in select areas)
- Premium one-piece TPO roof
- Roof ladder
- Automatic electric entry step

## CONSTRUCTION & EXTERIOR OPTIONS

- Dual Pane windows
- Partial paint with vinyl graphics packages
- Full-body paint packages with Gel-coat sidewalls
- Electric patio awning
- Fully automatic hydraulic leveling jacks (Std. 32A & 34T)
- Outside shower

## AUTOMOTIVE & COCKPIT

- "RV Style" AM/FM Dash radio with CD player, WB tuner and auxillary input
- Dash fans
- Generator start switch on dash
- Ceiling mounted dome light with dash switch
- Three-point seatbelts for driver and passenger
- Leatherette driver and passenger captain's chairs
- Deluxe exterior mirrors
- Fog lights
- 19.5" tires with stainless Steel wheel liners
- 5,000 lb. trailer hitch

## AUTOMOTIVE & COCKPIT OPTIONS

- Six-way power driver seat
- Back-up camera with audio
- Side Vision Camera System (Requires: Back-up camera)
- Heated, remote exterior mirrors

## INTERIOR

- 80" interior ceiling height
- Residential linoleum (galley, bath and entry)
- Metal entry grab handle
- 13,500 BTU roof air conditioner in front
- Ceiling ducted air conditioning system
- Cherry or Glazed Maple cabinetry
- Raised panel doors on wall cabinets
- Hardware with Oil Rubbed Bronze finish
- Fabric barrel chair (30Q only)
- Leatherette Euro-recliner with ottoman (32A & 34T)
- Fabric jackknife sofa (30Q & 31G)
- Fabric hide-a-bed sofa (32A,32D,34T)
- Leatherette hide-a-bed sofa with air mattress (31J only)
- Leatherette U-shaped dinette (31J & 32A)
- Booth dinette with cup holders (30Q,31G,32D,34T)
- Night Shades

## INTERIOR OPTIONS

- 13,500 BTU roof air conditioner in back (Requires 5500 watt generator)

- Leatherette jackknife sofa (30Q only)
- Fabric hide-a-bed sofa (31J only)
- Leatherette hide-a-bed sofa with air mattress (31G,32A,32D,34T)
- Electric overhead, hide-away bunk (31J only)

## GALLEY

- Double door refrigerator
- 3-burner high-output gas cooktop with oven
- Microwave oven
- Laminate countertops
- Large double bowl sink w/ single lever kitchen faucet
- Flip-up countertop extension (N/A 30Q,31J,32A)
- Pull-out countertop extension (32Aonly)
- Pantry (N/A 30Q,32D)
- Full extension metal drawer guides

## GALLEY OPTIONS

- Fantastic fan
- 3-burner high-output gas cooktop with convection microwave oven

## ENTERTAINMENT

- 26" LCD television in front overhead (30Q,31G,32D)
- 32" LCD television in living room entertainment center (31J,32A,34T)
- Cable TV & Satellite prep

## ENTERTAINMENT OPTIONS

- 19" LCD television in bedroom
- Home theater system with DVD player and radio tuner
- (2) 13" LCD televisions w/ DVD Player in bunk beds (31G & 34T)

## BEDROOM & BATHROOM

- Queen-size bed
- Bedsread and pillow shams
- Attractive headboard, beadsread, pillow shams and sconce wall lighting
- Bunk beds in hallway (31G & 34T)
- Lighted Wardrobe in bedroom
- China bowl toilet
- Shower with glass shower door

## SAFETY & CONVENIENCE

- Systems Control Center
- Smoke, LPG, carbon monoxide detectors
- Fire extinguisher
- Slide-out battery tray

## SAFETY & CONVENIENCE OPTIONS

- Valve stem extenders

## ELECTRICAL & PLUMBING

- Onan Microquiet 4,000 watt gas generator
- Battery disconnect switch
- Emergency start switch
- 30-amp service with detachable power cord
- 6-gallon gas water heater

## ELECTRICAL & PLUMBING OPTIONS

- Onan RV Marquis Gold 5,500 watt gas generator with 50-amp service and 6-gallon gas/electric water heater
- Second auxiliary battery
- Holding tanks with heat pads

YOUR LOCAL TMC DEALER:



RVIA

Go RVing.

P.O. BOX 1486 • ELKHART, IN 46515 • CUSTOMER SERVICE: 800-860-3812 • SALES DEPARTMENT: 800-860-5658 • [HURRICANE-RV.COM](http://HURRICANE-RV.COM)

