

SUNNYBROOK & MOBILE SCOUT

The Bristol Bay Series by SunnyBrook

2 0 1 1



SunnyBrook



Mobile Scout

THEY'LL KNOW YOU'VE ARRIVED



A

■ ■ ■ *Experience the Difference.*

From the time you pull in until you leave, neighboring campers are going to want to “touch and feel” your unit – inside and out. From the velvet smooth true gelcoat exterior to the plush luxury of the interior, your unit will be the benchmark by which other units are judged.

- A. Our model 3510RE is featured in this shot with Autumn Maple cabinetry and Mocha Dusk interior décor. Shown with preferred options such as Beauflor® wood grained flooring, 32 inch Jensen® LCD TV and a beautiful remote controlled electric fireplace.
- B. The extremely open “L” shaped center kitchen of the 3510RE shows off the enormous amount of storage space while providing a functional working environment.
- C. When you want wide open spaces and every home convenience you need to choose the 3455CK, here shown in Tranquility décor and our elegant Autumn Maple cabinetry.
- D. The lady of the house will be very excited to show her new model 3208FK. Storage galore and large surface countertops are features rarely seen in a front kitchen travel trailer. The beauty of maple makes this kitchen glow.
- E. The large slide-out and perfectly positioned entertainment center, complete with options such as a remote controlled electric fireplace, makes this 3208FK shown in Mocha Dusk décor, a cozy setting for the most discriminating RV'er.



D



B



C



E



A

■ ■ ■ *Experience the Comfort.*

A. The rear bedroom in our 3208FK features a full sized residential queen bed with pillow-top-mattress. Filled with large storage areas, deep mirrored sliding door wardrobes, this beauty is enhanced with an optional 19 inch LCD TV for your viewing pleasure.

B. The front bedroom of our 3510RE features an optional California king width bed and pillow top mattress as well as huge mirrored wardrobes, storage cabinets and an optional LCD TV.



B

C. The home-style bathroom, featured in our 3510RE, is complete with a spacious shower, porcelain toilet, vanity light bar and has an optional washer/dryer cabinet.

D. When you enter the bathroom area of your new 3208FK you realize the space saving innovations of SunnyBrook RV. This bathroom is complete with shower, porcelain toilet, storage cabinets and a built-in optional washer/dryer closet.

E. This inside view of the optional washer/dryer closet shows off the stackable washer and dryer that is available.



C



D



E

FEATURES



- The extra large movable "Grab Handle" is standard on all models and provides a safer assist while entering or exiting your coach.
- True Gelcoat sidewalls are standard on all Bristol Bay models.
- Triple-step entry way comes standard on all models.



- Outdoor high illumination scare lights are standard on all models.



- Main exit doors now have a sliding "clear pane" covering the door handle/lock area providing complete outside visibility — no longer do you have that solid color covering. A "Poodle Panel" is at the bottom of the door to keep your pets from scratching that nice screen door.



- True Gelcoat molded end caps are standard on all Bristol Bay Series fifth wheel models.



- Tires on all Bristol Bay Series models are filled with nitrogen. It provides improved fuel economy; tire life, braking and handling, and safety.



- Beauflor® - a new flooring dimension is resistant to mold & mildew, cold cracking, slipping and stains. The surface is highly resistant to tears, rips and gouges.



- Other brands come with cheap plastic toilets. Not a Bristol Bay Series. We offer standard porcelain foot flush toilets.



- The Bristol Bay Series features a triple 40 lb. LP tank option in the slider compartment that normally houses the standard dual 30 lb. tanks. Available on fifth wheels only.



- Individually adjustable jack stands are standard on both travel trailers and fifth wheels, providing ease of leveling and stability.



- Externally accessible propane gas port is standard and allows outdoor hookups for BBQ and Tailgating parties.



- R-7 insulated floor with 5/8" tongue and groove exterior grade plywood on aluminum floor joists is standard. Competitors typically use OSB or particle board.



- All water lines are color coded and use solid brass fittings at every joint. This reduces the chance of waterline mixup during inspection and/or repair.



- MOR/ryde® rubber suspensions offer smoother and easier towing.



- Real, lumber core cabinet stiles (vs. cheap MDF style stiles) are screwed together to provide the best cabinetry. We also use real poplar hardwood cabinet cleating vs. cheap pine that the competition uses.

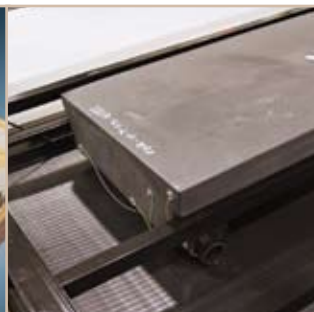

- Heated and enclosed holding tanks along with ducted floor heat, and solid steel I-beam frame are first class!



- Beefy, eight-lug hubs and Super Lube axles are standard. A Bristol Bay Series unit is built better and easier to maintain than others.



- Your Bristol Bay Series is built better. A full walk-on rubber roof is proof. Check out our aluminum superstructure!

TRAVEL TRAILER FLOORPLANS

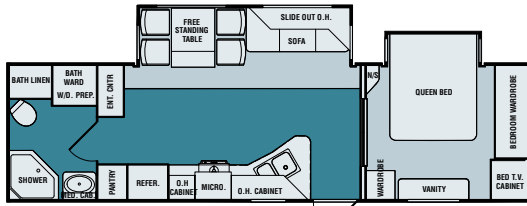

3010 RB

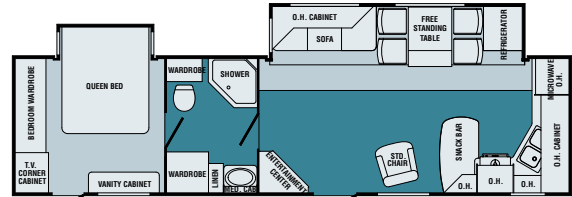

3208 FK

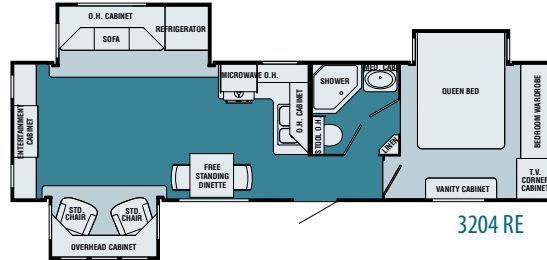

3204 RE

FIFTH WHEEL FLOORPLANS

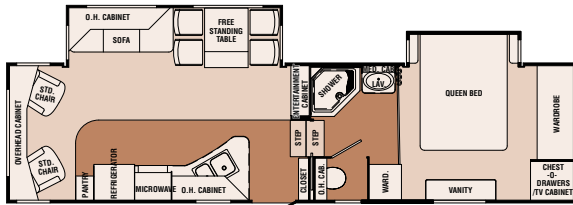

3150 RL

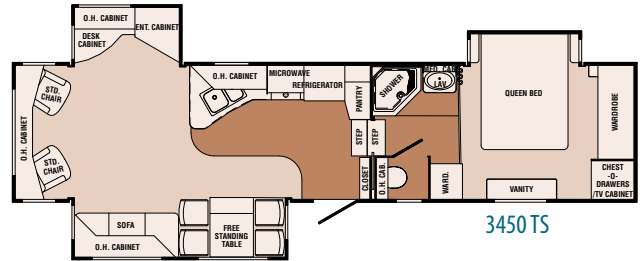

3450 TS

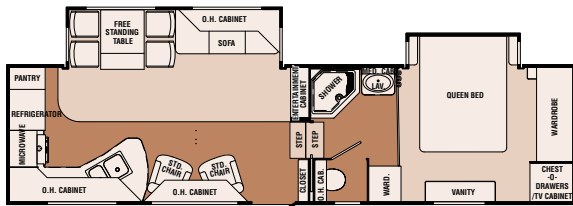

3155 RK

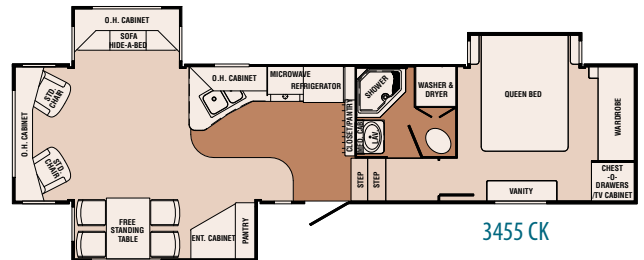

3455 CK

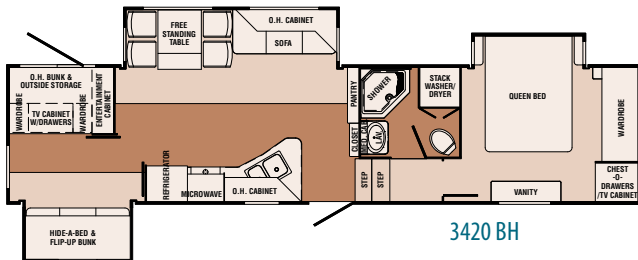

3420 BH

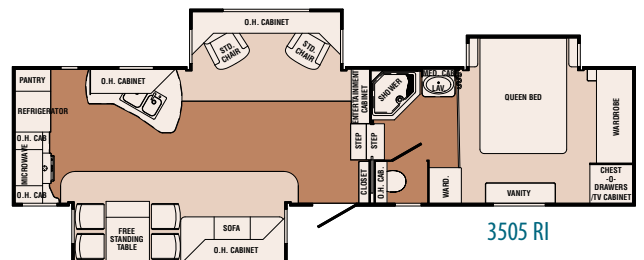

3505 RI

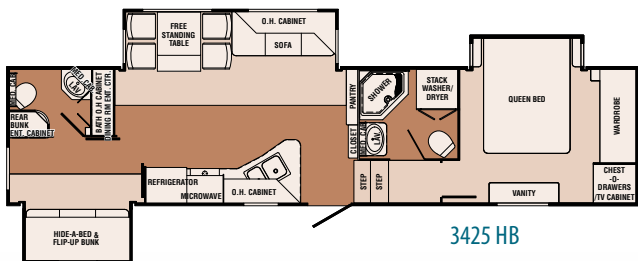

3425 HB

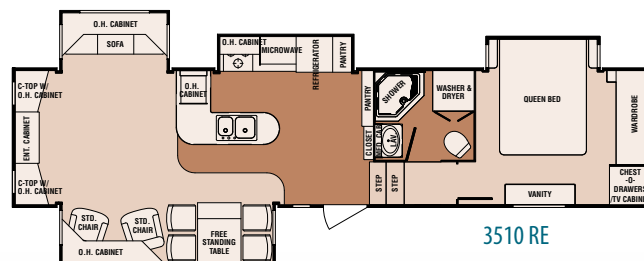

3510 RE

S P E C I F I C A T I O N S + S T A N D A R D S / O P T I O N S

Measurements	3010 RB	3204 RE	3208 FK	3150 RL	3155 RK	3420 BH	3425 HB	3450 TS	3455 CK	3505 RI	3510 RE
	Exterior Length*	34'-1"	35'-2"	36'-0"	32'-8"	32'-8"	36'-5"	36'-5"	35'-10"	35'-10"	35'-10"
Exterior Height**	11'-3"	11'-3"	11'-3"	12'-4"	12'-4"	12'-4"	12'-4"	12'-4"	12'-4"	12'-4"	12'-4"
Exterior Width	8'-3"	8'-3"	8'-3"	8'-3"	8'-3"	8'-3"	8'-3"	8'-3"	8'-3"	8'-3"	8'-3"
Interior Height	6'-8"	6'-8"	6'-8"	7'-0"	7'-0"	7'-0"	7'-0"	7'-0"	7'-0"	7'-0"	7'-0"
Hitch Height	22"	22"	22"	48"	48"	48"	48"	48"	48"	48"	48"

Capacities

Dry Hitch Weight/Lbs.***	1119	1081	1246	2211	2280	2440	2221	2500	2357	2421	2255
Dry Gross Weight/Lbs.***	7952	8597	8363	9497	9911	11,103	10,923	10,888	10,597	10,777	11,425
GVWR/Lbs.	11,700	11,700	11,700	15,000	15,000	15,000	15,000	15,000	15,000	15,000	15,000
Fresh Water Cap./Gal.	56	56	56	56	56	56	56	56	56	56	56
Black Water Cap./Gal.	33	33	33	33	33	33	66	33	33	33	33
Gray Water Cap./Gal.	66	33	69	69	69	69	102	69	69	69	69
Sleeping Capacity	4 std./6 opt.	4 std./6 opt.	4 std./6 opt.	4 std./6 opt.	4 std./6 opt.	9 std./11 opt.	7 std./9 opt.	4 std./6 opt.	4 std./6 opt.	4 std./6 opt.	4 std./6 opt.

Features

Dual 6000 Lb.	Str. Axles	Str. Axles	Str. Axles	Str. Axles	Str. Axles	Str. Axles	Str. Axles	Str. Axles	Str. Axles	Str. Axles	Str. Axles
Tire Size	ST235/80R/16E	ST235/80R/16E	ST235/80R/16E	ST235/80R/16E	ST235/80R/16E	ST235/80R/16E	ST235/80R/16E	ST235/80R/16E	ST235/80R/16E	ST235/80R/16E	ST235/80R/16E
Optional Awning Size	20'	18'	18'	20'	17'	18'	18'	16'	18'	16'	17'
Furnace Size	35M BTU	35M BTU	35M BTU	35M BTU	35M BTU	35M BTU	35M BTU	35M BTU	40M BTU	40M BTU	40M BTU
Dometic Gas/Elec. Refrig.	Double Door	Double Door	Double Door	Double Door	Double Door	Double Door	Double Door	Double Door	Double Door	Double Door	Double Door

*From center of coupler or king pin to rear bumper **Includes AC on roof ***Not including options

Bay Package (Required)

Dometic® 15.0 BTU Air Conditioner	Composite Surface Countertops (Kitchen and Bath)	(2) Security Lights	Extended Pin Box (N/A on TTs)
A&E 8500 Series Awning	Dometic® Microwave Oven	Fold Away Grab Handle	Hidden Safe
Deep Tint Windows	32" LCD TV in Living Room	Dexter EZ Lube Axles	50 Amp Electrical Service
Safety Glass	3 Burner Cooktop with 22" Oven	TV Antenna with Booster	
Pillow Top Mattress	Water Heater By-Pass	(2) Kitchen Sink Covers	

Discovery Package (Required)

Porcelain Toilet	Pre-Wire for 2nd AC in Bedroom	AM/FM/DVD with Surround Sound	Roof Ladder
Stabilizer Jacks	Quick Snap Jacks (N/A on TTs)	MOR/ryde® Suspension	Satellite Prep
Wide Stance Power Front Jacks (N/A on TTs)	Raised Oak Refer Panels	Range Cover	Black Water Tank Flush

Optional Equipment

End Table (N/A on TTs)	Heat Strip for A/C in Kitchen	Washer and Dryer Prep (N/A 3204 RE, 3150 RL, 3155 RK, 3450 TS, 3505 RI)	Thermopane Windows Upgrade
Dinette Booth ILO Table and 4 Chairs	Heat Strip for A/C in Bedroom	Stackable Washer and Dryer (N/A 3204 RE, 3150 RL, 3155 RK, 3450 TS, 3505 RI)	LP Generator Prep (N/A TTs)
Beauflor® Wood Look Floor ILO Ceramic Tile Look	Extreme Weather Package	72 x 80 California King Width Bed Upgrade (N/A TTs)	(3) 40 Lb. LP Tank Option Upgrade (N/A on TTs)
2 Recliners ILO 2 Euro Chairs and Ottomans	Convection Microwave Upgrade	Outside Shower	5500 Onan LP Generator Installed (N/A TTs)
1 Recliner ILO 1 Euro Chair and Ottoman (3208FK Only)	Central Vacuum (N/A on TTs)	Create-A-Breeze™ Vent (Kitchen/Bedroom)	Slide Room Awning
Flair Hide-A-Bed with Inflatable Mattress	Fireplace (N/A 3150 RL, 3155 RK, 3505 RI)	Fantastic Fan with Rain Sensor and Wall Switch (Kitchen)	12 Volt Power Awning
10 Gal. DSI Gas/Electric Water Heater Upgrade	Original Corian® by DuPont® Kitchen and Bath Countertops	MOR/ryde® Extended Pinbox Upgrade	CSA/State Seal
13.5 Ducted A/C in Bedroom	Mobile Scout Graphics	12 Volt Power Hitch Jack (TTs Only)	
15.0 Ducted A/C in Bedroom	Jensen 19" LCD TV Bedroom	16" Spare Tire and Carrier (TTs Only with Cover)	
Ceiling Fan (N/A on TTs)	Day/Night Shade Upgrade	Aluminum Wheels Upgrade	

For more, see your Bristol Bay Series dealer for details. Standards, options and specifications are subject to change.

All Aluminum Superstructure

SunnyBrook RV pioneered the all aluminum superstructure over 18 years ago, because we care about quality. You'll find more and thicker aluminum posts, cross members and roof bows than our competitors. Our lite-aluminum superstructure is screwed and glued together NOT welded. Welds can break under stress. Our bonded and screwed framing is lighter and stronger. Competitive brands use thinner posts, fewer bows, much less aluminum and sidewalls are glued to Lauan. There is a difference. Look into this before you make your buying decision. SunnyBrook RV has always kept the highest standards.



SUNNYBROOK & MOBILE SCOUT

The Bristol Bay Series by SunnyBrook

SunnyBrook RV

201 14th Street | Middlebury, IN 46540 | (574) 825-5250

www.sunnybrookrv.com

your SunnyBrook RV Dealer:



Tow Vehicle Disclaimer. CAUTION: Owners of SunnyBrook RV, Inc. recreational vehicles are solely responsible for the selection and proper use of tow vehicles. All customers should consult with a motor vehicle manufacturer or their dealer concerning the purchase and use of suitable tow vehicles for SunnyBrook RV, Inc. products. SunnyBrook RV, Inc. disclaims any liability or damages suffered as a result of the selection, operation, use or misuse of a tow vehicle. SUNNYBROOK RV INC.'S LIMITED WARRANTY DOES NOT COVER DAMAGE TO THE RECREATIONAL VEHICLE OR THE TOW VEHICLE AS A RESULT OF THE SELECTION, OPERATION, USE OR MISUSE OF THE TOW VEHICLE.

All illustrations and specifications contained in this literature are based on the latest product information available at the time of printing. SunnyBrook RV, Inc. reserves the right to make changes to colors, materials, specifications and pricing without notice or obligation. Photography may show optional equipment available at an additional cost. Items used as props in photography are not part of the packages. All liquid capacities and weights are approximate and dimensions are nominal. SunnyBrook reserves the right to make changes and improvements without incorporating these changes into similar models produced at an earlier date. Consult your local, authorized Bristol Bay Series or SunnyBrook dealer for the latest information and changes. SunnyBrook RV, inc. continues to be a member in good standing of the RVIA.