

2011

Camping Trailers

JAY SERIES | JAY SERIES SELECT HW | BAJA



JAY SERIES

JAY SERIES
SELECT HW

BAJA



AMERICA'S MOST LIVEABLE RVs.



TRUE VALUE OF OWNERSHIP

With Jayco, you get more amenities, more liveable, home-like features and superior construction for better durability and greater resale value. **Simply put, you won't find another RV packed with more TRUE VALUE — from the time of purchase to the time you sell.**

- + 2-year warranty
- + more standard features
- + more brand-name components
- + less maintenance
- + better resale value

True Value of Jayco Ownership

Learn more about Jayco's True Value by finding the blue arrows  throughout this brochure.



AMERICA'S MOST LIVEABLE RVS.



CERTIFIED GREEN

All Jayco products are green certified by TRA Certification Inc., an independent, third-party certification agency. Our camping trailers earned gold certification through the use of sustainable materials, environmentally-friendly production methods, energy-efficient components and reduction of waste.



WARRANTY

WE BACK OUR PRODUCTS FOR 2 YEARS. ASK OUR COMPETITION WHY THEY DON'T.

You want your RV to last a long time. And nobody backs their RVs better than we do. Our exclusive two-year Co-Pilot Warranty is the best in the business and provides assurance that you'll enjoy your purchase for many years. We also back our camping trailers with lifetime warranty coverage on our lifter system, roof, floor and frame and a five-year warranty coverage on our tent.



Have fun out there.

Packed with high-quality amenities and low-maintenance features—including an advanced lifter system that makes setting up fast and easy—our camping trailers are easier to maneuver, easier to store and easier to tow than larger units. And compared to a tent, they're way more comfortable and weather-resistant, making them the perfect place to spend time with your friends and family, without spending a fortune to do so.



↑ CONVENIENT

Innovative storage options, low-maintenance vinyl flooring, a full kitchen with hot and cold-running water, an outside shower (n/a on 806) and optional heated bed mats are just a few special touches.

↑ EASY TOWING

Keep your camping trailer in towing shape with our E-Z Lube axles and TorFlex independent torsion axle suspension (n/a on Baja).

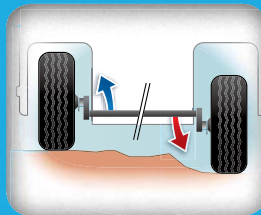

↑ PATENTED LIFTER SYSTEM

Fully enclosed to protect against rust and road debris, our patented lifter system uses strong, flexible push-rods to guide the roof up as you crank, while tubular lift posts with nylon bushings have no edges to chafe our DuraTek tent.

Camping Trailers

JAY SERIES® | JAY SERIES SELECT HW® | BAJA®

2011

CAMPING TRAILERS

Jay Series



BUILT FOR FAMILY

Perfect for family getaways and friendly get-togethers alike, the Jay Series is our most popular and affordable camping trailer, with a range of family-friendly floorplans, sleeping for up to eight people and plenty of room for all your stuff.



JAY SERIES 1207 | CHOCOLATE



CONVENIENT

The Jay Series tastefully designed dining area boasts a carry-out dinette table, stainless steel carry-out stove and hinged plywood dinette seat bases with extra storage.

CUSTOMIZABLE

The Customer Value Package adds a 2 cu. ft. refrigerator, two bunk-end fan lights, water purification system and self-storing awning.



JAY SERIES 1207 | CHOCOLATE



JAY SERIES 1207 | CHOCOLATE

Jay Series | FLOORPLANS

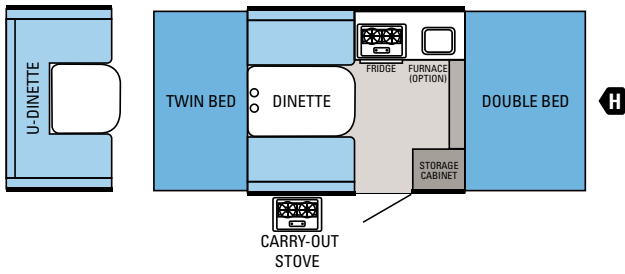

JAY SERIES | 806

Ext. Length: 11' 9" Travel Height: 59" Unloaded Weight (lbs.): 1,465

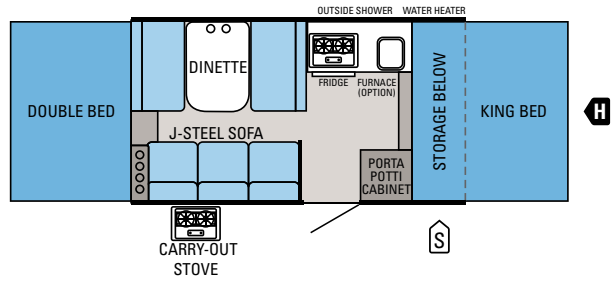

JAY SERIES | 1006

Ext. Length: 16' 2" Travel Height: 61" Unloaded Weight (lbs.): 2,005

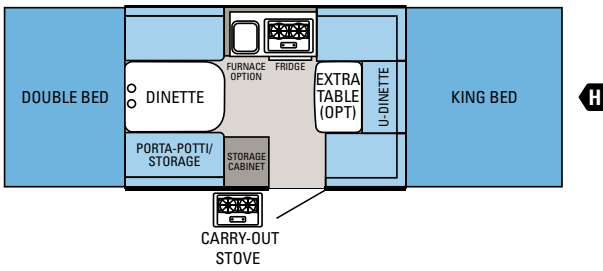

JAY SERIES | 1007

Ext. Length: 14' 2" Travel Height: 59" Unloaded Weight (lbs.): 1,750

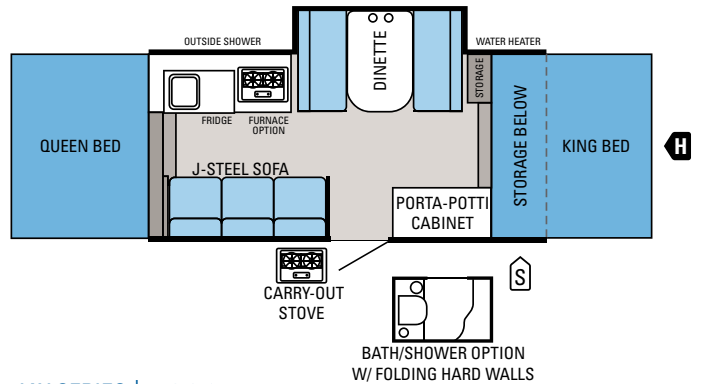

JAY SERIES | 1206

Ext. Length: 18' 2" Travel Height: 60" Unloaded Weight (lbs.): 2,450

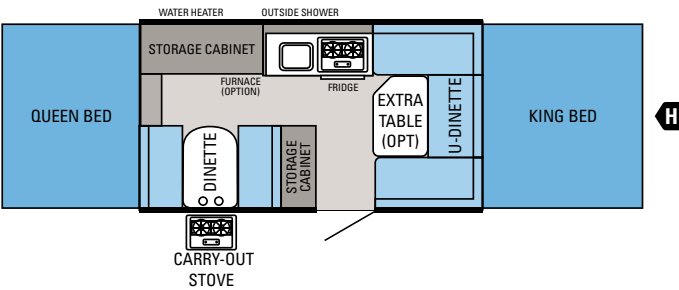

JAY SERIES | 1207

Ext. Length: 16' 2" Travel Height: 61" Unloaded Weight (lbs.): 1,970

Jay Series | INTERIOR DÉCOR

CHOCOLATE

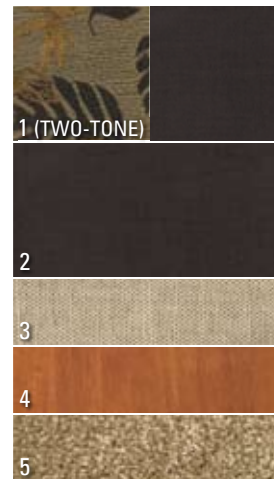

- 1 Dinette
- 2 Accent fabric
- 3 Drapery
- 4 Wood
- 5 Carpet

OUTSIDE STORAGE

TRAILER HITCH

MICROWAVE

REFRIGERATOR

Jay Series | STANDARDS AND OPTIONS

STANDARD KITCHEN EQUIPMENT

Acrylic sink and faucet
Appliances, pre-plumbed for propane
Carry-out dinette table
Spice rack (n/a 806)
Stainless-steel carry-out stove
Stove cover with wind deflectors

STANDARD EXTERIOR EQUIPMENT

12" C-range tires (806)
12" D-range tires (1007)
13" C-range tires (1006, 1207)
13" D-range tires (1206)
14" x 14" roof vent
20-lb. propane gas bottle
120V G.F.C.I. protected exterior receptacle
1,050-lb. rating on beds
Aluminum exterior sidewalls
Bumper, welded steel construction
Corrosion-resistant frame
Crank-down stabilizer jacks with sand pads
Diamond plate on front and rear walls
Domed fiberglass roof with no center seam and prepped for bike carrier
DuraTek water-repellent sectionalized tent
Electric brakes (1206)
Entrance door access with roof lowered
Entrance door caddy
Extrusions for box top are painted (powder-coated) white with white corner caps
E-Z Lube axles
Floor constructed of Structurwood and wrapped with Poly Flex underbelly material
Jayco's original, fully enclosed lifter system (same design used since 1968)
Leveling tongue jack and heavy-duty A-frame construction
Lifter post covers integrated into tent
Light in front trunk (select models)
One-piece construction entrance door
One-piece, high-density polyethylene wheel wells
Outside shower (n/a 806)

Patio light with amber lens
Permanently attached bed support poles
Prep wiring for battery
Rounded wheel wells
Scratch-resistant, embossed aluminum finish on exterior
Self-storing screen door
Self-storing step
Spare tire and tire carrier
Storage compartment in front trunk (select models)
Tent attachment Velcro around entrance door
TorFlex independent torsion axle suspension
Vinyl spare tire cover
White wheel rims

STANDARD INTERIOR EQUIPMENT

12V high-intensity lighting
120V G.F.C.I. protected interior receptacle
Automatic cut-off switch for interior lights
Ball bearing drawer guides 50-lb. capacity with full-drawer extension
Bed flaps cover edge of bed
Booth dinette
Brushed nickel hardware
Concord Cherry cabinetry
Coordinated furniture, designed and made by Jayco
Door pulls with roller catch
Drawers made of real wood
Granite-look countertop
Heavy-duty entrance door securement latches
Hinged plywood dinette seat bases
J-Steel sofa (1006, 1206)
Mildew-resistant aluminum ceiling
Non-sliding, 4" deep cushions for dinette with reversible EZ-clean vinyl backs
Powder-coated white bunk end bows with adjustable tension tent supports
Porta-potti storage cabinet (N/A 806, 1207)
Prep for A/C accommodating all roof-mounted A/C's
Privacy curtains for end-bunks
Sliding pantry in front wall (1006, 1206)
SoftShade window shades and valances

Tinted vinyl windows with fine-mesh screening
Vinyl flooring wall-to-wall
Water heater bypass system (N/A 806)

STANDARD HEAT, POWER & WATER EQUIPMENT

6-gal. water heater (N/A in 806)
12V electrical system with 30-amp 110V converter
17-gal. fresh water system with 12V demand pump
30-amp power cord
Hookup for city water

STANDARD SAFETY EQUIPMENT

Breakaway switch
Dual hitch safety chains
Fire extinguisher
Propane/carbon monoxide alarm
Smoke alarm

OPTIONS

16,000-BTU furnace with auto ignition
Bath/shower with hard walls and shower curtain (1206)
Customer Value Package
Deluxe screen room
Electric brakes (standard on 1206)
Extra table with pedestal leg (1007 and 1207)
Heated bed mats (2)
Hydraulic surge brakes
Outside grill
Powered roof vent
Roof-mount bike rack with double cross bars
Stereo with outside speakers
U-dinette (806)

CUSTOMER VALUE PACKAGE

2-cu.ft. 3-way gas/electric refrigerator (110V/12V/propane)
Bunk-end fan lights (2)
Self-storing awning made by Jayco
Water purification system

Jay Series | SPECIFICATIONS

FLOORPLAN	EXTERIOR LENGTH	CAMPSITE LENGTH	TRAVEL HEIGHT	UNLOADED VEHICLE WEIGHT (LBS.)	DRY HITCH WEIGHT (LBS.)	GROSS VEHICLE WEIGHT RATING (LBS.)	CARGO CARRYING CAPACITY (LBS.)	FRESH WATER CAPACITY (GAL.) (WITH WATER HEATER)	GRAY WASTEWATER CAPACITY (GAL.)	BLACK WASTEWATER CAPACITY (GAL.)
806	11' 9"	16' 2"	59"	1,465	175	2,250	785	17	0	0
1006	16' 2"	20' 10"	61"	2,005	235	2,950	945	23	0	0
1007	14' 2"	20' 10"	59"	1,750	185	2,550	800	23	0	0
1206	18' 2"	23' 4"	60"	2,450	245	3,450	1,000	23	11*	5*
1207	16' 2"	23' 4"	61"	1,970	190	2,950	980	23	0	0

*With optional bath/shower

2011

Jay Series Select HW



From a 3-burner stove/oven to a double-bowl sink, from double 20-lb. propane bottles to tall Lamilux 4000 fiberglass sidewalls, you'll find that the Jay Series Select HW is packed with more interior features than the competition, making it one of the industry's premier camping trailers.



JAY SERIES SELECT HW 141J | CRIMSON



JAY SERIES SELECT HW 141J | CRIMSON



JAY SERIES SELECT HW 141J | CRIMSON

Jay Series Select HW | STANDARDS AND OPTIONS

STANDARD KITCHEN EQUIPMENT

- 3 cu. ft. 3-way gas/electric refrigerator (110V/12V/propane)
- 3-burner stove/oven with recessed stove ring /cover
- Acrylic double-bowl sink and faucet
- Appliances, pre-plumbed for propane
- Carry-out dinette table
- Fluorescent light above sink
- Microwave oven
- Oversized oven
- Spice rack

STANDARD EXTERIOR EQUIPMENT

- 14" x 14" roof vent
- 14" C-range tires
- 120V G.F.C.I. protected exterior receptacle
- 1,050-lb. rating on beds
- Bumper, welded steel construction
- Corrosion-resistant frame
- Crank-down stabilizer jacks with sand pads
- Diamond plate on front and rear walls
- Domed fiberglass roof with no center seam and prepped for bike carrier
- DuraTek water-repellent sectionalized tent
- Electric brakes
- Entrance door access with roof lowered
- Entrance door caddy
- Exterior speakers, high-output marine grade (2)
- Extrusions for box top are painted (powder-coated) white with white corner caps
- E-Z Lube axles
- Floor constructed of Strukturwood and wrapped with Poly Flex underbelly material
- Jayco's original, fully enclosed lifter system (same design used since 1968)
- Lamilux 4000 fiberglass laminated sidewalls
- Leveling tongue jack and heavy-duty A-frame construction
- Lifter post covers integrated into tent
- One-piece construction entrance door
- One-piece high-density polyethylene wheel wells
- Outside shower
- Patio light with amber lens
- Permanently attached bed support poles
- Prep wiring for battery
- Rounded wheel wells
- Self-storing screen door
- Self-storing step
- Spare tire and tire carrier
- Tent attachment Velcro around entrance door
- TorFlex independent torsion axle suspension
- Vinyl spare tire cover

STANDARD INTERIOR EQUIPMENT

- 12V high-intensity lighting
- 120V G.F.C.I. protected interior receptacle
- Automatic cut-off switch for interior lights
- Ball bearing drawer guides 50-lb. capacity with full-drawer extension
- Bed flaps cover edge of bed

- Booth dinette
- Brushed nickel hardware
- Bunk-end fan lights (2)
- Cable TV hookup with RG6 connection
- Coordinated furniture, designed and made by Jayco
- Concord Cherry cabinetry
- Cup holders installed throughout
- Door pulls with roller catch
- Drawers made of real wood
- Floor-level courtesy lights
- Granite-look countertop
- Heavy-duty entrance door securement latches
- Hinged plywood dinette seat bases
- Mildew-resistant aluminum ceiling
- Non-sliding, 4" deep cushions for dinette with reversible EZ-clean vinyl backs
- Powder-coated white bunk end bows with adjustable tension tent supports
- Porta-potti storage cabinet
- Prep for A/C accommodating all roof-mounted A/C's
- Privacy curtains for end-bunks
- Raised-panel cabinet doors
- SoftShade window shades and valances
- Tinted vinyl windows with fine-mesh screening
- Vinyl flooring wall-to-wall

STANDARD HEAT, POWER & WATER EQUIPMENT

- 6-gal. water heater
- 12V electrical system with 35-amp 110V converter
- 17-gal. fresh water system with 12V demand pump
- 30-amp power cord
- 16,000-BTU furnace
- Double 20-lb. propane gas bottles with vinyl cover
- Hookup for city water
- Water heater bypass system

STANDARD SAFETY EQUIPMENT

- Breakaway switch
- Dual hitch safety chains
- Fire extinguisher
- Propane/carbon monoxide alarm
- Smoke alarm

OPTIONS

- Bath/shower with hard walls and clothes hanger
- Customer Value Package
- Deluxe screen room
- Heated bed mats (2)
- Hydraulic surge brakes
- Outside grill
- Powered roof vent
- Roof-mount bike rack with double cross bars

CUSTOMER VALUE PACKAGE

- Multi-Media Sound System AM/FM/CD stereo with MP3 input jack and 2 speakers (inside and out)
- Polished aluminum rims
- Self-storing awning made by Jayco
- Water purification system

Jay Series Select HW

FLOORPLAN

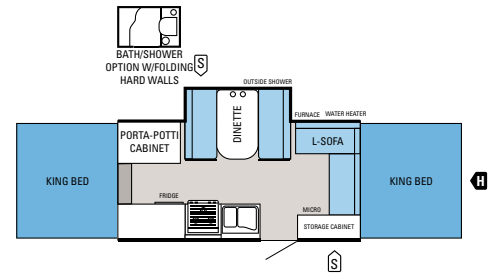

JAY SERIES SELECT HW | 141J

Ext. Length: 18' Travel Ht.: 66" Unloaded Wt. (lbs.): 2,780

- S OUTSIDE STORAGE
- MICRO MICROWAVE
- H TRAILER HITCH
- FRIDGE REFRIGERATOR

Jay Series Select HW

INTERIOR DÉCOR

CRIMSON



- 1 Dinette
- 2 Accent fabric
- 3 Drapery
- 4 Wood
- 5 Carpet

Jay Series Select HW | SPECIFICATIONS

FLOORPLAN	EXTERIOR LENGTH	CAMPSITE LENGTH	TRAVEL HEIGHT	UNLOADED VEHICLE WEIGHT (LBS.)	DRY HITCH WEIGHT (LBS.)	GROSS VEHICLE WEIGHT RATING (LBS.)	CARGO CARRYING CAPACITY (LBS.)	FRESH WATER CAPACITY (GAL.) (WITH WATER HEATER)	GRAY WASTEWATER CAPACITY (GAL.)*	BLACK WASTEWATER CAPACITY (GAL.)*
141J	18'	25' 8"	66"	2,780	375	3,850	1,070	17	7.5	5

*With optional bath/shower

Baja



With Baja, you'll never have to leave your toys at home again, thanks to our hard-core Bike Port deck that holds up to 1,500 pounds. Inside, you'll find many of the same features and amenities as the Jay Series Select HW camping trailers.



BAJA 12E | STEEL



BAJA 12E | STEEL



BAJA 12E | BIKE PORT DECK

Baja | STANDARDS AND OPTIONS

STANDARD KITCHEN EQUIPMENT

- 2 cu. ft. 3-way gas/electric refrigerator (110V/12V/propane) (12E)
- 3 cu. ft. 3-way gas/electric refrigerator (110V/12V/propane) (14F)
- 3-burner stove/oven with recessed stove ring/cover (14F)
- Acrylic sink and faucet
- Appliances, pre-plumbed for propane
- Carry-out dinette table
- Fluorescent light above sink
- Microwave oven (14F)
- Oversized oven (14F)
- Stainless-steel carry-out stove (12E)
- Stove cover with wind deflectors (12E)

STANDARD EXTERIOR EQUIPMENT

- 14" x 14" roof vent
- 15" off-road Dunlop Mud Rover radial tires
- 120V G.F.C.I. protected exterior receptacle
- 1,050-lb. rating on beds
- Corrosion-resistant frame
- Crank-down stabilizer jacks with sand pads
- Diamond-plate on rear and front wall
- Domed fiberglass roof with no center seam and prepped for bike carrier
- Double entrance step
- D-rings welded to front storage deck
- DuraTek water-repellent sectionalized tent
- Electric brakes
- Entrance door access with roof lowered
- Entrance door caddy
- Exterior speakers, high-output marine grade (2)
- Extrusions for box top are painted (powder-coated) white with white corner caps
- E-Z Lube axles
- Lamilux 4000 fiberglass laminated sidewalls
- Floor constructed of Strukturwood and wrapped with Poly Flex underbelly material
- Front storage deck with expanded steel surface and aluminum deck railing
- Jayco's original, fully enclosed lifter system (same design used since 1968)
- Leveling tongue jack and heavy-duty A-frame construction
- Lifter post covers integrated into tent
- Mud flaps
- One-piece construction entrance door
- One-piece, high-density polyethylene wheel wells
- Outside shower
- Patio light with amber lens
- Permanently attached bed support poles
- Prep wiring for battery
- Ramps/deck railing (dual use) with quick-connect deck attachment system
- Rear bumper made of 4" tubular steel
- Rounded wheel wells
- Self-storing screen door
- Spare tire and tire carrier
- Tent attachment Velcro around entrance door
- Vinyl spare tire cover

STANDARD INTERIOR EQUIPMENT

- 12V high-intensity lighting
- 120V G.F.C.I. protected interior receptacle
- Automatic cut-off switch for interior lights

- Ball bearing drawer guides 50-lb. capacity with full-drawer extension
- Bar for hanging clothes (select models)
- Bath/shower with hard walls and shower curtain (14F)
- Bed flaps cover edge of bed
- Booth dinette
- Brushed nickel hardware
- Bunk-end fan lights (2)
- Concord Cherry cabinetry
- Coordinated furniture, designed and made by Jayco
- Cup holders installed throughout (select models)
- Door pulls with roller catch
- Drawers made of real wood
- Granite-look countertop
- Heavy-duty entrance door securement latches
- Hinged plywood dinette seat bases
- J-Steel sofa (12E)
- Mildew-resistant aluminum ceiling
- Non-sliding, 4" deep cushions for dinette with reversible EZ-clean vinyl backs
- Powder-coated white bunk end bows with adjustable tension tent supports
- Prep for A/C accommodating all roof-mounted A/C's
- Privacy curtains for end-bunks
- SoftShade window shades and valances
- Tinted vinyl windows with fine-mesh screening
- Vinyl flooring wall-to-wall

STANDARD HEAT, POWER & WATER EQUIPMENT

- 6-gal. water heater
- 12V electrical system with 30-amp 110V converter
- 30-amp power cord
- 30-gal. fresh water system with 12V demand pump
- Double 20-lb. propane gas bottles with vinyl cover
- Hookup for city water
- Water heater bypass system

STANDARD SAFETY EQUIPMENT

- 1,500-lb. front deck capacity
- Breakaway switch
- Dual hitch safety chains
- Fire extinguisher
- Propane/carbon monoxide alarm
- Smoke alarm

OPTIONS

- 16,000-BTU furnace with auto ignition
- Bath/shower with hard walls (12E)
- Customer Value Package
- Deluxe screen room
- Front storage box
- Heated bed mats (2)
- Outside grill
- Powered roof vent
- Roof-mount bike rack with double cross bars

CUSTOMER VALUE PACKAGE

- Battery gauge
- Multi-Media Sound System AM/FM/CD stereo with MP3 input jack and 2 speakers (inside and out)
- Polished aluminum rims
- Self-storing awning made by Jayco
- Solar prep
- Water purification system

Baja | FLOORPLANS

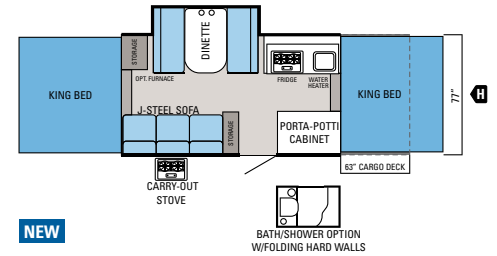

NEW

BAJA | 12E

Ext. Length: 22' 6" Travel Ht.: 69" Unloaded Wt. (lbs.): 3,025

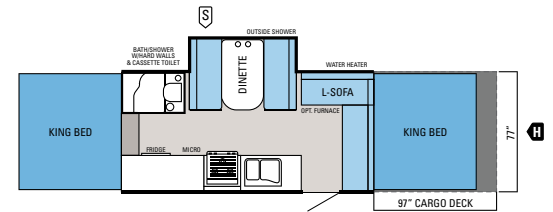

BAJA | 14F

Ext. Length: 26' 11" Travel Ht.: 78" Unloaded Wt. (lbs.): 4,025

- S OUTSIDE STORAGE
- MICRO MICROWAVE
- H TRAILER HITCH
- FRIDGE REFRIGERATOR

Baja | INTERIOR DÉCOR

STEEL



- 1 Dinette
- 2 Accent fabric
- 3 Drapery
- 4 Wood
- 5 Carpet

Baja | SPECIFICATIONS

FLOORPLAN	EXTERIOR LENGTH	CAMPSITE LENGTH	TRAVEL HEIGHT	UNLOADED VEHICLE WEIGHT (LBS.)	DRY HITCH WEIGHT (LBS.)	GROSS VEHICLE WEIGHT RATING (LBS.)	CARGO CARRYING CAPACITY (LBS.)	FRESH WATER CAPACITY (GAL.) (WITH WATER HEATER)	GRAY WASTEWATER CAPACITY (GAL.)	BLACK WASTEWATER CAPACITY (GAL.)
12E	22' 6"	27' 6"	69"	3,025	420	4,850	1,825	36.5	11*	5*
14F	26' 11"	32' 2"	78"	4,025	490	7,500	3,475	36.5	11	5

*With optional bath/shower

↑ LIVEABLE FEATURES AND AMENITIES

Every Jayco comes packed with features and amenities designed to make your life easier and family time more enjoyable.



3-WAY REFRIGERATOR

The refrigerator runs on propane, electric or battery, so your food will stay cold, no matter where you go (Jay Series Select HW and Baja).



OUTSIDE SHOWER

It's the perfect place to clean up after a hard day of playing (n/a on 806).



SOFT SHADES

Jayco's hand-crafted SoftShade window valances provide beauty and functionality.



FRONT STORAGE BOX

Keep your gear safe and secure in the convenient front storage box (optional on Baja only).



A TRADITION OF LIVEABILITY

Starting with our first lifter system for fold-down campers in 1968, which made for an easier, more enjoyable camping experience, Jayco has always been about liveability. Today, we're the world's largest family-owned RV manufacturer, yet our priorities remain the same: making RVs more liveable and family time more memorable.



16,000-BTU FURNACE

Stay warm with our camping trailer's 16,000-BTU furnace with auto ignition (optional on Jay Series and Baja; standard on Jay Series Select HW).



MULTI-MEDIA SOUND SYSTEM

Have a great time inside or out thanks to the optional stereo with AM/FM/CD/MP3 jack and interior and exterior speakers (part of the Customer Value Package on Jay Series Select HW and Baja).



TRUE VALUE OF OWNERSHIP

With Jayco, you get more amenities, more liveable, home-like features and superior construction for longer durability and a better resale value. Simply put, you won't find another RV packed with more *true value*—from the time of purchase to the time you sell. Don't believe us? Run through this list. The check marks don't lie.

US THEM

2011 CAMPING TRAILERS

- 2-year Co-Pilot warranty with 1-year roadside assistance
- Above-floor, fully enclosed patented lifter system (lifetime warranty)
- One-piece, seamless domed fiberglass roof with bike carrier prep (lifetime warranty)
- DuraTek water-repellent sectionalized tent (5-year warranty)
- Corrosion-resistant frame (lifetime warranty)
- E-Z Lube axles
- Ball bearing drawer guides with 50-lb. capacity, full-drawer extension
- Sleek, one-piece entry door
- Stainless-steel carry-out stove (Jay Series and Baja 12E)
- SoftShade window shades and valances
- Seamless floor decking with Poly Flex covering (lifetime warranty)



AMERICA'S MOST **LIVEABLE** RVs.

Camping Trailers

JAY SERIES | JAY SERIES SELECT HW | BAJA

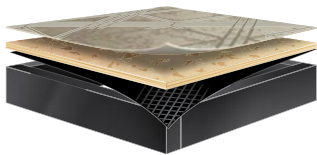

FLOOR

A combination of seamless $\frac{5}{8}$ " Structurwood, a Poly Flex under-floor covering, and a corrosion-resistant steel frame create one of the industry's strongest foundations.

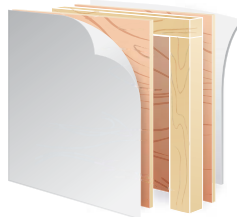

WALLS

Jayco's double-wall laminated construction, superior to the competition's single-wall structure, is designed to withstand use and travel.

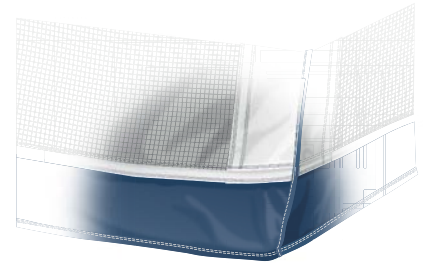

DURABLE TENT DESIGN

DuraTek water-repellent tent material, a Velcro attachment system, double-stitching and sturdy vinyl construction combine for durability and long-lasting value.



LIFTER SYSTEM

Fully enclosed to protect against rust and road debris, our patented lifter system uses strong and flexible push-rods to guide the roof up as you crank, while our tubular lift posts have no edges to chafe or soil the tent. Nylon bushings in the lifter posts reduce friction and extend the life of the system.

↑ JAYCO CONSTRUCTION

See the difference.

At Jayco, we've built a reputation for superior construction and craftsmanship. We always use top-quality materials and production techniques, giving our products reliable resale value and our owners peace of mind.

◀ INSIDE ENGINEERING

Much of what gives a Jayco camping trailer its reputation for durability, strength and liveability is in the details. Our camping trailers feature ① a one-piece seamless domed roof (with prep for an optional bike carrier), ② a corrosion-resistant frame, ③ tinted vinyl windows with fine-mesh screening, ④ a one-piece entry door with self-storing step, ⑤ mildew-resistant aluminum ceiling with prep for roof A/C, ⑥ our patented lifter system and ⑦ crank-down stabilizer jacks with sand pads.

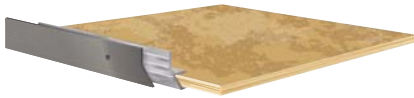

END BUNKS

A two-piece extruded aluminum bed frame, 1/2" seamless Structurwood, and heavy-duty bed supports can hold up to 1,050 pounds. Plus, with Jayco's new permanently attached bed support poles, setup and teardown is easier than ever, while eliminating misplaced poles.



BALL BEARING GUIDES

Our residential-style ball bearing drawer guides provide smooth operation and full-drawer extension. And with its 50-pound capacity and real-wood construction, you get a stronger, more substantial drawer and a true home-like feel.

↑ JAYCO CRAFTSMANSHIP

Jayco's dedicated production team includes Amish craftsmen who build with well-honed woodworking techniques passed down for generations and skilled seamstresses who produce our upholstery, bedding and draperies with great attention to detail.





AMERICA'S MOST **LIVEABLE** RVs.



WARRANTY

INDUSTRY-LEADING WARRANTY

The Jayco Co-Pilot Warranty is a manufacturer's limited warranty. Each Jayco is warranted to the original purchaser for twenty-four (24) months or twenty-four thousand (24,000) miles (mileage limitation applies to motorized products only), whichever occurs first, from the original date of purchase against defects in materials and workmanship. Jayco's limited warranty is not transferable.

ADDITIONAL WARRANTIES

Jayco offers to the original purchaser of any of our camping trailers additional industry-leading lifetime parts and labor coverage on our lifter system, roof, floor and frame. We also offer five-year (5) coverage on our tent with parts, labor and freight covered the first two years; parts, factory labor and return freight during years three, four and five.

For a copy of the limited warranties with full terms and conditions, ask your local dealer.



OVER 300 LOCAL DEALERS

Establishing a solid relationship with your local Jayco dealer is a key component in the enjoyment of your new Jayco. By purchasing from a local dealer, you will have a convenient location for sales, parts and service support.

Jayco dealers are required to deliver all products at the site of the sale to provide a full product orientation and walkthrough at the time of delivery. It's a good way to become familiar with your Jayco and to meet the service, parts and warranty staff members who will be assisting you. If you live in Canada, there are regulations that must be met when buying a Jayco RV. Your local Canadian dealer is a professional at meeting these requirements and regulations. There simply is no substitute for a good relationship with your local Jayco dealer.



1-YEAR ROADSIDE ASSISTANCE

Travel worry-free with Jayco's Customer First Roadside Assistance program, yours at no cost during your first year of ownership. This program is offered through Coach-Net, the largest RV emergency road service in the country, and gives you immediate access to dependable roadside assistance and support services with a simple phone call.

- Free jump starts
- Free tire changes
- Free fuel delivery
- Free lockout service
- Free travelers checks
- Toll-free nationwide service appointment assistance
- 24-hour toll-free emergency message service
- Free custom trip routing and full-color map service
- Free dispatch of on-site mechanical service
- \$2,000 trip-interruption reimbursement
- RV technical assistance hotline
- Free towing to nearest qualified service

Your Jayco Dealer



Jayco proudly sponsors Tread Lightly!, a nonprofit organization whose mission is to empower generations to enjoy the outdoors responsibly through education and restoration.

Unloaded Vehicle Weight (UVW): Sometimes referred to as "Dry Weight," UVW means the typical weight of this trailer as built at the factory. The UVW, as used in product literature and other promotional materials, does not include cargo, fresh water, propane, options or dealer-installed accessories.

Gross Vehicle Weight Rating (GVWR): GVWR means the maximum permissible weight of the trailer, including the UVW plus passengers, personal items, all cargo, fluids, options, and dealer-installed accessories. The GVWR is equal to or greater than the sum of the UVW and the CCC.



From RV insurance to extended warranties, JayPlus has it covered. Ask your Jayco dealer about our exclusive JayPlus program today.

Cargo Carrying Capacity (CCC): CCC means the maximum weight of all passengers, personal items, food, fresh water, propane, tools, other cargo and dealer-installed accessories that can be carried by the trailer. CCC is equal to or less than GVWR minus UVW. The addition of options will decrease the CCC.

Hitch Weight (HW): The hitch weight, as used in product literature and other promotional materials, does not include cargo, fresh water, propane gas, options or dealer-installed accessories. The addition of these types of items will either add to or subtract from the stated hitch weight.



As a Jayco owner, you can be part of the Jayco Jafari International Travel Club. Ask your dealer about the Jafari "flight" in your area, write Jayco or visit our website.

It is important for your safety and enjoyment that your tow vehicle be adequately sized and equipped to tow and handle the GVWR of the RV you select. Review weights and rating of your tow vehicle and consult a competent advisor for questions or advice. Whether you are new to RVing or a veteran, get a feel for the performance of your tow vehicle before heading out on the roadways. When you tow an RV, you must drive differently than when you drive a single vehicle. Practice hooking up, driving, backing up and braking in a safe environment or seek out professional instruction. Jayco affixes a weight label to each RV which lists weight information for that vehicle. See specifications chart inside.

Jayco, Inc., P.O. Box 460, Middlebury, IN 46540, www.jayco.com © **RVIA**

See dealer for further information and prices. All information in this brochure is the latest available at the time of publication approval. Jayco reserves the right to make changes and to discontinue models without notice or obligation. Photos in this brochure may show optional equipment and props for photography purposes. RVs built for sale in Canada may differ to conform to Canadian codes. ©2010 Jayco, Inc. 11-FDCT-PL 0610-100K Printed in U.S.A.