

# TIOGA®



## Meet the new Fleetwood generation.

NAME: David and Debbie Geller

AGE: It doesn't matter

OCCUPATION: Sporting Goods Distributors

OUTLOOK ON LIFE: *"Life begins after 40. And that's the truth.*

*Every day look for the little things that bring you joy. Remember to share, have fun and talk to each other. That's what keeps people young and happy at heart. Stand up for what you believe in and things will always work out. They have for us and we're having the best time of our lives. And you will too."*

MOTTO: *"Always lend a helping hand, because you never know when you'll land the big one."*

MOTOR HOME: Fleetwood TIOGA®

## Meet the new Fleetwood TIOGA®.

NAME: TIOGA®

PURPOSE: Value and quality from The World's #1 RV Manufacturer

SPECIFICATIONS: 6 floor plans - 22' to 31' models available •

96" wide interior • Five models available on Ford® E450 chassis •

Two models offered on Chevy™ Express chassis

STANDARD FEATURES: Selection of stylish decor packages •

Beautiful wood grain cabinetry • Quality Flexsteel® furniture • Name brand appliances • Patented slider bunk • Easy view TV cabinet • Ducted roof air (selected models) • Vacubond walls with block foam insulation • Smooth impact-resistant fiberglass exterior walls • Breakaway mirrors • Plus many safety features

MOTTO: "TIOGA®—recognized for quality and value."



**FLEETWOOD. RV**

The World's #1 RV Manufacturer

## Tioga Features for 2002

Our engineering may set us apart from the rest, but the things you'll notice most when you and your family take a trip, are the name brand appliances and top-of-the-line features. Here are just a few of the items that make life on the road with Tioga more enjoyable.



**1** A 5,000 lb. trailer hitch\* is available on selected models to bring along your boat, ATVs or other toys.

**2** Tioga's smooth, impact-resistant fiberglass walls are enhanced with color-coordinated graphics for lasting style.

**3** Tioga has a 4 $\frac{1}{4}$ " crowned roof with a durable, quality Tuff-Ply™ cover to protect your motor home from the elements.

**4** Convenient and spacious storage compartments are easy to open and made of non-corrosive polyethylene or galvanized sheet metal material.

**5** An optional electric powered entry step provides convenient automatic step extension when the door is opened and retraction when the door is shut.

**6** Automotive style undercoating protects vital components and chassis from rust and corrosion.

**7** A drip rail molding on both sides of your Tioga guides roof water run-off to the front and rear of your coach, away from openings and patio area.

**8** Optional steel running boards with sturdy formed steel construction, and a protective powder-coated finish, are available for the first step into the cab of your new Tioga.

**9** Anti-wicking process, on all of Tioga's openings and windows, includes multiple seals for prevention of leaks and moisture buildup.

**10** Velvac® breakaway exterior mirrors are mounted on pivoting arms for safe rotation if impacted. They are also available with optional remote electric adjustment and heated defrost features. (Selected Models)

**11** The optional skirt paint adds a classic touch to Tioga's exterior.



Beautiful residential-style wood cabinetry in the galley can even hold tall cereal boxes.



Every Tioga is available with an optional Winegard® satellite dish.



Our EZ Store™ Storage System was developed using a rack and pinion system to give you the utmost ease in accessing your stored gear below. (Available on SL Model 31W only)

\*The chassis manufacturer recommends the installation of a supplemental brake control system to activate the brakes on the vehicle or trailer you are towing.

Ford® Chassis	22C	23E	Tioga 24D	26Q	29V	Tioga SL 31W
Wheelbase	N/A	158"	158"	176"	198"	214"
GVWR (lbs) (1)	N/A	14,050	14,050	14,050	14,050	14,050
Front GAWR (lbs) (2)	N/A	4,600	4,600	4,600	4,600	4,600
Rear GAWR (lbs) (2)	N/A	9,450	9,450	9,450	9,450	9,450
Base Weight (lbs) (3)	N/A	9,899	9,186	9,840	10,140	11,953
GCWR (lbs) (4)	N/A	19,050	19,050	19,050	19,050	17,550
Hitch Rating Weight (lbs)*	N/A	5,000	5,000	5,000	5,000	3,500
Tongue Weight (lbs)*	N/A	500	500	500	500	350
Fuel Capacity (gal)	N/A	55	55	55	55	55
Chevy™ Chassis						
Wheelbase	139"	N/A	159"	N/A	N/A	N/A
GVWR (lbs) (1)	12,300	N/A	12,300	N/A	N/A	N/A
Front GAWR (lbs) (2)	4,300	N/A	4,300	N/A	N/A	N/A
Rear GAWR (lbs) (2)	8,600	N/A	8,600	N/A	N/A	N/A
Base Weight (lbs) (3)	8,898	N/A	9,137	N/A	N/A	N/A
GCWR (lbs) (4)	15,800	N/A	15,800	N/A	N/A	N/A
Hitch Rating Weight (lbs)*	3,500	N/A	3,500	N/A	N/A	N/A
Tongue Weight (lbs)*	350	N/A	350	N/A	N/A	N/A
Fuel Capacity (gal)	33	N/A	55	N/A	N/A	N/A
Dimensions and Capacities						
Overall Length–Ford® (5)	N/A	23' 11"	24' 11"	26' 9"	29' 10"	31' 2"
Overall Length–Chevy™ (5)	22' 11"	N/A	25' 4"	N/A	N/A	N/A
Overall Height	10' 7"	10' 7"	10' 7"	10' 7"	10' 7"	11' 4"
Overall Width (maximum) (6)	99"	99"	99"	99"	99"	99"
Interior Height (maximum)	79"	79"	79"	79"	79"	79"
Interior Width (maximum)	96"	96"	96"	96"	96"	96"
Fresh Water Holding Tank (gal)	30	35	30	30	30	35
Grey Water Holding Tank (gal)	30	36	36	34	37	35
Black Water Holding Tank (gal)	25	35	35	36	37	35
Appliance LPG Tank (gal) (WC) (7)	14	14	14	14	14	14
Water Heater Tank (gal)	6	6	6	6	6	6
Liquid Weight Reference	Water (gal) = (8.3 lbs/3.8 kgs)		Fuel (gal) = (6.1 lbs/2.8 kgs)		LPG (gal) = (4.5 lbs/2.0 kgs)	
Metric Conversion	Multiply pounds x 0.453 to obtain kilograms			Multiply gallons x 3.785 to obtain liters		

- GVWR (Gross Vehicle Weight Rating): Means the maximum permissible loaded weight of the motor home. The GVWR is equal to or greater than the sum of the unloaded vehicle weight plus the net carrying capacity.*
  - GAWR (Gross Axle Weight Rating): Means the maximum permissible loaded weight a specific axle is designed to carry.*
  - BW (Base Weight): Means the weight of the motor home without fuel, options, water, cargo or passengers.*
  - GCWR (Gross Combined Weight Rating): Means the value specified by the motor home manufacturer as the maximum allowable loaded weight of this motor home with its towed vehicle. Towing and braking capacities may differ. Refer to Fleetwood and chassis manufacturer manuals for complete information.*
  - Overall length measured from forward most body point or bumper to rear most body point or rear bumper.  
Add 5" for rear mounted spare tire.  
Add 1" for rear ladder.  
Add 32" for bike rack.*
  - Excludes safety equipment and awnings.*
  - Tank Manufacturer's listed water capacity (WC). Actual LPG capacity is 80% of water listing as required by the safety code.  
N/A: Not applicable.*
- \* The chassis manufacturer recommends the installation of a supplemental brake control system to activate the brakes on the vehicle or trailer you are towing.

**IMPORTANT — PLEASE READ:** Product information, photography and illustrations included in this publication were as accurate as possible at the time of printing. For further product information and changes, please visit our website at [www.fleetwoodrv.com](http://www.fleetwoodrv.com) or contact your local Fleetwood dealer. Prices, materials, design and specifications are subject to change without notice. All weights, fuel, liquid capacities and dimensions are approximate. Fleetwood has designed its recreational vehicles to provide a variety of uses for its customers. Each vehicle features optimal seating, sleeping, storage and fluid capacities. The user is responsible for selecting the proper combination of loads (i.e. occupants, equipment, fluids, cargo, etc.) to ensure that the vehicle's capacities are not exceeded.

# 2002 Standard Features and Options

# TIOGA®

Exterior Automotive	22C	23E	Tioga 24D	26Q	29V	Tioga SL 31W
Chassis—Ford® E450, 6.8L Triton™ V10 w/305 hp, Dual Airbags, 4W Anti-Lock Brakes, Automatic 4-Speed Transmission w/Overdrive		S	S	S	S	S
Chassis—Chevy™ Express, 8.1L Vortec™ V8 w/340 hp, 4W Anti-Lock Brakes, Automatic 4-Speed Transmission w/Overdrive			0			
Chassis—Chevy™ Express, 5.7L Vortec™ V8 w/245 hp, 4W Anti-Lock Brakes, Automatic 4-Speed Transmission w/Overdrive	S					
Trailer Hitch (3,500 lbs. Rating)—Chevy™*	S		0			S
Trailer Hitch (5,000 lbs. Rating)—Ford®*		S	S	S	S	
7-Pin Hitch Plug	S	S	S	S	S	S
Chrome Wheel Covers	S					
Stainless Steel Wheel Liners		S	S	S	S	S
Spare Tire	0	0	0	0	0	S
<b>Interior Automotive</b>						
Power Windows & Door Locks		S	S	S	S	S
Flexsteel® Adjustable/Reclining Bucket Seats w/Armrest (Ford)		S	S	S	S	S
Flexsteel® Deluxe Ultraleather™ Bucket Seats						0
Chassis Supplied—Heating & Air Conditioning, Cigarette Lighter/12V Power Supply, Intermittent Windshield Wipers, Power Steering w/Tilt Wheel, Cruise Control, Sunvisors (2), Dome Light, Beverage Cup-Holders, Map Pocket	S	S	S	S	S	S
Custom Dash Appliques		0	0	0	0	S
Privacy Curtain Panel	S	S	S	S	S	S
Rearview Camera/Monitor System					0	0
<b>Exterior</b>						
Smooth 1-Pc. Fiberglass Sidewall Surface	S	S	S	S	S	S
1-Pc. Crowned Roof w/Tuff-Ply™ Covering	S	S	S	S	S	S
Welded Cage Construction—Strong Box Tubing Components	S	S	S	S	S	S
Vacu-bond® Hull Lamination Process	S	S	S	S	S	S
Undercoating—Automotive Quality Undercarriage Protection	S	S	S	S	S	S
Aluminum Running Boards	0	S	S	S	S	
Steel Running Boards		0	0	0	0	
Custom Running Boards/Wheel Flares						S
Molded Rear Wheel Trim Flares	S	S	S	S	S	S
Molded Rear Wall/Ceiling Transition Trim	S	S	S	S	S	S
Painted Skirts	0	0	0	0	0	S
Rear Ladder	0	S	S	S	S	S
Breakaway Side Mirrors	S	S	S	S	S	
Power/Heated Side Mirrors		0	0	0	0	S
Awning—Patio Cover (USA Only)	0	0	0	0	0	0
AC Duplex GFI Receptacle on Patio Side	S	S	S	S	S	S
Windows—Radius Tinted	S	S	S	S	S	S
Luggage Doors—Strut Assisted w/Paddle Latches, Locking						S
Large Storage Bay—Multi-Door Compartment Access w/Smaller Storage Wells for Convenient Cargo Organization, Strut Assisted Doors				S		
Electric Power Entry Step	0	0	0	0	0	S
Entry Door w/Screen Door & Deadbolt Lock	S	S	S	S	S	S
Porch Light w/Interior Switch	S	S	S	S	S	S
Wash Unit—Dual Control Faucet, Shower Hose w/Flexible Hose, Water Pump On/Off Switch		0	0	0	0	
Central Utility Compartment—Wash Unit w/Pump Switch, City Water Hook-Up, Drainage Valves, Park Cable Input Jack, Telephone/Modem Input Jack, Power Cord Storage, Utility Access Hatches in Compartment Bottom						S
Bicycle Rack—Trailer Hitch Receiver Mount	0	0	0	0	0	0
<b>Interior</b>						
54" X 76" Cabover Bed w/Patented Slider Bunk Operation, Privacy Curtain, Roof Vent & Sliding Side Windows	S	S	S	S	S	S
Cabover Bunk Ladder	S	S	S	S	S	S
Television-Ready Cabinet	S	S	S	S	S	
Ceiling Lights w/Wall Switches at Entry & Lavy	S	S	S	S	S	S
Mini-Blinds	S					
Day/Night Pleated Shades—Living Area	0	S	S	S	S	S

The chassis manufacturer recommends the installation of a supplemental brake control system to activate the brakes on the vehicle or trailer you are towing.

## 2002 Standard Features and Options

# TIOGA®

Interior	22C	23E	Tioga 24D	26Q	29V	Tioga SL 31W
Night Pleated Shades—Bedroom			S	S	S	S
Jalousie Windows—Bedroom						S
Cup-holders (2) in Dinette	S	S	S	S	S	S
Large Viewing Window in Dinette		S	S	S	S	
Residential Style Clock	S	S	S	S	S	S
Carpet w/Pad & Vinyl Flooring in Galley & Lavy	S	S	S	S	S	S
Telephone/Modem Jack w/Exterior Jack Input	S	S	S	S	S	S
<b>Cabinetry</b>						
Mitered Frame Doors with Vinyl Face Drawer Fronts	S	S	S	S	S	
Mortise & Tenon Frame w/Raised Panel Doors & Solid Wood Drawer Fronts	0	0	0	0	0	S
American Oak or Plantation Cherry Woodgrain Selections	S	S	S	S	S	S
Drawer Boxes—Real Wood Construction	S	S	S	S	S	S
<b>Galley</b>						
Sink—Residential Size Double Bowl	S	S	S	S	S	S
Faucet—Single Lever Control	S	S	S	S	S	S
Water Filtration System	0	0	0	0	0	S
Rangehood w/Light & Fan	S	S	S	S	S	S
3-Burner Range w/High-Output/Piezo Ignitor	S					
3-Burner Range w/High-Output/Piezo Ignitor & Oven	0	S	S	S	S	S
Microwave Oven—1.0 cu. ft. w/Touch Panel	0	S	S	S	S	
Microwave Oven—Auto-Touch Convection						S
Refrigerator/Freezer—Dometic® 6 cu. ft.	S	S	S	S	S	
Refrigerator/Freezer—Dometic® 8 cu. ft.						S
Refrigerator Door Insert—Hardwood						S
Flip-Top Extension	S		S	S	S	
Kitchen Convenience Package—Spice Rack, Knife Holder, Paper Towel Holder, Sink Cover/Cutting Board, Silverware Drawer		S	S	S	S	S
Decorative Wall Border	S	S	S	S	S	S
<b>Bath</b>						
Shower Surround/Pan—Molded ABS	S			S	S	S
Shower/Tub Surround/Pan—Molded ABS		S	S			
Shower Head w/Flexible Hose Extension	S	S	S	S	S	S
Rectangular Sink w/Dual Control Faucet	S	S	S	S	S	S
Medicine Cabinet—Wood Construction	S	S	S	S	S	S
Mirror—Wall Mounted	S	S	S	S	S	S
Towel Bar	S	S	S	S	S	S
Shower Door w/Obscure Glass						S
Skylight/Roof Vent w/12V Fan	S	S	S	S	S	S
Toilet—Marine Style w/Tissue Roll Holder	S	S	S	S	S	S
Bath Door—White Colonial Panel w/Residential Passage Lock	S	S	S	S	S	S
<b>Bedroom</b>						
Bedsread w/Pillow Shams			S	S	S	S
Mattress—Innerspring			S	S	S	S
Double Bed			S			
Queen Bed				S	S	S
Twin Beds					0	0
Bunk Beds w/Cushions			0			
Double Bunk Beds w/Cushions					0	
TV Shelf w/12V & Cable Jacks, AC Receptacle				S	S	S
Reading Lights—Adjustable			S	S	S	
Wall Lights—Decorative						S
<b>Furnishings</b>						
Furniture—Quality Construction by Flexsteel®	S	S	S	S	S	S
Jackknife Sofa/Convertible for Sleeping	S					
Sofa—Jackknife w/Armrests & Snack Tray/Convertible for Sleeping		S			S	S
Dinette—Convertible for Sleeping	S	S	S	S	S	S
Lounge Chair—Swivel Base w/Forward Facing Lock Position			S	S		



# 2002 Standard Features and Options

# TIOGA®

Entertainment	22C	23E	Tioga 24D	26Q	29V	Tioga SL 31W
Video Ready Package—Retractable TV Antenna, Amplified Antenna Booster, Interior Jacks w/12V & Coax Cable Ports, Coax Cable, Exterior Park Cable Input Jack	S	S	S	S	S	S
Satellite Dish—Digital Elevation Sensor w/Manual Lift		0	0	0	0	0
13" Color TV (AC/DC) w/VCR & Remotes	0	0	0	0	0	
20" Color TV (DC) w/VCR & Remotes						S
Cabover Entertainment Center w/Color TV, VCR, Video Selector Center		0	0	0	0	
Exterior Entertainment Center—12V DC Jack, AC Duplex Receptacle, Coax Cable Jack, Speakers (2), Telephone/Modem Jack, Lockable Door		0	0	0	0	S
Radio (Cab)—AM/FM/Cassette	S	S	S	S	S	S
Radio (Cab)—AM/FM/CD	0	0	0	0	0	0
Multiple Disc CD Changer		0	0	0	0	0
4 Speakers—(2) in Cab Doors, (2) Ceiling Mounted	S	S	S	S	S	S
<b>Coach Support Systems</b>						
Monitor Panel—Auxiliary & Chassis Battery Condition Check, Holding Tank Levels, Fresh Water Tank Level, LP Gas Tank Level, All Level Readings in 1/4 Increments, DSI Water Heater Switch w/Lighted Indicator, Water Pump Switch w/On Indicator Light, Battery Disconnect Switch, Generator Start/Stop Switch & Hour Meter (w/Generator Option)	S	S	S	S	S	S
Auxiliary Battery—12V	S		S	S	S	
Auxiliary Batteries—Dual 6V Deep Cycle	0	S	0	0	0	S
Battery Compartment—Molded Cross-Link Polyethylene Container & Lid						
Easy Access for Battery Maintenance & Electrical Components Check	S	S	S	S	S	S
Auxiliary Start Circuit—Emergency Start Assist Switch on Dash	0	S	S	S	S	S
Battery Disconnect—Auxiliary Battery(ies), Switch on Monitor Panel	S	S	S	S	S	S
AC/DC Load Center w/12V Converter/Battery Charger	S	S	S	S	S	S
Shore-Line Power Cord—30-Amp, 30' Long, Compartment Storage	S	S	S	S	S	S
Generator—Onan® Microquiet 4000 Watt (Gasoline)	0	0	0	0	0	S
Air Conditioner—13,500 BTU						
Air Conditioner—13,500 BTU/Ducted Ceiling/Adjustable Flow Air Ports		0	0	0		
Air Conditioner—15,000 BTU/Ducted Ceiling/Adjustable Flow Air Ports					0	S
Roof Vent—Front Cabover Bunk	S	S	S	S	S	S
Roof Vent—Bedroom			S	S	S	S
Powered Fan-Tastic® Fan/Vent—Cabover Bunk	0	0	0	0	0	0
Furnace—25,000 BTU, Auto-Ignition, Ducted, Wall Mtd. Thermostat	S	S	S			
Furnace—30,000 BTU, Auto-Ignition, Ducted, Wall Mtd. Thermostat				S	S	S
Fresh Water Plumbing—Cross-Linked Polyethylene Tubing	S	S	S	S	S	S
Water Heater—6 Gallon, Electronic Ignition, LP Gas	S	S	S	S	S	S
Water Heater Bypass Valve—Fresh Water System Winterization	S	S	S	S	S	S
Water Pump—12V, Demand Operation	S	S	S	S	S	S
Water Pump Controller—On/Off Switches at Galley, Lavy & Optional Exterior Wash Unit		S	S	S	S	
Water Pump Controller—On/Off Switches at Galley, Lavy & Exterior Utility Compartment						S
Water Tank Drain	S	S	S	S	S	S
City Water Hook-Up	S	S	S	S	S	
Holding Tank Heater—12V, On/Off Switch, Thermostatically Controlled	0	0	0	0	0	
Holding Tank Compartment—Forced Air Heated						S
Sewer Hose Compartment—Located Near Holding Tank Dump Valves	S	S	S	S	S	
Sewer Hose Storage—In Utility Compartment w/Holding Tank Valves						S
<b>Safety</b>						
3-Point Seat Belts—Driver and Passenger Front Seats	S	S	S	S	S	S
Driver/Passenger Airbag Supplemental Restraint System (Ford Only)		S	S	S	S	S
Lap Belts—At Selected Living Area Seating Positions	S	S	S	S	S	S
Smoke/Detector/Alarm	S	S	S	S	S	S
Carbon Monoxide Detector/Alarm	S	S	S	S	S	S
Fire Extinguisher—10 BC	S	S	S	S	S	S
GFI Circuit Protection—Galley, Lavy, Patio Receptacles	S	S	S	S	S	S
Entry Assist Handle	S	S	S	S	S	S
<b>Slide-Out</b>						
Living Room—Wardrobe/Sofa w/Debris Awning		S				
Living Room—Dinette/Sofa w/Debris Awning						S

# Model 22C

- Dinette
- Roomy Cabover Bed
- Sofa Bed
- Pantry
- Large Wardrobe
- Fully Enclosed Bathroom

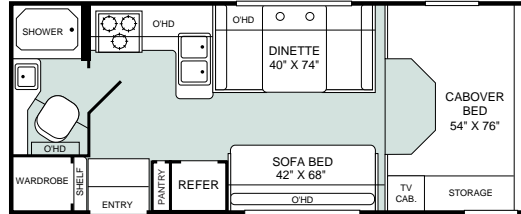

# Model 23E

- Sofa Bed
- Roomy Cabover Bed
- Dinette
- Rear Kitchen
- Large Wardrobe
- Fully Enclosed Bathroom

NEW!

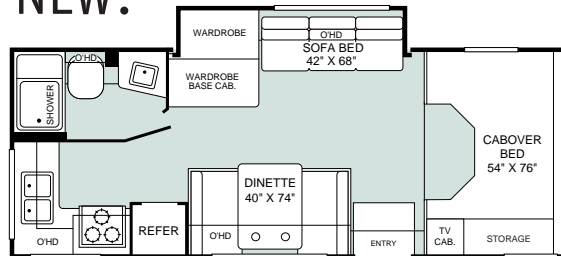

# Model 24D

- Dinette
- Roomy Cabover Bed
- Lounge Chair
- Double Bed or Optional Bunk Beds
- Fully Enclosed Bathroom

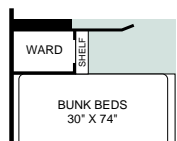
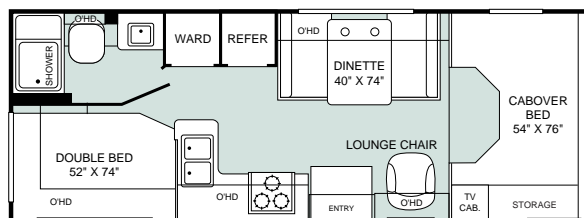

# Model 26Q

- Dinette
- Roomy Cabover Bed
- Lounge Chair
- Queen Bed
- Plenty of Wardrobe Storage
- Fully Enclosed Bathroom

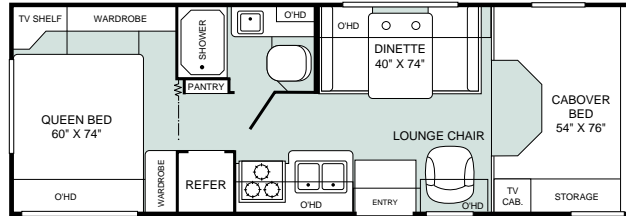

# Model 29V

- Sofa Bed and Dinette
- Roomy Cabover Bed
- Split Bathroom
- Choice of 3 Bedroom Configurations

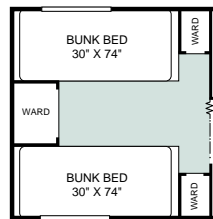

OPT. 863

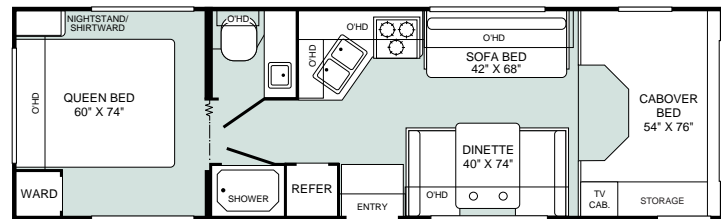

OPT. 835

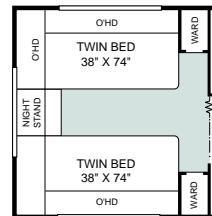

# Model SL 31W

- Dinette
- Sofa Bed
- Roomy Cabover Bed
- Split Bathroom
- Queen Bed or Optional Twin Beds

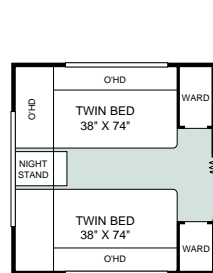

OPT. 835

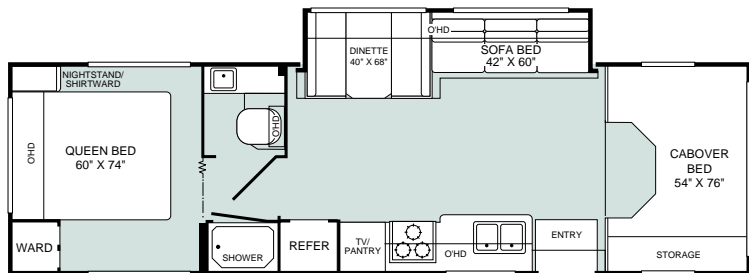



Why would you buy anything else?

**FLEETWOOD® RV**

For every road you travel, Fleetwood has the RV to fit your high standards and lifestyle. We build the recreational vehicles America wants, accounting for nearly one out of every three RVs on the road today. How do we do it? We call it the **Fleetwood Equation**.

# Size + Service + Quality = Value!

## Size *The world's #1 RV manufacturer*

For over a half-century Fleetwood has grown to become the largest manufacturer of recreational vehicles in the world. And stands today as the only RV manufacturer in the **Fortune 500**. You won't find our nearest competitor in even the top 1,000. Fleetwood remains, year after year, the largest, most influential, innovative and recognized leader in the RV industry.

## Service *Listening to our customers*

With over 1,100 service dealers in the US and Canada, Fleetwood has the largest network in the RV industry. No other RV company comes close in equaling this vital customer support system. Fleetwood RV service dealers have instant, real-time electronic access to your service records as well as parts inventory and warranty repair authorization inquiries. We also provide a 24-hour customer call center for service and product information so no matter where you travel in North America, professional support and fast answers are always nearby. Call toll free 24 hours a day: **1-800-322-8216**.



## Quality *Using only the best materials*

At Fleetwood, quality begins at the design stage so every coach is built right, right from the start. Subsequent

to design approval, full-functioning prototypes are built, then punished on a test track and subjected to accelerated life cycle tests where a few weeks can equal years of normal use. At the same time, components and systems are test-cycled thousands of times assuring years of problem-free use.

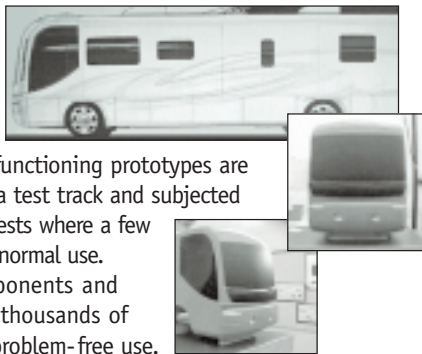

Once approved for production, each unit is built by skilled technicians using quality materials and components, many of which are sourced through, or manufactured by, our subsidiary companies such as Gold Shield Fiberglass and Continental Lumber Products.



Fleetwood engineers specify the very best products and appliances from companies such as Coleman®, Dometic®, Flexsteel®, Ford®, Freightliner®, Magic Chef®, Panasonic®, and Workhorse®. Companies that are experts in their respective fields and play a significant role as partners, not just suppliers.

All this assures that every Fleetwood RV has the fit, finish and details required by our high standards—as well as yours.

## Value *Priced right with style*

At Fleetwood RV, we look at value as the sum of everything we offer.

- **Value** is our design, engineering expertise, and innovative manufacturing methods.
- **Value** is structures and components that are the best in the industry, that meet or exceed government and industry safety standards.
- **Value** is Ownercare — a one-year/three-year warranty with coverage from a company that will be around in the future to service your needs. Ownercare is one of the RV industry's most comprehensive programs and includes systems and applications, construction, no deductible and no service charge. And it is fully transferable for the first 12 months. See your nearest Fleetwood dealer for a full explanation of benefits and restrictions.
- **Value** is customer satisfaction. When asked, more experienced RV owners would recommend Fleetwood to a friend than any other brand. Fleetwood RVs consistently hold their value better than most RVs at trade-in time.



**Value is peace of mind.**

**SSQV**—Size, Service, Quality, and Value. Together they equate to the very best RV you can buy, and the reason you should purchase a Fleetwood over any other brand.

**Require these features when you purchase your next RV... Fleetwood does!**

*See you on the road!*

## Limited One-Year/Three-Year Warranty

For Motor Homes Manufactured by subsidiaries of Fleetwood Enterprises, Inc., sold in the United States and Canada

### Coverage Provided

Your new motor home, including the structure, plumbing, heating, electrical systems, all appliances and equipment installed by the manufacturer, is warranted under normal use to be free from manufacturing defects in material or workmanship. Appearance imperfections or damage to paint, graphics, exterior materials, or upholstery that may have occurred prior to delivery are normally corrected during the inspection process at the manufacturing plant or at the dealership.

The warranty extends to the first retail purchaser and his transferee(s) and begins on the date of original retail delivery or the date the motor home is first placed into service as a rental, commercial or demonstrator unit (whichever occurs first). The warranty extends for the following periods:

1. For all defects (other than structural) the warranty extends for a period of one year from such date or until the unit has received 15,000 total miles of use as determined by the mileage shown on the odometer (whichever occurs first).
2. For structural defects, 3 years; structural defects are limited to the following: roof structure, sub-floor structure, exterior walls, interior walls and ceilings.

Written notice of defects must be given to the selling dealer or manufacturer not later than ten (10) days after the expiration of the warranty period.

### Owner's Obligation

The owner is responsible for normal maintenance as described in the Owner's Information Package; however, minor adjustments (such as cabinet latches, TV antenna control, etc.) will be performed by the dealer during the first 90 days of warranty coverage. Thereafter, such adjustments are the responsibility of the owner as normal maintenance unless required as a direct result of repair or replacement of a defective part under this warranty.

If a problem occurs which the owner believes is covered by this warranty, the owner shall contact the selling dealer, or the Fleetwood Service Center, giving sufficient information to resolve the matter. The owner shall deliver the motor home to the dealer or the Fleetwood Service Center location for warranty service.

**FLEETWOOD RV**

The World's #1 RV Manufacturer

Fleetwood Enterprises, Inc. • RV Marketing • P.O. Box 7638 • Riverside, CA 92513-7638

Your local Fleetwood RV dealer is:

### Dealer's Obligation

By agreement with the manufacturer, the dealer is obligated to maintain the motor home prior to retail sale, to perform a detailed pre-delivery inspection and to repair or replace any parts necessary to correct defects in material or workmanship.

### When the Dealer Does Not Resolve the Problem

If the dealer is unable or unwilling to resolve a problem which the owner is convinced is covered by the warranty, the owner should contact the Fleetwood Service Center at the address listed below and provide the Fleetwood Service Center with a description in writing of the problem and attempts made to resolve it.

### Manufacturer's Obligations

Upon receipt of notice of a claim, where the dealer was unable or unwilling to resolve the problem the Fleetwood Service Center will repair or replace any parts necessary to correct defects in material or workmanship or will take other appropriate action as may be required.

### What is Not Covered By This Warranty

This warranty does not cover:

1. The automotive chassis system (including the chassis and drive train), tires and batteries, which are covered by the separate warranties of the respective manufacturers of these components.
2. Defects caused by or related to:
  - a. Abuse, misuse, negligence or accident;
  - b. Failure to comply with instructions contained in the Owner's Information Package;
  - c. Alteration or modification of the motor home;
  - d. Environmental conditions (salt, hail, chemicals in the atmosphere, etc.)
3. Normal deterioration due to wear or exposure, such as fading of fabrics or drapes, carpet wear, etc.
4. Normal maintenance and service items, such as light bulbs, fuses, wiper blades, lubricants, etc.
5. Motor homes on which the odometer reading has been altered.
6. Transportation to and from dealer or Fleetwood Service Center location, loss of time, inconvenience, commercial loss, loss of use, towing charges, bus fares, vehicle rental, incidental charges such as telephone calls, or hotel bills, or other incidental or consequential damages.

Some states do not allow the exclusion of limitation of incidental or consequential damages, so the above limitation exclusion may not apply to you.

This warranty gives you specific legal rights, and you may also have other rights, which vary from state to state.

The manufacturer is not responsible for any undertaking, representation or warranty made by any dealer or other person beyond those expressly set forth in this warranty.

### [www.fleetwoodrv.com](http://www.fleetwoodrv.com)

Visit our website to find a dealer near you or learn more about other Fleetwood products. Or call 1-800-444-4905.

FOR CUSTOMER ASSISTANCE, call toll free 24 hours a day at 1-800-322-8216, visit our website, or you may write to Fleetwood Enterprises, Inc., P.O. Box 7638, Riverside, CA 92513-7638.

**IMPORTANT—PLEASE READ:** Product information, photography and illustrations included in this publication were as accurate as possible at the time of printing. For further product information and changes, please visit our website at [www.fleetwoodrv.com](http://www.fleetwoodrv.com) or contact your local Fleetwood dealer. Prices, materials, design and specifications are subject to change without notice. All weights, fuel, liquid capacities and dimensions are approximate. Fleetwood has designed its recreational vehicles to provide a variety of uses for its customers. Each vehicle features optimal seating, sleeping, storage and fluid capacities. The user is responsible for selecting the proper combination of loads (i.e. occupants, equipment, fluids, cargo, etc.) to ensure that the vehicle's capacities are not exceeded.