

**2011**

**Includes  
Micro-Lites &  
Ultra-Lites**

***Nomad***<sup>®</sup>

**Complete Line of  
Travel Trailers and Fifth Wheels**



Your local ***Nomad*** dealer is:

**SKYLINE**<sup>®</sup>

BRINGING AMERICA HOME. BRINGING AMERICA FUN.

Effective May 2010

# Dare to Compare

	<b><u>SKYLINE</u></b> <sup>®</sup>	<b><u>Other Brand</u></b>
3-2-1 Warranty	✓	_____
Individually Weighed — <i>Certified</i> — Posted on Exterior	✓	_____
Rain Tunnel Tested	✓	_____
Simulated Road Tested (Shake Simulator)	✓	_____
Stile & Rail Cabinet Construction on Upper & Lower Cabinets	✓	_____
Seamless One-Piece Roof with Manufacturer's 12 Year Limited Warranty	✓	_____
Radius Clamp-Ring Windows	✓	_____
Radius Sealed Outside Compartment Doors	✓	_____
5/8" Tongue & Groove Floor	✓	_____
Cambered Chassis	✓	_____
R7 Insulation	✓	_____
Larger-Capacity Holding Tanks	✓	_____
Upgraded Name Brand Appliances	✓	_____
59 Years in Business	✓	_____

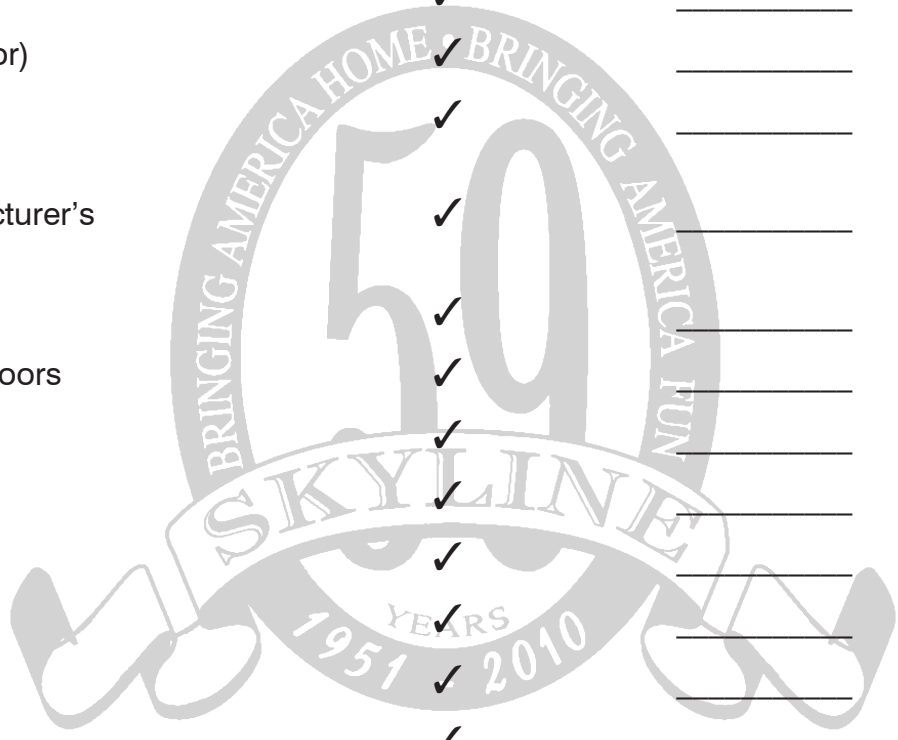

**S**ince 1951, we've been building products that measure up to the expectations of our customers. From the very beginning, we've understood that our customers come first. You're the reason we're in business and every member of the Skyline team is committed to bring you nothing less than the best.

This commitment has earned Skyline its nationwide reputation for leadership and uncompromising integrity. Our designers, engineers, and production people work as a team to build RVs that meet your needs. The best RVs at the best prices. Each backed by a straightforward one-year full warranty and a nationwide customer service program that is short on red tape and long on results.

Skyline is a solid corporate citizen having no corporate debt and a strong cash position. For our customers, this means that Skyline has the financial muscle to stand in back of its products and you can count on the fact that Skyline will be around if you ever need us.

For us at Skyline, "*Bringing America Home. Bringing America Fun.*" is more than a slogan. It is a statement of our responsibility to a country that has been good to us. It is a pledge to extend our record of leadership, to continue the long tradition of superior service, and to strengthen the trust placed in us by the customers we are privileged to serve. It is our determination to serve America and its people with quality, affordable recreational vehicles for many years to come.



## Interior

### Cabinets

- All Wood Drawers w/Travel Lock Guide System (Except in Micro-Lite Kitchen)
- High Pressure Laminate Countertops
- Durable Solid Wood-Framed Cabinet Doors w/Raised Panel Insert in Kitchen & Living Area Overhead
- Aluminum Framing on Select Cabinets (Micro-Lites Only)
- Removable Plastic Drawers w/Door (Micro-Lite Kitchen Only)

### Decor

- Color-Coordinated Designer Interiors
- Box Valance on All Living Area Windows
- Mini Blinds
- Embossed Vinyl Flooring
- Sofa w/Matching Arm Pillows (Per Floor Plan)
- Decorative Glass Doors in Select Overhead Cabinets

### Kitchen & Living Area

- Large Dometic® Refrigerator (Optional on Micro-Lites)
- Acrylic Kitchen Sink w/Deep 60/40 Basin (Single Bowl) on Micro-Lites)
- High Rise Kitchen Faucet
- Wedgewood® Two-Burner Range (Optional on Micro-Lites)
- Lighted Range Hood w/Fan
- Park Cable for TV Hookup
- Six Gallon Fast-Recovery Gas Water Heater
- 120 V to 12 V Power Convertor (55 amps on Ultra-Lites; 35 amps on Micro-Lites)

### Bedroom / Bath

- TV Hookup (Where Applicable)
- Color-Coordinated Quilted Bedspread
- Inner Spring Mattress
- Power Bath Exhaust Fan
- Medicine Cabinet w/Mirror
- Towel Ring
- Bath Skylight Over Tub /Shower (Optional on Micro-Lites)
- ABS Tub/Shower

## Exterior

### Roof Construction

- Tapered Trusses on 16" Centers to Promote Water Runoff
- Seamless One-Piece Roof w/Manufacturer's 12-Year Limited Warranty
- Wide Rain Gutter Rails w/Extra Long Drip Spouts
- R-7 Insulation

### Wall Construction

- Fiberglass Exterior w/Custom Styled Exterior Graphics
- Welded Aluminum Frame Sidewalls & Endwalls
- Laminated Sidewall Construction w/Block Foam Insulation, Steel Cabinet Backers, Luan Exterior Panel Under Fiberglass Exterior
- Radius Tinted Slider Clamp-Ring Windows
- Radius Entry Door w/Screen Kick Panel
- Flush-Mount Heavy Duty Exterior Trunk Doors w/Continuous Hinge
- Patio Convenience Light

### Chassis Construction

- Steel Frame I-Beam Chassis w/Steel Outriggers (Tube Frame on Micro-Lites)
- Dual Battery Rack (Travel Trailers)
- Black Rotocast Wheel Wells (Most Models)
- 10" Electric Brakes at All Wheels
- Safety Chains (Travel Trailers)
- Enclosed Underbelly Containing All Tanks (Drain Valves Not Enclosed — Ultra-Lites Only)
- Rear Bumper
- Breakaway Safety Switch

### Floor Construction

- Tightly Sealed Woven Polyethylene Underbelly
- Laminated Floor Construction w/Welded Aluminum Frame, Block Foam Insulation & Luan Plywood Decking

### Features

- LP Tanks w/Auto Changeover (Single 40 lb. Bottle on Model 195)
- Rotocast Holding Tanks w/Drain Outlet
- Under-Floor Water Tank to Maximize Interior Storage
- Exterior Hitch Light
- Exterior Assist Handle at Each Entry Door
- Exterior Patio Receptacle
- Molded Fender Skirt
- 30 amp Power Shore Line
- Detachable Power Shore Line (Optional on Micro-Lites)

## Security & Safety

- LP Gas Leak/Carbon Monoxide Detector
- Smoke Detector
- Fire Extinguisher
- Flush Door Latch w/Integral Dead Bolt Lock

## Some Popular Options

### Interior Value Package (Ultra-Lites)

- AM/FM/DVD Stereo w/USB & iPod Connections & 4 Speakers
- 6 Gallon Gas/DSI Water Heater
- Monitor Panel
- Microwave Oven w/Carousel
- Large Double Door Refrigerator
- Bath Tub/Shower Surround
- Shower Curtain Valance
- Deluxe Medicine Cabinet
- Deluxe Headboard
- Upgrade Window Treatment

### Exterior Value Package (Ultra-Lites)

- A&E® Power Side Awning
- Stabilizer Jacks (2 at Rear)
- Propane Bottle Cover (Travel Trailers)
- Spare Tire w/Carrier
- Double Entry Step
- Exterior Shower
- Goodyear® Tires
- TV Antenna
- Exterior Speakers
- Black Tank Flush
- Front Power Jacks (Fifth Wheels Only)

### Interior Value Package (Micro-Lites)

- Large Single Door Refrigerator
- Two Burner Cooktop
- Microwave Oven
- AM/FM/DVD Stereo w/USB & iPod Connections & 4 Speakers
- Wallpaper Border in Living Area
- One-Piece Tub Surround
- Night Shades
- Night Lights (2)
- Skylight in Bath
- Lambrequin Legs on All Windows
- Water Heater Bypass
- Monitor Panel

### Exterior Value Package (Micro-Lites)

- 9,200 Btu Air Conditioner
- A&E® Sunchaser Side Awning
- TV Antenna
- Propane Bottle Cover
- Super-Lube Axles
- Detachable Power Shore Line
- Outside Speakers
- Goodyear® Tires

### Camper Convenience Package (Micro-Lites)

- Lock Box
- Key Holder & Coat Hooks
- Rechargeable Flashlight
- Rechargeable Hand Vacuum
- Termination & Hitch Light
- Outside Quick Disconnect Propane Hookup

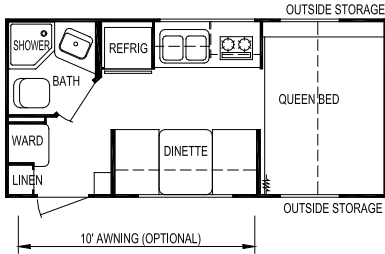

Model 189

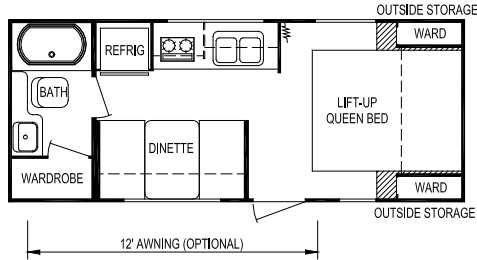

Model 194

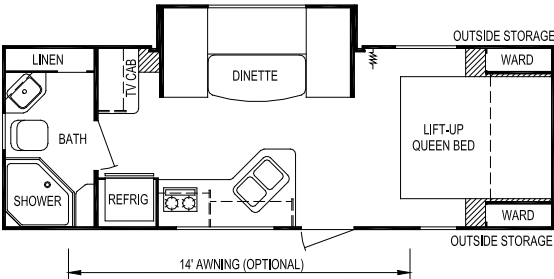

Model 206

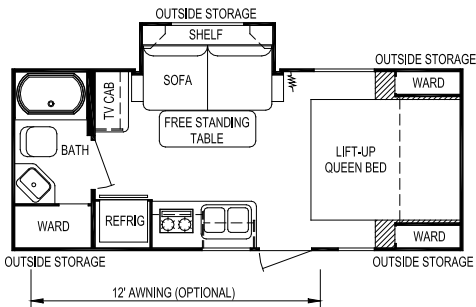

Model 210

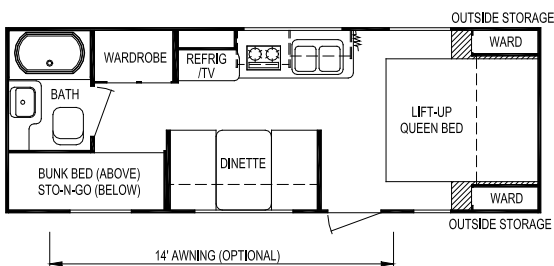

Model 248

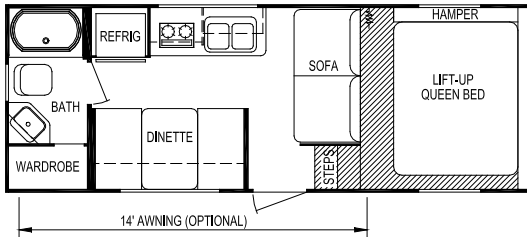

Model 195

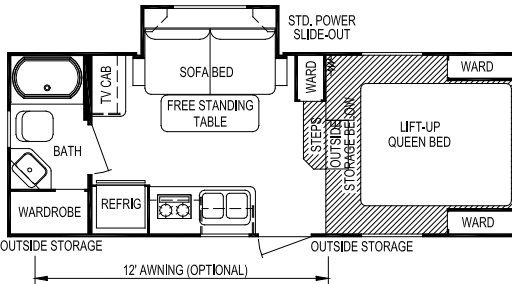

Model 212

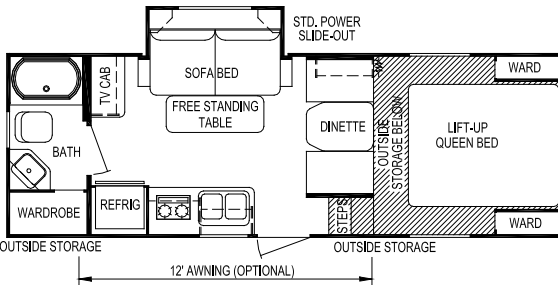

Model 213

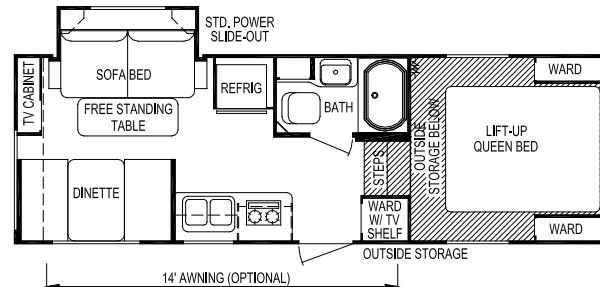

Model 214

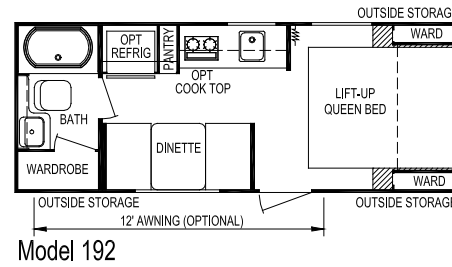
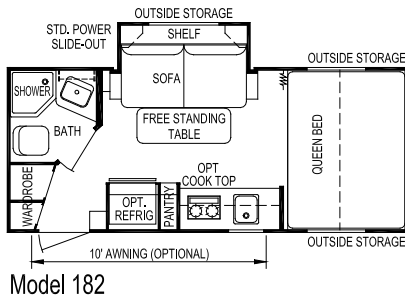

## Specifications

## 2011 Ultra-Lites & Micro-Lites

Model	Ultra-Lite Travel Trailers					Ultra-Lite Fifth Wheels				Micro-Lite Travel Trailers	
	189	194	206	210	248	195	212	213	214	182	192
<b>Weights</b>											
<b>Unloaded Vehicle Weight (see Note 2)</b>	3,000	3,375	4,100	3,625	3,700	3,775	4,650	4,850	4,475	2,950	2,775
<b>Dry Hitch Weight</b>	275	400	450	450	425	725	1,050	1,150	1,050	325	300
<b>Dry Axle Weight</b>	2,725	2,975	3,650	3,175	3,275	3,050	3,600	3,700	3,425	2,625	2,475
<b>GVWR (Total Capacity of Trailer)</b>	4,950	4,950	5,940	5,940	5,940	6,700	6,700	6,700	6,700	4,300	4,300
<b>Carrying Capacity (see Note 2)</b>	1,825	1,425	1,675	2,150	2,100	2,750	1,875	1,600	2,050	1,300	1,400
<b>Accommodations</b>											
<b>Sleeping (standard / optional)</b>	3	4	4	4	6	6	4	5	6	4	3
<b>Bed Size (standard)</b>	60" x 80"	60" x 74"	60" x 74"	60" x 74"	60" x 74"	60" x 74"	60" x 74"	60" x 74"	60" x 74"	60" x 80"	60" x 74"
<b>Second Bed Size</b>	N/A	N/A	N/A	N/A	N/A	N/A	N/A	N/A	N/A	N/A	N/A
<b>Dinette Size</b>	33" x 70"	39" x 70"	44" x 92"	N/A	39" x 70"	39" x 70"	N/A	33" x 66"	39" x 70"	N/A	33" x 70"
<b>Sofa</b>	N/A	N/A	N/A	42" x 64"	N/A	42" x 64"	42" x 64"	42" x 64"	42" x 64"	42" x 64"	N/A
<b>Measurements</b>											
<b>Exterior Length (see Note 3)</b>	19'-10"	22'-7"	26'-4"	22'-5"	25'-6"	21'-8"	21'-5"	23'-5"	24'-2"	20'-10"	22'-2"
<b>Exterior Width (see Note 3)</b>	90"	90"	90"	90"	90"	90"	90"	90"	90"	84"	84"
<b>Exterior Height (see Note 3)</b>	9'-11"	9'-11"	9'-11"	9'-11"	9'-11"	10'-1"	10'-1"	10'-1"	10'-1"	9'-2"	9'-2"
<b>Interior Height</b>	76"	76"	76"	76"	76"	76"	76"	76"	76"	76"	76"
<b>Capacities</b>											
<b>Fresh Water System (gallons)</b>	32	32	32	32	32	32	32	32	32	32	32
<b>Gray Water Tank (gallons)</b>	24	24	24	24	24	24	24	24	24	24	24
<b>Black Water Tank (gallons)</b>	24	24	24	24	24	24	24	24	24	24	24
<b>Air Conditioner Size (optional)</b>	13,500	13,500	13,500	13,500	13,500	13,500	13,500	13,500	13,500	9,200	9,200
<b>Awning Size (optional)</b>	10'	12'	14'	12'	14'	14'	12'	12'	14'	10'	12'
<b>Convertor Size (amps)</b>	55	55	55	55	55	55	55	55	55	35	35
<b>Furnace Rating (Btu)</b>	18,000	18,000	25,000	18,000	18,000	18,000	18,000	18,000	18,000	18,000	18,000
<b>Propane Gas Capacity (pounds)</b>	40	40	40	40	40	40	40	40	40	40	40
<b>Tires (see Note 4)</b>	205/ 75R14-C	205/ 75R14-C	205/ 75R14-C	205/ 75R14-C	205/ 75R14-C	205/ 75R14-C	205/ 75R14-C	205/ 75R14-C	205/ 75R14-C	185/ 80R13-C	185/ 80R13-C
<b>Water Heater (gallons)</b>	6	6	6	6	6	6	6	6	6	6	6

**Notes**

- (1) All weights, dimensions, and capacities shown are approximate values.
- (2) Unloaded vehicle weight and carrying capacity will vary depending upon optional equipment. Full propane tanks are factored into carrying capacity. Skyline weighs every unit at the factory. See trailer weight information label located inside the front entry door for specific unloaded vehicle weight and cargo carrying capacity.
- (3) Dimensions stated to industry standards. Exterior length includes approximately a four foot hitch on travel trailers. Exterior height includes air conditioner, if installed. Exterior width does not include the width of the fenders and tires, which may extend up to 5" on each side of the body.
- (4) Goodyear® Marathon ST Radial tires are a mandatory option.

## Interior

### Cabinets

- All Wood Drawers w/Steel Side Roller Guides
- High Pressure Laminate Countertops
- Durable Solid Wood Framed Cabinet Doors w/Raised Panel Insert in Kitchen & Living Area Overhead

### Decor

- Color-Coordinated Designer Interiors
- Color-Coordinated Wall Border
- Deluxe Box Valance on All Living Area Windows
- Mini Blinds
- Embossed Vinyl Flooring
- Sofa w/Matching Arm Pillows
- Decorative Glass Doors in Select Overhead Cabinets

### Kitchen & Living Area

- Large Dometic® Refrigerator
- Raised Panel Refrigerator Door Insert
- Dinette Table w/Folding Legs for Use Inside or Out
- Acrylic Kitchen Sink w/Deep 60/40 Basin
- High Rise Kitchen Faucet
- Wedgewood® Three-Burner Range
- Lighted Range Hood w/Fan
- Park Cable for TV Hookup
- Six Gallon Fast-Recovery Gas Water Heater
- 120 V to 12 V Power Convertor (55 amps)
- System Monitor Panel (Fresh Water, Battery & Holding Tank Levels w/Water Heater Switches)

### Bedroom / Bath

- TV Hookup (Where Applicable)
- Color-Coordinated Headboard & Quilted Bedspread

- Evergreen® Mattress
- Power Bath Exhaust Fan
- Medicine Cabinet w/Mirror
- Towel Ring
- Bath Skylight Over Tub / Shower
- ABS Tub/Shower

## Exterior

### Roof Construction

- Tapered Trusses on 16" Centers to Promote Water Runoff
- Seamless One-Piece Roof w/Manufacturer's 12-Year Limited Warranty
- Wide Rain Gutter Rails w/Extra Long Drip Spouts
- R-7 Insulation

### Wall Construction

- Fiberglass Exterior w/Custom Styled Exterior Graphics
- Welded Aluminum Frame Sidewalls & Endwalls
- Laminated Sidewall Construction w/Block Foam Insulation, Steel Cabinet Backers, Lauan Exterior Panel Under Fiberglass Exterior
- Radius Tinted Slider Clamp-Ring Windows
- Radius Entry Door w/Screen Kick Panel
- Flush-Mount Heavy Duty Exterior Trunk Doors w/Continuous Hinge
- Patio Convenience Light w/Amber Lens

### Chassis Construction

- Steel Frame I-Beam Chassis w/Steel Outriggers
- Dual Battery Rack
- Black Rotocast Wheel Wells (Most Models)
- 10" Electric Brakes at All Wheels (Models 2020B, 2220B, 2601B, 2640B & 2961B)

- 12" Electric Brakes at All Wheels (Model 2970B)
- Safety Chains & Breakaway Safety Switch
- Enclosed Underbelly Containing All Tanks (Drain Valves Not Enclosed)
- Rear Bumper w/Sewer Hose Carrier

### Floor Construction

- 2 x 3 Floor Framing w/R-7 Insulation
- Tightly Sealed Woven Polyethylene Underbelly
- Floor-Ducted Heating to Increase Storage in Lower Cabinets
- 5/8" Tongue & Groove Floor Decking

### Features

- Two 30 lb. LP Tanks w/Auto Changeover
- Rotocast Holding Tanks w/Drain Outlet
- Under-Floor Water Tank to Maximize Interior Storage
- Water Heater Bypass
- Exterior Hitch Light
- Exterior Assist Handle at Each Entry Door
- Exterior Patio Receptacle
- Molded Fender Skirt
- 30 amp Power Shore Line
- Decorative 12 Volt Light Above Dinette (In Slide-Out Room Only)
- Decorative 12 Volt Wall Light(s) at Sofa (In Slide-Out Room Only)

### Security & Safety

- LP Gas Leak/Carbon Monoxide Detector
- Smoke Detector
- Fire Extinguisher
- Flush Door Latch w/Integral Dead Bolt Lock

## Some Popular Options

- Outside Grill (Most Models)
- Aluminum Wheels
- LCD TV
- Fireplace (2970B Only)

### Interior Value Package

- Large Double Door Refrigerator
- Deluxe Refrigerator Insert
- 3-Burner Range w/17" Oven & Piezo
- Microwave Oven w/Carousel
- AM/FM/DVD Stereo w/USB & iPod Connections & 4 Inside Speakers
- Oval Wall Mirror
- Bath Tub/Shower Surround
- Molded Sink Cover
- 6 Gallon Gas/DSI Water Heater
- Day/Night Shades
- Box Valances w/Lambrequin in Bedroom

### Exterior Value Package

- Stabilizer Jacks
- Spare Tire w/Carrier
- Propane Bottle Cover
- 13.5 MBtu Ducted Air Conditioner w/Wall Thermostat
- 12 V Power A&E® Side Awning
- TV Antenna
- Exterior Shower
- Goodyear® Tires
- Chrome Wheels
- Door Side Scare Light
- Black Tank Flush
- Exterior Speakers

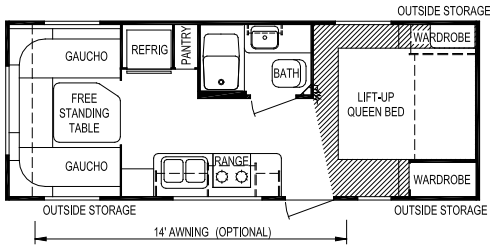

Model 2020B

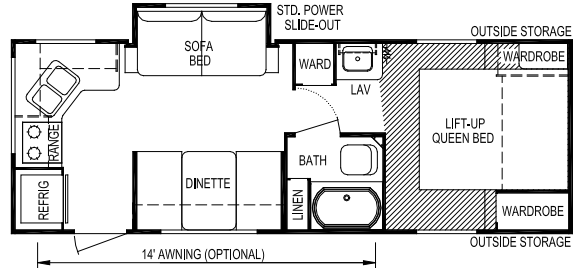

Model 2640B

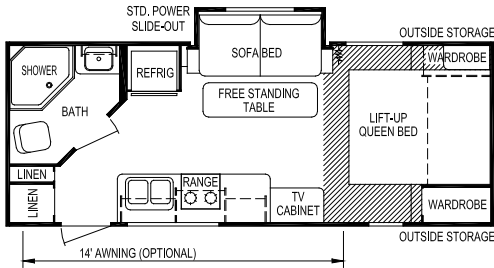

Model 2220B

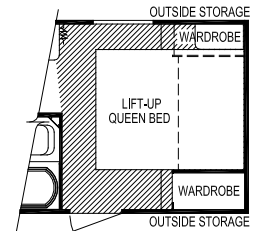

Option Front Entry (Model 2640B)

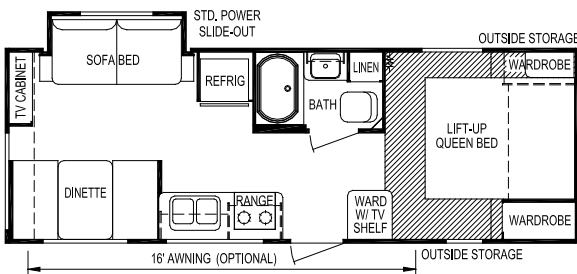

Model 2450B

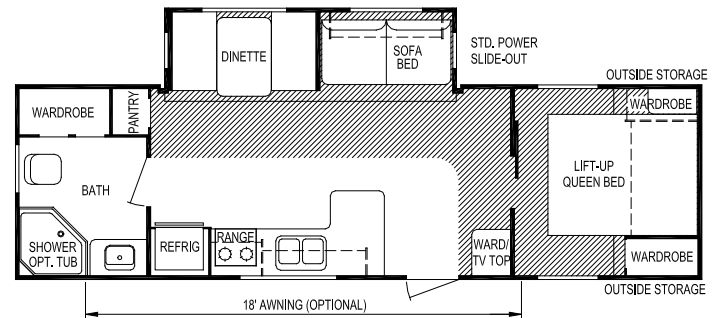

Model 2961B

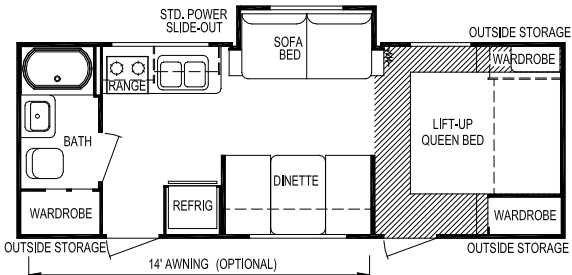

Model 2570B

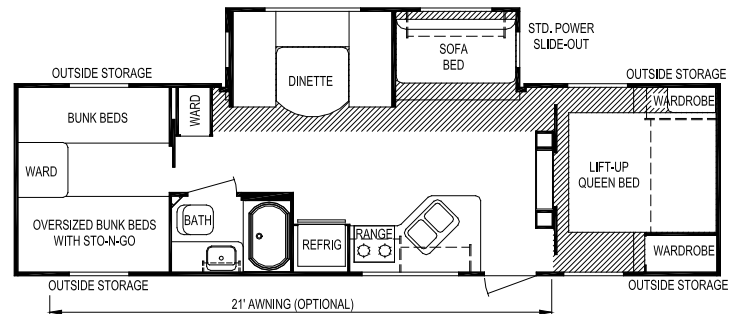

Model 2970B

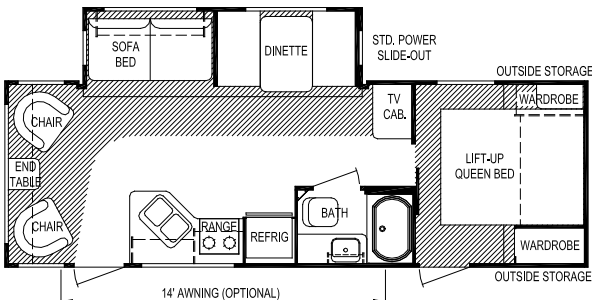

Model 2601B



# Specifications **2011 Aluma-Bond**

<b>Model</b>	<b>2020B</b>	<b>2220B</b>	<b>2450B</b>	<b>2570B</b>	<b>2601B</b>	<b>2640B</b>	<b>2961B</b>	<b>2970B</b>
<b>Weights Unloaded Vehicle Weight (see Note 2)</b>	4,125	4,100	4,325	4,150	5,175	4,200	5,725	6,300
<b>Dry Hitch Weight</b>	600	450	625	500	575	625	625	900
<b>Dry Axle Weight</b>	3,525	3,650	3,700	3,650	4,600	3,575	5,100	5,400
<b>GVWR (Total Capacity of Trailer)</b>	6,200	7,750	7,750	6,200	7,750	7,750	7,750	8,800
<b>Carrying Capacity (see Note 2)</b>	1,900	3,450	3,225	1,850	2,350	3,350	1,800	2,250
<b>Accommodations Sleeping (standard / optional)</b>	4	4	6	6	6	6	6	10
<b>Bed Size (standard)</b>	60" x 74"	60" x 74"	60" x 74"	60" x 74"	60" x 74"	60" x 74"	60" x 74"	60" x 74"
<b>Second Bed Size</b>	N/A	N/A	N/A	N/A	N/A	N/A	N/A	(2) 28" x 74" (2) 38" x 74"
<b>Dinette Size</b>	60" x 90"	N/A	39" x 70"	39" x 70"	39" x 70"	39" x 70"	39" x 70"	48" x 79"
<b>Sofa</b>	N/A	42" x 64"	42" x 64"	42" x 64"	42" x 64"	42" x 64"	42" x 64"	41" x 70"
<b>Measurements Exterior Length (see Note 3)</b>	24'-10"	24'-10"	27'-2"	26'-0"	28'-8"	27'-0"	31'-10"	33'-1"
<b>Exterior Width (see Note 3)</b>	96"	96"	96"	96"	96"	96"	96"	96"
<b>Exterior Height (see Note 3)</b>	9'-11"	10'-1"	10'-1"	9'-11"	10'-4"	10'-1"	10'-4"	10'-4"
<b>Interior Height</b>	76"	76"	76"	76"	76"	76"	76"	76"
<b>Capacities Fresh Water System (gallons)</b>	46	46	46	46	46	46	46	46
<b>Gray Water Tank (gallons)</b>	31	31	31	31	40	62	40	40
<b>Black Water Tank (gallons)</b>	31	31	40	31	40	31	40	40
<b>Air Conditioner Size (optional)</b>	13,500	13,500	13,500	13,500	13,500	13,500	13,500	13,500
<b>Awning Size (optional)</b>	14'	14'	16'	14'	14'	14'	18'	21'
<b>Convertor Size (amps)</b>	55	55	55	55	55	55	55	55
<b>Furnace Rating (Btu)</b>	25,000	25,000	25,000	25,000	25,000	25,000	25,000	25,000
<b>Propane Gas Capacity (pounds)</b>	60	60	60	60	60	60	60	60
<b>Tires (see Note 4)</b>	205/75R14-C 205/75R14-C 205/75R14-C 205/75R14-C 205/75R15-C 205/75R14-C 205/75R15-C 225/75R15-D							
<b>Water Heater (gallons)</b>	6	6	6	6	6	6	6	6

## Notes

(1) All weights, dimensions, and capacities shown are approximate values.

(2) Unloaded vehicle weight and carrying capacity will vary depending upon optional equipment. Full propane tanks are factored into carrying capacity. Skyline weighs every unit at the factory. See trailer weight information label located inside the front entry door for specific unloaded vehicle weight and cargo carrying capacity.

(3) Dimensions stated to industry standards. Exterior length includes approximately a four foot hitch on travel trailers. Exterior height includes air conditioner, if installed. Exterior width does not include the width of the awning, if installed.

(4) Goodyear® radial tires are a mandatory option.

## Interior

### Cabinets

- Light & Dark Woodgrain Cabinets
- Drawers w/Travel-Lock Glide System

### Decor

- Color-Coordinated Designer Interior
- Mini-Blinds for All Windows (Except over Bunks)
- Embossed Vinyl Flooring
- Extra Padded Dinette & Sofa Seat Cushions
- Decorative Glass Doors in Select Overhead Cabinets

### Kitchen & Living Area

- Large Dometic® Double-Door Refrigerator
- Wedgewood® Three-Burner Range w/Oven
- Power Range Hood w/Light
- 25,000 Btu Furnace (18,000 Btu on Models 193 & 224)
- 120 V to 12 V Power Convertor
- Microwave Recept & Shelf
- Living Room TV Jack
- Acrylic Kitchen Sink
- Six Gal. Fast Recovery Gas Water Heater

### Bedroom

- Color-Coordinated Quilted Bedspread (Most Models)

- Lift-up Bed Storage (Most Models)
- Evergreen® Mattress

### Bath

- ABS Tub (Shower on Model 224)
- Medicine Cabinet w/Mirror
- Towel Ring
- Wall Switch for Light

## Exterior

### Roof Construction

- Tapered Roof Construction to Promote Water Runoff
- Seamless One-Piece Roof w/12 Year Manufacturer's Limited Warranty
- Pre-Wired & Framed for Roof Air Conditioner
- Awning Drip Rail w/Extra Long Drip Spouts

### Wall Construction

- Double Wrapped & Sealed Corners
- Wall Studs on 16" Centers (*Maximum*)
- Steel-Strap Reinforcement on Walls for Superior Durability
- R-7 Settle-Resistant Insulation
- Twist Locks on All Storage Doors
- Radius Clamp-Ring Windows
- Patio Convenience Light

- Entry Screen Door
- Entry Door Assist Handle

### Chassis Construction

- Cambered Steel Frame Chassis w/Steel Outriggers
- Black Rotocast Wheel Wells (Most Models)
- Battery Rack
- Electric Brakes at All Wheels
- Safety Chains & Breakaway Safety Switch

### Floor Construction

- 5/8" Tongue & Groove Floor Decking
- Tightly Sealed Woven Polyethylene Underbelly

### Features

- Two 30 lb. Propane Tanks w/Changeover
- Holding Tanks w/Drain Outlet
- Rear Bumper w/Sewer Hose Carrier

## Security & Safety

- LP Gas Leak Detector
- Smoke Detector
- Carbon Monoxide Detector
- Fire Extinguisher
- Flush Door Latch w/Integral Dead Bolt Lock

## Some Popular Options ---

### Exterior Value Package

- Stabilizer Jacks
- Goodyear® Tires
- Color-Coordinated A&E® Side Awning
- Outside Shower
- Spare Tire Kit
- TV Antenna
- TV Park Cable Hookup
- Hitch Light
- Black Tank Flush
- Exterior Speakers

### Interior Value Package

- 13,500 Btu Dometic® Air Conditioner
- AM/FM/DVD Stereo w/USB & iPod Connections
- TV Jack in Bedroom
- Microwave
- Wall Border in Living Room & Kitchen
- Sink Cover
- Two Wall Lights in Slide-Out Room
- High-Rise Kitchen Faucet
- Range w/Oven & Piezo
- Tub / Shower Surround
- Deluxe Medicine Cabinet

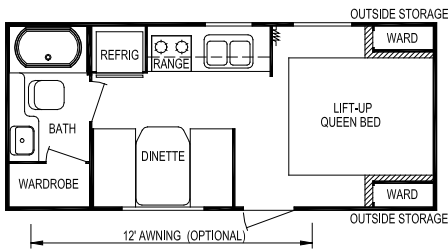

Model 193LT

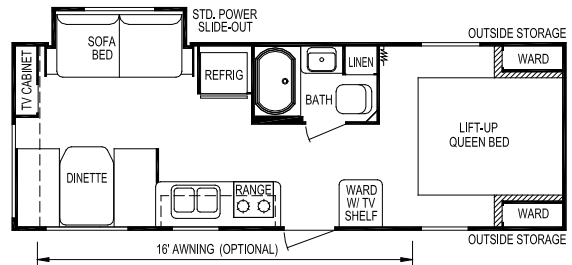

Model 245LT

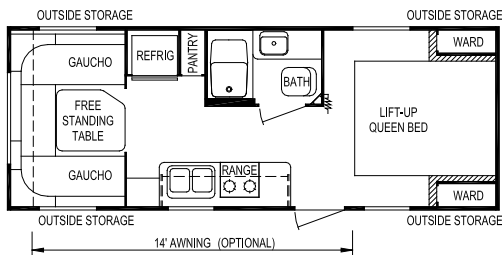

Model 200LT

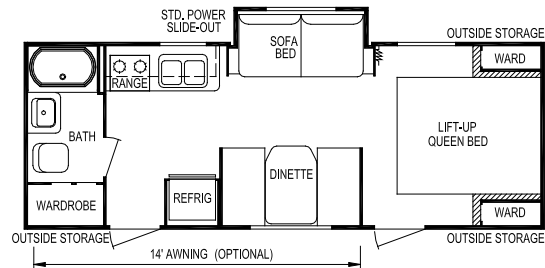

Model 257LT

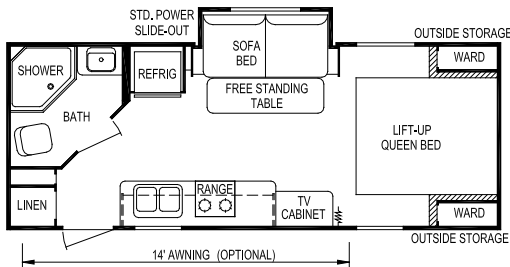

Model 224LT

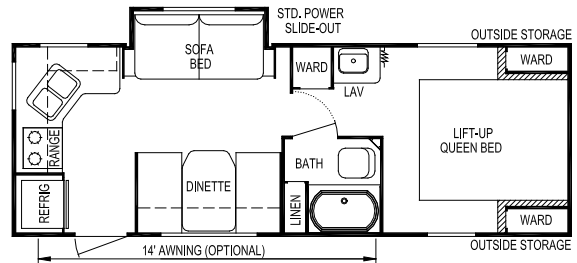

Model 261LT

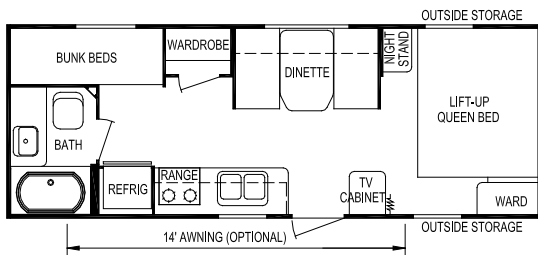

Model 227LT

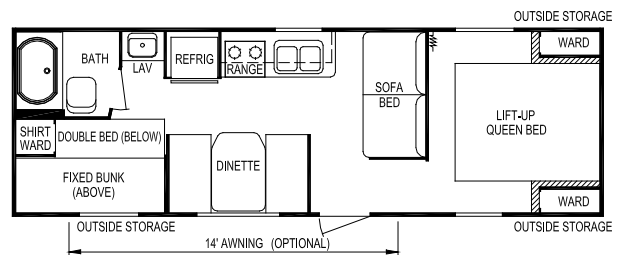

Model 263LT

<b>Model</b>	<b>193LT</b>	<b>200LT</b>	<b>224LT</b>	<b>227LT</b>	<b>245LT</b>	<b>257LT</b>	<b>261LT</b>	<b>263LT</b>
<b>Weights</b> Unloaded Vehicle Weight (see Note 2)	3,525	3,900	4,100	3,975	4,325	4,150	4,525	4,050
Dry Hitch Weight	475	550	450	500	625	500	625	500
Dry Axle Weight	3,050	3,350	3,650	3,475	3,700	3,650	3,900	3,550
GVWR (Total Capacity of Trailer)	5,600	5,600	6,200	6,200	6,200	6,200	6,200	6,200
Carrying Capacity (see Note 2)	1,900	1,525	1,900	2,050	1,675	1,850	1,475	1,950
<b>Accommodations</b> Sleeping (standard / optional)	4	4	4	6	6	6	6	8
Bed Size (standard)	60" x 74"	60" x 74"	60" x 74"	60" x 74"	60" x 74"	60" x 74"	60" x 74"	60" x 74"
Second Bed Size	N/A	N/A	N/A	(2)28"x76"	N/A	N/A	N/A	48" x 74" 28" x 76"
Dinette Size	40" x 71"	60" x 90"	N/A	40" x 71"	40" x 71"	40" x 71"	40" x 71"	40" x 71"
<b>Measurements</b> Exterior Length (see Note 3)	22'-2"	25'-3"	24'-11"	25'-11"	27'-5"	26'-1"	27'-0"	28'-11"
Exterior Width (see Note 3)	96"	96"	96"	96"	96"	96"	96"	96"
Exterior Height (see Note 3)	9'-11"	9'-11"	9'-11"	9'-11"	9'-11"	9'-11"	9'-11"	9'-11"
Interior Height	76"	76"	76"	76"	76"	76"	76"	76"
<b>Capacities</b> Fresh Water System (gallons)	54	54	54	54	54	54	54	54
Gray Water Tank (gallons)	31	31	31	31	31	31	62	31
Black Water Tank (gallons)	31	31	31	31	40	31	31	31
Awning Size (opt.)	12'	14'	14'	14'	16'	14'	14'	14'
Convertor Size (amps)	55	55	55	55	55	55	55	55
Furnace Rating (Btu)	18,000	25,000	18,000	25,000	25,000	25,000	25,000	25,000
Propane Gas Capacity (pounds)	60	60	60	60	60	60	60	60
Tires (see Note 4)	205/ 75R14-C	205/ 75R14-C	205/ 75R14-C	205/ 75R14-C	205/ 75R14-C	205/ 75R14-C	205/ 75R14-C	205/ 75R14-C
Water Heater (gallons)	6	6	6	6	6	6	6	6

**Notes**

- (1) All weights, dimensions, and capacities shown are approximate values.
- (2) Unloaded vehicle weight and carrying capacity will vary depending upon optional equipment. Full propane tanks are factored into carrying capacity. Skyline weighs every unit at the factory. See trailer weight information label located inside the front entry door for specific unloaded vehicle weight and cargo carrying capacity.
- (3) Dimensions stated to industry standards. Exterior length includes approximately a four foot hitch on travel trailers. Exterior height includes air conditioner, if installed. Exterior width does not include the width of the awning, if installed.
- (4) Goodyear® Marathon ST Radial tires are a required option — part of exterior value package.

# Standard Features --- 2011 Travel Trailers

## Interior

### Cabinets

- Light & Dark Hardwood Cabinets
- Drawers w/Travel-Lock Glide System
- Oak Frame Cabinet Doors w/ Raised Panel Insert in Kitchen & Living Area Over-Head Cabinets

### Decor

- Color-Coordinated Designer Interior
- Mini-Blinds for All Windows (Except over Bunks)
- Embossed Vinyl Flooring
- Extra Padded Dinette & Sofa Seat Cushions
- Deluxe Designer Box Valance on All Windows (Except over Bunks)
- Decorative Wall Lights at Sofa and Ceiling Light at Dinette in Super Slide-Outs
- Decorative Glass Doors in Select Overhead Cabinets

### Kitchen & Living Area

- Large Dometic® Double-Door Refrigerator
- Wedgewood® Oven w/High Output Three-Burner Range
- Power Range Hood w/Light
- 25,000 Btu Furnace
- 120 V to 12 V Power Converter
- Microwave Recept & Shelf
- Living Room TV Jack
- Acrylic Kitchen Sink
- Six Gal. Fast Recovery DSI Water Heater
- System Monitor Panel (Fresh Water, Battery & Holding Tank Levels)

### Bedroom

- Color-Coordinated Quilted Bedspread & Head Board (Most Models)
- Lift-up Bed Storage (Most Models)
- Plush Carpet per Floor Plan Shaded Area
- Roof Vent
- Evergreen® Mattress

### Bath

- ABS Tub
- Medicine Cabinet w/Mirror
- Towel Ring
- Shower Curtain Valance
- Wall Switch for Light

## Exterior

### Roof Construction

- Tapered Roof Construction to Promote Water Runoff
- Seamless One-Piece Roof w/12 Year Manufacturer's Limited Warranty
- Pre-Wired & Framed for Roof Air Conditioner
- Awning Drip Rail w/Extra Long Drip Spouts
- A/C Ducting

### Wall Construction

- Double Wrapped & Sealed Corners
- Wall Studs on 16" Centers (*Maximum*)
- Steel-Strap Reinforcement on Walls for Superior Durability
- R-7 Settle-Resistant Insulation
- Twist Locks on All Storage Doors

- Radius Clamp-Ring Windows
- Patio Convenience Light
- Radius Entry Door w/Smooth Fiberglass Exterior
- Entry Screen Door
- Entry Door Assist Handle

### Chassis Construction

- Cambered Steel Frame Chassis w/Steel Outriggers
- Black Rotocast Wheel Wells (Most Models)
- Battery Rack
- Electric Brakes at All Wheels
- Safety Chains & Breakaway Safety Switch
- Triple Entry Step

### Floor Construction

- 5/8" Tongue & Groove Floor Decking
- Tightly Sealed Woven Polyethylene Underbelly

### Features

- Two 30 lb. Propane Tanks w/Changeover
- Propane Tank Cover
- Holding Tanks w/Drain Outlet
- Rear Bumper w/Sewer Hose Carrier

### Security & Safety

- LP Gas Leak Detector
- Smoke Detector
- Carbon Monoxide Detector
- Fire Extinguisher
- Flush Door Latch w/Integral Dead Bolt Lock

## Some Popular Options ---

15,000 Btu Roof A/C

### Exterior Value Package

- Color-Coordinated A&E® Side Awning
- Outside Shower
- Spare Tire Kit
- Stabilizing Jacks (4)
- TV Antenna
- TV Park Cable Hookup
- Goodyear® Radial Tires
- Hitch Light
- Black Tank Flush
- Exterior Speakers
- Diamond Plate Lower Front Metal

### Interior Value Package

- 13,500 Btu A/C
- Microwave
- AM/FM/DVD Stereo w/USB & iPod Connections
- TV Jack in Bedroom
- Wall Border — Kitchen & Living Room
- Sink Cover
- Power Bath Vent
- Lambrequin Legs on Living Area Valances
- High Rise Kitchen Faucet
- Deluxe Wood Medicine Cabinet
- Piezo Ignition Range
- Tub Surround

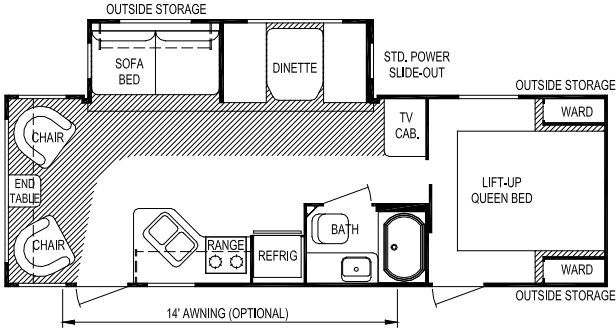

Model 265

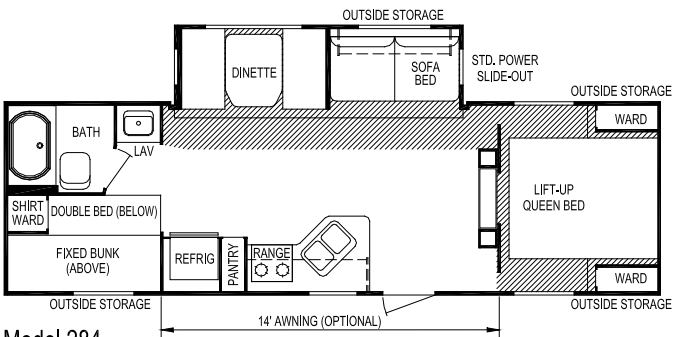

Model 284

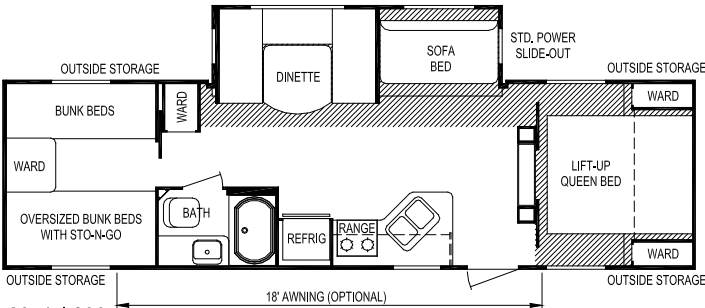

Model 290

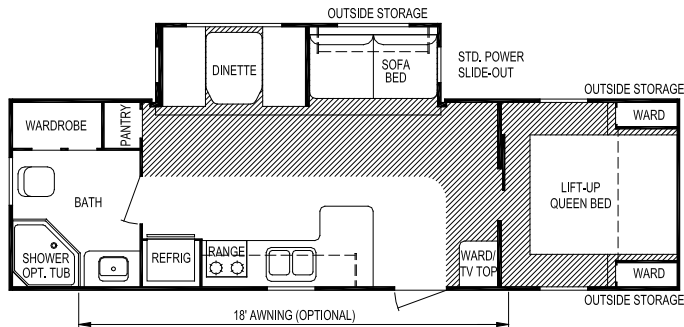

Model 299

# Specifications **2011 Travel Trailers**

<b>Model</b>	<b>265</b>	<b>284</b>	<b>290</b>	<b>299</b>
<b>Weights</b> Unloaded Vehicle Weight (see Note 2)	5,725	6,075	6,650	5,725
Dry Hitch Weight	650	800	950	625
Dry Axle Weight	5,075	5,275	5,700	5,100
GVWR (Total Capacity of Trailer)	7,750	7,750	11,200	7,750
Carrying Capacity (see Note 2)	1,800	1,425	4,300	1,800
<b>Accommodations</b> Sleeping (standard / optional)	6	9	8	6
Bed Size (standard)	60" x 74"	60" x 74"	60" x 74"	60" x 74"
Second Bed Size	N/A	48" x 74" 28" x 76"	(2) 28" x 76" (2) 38" x 74"	N/A
Dinette Size	40" x 71"	40" x 71"	48" x 79"	40" x 71"
Sofa Size	42" x 64"	42" x 64"	41" x 70"	42" x 64"
<b>Measurements</b> Exterior Length (see Note 3)	29'-0"	31'-0"	33'-3"	31'-11"
Exterior Width (see Note 3)	96"	96"	96"	96"
Exterior Height (see Note 3)	11'-0"	11'-0"	11'-0"	11'-0"
Interior Height	78"	78"	78"	78"
<b>Capacities</b> Fresh Water System (gallons)	54	54	54	54
Gray Water Tank (gallons)	40	40	40	40
Black Water Tank (gallons)	40	40	40	40
Air Conditioner Size (Btu) (optional)	13,500	13,500	13,500	13,500
Awning Size (optional)	14'	14'	18'	18'
Convertor Size (amps)	55	55	55	55
Furnace Rating (Btu)	25,000	25,000	25,000	25,000
Propane Gas Capacity (pounds)	60	60	60	60
Tires (see Note 4)	205/ 75R15-C	205/ 75R15-C	225/ 75R15-D	205/ 75R15-C
Water Heater (gallons)	6	6	6	6

## Notes

(1) All weights, dimensions, and capacities shown are approximate values.

(2) Unloaded vehicle weight and carrying capacity will vary depending upon optional equipment. Full propane tanks are factored into carrying capacity. Skyline weighs every unit at the factory. See trailer weight information label located inside the kitchen cabinet door for specific unloaded vehicle weight and carrying capacity.

(3) Dimensions stated to industry standards. Exterior length includes approximately a four foot hitch on travel trailers. Exterior height includes air conditioner, if installed. Exterior width does not include the width of the awning, if installed.

(4) Goodyear® Marathon ST Radial tires are a required option — part of exterior value package.



## Skyline Customer Satisfaction

Skyline Customer Satisfaction is more than just a promise. We believe you deserve quality in every aspect of ownership. To ensure your continued satisfaction, we're dedicated to providing you with a quality product along with the very best service available in our industry. Skyline's "Commitment of Excellence" will be a source of pride and satisfaction for you.

Contact your Skyline dealer for details.

<b>SKYLINE</b>	
<i>Commitment of Excellence</i>	
OWNER	<b>SATISFIED CUSTOMER</b>
ORIGINAL DEL. DATE	DEALER NO.
VEHICLE ID NO.	MODEL NO.
BRINGING AMERICA HOME. BRINGING AMERICA FUN.	

## NO-NONSENSE WARRANTY

Manufacturing defects reported to Skyline within one year after original retail delivery of your new Travel Trailer or Fifth Wheel by an authorized dealer will be corrected without charge and within reasonable times. Excluded are misuse (including lack of reasonable maintenance), minor imperfections, alterations, and dealer or owner improper transportation, installation, or hookup.

This warranty gives you specific legal rights. You may have other rights which vary from state to state.

*Skyline's suppliers often provide additional warranties on their components beyond the Skyline factory bumper-to-bumper warranty. For example — the range, water heater, furnace and convertor carry two-year supplier warranties while the air conditioner, refrigerator, microwave and awning carry three-year warranties. The one-piece roof carries a 12-year warranty. Ask your dealer for full details.*

**Manufacturer's Notice:** All specifications, equipment, and prices are subject to change without prior notice. Production of all models subject to seasonal scheduling. Skyline Corporation reserves the right to improve a model without incorporating these changes in similar models produced at an earlier date.

Consult your automobile dealer and your recreational vehicle dealer to assure the proper match between tow vehicle and trailer. Tow vehicle and recreational unit must be properly equalized for efficient product performance and safety. Before you purchase your recreational vehicle, carefully consider the number of people it will accommodate and its end use. Manufacturer's load capacity restrictions and recommendations must be followed for safe and efficient product performance.

Your Retailer, an independent contractor, who is not an agent of Skyline Corporation, is the party responsible for your purchase contract and any additions, deletions, alterations, or attachments made to or in your recreational vehicle.



For the name of your nearest Skyline-built RV dealer, call:  
Hemet, CA 1-888-442-0997  
Mansfield, TX 1-800-962-7773  
Elkhart, IN 1-800-736-2573

Go RVing.

Or visit us at our Web Site at [www.skylinecorp.com](http://www.skylinecorp.com)