

OUTPOST LITE BY IT



Allen Camper Manufacturing Co. is family owned and operated, and for over 50 years has been manufacturing quality, dependable trailers. It is not just a trailer, but family pride and experience that you will be pulling down the road. Buy with confidence.



AUTHORIZED DEALER:

Outpost Trailers Floor Plans



201 FBS

The Outpost 201 FBS is a front bedroom with a slide for livable room.

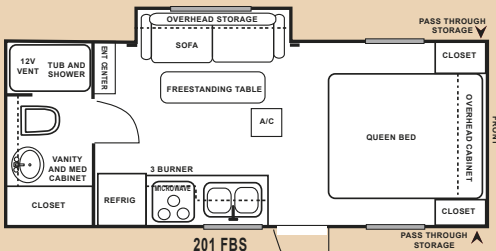

201 FBS



279 RBSS

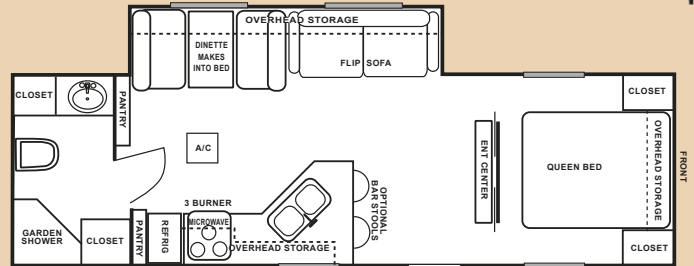

279 RBSS

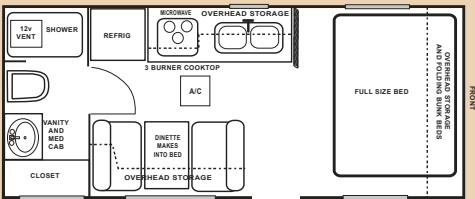

180 FB

The Outpost 180 FB

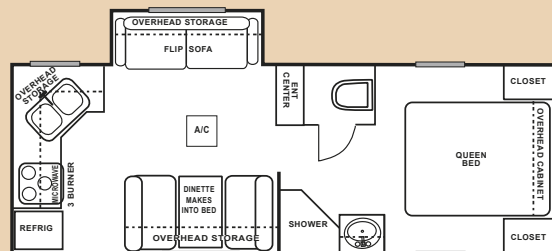

241 RKS

241 RKS

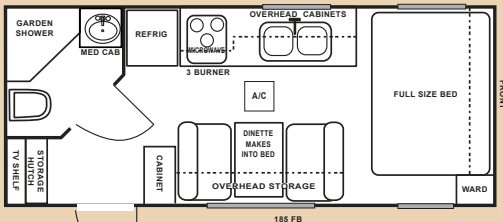

185 FB

185 FB

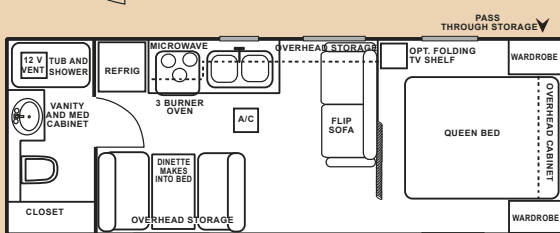

251 FB

251 FB

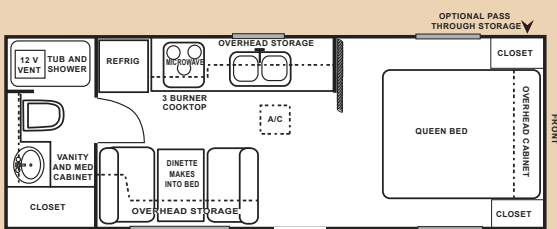

221 FB

221 FB

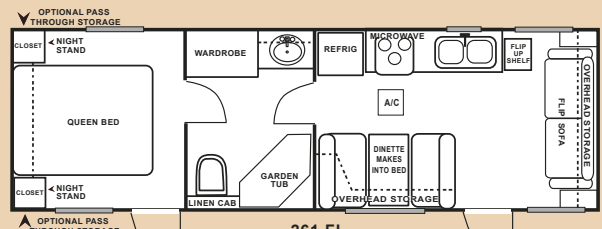

261 FL

261 FL

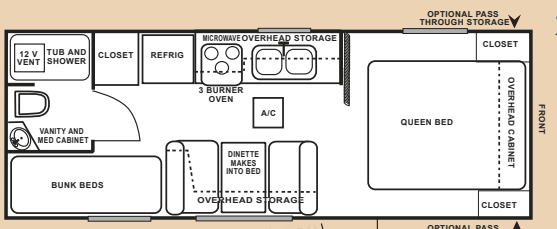

231 BH

231 BH

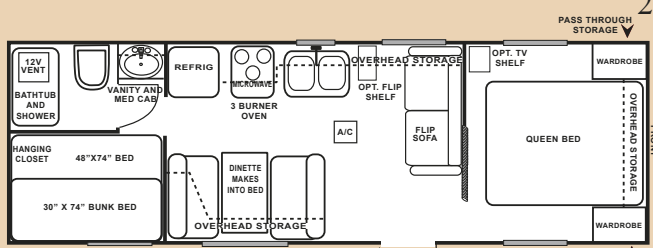

271 BH

271 BH

Outpost Trailers Floor Plans continued

281 BHSS

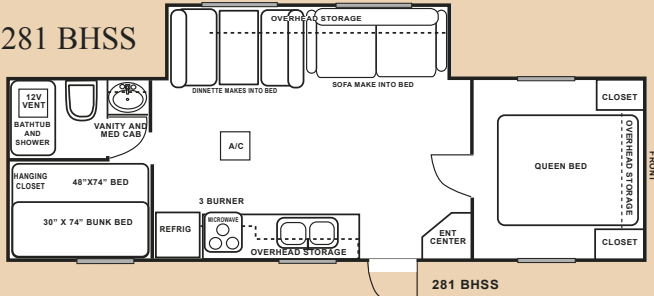

283 FKSS

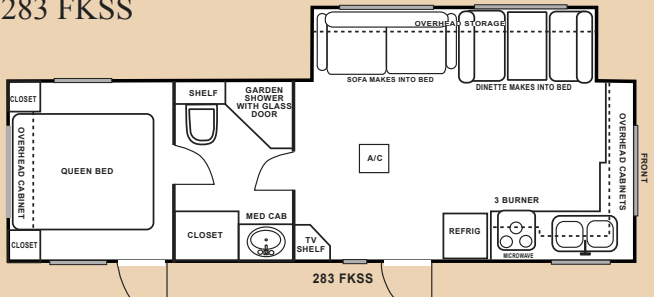

320 QBSS

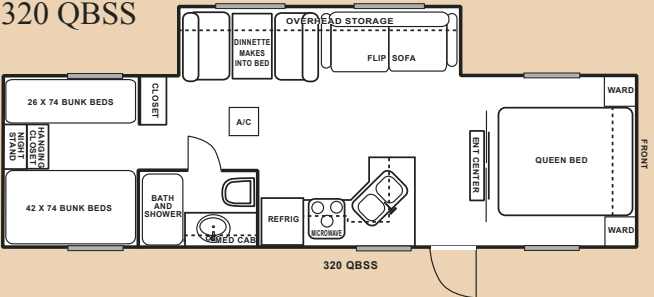

299 RKSS

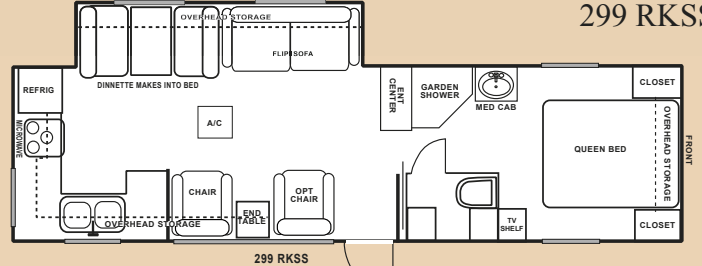

325 FKDS

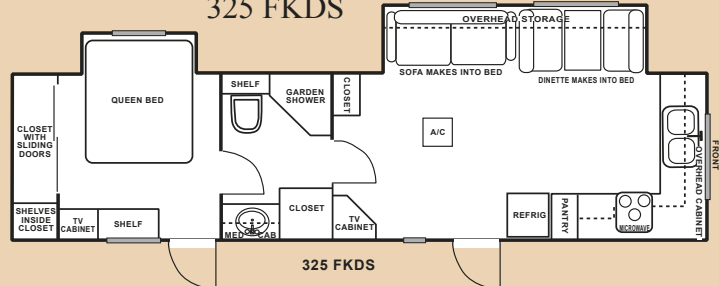

Outpost 5th Wheels Floor Plans

199 RB

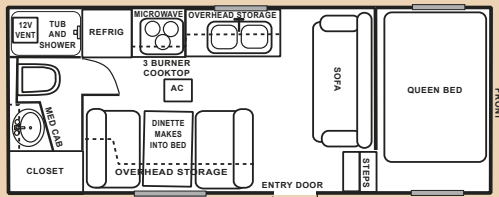

230 FRKL

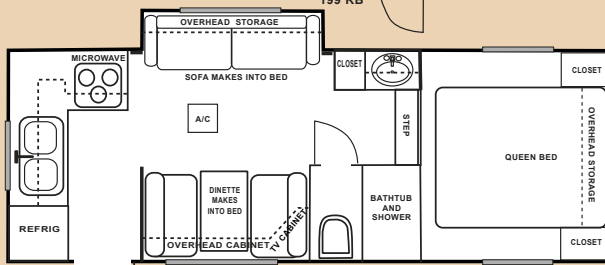

249 BH

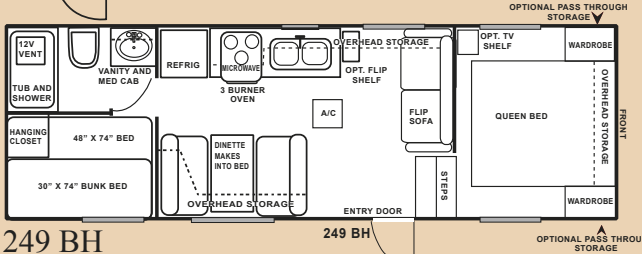

255 RKDS

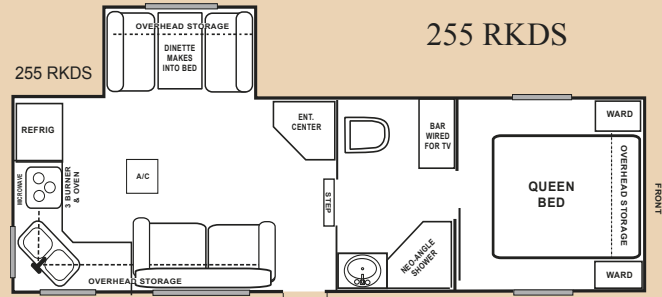

2690 TRIPLE SLIDE

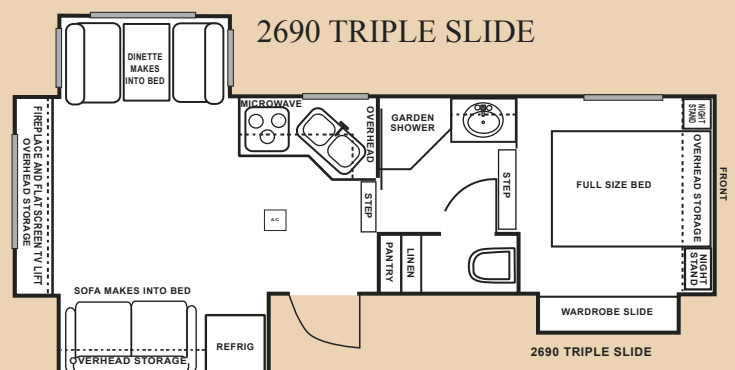

Quality Construction

Frames: All steel frames with outriggers and cross members placed to carry the load for maximum balance and strength. Tandem axles and brakes are on all wheels.

Floors: Covered under floor on all units 2 x 2 floor joists 12" or 16" OC. With R-7 high density fiberglass insulation. 5/8" plywood decking glued to frame on all floors. Deluxe vinyl on floors and deluxe carpet in 5th wheel bedrooms. All floors are bolted to frames, not just lagged.

Sides, Fronts & Backs: All sides, fronts and backs are framed 16" OC and all paneling is glued to frame and stapled to let glue set up. Extra framing is used around doors, large windows and R-7 fiberglass insulation is used. Side walls are set on top of floor and screwed on, and roof is screwed down, not just nailed. Free flowing fiberglass siding is an option.

Roof: Tapered roof rafters 16" OC or bow type rafters 16" OC. Ceiling paneling glued, screwed and stapled, R-7 high density fiberglass insulation is used to fill in between rafters. 1/4" decking is put over the rafters, and Rubber Roof is glued to decking. The Rubber Roof is rolled over corners for a better seal.



299 RKSS

Beautiful Cabinet Works



279 RBSS
Entertainment Center



Large Pantry in the 279 RBSS



Overhead Cabinets and lots of built in storage and double sink.



Garden Shower
299RKSS



Bedroom with Overhead Storage and Night Stands

Optional Equipment

2 - 30# LP BOTTLES W/ AUTO REGULATOR (EXCHANGE)
 3 WAY WATER HEATER
 6' REFRIGERATOR (180 FB, 221 FB, 231BH, 199 RB)
 8' REFRIGERATOR
 15 K.A.C. DUCTED
 50 AMP SERVICE
 AIR CONDITIONING - 2ND UNIT
 AIR CONDITIONING - WIRING & BRACED FOR 2ND UNIT
 BEDSPREAD AND PILLOW SHAMS
 BLACK WATER FLUSH TANK
 BORDER TRIM INSIDE
 DAY NIGHT SHADES
 ELECTRIC AWNING
 ELECTRIC FOUR CORNER JACKS
 ELECTRIC TONGUE JACK
 FIBERGLASS EXTERIOR
 FIRE PLACE (PER FLOOR PLAN)
 FOLDING ASSIST HANDLE
 FOLDING BUNK MATTRESS
 FOLDING TV SHELF
 FREE STANDING TABLE & 4 CHAIRS
 GLASS SHOWER DOOR
 HEADBOARD TO MATCH BEDSPREAD
 HEATED & ENCLOSED HOLDING TANKS
 HIDE-A-BED AIR MATTRESS
 J- LOUNGE (299 MODEL ONLY)
 OUTSIDE SHOWER
 OVEN STOVE (180 FB, 221 FB OR 199 RB)
 PASS THROUGH STORAGE (221 FB, 231 BH)
 PROPANE BOTTLE COVER
 SKYLIGHT OVER SHOWER
 SLIDE OUT AWNING
 TV- JENSEN HDLCD.

The only TV designed for mobile use.
 WASHER & DRYER (325FK, 283FKSS)
 WINDOWS, TINTED, THERMAL PANE
 WIRED FOR SATELLITE



Free Standing Table & 4 Chairs



Glass Shower Door & Skylight Over Shower



Chrome Wheels



Tinted Thermal Pane Windows

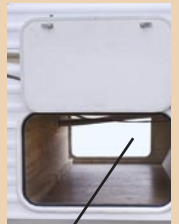

Pass Through Storage



Standard Equipment



1. Microwave
2. Gas & Electric Automatic Refrigerator with Black Glass Front
3. Freezer
4. Deluxe Cabinets
5. Air Conditioning
6. Furnace
7. Double Sink
8. Propane Stove
9. Propane Oven
10. 12V Power Range Hood



Jensen LCD HDTV approved for RVs is standard on some units and available on most units. This is the only Flat Screen TV designed for RVs.

Outpost Trailers' standard equipment is optional equipment on other trailers.

Travel Trailers

MODEL	180FB	185FB	201FBS	221FB	231BH	241RKS	251FB	261FL	271BH	279RBSS	281BHSS	283FKSS	
TIRE SIZE	175/80/13	205/75/15	205/75/15	175/80/13	205/75/15	205/75/15	205/75/15	205/75/15	205/75/15	205/75/15	205/75/15	205/75/15	
REFRIGERATOR	5'	5'	5'	5'	5'	6'	6'	6'	6'	6'	6'	6'	
HITCH WEIGHT	300	350	350	350	500	600	620	700	650	700	800	1,110	
AXLE WEIGHT	2,500	3,000	3,600	2,650	3,150	4,220	3,880	4,320	4,500	5,450	5,300	5,230	
SHIP WEIGHT	2,800	3,350	3,450	3,100	3,650	4,820	4,500	5,020	5,150	6,150	6,100	6,340	
GVWR	4,400	4,400	5,000	4,400	5,500	7,500	7,620	7,650	7,650	8,100	7,800	8,100	
CARGO CAPACITY	1,600	1,050	1,550	1,300	1,850	2,680	3,120	2,680	2,500	1,950	1,700	1,760	
EXTERIOR LENGTH	19'1"	21'	21'	21'	23'8"	25'5"	26'5"	29'5"	29'8"	30'	30'	30'6"	
EXTERIOR WIDTH	7'7"	7'7"	7'7"	7'7"	7'7"	8'	8'	8'	8'	8'	8'	8'	
EXTERIOR HEIGHT	9'9"	10'	10'	9'10"	9'11"	11'	10'1"	10'3"	10'3"	11'	11'	11'	
SLEEPING CAPACITY	4	6	4	4	6	6	6	6	9	6	9	6	
FRESH WATER	20	20	20	20	20	42	42	42	42	42	42	42	
WASTE WATER	22	30	22	22	22	30	30	30	30	38	30	30	
GREY WATER	22	34	22	22	22	34	38	38	38	38	38	38	
LPG CAPACITY	10 GAL	10 GAL	10 GAL	10 GAL	10 GAL	10 GAL	10 GAL	10 GAL	10 GAL	10 GAL	10 GAL	10 GAL	
FURNACE BTU	20,000	20,000	20,000	20,000	20,000	25,000 DUCTED	25,000 DUCTED	25,000 DUCTED	25,000 DUCTED	25,000 DUCTED	25,000 DUCTED	25,000 DUCTED	

Standard Equipment List

12V BATH VENT
12V POWER RANGE HOOD
R-7 FIBERGLASS INSULATION
AIR CONDITIONER
13,500 ROOF
AIR CONDITIONER
13,500 BTU DUCTED
ALL 8' WIDE TRAILERS
AM FM CD WITH SPEAKERS
ASSIST HANDLE
AWNING
AXLES, EASY LUBE
(ALL SLIDE OUT MODELS)
BLINDS, ALUMINUM MINI
CITY WATER CONNECTION
COVERED UNDERBELLY
DEAD BOLT LOCK
ELECTRIC BRAKES &
SAFETY CHAINS
EXTERIOR STORAGE
FIRE EXTINGUISHER
FURNACE
ELECTRIC IGNITION
GRAVEL GUARD
DIAMOND PLATE
LOW WATER DRAINS
LP DETECTOR
MICROWAVE OVEN

MONITOR PANEL
OUTSIDE RECEPTACLE
3 - BURNER HIGH OUTPUT
RANGE W/PIEZO LIGHT
& OVEN
(ALL 8' TRAILERS)
PORCH LIGHT
RADIOUS WINDOWS
REFRIGERATOR,
GAS & ELECTRIC
SEWER HOSE BUMPER
SLIDES, PUSH BUTTON
ELECTRIC
SMOKE ALARM
SPARE TIRE KIT
SPARE TIRE
GOODYEAR
SPOKE WHEELS
STABILIZER JACKS
TUB SURROUND
TV ANTENNA WITH
BOOSTER & CABLE
WHEEL WELLS
GALVANIZED
MOST MODELS
WATER HEATER
6 GALLON
QUICK RECOVERY

Standard Equipment: Push Button Electric Slides



Allen Camper Manufacturing Co. is family owned and operated, and for over 50 years has been manufacturing quality, dependable trailers. It is not just a trailer, but family pride and experience that you will be pulling down the road. Buy with confidence.

Travel Trailers				Fifth Wheel Trailers					
MODEL	299RKSS	320QBSS	325FKDS	199RB	230FRKS	249BH	255RKDS	2690RETS	
TIRE SIZE	225/75/15	225/75/15	225/75/R15	175/80/13	205/75/15	205/75/15	205/75/15	205/75/15	
REFREGIRATOR	6'	6'	6'	5'	6'	6'	6'	6	
HITCH WEIGHT	1,110	950	1000	500	500	775	N/A	1360	
AXLE WEIGHT	6,150	2,950	6,375	2,950	3,400	4,050	5,200	4,800	
SHIP WEIGHT	7,100	7,235	7,735	3,000	4,000	5,120	6,499	6,250	
GVWR	11,500	11,500	11,500	4,500	5,600	7,750	8,316	8,500	
CARGO CAPACITY	4,400	3,765	3,765	1,050	1,600	2,630	1,779	2,250	
EXTERIOR LENGTH	34'5"	34'5"	34'5"	20'10"	23'	26'5"	27'8"	27'	
EXTERIOR WIDTH	8'	8'	8'	7'7"	7'7"	8'	8'	7'7"	
EXTERIOR HEIGHT	11'	11'	11'	10'	11'	10'10"	12'5"	11'8"	
SLEEPING CAPACITY	6	10	6	6	6	9	6	6	
FRESH WATER	42	42	42	20	30	42	42	42	
WASTE WATER	38	38	30	30	30	33	33	33	
GREY WATER	38	38	38	30	33	30	30	30	
LPG CAPACITY	10 GAL	10 GAL	10 GAL	10 GAL	10 GAL	10 GAL	10 GAL	10 GAL	
FURNACE BTU	35,000 DUCTED	35,000 DUCTED	35,000 DUCTED	20,000	25,000 DUCTED	25,000 DUCTED	25,000 DUCTED	25,000 DUCTED	

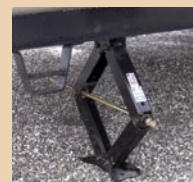

Stabilizer Jacks



Spare Tire, Goodyear

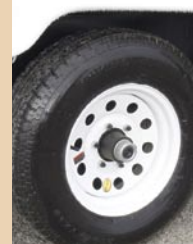

Easy Lube Axle (On All Slide-Outs)



Gravel Guard Diamond Plate



The 241 RKS Outpost Trailer has features found in much larger trailers. The shower and electric awning are two features not usually available in a 24 foot trailer. Outpost Trailers are packed with features that you will use and appreciate.



BUILDING QUALITY RVs SINCE 1958

ALLEN CAMPER MFG. CO., INC.

MANUFACTURERS OF FIFTH WHEELS, TRAVEL TRAILERS AND PARK MODELS

29981 State Highway 1E • Allen, OK 74825

Phone: 580-857-2413 • Fax: 580-857-2414

www.allencampermfg.com • info@allencampermfg.com