

PREMIER
ULTRA LITE BY BULLET

PREMIER

ULTRA LITE BY BULLET



THE PREMIER... LUXURY LIGHTWEIGHT
A NEW ERA IN ULTRA LITES

www.keystone-premier.com





PREMIER
ULTRA LITE BY BULLET

Premier by Bullet is the new gold standard in ultra lite RVs. With vaulted ceilings almost 7-feet tall, huge frameless picture windows, and comfortable seating in the extra deep slide out rooms, Premier surrounds you with "at home" comfort.



- ① Deep, full extension cabinet drawers
- ② Easy-access storage behind the sink
- ③ Laminated counter top with wrapped edges
- ④ Deep single-basin sink
- ⑤ 21" conventional oven
- ⑥ Residential pantry with removable shelves
- ⑦ Double-door refrigerator
- ⑧ Full-function microwave oven
- ⑨ Spice rack hidden in the window valance
- ⑩ Large, unobstructed overhead cabinet



What's the big thing about Premier?

From floorplan layout to interior and exterior styling, Premier is in a class by itself. Take, for example, Premier's interior features. These include craftsman-style real hardwood cabinetry, Beauflor extra durable cushioned floors, stainless steel appliances, plus an ingenious use of space that makes more efficient use of every square foot of interior area. With Premier, you'll enjoy a luxury RV that's functional, beautiful and can be towed by today's fuel-efficient SUVs and trucks.

What's the big thing about Premier?
In a word, **EVERYTHING.**



www.keystone-premier.com

PREMIER

ULTRA LIFE BY BULLET

EXTERIOR FEATURES



Largest Pass-Thru Storage in it's class. 40.3 cubic ft. of pass-thru storage for all of your camping gear.



Frameless Tinted Windows allow you to keep the windows open for air flow, even when it's raining.



Electric Awning makes it easy to extend/retract the awning. Awning is also equipped with adjustable arms.



LED Lights are brighter for safety and have longer life.



Wide Stance Axles dramatically increases how the unit tows by reducing bouncing and swaying during travel.



Exterior Shower equipped with a fixed shower head and access to both hot and cold water.



1. Power Tongue Jack
2. Quick Access LP Cover
3. Integrated Dual Battery Tray
4. LED Docking Lights
5. Dual Radius Fiberglass Front Cap
6. 5" Radius Galvanized Roof Trusses
7. Hurricane Straps
8. Fully Insulated Roof
9. Durable Roof Decking
10. One Piece EPDM Rubber Roof
11. 13.5 Quick Cool Air Conditioning
12. Full Length Rain Gutter and Spouts
13. Rolled Roof Edge
14. Smooth Fiberglass Exterior

15. 1/8" Luan Wall Backing
16. Hi-Density Block Foam Insulation
17. 1 1/2" Box Welded Aluminum Frame Structure
18. Decorative Interior Wall Board
19. Residential Stain Resistant Linoleum
20. 1st Layer Floor Decking

21. 2nd Layer Floor Decking
22. Hi-Density In Floor Block Foam Insulation
23. Welded Aluminum Floor Joists
24. 3rd Layer Floor Decking
25. Paco/I - Beam Frame
26. Darco Vapor Barrier Wrap

27

31



LOOK FOR
PREMIER VIDEOS
ON OUR WEBSITE!



- 27. Enclosed Underbelly
- 28. Radial Tires with Electric Breaks (4)
- 29. Load Equalization Axle System
- 30. Easy Lube Axles
- 31. Radius Entry Steps
- 32. Frameless Tinted Windows

LIGHTWEIGHT SOLID CONSTRUCTION

INTERIOR FEATURES



Laundry Chute provides a convenient place to dispose of dirty clothes until you get home.



9" Deep Single Basin Kitchen Sink allows enough size and depth for washing pots and pans.



6' 11" Vaulted Ceiling creates an open, spacious interior.



Progressive Interior Lighting located above the queen size bed in the master bedroom.



Max-Depth Slide Out Room is 38" deep allowing for larger dinette and sofa.



CD/DVD/AM/FM Stereo w/ MP3 Hookup gives you multiple option for entertainment on those rainy days at the campground.



Sofa easily converts into a comfortable **Queen Sized Bed**.



Swivel TV w/Mirror (per floorplan) eliminates the need to bring a second television for the master bedroom while providing additional storage.



28RLPR | LIVING AREA SHOWN WITH GODIVA DECOR



31BHPR | BUNKHOUSE SHOWN WITH BLACKBERRY DECOR

You'll find a Premier floorplan to fit your lifestyle perfectly.

The Outdoor Camp Kitchen on the 31BHPR (photo directly above) offers refrigerator, cooktop, sink with hot and cold running water, storage and LCD TV. It's a great way to add to your tailgating experience or those lazy days hanging out beneath the patio awning.

The Premier Dream Locker (photo right) is located immediately inside the doorway of the 28RLPR and 29REPR floorplans. This space is designed as a convenient area to shed and store your outdoor gear including shoes and boots, coats, and other equipment.



281BHS | DREAM LOCKER

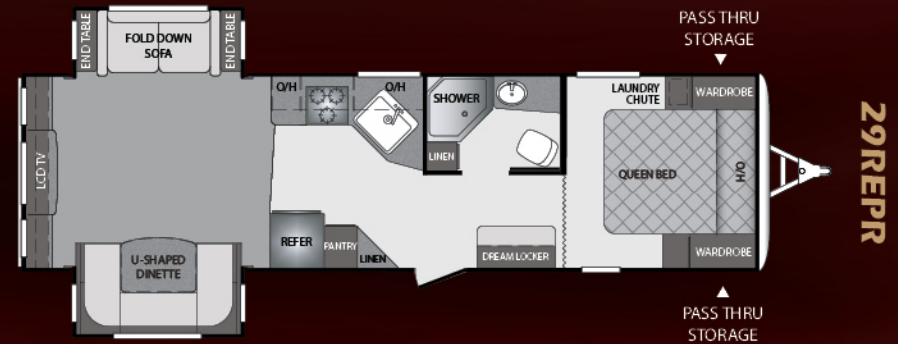
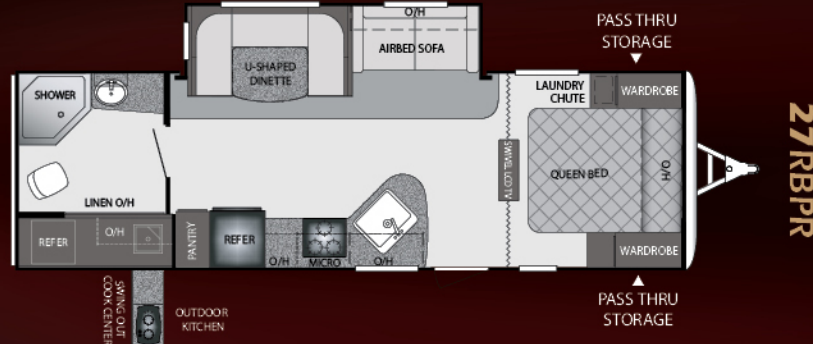
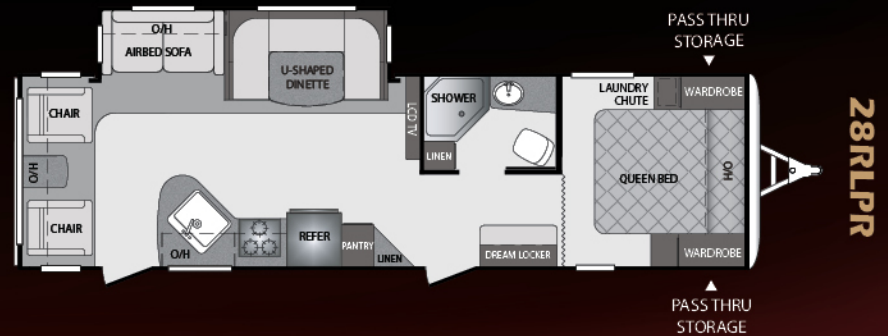
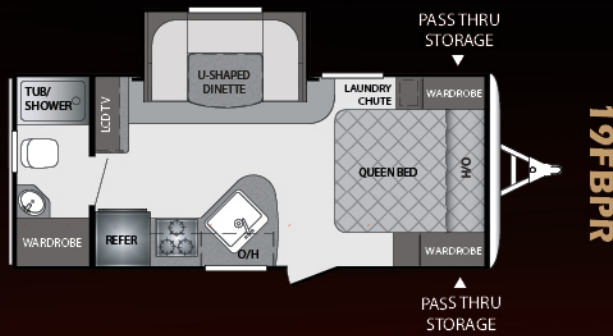

WEIGHTS AND MEASUREMENTS

| | 19FBPR | 27RBPR | 28RLPR | 29REPR | 31BHPR |
|-------------------|---------|---------|---------|---------|---------|
| Shipping | 4090 | 5335 | 5900 | 5980 | 6355 |
| Carrying Capacity | 3320 | 2265 | 1700 | 1620 | 1245 |
| Hitch | 410 | 645 | 670 | 520 | 780 |
| Ext. Length | 23' 2" | 30' 6" | 33' 6" | 33' 6" | 35' 4" |
| Ext. Width | 8' | 8' | 8' | 8' | 8' |
| Ext. Height | 10' 11" | 10' 11" | 10' 11" | 10' 11" | 10' 11" |
| Fresh Water | 41 | 41 | 41 | 41 | 41 |
| Waste Water | 30 | 30 | 30 | 30 | 30 |
| Grey Water | 30 | 30 | 60 | 30 | 30 |
| LPG | 40 | 40 | 40 | 40 | 40 |

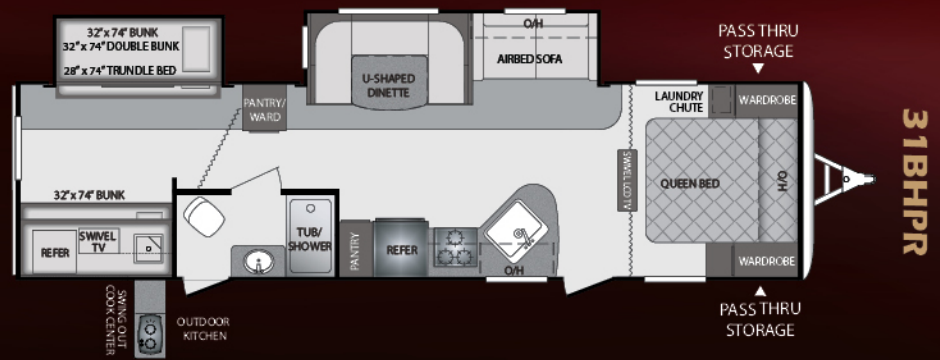

VIEW SNAPSHOT PHOTOS OF FLOORPLAN INTERIORS AT WWW.KEYSTONE-PREMIER.COM



www.keystone-premier.com

GODIVA
DECORBLACKBERRY
DECORSAGE BRUSH
DECOR

CONSTRUCTION STANDARDS

- Aggressive Front Profile for Increased Towability
- Aluminum Framed Front, End and Side Walls
- Laminated Fiberglass Exterior Side Walls
- 2" Thick Laminated Aluminum Floor
- In Frame Fresh, Grey, and Black Water Tanks
- 6" and 8" I-Beam with Welded Outriggers
- 1/4" ABS Enclosed Underbelly
- Darco Moisture Barrier
- One Piece Seamless Rubber Roof
- E-Z Lube Axles
- Electric Brake System (4wheels)
- R-11 Insulation in Floor
- R-7 Insulation in Sidewalls
- R-11 Insulation in Roof

EXTERIOR CAMPING PACKAGE

- Wide Stance E-Z Lube Axles
- 6 Gallon Gas/Electric DSI Water Heater
- Radius Entry Door with Gas Strut
- Outside Speakers
- Outside Shower (Hot and Cold Water)
- 4 Stabilizer Jacks
- TV Antenna and Cable Hook-Up
- Electric Awning with Adjustable Arms
- Radial Tires

EXTERIOR FEATURES

- Outdoor Kitchen (27RB, 31BH)
- Aluminum Wheels
- Dual Propane Tanks with Cover
- In Frame Dual Battery Rack
- Oversized Exterior Pass Thru Storage with Lighting
- LP Quick Connect
- Amber Patio Light
- Spare Tire

INTERIOR CAMPING PACKAGE

- 13.5 BTU Ducted A/C (N/A Micro Series)
- Night Shades
- CD/DVD/AM/FM Stereo with Aux and I-Pod Hookup
- 19" LCD TV
- Microwave
- 6 cu./ft. Double Door Refrigerator
- 3 Burner High Output Range
- 9" Deep Oversized Single Basin Sink with High Rise Faucet
- Solid Wood Raised Panel Cabinet Doors
- Foot Flush Toilet
- Tub Surround with Shelves

INTERIOR FEATURES

- 6' 11" Vaulted Ceiling
- Beauflor Linoleum
- Swivel Rockers (Per Floor Plan)
- Pillow Back Furniture
- Swivel TV with Mirror and Convenience Center (Per Floor Plan)
- Night Shades in Living Area
- Spice Rack Valance
- 17" Oven (N/A Micro Series)
- Chestnut Glazed Hardwood Cabinet Doors
- Decorative Wall Border

BATHROOM

- Deluxe Curved Shower Curtain
- Power Vent Fan
- Solid Wood Medicine Cabinet
- Linen Storage

MASTER BEDROOM

- Upgraded Innerspring Mattress
- Mirrored Wardrobes
- Laundry Chute
- Under Bed Storage
- Individual Reading Lights

SAFETY EQUIPMENT

- Carbon monoxide detector
- Smoke alarm
- Fire extinguisher
- Electric brakes
- Safety chains
- Frameless tinted safety glass windows, Egress windows (Fire Escape)
- GFI receipts

OPTIONS

- Full Body Paint
- RVO Grill
- 15K A/C



YOUR LOCAL DEALER IS:

THERMAL PACKAGE

- Heated and Enclosed Underbelly
- 2" Pipe off of Furnace to Underbelly
- 30K BTU Furnace and Residential Heat Ducts

PREMIER
PACKAGE

- Aerodynamic Fiberglass Front Cap
- Stainless Steel Appliances
- Vaulted Ceiling System
- Exterior LED Lights
- Frameless Tinted Windows
- Power Tongue Jack
- Air Bed Sofa Sleeper
- Max Depth Slides
- Progressive Interior Lighting
- Chestnut Glazed Cabinetry
- Upgraded Exterior Graphics Package



www.keystone-premier.com

LOOK FOR
PREMIER VIDEOS
ON OUR WEBSITE!Go RVing
Life's A Trip!2642 Hackberry Drive | PO Box 2000
Goshen, IN 46527-2000
(574) 535-2100

www.kestonerv.com

Product information is as accurate as possible as of the date of publication of this brochure. Features, floor plans, and specifications are subject to change without notice. Please also consult Keystone's web site at kestonerv.com for more current product information and specifications. Tow Vehicle Disclaimer: CAUTION: Owners of Keystone recreational vehicles are solely responsible for the selection and proper use of tow vehicles. All customers should consult with a motor vehicle manufacturer or their dealer concerning the purchase and use of suitable tow vehicles for Keystone products. Keystone disclaims any liability or damages suffered as a result of the selection, operation, use or misuse of a tow vehicle. KEYSTONE'S LIMITED WARRANTY DOES NOT COVER DAMAGE TO THE RECREATIONAL VEHICLE OR THE TOW VEHICLE AS A RESULT OF THE SELECTION, OPERATION, USE OR MISUSE OF THE TOW VEHICLE. 10/2010