



# Sportsmen Classic



## 16RBT

Simple pleasures are always the best. With 3 floor plans that now feature expandable sleeping areas and a new toy hauler model. The Sportsmen Classic is ready to share the good times.



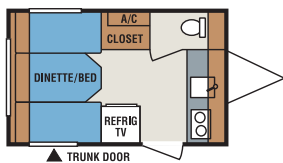

13FK

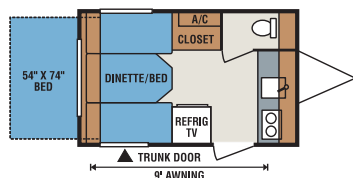

13FKT

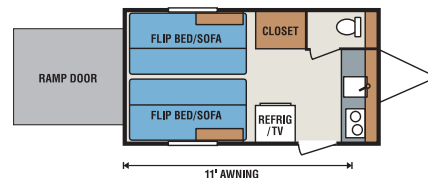

14FKTH

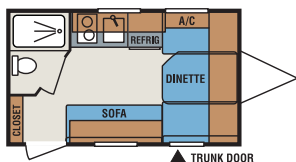

14RB

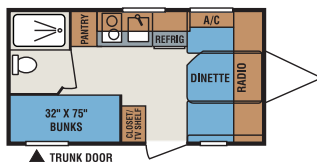

16BH

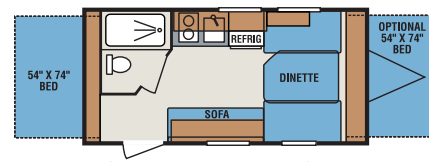

16RBT

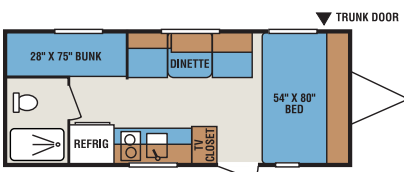

19BH

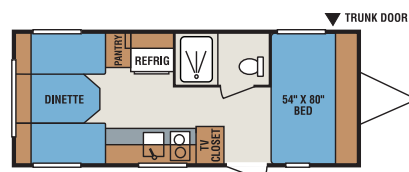

19SB

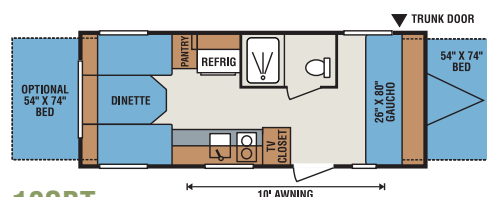

19SBT

SPECIFICATIONS	13FK	13FKT	14FKTH	14RB	16BH	16RBT	19BH	19SB	19SBT
UVW (Unloaded Vehicle Weight)	1,670	1,940	2,060	1,920	2,140	2,270	2,540	2,400	2,500
Dry Hitch Weight	180	170	320	240	290	290	260	300	320
Dry Axle Weight	1,490	1,770	1,740	1,680	1,850	1,980	2,280	2,100	2,180
NCC (Net Carrying Capacity)	1,030	760	1,440	780	560	430	960	1,100	1,000
GVWR	2,700	2,700	3,500	2,700	2,700	2,700	3,500	3,500	3,500
Interior Height	73"	73"	73"	73"	73"	73"	73"	73"	73"
Exterior Height	8'1"	8'1"	8'3"	8'	8'1"	8'	8'2"	8'2"	8'2"
Exterior Width	84"	84"	84"	84"	84"	84"	84"	84"	84"
Exterior Length	13'9"	13'9"	15'10"	15'10"	17'2"	17'2"	20'6"	20'6"	20'6"
Refrigerator (cu. feet)	4.6	4.6	4.6	4.6	4.6	4.6	4.6	4.6	4.6
Water Heater Cap. (gal. Gas) <i>OPTIONAL</i>	6	6	6	6	6	6	6	6	6
Fresh Water Cap. (gal.)	10	10	10	10	10	10	20	20	20
Waste Water Cap. (gal.)	5	5	5	9	9	9	9	15	15
Gray Water Cap. (gal.)	9	9	9	15	15	15	15	15	15
LP Gas Cap. (lbs.) <i>OPTIONAL</i>	20	20	20	20	20	20	20	20	20
Furnace BTUs (1,000's) <i>OPTIONAL</i>	16	16	16	16	16	16	16	16	16
Tire Size	13"	13"	14"	13"	13"	13"	14"	14"	14"
Awning <i>OPTIONAL</i>	9'	9'	10'	10'	10'	10'	10'	10'	10'



### Standard Features

- 4.6 Cu. Electric Refrigerator
- 2 Burner Electric Hot Plate
- Single Bowl Sink
- 54" Dinette Seats
- Overhead Cabinets
- 10 Gallon Fresh Water Tank
- Tinted Windows
- City Water Fill
- 12 V Water Pump
- 12 V Converter with Charger
- 13" Tires
- 1 Piece Aluminum Roof
- R-7 Insulation

### Regular Package

- TV Antenna
- Awning with Hardware
- Toilet
- Spare Tire
- 2 Stabilizer Jacks

### Options

- 16,000 BTU Furnace
- 5,000 BTU Air Conditioner
- Spare Tire
- 4 Stabilizer Jacks
- 2 Stabilizer Jacks
- Microwave

### Full Package Option

- Gas Hot Plate in Lieu of Electric Hot Plate
- Microwave
- TV Antenna

- 3 Cu. Gas/Electric Refrigerator in Lieu of Electric Refrigerator
- 6 Gallon Gas Water Heater

- Single Gas Bottle
- Spare Tire
- 2 Stabilizer Jacks
- Awning with Hardware
- Shower and Toilet

- Shower and Toilet (Forced Option 14RB, 16BH, 19SB and 19BH)
- Single Gas Bottle (Forced Option 14RB, 16BH, 19SB and 19BH)
- Front Window (N/A 13FK)

- 6 Gallon Gas Water Heater (Forced Option 14RB, 16BH, 19SB and 19BH)
- Front Tent (16RBT)
- Rear Tent (19SBT)

For more product details and in-depth information, visit us on the web at [www.kz-rv.com](http://www.kz-rv.com)