

Flagstaff

MAC, CLASSIC, HIGHWALL & HARD SIDE TENT CAMPERS

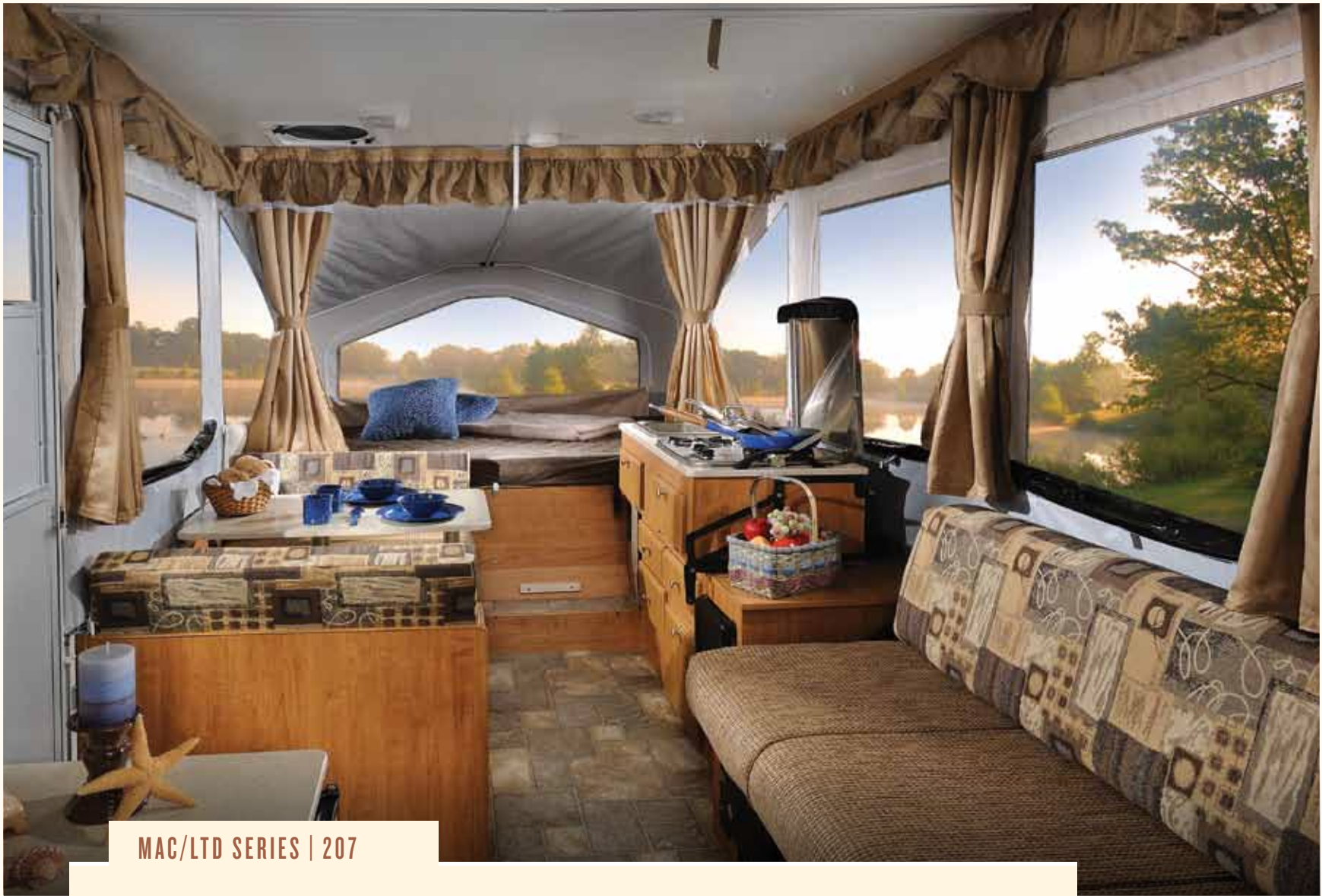



MAC/LTD SERIES | 207

Flagstaff takes pride in packing the most value possible into our MAC / LTD series. While coming standard with many features, you still have the flex-

ibility to incorporate as many options as you choose to fit your camping preferences. Make your investment go a long way with the MAC / LTD camper.

FLAGSTAFF MAC/LTD SERIES



POPULAR FEATURES

- A. Under Floor 20 Gallon Water Tank (STD. Except LTD.)
- B. Outside Grill With Work Table (STD. on all Except LTD)
- C. Plywood Bed Ends (STD.)
- D. Heated Mattress (STD. OPT.)
- E. One-Piece Door (STD. Except LTD.)
- F. Exterior Electric Plug (STD. Except I76LTD)
- G. Metal Drawer Guides (STD.)
- H. Spare Tire (STD. with Travel Package)



FLAGSTAFF CLASSIC SERIES

POPULAR FEATURES

- A. Swing Down Galley (Most Models)
- B. Sliding Storage Trunk (Some Models)
- C. Outside Shower (STD.)
- D. Outside Speaker (STD.)
- E. Bunk Light & Fan (STD.)
- F. Hanging Shirt Bar (STD.)
- G. Porta-Potty (STD 620ST & 425D)
- H. Crank Down Stabilizer Jack with Sand Pad (STD.)
- I. Stereo With CD Player (STD.)





CLASSIC SERIES | 823D

The Classic series has many outstanding features to enhance your camping experience. The swing-down galley and standard power lift make the

Classic a breeze to set-up. The expansive seating throughout the camper gives everyone plenty of room to sit and enjoy themselves.



HIGH WALL SERIES | HW27SC

Cherry-colored cabinetry, stainless steel finishes and beautiful tile-look flooring puts this camper in a class of its own. The Flagstaff High Wall Campers

are perfect for those families who want the luxurious features of a travel trailer in a much lighter towable option. It's your vacation. Go in style.

FLAGSTAFF HIGH WALL SERIES



POPULAR FEATURES

- A. Fantastic Fan (Std. Opt.)
- B. Water Filter (Std. w/ Hot Water Package)
- C. Power Lift With Manual Override (Std. Classic, HW)
- D. Beautiful hardwall shower with a residential-style flush toilet complete with a 12-gallon black water holding tank. (Std. HW)

Left: No more waiting in line for the showers. While breakfast is started, take a morning shower in privacy without leaving your camper. Our high wall models include a three burner range with cover and oven, microwave, stereo, a larger kitchen sink and shower which brings the finer amenities to tent camping.





FLAGSTAFF TENT CAMPERS: CONSTRUCTION CUTAWAY *Model 625D*

FLAGSTAFF QUALITY CONSTRUCTION



- 1) Three Stage Double Arm Lifter Posts
(NA on Hard Sides)
- 2) Fiberglass Vacuum Bonded Radius Roof w/
No Center Seam (NA on Hard Sides)
- 3) Five-Piece Tenting With Breathable Bed Ends
(NA on Hard Sides)
- 4) E-Z Crank Down Stabilizer Jacks w/ Sand Pads
- 5) Full Perimeter Aluminum Bed Frames
(NA on Hard Sides)
- 6) Plywood Bunk Ends (NA on Hard Sides)
- 7) Seven-Way Pigtail Wiring
- 8) Under Floor 20 Gallon Fresh Water Tank
(LTDs 10 Gallon Above Floor)
- 9) E-Coated Tubular Steel Frame
- 10) Powder Coated Rafter Poles and Bed Bows
(NA on Hard Sides)
- 11) Air Conditioner Reinforcing Laminated Into Roof
(NA on Hard Sides)
- 12) 13" Radial Tires on 12' Models
(12" Radial Tires on 8' & 10' Models)
- 13) Easy Lube Axles (Except LTDs)
- 14) Breathable Canvas Bed End Material
- 15) One-Piece Door (Except LTDs & Hard Sides)

ALKO® AXLES AND EASY LUBE HUBS

AL-KO Axles offer many advantages over conventional axles:

- Fully independent wheel suspension.
- Lower trailer center of gravity for improved stability.
- No metal to metal contact and no springs, shackles, hangers, or U-bolts to break or wear out.

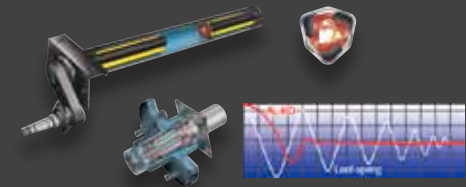

The UltraLube™ Hubs allow you to repack bearings quickly and easily without disassembly. Note: Torsion Axles on Classics and HW only. Easy-Lube Hubs on all units except LTDs.

FLAGSTAFF HIGH WALL SERIES

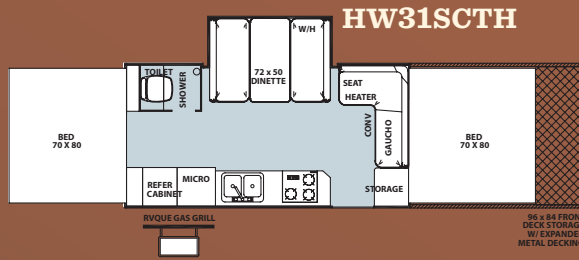
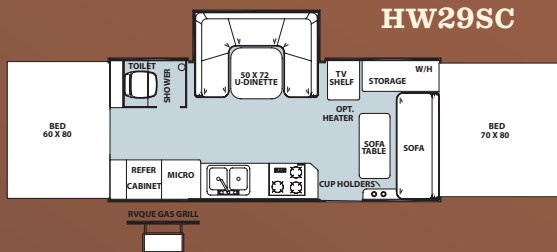
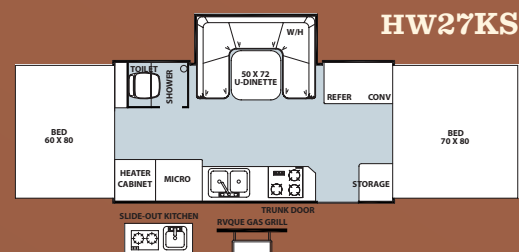
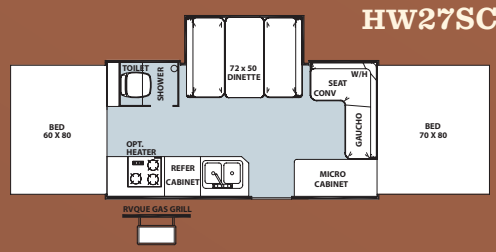
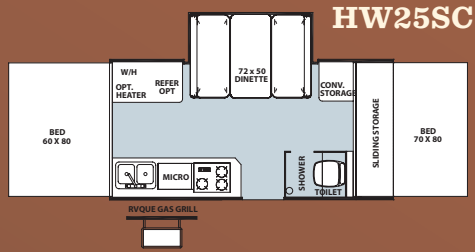

HIGH WALL SERIES SPECIFICATIONS

MODEL	HW25SC	HW27KS	HW27SC	HW29SC	HW31SCTH
GVWR (GROSS VEHICLE WEIGHT RATING)	3873	3779	3859	4573	6250
BASE/DRY UNIT WEIGHT	2910	2806	2959	3135	3676
BASE DRY HITCH WEIGHT	373	279	359	373	404
BASE DRY AXLE WEIGHT	2537	2527	2600	2762	3272
CARGO CAPACITY	963	935	862	1217	2317
BOX SIZE	12'	14'	14'	16'	14'
TRAILER SIZE (CLOSED W/ HITCH)	19' 1"	19' 4"	19' 4"	21' 4"	28' 4"
HEIGHT (CLOSED)	68"	68"	68"	68"	68"
TRAILER LENGTH (OPEN)	22' 6"	24' 9"	24' 9"	26' 9"	33' 9"
FRESH WATER CAPACITY	26	26	26	26	26
GRAY WATER CAPACITY	12	12	12	12	12
BLACK WATER CAPACITY	12	12	12	12	12

Model number of any particular unit does not necessarily reflect the overall length of the unit itself. Dry weight are estimates.

HIGH WALL SERIES | STANDARDS & OPTIONS

STANDARD FEATURES

- Cherry Interior with "Tile-Look" Linoleum
- Two-Tone Fabric Interiors
- Stainless Steel Look Appliances and Sink
- Double Pan Sink with High Rise Faucet
- Electric Water Pump
- Hot Water Package (Incl. Water Filter, Outside Shower, DSI Six Gallon Hot Water Heater)
- Hard Wall Shower with Residential Flush Toilet
- Three Burner Stove with Oven
- Microwave
- Free Standing Table – High Pressure Laminate
- Comfortable Family Style Dinette w/ 4" Reversible Cushions
- Residential Style Raised Panel Doors
- Wood Drawers w/ Metal Guides
- Large Clothes Bar
- AM/FM Stereo with CD player
- TV Outlet with Cable and Satellite Hook Up
- LCD TV (HW29SC Only)

- LP Leak Detector
- 35 Amp Converter with Built in Battery Charger
- 12v Safety Switch
- Interior Floor Lights
- Bunk Light with Fan
- Soft Quilted Top Innerspring Mattresses
- Torsion Axles by AL-KO w/ Easy-Lube Axles
- 14" Tires with Aluminum Wheels
- Electric Brakes
- Power Lift System
- Battery Box and Wiring Kit
- Dual 20 lb. Gas Bottles
- Diamond Plated Front Cap
- Outdoor Gas Grill w/ Worktable
- Outside Speaker
- Black Water Hose Storage
- One Piece Screen Door
- Folding Grab Handle
- Exterior Graphic Design

STANDARD CONSTRUCTION FEATURES

- Fiberglass Vacuum Bonded Radius Roof w/ No Center Seam
- 3-Stage Double Arm Lifter Posts
- Smooth Fiberglass Vacuum Bonded Exterior
- Lower Door Operational in Closed Position
- Five Piece Sectionalized Vinolon Supreme Tenting
- Tent Permanently Attached on Bunk Ends and Slide Out
- Plywood Bunk Ends
- Full Perimeter Aluminum Bed Frames
- Powder Coated Rafter Poles and Bed Bows
- Tinted Vinyl Windows
- One Piece Undercoated Structurewood Floor
- Automotive E-Coated Tubular Steel Frame
- (4) E-Z Crank-Down Stabilizer Jacks w/ Sand Pads
- Seamless, High Density Polyethylene Wheel Wells
- Under Floor 20 Gallon Fresh Water Tank
- 12 Gallon Gray Water Holding Tank
- 12 Gallon Black Water Holding Tank

- 2000 lb. Tongue Jack w/ Swivel Wheel
- 7-Way Pigtail Plug

OPTIONAL FEATURES

- Create-a-Breeze 3 Speed Fantastic Fan
- Carbon Monoxide Detector
- Air Conditioner Wiring Kit
- 13,500 BTU Air Conditioner
- 20,000 BTU Forced Air Furnace w/ Electric Ignition
- Extra Large 4.0 cu. ft. Refrigerator
- Heated Innerspring Mattresses
- Hanging Wardrobe
- Hanging Pantry
- Power Front Jack
- Screen Room w/ Privacy Panels
- Travel Pack (Incl. Spare Tire, Tire Bracket, Tire Cover, Installed Step)
- Convenience Pack (Incl. Privacy Curtains, Roof Valances, A/C Bracing, Patio Light, 110V Exterior Outlet)

FLAGSTAFF HARD SIDE SERIES



HARD SIDE SERIES | T12RS



HARD SIDE SERIES SPECIFICATIONS

T12RB

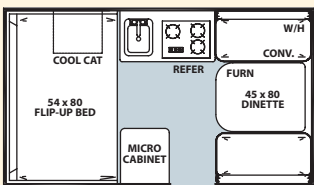

T12RS

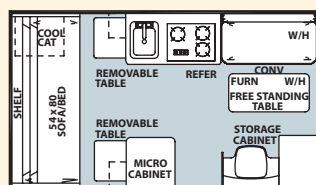

T12DD

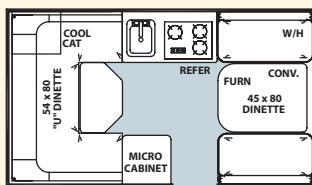

MODEL	T12RB	T12RS	T12DD
GVWR (Gross Vehicle Weight Rating)	3179	3205	3082
BASE DRY UNIT WEIGHT	1784	1803	1846
BASE DRY HITCH WEIGHT	257	259	273
BASE DRY AXLE WEIGHT	1527	1544	1573
CARGO CAPACITY	1217	1217	1217
BOX SIZE	12'	12'	12'
TRAILER SIZE (Closed w/ Hitch)	17' 1"	17' 1"	17' 1"
HEIGHT (Closed)	60"	60"	60"
FRESH WATER CAPACITY	26	26	26

Model number of any particular unit does not necessarily reflect the overall length of the unit itself. Dry weight are estimates.

* Hard Side standards and options available on page 12.

FLAGSTAFF CLASSIC & HARD SIDE SERIES STANDARDS & OPTIONS

CLASSIC / HARD SIDE STANDARD FEATURES

- Cherry Interior with "Tile-Look" Linoleum
- Two-Tone Fabric Interiors
- Residential Style Kitchen Faucet w/ Electric Water Pump
- Larger Deeper Sinks
- Hot Water Pkg. (Incl. Water Filter, Outside Shower, Six Gallon DSI Hot Water Heater, Demand Water Pump)
- Permanently Mounted 3-Burner Indoor Range w/ Stove Cover
- Free Standing Table – High Pressure Laminate
- Comfortable Family Style Dinette w/ 4" Reversible Cushions (N/A T12RS)
- Residential Style Raised Panel Doors
- Wood Drawers w/ Metal Guides
- Large Clothes Bar
- AM/FM Stereo w/ CD Player
- Cable Ready
- 35 Amp Converter with Built In Battery Charger
- 12V Safety Switch
- LP Leak Detector
- Port-a-Potty (620ST, 425D, T12RB, T12DD)
- Soft Quilted Top Innerspring Mattresses (N/A T12RS, T12DD)
- Independent Torsion Axles
- Easy Lube Axles
- 13" Radial Tires with Aluminum Wheels
- Electric Brakes
- Battery Box and Wiring Kit
- Outdoor Gas Grill w/ Worktable
- Outside Speaker

- Folding Grab Handle
- Exterior Graphic Design

CLASSIC ADDITIONAL STANDARDS

- 3 Double Ceiling Lights w/ Jacks for Accessories
- Bunk Light w/ Fan
- Swing Level Galley
- Large Built-in Ice Box
- One Piece Screen Door
- Awning
- Electric Lifter system
- 20 lb. LP Bottle
- 28.5" Front Storage Deck (720BH Only)
- Sliding Storage Tray on All Front Trunk Models (Except 620ST)

HARD SIDE ADDITIONAL STANDARDS

- Create-A-Breeze Three Speed Fantastic Fan
- Large, Opening Picture Window
- Privacy Curtains
- 10,000 BTU Cool Cat Heat Pump
- 3 Way Refer 2.5 Cu. Ft. 110v & 12v
- Stainless Steel Appliances
- Microwave
- Cassette Toilet (T12RS)
- 2 Double Ceiling Lights
- Interior Floor Light
- Thermostatically Controlled Heated Mattresses (STD with T12RB)

- Courtesy Light on Front
- 110V Exterior Outlet
- Double 20lb LP Bottles w/ Cover

STANDARD CONSTRUCTION FEATURES

- Smooth Fiberglass Vacuum Bonded Exterior
- One Piece Undercoated Stucturewood Floor
- Automotive E-Coated Tubular Steel Frame
- (4) E-Z Crank-Down Stabilizer Jacks w/ Sand Pads
- Seamless, High Density Polyethylene Wheel Wells
- Under Floor 20 Gallon Fresh Water Tank
- 2000 lb. Tongue Jack w/ Swivel Wheel
- 7-Way Pigtail Plug

CLASSIC ADDITIONAL STANDARD CONSTRUCTION FEATURES

- Five Piece Sectionalized Vinolon Supreme Tenting
- Tent Permanently Attached on Bunk Ends and Slide Out
- Plywood Bunk Ends
- Full Perimeter Aluminum Bed Frames
- Powder Coated Rafter Poles and Bed Bows
- Tinted Vinyl Windows
- Fiberglass Vacuum Bonded Radius Roof w/ No Center Seam
- 3-Stage Double Arm Lifter Posts
- Lower Door Operational in Closed Position

HARD SIDE ADDITIONAL STANDARD CONSTRUCTION FEATURES

- Completely Enclosed Living Area
- Fiberglass Vacuum Bonded Roof with Metal Interior Roof

- Large Tinted Sky Light with Shade
- Aerodynamic Diamond Plate Front
- Automatic LP Regulator
- Installed Door Step
- Spare Tire and Mount

POPULAR OPTIONS

- Carbon Monoxide Detector
- Create-A Breeze Three Speed Fantastic Fan
- 20,000 BTU Forced Air Furnace w/ Electric Ignition

CLASSIC ADDITIONAL OPTIONS

- Thermostatically Controlled Heated Mattresses
- Extra-Large 2.5 Cubic Ft. Refrigerator
- Add-A-Room w/ Privacy Panels
- Overhead Kitchen Pantry
- Hanging Wardrobe
- Air Conditioning Wiring Kit
- Dual 20 lb. LP Bottles w/Cover
- Travel Pack (Incl. Spare Tire, Tire Bracket, Tire Cover, Installed Step)
- Convenience Pack (Incl. Privacy Curtains, Roof Valances, A/C Bracing, Patio Light, 110V Exterior Outlet)

HARD SIDE ADDITIONAL OPTIONS

- Power Front Jack

CLASSIC SERIES SPECIFICATIONS

MODEL	425D	620ST	625D	720BH	823D
GVWR	3263	3136	3252	3235	3318
BASE/DRY UNIT WEIGHT	2446	1917	2473	1917	2445
BASE DRY HITCH WEIGHT	303	247	292	275	358
BASE DRY AXLE WEIGHT	2143	1670	2181	1642	2087
CARGO CAPACITY	798	1017	760	1299	854
BOX SIZE	12'	10'	12'	10'	12'
TRAILER SIZE (CLOSED W/ HITCH)	19' 1"	16' 5"	19' 1"	16' 7"	19' 1"
HEIGHT (CLOSED)	61"	57"	61"	57"	61"
TRAILER LENGTH (OPEN)	23' 6"	20' 2"	23' 6"	20' 2"	23' 6"
FRESH WATER CAPACITY	26	26	26	26	26

Model number of any particular unit does not necessarily reflect the overall length of the unit itself. Dry weight are estimates.



A

FLAGSTAFF CLASSIC SERIES

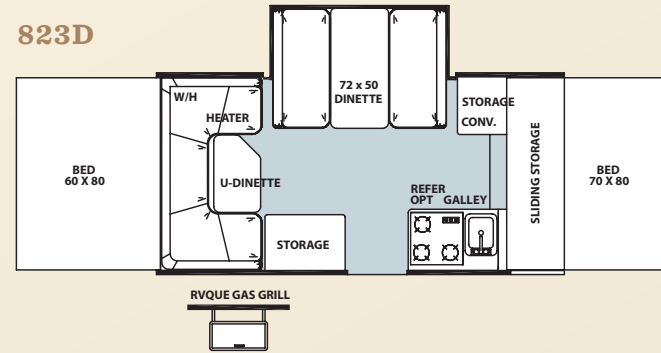
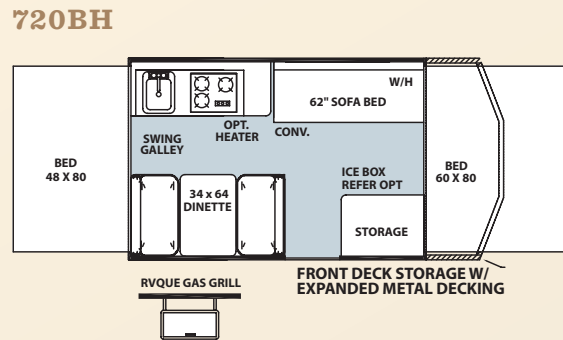
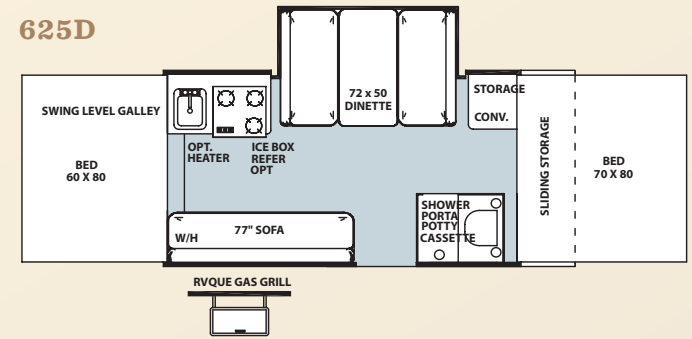
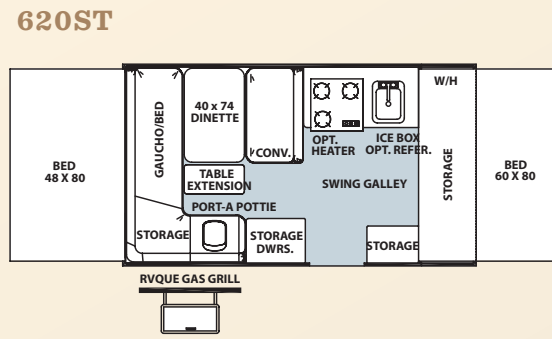
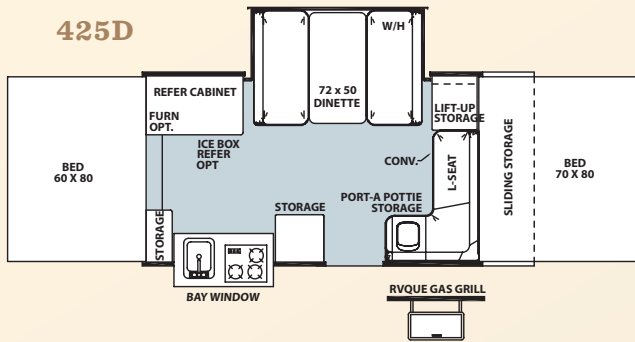

FLAGSTAFF POPULAR FEATURES

- A. Add-A-Room with Privacy Panels
- B. Hanging Wardrobe
- C. Hanging Pantry
- D. Power Lift (Opt. LTD. and Freedom)

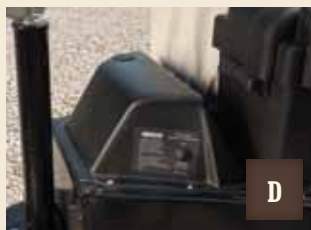
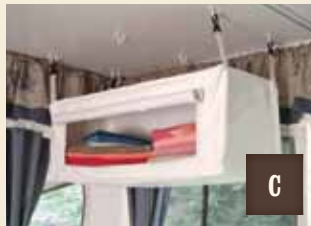

FLAGSTAFF MAC/LTD SERIES STANDARDS & OPTIONS

MAC/LTD STANDARD FEATURES

- Oak Interior with "Tile-Look" Linoleum
- Two-Tone Fabric Interiors
- Residential Kitchen Faucet w/ Electric Water Pump
- Water Filtration System w/ All Shower Models (MAC Only)
- Port-a-Potty (206ST Only)
- Shower Cassette Package (205, 246D, BR23SC, BR24SC, BR28TSC)
- Swing Level Galley with Storage (MAC Only)
- Metal Drawer Guides
- Permanently Mounted 3 Burner Indoor Range (MAC Only)
- Large Built-In Icebox
- Free Standing Table – High Pressure Laminate
- Comfortable Family Style Dinette w/ Cushions
- LP Leak Detector
- 35 Amp Converter w/ Built in Battery Charger (MAC Only)
- Automatic 12 Volt Safety Switch
- Soft Quilted-Top Bed Mattresses
- Leaf-Spring Axle
- Easy Lube Axles (MAC Only)
- 13" Radial Tires (MAC Only)
- 15" Mud Rover Tires w/ Al. Wheels Shocks (BR23SC, BR24SC, BR28TSC Only)
- Electric Brakes (MAC Only)
- Power Lift System (BR23SC, BR24SC, BR28TSC Only)
- Battery Box (MAC Only)
- 20 lb LP Bottle

- (2) 20 lb LP Bottles (BR23SC, BR24SC, BR28TSC Only)
- 28.5" Front Storage Deck (206BH, 228BH Only)
- 48" Front Storage Deck (BR23SC Only)
- 96" Front Storage Deck (BR24SC, BR28TSC Only)
- Diamond Plated Front, Rear and Side Skirt (BR23SC, BR24SC, BR28TSC Only)
- Awning
- Outside Gas Grill (MAC Only)
- Exterior Work Table (MAC Only)
- Folding Grab Handle (MAC Only)
- One Piece Screen Door (MAC Only)
- Installed Double Step (BR23SC, BR24SC, BR28TSC Only)
- Exterior Graphic Design

LTD ADDITIONAL STANDARD FEATURES

- Fold Over Galley with Upper and Lower Storage
- Two Burner Free-Standing Range
- 25 Amp Converter w/ Built in Battery Charger
- Roof Vent
- Privacy Curtains
- 10 Gallon Fresh Water Tank
- 12" Radial Tires
- Rear Crank Down Stabilizer Jacks w/ Sand Pads
- 110V Exterior Outlet (206 LTD only)
- Patio Light (206 LTD only)
- Installed Door Step
- Spare Tire

STANDARD CONSTRUCTION FEATURES

- Fiberglass Vacuum Bonded Radius Roof w/ No Center Seam
 - Three Stage Double Arm Lifter Posts
 - Main Door Operational in Closed Position
 - Five-Piece Vinolon Supreme Tenting
 - Tent Permanently Attached on Bunk Ends and Slide Out
 - Plywood Bunk Ends
 - Full Perimeter Aluminum Bed Frames
 - Powder Coated Rafter Poles and Bed Bows
 - Tinted Vinyl Windows
 - One-Piece Undercoated Structurewood Floor
 - Automotive E-Coated Tubular Steel Frame
 - (4) E-Z Crank Down Stabilizer Jacks w/ Sand Pads (MAC Only)
 - Seamless, High Density Polyethylene Wheel Wells
 - Under Floor 20 Gallon Fresh Water Tank (MAC Only)
 - 2,000 lb. Tongue Jack w/ Swivel Wheel
 - Seven-Way Pigtail Wiring
- ## MAC POPULAR OPTIONS
- Create-A-Breeze Three Speed Fantastic Fan
 - 20,000 BTU Forced Air Furnace w/ Electric Ignition
 - Air Conditioner Wiring Kit
 - Shower/Cassette Option: Incl. Water Filtration System, Six Gallon DSI Hot Water Heater, Demand Water Pump, and Cassette Toilet (Model 228, 228BH, 228D)
 - Hot Water Package w/ Outside Shower (206ST, 206BH,

- 207, 208, 227, 228, 228BH, 228D)
- Carbon Monoxide Detector
- Large 1.9 Cubic Ft. 3 Way Refrigerator
- Overhead Kitchen Pantry
- Thermostatically Controlled Heated Bed Mattresses
- Power Lift System (Std. BR23SC, BR24SC, BR28TSC)
- Dual 20 Lb. LP Bottles with Cover
- Add-A-Room w/ Privacy Panels
- Convenience Pack (Incl. Privacy Curtains, Roof Valances, A/C Bracing, Patio Light, 110V Exterior Outlet)
- Travel Pack (Incl. Spare Tire, Tire Bracket, Tire Cover, Installed Step)

LTD POPULAR OPTIONS

- Thermostatically Controlled Heated Bed Mattresses
- Large 1.9 Cubic Ft. Refrigerator
- 20,000 BTU Forced Air Furnace w/ Electronic Ignition
- Electric Brakes
- Outside Gas Grill
- Battery Box
- Power Lift
- Carbon Monoxide Detector
- Add-A-Room w/ Privacy Panels

MAC/LTD SPECIFICATIONS

MODEL	206ST	206BH	205	207	208	227	228	228BH	228D	246D	BR23SC	BR24SC	BR28TSC	176LTD	206LTD
GVWR	2990	3022	2785	2669	2607	3024	3077	3109	3059	2988	3770	3876	5576	2151	2274
BASE/DRY UNIT WEIGHT	1772	1809	1654	1638	1589	1892	1986	2037	2158	2278	2545	2388	2991	1347	1493
BASE DRY HITCH WEIGHT	241	272	223	240	230	274	327	359	309	238	270	376	190	175	174
BASE DRY AXLE WEIGHT	1531	1537	1431	1398	1359	1618	1659	1678	1849	2040	2275	2012	2801	1172	1319
CARGO CAPACITY	1066	1066	917	866	866	966	966	1053	882	691	1206	1469	2317	683	762
BOX SIZE	10' 10"	10' 10"	10' 10"	10' 10"	10' 12"	12' 12"	12' 12"	12' 12"	12' 14"	14' 12"	10' 10"	10' 12"	12' 12"	8' 8"	10' 10"
TRAILER SIZE (CLOSED W/ HITCH)	16' 5"	16' 7"	14'	14'	14'	15' 9"	15' 9"	18' 6"	15' 9"	17' 9"	21' 5"	23' 6"	25' 7"	12'	14'
HEIGHT (CLOSED)	57"	57"	57"	57"	57"	57"	57"	57"	57"	57"	62.5"	62.5"	62.5"	57"	57"
TRAILER LENGTH (OPEN)	20' 2"	20' 2"	20' 2"	20' 2"	20' 2"	22' 6"	22' 6"	22' 6"	22' 6"	24' 9"	27'	27'	30' 3"	17'	20' 2"
FRESH WATER CAPACITY	20	20	20	20	20	20	20	20	20	26	26	26	26	11	11

Model number of any particular unit does not necessarily reflect the overall length of the unit itself. Dry weight are estimates.

FLAGSTAFF MAC/LTD SERIES

206ST

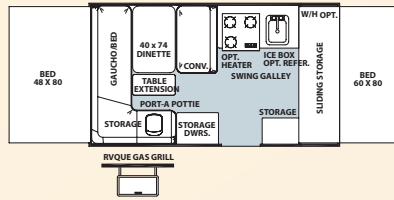

206BH

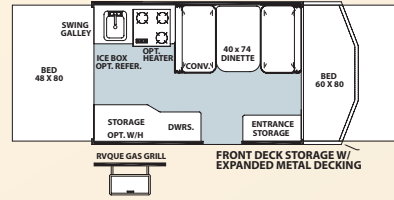

205

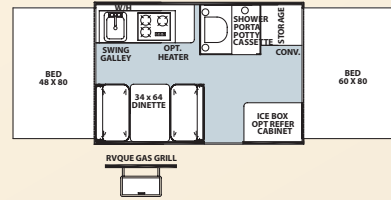

207

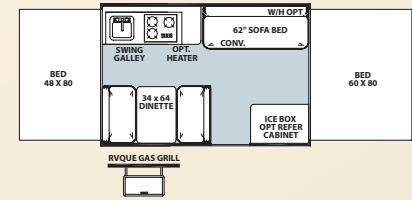

208

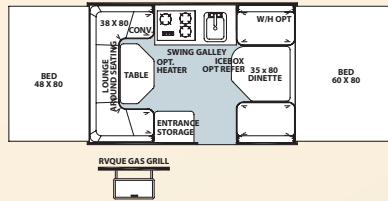

227

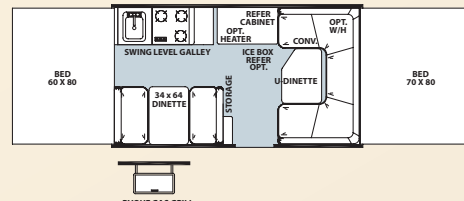

228

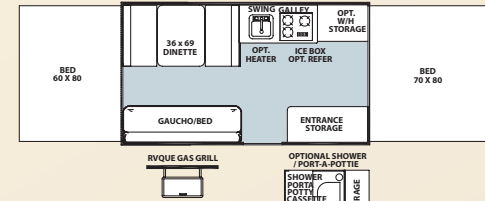

228BH

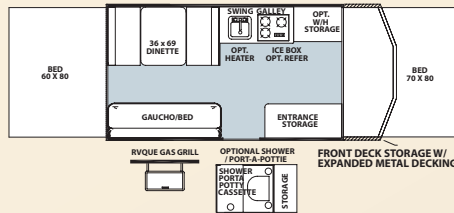

228D

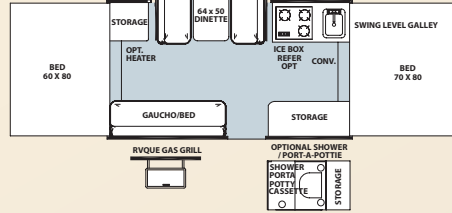

246D

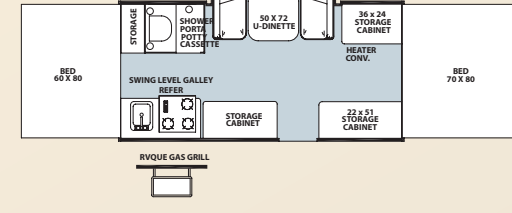

BR23SC

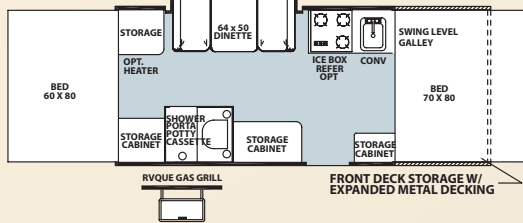

BR24SC

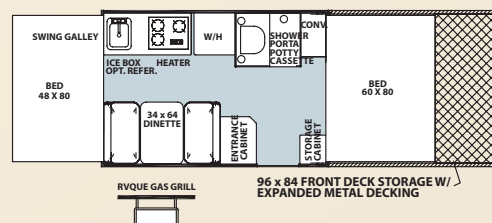

BR28TSC

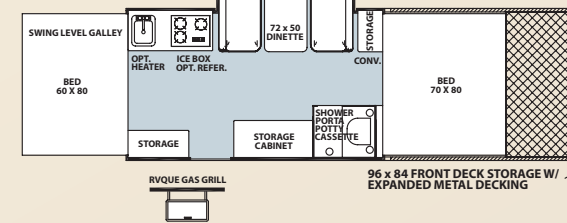

176LTD

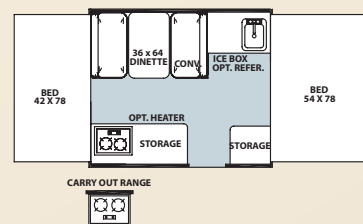

206LTD

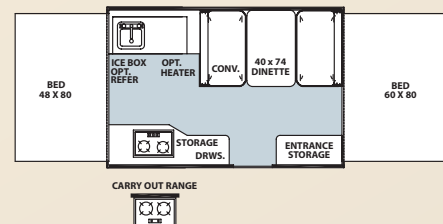

PEACE OF MIND.



Forest River has yet another exclusive feature to offer: One year of free roadside assistance will be given to every 2011 Flagstaff customer. This is just one more way to say “Thank you” and to ensure an enjoyable traveling experience.

FOREST RIVER ENCOURAGES YOU TO

BUY LOCALLY

FROM YOUR HOMETOWN DEALERSHIP.

Forest River, Inc. strongly encourages our retail customers to purchase from their local dealership whenever possible due to the following factors:

- 1) Our Dealers are as a rule, independently owned and operated businesses. Outside of those customers they personally sold products to, they are not contractually obligated to perform warranty service on Forest River products that were purchased elsewhere. There may be an occasion that you would be required to return to the point of purchase to satisfy warranty requirements.
- 2) Although many dealerships will eventually service products not purchased at their place of business, they will usually take care of their customers and other Forest River customers who are traveling away from their local dealer as they would their own.

3) Local purchases allow a customer to establish a relationship with a dealer close to home. This relationship provides the customer with a convenient location for service and support from a “home town” professional.

4) The opportunity for a thorough PDI (Pre Delivery Inspection) and product orientation is an additional benefit of buying from your local dealer. Further providing the opportunity for refresher courses or the ability to get questions answered much more conveniently.

5) For our Canadian customers, there are also requirements which must be met to bring an RV purchased out of the country to their home. Although not insurmountable, these requirements may involve such things as additional inspections and certifications, taxes and fees. Your local Canadian Dealer is a professional at meeting these requirements.

6) Forest River’s goal is for all RV Owners to fully enjoy their RV experience. In light of this goal, and considering the advantages of buying local, we encourage you to be thorough when determining what product to purchase and which dealer to purchase it from as both are key to your ultimate satisfaction and the realization of your dreams.



Forest River’s Hallmark of Excellence **PRE-DELIVERY INSPECTION FACILITIES**

Brought online in 2005, Forest River is proud of its state-of-the-art test facility. This beautiful building blends many of the old tried and true methods of testing our diverse types of RVs with new innovative ways of solving quality issues. Being centrally located to most Forest River manufacturing facilities, this 20,000 square foot PDI (Pre-delivery Inspection) test building gives immediate daily feedback to individual managers. This assures the production facilities that nothing has slipped by the plant’s quality assurance personnel and the units are “green” and ready to ship.

Scan this barcode using a QR Reader on your smart phone to learn more about Forest River.

FLAGSTAFF WARRANTY PROGRAM

For details on Flagstaff’s complete warranty program, see your Flagstaff dealer. When it comes to backing products With the same quality and commitment it does when it begins the manufacturing process, the only name you have to remember when you’re looking for a recreational vehicle is Flagstaff. Flagstaff offers the following additional limited warranties to the original purchasers. Consult written warranty for details.

1. Five-year roof warranty, 2. Twenty-five-year floor warranty, 3. Five-year frame warranty, 4. Five-year tent warranty, 5. Five-year warranty on torsion axle suspension, 6. Limited life-time warranty of lifter system, 7. One-year bumper to bumper. Ask your dealer about the available lifetime structural warranty.

All specifications contained herein are based on the latest product information at time of printing. Forest River reserves the right to make changes in colors, materials, equipment and specifications at any time Without notice and assumes no responsibility for any errors in this brochure.



Forest River, Inc. 55470 C.R. 1 Elkhart, IN 46515 574.389.4600 www.forestriverinc.com
www.forestriveraccessories.com LITHO U.S.A FOR 0845

YOUR FLAGSTAFF DEALER

