

**Flagstaff** SUPER LITE, V-LITE, CLASSIC SUPER LITE TT & FW

# Flagstaff

SUPER LITE, V-LITE, CLASSIC SUPER LITE TT & FW







## 26BHS | LEAF WITH OAK

Our trailers are packed full of quality features in order to bring to you one of the best values in the light weight market. When you explore our floor-plans, you will notice many flush-floor slides, solid

wood doors and drawer fronts and expansive dinettes, utilizing free standing tables with adjustable swing level legs. We use only the best inside our "Super Lite Series."



# FLAGSTAFF SUPER LITE SERIES

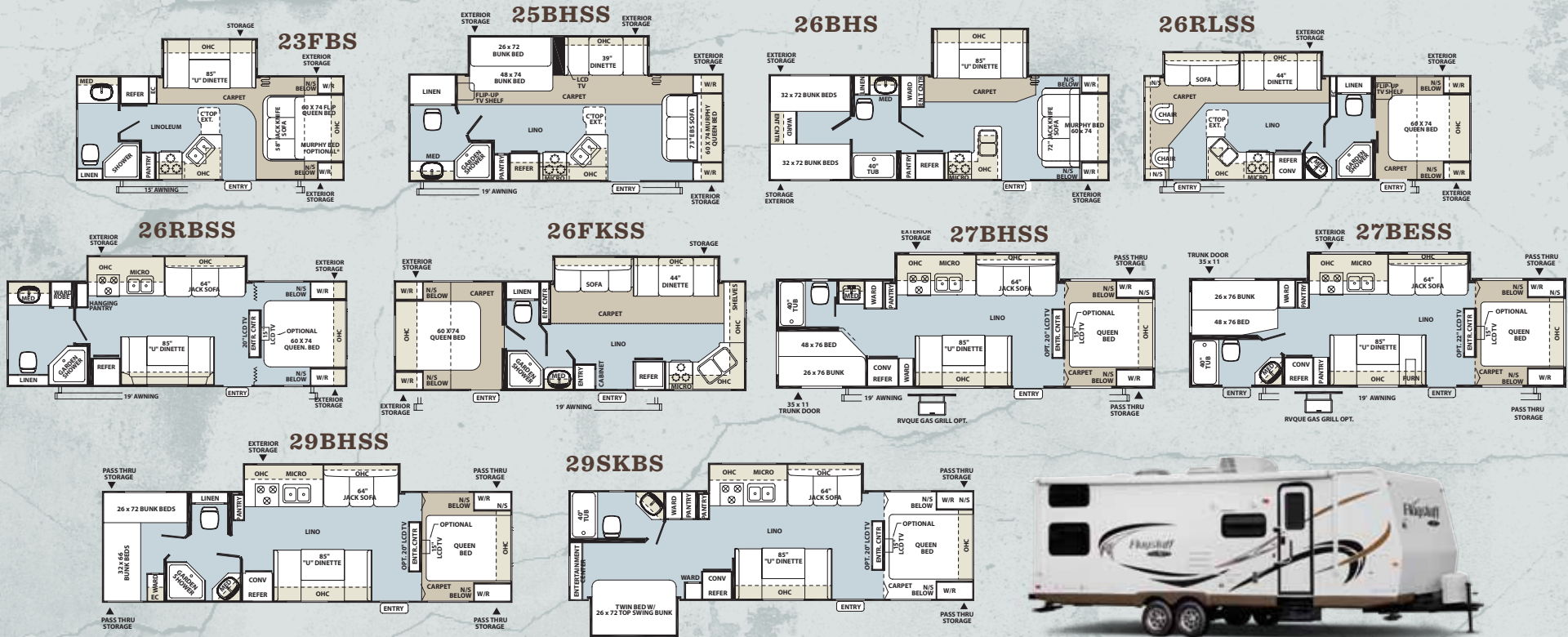

## SUPER LITE SERIES SPECIFICATIONS

MODEL	23FBS	25BHSS	26BHS	26RLSS	26RBSS	26FKSS	27BHSS	27BESS	29BHSS	29SKBS
GVWR (Gross Vehicle Weight Rating)	6594	6653	6767	6603	6580	6691	6570	6594	7383	7703
BASE/DRY UNIT WEIGHT	4400	5014	4923	5317	4707	5323	5177	5053	5163	5459
BASE DRY HITCH WEIGHT	678	653	767	603	580	691	570	594	579	703
BASE DRY AXLE WEIGHT	3722	4361	4156	4714	4127	4632	4607	4459	4584	4756
CARGO CAPACITY	1833	1601	1807	1249	1833	1330	1355	1503	1833	1833
LENGTH	23' 9"	27' 5"	29' 5"	29' 7"	29' 7"	29' 7"	31' 11"	31' 11"	33' 5"	33' 5"
WIDTH	96"	96"	96"	96"	96"	96"	96"	96"	96"	96"
HEIGHT W/O A/C	115"	118"	118"	118"	114"	120"	114"	114"	115"	115"
INTERIOR HEIGHT	78"	78"	78"	78"	78"	78"	78"	78"	78"	78"
FRESH WATER CAPACITY	36 gal	36 gal	36 gal	36 gal	36 gal	36 gal	36 gal	36 gal	36 gal	36 gal
GRAY WATER CAPACITY	37 gal	37 gal	37 gal	37 gal	37 gal	74 gal	74 gal	37 gal	37 gal	37 gal
BLACK WATER CAPACITY	37 gal	37 gal	37 gal	37 gal	37 gal	37 gal	37 gal	37 gal	37 gal	37 gal

Model number of any particular unit does not necessarily reflect the overall length of the unit itself. Dry weights are estimates.



26BHS BUNK ROOM



# FLAGSTAFF V-LITE SERIES

**21WRS**

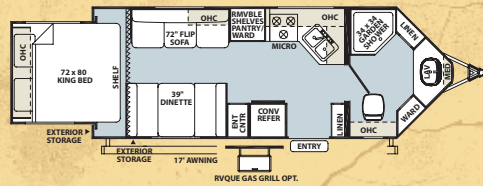

**26WRB**

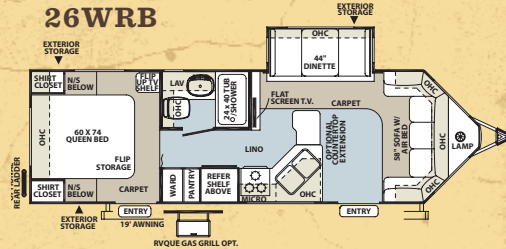

**30WRLS**

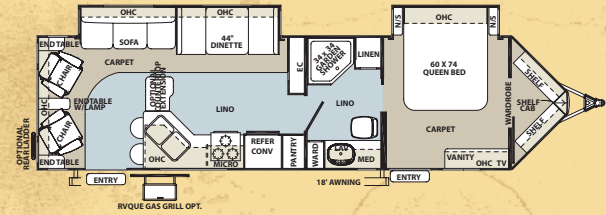

**30WRKSS**

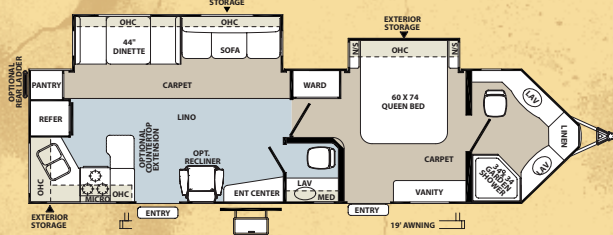

**30WTBS**

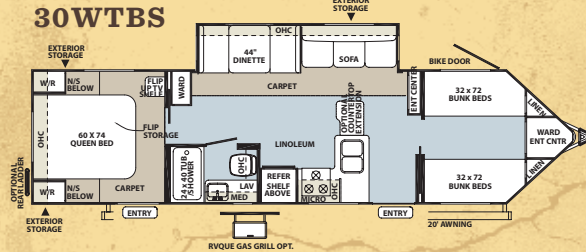

**30WFKSS**

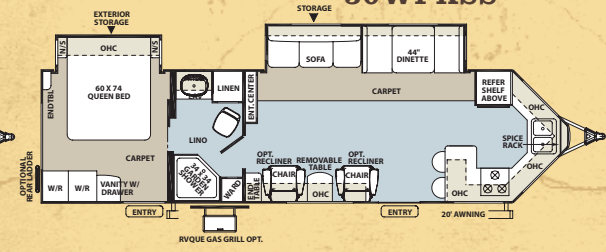

**30WRLTS**

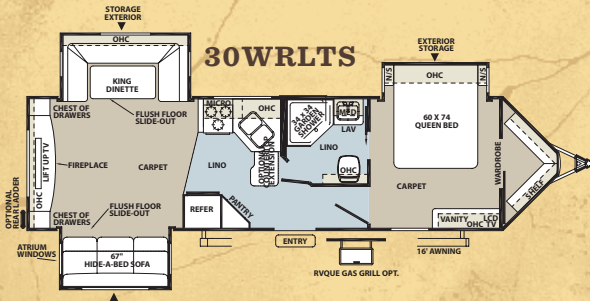

## SLIDE-OUT OPTIONS

Slide-out Option Available on Classic / V-Lites Only

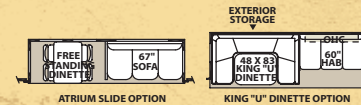

## V-LITE SERIES SPECIFICATIONS

MODEL	21WRS	26WRB	30WRLS	30WRKSS	30WTBS	30WFKSS	30WRLTS
GVWR (Gross Vehicle Weight Rating)	7028	8659	8848	8832	8402	8742	8760
BASE/DRY UNIT WEIGHT	4781	5293	6616	6447	6129	6544	6744
BASE DRY HITCH WEIGHT	577	659	848	832	974	742	760
BASE DRY AXLE WEIGHT	4204	4634	5768	5615	5155	5802	5984
CARGO CAPACITY	1900	1900	1900	1900	1900	1900	1900
LENGTH	24' 8"	29' 5"	34' 3"	34' 3"	34' 3"	34' 3"	34' 3"
WIDTH	96"	96"	96"	96"	96"	96"	96"
HEIGHT W/O A/C	120"	120"	120"	120"	120"	120"	120"
INTERIOR HEIGHT	78"	78"	78"	78"	78"	78"	78"
FRESH WATER CAPACITY	43 gal	43 gal	43 gal	43 gal	43 gal	43 gal	43 gal
GRAY WATER CAPACITY	38 gal	32 gal	38 gal	76 gal	38 gal	70 gal	38 gal
BLACK WATER CAPACITY	38 gal	38 gal	38 gal	76 gal	38 gal	38 gal	38 gal

Model number of any particular unit does not necessarily reflect the overall length of the unit itself. Dry weights are estimates.







### 30WFKSS | SEDONA WITH COMBO

The Flagstaff V-Lite uses every possible space for interior room and storage, thanks to its “V” nose design. While the aerodynamic, six-sided vacuum-bonded exteriors can be towed by a wide

variety of vehicles on the market, the available standards and options provide extensive customization for each individual consumer.



A. Extra large dinette storage drawers

B. Full extension metal drawer guides in the kitchen

C. Day night shades (Std. V-Lite and Classic Super Lite, Opt. Super Lite)

D1. Residential Style Air Bed Sofa (Opt. Std. on 26RLSS, 26FKSS, and V-Lite)

D2. Full 60" x 80" queen air mattress on Standard Sofa (48" x 80" with King-U-Dinette option)

D3. Additional storage under sofa

E. Forest River Switch Center (N/A Super Lite)

F. Gaming Plate (Std. on V-Lite, Classic Super Lite, Opt. on Super Lite)

G. Serta Residential grade mattress (N/A Super Lite, CP: on V-Lite, Classic Super Lite)





# FLAGSTAFF POPULAR STANDARD AND OPTIONAL FEATURES

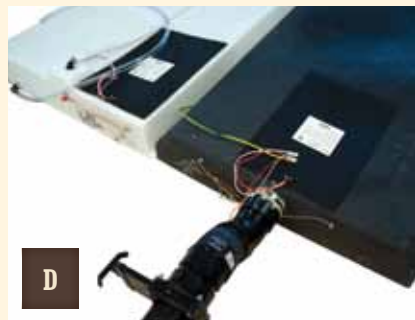

A. Door side cable hook up (N/A Super Lite)

B. Heated pass through storage with separated front trunk area. (Std. on all 5th Wheels)

C. Large LCD TV and entertainment center (Std. on most models)

D. Heated holding tanks with 12 Volt heat pads. (Std. on Classic Super Lite, V-Lite and Opt. on Super Lite)

E. Free-standing chair with seat storage & table extension (Opt.)

TUSCAN CREAM DÉCOR OPTION



WOOD-LOOK FLOOR COVERING  
ONLY AVAILABLE WITH TUSCAN CREAM & COMBO DÉCOR  
(NA WITH SUPER LITE MODELS)

## LUXURIOUS RESIDENTIAL FABRICS

LEAF



SEDONA



SIESTA SAND

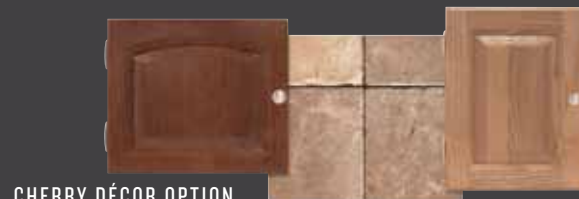

CHERRY DÉCOR OPTION

STANDARD FLOOR COVERING

OAK DÉCOR OPTION

# FLAGSTAFF HIGH QUALY CONSTRUCTION

A. All Steel "I" beam frame construction

B. Aluminum bed frames with gas strut storage at the foot of the beds. (Drawer storage most models)

C. Aluminum dinette frames for added strength and weight savings

D. Enclosed underbelly protects trailer components as well as increasing aerodynamics

E. Front window with rock guard for additional daylight (Most models)

F. TPO front cap adds strength and durability. (Std. Classic TT and FW)







A



B



C



D

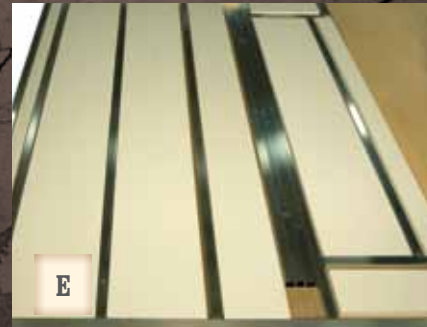

E



F1



F2



F3

A. Flagstaff is one of the strongest light weight trailers on the market because the trailers are vacuum bonded on all six sides. The walls, floors, roof and fronts and backs have been vacuum bonded to make sure your trailer is light weight and built to last.

B. Structurally engineered materials makes our vacuum-bonded walls some of the strongest in the industry.

#### C. ALKO® AXLES AND EASY LUBE HUBS

- Four wheel independent wheel suspension.
- Lower trailer center of gravity for improved stability.
- No metal to metal contact and no springs, shackles, hangers, or U-bolts to break or wear out.

D. Glued and screwed wood cabinetry

E. Vacuumed bonded floor with 16" on center aluminum floor joists

#### ROOF CONSTRUCTION

F1. Vacuumed bonded roof with 2" radius

F2. Radius roof foam with built in A/C ducts

F3. 4.5" thick roof foam





### 831FKBSS | LEAF WITH COMBO

The Classic series has many outstanding features to enhance your camping experience. The cabinet filled kitchen with large picture window and comfortable seating help bring the feel of

home to your outdoor experience. The expansive floorspace and seating available throughout the camper gives everyone plenty of room to move about or simply sit and enjoy themselves.



# FLAGSTAFF CLASSIC SUPER LITE SERIES TRAVEL TRAILERS

**SLIDE-OUT OPTIONS**  
 Slide-out Option Available on Classic / V-Lites Only

Options include:  
 - Atrium Slide Option: Free Handing Dinette, 60\"/>



## CLASSIC SUPER LITE SERIES SPECIFICATIONS

MODEL	829RKSS	829BHSS	830RBSS	831BHDS	831KRSS	831RLSS	831RLBSS	831FKBSS	831DBSS	831QBSS	831KDSS	831RKSS	831FLSS
GVWR (Gross Vehicle Weight Rating)	8344	8312	8657	8928	8790	8504	8780	8814	8512	8487	8424	8544	8764
BASE/DRY UNIT WEIGHT	5887	5947	6302	6769	6340	5981	6379	6476	6085	5981	5938	6094	6559
BASE DRY HITCH WEIGHT	536	771	840	928	790	639	780	814	844	1023	974	968	764
BASE DRY AXLE WEIGHT	5351	5176	5462	5841	5550	5342	5599	5662	5241	4958	4964	5126	5795
CARGO CAPACITY	1900	1900	1900	1900	1900	1900	1900	1900	1900	1900	1900	1900	1900
LENGTH	32' 2"	31' 6"	33' 3"	33' 10"	34' 1"	34' 1"	34' 8"	34' 1"	34' 1"	34' 1"	34' 1"	33' 1"	32' 2"
WIDTH	96"	96"	96"	96"	96"	96"	96"	96"	96"	96"	96"	96"	96"
HEIGHT W/O A/C	120"	120"	120"	120"	120"	120"	120"	120"	120"	120"	120"	120"	120"
INTERIOR HEIGHT	78"	78"	78"	78"	78"	78"	78"	78"	78"	78"	78"	78"	78"
FRESH WATER CAPACITY	43 gal	43 gal	43 gal	43 gal	43 gal	43 gal	43 gal	43 gal	43 gal	43 gal	43 gal	43 gal	43 gal
GRAY WATER CAPACITY	38 gal	76 gal	38 gal	38 gal	70 gal	76 gal	38 gal	64 gal	38 gal	38 gal	38 gal	38 gal	38 gal
BLACK WATER CAPACITY	38 gal	38 gal	38 gal	38 gal	38 gal	38 gal	38 gal	38 gal	38 gal	38 gal	38 gal	38 gal	38 gal

Model number of any particular unit does not necessarily reflect the overall length of the unit itself. Dry weights are estimates.



Standard on Travel Trailer models: 829RKSS, 831RKSS, 831BHDS.

Standard on Fifth Wheel model: 8528TBWS



# FLAGSTAFF CLASSIC SUPER LITE SERIES FIFTH WHEELS

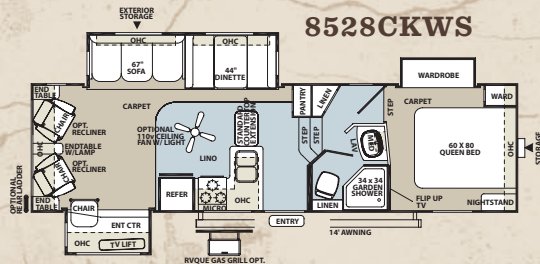
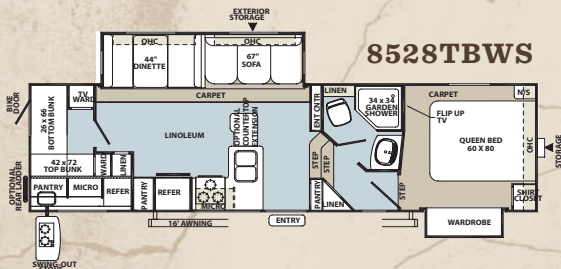
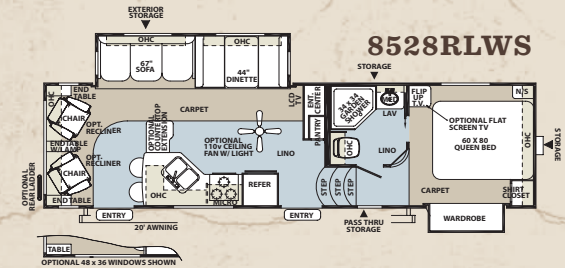
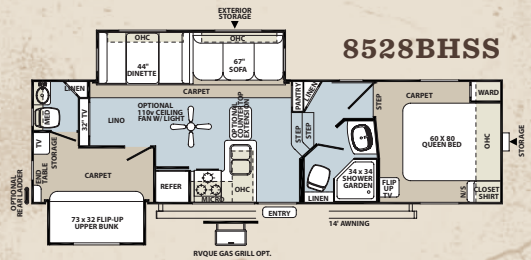
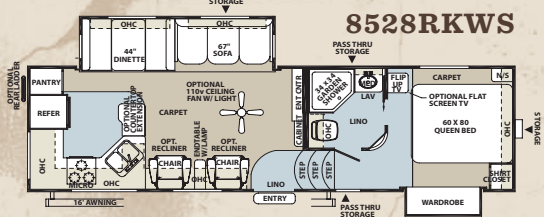
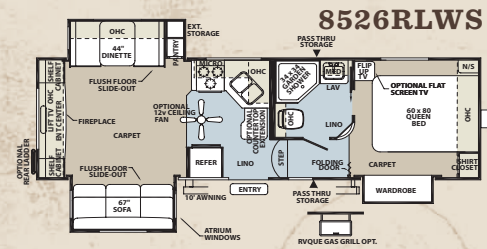
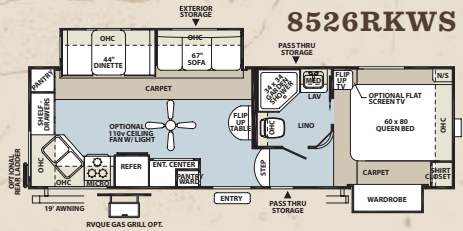
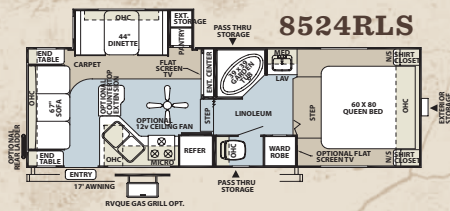

## SLIDE-OUT OPTIONS

Slide-out Option Available on Classic / V-Lites Only

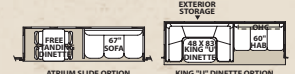

## CLASSIC SUPER LITE SERIES SPECIFICATIONS

MODEL	8524RLS	8526RKWS	8526RLWS	8528BHSS	8528RKWS	8528RLWS	8528TBWS	8528CKWS
GVWR (Gross Vehicle Weight Rating)	8188	8778	9144	9407	9134	9253	9522	9595
BASE/DRY UNIT WEIGHT	5880	6366	6773	7308	6870	6866	7346	7220
BASE DRY HITCH WEIGHT	997	1515	1200	1407	1134	1253	1522	1595
BASE DRY AXLE WEIGHT	4883	4851	5573	5901	5736	5613	5824	5625
CARGO CAPACITY	1900	1900	1900	1900	1900	1900	1900	1900
LENGTH	26' 3"	28' 10"	29'	30' 4"	30' 4"	30' 4"	30' 6"	31' 2"
WIDTH	96"	96"	96"	96"	96"	96"	96"	96"
HEIGHT W/O A/C	136"	136"	136"	146"	146"	146"	146"	146"
FRESH WATER CAPACITY	43 gal	43 gal	43 gal	43 gal	43 gal	43 gal	43 gal	43 gal
GRAY WATER CAPACITY	38 gal	76 gal	38 gal	76 gal	76 gal	76 gal	76 gal	76 gal
BLACK WATER CAPACITY	38 gal	38 gal	38 gal	76 gal	38 gal	38 gal	38 gal	38 gal

Model number of any particular unit does not necessarily reflect the overall length of the unit itself. Dry weights are estimates.







**8528CKWS | SIESTA SAND WITH CHERRY**

The Classic series includes large pass through storage with a separated front trunk area so you can bring all the things you desire to enjoy on your vacation. The spacious interior and picturesque

view through the many windows enable you to experience your surroundings in the comfort of your Classic fifth wheel trailer..



## FLAGSTAFF 2010 SUPER LITE, V-LITE & CLASSIC SUPER LITE STANDARDS & OPTIONS

MODELS	SL	V	CSL	MODELS	SL	V	CSL	MODELS	SL	V	CSL
<b>INTERIOR FEATURES</b>											
· Tuscan Cream, Oak, Cherry and Combo Interior (Combo NA in SL models)	0	0	0	· LCD TV With 5.1 Digital Dolby Surround Sound Speaker System (N/A 23FBS)	0	S	S	· 48" X 84" Spacious King-U-Style Dinette (Std. w/ SL: 23FBS, 26BHS, 27BHSS, 29BHSS, 29SKBS V:30WRLTS)(N/A w/ V: 21WRS, 26WRB CSL: F8524RLS, F8526RLWS, F8528CKWS)	S	S/O	0
· Decorative Solid Wood Slide Out Fascia	--	S	S	· Digital AM/FM/DVD w/ Remote	CP	S	S	· Free Standing High Pressure Laminated Table with Swing Level Leg	S	S	S
· Solid Wood and Raised Panel Doors and Drawers	S	S	S	· MP3 Player Hook-Up	S	S	S	· Free Standing Table and Chairs (SL: 26RLSS, 26FKSS Only)	0	0	0
· Screwed and Glued Cabinetry	S	S	S	· Satellite Radio	0	S	S	· Stainless Steel Appliances	0	0	0
· Residential Full Extension Metal Drawer Guides in Kitchen	S	S	S	· Mounted 22" LCD TV	CP	--	--	· Raised Refrigerator Panels	0	0	0
· Flooring: Carpet and an Engineered Mold and Mildew Resistant Floor Covering	S	S	S	· 22" LCD TV Mounted in Bedroom (Std. on all TT Center Entertainment Floor Plans)	--	--	S	· Auto Gas/Electric Refrigerator	S	S	S
· Minimum Carpet available	0	0	0	· LCD Bedroom TV	--	0	0	· Three Burner High Output Gas Range	S	S	S
· Floor Ducted Furnace	S	S	S	· Drop Down 22" LCD TV in O/S Kitchen (829RKSS and 8528TBWS Only)	--	--	S	· Gas Oven With Piezo Ignition	CP	S	S
· 13,500 BTU Ducted Roof Air	CP	CP	CP	· Air Hide-A-Bed Sofa w/ Storage (N/A w/ V: 21WRS, CSL: F8524RLS)(Std. w/ SL: 26RLSS, 26FKSS, V: most models)	S	S	0	· Microwave	CP	CP	CP
· 15,000 BTU Ducted Roof Air	0	0	0	· Swivel Chair (Where Available)	S	S	S	· Large Double Bowl Sink w/ Residential Style Faucet	S	--	--
· Ceiling Fans (Fifth Wheels)	--	--	0	· Lazy Boy Leather Recliner Option: Available 'ILO All Units with Barrel Chairs (N/A w/ V: 30WRLS, CSL: 831FLSS)	--	0	0	· New Flush Mount Stone Cast Sinks with Lift Off Kitchen Faucets	--	S	S
· Carbon Monoxide Detector	SO	SO	SO	· End Table with Attached Lamp (Where Available)	S	S	S	· Residential One-Piece Sink Cover/ Cutting Board	S	S	S
· 12 Volt Power Plug Hook-up	S	S	S	· Designer Valances w/ Lambrequin Arms	S	S	S	· Water-Pur Filtration System	SO	SO	SO
· CSA	0	0	0	· Mini Blinds	S	--	--	· Counter Top Extension (N/A w/ V: 30WFKSS CSL: 831FKBSS, F8526RKWS) Avail. w/ SL: 23FBS, 25BHSS, 26RLSS Only)	0	0	0
· Monitor Panel	S	S	S	· Day/Night Shades	0	S	S	· Trash Can in Kitchen (Most Models)	--	S	S
· 55 Amp Converter With Charger	S	S	S	· Aluminum Bed and Dinette Frames	S	S	S	· Tub Surround	S	S	S
· Interior Floor Light by Entrance Door	--	S	S	· 44" Family Style Dinette (N/A w/ L: 2FBS, 27BHSS, 29BHSS, 29SKBS V:30WRLTS)	S	S	S				
· Directional Reading Lights on Sofa Slides	S	S	S								
· Residential Dome Style Lights Over Sofa and Table	--	S	S								
· Upgraded Recessed Lighting Around Medicine Cabinet	--	S	S								

SL = SUPER LITE, V = V-LITE, CSL = CLASSIC SUPER LITE

S = STANDARD

SO = STANDARD OPTION

0 = OPTIONAL

-- NOT AVAILABLE

CP = CONVENIENCE PACKAGE



## FLAGSTAFF 2010 SUPER LITE, V-LITE & CLASSIC SUPER LITE STANDARDS & OPTIONS

MODELS	SL	V	CSL	MODELS	SL	V	CSL	MODELS	SL	V	CSL
· Bathroom Skylight	S	S	S	· CSL: 830RBSS)	0	0	0	· Two 30 lb Gas Bottles	--	S	S
· Six Gallon "Quick Recovery" 110 DSI Gas/Electric Water Heater	CP	S	S	· Laminated Fiberglass Sidewalls:				· Molded Bottle Cover	S	S	S
· Water Heater By-Pass Kit	S	S	S	· Lamilux 1500	S	--	--	· Surface Coated Steel I-Beam Frame	S	S	S
· Residential Style Porcelain Bowl Foot Flush Toilets	--	--	S	· Lamilux HG 4000 with High Gloss Finish	--	CP	CP	· Power Front Jack (Std on 5th wheels)	0	0	0
· Foot Flush Toilets	S	--	--	· Electric Slide-Out	S	S	S	· Stabilizer Jacks	S	S	S
· Create-a-Breeze Three Speed Fantastic Vent	SO	SO	SO	· Decorative Frame Skirting	S	S	S	· Power Stabilizer Jacks (Included in CP: All Fifth Wheel Models)	0	0	0
· Extra Create-a-Breeze fan	0	0	0	· Power Awning With Adjustable Rain Dump	CP	CP	CP	· Torsion Axle, Rubber-Ryde Suspension	S	S	S
· Residential Serta Mattress	--	CP	CP	· Awning Slide Topper	0	0	0	· Easy Lube Axles	S	S	S
· Murphy Bed System for Unmatched Floor Plan				· 30" Entrance Door (Most Models)	--	S	S	· 14" Tires With Double Step	S	--	--
· Flexibility (SL: 23FBS, 25BHSS, 26BHS Only)	S	--	--	· Lighted Entry Step	--	S	S	· 15" Tires With Triple Step	--	S	S
· Heated Mattress	SO	0	0	· Large Grab Handles	CP	S	S	· Aluminum Wheels	0	CP	CP
				· Windows w/ Tinted Safety Glass	CP	CP	CP	· Chrome-Look Wheel Covers	0	--	--
				· Storm Windows available	0	0	0	· Spare Tire Carrier & Cover	CP	CP	CP
				· Atrium Slide Windows ( Super Slides)	--	0	0	· Enclosed Holding Tanks	S	S	S
				· Outside Gas Grill and Worktable	CP	0	0	· Electronically Controlled Heated Holding Tanks	0	S	S
				· Outside Grill Prep	--	S	S	· Black Water Flush	S	S	S
				· Outside Speakers	CP	CP	CP				
				· Outside Shower	S	S	S				
				· 1/2 Sliding Storage Tray (N/A 25BHSS)	0	--	--				
				· Front Outside Storage Separated From Pass Thru Storage (Fifth Wheel Models Only)	--	--	S				
				· Two 20 lb Gas Bottles	S	--	--				

### EXTERIOR FEATURES

· Fully Laminated Aluminum Frame (Floor, Sidewall, & Roof)	S	S	S
· Insulation Factors R-7 Side Wall, R-12 Floor and R-14 Roof	S	S	S
· Radius Roof	S	S	S
· Vinyl / Rubber Composite Roofing Membrane	S	S	S
· TV Antenna w/ Cable & Satellite Hook-Up	S	S	S
· Rear Ladder (N/A w/ V: 21WRS)			



SL = SUPER LITE, V = V-LITE, CSL = CLASSIC SUPER LITE

S = STANDARD

0 = OPTIONAL

CP = CONVENIENCE PACKAGE

SO = STANDARD OPTION

-- NOT AVAILABLE



## PEACE OF MIND.



Forest River has yet another exclusive feature to offer: One year of free roadside assistance will be given to every 2011 Flagstaff customer. This is just one more way to say “Thank you” and to ensure an enjoyable traveling experience.

FOREST RIVER ENCOURAGES YOU TO

## BUY LOCALLY

FROM YOUR HOMETOWN DEALERSHIP.

Forest River, Inc. strongly encourages our retail customers to purchase from their local dealership whenever possible due to the following factors:

- 1) Our Dealers are as a rule, independently owned and operated businesses. Outside of those customers they personally sold products to, they are not contractually obligated to perform warranty service on Forest River products that were purchased elsewhere. There may be an occasion that you would be required to return to the point of purchase to satisfy warranty requirements.
- 2) Although many dealerships will eventually service products not purchased at their place of business, they will usually take care of their customers and other Forest River customers who are traveling away from their local dealer as they would their own.

3) Local purchases allow a customer to establish a relationship with a dealer close to home. This relationship provides the customer with a convenient location for service and support from a “home town” professional.

4) The opportunity for a thorough PDI (Pre Delivery Inspection) and product orientation is an additional benefit of buying from your local dealer. Further providing the opportunity for refresher courses or the ability to get questions answered much more conveniently.

5) For our Canadian customers, there are also requirements which must be met to bring an RV purchased out of the country to their home. Although not insurmountable, these requirements may involve such things as additional inspections and certifications, taxes and fees. Your local Canadian Dealer is a professional at meeting these requirements.

6) Forest River’s goal is for all RV Owners to fully enjoy their RV experience. In light of this goal, and considering the advantages of buying local, we encourage you to be thorough when determining what product to purchase and which dealer to purchase it from as both are key to your ultimate satisfaction and the realization of your dreams.



## Forest River’s Hallmark of Excellence **PRE-DELIVERY INSPECTION FACILITIES**

Brought online in 2005, Forest River is proud of its state-of-the-art test facility. This beautiful building blends many of the old tried and true methods of testing our diverse types of RVs with new innovative ways of solving quality issues. Being centrally located to most Forest River manufacturing facilities, this 20,000 square foot PDI (Pre-delivery Inspection) test building gives immediate daily feedback to individual managers. This assures the production facilities that nothing has slipped by the plant’s quality assurance personnel and the units are “green” and ready to ship.

Scan this barcode using a QR Reader on your smart phone to learn more about Forest River.

## FLAGSTAFF WARRANTY PROGRAM

For details on Flagstaff’s complete warranty program, see your Flagstaff dealer. When it comes to backing products with the same quality and commitment it has when it begins the manufacturing process, the only name you have to remember when you’re looking for a recreational vehicle is Flagstaff. Flagstaff offers the following additional limited warranties to the original purchasers. Consult written warranty for details.

1. Twelve-year vinyl roof warranty, 2. Two-year fiberglass warranty, 3. Five-year axle warranty, 4. One-year bumper to bumper, 5. Available second-year warranty.

## YOUR FLAGSTAFF DEALER



All specifications contained herein are based on the latest product information at time of printing. Forest River reserves the right to make changes in colors, materials, equipment and specifications at any time Without notice and assumes no responsibility for any errors in this brochure.



Forest River, Inc. 55470 C.R. 1 Elkhart, IN 46515 574.389.4600 [www.forestriverinc.com](http://www.forestriverinc.com)  
[www.forestriveraccessories.com](http://www.forestriveraccessories.com) LITHO U.S.A FOR 0867