



Mintaro®

Due to continuous product improvement, please see the website for the latest in standards and options, specifications, and technical data. *Go to www.holiday Rambler.com.*



The Mintaro features a full 60 x 80 queen bed (not short queen). Usable drawers in both nightstands, along with ample storage and closet space, make the bedroom ideally functional.



The bathroom includes vanity light bar and ample storage space in cabinets.



Skylight in shower is standard!



Optional gas/electric DSI water heater

BODY CONSTRUCTION

- 6" I-Beam Frame Powder Coated (26 BHS)
- 8" I-Beam Frame Powder Coated (28 RLS)
- 10" I-Beam Frame Powder Coated (N/A 26 BHS & 28 RLS)
- White Wheels
- Frame Mounted Entry Step (Self Storing Single Step) Double steps (26 BHS & 28 RLS)
- Frame Mounted Entry Step (Self Storing Single Step) Triple steps (N/A 26 BHS & 28 RLS)
- Tandem Axles with 10" Electric Brakes
- 16" on Center 2x2 Sidewall Studs with R-7 Insulation
- .024 Aluminum Sidewall Exterior
- 5/8" Thick Flooring
- Roof; Seamless Rubber with 5" Wood Trusses, and Fiberglass Insulation. Walkable Deck, with Ducted Roof for Air Conditioning
- Rain Gutters with Downspouts Above Slide-outs
- Diamond Plate Front Lower Panel of Coach
- Molded ABS Fender Skirts - White
- Vinyl Exterior Graphics

APPLIANCES AND ACCESSORIES

- Double Door 6 cu. ft. Refrigerator
- Wedgewood 3-Burner Cooktop
- Lighted Powered Range Hood
- Pre-Wire for Microwave
- TV Prep and Mounting Bracket
- Systems Monitor Panel - Battery Levels, Holding Tank Levels, & Water Pump Switch

INTERIOR

- Golden Select Cabinetry
- Square Raised Panel Upper Cabinet Doors and Frame Flat Panel Base Cabinet Doors with Mortise and Tenon Corners
- Wood Grain Panel Refrigerator Insert doors
- Metal Drawer Glides
- Wallpaper Border Main Kitchen and Bath
- Kitchen Soffit Lights
- Decorative Slide-out Fascia
- Main Floors Linoleum Throughout
- Wood Grain Bath Door
- Wood Grain Swing Door to Bedroom (30 QBHS & 32 RLS)
- Fabric Close-off Curtain To Main Bedroom (28 RLS)
- Fabric Close-off Curtain Bunks (N/A 28 RLS & 32 RLS)
- Pleated Folding Door Close-off to Bedroom (26 BHS & 31 BHDS)
- Mini Blinds Throughout (Except Bunk Location)

FURNITURE

- Queen Bed 60" x 80"
- Lower Bunk Full Bed (31 BHDS)
- Bunk Bed with Vinyl Back Upper Only (31 BHDS)
- Bunk Beds w/Vinyl Backs Upper and Lower (26 BHS)
- Double Bunk Beds
- Fabric Covered Fold Down Sleeper Sofa
- Booth Dinette with Fabric Cushions with Vinyl Backs, End Door Storage Both Booths

ELECTRICAL SYSTEMS AND LIGHTS

- Electrical Management System - 30AMP
- 30 Amp Power Cord
- A-Frame Battery Rack
- 55 Amp Converter with Charger
- Porch Light / Security Light
- Patio Side 120V Exterior Recept
- Patio Side Cable TV Hook-up
- Double Pancake All Ceiling Locations
- Interior Ceiling Light Switches
- Kitchen Soffit Lights
- Single Pancake Lights at Bunk Locations (N/A 28 RLS & 32 RLS)

PLUMBING AND LP SYSTEMS

- Platinum Double Bowl Kitchen Sink with Hi-rise Goose Neck Faucet
- 6-Gallon L.P. Water Heater
- Water Heater By-pass
- Thetford Toilet - with Foot Flush
- Two 20 lb. L.P. Tanks with Automatic Changeover
- Rotocast Holding Tanks
- Rotocast Fresh Tank

HEATING, VENTS & A/C

- Electronic Ignition Furnace
- Gas Line Hook-Up at Front of Coach

WINDOWS, AWNINGS

- Radius Windows
- Safety Glass Windows (Opt to Std)
- Galley Window
- Entry Door with Window, Dead Bolt,
- Skylight in Bathroom
- Exterior Entry Assist Entry Door Handle

OPTIONS

- Spare Tire w/ABS Cover
- Stabilizer Jacks (4)
- Electric Tongue Jack with Light
- Rear Ladder
- Canadian RV Certification
- Wedgewood Oven with 3-Burner Cooktop
- Bi-Fold Range Cover
- Microwave
- Kitchen Sink Cover (1)
- 19" LCD TV Loose Ship
- 5.1 Home Theater w/DVD Player, (5) Interior Speakers, TV Antenna w/Cable Hook-ups
- 26" LCD TV (26 BHS & 31 BHDS)
- 19" LCD TV Loose Ship (N/A 26 BHS & 31 BHDS)
- TV Antenna w/Booster
- RVQ Grill w/Stand
- Decors - Autumn Trail, Brass Ring
- Carpet and Pad Living Area
- Carpet and Pad Bedroom
- Two Barrel Chairs with Center Table (28 RLS)
- Two Barrel Chairs IPO Jackknife Sofa (32 RLS)
- Hide-a-Bed with Air Mattress
- Freestanding Dinette with (4) Four Chairs
- 6-Gal. Gas/Elec. DSI Electronic Ignition L.P. Water Heater
- Two 30 lb. L.P. Tanks with Automatic Changeover with ABS Cover
- Outside Shower
- A/C 13,500 BTU - Ducted
- A/C 15,000 BTU - Ducted
- Patio Awning
- Bedroom Entry Door

EXTERIOR

Diamond plated front wall adds style and protects trailer against road elements. Enclosed underbelly protects tanks and provides extended camping season.



\\fileserv1\main_files\server\Artist\Active\W-90-043.HRMintaro.912014\912014...pdf Page 2 Author: Rampage Systems, Inc. Title: Extracraft\Hrpage Creator: Rampage JPF Imposition Producer: PPF\lib Personalization Server 7.0.0p3 (C++\Win32) Creation Date: D:20100302153433-05'00' 2400.0 dpi (Screened Data File POS, Right-Reading, Color-Setup, Std-OPP) [TRAP ABO:100 Scaling Percent: HF 100 WD 100 Vrs:\luc\ C:175815 M:175875 Y:17580 K:175845] bleed: 0.125 margin size: 0.375 PS Version: 3015.102 HQN Version 7.0 Revision 91 RSI System 10.5 Build: #43, Ripped on Tuesday, March 02, 2010 3:47:59 PM ID: swervin

9.9 9.8 9.5 9.4 9.3 9.2 9.1 9.0 8.9 8.8 8.7 8.6 8.5 8.4 8.3 8.2 8.1 8.0 7.9 7.8 7.7 7.6 7.5 7.4 7.3 7.2 7.1 7.0 6.9 6.8 6.7 6.6 6.5 6.4 6.3 6.2 6.1 6.0 5.9 5.8 5.7 5.6 5.5 5.4 5.3 5.2 5.1 5.0 4.9 4.8 4.7 4.6 4.5 4.4 4.3 4.2 4.1 4.0 3.9 3.8 3.7 3.6 3.5 3.4 3.3 3.2 3.1 3.0 2.9 2.8 2.7 2.6 2.5 2.4 2.3 2.2 2.1 2.0 1.9 1.8 1.7 1.6 1.5 1.4 1.3 1.2 1.1 1.0 0.9 0.8 0.7 0.6 0.5 0.4 0.3 0.2 0.1 0.0





26BHS

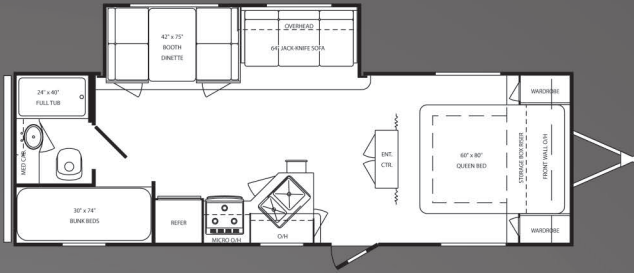

30QBHS

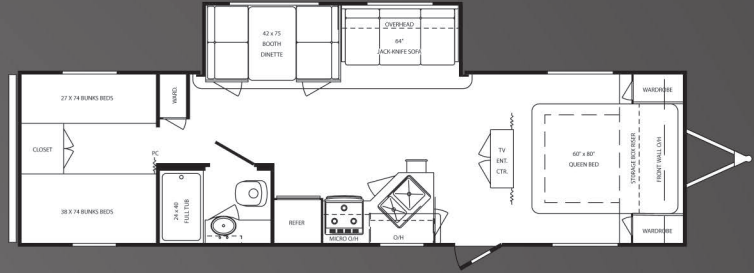

28RLS

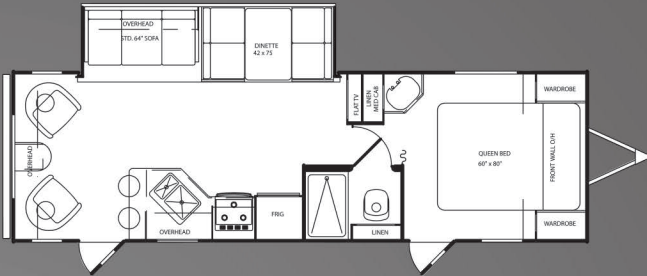

32RLS



31BHDS

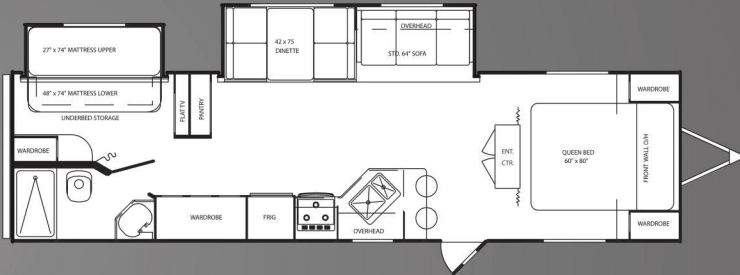

DECOR OPTIONS

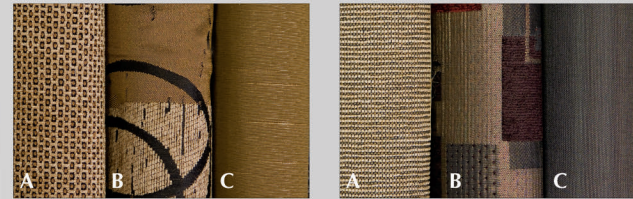

Brass Ring

Autumn Trail

A. Sofa

B. Accent

C. Bedroom



The Mintaro kitchen features real wood drawer fronts (not MDF) and raised panel doors with mortise and tenon construction for superior durability. A high arched residential faucet and coordinating appliances complete the elegant kitchen.

Enjoy the Mintaro's spacious, well appointed living space with plush amenities including 5" dinette cushions (not 4" low density) and optional hide-a-bed sofa with air mattress.

Creation Date: D:20100302153434-05'00'... Author: Rampage Systems, Inc. Title: Extracraft... PS Version: 3015.102 HQN Version 7.0 Revision 91 RSI System 10.5 Build: #43, Ripped on Tuesday, March 02, 2010 3:53:16 PM ID: swervin

99 98 95 9 2 35 9 35 98 99





2011 MINTARO®



HOLIDAY RAMBLER®
This is Living®

BEING DIFFERENT MAKES ALL THE DIFFERENCE.

At Holiday Rambler, it's our goal for all our customers to enjoy their RV experience from the beginning. We have forged strong, reliable relationships with our dealer partners, and we encourage our customers to do the same. We're proud to boast a large network of dealership partners and service centers across North America. We're confident that this relationship will only enhance your RV experience and provide the added peace of mind you desire, so you can focus on the important stuff. After all, we're not just selling a world-class product, we're selling "fun". You can rest assured, Holiday Rambler will be along for the ride, every mile your RV adventure takes you.

SPECIFICATIONS

2011 Specifications	26BHS	28RLS	30QBHS	31BHDS	32RLS
Weights					
Gross Vehicle Weight Rating	7,700	7,700	11,440	9,484	11,440
Dry Hitch Weight (Appr.)	600	625	733	816	TBD
Dry Axle(s) Weight (Appr.)	5,212	5,589	6,407	6,690	TBD
Dry Unloaded Vehicle Weight (Appr.)	5,812	6,214	7,140	8,668	TBD
Net Carrying Capacity (NCC)	1,888	1,486	4,300	2,794	TBD
Tire Size	14"	14"	15"	15"	15"
Tire Load Range	C	C	D	D	D
Measurements					
Overall Length	29'-0"	30'-3"	33'-10"	34'-8"	34'-6"
Overall Height (Including A/C)	11'-3"	11'-3"	11'-3"	11'-3"	11'-3"
Exterior Width (w/o Awning)	8'-0"	8'-0"	8'-0"	8'-0"	8'-0"
Tank Capacities					
Water Heater	6 Gal.	6 Gal.	6 Gal.	6 Gal.	6 Gal.
Grey Tank	40 Gal.	40 Gal.	35 Gal.	40 Gal.	TBD
Black Tank	40 Gal.	40 Gal.	35 Gal.	40 Gal.	TBD
Fresh Tank	40 Gal.	40 Gal.	40 Gal.	40 Gal.	TBD
Two 20 Lb. L.P. Tanks Standard (30 Lb. Tanks Optional)	S	S	S	S	S

* Weights may vary by options.
** Tank manufacturer's listed water capacity (WC). Actual filled LP capacity is 80% of listing due to safety shut off required on tank.

The actual overall length of the recreational vehicle may differ from that indicated in the brochure due to variances in the manufacturing process and/or installed components. The actual length may be greater or less than that indicated. Due to the large variety of options and floorplan arrangements available to our customers, actual weights for each unit can differ significantly. Monaco provides a weight sticker on each unit we produce which includes that unit's tank capacities and approximate weight. Consult your local Monaco dealer for unit availability and further information. The information printed in this brochure reflects product design, fabrication, and component parts at the date of printing. The manufacturer reserves the right, at any time, to make changes in product design or material or component specifications as its sole option, without notice. This includes the substitution of components of a different brand or trade name which will result in comparable performance. All information printed in this brochure is subject to change after the date of printing. Some features shown or mentioned in this brochure are optional and may not be available in selected floorplans. Photographs may show props or decorations that are not standard equipment. Monaco, the Monaco logo and its design, are registered trademarks. Other products and company names are trademarks and/or registered trademarks of their respective holders. While the color of the motorhome's exterior and the interior fabrics depicted in this sales brochure are fair and reasonable depictions, the colors depicted may not be an exact match of the actual colors because of the variances in photo-processing and printing. Due to product improvements, changes during the model year and/or transcription errors that may occur, information represented within this brochure may not be accurate at the time of your purchase. If certain information is significant to your purchasing decision, please confirm the information with your dealer. Component part and appliance manufacturers issue limited warranties covering portions of the recreational vehicle not covered under the Limited Warranties issued by Monaco RV, LLC. To learn specific details regarding warranty coverage, please contact your selling dealership or review the warranty packet inside the recreational vehicle.

606 Nelson's Pkwy., Wakarusa, IN 46573 | 800.245.4778 | www.holidayrambler.com

M-90-043 12/09 ©Monaco RV Litho USA

\\files\main\files\server\Artist\Active\ave\2011\mintaro\912014\912014_01.pdf Page 4 Author: Rampage Systems, Inc. Title: Extracraft\Frame Creator: Rampage JDF Imposition Producer: PDFLib Personalization Server 7.0.0p3 (C++/Win32) Creation Date: D:20100302153434-05'00' 2400.0 dpi (Screened Data File POS, Right-Reading, Color-Setup, Std-Over) [TRAP ABO;100 Scaling Percent: HT 100 WD 100 Vrs\luc\ C:175815 M:175815 Y:175815] bleed: 0.125 margin size: 0.375 PS Version: 3015.102 HQN Version 7.0 Revision 91 RSI System 10.5 Build: #43, Ripped on Tuesday, March 02, 2010 4:01:26 PM ID: swervin

