

# VIKING

Fold-Down Camping Trailers

The possibilities  
are endless.



# The Viking Difference

## Construction & Features Competitors Can't Match

### Warmest Folding Camper in the Industry

What would you rather sleep on?

#### Viking Standard

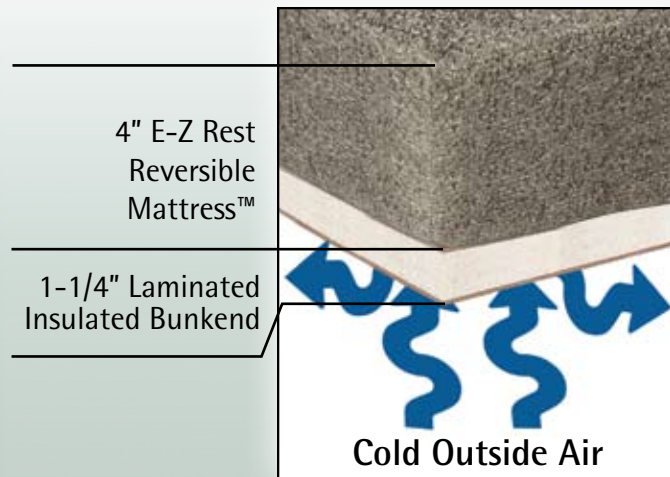

#### Competitors

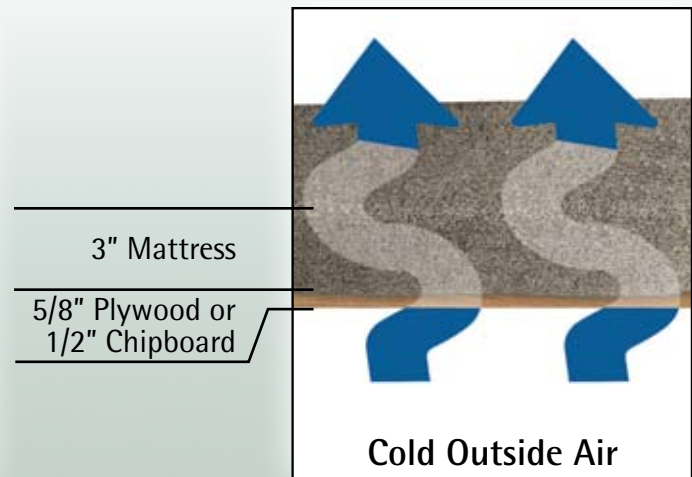

#### 1-1/4" laminated insulated bunkend

- Double the industry standard thickness
- Solid wood, steel reinforced frame filled with 1" thick high density foam and laminated with wood panel on top and bottom
- Yields a more stable bedend vs. chipboard or spliced plywood used by other brands
- Insulation improves comfort and warmth



Optional 20M BTU Suburban® Furnace with forced air, electronic ignition and thermostat control. Largest heating capacity of any folding camper.



#### E-Z Rest Reversible Mattresses™

- Softer on one side, firmer on the other. Now you have a choice!
- A higher level of comfort over standard foam or cheap innerspring mattresses used by the competition.



Optional 12V mattress heater.

### Roof Side Z-Rail

Channels water away.



- Z-Rails on roof perimeter and sidewalls keep wood above water level collection points.
- Others use U channel where wood and water can come in contact at the bottom of the channel.
- Channels are kept open to allow water to run out like a gutter.
- Others attempt to seal channels to keep water out; when the seal is compromised, water will collect and cannot escape.

## SST & Coleman® Stove & Stand



### Super Sliding Storage Trunk (SST)

- Rugged 25 cu.ft. rotocast plastic trunk has enough space to take it all with you.
- Trunk slides in both directions on a patented mechanism that provides full access to the trunk interior with the front bed pulled out.
- Trunk lids also flip over to serve as additional shelves/table tops complete with cup holders.



### Lakeside Maple Wood with Natural Touch Finish on Paneling and Cabinet Doors

- Special durable coating resists scratches, moisture and marking
- Feel the difference



### Coleman® Grill Stove with Electronic Ignition and Multipurpose Portable Stand

- True high pressure cooking – fast and efficient
- 25 ft. long grill hose in the Camp Rite package connects the Grill Stove directly to the camper's front gas bottle.
- Portable stand provides stable footing for the Grill Stove, a cooler, garbage bag, etc.; yet it folds up to a compact size that's easy to store.



### Improved Entry Doors

- Redesigned upper screen door makes installation easy and improves alignment and function on 2-piece door models.
- Removable travel door stores out of the way on one-piece door models.

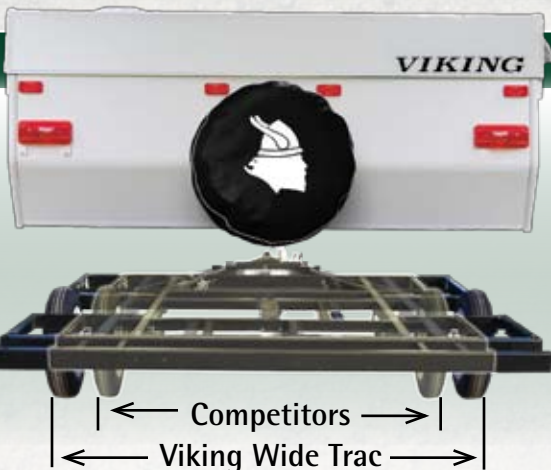

## Wide Trac Suspension

Better safety and stability on the road.

- Widest stance of any folding camper
- Improves towing safety and stability
- Stronger axle beams than most competitors
- Steel frame with automotive E-coat finish. E-coat is a 12 step cleaning and finishing process that applies multiple layers of protection to fully penetrate and coat INSIDE and OUT. Powder coating used by some competitors cannot cover inside surfaces.

## Dura Tuff Roof

- No one else includes the extra wood layer between the top skin and internal foam that provides stiffness and reduces the probability of damage due to hail, road debris, etc.
- Roof vent is placed off to the side so the A/C can be center-mounted without having to remove the vent. This design allows you to have both the vent and A/C.

- The roof is framed with steel supports to accept A/C on all models without extra reinforcement.
- Covered with a seamless exterior.

- Ceiling Board
- Wood Frame & Foam Roof Structure
- Dura Tuff Wood Protective Layer
- One Piece Seamless Skin

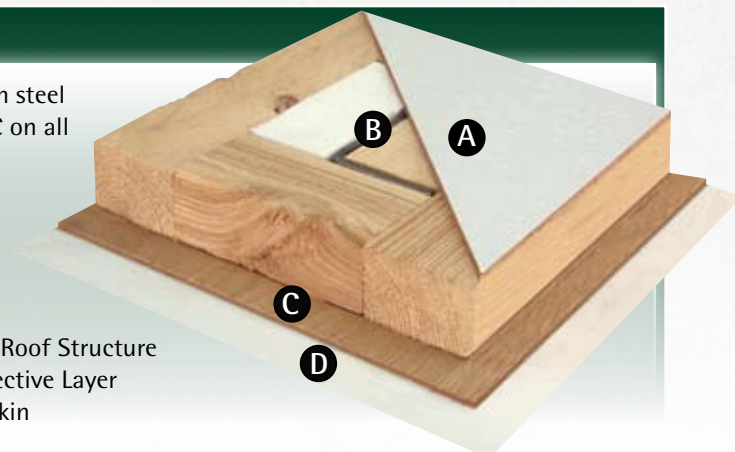



2107

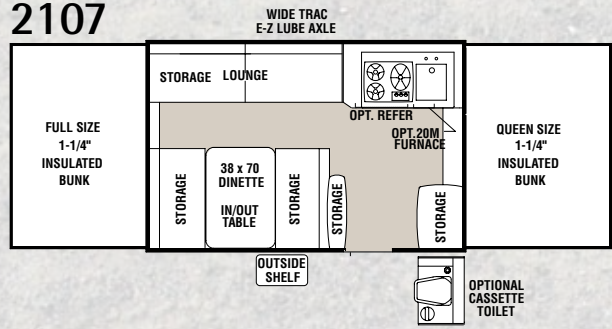

2108 ST

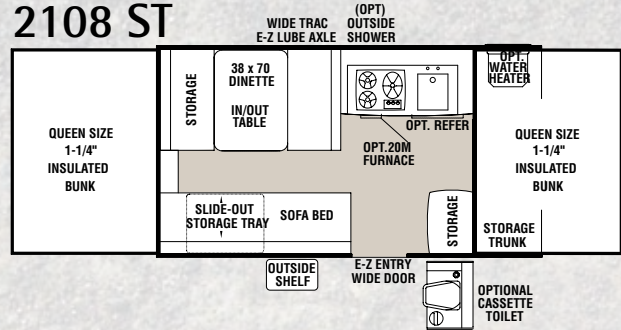

1706

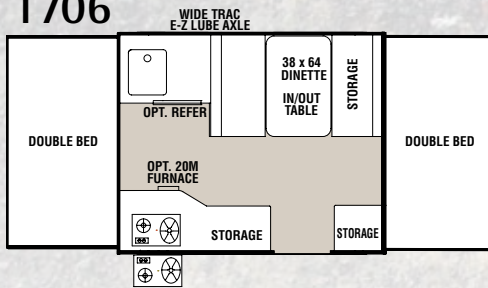

2306 ST

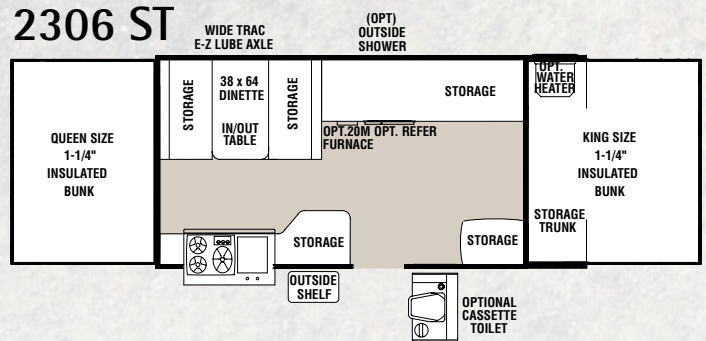

1906

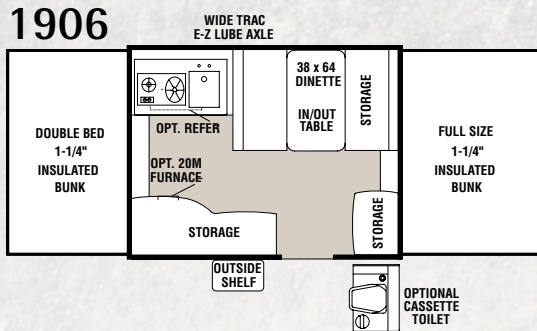

2308 ST

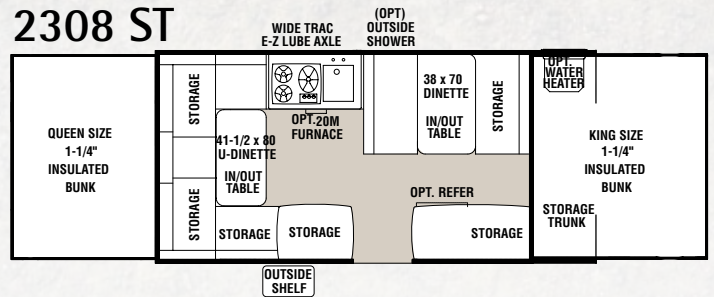

1906 UD

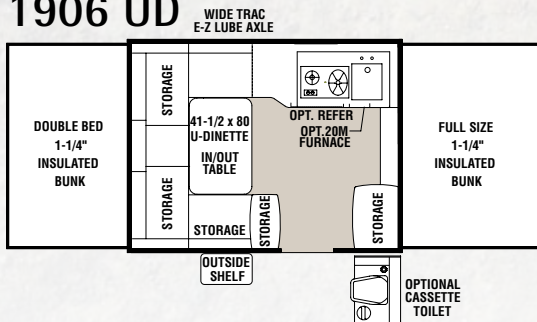

2407 ST

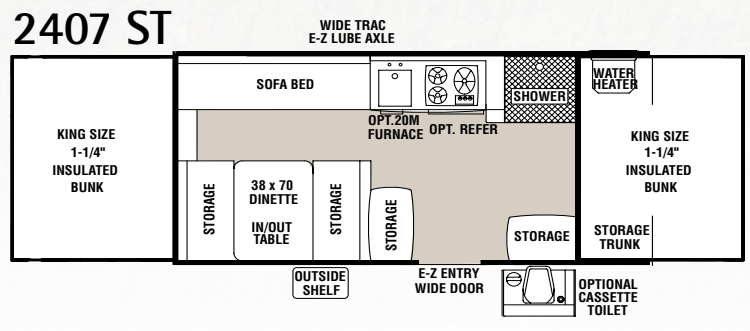

1906 ST

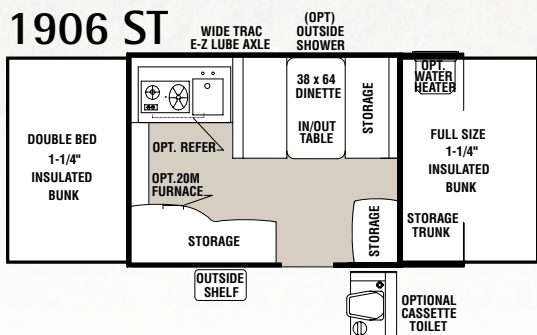

# Epic

## Specifications

	1706	1906	1906 UD	1906 ST	2107	2108 ST	2306 ST	2308 ST	2407 ST
Interior Box Size	8'	8.5'	8.5'	8.5'	10'	10'	12'	12'	12'
Exterior Box Size	8' 9"	9' 3"	9' 3"	11' 5"	10' 9"	12' 11"	14' 10"	14' 10"	14' 10"
Travel Length	12' 2"	12' 8"	12' 8"	14' 10"	14' 2"	16' 4"	18' 3"	18' 3"	18' 3"
Travel Width	85"	85"	85"	85"	85"	85"	85"	85"	85"
Travel Height	54"	54"	54"	54"	56"	56"	56"	56"	56"
Interior Open Length	16' 11"	17' 11"	17' 11"	17' 11"	20' 5"	20' 9"	23' 5"	23' 5"	24' 5"
Interior Open Height	6' 10"	6' 10"	6' 10"	6' 10"	6' 10"	6' 10"	6' 10"	6' 10"	6' 10"
Sleeping Capacity	6	6	6	6	7	7	7	8	7
Front Sleeping Area	48 X 76	54 X 80	54 X 80	54 X 80	58 X 80	58 X 80	70 X 80	70 X 80	70 X 80
Rear Sleeping Area	48 X 76	48 X 80	48 X 80	48 X 80	54 X 80	58 X 80	58 X 80	58 X 80	70 X 80
Dinette Area	39 X 64	39 X 64	N/A	39 X 64	39 X 70	39 X 70	39 X 64	39 X 64	39 X 70
"U" Dinette	N/A	N/A	42 X 80	N/A	N/A	N/A	N/A	42 X 80	N/A
Lounge Area	N/A	N/A	N/A	N/A	80"	N/A	N/A	N/A	N/A
Sofa Bed	N/A	N/A	N/A	N/A	N/A	34 X 76	N/A	N/A	34 X 70
Tire Size	4.80 X 12	4.80 X 12	4.80 X 12	4.80 X 12	5.30 X 12	ST175/80D13	ST175/80D13	ST175/80D13	ST175/80D13
Tire Load Range	4 Bolt C	4 Bolt C	4 Bolt C	4 Bolt C	4 Bolt C	5 Bolt D	5 Bolt D	5 Bolt D	5 Bolt D
Hitch Weight # (approx.), (lbs./Kg)	111/50	116/53	175/79	220/100	200/91	202/93	221/100	244/111	261/118
Axle Weight # (approx.), (lbs./Kg)	1138/517	1338/607	1283/582	1381/627	1448/657	1667/756	2010/912	1859/843	1913/868
Dry Weight # (approx.), (lbs./Kg)	1249/567	1454/660	1458/661	1601/727	1648/748	1869/849	2231/1012	2103/954	2174/986
Cargo Capacity # (approx.), (lbs./Kg)	849/385	642/291	697/316	599/272	752/341	833/378	1210/549	1361/617	1307/593
Gross Vehicle Weight Rating (GVWR), (lbs./Kg)	2098/952	2096/951	2155/977	2200/999	2400/1089	2702/1227	3441/1561	3464/1571	3481/1579
Coupler Ball Size	2"	2"	2"	2"	2"	2"	2"	2"	2"

## Viking Features

**VRX-14 Supreme Tent with storm cuff and tinted windows (no cuff on 1706)**

**Portable in/out dinette table**

**4" upholstered cushions**

**Z-rails channel water away**

**Patio light**

**Fantastic Fan™ power roof vent is standard on all models (except 1706).**

**One piece undercoated floor**

**Lined drapes for improved privacy**

**Bedend light with fan (see spec chart for availability)**

**Sandpad for greater stability**

**EZ Lube axle bearing. Easier maintenance for improved safety.**

**Entrance door 3" wider than industry standard and stores crankhandle**

**Low profile removable tongue jack**

**INDUSTRY BEST**

# Legend Floor Plans

## Model 2275 SC

Heavier Duty than other Toy Hauler Folding Campers

6" I-Beam Frame • 5200 lb. Torsion Axle for Heavy Cargo Capacity • Reinforced Diamond Plate Front Deck

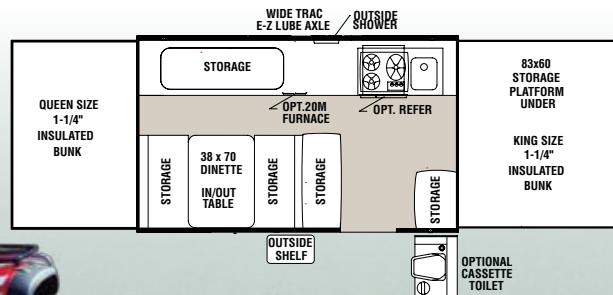

## Legend

### Specifications

	2275 SC	2465 SST	2485 SST
Interior Box Size	11'	12'	12'
Exterior Box Size	11' 9"	12' 6"	12' 6"
Travel Length	21' 4"	18' 5"	18' 5"
Travel Width	85"	85"	85"
Travel Height	60"	55"	55"
Front Storage Cargo Platform	60 X 83	28 x 83*	28 x 83*
Interior Open Length	22' 2"	24' 5"	24' 5"
Interior Open Height	6' 10"	6' 10"	6' 10"
Sleeping Capacity	6	6	8
Front Sleeping Area	70 X 80	70 X 80	70 X 80
Rear Sleeping Area	58 X 80	70 X 80	70 X 80
Dinette Area	39 X 70	45 X 73	45 X 73
Sofa Bed	N/A	N/A	34 X 76
Tire Size	ST225/75D15	ST175/80D13	ST175/80D13
Tire Load Range	5 Bolt D	5 Bolt D	5 Bolt D
Hitch Weight # (approx.), (lbs./Kg)	378/172	287/130	288/131
Axle Weight # (approx.), (lbs./Kg)	2401/1090	2408/1093	2332/1059
Dry Weight # (approx.), (lbs./Kg)	2779/1262	2695/1223	2620/1190
Cargo Capacity # (approx.), (lbs./Kg)	2679/1216	812/368	888/403
Gross Vehicle Weight Rating (GVWR), (lbs./Kg)	5458/2478	3507/1591	3508/1593
Coupler Ball Size	2-5/16"	2"	2"

\*With SST Removed



Model 2485 SST

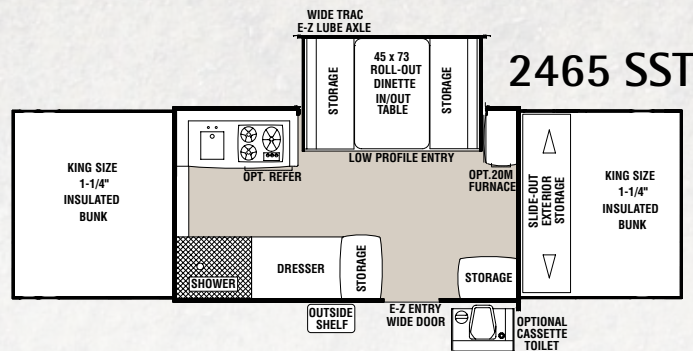

2465 SST

The 2485SST includes a sofa bed that provides comfortable seating by day and extra sleeping space at night.

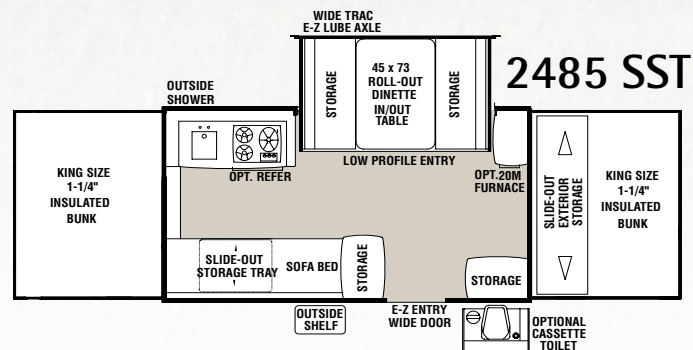

2485 SST

# Viking Standards & Options

## Standard Features

- Goshen Lift System w/ Double Lift Arms
- Coleman® Propane Grill Stove w/Stand (N/A on 1706)
- 4 Layer Seamless Roof – A/C Ready (3-Layer on 1706)
- Durable Aluminum Laminated Exterior Skin
- VRX-14 Cleanable Sectionalized Tent w/Storm Cuff (No Cuff on 1706)
- 1-1/4" Laminated/Insulated Bed (N/A 1706)
- E-Z Glide Rollout Bunk System
- 4" Thick E-Z Rest Reversible Mattress™
- 4" Thick Cushions
- Lined Side Privacy Drapes
- E-Z Swing Over Galley w/ Drawer (Legends)
- 3- Burner Wedgewood Range (2-Burner on 1706, 1906, 1906 UD, 1906 ST)
- Stainless Steel Sink
- Inside/Outside Dinette Table
- Outside Utility Shelf (N/A 1706)
- Radius Edge Hi-Pressure Countertop
- Roll-Out Dinette w/Light (2465 SST & 2485 SST)
- Kitchen Faucet w/12 Volt Water Pump
- Hot Water System w/Built-In Shower (2407 ST & 2465 SST)
- Hot Water System w/Outside Shower (2275 SC & 2485 SST)
- Under Floor Water Tank – 23/30 Gal. (16 Gal. Above Floor on 1706, 1906, 1906 UD, 1906 ST)
- 25 Amp Converter w/Battery Charger (35 Amp on 2275 SC & 12 Amp on 1706)
- Exterior 120 Volt GFI Protected Outlet (N/A 1706)
- Bedend Light w/Fan (Opt. on Epics)
- Patio Light (N/A on 1706)
- Modular Storage Cabinet (N/A 1706 & 2308 ST)
- E-Z Install Two Piece Screen Door (Epics)
- One Piece Screen Door w/ Removable Lower Door (Legends)
- 20 Cu.Ft. Front Storage Compartment w/Light (All Epic ST Models)
- 25 Cu.Ft. Patented Super Sliding Storage Compartment (All Legend SST Models)
- Fantastic Fan Power Roof Vent (N/A 1706)
- Clothes Hanger Bar (Legends)
- Inside-Outside Side Storage Drawer (2108 ST & 2485 SST)
- Wide Trac E-Z Lube HD Spring Suspension (Epics)
- Wide Trac E-Z Lube HD Torsion Suspension (Legends - 5200 Lbs. Rating on 2275 SC)
- Electric Brakes (2306 ST, 2308 ST, 2407 ST & All Legends)
- Seamless High Density Polyethylene Wheel Wells
- Low Profile Removable Tongue Jack w/ Rubber Wheel
- Durable 7 Wire Trailer Connection
- Tubular Steel Frame w/ E-Coat Finish
- 4 Crank Down B.A.L. Jacks (2 on 1706)
- Spare Tire, Bracket, Cover & Entrance Step (No Bracket or Cover on 1706)
- Lined Bedend Privacy Curtains & Valances



Convenient outside shelf

## Optional Features

- 3-Way Dometic® Refrigerator (1.9 Cu.Ft. on Epics – 2.5 Cu.Ft. on Legends)
- 20,000 BTU Suburban Furnace
- Awning
- Screenroom w/Privacy Flaps
- Modular Cassette Potti w/Electric Flush (N/A 1706 & 2308 ST)
- Hot Water System w/Outside Shower (All Epic ST Models)
- Electric Brakes
- Camp Rite Package – Grill Hose, Battery Box, & Second Gas Bottle Ring
- Second Gas Bottle & Vinyl Double Bottle Cover
- Vinyl Single Gas Bottle Cover
- Hanging Storage Cabinet
- Hanging Wardrobe Cabinet
- Bike Rack - Roof Mount
- Mattress Heater & 12 Volt Outlet
- Carefree Power Lift
- Entrance Door Caddy (Epics Only)
- Ridge Pole Storage Pouch
- Cutting Board Sink Cover
- Water Filter
- Bed Sheet Set

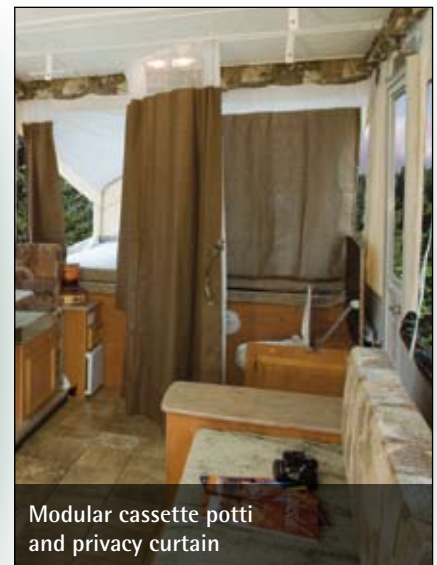

Modular cassette potti and privacy curtain

# Viking Express

**ONLY  
455 LBS.**



- 455 Lbs. Total Weight!
- 12 Cu.Ft. Top Storage Compartment
- Heavy Duty VRX-14 Vinyl Tent
- Two Double Beds & In/Out Table



## Express Specifications

Ext. Box Size (front to back)	6' 6"
Travel Length	10' 3"
Travel Width	65"
Travel Height	31"
Interior Open Length	11' 10"
Interior Open Height	6' 9"
Sleeping Capacity	4
Side Sleeping Area	46 x 72
Inside/Outside Table Size	27 x 39
Tire Size	4.80 x 8
Tire Load Range	4 Bolt B
Hitch Weight # (approx. lbs./kg.)	40/18
Axle Weight # (approx. lbs./kg.)	415/188
Coupler Ball Size	2"

## Limited Warranty

- Lift System - Lifetime
- Vinyl Tent - 5 years
- Roll Out System - 5 years
- Frame - 5 years
- Roof Assembly - 5 years
- Dexter® Axle - 5 years
- Refrigerator - 3 years
- Plumbing System - 10/25 year
- Electronic Converter- 2 years
- Roof Exterior - 2 years

## Viking is Proud to Offer



Go RVing



# VIKING

Viking RV

A Forest River Company  
580 West Burr Oak Street  
P.O. Box 549 • Centreville, MI 49032

Authorized Dealer:



A Berkshire-Hathaway Company

See your Viking Dealer for a  
complete list of parts  
and accessories.

**(269) 467-6321**  
**www.vikingrv.com**

Product information and photography are as accurate as possible at the time of publication. Subsequent refinements may be evident in the final product. Prices and specifications are subject to change without notice. All liquid capacities are approximate and dimensions are nominal.

## Viking Optional Accessories



Custom fitted sheets and pillowcases



Awning and screen room  
w/privacy panels



Modular cassette potti



Hanging cabinet



Hanging wardrobe

Gas bottle cover

