

2010 COACH HOUSE PLATINUM II 240 & 241XL

■ COLOR: Studio (optional deluxe full-body paint)



Efficiency Meets Style in a Great New Package

INTRODUCING THE COACH HOUSE® PLATINUM® II — a downsized Class C motorhome built on the popular Freightliner Sprinter chassis, powered by Mercedes-Benz.

Outside, admire the look of the streamlined Sprinter cab, married to Coach House's patented one-piece fiberglass shell. Inside, appreciate the great floor plans, including a choice of a front dinette or front power sofa, each available in an optional slideout.

What you may appreciate most, though, is the money you will save with the Platinum II. It is the most economical Coach House to operate, thanks to its energy-efficient Mercedes turbo-diesel engine. Depending on options, load, and driving habits, this vehicle may get 20 miles per gallon or better.

Make no mistake, though. The Platinum II is built to the same high standards as every Coach House motorhome. We invite you to compare the Platinum II to other downsized motorhomes, and we know you will agree that the Coach House Platinum II is in a class by itself.



3480 TECHNOLOGY DRIVE · NOKOMIS, FL 34275
(941) 485-0984 · Toll-free 1-800-235-0984
www.coachhouseserv.com
E-mail: info@coachhouseserv.com

■ FLOOR PLAN: 241XL SS ■ DECOR: Wellington



LEFT: Rear power sofa folds down into a double bed in Side Sofa floor plans.

BELOW: A view to the rear shows how all the comforts of home fit neatly into the Platinum II motorhome, including kitchen (left), bathroom (right rear) and sleeping accommodations (left rear).

■ FLOOR PLAN: 241XL SD ■ DECOR: Wellington



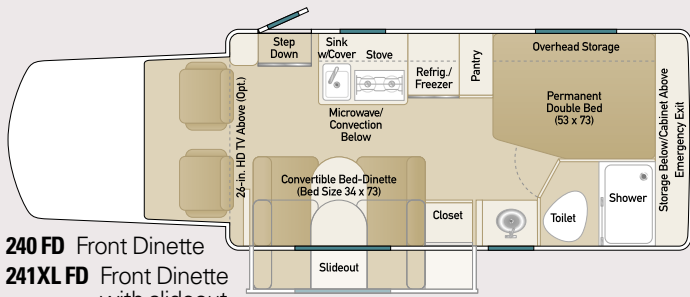

240 FD Front Dinette
241XL FD Front Dinette with slideout

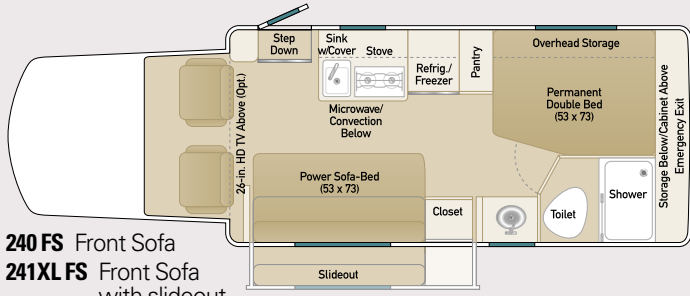

240 FS Front Sofa
241XL FS Front Sofa with slideout

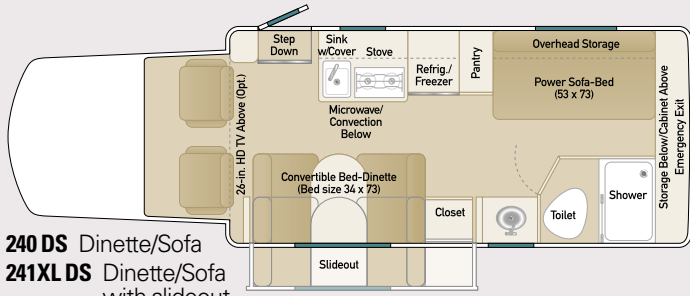

240 DS Dinette/Sofa
241XL DS Dinette/Sofa with slideout

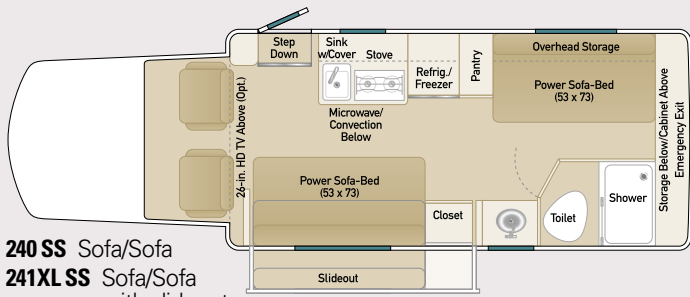

240 SS Sofa/Sofa
241XL SS Sofa/Sofa with slideout

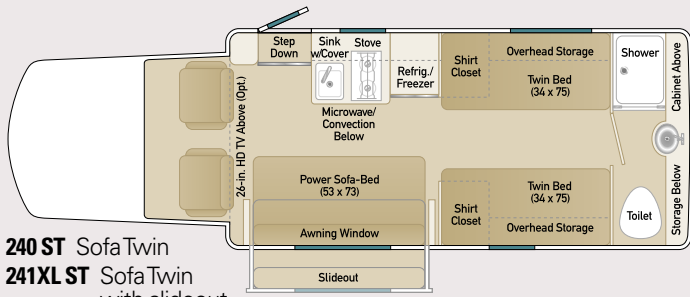

240 ST Sofa Twin
241XL ST Sofa Twin with slideout

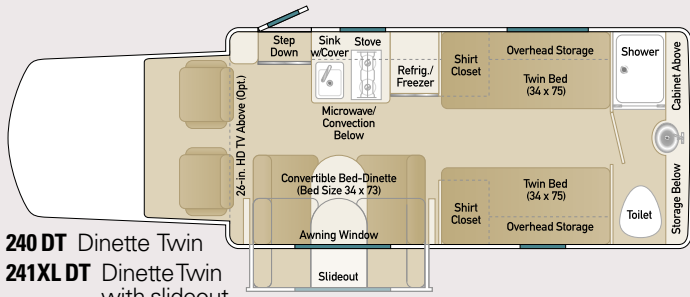

240 DT Dinette Twin
241XL DT Dinette Twin with slideout

S = Standard O = Optional

INTERIOR FEATURES

- Three Color Choices — Lido, Wellington and Studio S
- Expansive overhead cabinetry S
- Large Wardrobe closet S
- Solid-surface countertops S
- Day-night shades S
- TV antenna S
- Front privacy drape on overhead track S
- Premium-grade carpet and floor coverings S
- Mirror in bathroom S
- Separate 6-ft-3-in. stand-up shower S
- Porcelain toilet S
- Lavatory sink S
- Fire extinguisher S
- Optima leather-touch upholstery S
- 26" flat-panel front HD TV with DVD player S
- Bose 3-2-1- Surround Sound 0
- 15" HD TV in bedroom with DVD 0
- Rear view mirror with compass and outside temperature 0

EXTERIOR FEATURES

- Patented aerodynamic one-piece fiberglass body S
- Electric entrance step w/light S
- Large lockable exterior storage S
- 4-inch channel aluminum floor trusses S
- Stainless steel wheel simulators S
- Exterior hot and cold shower S
- Full-size side entry door w/screen S
- Telephone and cable TV jacks S
- Firestone Ride-Rite air suspension system w/ compressor S
- White exterior paint (vinyl graphics) S
- Basic full-body paint 0
- Deluxe full-body paint 0
- HWH hydraulic slide out (XL model) 0
- 11-foot retractable box awning 0
- Trailer hitch 0

GALLEY

- Two-burner LP gas stove S
- Range hood with monitor panel S
- Recessed kitchen sink w/cover S
- 6-cu.-ft. three-way refrigerator S
- Built-in coffeemaker S
- Microwave/convection oven S

SELF-SUPPORTING SYSTEMS

- All-weather interior plumbing S
- 68-lb. propane tank S
- 6-gallon LPG/electric water heater w/ bypass valve S

- Porcelain flush toilet S
- Demand fresh water system S
- City water connection S
- Universal utility compartment S

HEATING AND COOLING

- 30,000-Btu auto LP gas furnace S
- Two Fantastic roof vents with thermostat, rain sensor and 3-speed fan in front S
- Heavy-duty insulation R-18 S
- 13,500-Btu ducted roof air conditioner with heat strip S
- Heated holding tanks 0

ELECTRICAL

- 110v / 12v 45-amp converter / charger S
- Emergency start switch S
- Ample 110v electrical outlets S
- Interior light group w/ wall switches S
- Carbon monoxide, LP gas and smoke detectors S
- Auxiliary battery disconnect S
- 30-ft shore power cord S
- Exterior 110v outlet S
- Battery isolator S
- Porch, compartment and entry lights S
- Automatic satellite dish (stationary) 0
- 800-watt power inverter 0
- 3.6 LPG generator 0
- Color back-up video camera and monitor 0
- Security alarm with keyless remote 0
- Solar battery charger 0
- Navigation system 0

DIMENSIONS

- Wheelbase 170"
- Overall length 25' 9"
- Overall width 8' 0"
- Overall width w/ slideout extended 10' 0"
- Overall height include A/C 10' 8"
- Interior headroom 6' 4"
- GVWR (max weight of loaded vehicle) 11,030 lbs
- Rear axle ratio 4.18 to 1

BED SIZES

- Power sofa 53" x 73"
- Dinette bed (FD only) 34" x 73"
- Double bed 53" x 73"
- Twin beds 34" x 75"

TANK CAPACITIES

- Fuel tank 25 gal.
- Fresh water tank 25 gal.
- Grey water tank 28 gal.
- Black water tank 25 gal.

CHASSIS FEATURES

Mercedes-Benz Sprinter 3500 Chassis (170-in. wheelbase), 3.0L V6 turbodiesel with adaptive ESP, 154HP and 280 foot-pounds of torque. Electronically controlled 5-speed transmission; 180-amp alternator; four-wheel ABS disc brakes; power-assisted rack-and-pinion steering; in-dash AM/FM/CD player; keyless entry; power windows; power door locks; 25-gallon fuel tank; driver/passenger airbag supplemental restraint system; air conditioning; cruise control; tilt steering wheel; intermittent wipers; front chrome grill; halogen head lamps; aux. transmission oil cooler.