

Wind River



Wind River

"Follow the Wind to Your Dreams"



- *** Fiberglass Front Cap/Shock Absorbing Suspension
- *** Electric Awnings/LCD TV's
- *** Light-Weight Aluminum Frame Construction
- *** Laminated Fiberglass Sidewall Construction
- *** Stainless Steel Appliances / Halogen Ceiling Lights

 **OUTDOORS RV**
MANUFACTURING

Wind River

OUTDOORS RV
MANUFACTURING



25ORLS – One of our most popular models...luxury features abound here...lounge recliners, two tone day & night shades, bullet reading lights both over the recliners and over the sleeper sofa, halogen lights in the living area and in the slide-out and the list goes on...notice the carpet design...today's RV buyer is wanting less and less carpet to clean...we put just enough down for comfort at the dinette and sofa and make sure the traffic areas are open and easy to clean!



THE BATHROOM
the WindRiver does not take shortcuts even in here...notice the built-in wooden medicine cabinet, bathroom window, porcelain toilet, brushed nickel motor home style glass shower enclosure, and comfort air upgraded ceiling fan...full function bathroom is an understatement!



THE DINETTE – the WindRiver 2702BS is built with a full-sized U-Shaped Dinette that is perfect for meal or game time for the entire family...

*"Follow the Wind to Your Dreams"...*with one look at the inside of a WindRiver you will see that the term Luxury-Lite home away from home fits perfectly. From the Italian designed tile flooring, halogen ceiling lights, and stainless steel appliances ...the Outdoors with family and friends will feel just like home!

270DBHS Bunk Design

Large oversized rear bunks (top bunk is rated at 350 lbs) so your family & friends can enjoy the Outdoors right along with you... the bottom bunk lifts up and out of the way for an amazing storage area for bikes, golf clubs, kayak's, etc. The 2nd entry door opens up perfectly to load and unload this storage area, plus makes for an excellent in an out for the kids to use the bathroom while the adults are enjoying a movie, playing cards, or cooking lunch/dinner in the living room/kitchen!

THE BEDROOM - Individual bullet reading lights, pillow top mattress, pillow shams, and the motor home style headboard keep up the luxury theme after an incredible day in the Outdoors! You will be thanking the pillow top mattress for days...so many RV manufacturers take this feature for granted...not Outdoors RV Mfg - we are active users of the products we produce and this was just one more feature we all felt was extremely important to put in all of our units!

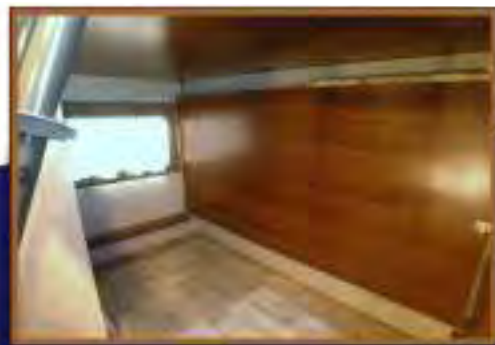

THE KITCHEN - Stainless steel appliances, pot & pan drawer, 8 cu ft fridge (optional), pull out pantry, flip up counter, metal full extension drawer guides, and the list goes on...also notice the kitchen window design...no more bending down to look out the window...the reason we all go camping is to enjoy the Outdoors and now while preparing meals for the family the Outdoors is right in front of you!

Wind River Floor Plans

Follow the Wind To Your Dreams

Travel Trailers

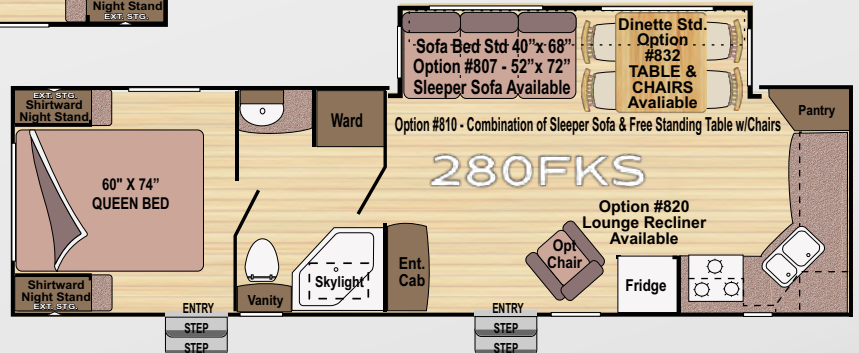
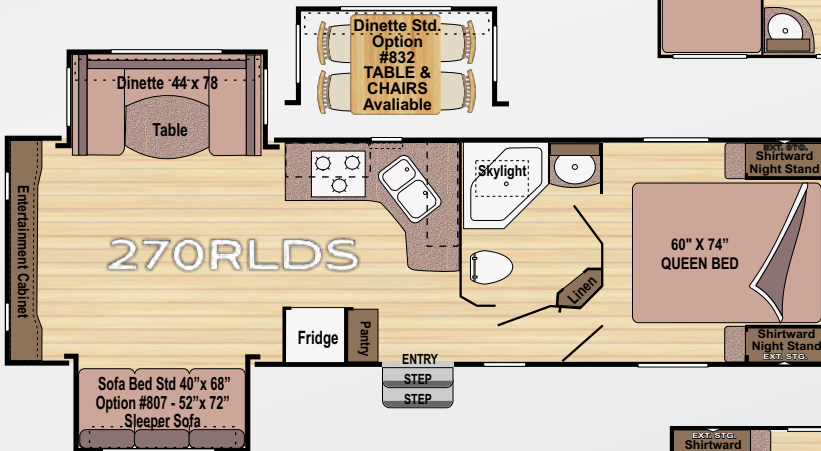
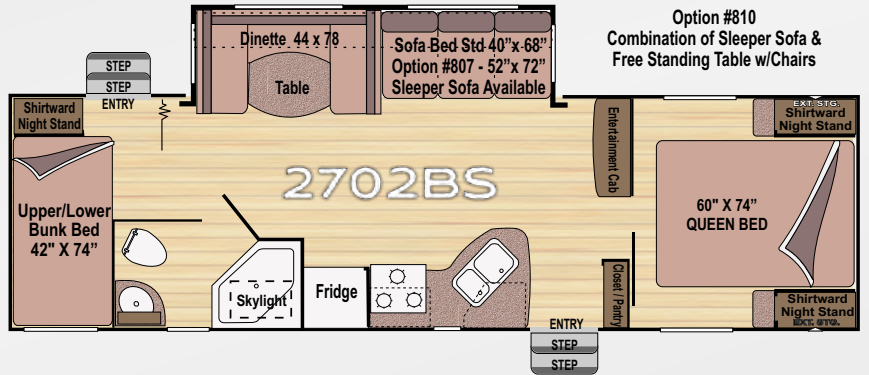
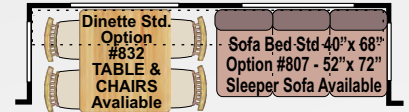
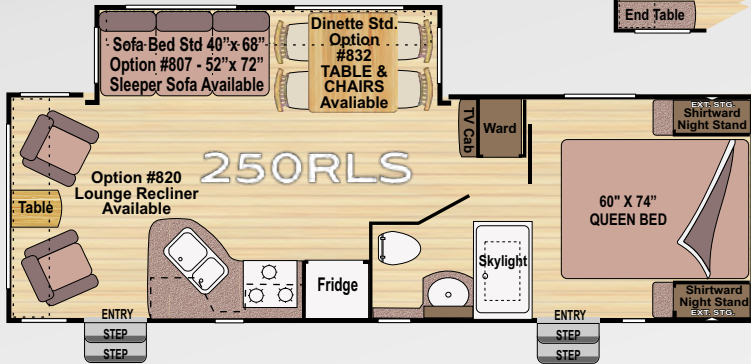
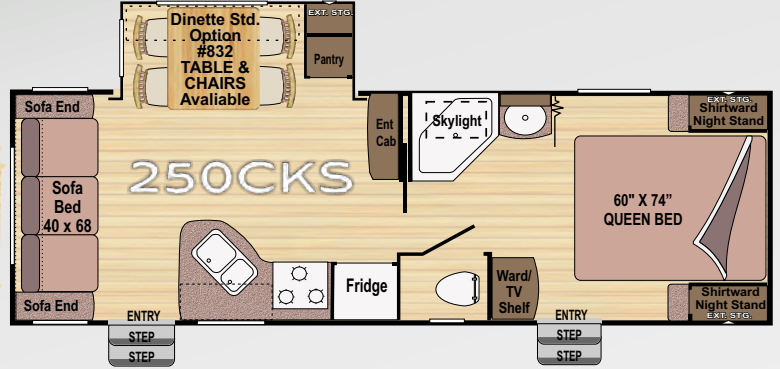
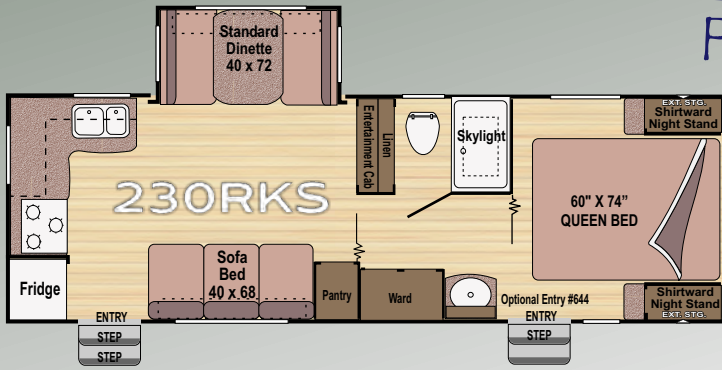

Wind River Floor Plans

5th Wheels

Follow the Wind To Your Dreams

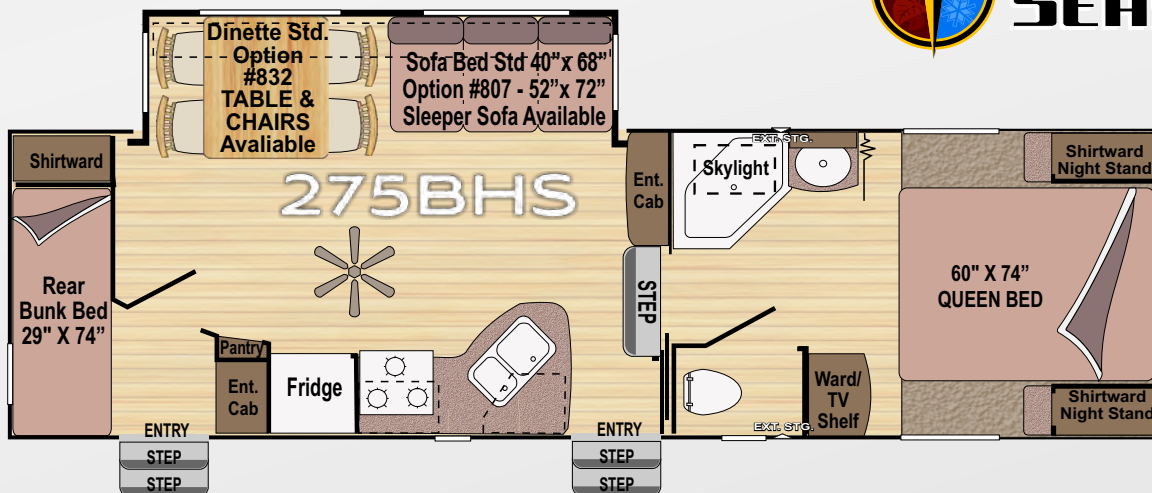
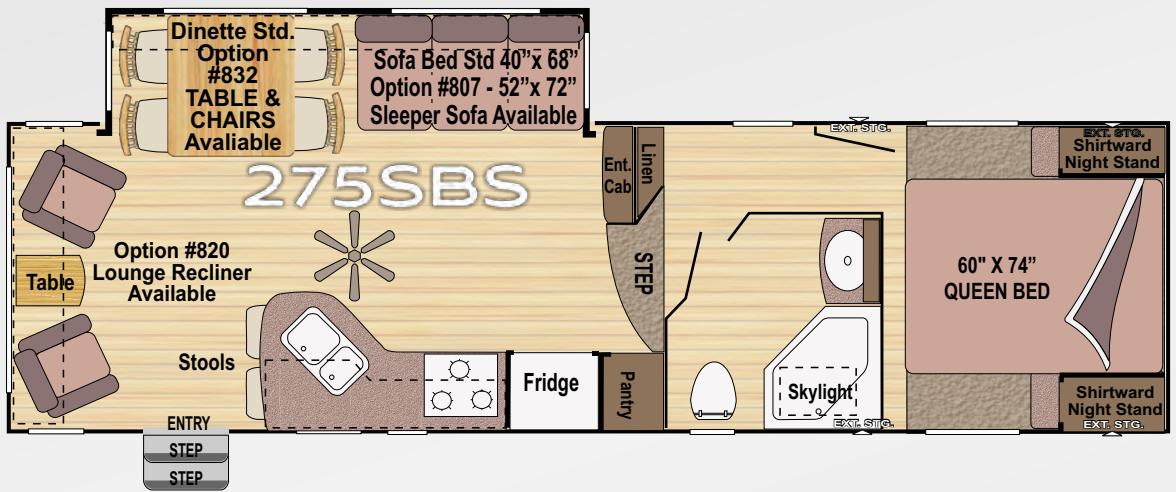
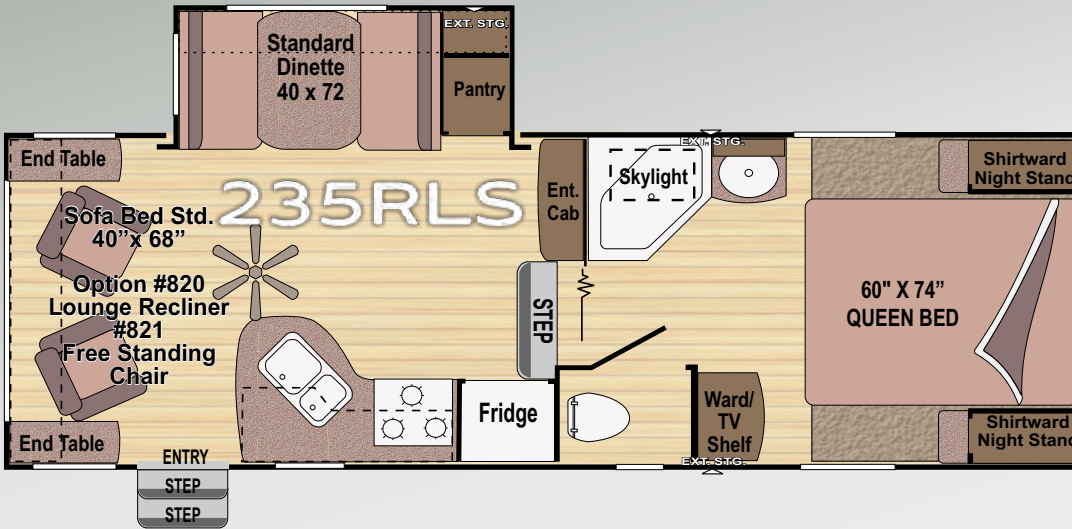

Dimensions & Capacities

	230RKS	250CKS	250RLS	2702BS	270RLDS	280FKS	235RLS	275BHS	275SBS
GVWR (lbs)	7500	7550	7600	8000	8500	7800	8000	8900	9000
Gross Dry Weight (lbs)	5658	5658	5748	6456	6793	6456	6333	7643	7426
Cargo Carrying Capacity (lbs)	1842	1892	1852	1544	1707	1344	1667	1257	1574
Hitch Dry Weight (lbs)	730	668	693	676	878	984	1394	1541	1669
Length (including hitch)	28'9"	29'8"	29'8"	32'4"	31'11"	32'8"	27'2"	31'2"	31'5"
Fresh Water Holding Tank (gal)	46	46	46	46	46	46	46	46	46
Grey Water Holding Tank (gal)	30/30	40	40	40	40	30/30	40	40/30	40
Black Water Holding Tank (gal)	30	30	30	30	30	30	30	30	30
Propane Capacity (lbs)	60	60	60	60	60	60	60	60	60
Goodyear Tire Size (load range)	ST205/ 75 15C	ST205/ 75 15C	ST205/ 75 15C	ST225/ 75 15D	ST225/ 75 15D	ST205/ 75 15C	ST205/ 75 15C	ST225/ 75 15D	ST225/ 75 15D

*Verify the towing capacity of your tow vehicle. If you don't know or aren't sure, you can ask your automotive dealership or contact your tow vehicle manufacturer.

*All weights above are average approximations and may vary. Weights are calculated before adding options.

*Specifications are subject to change without notice.

Standard

Interior - Throughout

- * Atwood 6 Gal High Efficiency Gas/Electric Water Heater w/ Maximum Recovery Rate of 17.8 Gal Per Hour.
- * AM/FM Stereo CD Player w/6 Surround Sound Ceiling Mount Speakers & Sub Woofer.
- * 13.5 Btu Air Conditioner.
- * Living Room Day/Night Shades.
- * Ceiling Fan (5th Wheels).
- * Hydro Flame Forced Air-Direct Spark Ignition Furnace w/ Thermostat.
- * Ventilated Slide-Out End Wall Windows.
- * Solid State Convertor w/Built In Battery Charger.
- * Ceiling Mount 12V Décor Light (Slide-Out Models).
- * Water Heater Bypass.
- * 6 Gallon Propane/110V DSI (Direct Spark Ignition) Water Heater.
- * Aluminum Framing in Dinette and Bed Frame.
- * Reversible Dinette Cushions.
- * Swivel Reading Lights Over Sofa.
- * Mortise and Tenon Raised Panel Cabinet Doors.
- * Coat Closet at Entry (Select Models).
- * Sofa Throw Pillows.
- * Centralized Control Panel.
- * 26" LCD TV w/ DVD.
- * Recessed Halogen Ceiling Lights in Living Room, Galley and Dining Room.
- * Glass Shower Enclosure

Galley

- * Deluxe Pullout Galley Storage System.
- * 60/40" Sink.
- * Deluxe Full Extension Roller Bearing Drawer Guides.
- * Double Door Propane Electric Fridge.
- * Dual Sink Covers/Cutting Board.
- * 3 Burner Range w/ 16" Oven.
- * Hi-Rise Faucet.
- * Microwave w/ Electronic Touch Pad.
- * Pantry, Pot & Pan Drawer.
- * Range Hood w/ 12V Light & Exhaust Fan.
- * Beaufloor Outdoors Tough Flooring.
- * Flip Up Counter Extension (Most Models).
- * Range Cover

Bedroom

- * Custom Headboard.
- * Pillow Top Mattress.
- * Pillow Shams.
- * Residential Size Wardrobe.
- * Strut Assisted Lift-Up Bed Platform w/ Below Bed Storage (Most Models).
- * Swivel Reading Lights.
- * Laundry Chute w/ Basket (5th Wheels).
- * Day/Night Shades

Bathroom

- * 12V Power Comfort Air Bath Vent.
- * ABS Tub/Shower Enclosure.
- * Bathroom Skylight.
- * Medicine Cabinet w/ Mirrored Door.

- * Porcelain Toilet, Wall Switched Ceiling Light.
- * Bathroom Window w/ Blind

Safety/Convenience

- * 120V GFI Circuit Protection (Galley/Bath/Patio), 4 Wheel Electric Brakes.
- * Break-Away Emergency Disconnect Brake.
- * Carbon Monoxide Detector/Alarm.
- * Entry Assist Handle.
- * Fire Extinguisher.
- * Propane Detector/Alarm.
- * Smoke Detector/Alarm.
- * Wall Mounted Systems Monitor Panel.
- * Water System Winterization Port.
- * Centralized Control Center

Exterior - Throughout

- * 120V Patio Receptacle, 26" Radius Entry Door.
- * Dual 30lb Propane Cylinders w/Regulator & Auto Changeover.
- * Extended Pin Box & Power Landing Gear (5th Wheels).
- * 5 Sided Aluminum Frame Fiberglass Sidewall Construction.
- * Hitch Light.
- * Molded Wheel Well Skirts.
- * Radius Truss Roof Rafters.
- * Rear Bumper w/ Sewer Hose Carrier.
- * Split Tank Propane System (5th Wheels).
- * Welded Double Battery Rack (Travel Trailers).
- * Exterior Shower.
- * Patio Awning.
- * Security Light.

- * Stabilizer Jacks.
- * Tinted Safety Glass Windows.
- * TV Antenna.
- * Shock Absorbing Rubberized Suspension.
- * Black Tank Flush.
- * Exterior Speakers.
- * Cooler Sized Luggage Doors w/ Interior Lights.
- * Power Landing Gear (5th Wheels).
- * Enclosed Chassis w/ Heated Tanks.
- * Winterization Valve.
- * Fiberglass Front Cap (5th Wheels).
- * Assist Handle.
- * Exterior Shower

Options

Interior - Throughout

- * Sleeper Sofa.
- * Free Standing Dinette.
- * Raised Panel Refer Insert (6 Panel).
- * Lounge Recliner (Option).
- * Stainless Steel Appliances.
- * Large 8 Cu ft Double Door Refrigerator.
- * Living Room Carpet (Select Models).
- * Bedroom Carpet

Exterior - Throughout

- * Four Seasons Package.
- * Roof Ladder.
- * Fiberglass Front Cap (Travel Trailers).
- * Dual Pane Windows.
- * Aluminum Wheels.
- * Goodyear Tires.
- * Spare Tire.
- * Electric Awning

Interior Views



Silver Maple



Western Sunset



FOUR SEASONS

Available on All Models

Welcome to the Outdoors!



In a 4 Seasons Outdoors RV the entire chassis is enclosed from front to back for both insulation and protection from road debris.



We use Astro-foil (R-15) insulation along the entire length of the floor. Plus an additional wrap around the holding tanks

The Industry Standard:



The Industry Standard: Holding tank dump valves are not enclosed and are exposed to freezing.



The Industry Standard: A single layer of insulation.

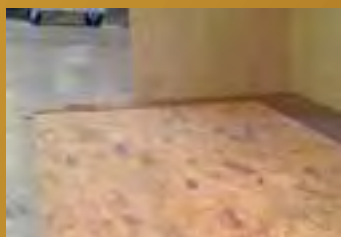

The Industry Standard: No insulation in the slide out floors

The Industry Standard:
Cold and Drafty,
Not Designed for Northern Climates

The Outdoors RV Standard:



The Outdoors RV Standard: Our Dump Valves are located within the Enclosed / Heated underbelly to protect them from freezing.



The Outdoors RV Standard: Insulation is double layered for added protection



The Outdoors RV Standard: The entire slide out floor is covered with Astro Foil / R-15 Insulation

The Outdoors RV Standard:
Warm in the Winter and Cool in the Summer,
Perfect for colder Northern US and Canadian climates.

Wind River



Situated in a picturesque mountain valley of Eastern Oregon a new RV company is born. The focus of this company is to design RV's for the NW and Western Canada, merchandise the products with a hand selected group of dealers with the end goal of having our customers enjoy an Outdoor experience like no other.

The NW and Western Canada will be the targeted area for the products produced here. This area has an incredible percentage of people that enjoy the RV lifestyle and why wouldn't they with the Outdoors right outside most people's backdoor. Our goal is not to be the largest manufacturer in the country nor follow market share graphs. We simply want to design and build great RV's. The management team for this new RV company has over 160 years of combined RV experience.

Here are a few examples:

- Jim Croxton – General Manager (25 Years)
- Darin Nelson – Sales Manager/US Sales (16 Years)
- Rod Glass – Canadian Sales Manager (23 Years)
- Robin Larsen – Training/Sales (15 Years)
- Rick Ewing – Service Manager (30 Years)
- Terry Fischer – Production Manager (29 Years)
- Henry Quint – Purchasing Manager (20 Years)
- Rick Hudson – Asst Production Manager (25 Years)
- Karen Evans – Sales Administrator (7 Years)

We look forward to producing an excellent product for you and your family to use in the Outdoors – please feel free to visit us anytime – we would love to meet you!

Outdoors RV Manufacturing is a division of Northwood Manufacturing Incorporated

Your Local Outdoors RV Dealer is:



PO BOX 1047
62582 Pierce Road
La Grande, OR 97850

Phone 541.624.5500
Fax 541.963.2448
www.outdoorsrvmfg.com