

LIGHT DUTY TOWABLE



OFFERED

CreekSide

Welcome to the Outdoors!



Creek Side

"Where to Escape from the Everyday"

- *** Roto-Torqued Outdoors Tough Cabinetry
- *** Off Road Chassis
- *** Goodyear Radial Tires - Safety/Warranty
- *** Cooler Sized Storage Doors
- *** Beaufloor Outdoors Tough Flooring

 **OUTDOORS RV**
MANUFACTURING

Creek Side

OUTDOORS RV
MANUFACTURING



THE BATHROOM - even our smallest model is designed with you in mind! Separate sink area from the rest of the bathroom so someone can brush their teeth while another takes a shower - ...how often do you camp by yourself?



THE BEDROOM - In our 18CK and 21CKS models you will find an all important shirt ward along with an optional combo overhead bunk - Storage is important no matter what size of unit you enjoy the Outdoors in. Purchase your CreekSide with the optional Pillow Top Mattress and you will sleep like you did as a kid your first night out.



18CK - Our most popular model and you can see why...here at Outdoors RV we do not cut corners even with our smallest unit - Raised Panel Overhead Doors, Outdoors Tough Flooring, Granite Designed Counter-Tops, Throw Pillows, Spice Rack, Shelves in Cabinets, Extra Large Real Wood Drawers, 11 Lights just in this area and the list goes on and on...Function and Storage are important to us here at Outdoors RV...

Everyone deserves to enjoy the Outdoors with family & friends...

CreekSide

Take one look at the Inside of a 2010 CreekSide and you will see that this is the perfect place to "Escape from the Everyday". From the beautifully appointed wood grain flooring to granite designed countertops...the Outdoors never looked so good!



THE DINETTE - 5" Dinette Cushions (Comfort is the key), Pot & Pan Drawer, Optional Two Tone Day & Night Shades are features that you do not normally find in this price point of product...again we are active RV'ers and while out enjoying the Outdoors we did not want you to go without!

OVERHEAD GALLEY STORAGE - Extra large storage compartment conveniently located above the galley sink...the raised panel doors give it just the right touch!



THE LIVING ROOM - Even in our 21CKS you will see that we have an immense amount of living space to enjoy the Outdoors in! The Beaufloor Outdoors Tough Flooring is a standard feature in every CreekSide - not only does this flooring look great it has a Cold Cracking Warranty for 2 Years down to 50 Below Zero. Since we are active users of the products here at Outdoors RV we design every feature we put in the coach as if we were buying it ourselves.

CreekSide Floor Plans

"Where to Escape from the Everyday"

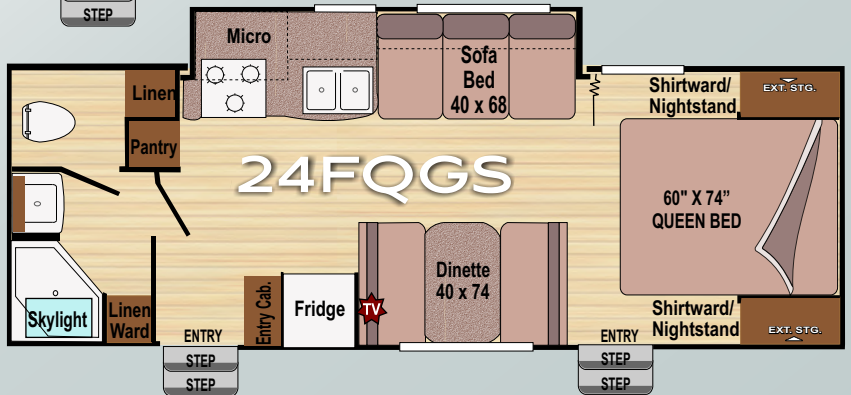
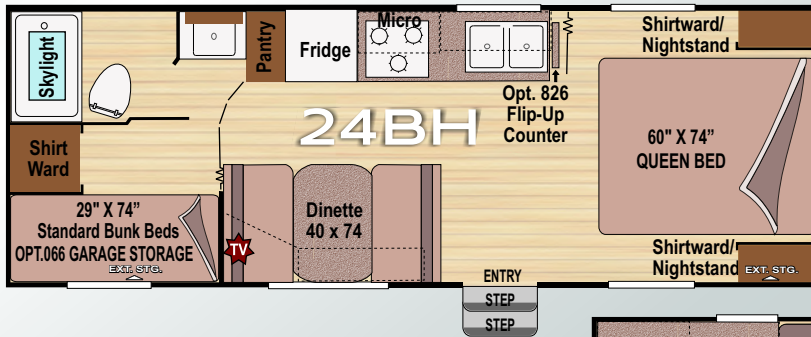
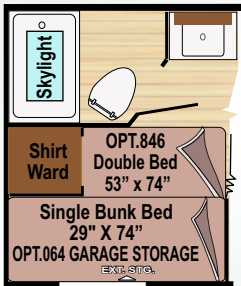
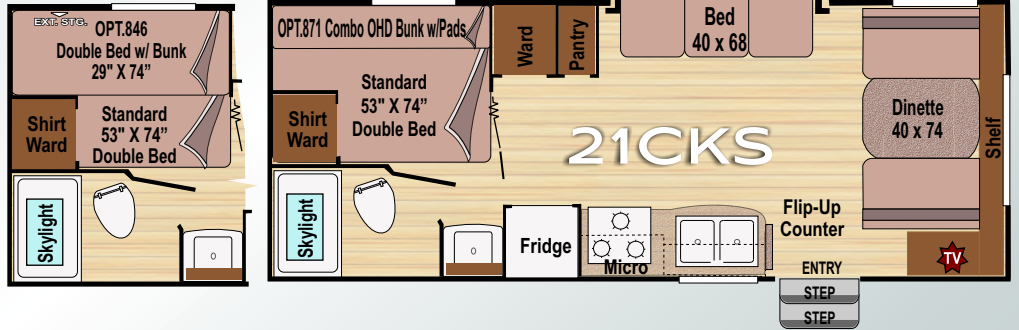
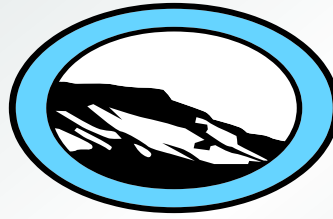
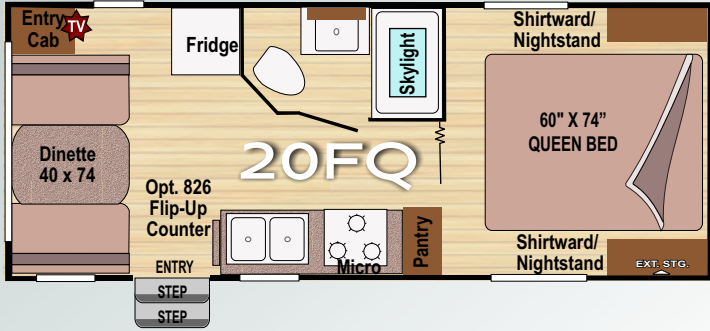
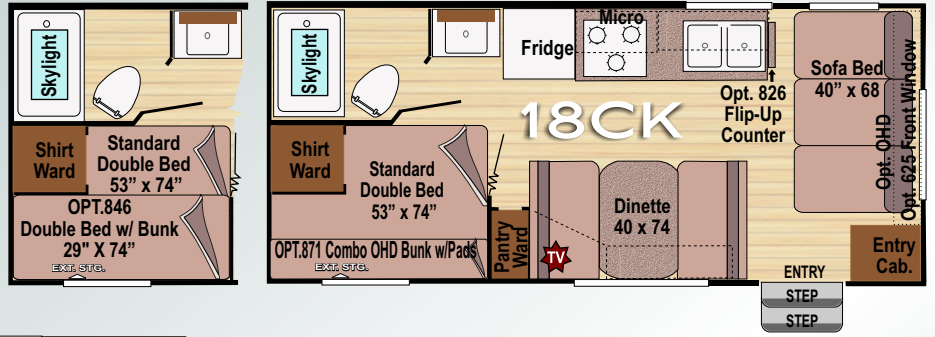

CreekSide Floor Plans

"Where to Escape from the Everyday"

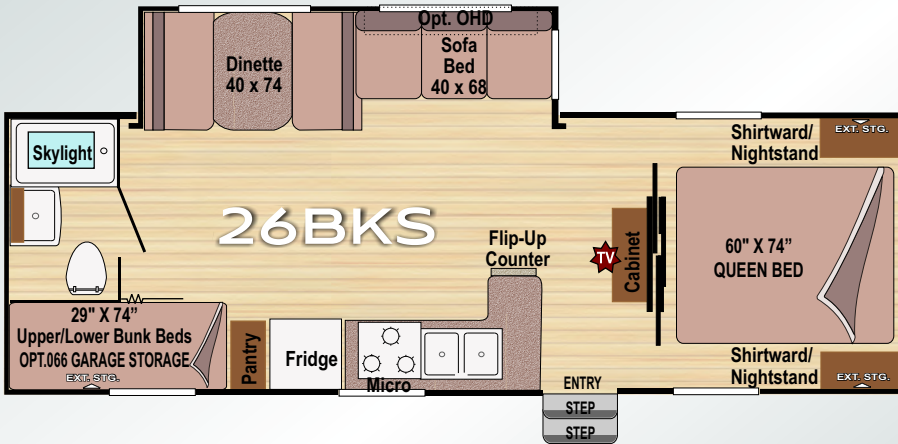
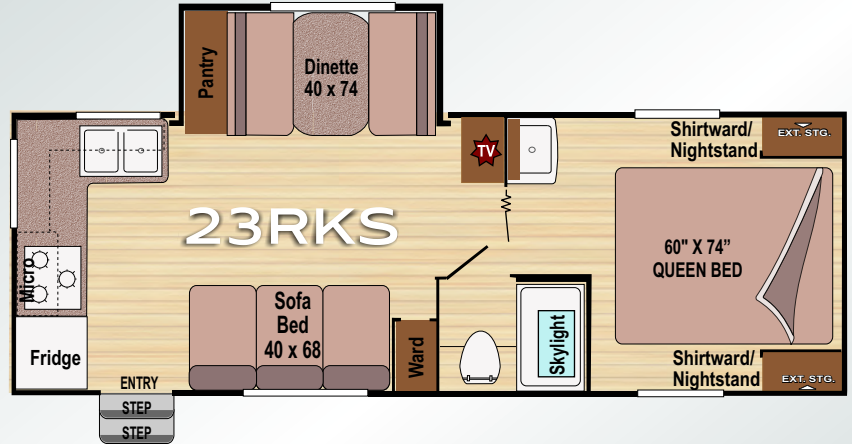

All three of these models are 4-Season Rated!

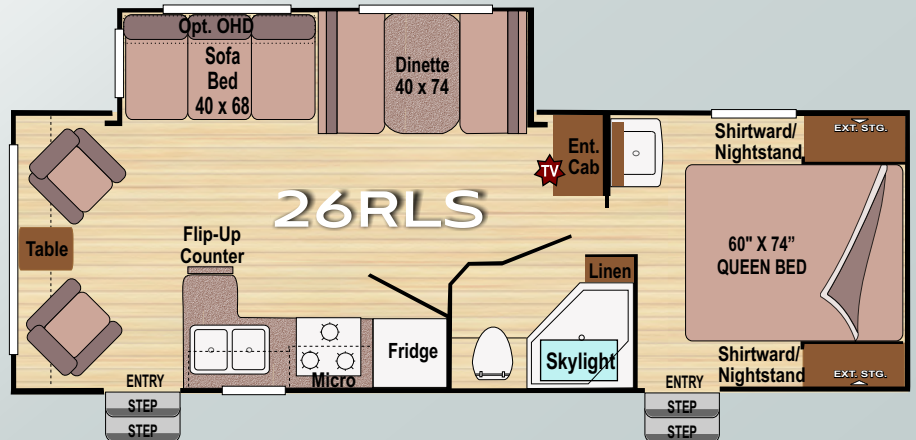

Dimensions & Capacities

<i>Creek Side</i>	18CK	20FQ	24BH	21CKS	23RKS	24FQGS	26BKS	26RLS
GVWR (lbs)	5600	5800	5800	6400	7900	7000	8000	7900
Gross Dry Weight (lbs)	4000	3936	4005	4198	5582	4856	5595	5521
Cargo Carrying Capacity (lbs)	1600	1864	1795	2202	2318	2144	2405	2379
Hitch Dry Weight (lbs)	345	520	453	636	691	408	518	801
Length (including hitch)	22'3"	23'9"	26'8"	24'8"	27'6"	27'4"	29'3"	29'1"
Fresh Water Holding Tank (gal)	46	46	46	56	56	56	56	56
Grey Water Holding Tank (gal)	40	40	40	40	40	40	40	40
Black Water Holding Tank (gal)	40	40	40	40	40	40	40	40
Propane Capacity (lbs)	40	40	40	60	60	60	60	60
Goodyear Tire Size (load range)	St205/ 75 14C	St205/ 75 14C	St205/ 75 14C	St205/ 75 14C	ST225/ 75 15D	St205/ 75 14C	St225/ 75 15D	St225/ 75 15D

*Verify the towing capacity of your tow vehicle. If you don't know or aren't sure, you can ask your automotive dealership or contact your tow vehicle manufacturer.

*All weights above are average approximations and may vary. Weights are calculated before adding options.

*Specifications are subject to change without notice.

Standard

Interior - Throughout

- * 120 Volt Central Electrical Panel,
- * 120 Volt GFI Circuit Protection (Galley/Bath/Patio),
- * 6 Gallon Propane/12V DSI (Direct Spark Ignition) Water Heater,
- * Box Wrapped Valance Window Treatment,
- * Ceiling Mount Décor Light Over Dinette and Sofa (Select Models),
- * Double Light Fixtures (Most Areas),
- * Dual 7 Gallon Propane Cylinders w/Regulator and Auto-Changover (select models),
- * Atwood Forced Air, Direct Spark Ignition Furnace with Thermostat,
- * In-Ceiling Air Conditioner Ducting (Most Models),
- * In-Floor Furnace Ducting (Most Models),
- * Interior Lights w/Wall Switch,
- * Large TV Location (Most Models),
- * Standard Mini-Blinds Throughout (Except Bunk Windows),
- * Raised Panel Overhead Doors in Living Areas,
- * Solid State Converter w/ Built-In Battery Charger,
- * Stereo AM/FM/CD Player,
- * Sofa Throw Pillows (2),
- * Valance Lambrequins in Living Areas (Select Models),
- * Wall Mount Décor Light on Large Slide-Outs (Select Models),
- * Wall Mounted Systems Monitor Panel,
- * Water Heater Bypass,
- * Wired for Roof Air Conditioner,
- * Beauflor Outdoor Tough Wood Grain Flooring (2 Year 50 below cold cracking warranty)

Galley

- * Double Bowl Sink,
- * Flip-Up Counter Extension (Select Models),
- * Double Handle High Rise Faucet,
- * 3 Burner Range w/ 16" Oven,
- * Double Door Propane/Electric

Refrigerator,

- * Large Cabinet Doors,
- * Microwave w/ Electronic Touch Pad,
- * Raised Panel Overhead Cabinet Doors,
- * Overhead Storage Cabinet Above Sink,
- * Range Hood w/ 12 Volt Light and Exhaust Fan

Bedroom

- * Bedside Nightstand (Most Models),
- * Décor Coordinated Bedspread,
- * Inner-Spring Mattress,
- * Lift-Up Bed Platform w/ Below Bed Storage (Most Models),
- * Valance Lambrequins (Select Models),
- * Wardrobes Accommodate Residential Size Clothes Hangers

Bathroom

- * 12 Volt Power Exhaust Fan Roof Vent,
- * ABS Bath Tub Surround (Select Models),
- * Medicine Cabinet w/ Mirrored Door and Adjustable Shelves,
- * Skylight,
- * Thetford Fresh Water Flush Toilet,
- * Towel Bar, Towel Ring, Toilet Paper Holder,
- * Upgrade Fabric Shower Curtain,
- * Wall-Switched Ceiling Light

Safety/Convenience

- * 26" Wide Main Entry Door w/ Window,
- * 4-Wheel Electric Brakes,
- * Break-Away Emergency Disconnect Brake,
- * Carbon Monoxide Detector/Alarm,
- * Fire Extinguisher,
- * Flush Mount Entry Door Latch w/ Deadbolt Lock,
- * Patio Light w/ Interior Switch,
- * Propane Detector/Alarm,

- * Retractable Entry Step w/, Non Skid Strip,
- * Smoke Detector/Alarm

Exterior - Throughout

- * Stabilization Jacks/2 Pair (Select Models),
- * 120 Volt Patio Receptacle,
- * Arctic White Gloss Exterior Metal Finish,
- * Fiberglass Insulation,
- * Front Gravel Guard,
- * Full Color Decorative Exterior Graphics,
- * LPG Cover,
- * Molded Wheel Well Skirts (Select Models),
- * Patio Awning,
- * Radius Aluminum Sidewall, Skirting (Select Models),
- * Radius Corner Entry Door (Select Models),
- * Radius Corner Luggage Doors (Select Models),
- * ABS Molded Entry Step Trim,
- * Radius Corner Safety Glass Windows,
- * Security Light (Select Models),
- * Screen Door,
- * Rear Bumper w/ Sewer Hose Carrier,
- * Slide-Out End Wall Window,
- * Seamless One-Piece Rubber Roof,
- * Structural I-Beam Cambered Chassis,
- * Sub Floor Fresh Water Holding Tanks (Select Models),
- * Truss Roof Rafters,
- * TV Antenna,

Storage

- Locking Insulated Luggage Doors,
- Cooler Sized Pass Through Storage (Most Models)

Options

Interior - Throughout

- * 13,500 BTU Air Conditioner,
- * Day/Night Shades (Select Models),
- * 6 Gallon Propane/12V/110V DSI (Direct Spark Ignition) Water Heater (Select Models),
- * Front Window w/ Rock Guard (18CK),
- * Upgrade Stereo AM/FM/CD/DVD/MP3 - Speakers & Subwoofer, (Select Models)
- * Pillow Top Mattress,
- * LCD TV w/ Upgraded Stereo DVD, (Select Models)
- * Range Cover,
- * Sink Lids (2),
- * Pot and Pan Drawer,
- * Glass Shower Enclosure (Select Models),
- * Porcelain Toilet (Select Models),
- * Slide-Out Overhead Cabinets,
- * Double Bed w/ Bunk Combo (Select Models),
- * Flip Up Counter (Select Models),
- * ABS Tub Shower Enclosure (Select Models),
- * Combo Overhead Bunk (Select Models),
- * Front Overhead Cabinet (18CK)
- * Deluxe 6 Panel Wood Grain Refer Insert (Select Models)

Exterior - Throughout

- * Four Seasons Package - (Select Models),
- * Goodyear Radial Tires (Safety-Warranty),
- * Exterior Shower,
- * Bunk Garage Storage (Select Models),
- * Goodyear Radial Spare Tire & Carrier,
- * Stabilizer Jacks (Select Models),
- * Exterior Speakers,
- * Ladder (Select Models),
- * 7 Gallon Propane Tanks (Select Models),
- * Electric Awning (Select Models)
- * Double Insulation (Select Models)

Interior View



...and Coming Soon: New Prairie Fawn Interior Decor



FOUR SEASONS

Available on All Models

Welcome to the Outdoors!



In a 4 Seasons Outdoors RV the entire chassis is enclosed from front to back for both insulation and protection from road debris.

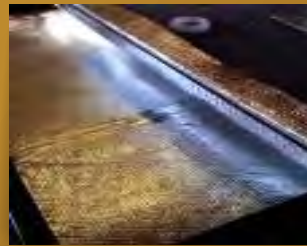

We use Astro-foil (R-15) insulation along the entire length of the floor. Plus an additional wrap around the holding tanks

The Industry Standard:



The Industry Standard: Holding tank dump valves are not enclosed and are exposed to freezing.



The Industry Standard: A single layer of insulation.



The Industry Standard: No insulation in the slide out floors

The Industry Standard:
Cold and Drafty,
Not Designed for Northern Climates

The Outdoors RV Standard:



The Outdoors RV Standard: Our Dump Valves are located within the Enclosed / Heated underbelly to protect them from freezing.



The Outdoors RV Standard: Insulation is double layered for added protection



The Outdoors RV Standard: The entire slide out floor is covered with Astro Foil / R-15 Insulation

The Outdoors RV Standard:
Warm in the Winter and Cool in the Summer,
Perfect for colder Northern US and Canadian climates.

Creek Side



Situated in a picturesque mountain valley of Eastern Oregon a new RV company is born. The focus of this company is to design RV's for the NW and Western Canada, merchandise the products with a hand selected group of dealers with the end goal of having our customers enjoy an Outdoor experience like no other.

The NW and Western Canada will be the targeted area for the products produced here. This area has an incredible percentage of people that enjoy the RV lifestyle and why wouldn't they with the Outdoors right outside most people's backdoor. Our goal is not to be the largest manufacturer in the country nor follow market share graphs. We simply want to design and build great RV's. The management team for this new RV company has over 160 years of combined RV experience.

Here are a few examples:

- Jim Croxton – General Manager (25 Years)
- Darin Nelson – Sales Manager/US Sales (16 Years)
- Rod Glass – Canadian Sales Manager (23 Years)
- Robin Larsen – Training/Sales (15 Years)
- Rick Ewing – Service Manager (30 Years)
- Terry Fischer – Production Manager (29 Years)
- Henry Quint – Purchasing Manager (20 Years)
- Rick Hudson – Asst Production Manager (25 Years)
- Karen Evans – Sales Administrator (7 Years)

We look forward to producing an excellent product for you and your family to use in the Outdoors – please feel free to visit us anytime – we would love to meet you!

Outdoors RV Manufacturing is a division of Northwood Manufacturing Incorporated

Your Local Outdoors RV Dealer is:



PO BOX 1047 Phone 541.624.5500
62582 Pierce Road Fax 541.963.2448
La Grande, OR 97850 www.outdoorsrvmfg.com