



2010 Coachmen Clipper
Easy.

Where life is stress free.



The Clipper Difference.

Construction & Features Competitors Can't Match



Warmest Folding Camper in the Industry

What would you rather sleep on?

Clipper Standard

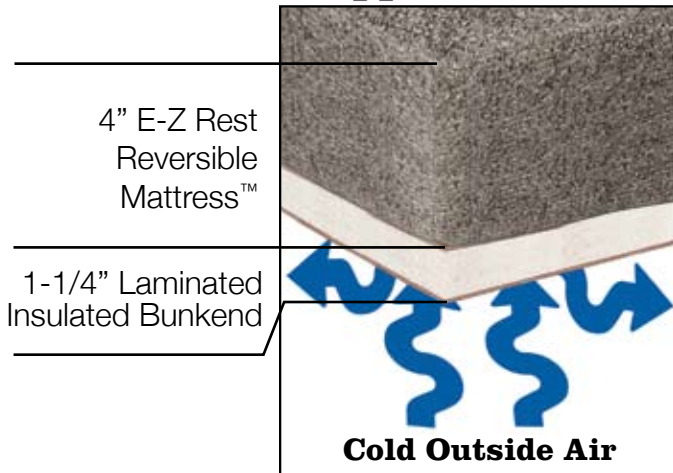

Competitors

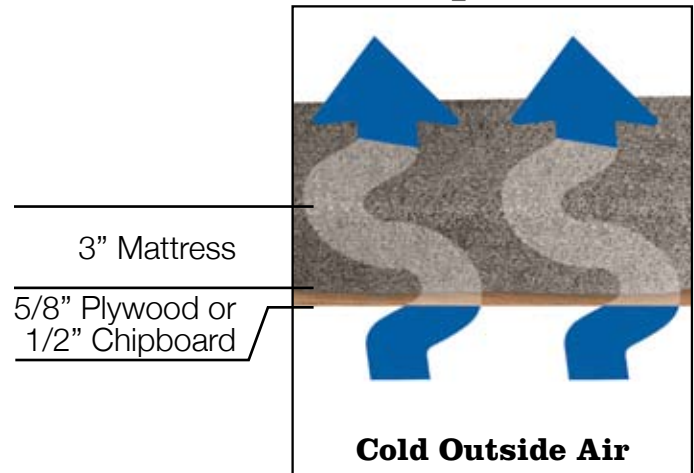

1-1/4" laminated insulated bunkend

- Double the industry standard thickness
- Solid wood, steel reinforced frame filled with 1" thick high density foam and laminated with wood panel on top and bottom
- Yields a more stable bedend vs. chipboard or spliced plywood used by other brands
- Insulation improves comfort and warmth



Optional 20M BTU Suburban® Furnace with forced air, electronic ignition and thermostat control.

Largest heating capacity of any folding camper.



Flip the mattress to suit your comfort.

E-Z Rest Reversible Mattresses™

- Softer on one side, firmer on the other. Now you have a choice!
- A higher level of comfort over standard foam or cheap innerspring mattresses used by the competition.



Optional 12V mattress heater.

Roof Side Z-Rail

Channels water away.

- Z-Rails on roof perimeter and sidewalls keep wood above water level collection points.
- Others use U channel where wood and water can come in contact at the bottom of the channel.
- Channels are kept open to allow water to run out like a gutter.
- Others attempt to seal channels to keep water out; when the seal is compromised, water will collect and cannot escape.



Dura Tuff Roof

- No one else includes the extra wood layer between the top skin and internal foam that provides stiffness and reduces the probability of damage due to hail, road debris, etc.
- Roof vent is placed off to the side so the A/C can be center-mounted without having to remove the vent. This design allows you to have both the vent and A/C.

- The roof is framed with steel supports to accept A/C on all models without extra reinforcement.
- Covered with a seamless exterior.

- A. Ceiling Board
 B. Wood Frame & Foam Roof Structure
 C. Dura Tuff Wood Protective Layer
 D. One Piece Seamless Skin

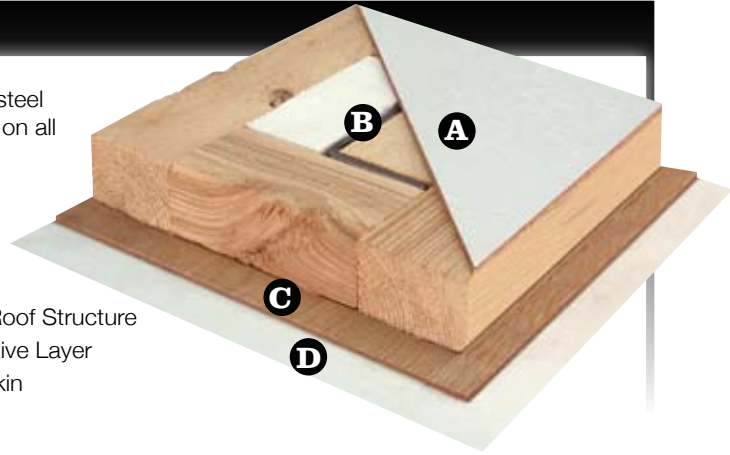

SST & Coleman® Stove & Stand



Super Sliding Storage Trunk (SST)

- Rugged 25 cu.ft. rotocast plastic trunk has enough space to take it all with you.
- Trunk slides in both directions on a patented mechanism that provides full access to the trunk interior with the front bed pulled out.
- Trunk lids also flip over to serve as additional shelves/table tops complete with cup holders.



Lakeside Maple Wood with Natural Touch Finish on Paneling and Cabinet Doors

- Special durable coating resists scratches, moisture and marking
- Feel the difference



Coleman® Grill Stove with Electronic Ignition and Multipurpose Portable Stand

- True high pressure cooking – fast and efficient
- 25 ft. long grill hose in the Camp Rite package connects the Grill Stove directly to the camper's front gas bottle.
- Portable stand provides stable footing for the Grill Stove, a cooler, garbage bag, etc.; yet it folds up to a compact size that's easy to store.



Improved Entry Doors

- Redesigned upper screen door makes installation easy and improves alignment and function on 2-piece door models.
- Removable travel door stores out of the way on one-piece door models.

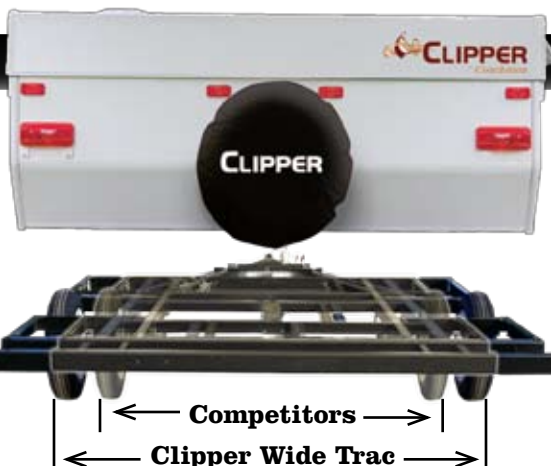

Wide Trac Suspension

Better safety and stability on the road.

- Widest stance of any folding camper
- Improves towing safety and stability
- Stronger axle beams than most competitors
- Steel frame with automotive E-coat finish. E-Coat is a 12 step cleaning and finishing process that applies multiple layers of protection to fully penetrate and coat INSIDE and OUT. Powder coating used by some competitors cannot cover inside surfaces.

Sport

Specifications

	806	106	106 UD	106 ST	107	108 ST	126 ST	128 ST	127 ST
Interior Box Size	8'	8.5'	8.5'	8.5'	10'	10'	12'	12'	12'
Exterior Box Size	8' 9"	9' 3"	9' 3"	11' 5"	10' 9"	12' 11"	14' 10"	14' 10"	14' 10"
Travel Length	12' 2"	12' 8"	12' 8"	14' 10"	14' 2"	16' 4"	18' 3"	18' 3"	18' 3"
Travel Width	85"	85"	85"	85"	85"	85"	85"	85"	85"
Travel Height	54"	54"	54"	54"	56"	56"	56"	56"	56"
Interior Open Length	16' 11"	17' 11"	17' 11"	17' 11"	20' 5"	20' 9"	23' 5"	23' 5"	24' 5"
Interior Open Height	6' 10"	6' 10"	6' 10"	6' 10"	6' 10"	6' 10"	6' 10"	6' 10"	6' 10"
Sleeping Capacity	6	6	6	6	7	7	7	8	7
Front Sleeping Area	48 X 76	54 X 80	54 X 80	54 X 80	58 X 80	58 X 80	70 X 80	70 X 80	70 X 80
Rear Sleeping Area	48 X 76	48 X 80	48 X 80	48 X 80	54 X 80	58 X 80	58 X 80	58 X 80	70 X 80
Dinette Area	39 X 64	39 X 64	N/A	39 X 64	39 X 70	39 X 70	39 X 64	39 X 64	39 X 70
"U" Dinette	N/A	N/A	42 X 80	N/A	N/A	N/A	N/A	42 X 80	N/A
Lounge Area	N/A	N/A	N/A	N/A	80"	N/A	N/A	N/A	N/A
Sofa Bed	N/A	N/A	N/A	N/A	N/A	34 X 76	N/A	N/A	34 X 70
Tire Size	4.80 X 12	4.80 X 12	4.80 X 12	4.80 X 12	5.30 X 12	ST175/80D13	ST175/80D13	ST175/80D13	ST175/80D13
Tire Load Range	4 Bolt C	4 Bolt C	4 Bolt C	4 Bolt C	4 Bolt C	5 Bolt D	5 Bolt D	5 Bolt D	5 Bolt D
Hitch Weight # (approx.), (lbs./Kg)	111/50	116/53	175/79	220/100	200/91	202/93	221/100	244/111	261/118
Axle Weight # (approx.), (lbs./Kg)	1138/517	1338/607	1283/582	1381/627	1448/657	1667/756	2010/912	1859/843	1913/868
Dry Weight # (approx.), (lbs./Kg)	1249/567	1454/660	1458/661	1601/727	1648/748	1869/849	2231/1012	2103/954	2174/986
Cargo Capacity # (approx.), (lbs./Kg)	849/385	642/291	697/316	599/272	752/341	833/378	1210/549	1361/617	1307/593
Gross Vehicle Weight Rating (GVWR), (lbs./Kg)	2098/952	2096/951	2155/977	2200/999	2400/1089	2702/1227	3441/1561	3464/1571	3481/1579
Coupler Ball Size	2"	2"	2"	2"	2"	2"	2"	2"	2"

Clipper Features

VRX-14 Supreme Tent with storm cuff and tinted windows (no cuff on 806)

Portable in/out dinette table

4" upholstered cushions

Z-rails channel water away

Patio light

Fantastic Fan™ power roof vent is standard on all models (except 806).

One piece undercoated floor

Lined drapes for improved privacy

Bedend light with fan (see spec chart for availability)

Sandpad for greater stability

EZ Lube axle bearing. Easier maintenance for improved safety.

Entrance door 3" wider than industry standard and stores crankhandle

Low profile removable tongue jack

INDUSTRY BEST

2010 Coachmen Clipper Sport Floor Plans



806

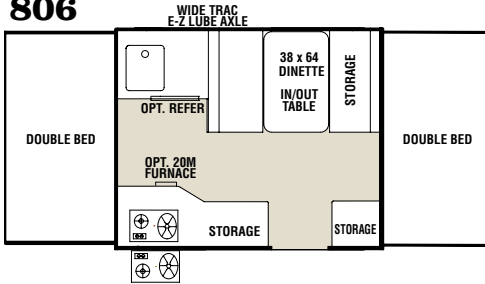

106

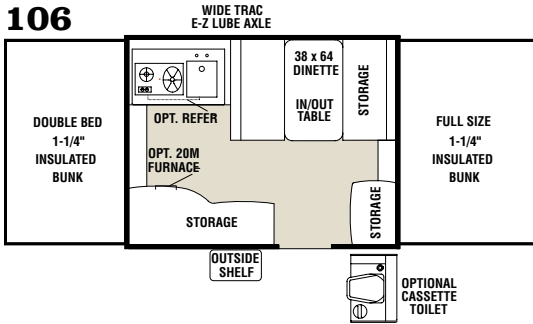

108 ST

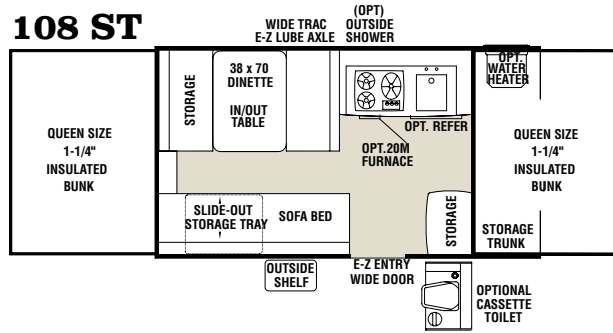

106 UD

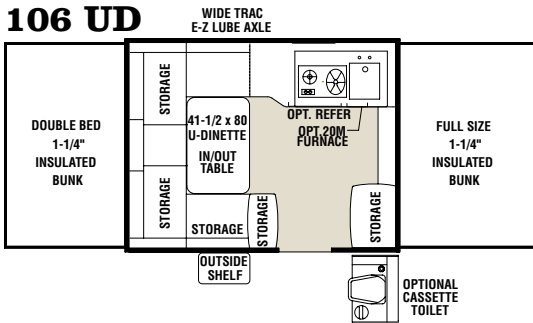

126 ST

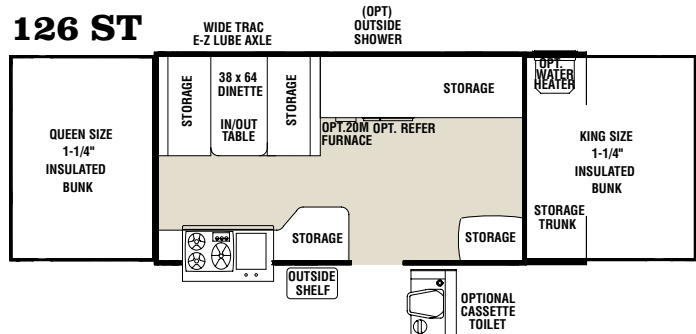

106 ST

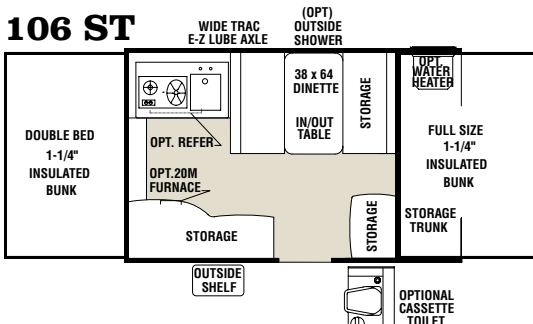

128 ST

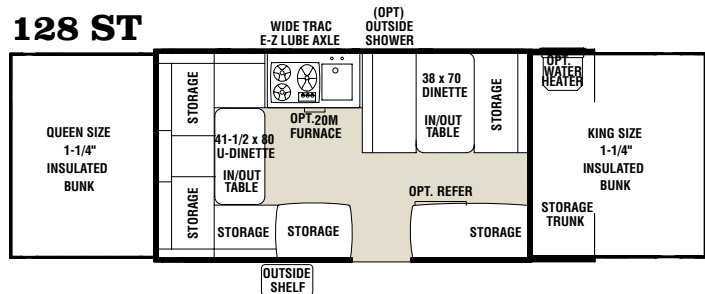

107

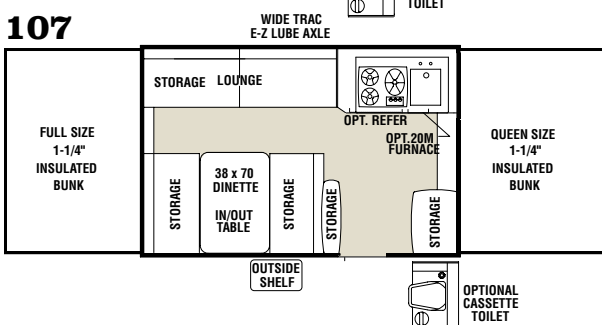

127 ST

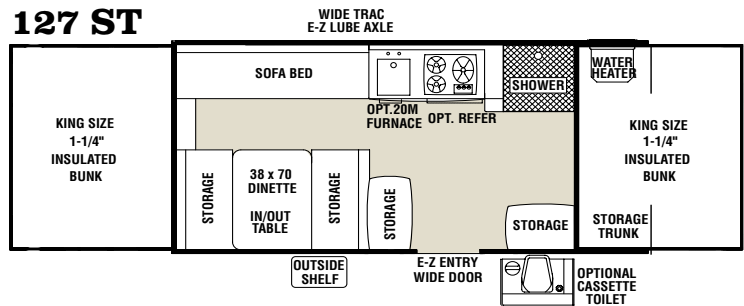

2010 Coachmen Clipper Classic



Roomy interior space and large king size bunks make the Classic Slide-Out models ideally suited for family camping. Let the kids bring their friends along. There's room for everyone!

Classic Specifications

	1175 SC	1265 SST	1285 SST
Interior Box Size	11'	12'	12'
Exterior Box Size	11' 9"	12' 6"	12' 6"
Travel Length	21' 4"	18' 5"	18' 5"
Travel Width	85"	85"	85"
Travel Height	60"	55"	55"
Front Storage Cargo Platform	60 X 83	28 x 83*	28 x 83*
Interior Open Length	22' 2"	24' 5"	24' 5"
Interior Open Height	6' 10"	6' 10"	6' 10"
Sleeping Capacity	6	6	8
Front Sleeping Area	70 X 80	70 X 80	70 X 80
Rear Sleeping Area	58 X 80	70 X 80	70 X 80
Dinette Area	39 X 70	45 X 73	45 X 73
Sofa Bed	N/A	N/A	34 X 76
Tire Size	ST225/75D15	ST175/80D13	ST175/80D13
Tire Load Range	5 Bolt D	5 Bolt D	5 Bolt D
Hitch Weight # (approx.), (lbs./Kg)	378/172	287/130	288/131
Axle Weight # (approx.), (lbs./Kg)	2401/1090	2408/1093	2332/1059
Dry Weight # (approx.), (lbs./Kg)	2779/1262	2695/1223	2620/1190
Cargo Capacity # (approx.), (lbs./Kg)	2679/1216	812/368	888/403
Gross Vehicle Weight Rating (GVWR), (lbs./Kg)	5458/2478	3507/1591	3508/1593
Coupler Ball Size	2-5/16"	2"	2"

*With SST Removed

Model 1175 SC



Heavier Duty than other Toy Hauler Folding Campers

6" I-Beam Frame • 5200 Lb. Torsion Axle for Heavy Cargo Capacity • Reinforced Diamond Plate Front Deck

1175 SC

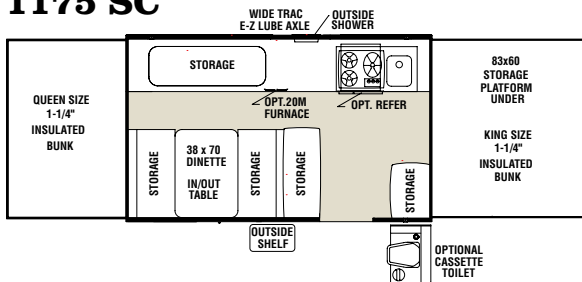

Model 1285 SST



1265 SST

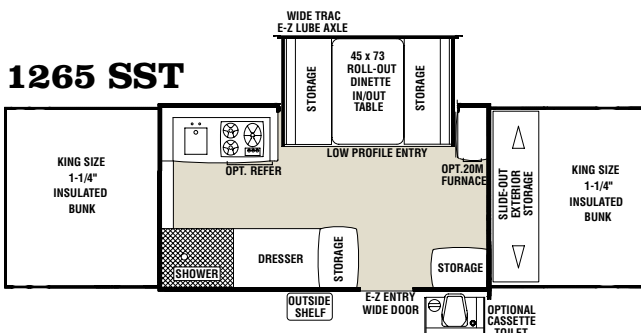

1285 SST

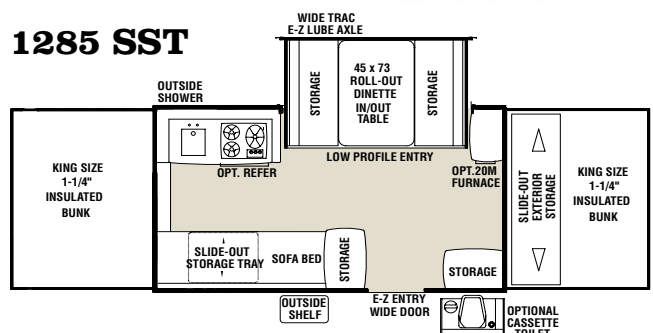

2010
Coachmen **Clipper**
Standards & Options

Standard Features

- Goshen Lift System w/Double Lift Arms
- Coleman® Propane Grill Stove w/Stand (N/A on 806)
- 4 Layer Seamless Roof — A/C Ready (3-Layer on 806)
- Durable Aluminum Laminated Exterior Skin
- VRX-14 Cleanable Sectionalized Tent w/Storm Cuff (No Cuff on 806)
- 1-1/4" Laminated/Insulated Bed (N/A 806)
- E-Z Glide Rollout Bunk System
- 4" Thick E-Z Rest Reversible Mattress™
- 4" Thick Cushions
- Lined Side Privacy Drapes
- E-Z Swing Over Galley w/Drawer (Classics)
- 3- Burner Wedgewood Range (2-Burner on 806, 106, 106 UD, 106 ST)
- Stainless Steel Sink
- Inside/Outside Dinette Table
- Outside Utility Shelf (N/A 806)
- Radius Edge Hi-Pressure Countertop
- Roll-Out Dinette w/Light (1265 SST & 1285 SST)
- Kitchen Faucet w/12 Volt Water Pump
- Hot Water System w/Built-In Shower (127 ST & 1265 SST)
- Hot Water System w/Outside Shower (1175 SC & 1285 SST)
- Under Floor Water Tank — 23/30 Gal. (16 Gal. Above Floor on 806, 106, 106 UD, 106 ST)
- 25 Amp Converter w/Battery Charger (35 Amp on 1175 SC & 12 Amp on 806)
- Exterior 120 Volt GFI Protected Outlet (N/A 806)
- Bedend Light w/Fan (Opt. on Sports)
- Patio Light (N/A on 806)
- Modular Storage Cabinet (N/A 806 & 128 ST)
- E-Z Install Two Piece Screen Door (Sports)
- One Piece Screen Door w/Removable Lower Door (Classics)
- 20 Cu.Ft. Front Storage Compartment w/Light (All Sport ST Models)
- 25 Cu.Ft. Patented Super Sliding Storage Compartment (All Classic SST Models)
- Fantastic Fan Power Roof Vent (N/A 806)
- Clothes Hanger Bar (Classics)
- Inside-Outside Side Storage Drawer (108 ST & 1285 SST)
- Wide Trac E-Z Lube HD Spring Suspension (Sports)
- Wide Trac E-Z Lube HD Torsion Suspension (Classics - 5200 Lbs. Rating on 1175 SC)
- Electric Brakes (126 ST, 128 ST, 127 ST & All Classics)
- Seamless High Density Polyethylene Wheel Wells
- Low Profile Removable Tongue Jack w/ Rubber Wheel
- Durable 7 Wire Trailer Connection
- Tubular Steel Frame w/ E-Coat Finish
- 4 Crank Down B.A.L. Jacks (2 on 806)
- Spare Tire, Bracket, Cover & Entrance Step (No Bracket or Cover on 806)
- Lined Bedend Privacy Curtains & Valances

Optional Features

- 3-Way Dometic® Refrigerator (1.9 Cu.Ft. on Sports — 2.5 Cu.Ft. on Classics)
- 20,000 BTU Suburban Furnace
- Awning
- Screenroom w/Privacy Flaps
- Modular Cassette Potti w/Electric Flush (N/A 806 & 128 ST)
- Hot Water System w/Outside Shower (All Sport ST Models)
- Electric Brakes
- Camp Rite Package — Grill Hose, Battery Box, & Second Gas Bottle Ring
- Second Gas Bottle & Vinyl Double Bottle Cover
- Vinyl Single Gas Bottle Cover
- Hanging Storage Cabinet
- Hanging Wardrobe Cabinet
- Bike Rack - Roof Mount
- Mattress Heater & 12 Volt Outlet
- Carefree Power Lift
- Entrance Door Caddy (Sports Only)
- Ridge Pole Storage Pouch
- Cutting Board Sink Cover
- Water Filter
- Bed Sheet Set



1175 SC

2010
Coachmen Clipper

Express

**ONLY
455 LBS.**

AT COACHMEN,
we're all about easy.
Our motorhomes, fifth
wheels, travel trailers
and folding campers
are designed to be easy
to use, easy to enjoy,
easy to own. And our
no hassle warranty
keeps them that way.

- 455 Lbs. Total Weight!
- 12 Cu.Ft. Top Storage Compartment
- Heavy Duty VRX-14 Vinyl Tent
- Two Double Beds & In/Out Table

Specifications

Ext. Box Size (front to back)	6' 6"
Travel Length	10' 3"
Travel Width	65"
Travel Height	31"
Interior Open Length	11' 10"
Interior Open Height	6' 9"
Sleeping Capacity	4
Side Sleeping Area	46 x 72
Inside/Outside Table Size	27 x 39
Tire Size	4.80 x 8
Tire Load Range	4 Bolt B
Hitch Weight # (approx. lbs./kg.)	40/18
Axle Weight # (approx. lbs./kg.)	415/188
Coupler Ball Size	2"



Viking
Recreational Vehicles
A Forest River Company
580 West Burr Oak Street
P.O. Box 549
Centreville, MI 49032
269.467.6321

To see how Coachmen
is making the easy life
even easier, visit
www.easyRVing.com
or call 269.467.6321.



A Berkshire-Hathaway Company

All information contained in this brochure is believed to be accurate at the time of publication. However, during the model year, it may be necessary to make revisions and Coachmen reserves the right to make all such changes without notice, including changes in prices, colors, materials, equipment and specifications, as well as the addition of new models and the discontinuance of models shown in this brochure. Therefore, please consult with your Coachmen dealer and confirm the existence of any materials, design or specifications that are material to your purchase decision.

Viking RV 2009 Printed in U.S.A.
F-66-210



Coachmen
Life should be so easy.

Coachmen

Easy to Use. Really.

Pete, the Coachmen mascot, symbolizes our commitment to being your best friend on the road. Like Pete, we're always there to make sure everything about your Coachmen is as easy and uncomplicated as possible, so you can escape from the hassles and worries of everyday life and enjoy RVing.

Your Coachmen will be easy to buy, easy to use and easy to own. That's our promise to you. We accomplish this in big ways through clever designs and superior support after the sale. But the real measure of being "easy" is in the countless thoughtful touches we include throughout your new Coachmen RV. As you

review this brochure please check out many of our easy touches.

Remember, no matter where the road takes you, the going is always easier with Coachmen.

Easy to Enjoy. Honest.

When you go RVing, there's one thing you should always leave behind: worry.

At Coachmen, our no hassle warranty is our commitment to you, to assure your ongoing satisfaction. This no hassle warranty means that we won't refer you back to some supplier you've never heard of. We won't bounce you back and forth between the dealership and the factory.

Also, should you ever need service or repair; it is easy to find one of the hundreds of Coachmen dealers or authorized repair centers nationwide.

We take pride in working with you to keep your RV experience as enjoyable as possible. We're with you every step of the way. Coachmen. You couldn't ask for an easier traveling companion.

Limited Warranty

- Lift System - Lifetime
- Vinyl Tent - 5 years
- Roll Out System - 5 years
- Frame - 5 years
- Roof Assembly - 5 years
- Dexter® Axle - 5 years
- Refrigerator - 3 years
- Plumbing System - 10/25 year
- Electronic Converter- 2 years
- Roof Exterior - 2 years