

ADMIRAL®
2010



HOLIDAY RAMBLER®

This is Living®



Admiral





35SED | INFINITY II | NEWPORT CHERRY II



LET'S GET ROLLING.

There's a lot of country out there, and the 2010 Admiral is a great way to see it all and do it all. This popular motorhome boasts an impressive new exterior, with full-body paint and painted graphics. You'll find a wide range of beautiful details inside, including new raised panel cabinet doors, solid surface countertops and cozy Leatherette recliner cockpit seats. Select models offer the incomparable spaciousness of our exclusive PanaSuite full-wall slide-out on the driver's side. It's just a few of the ways the Admiral makes a great home on the road.



Admiral
2010



When you purchase a Holiday Rambler, you can be sure the storage boxes are some of the strongest and most reliable you'll find anywhere. They feature our exclusive multi-layer construction to give you maximum insulation and to reduce the chance of warping, twisting or shifting.

9-LAYER ROOF CONSTRUCTION

(top to bottom)

- One-piece peaked fiberglass roof
- Luaun backing
- Thick, tapered bead foam insulation
- Aluminum double I-beam superstructure filled with fiberglass insulation
- Vapor barrier
- Structure foam: thermal insulative barrier
- 1/2" bead foam insulation
- Foam padding for extra insulation
- Padded vinyl ceiling



4-LAYER SIDEWALL CONSTRUCTION

(right to left)

- Smooth gel coat fiberglass wall
- 1-1/2" thick foam insulation
- 1-1/2" x 1-1/2" square tubular aluminum frame
- Interior paneling

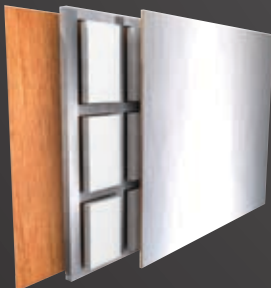

4-LAYER FLOOR CONSTRUCTION

(top to bottom)

- Structurwood™
- High-performance thermal insulation foam
- 1-1/2" aluminum tube
- Three-ply poly underbelly

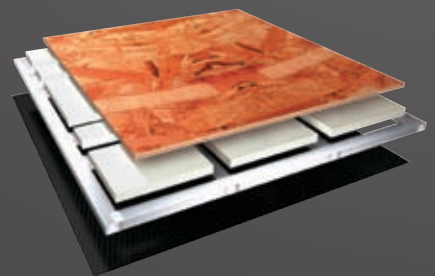



NEWPORT CHERRY II

COLORS AND PATTERNS IN PERFECT HARMONY.

Leave it to Holiday Rambler to offer you enticing exterior colors and interior décors. Choose the one that fits your style — from boldly sophisticated to classic elegance. Then, put it together with beautiful raised panel hardwood cabinetry, and you've created a masterpiece all your own.



INFINITY II



HONEYCOMB IV

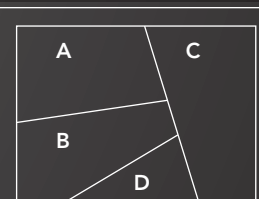

- A. BEDSPREAD
- B. SOFA
- C. ACCENT
- D. CARPET



BODY CONSTRUCTION: FEATURES

- Laminated Sidewall Construction
- Smooth Gel Coat Fiberglass Exterior Walls
- Front Molded Fiberglass Caps
- Panaview™ 1-Piece Front Windshield
- Large Chrome Front Grille
- Rear Cap with Large Automotive Style Taillights
- Interior Height 84 inches
- One-Piece Interior Engine Cover
- Front-Mounted 17.5" Chrome Head Exterior Mirror with Power Control Heads and Heat
- Metal Fuel Door with Lock
- One-Piece Polyethylene Pass-Through Storage Compartment
- Side-Hinged Baggage Doors, All Door Locations
- 4-Color Full-Body Paint with Painted Graphics, Awning with Metal Covers
- Rear Ladder
- Undercoating

OPTIONS

- Film Front Protection Mask
- Standard Run Savings Package: Film Front Protection Mask, Kitchen Powered Attic Fan w/ Wall Control of Automatic Dome and Fan Power, 3-Camera Rear Vision System, Central Vacuum System, Front Living Room DVD Player, RV Sani-Con 2 System, 12V Heater in Wet Bay

FORD 20,500 LB. CHASSIS/ENGINE/SUSPENSION (30SFS ONLY): FEATURES

- 6.8L 3-Valve V-10 Gasoline Engine with Electronic Fuel Injection
- Engine Displacement: 6.8 Liters 415 Cu. In.
- Power: 362 HP, Torque: 457 lbs./ft.
- TorqShift 5-Speed Automatic Overdrive Transmission with Tow/Haul Mode
- Transmission Oil Temperature Gauge
- Fuel Tank Capacity 75 Gallon
- 130 Amp Alternator
- Rear Axle Ratio 5.38:1
- Stainless Steel Wheel Liners
- Leaf Spring Suspension
- Front and Rear Disc, 4-Wheel Anti-Lock Brakes
- Heavy-Duty Front Track Bar with Shock Absorbers
- Fully Automatic Hydraulic Leveling System
- Prewire for Supplemental Braking System
- 5,000 lb. Hitch Receiver with Dual Connector 4-Pin or 7-Pin
- SmartStructure II

WORKHORSE 20,700 LB. CHASSIS/ENGINE/SUSPENSION (30SFS ONLY): FEATURES

- 8.1L V-8 Gasoline Engine with Electronic Fuel Injection
- Engine Displacement: 8.1 Liters 496 Cu. In.
- Power: 340 HP, Torque: 455 lbs./ft.
- 6-Speed Automatic Transmission with Overdrive
- Fuel Tank Capacity 75 Gallon
- 145 Amp Alternator
- Rear Axle Ratio 5.13:1
- Stainless Steel Wheel Liners
- Leaf Spring Suspension
- ABS Brake System
- Fully Automatic Hydraulic Leveling System with Aluminum Legs
- Prewire for Supplemental Braking System
- 5,000 lb. Hitch Receiver with Dual Connector 4-Pin or 7-Pin
- SmartStructure II

FORD 22,000 LB. CHASSIS/ENGINE/SUSPENSION (N/A: 30SFS AND 33SFS): FEATURES

- 6.8L 3-Valve V-10 Gasoline Engine with Electronic Fuel Injection
- Engine Displacement: 6.8 Liters 415 Cu. In.
- Power: 362 HP, Torque: 457 lbs./ft.
- TorqShift 5-Speed Automatic Overdrive Transmission with Tow/Haul Mode
- Transmission Oil Temperature Gauge
- Fuel Tank Capacity 75 Gallon
- 130 Amp Alternator
- Rear Axle Ratio 5.38:1
- Wheel/Rims Polished Aluminum Wheels
- Leaf Spring Suspension
- Front and Rear Disc, 4-Wheel Anti-Lock Brakes
- Heavy-Duty Front Track Bar with Shock Absorbers
- Fully Automatic Hydraulic Leveling System with Aluminum Legs
- Prewire for Supplemental Braking System
- 5,000 lb. Hitch Receiver with Dual Connector 4-Pin or 7-Pin
- SmartStructure II

WORKHORSE 22,000 LB. CHASSIS/ENGINE/SUSPENSION (N/A: 30SFS): FEATURES

- 8.1L V-8 Gasoline Engine with Electronic Fuel Injection
- Engine Displacement: 8.1 Liters 496 Cu. In.
- Power: 340 HP, Torque: 455 lbs./ft.
- 6-Speed Automatic Transmission with Overdrive
- Fuel Tank Capacity 75 Gallon
- 145 Amp Alternator
- Rear Axle Ratio 5.86:1
- Aluminum Wheels
- Leaf Spring Suspension
- ABS Brake System
- Fully Automatic Hydraulic Leveling System with Aluminum Legs
- Prewire for Supplemental Braking System
- 5,000 lb. Hitch Receiver with Dual Connector 4-Pin or 7-Pin
- SmartStructure II

COCKPIT: FEATURES

- Fiberglass Automotive Dash with Vinyl Covering, Oxford Burl Instrument Panel
- In-Dash AM/FM/CD Stereo Radio with Sirius-Ready Compatibility, Aux-in-Connection, SD Card Slot and Weather Band
- Front Power Sunvisors
- Rear Vision System Prep
- Leatherette Pilot and Co-Pilot Cockpit Recliner Seats
- 6-Way Power Pilot Seat
- Carpeted Driver and Passenger Floor Mats

OPTIONS

- Sirius Satellite Radio Tuner with Antenna
- Single Camera LCD Rear Vision System
- 3-Camera LCD Rear Vision System with Cameras in Exterior Mirrors
- Interior Solar Privacy Sunscreens
- GPS Navigation System
- Driver-Side Door with Electric Window

APPLIANCES AND ACCESSORIES: FEATURES

- Large Double-Door Refrigerator
- High-Output 3-Burner Cooktop without Oven
- Bi-Fold Range Cover
- Spacesaver Convection Microwave with Touch Control
- 26" LCD Stereo TV with Remote Control in Cockpit Overhead (N/A 33SDD, 34SBD)
- 32" LCD Stereo TV with Remote Control on Living Room Wall (33SDD, 34SBD Only)
- 19" Bedroom Widescreen LCD TV
- Curbside: Exterior Hookups for DSS Dish, Cable, 110V Outlet, with Hatch Door to Exterior
- Digital Satellite System Prep
- Curbside: Exterior Gas Line Hookup Prep for LP Accessories

OPTIONS

- Large Double-Door Refrigerator with Ice Maker 10 Cu. Ft.
- Large Four-Door Refrigerator with Ice Maker (N/A with Pantry) (N/A 30SFS and 33SFS)

- High-Output Three-Burner Range with Oven
- Washer/Dryer Prep (34SBD Only)
- Combination Washer/Dryer (Requires Washer/Dryer Prep Option) (34SBD Only)
- Central Vacuum System
- Front Living Room Area DVD Player
- Bedroom DVD Player
- 26" Exterior Storage Bay Pull-Out LCD TV with Stereo, CD, DVD and Sub Woofer

INTERIOR: FEATURES

- Hardwood Cabinetry in Newport Cherry II
- Raised Panel Cabinet Doors
- Hardwood Raised Panel Refrigerator Doors
- Wallpaper Border Kitchen and Bath
- Heavy-Duty Ball Bearing Drawer Guides
- Wood Cabinet Drawer Boxes
- Solid Surface Kitchen Countertop with Solid Surface Edge Treatment and Backsplash
- Kitchen Countertop Extension with Two Drawers Below and 110V Outlet (34SBD Only)
- Kitchen Countertop Extension (30SFS, 33SDD)
- All Other Countertops (except Kitchen) Laminated with Wood Grain Rubber Edge Treatment
- Kitchen Pantry Next to Refrigerator with Full-Height Wire Roll-Out Storage (N/A with Four-Door Refrigerator Option) (N/A 30SFS)
- Carpeting with Pad in Living Area and Bedroom
- Soft Touch Padded Vinyl Ceiling
- Wood Grain Crown Molding in Bedroom and Living Area
- Wood Slide-Out Fascia with Wood Inserts
- Satin Nickel Cabinetry Hardware and Bath Accessories
- Hardwood Framed Pocket Doors with

- Flat Panel Insert, Slide-Bolt Door Latch (N/A 33SDD, 35SFD)
- Blackout Day/Night Pleated Shades in Living Area and Bedroom

OPTIONS

- Décors: Honeycomb IV and Infinity II

FURNITURE: FEATURES

- Queen Bed with Nightstands (60" X 74" – 30SFS, 33SFS, 34SBD) (60" X 80" – 33SDD, 35SFD)
- Arched Back Wood Booth Dinette, with Side-Sliding Dinette Tabletop (33SDD, 34SBD)
- Freestanding Dinette with Two Freestanding Chairs and Two Folding Chairs (30SFS, 33SFS, 35SFD)
- Roadside: Fabric Hide-A-Bed Sofa with Air Mattress
- Curbside: Fabric Love Seat Sofa (35SFD Only)
- Leatherette Swivel-Rocker Barrel Chair (N/A 30SFS, 33SDD and 35SFD)

OPTIONS

- Roadside: Leatherette Hide-A-Bed Sofa with Air Mattress
- Roadside: Leatherette Ensemble Booth Dinette Includes Leatherette Hide-A-Bed Sofa Selection with Air Mattress (Forward-Facing Seatbelts at Booth Dinette N/A with This Option) (33SDD, 34SBD)
- Curbside: Leatherette Love Seat Sofa in Place of Fabric Love Seat Sofa (35SFD Only)
- Curbside: One Leatherette Euro-Recliner with Ottoman; Wall-Mounted Table in Place of Sofa (35SFD Only)
- Curbside: Leatherette Swivel Recliner in Place of Swivel Rocker Barrel Chair (33SFS and 34SBD Only)
- Curbside: Leatherette Euro-Recliner with Ottoman in Place of Leatherette Swivel Rocker Barrel Chair (N/A 30SFS, 33SDD and 35SFD)
- King Bed with King Bed Headboard and Bedspread (33SDD Only)
- Hallway Bunks with Two Fold-Down DVD Players with Game Hookups and Light at Each Bunk; Two Wireless Headphones and Bunk Ladder Included (34SBD Only)
- Narrowed Arched Back Booth with Side-Slide Dinette Tabletop (N/A 33SDD, 34SBD)
- Freestanding Dinette with Two Freestanding Chairs and Two Folding Chairs (33SDD, 34SBD)



Due to continuous product improvement, visit www.holidayrambler.com for the latest in standards and options, specifications, and technical data.

ELECTRICAL SYSTEMS AND LIGHTS: FEATURES

- 30 Amp 120V Distribution Panel and Cord (30SFS Only)
- 50 Amp 120V Distribution Panel and Cord (N/A 30SFS)
- 60 Amp Electronic 12V Power Converter
- Onan® 4.0 kW Generator (30SFS Only)
- Onan® 5.5 kW Gas Generator (N/A 30SFS)
- Two 6V House Batteries
- Battery Disconnect Switches
- Exterior Power Entry Step with Light
- Water Pump Switch in Service Bay Area and Convenience Center
- Lights in Outside Storage Compartments
- Underhood Utility Light
- Recessed Ceiling Map Light Above Each Cockpit Seat
- Hallway Convenience Center
- Decorative Satin Nickel Lighting: Living Room Wall Light, Dinette Overhead Light and Bath Vanity Light

OPTIONS

- 50 Amp Energy Management System (N/A 30SFS)
- 600 Watt Inverter (N/A 30SFS)

PLUMBING AND LP SYSTEMS: FEATURES

- Two-Hole Kitchen Hi-Rise Faucet with Soap Dispenser
- Central Water Filtration System
- Stainless Steel Bath Lavatory Bowl
- Satin Nickel Bath Lavatory Faucet
- Demand Water System and Water Pump
- 10-Gallon LP Gas/Electric Water Heater with Electronic Ignition
- Winterization Valving System
- Water Heater Bypass Valve
- China Toilet with Sprayer
- Holding Tank Rinsing System
- Insulated Systems Compartment with Easy Access to Hookup
- Shower Inside Wet Bay with Hot/Cold Water and Shower Head with Shut-Off
- Gravity and Pressurized Water Fill (N/A 35SFD)
- Contained Storage Area for Sewer Hose
- Shower Faucet with Shower Hose and Head with Shut-Off

OPTIONS

- RV Sani-Con 2 System
- Bathtub Option in Place of Shower

HEATING, VENTS AND AIR CONDITIONING: FEATURES

- Dual 13.5M BTU Air Conditioner with Ducted Air (N/A 30SFS)
- Single 13.5M BTU Air Conditioner with Ducted Air (30SFS Only)
- 31M BTU Electronic Ignition Furnace (30SFS Only)
- 35M BTU Electronic Ignition Furnace (N/A 30SFS)
- Electronic Dash AC/Heat Climate Control System
- Kitchen 12V Roof Vent
- Bath 12V Roof Vent
- Single 15M BTU Air Conditioner with Heat Pump in Place of 13.5 (30SFS Only)
- Kitchen Powered Attic Fan with Wall Control of Automatic Dome and Fan Power
- Bath Powered Attic Fan with Wall Control of Automatic Dome and Fan Power
- 12V Heater in Wet Bay, Heat Pad on Fresh Tank

OPTIONS

- Dual 15M BTU Air Conditioner with Heat Pumps in Place of 13.5 (N/A 30SFS)

WINDOWS, DOORS AND AWNINGS: FEATURES

- Radius Flush-Mounted Dual Pane Windows (Safety Glass, Dark Tinted)
- Rear Wall Bedroom Window (33SDD, 34SBD, 35SFD)
- Bathroom Window (35SFD Only)
- Awning Rail
- 30" Wide Radius Entrance Door with Clear Glass, Roller Shade, Screen Door
- and Anti-Skid Steps
- Topper Slide-Out Awnings in Living Area and Bedroom
- Protecta Glaze Tinted Plexiglas® Skylight in Bathroom
- Eclipse Poly-Weave Automatic Patio Awning with Metal Cover
- Poly-Weave Window Awnings in Living Area Slide-Out House Windows
- Poly-Weave Side Window Awning Bedroom (N/A 34SBD and 35SFD)

OPTIONS

SAFETY: FEATURES

- Fire Extinguisher
- Deadbolt Lock on Entrance Door
- 120V GFI Protected Circuit, Kitchen, Bath and Exterior
- LP Gas Detector
- Smoke Detector
- Carbon Monoxide Detector
- Pilot and Co-Pilot Three-Point Seatbelts
- Third Brake Safety Light
- Egress Window(s)

Weights* (Ford 20,500 Lb. Chassis)	30SFS	33SFS	33SDD	34SBD	35SFD
Gross Vehicle Weight Rating	20,500	N/A	N/A	N/A	N/A
Gross Combined Weight Rating	25,500	N/A	N/A	N/A	N/A
Front Gross Axle Weight Rating	7,500	N/A	N/A	N/A	N/A
Rear Gross Axle Weight Rating	13,500	N/A	N/A	N/A	N/A
Weights* (Workhorse 20,700 Lb. Chassis)					
Gross Vehicle Weight Rating	20,700	N/A	N/A	N/A	N/A
Gross Combined Weight Rating	25,700	N/A	N/A	N/A	N/A
Front Gross Axle Weight Rating	7,500	N/A	N/A	N/A	N/A
Rear Gross Axle Weight Rating	13,500	N/A	N/A	N/A	N/A
Weights* (Ford 22,000 Lb. Chassis)					
Gross Vehicle Weight Rating	N/A	N/A	22,000	22,000	22,000
Gross Combined Weight Rating	N/A	N/A	26,000	26,000	26,000
Front Gross Axle Weight Rating	N/A	N/A	7,500	7,500	7,500
Rear Gross Axle Weight Rating	N/A	N/A	14,500	14,500	14,500
Weights* (Workhorse 22,000 Lb. Chassis)					
Gross Vehicle Weight Rating	N/A	22,000	22,000	22,000	22,000
Gross Combined Weight Rating	N/A	26,000	26,000	26,000	26,000
Front Gross Axle Weight Rating	N/A	8,000	8,000	8,000	8,000
Rear Gross Axle Weight Rating	N/A	14,500	14,500	14,500	14,500
Measurements					
Wheelbase	190"	228"	208"	228"	228"
Overall Length	31' 0"	34' 3"	34' 3"	35' 2"	36' 1"
Overall Height, Including AC	12' 6"	12' 9"	12' 9"	12' 9"	12' 9"
Interior Height	84"	84"	84"	84"	84"
Interior Width	96"	96"	96"	96"	96"
Exterior Width	100.5"	100.5"	100.5"	100.5"	100.5"
Tank Capacities** (Gal.)					
Water Heater	10	10	10	10	10
Gray Tank	54	54	57	55	57
Black Tank	45	45	40	42	42
Fresh Tank	80	80	80	80	80
LP Tank***	20	20	21	20	20

* Towing capacity is limited by GCWR; your vehicle's towing capacity is the difference between the GCWR and the actual vehicle weight, including all water, fuel, passengers and cargo. Your towed vehicle should be equipped with auxiliary brakes if the weight of the towed vehicle exceeds 1,000 lbs. Consult your owner's manual for further towing information.

** All tank capacities are estimated based upon calculations provided by the tank manufacturers and represent approximate capacities. The actual "usable capacity" may be greater or less than the estimated capacities based upon fabrication and installation of the tanks.

*** Actual filled LP capacity is 80% of listing due to safety shut-off required on tank.

The actual overall length of the recreational vehicle may differ from that indicated in the brochure due to variances in the manufacturing process and/or installed components. The actual length may be greater or less than that indicated. Due to the large variety of options and floorplan arrangements available to our customers, actual weights for each unit can differ significantly. Holiday Rambler provides a weight sticker on each unit we produce which includes that unit's tank capacities and approximate weight. Consult your local Holiday Rambler dealer for unit availability and further information. The information printed in this brochure reflects product design, fabrication, and component parts at the date of printing. The manufacturer reserves the right, at any time, to make changes in product design or material or component specifications as its sole option, without notice. This includes the substitution of components of a different brand or trade name which will result in comparable performance. All information printed in this brochure is subject to change after the date of printing. Some features shown or mentioned in this brochure are optional and may only be available in selected floorplans. Photographs may depict a floorplan option that has been discontinued or is no longer available at the time of your purchase. Photographs may show props or decorations that are not standard equipment. Holiday Rambler, the Holiday Rambler logo and its design, are registered trademarks. Other products and company names are trademarks and/or registered trademarks of their respective holders. While the color of the motorhome's exterior and the interior fabrics depicted in this sales brochure are fair and reasonable depictions, the colors depicted may not be an exact match of the actual colors because of the variances in photo-processing and printing. Due to product improvements, changes during the model year and/or transcription errors that may occur, information represented within this brochure may not be accurate at the time of your purchase. If certain information is significant to your purchasing decision, please confirm the information with your dealer. Component part and appliance manufacturers issue limited warranties covering portions of the recreational vehicle not covered under the Limited Warranties issued by Monaco RV, LLC. To learn specific details regarding warranty coverage, please contact your selling dealership or review the warranty packet inside the recreational vehicle.



Admiral[®]
2010

30SFS

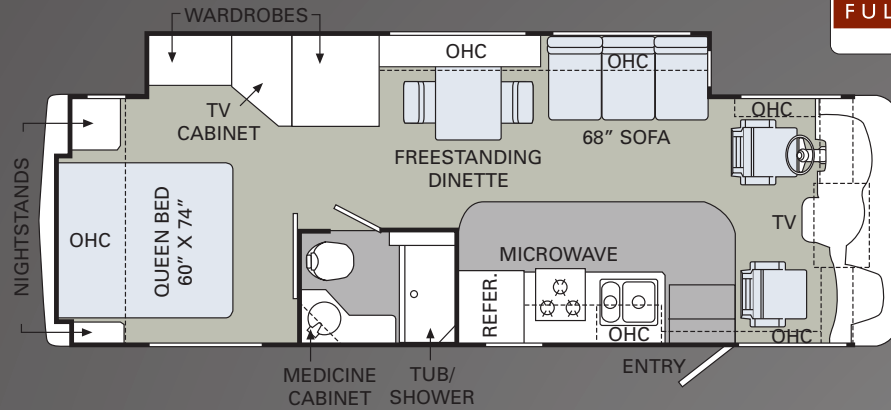

33SFS

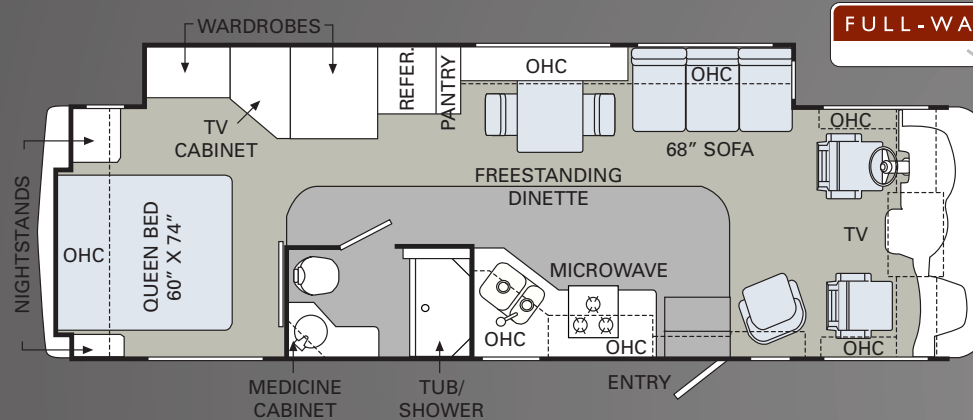

33SDD

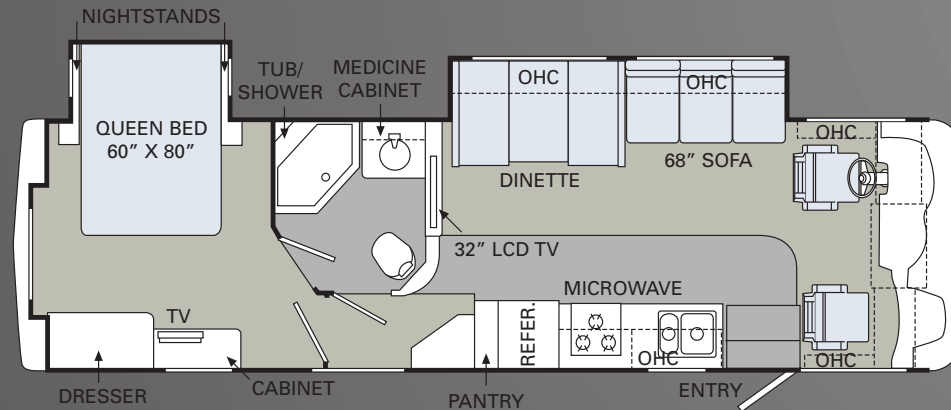

BUY LOCALLY. ENJOY EVERYWHERE.

Holiday Rambler strongly encourages our retail customers to purchase from their local dealerships whenever possible. Buying a new Holiday Rambler locally allows a customer to establish a relationship with a dealer close to home and provides convenient service and support from product-trained technicians. On our end, Holiday Rambler will continue to provide our dealer partners and customers with the finest recreational vehicles in the industry.

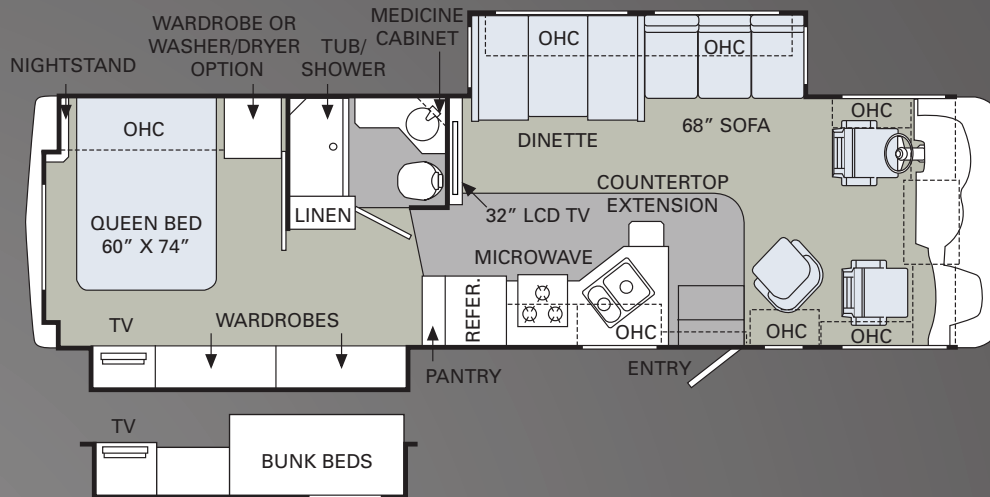

FULL-WALL SLIDE

PANA suite

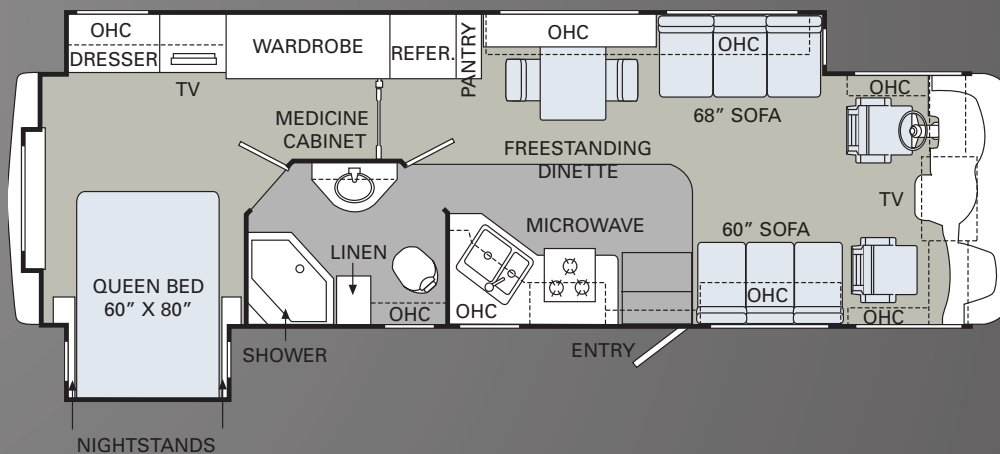

CARPET | TILE

ALL ROADS LEAD TO WWW.HOLIDAYRAMBLER.COM

Wherever the road takes you, you're never more than a click away from your friends at Holiday Rambler. Just go to www.holidayrambler.com for all the latest product news, club dates and destinations, a dealer locator function, and factory tour information. You can also e-mail us directly through the site at any time.





HOLIDAY RAMBLER®

This is Living®

At Holiday Rambler, a brand of Monaco RV, it's our goal for all our customers to enjoy their RV experience from the beginning. We have forged strong, reliable relationships with our dealer partners, and we encourage our customers to do the same. We're proud to boast a network of over 350 dealership partners and service centers across North America. We're confident that this relationship will only enhance your RV experience and provide the added peace of mind you desire, so you can focus on the important stuff. After all, we're not just selling a world-class product, we're selling "fun." You can rest assured, Holiday Rambler and Monaco RV will be along for the ride, every mile your RV adventure takes you.

NAVIGATOR®



SCEPTER®



ENDEAVOR®



NEPTUNE®



ADMIRAL®



ARISTA®



ALUMA-LITE®



AUGUSTA™

