

2010 Motorhomes by Jayco



AMERICA'S MOST **LIVEABLE** RVs.

2010 INSIGNIA

Luxury Liner



Ultimate



MANEUVERABLE

A surprisingly tight 55-degree turning radius, back-up and side-view cameras, and a one-piece seamless windshield make Insignia as easy to park as it is to drive.

INSIGNIA®
2010 Motorhomes by Jayco®

LIVEABILITY MEETS LUXURY

sophistication.

Designed as a five-star luxury suite on wheels, the 2010 Jayco Insignia offers everything you expect to find in a high-end Class A diesel pusher. Except the exorbitant price tag. Since it's built on a Freightliner chassis, with six-speed automatic transmission and a 360 HP Cummins ISC turbocharged engine, you'll have the power and maneuverability you need to handle whatever obstacles the road may throw your way. And handle them all in style.



STRONG

Insignia's Freightliner® chassis, combined with our X-Bridge™ Frame design, resists flexing and provides a strong foundation for the 5"-thick floor, with tongue-and-groove plywood underlayment, fiberglass insulation and a Poly Flex™ vapor barrier.

DURABLE

Our 2 3/4" TuffShell™ sidewall construction features a welded tubular aluminum frame, fiberglass and beadfoam insulation, 3/16" plywood and a layer of durable fiberglass.

A TRADITION OF LIVEABILITY

Starting with our first lifter system for fold-down campers in 1968, which made for an easier, more enjoyable camping experience, Jayco has always been about liveability. Today, we're the world's largest family-owned RV manufacturer, yet our priorities remain the same: making RVs more liveable and family time more memorable.



INSIGNIA 40CKFL | PAPIKA



EXTRAORDINARY IN EVERY WAY.

Insignia's tastefully decorated interior – Ultraleather™ cab and living area appointments, Washington Glazed Maple hardwood cabinetry, solid hardwood passage doors, high-end appliances, DuPont® Corian® solid-surface countertops in the bath and kitchen, plus oil-rubbed bronze fixtures and hardware throughout the coach – provide an unparalleled level of luxury and sophistication, for an RV experience that's anything but ordinary.

ELEGANT

You'll love preparing meals in the warm and roomy kitchen, complete with residential-style touches and ample storage options.

PEACEFUL

A pillowtop mattress, quilted bedspread, decorative headboard and halogen reading lights complete the bedroom's home-like atmosphere.

SPACIOUS

Insignia's bathroom boasts a fiberglass radius shower, DuPont® Corian® countertop with an integrated sink and an optional porcelain tile floor.



INSIGNIA 40CKFL | PAPRIKA



INSIGNIA 40CKFL | PAPRIKA



INSIGNIA 40CKFL | PAPRIKA

Jayco construction

At Jayco, we've built a reputation for superior construction and craftsmanship. We always use top-quality materials and production techniques, giving our products **reliable resale value** and our owners peace of mind.

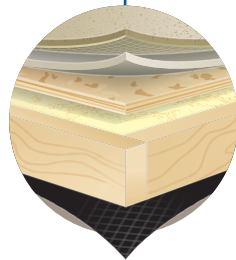

FLOOR

The dependable Freightliner® chassis, combined with the exclusive X-Bridge™ Frame design, resists flexing and provides a strong foundation for the Insignia's 5" thick floor, which features tongue-and-groove plywood, fiberglass insulation and a Poly Flex™ vapor barrier.

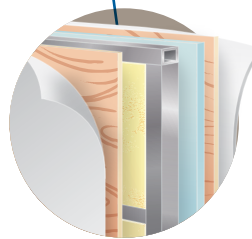

WALLS

Our 2 3/4" TuffShell™ sidewall construction features a welded tubular aluminum frame, fiberglass and bead-foam insulation, 3/16" plywood and a layer of durable exterior fiberglass.

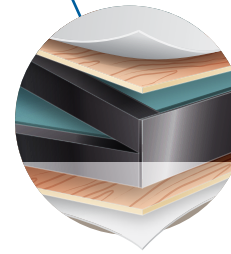

ROOF

Our seamless one-piece fiberglass roof covers 4 1/2" aluminum trusses with R-19 fiberglass insulation and a vinyl ceiling, offering superior protection from rain, heat and noise.

Jayco craftsmanship

Jayco's dedicated production team includes Amish craftsmen who build with well-honed woodworking techniques passed down for generations.



Jayco liveability

HAND-LAID TILE

Insignia's interior features optional hand-laid porcelain tile floors and backsplash, with 2" inlays.

CEDAR-LINED CLOSETS

There's plenty of room for your wardrobe in Insignia's cedar-lined walk-in style closets.

WASHER/DRYER

The optional washer/dryer combo adds convenience without taking up space.

DRAWER GUIDES

New ball bearing drawer guides provide smooth operation and full-drawer extension.

ENTERTAIN ANYWHERE

Insignia's optional outside entertainment center features a 32" LCD HDTV with CD/DVD player and speakers.

Standards and options

STANDARD BATHROOM EQUIPMENT

2-panel residential-style solid hardwood passage doors
Bathroom power vent
DuPont® Corian® solid-surface countertops with integrated sink
Oil-rubbed bronze fixtures
Overhead cabinet above stool
Radius-glass shower door
Radius-glass shower door with reeded glass design
Residential medicine cabinet with mirror
Skylight in shower
Thetford® porcelain stool with foot pedal
Toilet paper holder
Towel holder
Towel ring
Vanity light fixture
Window in commode area

STANDARD BEDROOM EQUIPMENT

26" digital LCD HDTV
Decorative headboard
Halogen oil-rubbed bronze reading lights
Home theater system, Dolby® Digital 5.1 Surround Sound with DVD
Large wardrobe
Queen bed with pillowtop mattress (60" x 80")
Quilted bedspread with 2 pillow shams

STANDARD KITCHEN EQUIPMENT

Amana® 1.6 cu. ft. convection microwave oven with carousel
DuPont® Corian® bi-fold, recessed cover for stove
DuPont® Corian® sink covers (2)
DuPont® Corian® solid-surface countertops with integrated sink
High-rise single-lever faucet with pull-out sprayer
Mini-blind
Norcold® 12 cu. ft. 4-door refrigerator with ice maker
Porcelain tile backsplash with tinted glass inlays
Recessed, sealed 3-burner range
Silverware drawer, divided for utensils
Slideout dinette table with (2) chairs
Under-sink, stove and sink cover rack

STANDARD CAB EQUIPMENT

3-point, lap and shoulder safety belts (driver and passenger)
12V auxiliary in-dash receptacle (2)
Adjustable foot pedal
Auxiliary start switch
Chassis battery disconnect
Color back-up camera and monitor
Cruise control
Freightliner® message center with LCD display featuring: odometer, tachometer, instantaneous fuel economy, fuel remaining, outside air temp., coolant temp., engine oil temp. and pressure, transmission temp., turbo boost pressure and air pressure
High-output dash heater and A/C
Intermittent windshield wipers, single motor
Kenwood® touch-screen AM/FM/CD/DVD with camera, navigation and Bluetooth®

Non-powered side sun visors and privacy shade
Powered front sun visors and privacy shade
Powered stepwell cover
Push-button shift control
Smart wheel
Tilt and telescoping steering
Windshield, one-piece tinted

STANDARD CHASSIS EQUIPMENT

2 chassis batteries
4.63 rear axle ratio
22-1/2" radial tires
55-degree turning radius
100-gal. fuel tank (dual fill)
160-amp alternator
1,000-watt in-block engine heater
10,000-lb. hitch with 7-pin plug
50,000-PSI frame rail
Allison® 3,000 MH 6-speed electronic transmission
All-wheel ABS brakes
Cummins® ISC Turbocharged 360 HP Engine 1,050-lb. ft. torque at 1,400 RPM
Daytime running lights
Engine exhaust brake
Freightliner® XCR Series Chassis
Front axle 12,400-lb. I-beam Wide-Trac™
Neway® air suspension
Polished aluminum wheels
Raised rail for maximum storage
Rear axle, 20,000-lb.
Rear radiator with fan clutch
Sachs™ shocks

STANDARD CONSTRUCTION FEATURES

5/8" tongue-and-groove plywood main floor decking
1/2" bead-foam insulation and fiberglass insulation in sidewalls (R-10)
1-1/2" welded tubular-aluminum fiberglass framework
2" x 4" floor trusses
4-1/2" arched aluminum truss roof (R-19)
Cabinetry crafted with screwed-stile hardwood construction
Deluxe hidden cabinet hinges
Electric-powered slideout
Enclosed, insulated and heated underbelly (R-14)
Fully-decked roof with 3/8" plywood
One-piece fiberglass roof
Sidewalls bolted to frame
Smooth gel-coat fiberglass exterior walls
X-Bridge™ Frame support

STANDARD EXTERIOR EQUIPMENT

120V G.F.C.I. protected exterior receptacle
Carefree® armored slideout awnings
Carefree® Eclipse™ awning with polyweave fabric, armored side and wind sensor
Chrome, heated, remote-control, side-view mirrors
Docking lights
Door for dump valve access

Driving lamps
Electric-powered, double entrance step
Frameless dual-pane windows
Full-body premium paint package
Hydraulic automatic leveling jacks
Lighted heavy-duty grab handle
One-piece pass-through storage compartments
Patio light with inside switch
Rear molded fiberglass cap
Roof ladder
Side-hinged baggage doors
Sliding battery tray
Uni-Dock™ exterior utility center, heated and enclosed with second system monitor panel

STANDARD INTERIOR EQUIPMENT

2-panel residential-style passage doors throughout
32" LCD HDTV in dash overhead (40CKFL)
40" LCD HDTV in living area (36CKFL, 40FKSA)
All-in-one home theater remote
Ball bearing drawer guides 75-lb. capacity with full-drawer extension
Cable TV hookup with RG6 coax
Crank-up HDTV antenna with signal booster
Decorative oil-rubbed bronze lighting throughout
Decorative pillows for sofa and hide-a-bed
Decorative trim package
Fabric-covered box valances with lambrequin legs
Hardwood cabinets
Hardwood fascia boards
High-intensity halogen recessed 12V lighting package
Home theater system, Dolby® Digital 5.1 Surround Sound with DVD
Lights at entrance steps
Padded vinyl ceiling throughout
Phone jack
Pleated day/night shades throughout
Prep for satellite dish for roof
Prep for washer and dryer
Residential-style trim and molding
Ultraleather™ hide-a-bed sofa
Washington Glazed Maple solid hardwood cabinetry and raised-panel doors throughout

STANDARD HEAT, POWER AND WATER

5-watt solar panel (for chassis batteries)
12-gal. gas/electric DSI auto-ignition water heater
12V demand water pump
12V electrical system
40-gal. propane gas tank, chassis-mounted
50-amp electric service
50-amp quick-connect power cord
2,000-watt inverter with (4) 6V batteries
42,000-BTU furnace with auto-ignition
Black holding tank sprayer
Conveniently-placed water pump switches
Dual insulated ceiling air ducts with adjustable air vents
Holding and fresh water tanks, radiant-heated
Hookup for city water

Onan® 8,000-watt diesel generator with auto-changeover on sliding tray
Onan® Energy Command™ center
Outside shower
Systems monitor panel
Water heater bypass system
Winterizing kit

STANDARD SAFETY EQUIPMENT

Battery disconnect switch
Deadbolt lock on entrance door
Egress window
Fire extinguisher
Lap safety belts in living area
Propane/carbon monoxide alarm
Smoke alarm
Third brake light

OPTIONS

22" oven
26" LCD front overhead TV (select models)
Air horns
Auto-rewind water hose (power)
Burnished Glazed Maple hardwood cabinetry
Canadian standards
Central vacuum system
Customer Value Package
Dakota Sandstone premium paint package
Electric power cord reel
Exterior 32" LCD HDTV with CD/DVD player and speakers
Fireplace (select models)
Iron Slate premium paint package
Multiplex lighting
Sirius® radio tuner/antenna
Slideout cargo tray
Washer/dryer combination
Window awning
Winegard® In-Motion™ dome satellite dish

CUSTOMER VALUE PACKAGE

6-way power, Ultraleather™ driver and passenger seat
Carefree® power entrance door awning
CB antenna
Ceiling mirror
Dual 15,000-BTU low-profile central A/C with heat pump, digital thermostat and Chillgrille™
Full-width mudflap
In-dash compass and exterior temperature gauge
Porcelain tile kitchen, bathroom, living area and driver compartment with 2" inlays
Security lights (2)
Security system
Side cameras with turn signals
Ultraleather™ sofa
Water purifier with faucet

Specifications

FLOORPLAN	EXTERIOR LENGTH	EXTERIOR HEIGHT W/AC	INTERIOR HEIGHT	GROSS VEHICLE WEIGHT RATING (LBS.)	GROSS COMBINED WEIGHT RATING (LBS.)	ENGINE/SIZE	WHEEL BASE	FURNACE AUTO IGNITION (BTUS)	FRESH WATER CAPACITY* (GALS.)	GRAY WASTE WATER CAPACITY (GALS.)	BLACK WASTE WATER CAPACITY (GALS.)
36CKFL	37' 5"	152"	84"	32,400	42,400	Cummins ISC-360 8.3L	228"	42M	93	60	60
40CKFL	40' 11"	152"	84"	32,400	42,400	Cummins ISC-360 8.3L	266"	42M	93	60	60
40FKSA	TBD	TBD	84"	32,400	42,400	Cummins ISC-360 8.3L	266"	42M	93	60	60

* includes water heater

Floorplans

◀ = outside storage
 LAV. = bathroom sink
 MICRO. = microwave
 OHC. = overhead cabinets
 REFRIG. = refrigerator
 WARD. = wardrobe

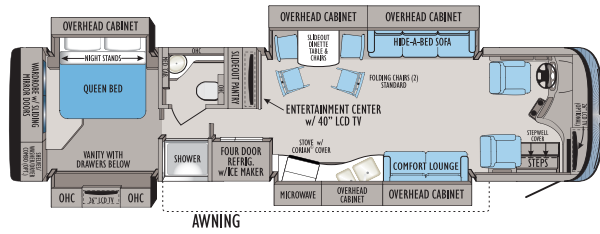

INSIGNIA | 36CKFL

Ext. Length: 37' 5" Ext. Height: 152"

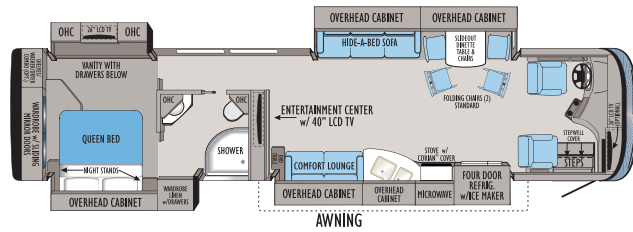

INSIGNIA | 40FKSA

Ext. Length: TBD Ext. Height: TBD

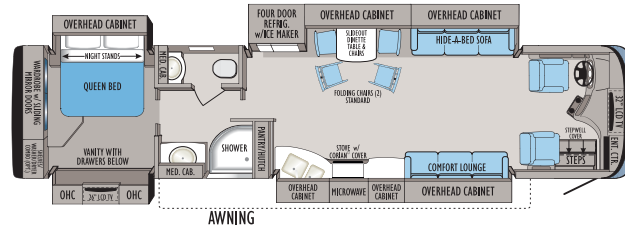

INSIGNIA | 40CKFL

Ext. Length: 40' 11" Ext. Height: 152"

Exterior color options

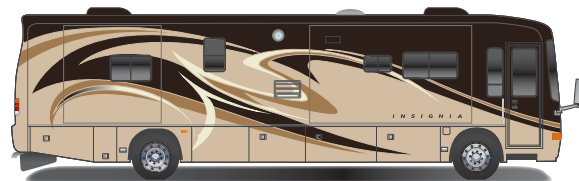

DAKOTA SANDSTONE PREMIUM PAINT

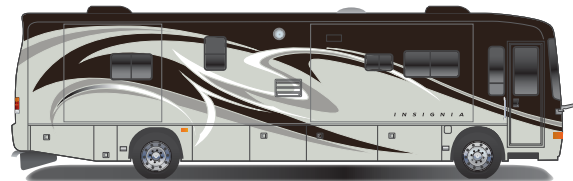

IRON SLATE PREMIUM PAINT

Gross Vehicle Weight Rating (GVWR): GVWR means the maximum permissible weight of the motorhome, including the Unloaded Vehicle Weight (UVW) plus passengers, personal items, all cargo, fluids, options and dealer-installed accessories. The GVWR is equal to or greater than the sum of the UVW and the Cargo Carrying Capacity.

Gross Combined Weight Rating (GCWR): The maximum allowable combined weight of the motorhome used as a tow vehicle and the attached towed vehicle.

Gross Axle Weight Rating (GAWR): The maximum allowable weight each axle assembly is designed to carry, as measured at the tires, therefore including the weight of the axle assembly itself.

Interior color options

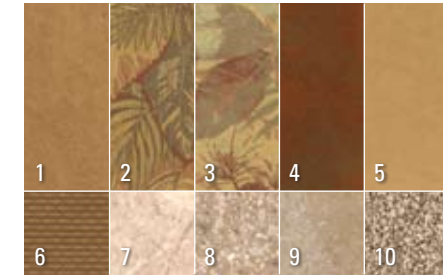

PAPRIKA

- 1 Sofa and driver/passenger chairs
- 2 Accent fabric
- 3 Bedroom accent
- 4 Bedroom accent
- 5 Bedroom accent
- 6 Chair
- 7 Wall panel
- 8 Countertop
- 9 Flooring
- 10 Carpet



CARAMEL



IVORY



WOOD OPTIONS

It is important for your safety and enjoyment that you are aware of the weights and tow ratings of the RV you select. Consult a competent advisor for questions or advice. Whether you are new to RVing or a veteran, get a feel for the performance of your RV before heading out on the roadways. When you tow a vehicle with your RV, you must drive differently than when you drive a single vehicle. Practice hooking up, driving, backing up and braking in a safe environment or seek out professional instruction. Jayco affixes a weight label to each RV which lists weight information for that vehicle. Refer to that label to verify the vehicle will meet your requirements.



AMERICA'S MOST **LIVEABLE** RVs.

1 YEAR LIMITED WARRANTY

The Jayco Insignia Motorhome Warranty is a manufacturer's limited warranty. It comes from the people who build Jayco recreation vehicles to the people who buy them. Each Insignia is warranted to the original purchaser for twelve (12) months from the original date of purchase (or 12,000 miles, whichever comes first) against defects in materials and workmanship. The Insignia Motorhome Warranty also includes a three (3) year structural guarantee. Jayco's limited warranty is not transferable. **Go ahead and compare the Jayco warranty with other manufacturers' warranties. You'll find it's the best in the business!**

For a copy of the limited warranty with full terms and conditions, ask your local Jayco dealer.

Your Jayco Dealer

300 JAYCO DEALERS

Establishing a solid relationship with your local Jayco dealer is a key component in the enjoyment of your new Jayco. By purchasing from a local dealer, you will have a convenient location for sales, parts and service support.

Jayco dealers are required to deliver all products at the site of the sale to provide a full product orientation and walkthrough at the time of delivery. It's a good way to become familiar with your Jayco and to meet the service, parts and warranty staff members who will be assisting you. If you live in Canada, there are regulations that must be met when buying a Jayco RV. Your local Canadian dealer is a professional at meeting these requirements and regulations. There simply is no substitute for a good relationship with your local Jayco dealer.

1 YEAR ROADSIDE ASSISTANCE

Travel worry-free with Jayco's Customer First Roadside Assistance program, yours at no cost during your first year of ownership. This program is offered through Coach-Net®, the largest RV emergency road service in the country, and gives you immediate access to dependable roadside assistance and support services with a simple phone call.

- Free jump starts
- Free tire changes
- Free fuel delivery
- Free lockout service
- Free travelers checks
- Toll-free nationwide service appointment assistance
- 24-hour toll-free emergency message service
- Free custom trip routing and full-color map service
- Free dispatch of on-site mechanical service
- \$2,000 trip-interruption reimbursement
- RV technical assistance hotline
- Free towing to nearest qualified service



Jayco proudly sponsors Tread Lightly!, a nonprofit organization whose mission is to empower generations to enjoy the outdoors responsibly through education and restoration.



From RV insurance to extended warranties, JayPlus has it covered. Ask your Jayco dealer about our exclusive JayPlus program today.



As a Jayco owner, you can be part of the Jayco Jafari International Travel Club. Ask your dealer about the Jafari "flight" in your area, write Jayco or visit our website.

Jayco, Inc., P.O. Box 460, Middlebury, IN 46540
www.jayco.com 

See dealer for further information and prices. All information in this brochure is the latest available at the time of publication approval. Jayco reserves the right to make changes and to discontinue models without notice or obligation. Photos in this brochure may show optional equipment and props for photography purposes. RVs built for sale in Canada may differ to conform to Canadian codes. ©2010 Jayco, Inc. 10-INSG-PL 0909-10K Printed in U.S.A.