

CAMBRIA

{ 2010 }



 **ITASCA**



Now is the Time

Get out there and explore. See new places. Take the road less traveled. Visit old friends and meet new ones. There's a whole world out there waiting for you. Let your imagination run wild, because when you own an Itasca Cambria®, the possibilities are limitless.

The Itasca Difference Itasca motor homes are built on our exclusive SuperStructure® foundation creating some of the industry's strongest, most durable motor homes. Quality components, precision manufacturing and attention to the smallest details—such as running every coach through our high-pressure leak test—all go into making Itasca motor homes simply the best.



CAMBRIA

Exteriors

Upgrade from deluxe graphics to full-body paint and add the available stylized aluminum wheels for an even more distinct appearance.

Espresso Metallic
{ DELUXE GRAPHICS }



Pewter Metallic
{ DELUXE GRAPHICS }



Sandstone
{ FULL-BODY PAINT }



Deep Pool
{ FULL-BODY PAINT }



Harvest Frost
{ FULL-BODY PAINT }



Hot Red
{ FULL-BODY PAINT }



Interior Décor

Choose from three fabric collections. Upgrade to UltraLeather™ furniture for luxurious comfort that is both durable and easy to clean. The cabinetry comes in your choice of Honey Cherry, Belmont Maple, or Forest Cherry finish with satin nickel hardware for a warm, inviting interior.

Honey Cherry



Belmont Maple



Forest Cherry



Godiva

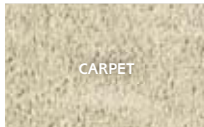
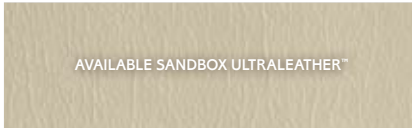
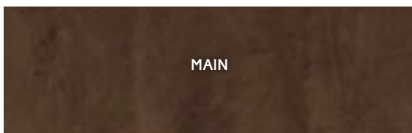

Cornerstone

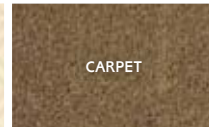
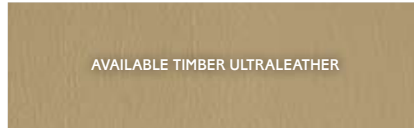
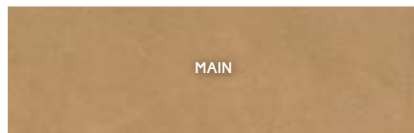

Remington

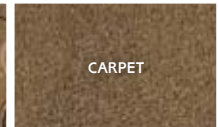
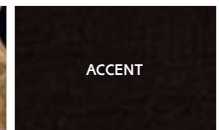
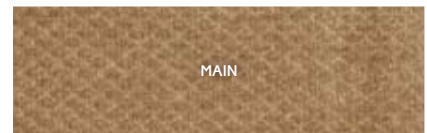



SMARTSPACE™

Bold, Nimble and Refined

These words will spring to mind when you catch your first glimpse of the 2010 Itasca Cambria®. The Cambria embraces Winnebago Industries' SmartSpace™ design philosophy with innovative features such as an available bedroom TV that can be used both indoors and out for added flexibility. Two floorplans that feature double and triple slideouts are available to suit your style. Enjoy the openness created by the available skylight and you can also add an interior upgrade package that includes a dash and beverage tray appliqué, accent rope lighting, a kitchen backsplash, range and sink covers, pleated day/night window blinds and the Dream Dinette™ table upgrade (30C). Make the most of your next trip as proud owner of your 2010 Itasca Cambria.

Comfort Sofa Sleeper This 2-in-1 sofa redefines comfort and convenience.

- 1) By day it's a plush sofa.
- 2) A hidden drawer stores bed linens.
- 3) It converts easily into a bed.
- 4) The mattress inflates and deflates with an automatic pump.

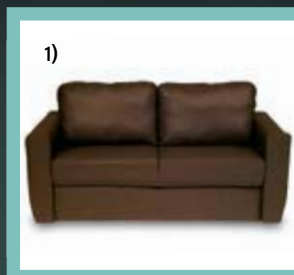



30C Cornerstone with Honey Cherry

Entertainment Features

- 26" LCD TV
- Home theater sound system w/DVD player
- Available King-Dome® HD in-motion satellite dish
- Available 300-watt inverter
- RV Radio*
- Available Sirius® satellite radio w/iPod interface connector

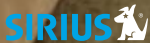

It's All Inside

Designed with you in mind, you'll love every minute in your Cambria. The fun starts with an overhead entertainment center, complete with a 26" LCD TV and a home theater sound system with five speakers, a subwoofer and DVD player. The video selection system allows you to watch DVDs on the available bedroom TV. Press a button and the available Rest Easy® multi-position lounge glides from sofa to recliner to comfortable bed (30C). A large available skylight with a built-in shade and built-in cab window blinds let you control light and privacy levels. The sofa readily converts into a bed on the 30C or you can upgrade to the new Comfort Sofa Sleeper.

The kitchen is fully equipped with a 3-burner range top with storage below and a microwave oven with a vented range hood. Choose the available microwave/convection oven for even more cooking options. Features such as an available water filtration system for cold water and full-extension drawers add to the at-home feel. When dinner is ready, you'll dine in comfort with the U-shaped dinette (28B) or dinette (30C). Choose the interior upgrade package and enjoy the Benchmark® dinette with the Dream Dinette™ table that easily adjusts with one hand to the perfect height.



REST EASY®



30C Cornerstone with Honey Cherry

Get a Great Night's Sleep

After a day of exploring, the available Ideal Rest™ memory foam mattress is the perfect place to unwind and recharge. Whether you're fast asleep or watching the available LCD TV, you'll love the body-conforming mattress. The 30C features a full bath with an elegant, curved glass shower door. The 28B includes a retractable shower door that conveniently squeegees itself clean.



 Ideal Rest™



Bed/Bath features

- Available Ideal Rest body-conforming memory foam mattress
- Available 19" LCD TV (30C)
- Available 15" LCD TV (28B)
- Shower skylight
- Flexible showerhead

More Enjoyment The available exterior entertainment center includes an AM/FM stereo, a CD player and a removable table. You can also easily take the available bedroom TV outside to its exterior mounting bracket and enjoy your favorite shows under the available awning.



Easy Does It The TrueLevel™ holding-tank monitoring system uses sonar technology to read liquid levels from outside the tank. There are no probes to corrode or clog, just accurate readings time after time.



TRUEREVEL



The only manufacturer to have received the RVDA Quality Circle Award for exceptional products, service and support for 12 consecutive years



The World is Your Campsite

Pull up in style wherever you go in your new Cambria, choosing from four full-body paint options and available stylized aluminum wheels. Underneath the awning you can listen to music on the available entertainment center or watch the available TV. A deep-cycle Group 31 battery and an available 4,000-watt Cummins Onan® MicroQuiet™ generator provide power for all your accessories. You can also add a second Group 31 battery for even more power. Towing is easy with a 5,000-lb. hitch⁵ and available power mirrors with defrost. Control the available automatic hydraulic leveling jacks from the entrance door so you can watch them lower into position. Add the available rearview monitor system for optimal viewing while backing and maneuvering.

SUPER STRUCTURE

SuperStructure Legendary strength and durability are the result of SuperStructure construction that goes into every Itasca motor home. It's the combination of quality, proprietary components and careful attention to detail that makes Itasca motor homes the cream of the crop.

- Patented Thermo-Panel™ sidewalls are durable and lightweight.
- Specially engineered interlocking joints connect the floor, sidewalls and roof together for strength and durability.
- An automotive-style dip tank applies an advanced electrodeposition coating that protects critical steel components.
- The crowned, one-piece fiberglass roof is backed by a 10-year limited parts-and-labor roof skin warranty.

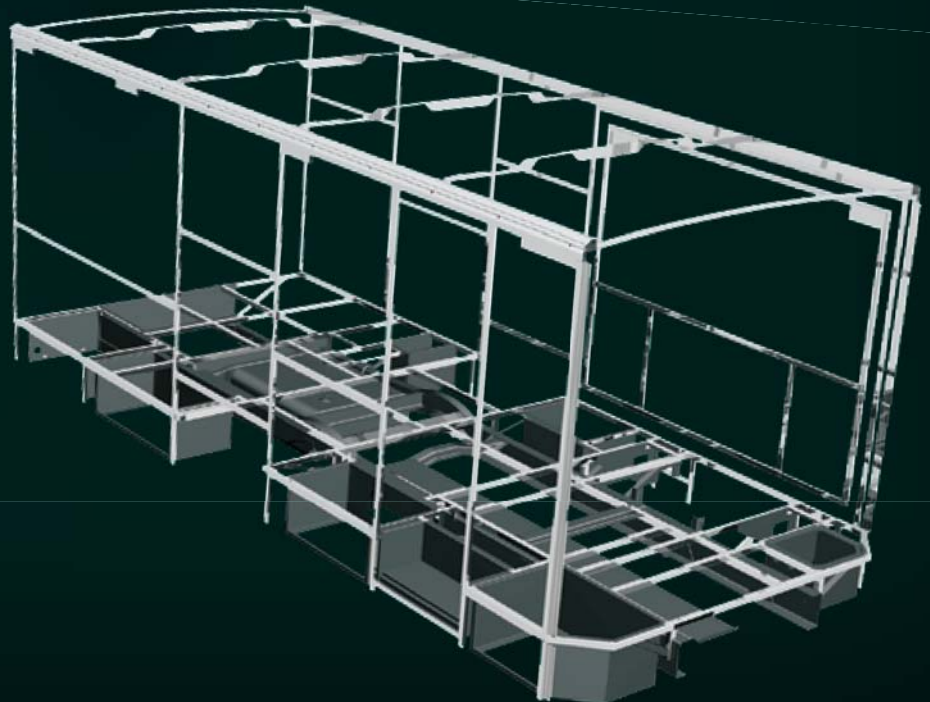

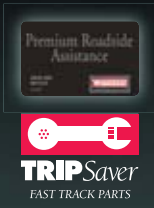

Committed to Service We back our motor homes with the industry's best service after the sale:

- 12-month/15,000-mile basic limited warranty
- 36-month/36,000-mile warranty on structure
- Standard 10-year limited parts-and-labor roof skin warranty
- Complimentary 24-hour roadside assistance program
 - RV Technical Assistance Hotline
 - RV Service Appointment Assistance
 - Emergency Trip Interruption
 - Emergency Message Service
 - Nationwide Trip Routing
 - Fee-Free Travelers Cheques

Floorplans & Specifications

Dimensions shown are for sleeping space only and may vary due to styling differences. Dashed lines denote overhead storage areas. Floorplans and specifications are also available online at Goltasca.com.

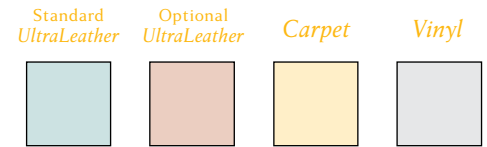

28B Weights & Measures

Length	29'7"
Exterior Height ¹	10'5"
Exterior Width	7'11"
Exterior Storage ² (cu. ft.)	28.5
Awning Length	19'
Interior Height	6'5"
Interior Width	7'8"
Freshwater Capacity w/Heater ³ (gal.)	33
Holding Tank Capacity - Black/Gray ³ (gal.)	27/35
LP Capacity ⁴ (gal.)	18
Fuel Capacity (gal.)	55
GCWR ⁵ (lbs.)	20,000
GVWR (lbs.)	14,500
GAWR - Front (lbs.)	5,000
GAWR - Rear (gal.)	9,500
Wheelbase	200"

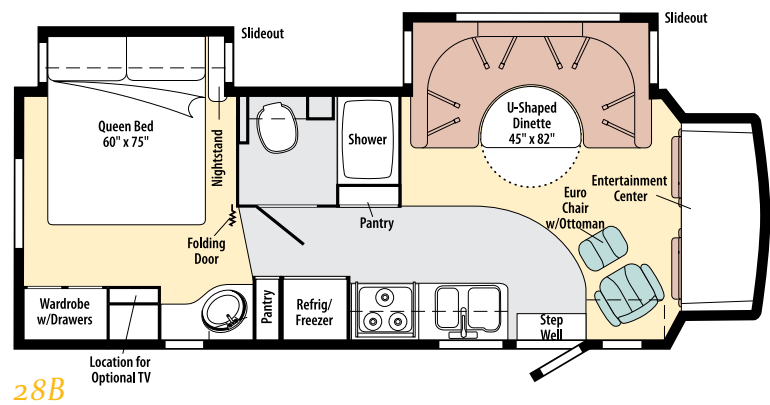

30C Weights & Measures

Length	31'7"
Exterior Height ¹	10'5"
Exterior Width	7'11"
Exterior Storage ² (cu. ft.)	13.8
Awning Length	14'
Interior Height	6'5"
Interior Width	7'8"
Freshwater Capacity w/Heater ³ (gal.)	33
Holding Tank Capacity - Black/Gray ³ (gal.)	27/35
LP Capacity ⁴ (gal.)	18
Fuel Capacity (gal.)	55
GCWR ⁵ (lbs.)	20,000
GVWR (lbs.)	14,500
GAWR - Front (lbs.)	5,000
GAWR - Rear (lbs.)	9,500
Wheelbase	220"

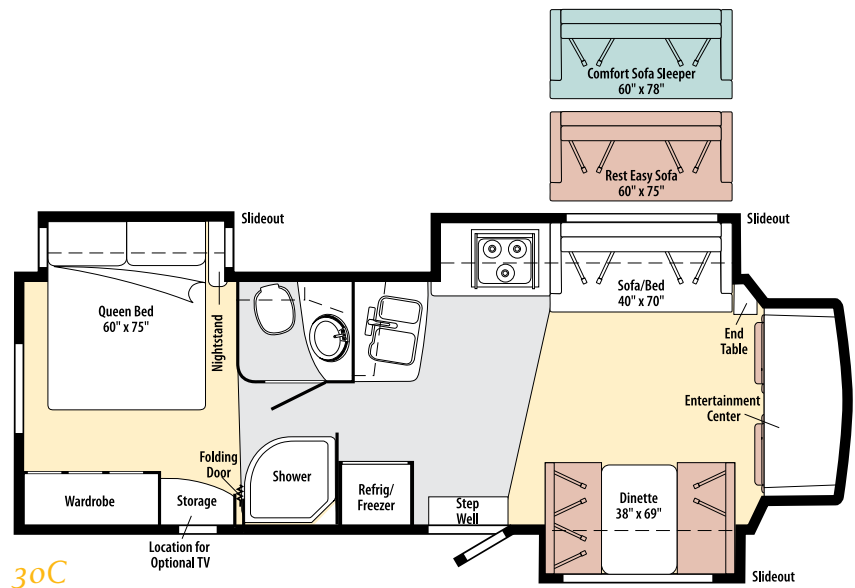

Ford® E450 Chassis

305-hp 6.8L Super-Duty V10 SEFI Triton® engine

TorqShift™ 5-speed automatic transmission

115-amp. alternator

4-wheel ABS

Trailer Hitch²: 5,000-lb. drawbar/350-lb. maximum vertical tongue weight and wiring w/7-pin connector

Stainless steel wheel liners

Optional Equipment

- Rear auxiliary air springs
- Automatic hydraulic leveling jacks (front and rear)
- Stylized aluminum wheels

Cab Conveniences

Cab Seats: armrests, lumbar support and multi-adjustable slide/recline

Beverage holders

RV Radio[®]: AM/FM, CD player, weather band, iPod/MP3 input, 2 remotes

Chassis/house battery radio power switch

Tilt steering wheel

Power steering

12-volt receptacles

Cruise control

Power door locks

Manually adjustable exterior mirrors

Sunvisors

Optional Equipment

- Sliding, pleated cab window blinds
- Rearview monitor system w/one-way audio
- Sirius[®] Plug-N-Play satellite radio system w/6-month complimentary subscription, 2 docking ports and iPod interface connector
- Power exterior mirrors w/defrost

Interior

Home Theater Sound System: amplifier, receiver, DVD player, 5 speakers, subwoofer

26" LCD TV

Satellite system ready

Video selection system

Tinted windows

Cab divider curtain

Pleated shades (lounge, dinette and bedroom)

Mini blinds (galley and bath)

Amplified digital TV antenna

Systems monitor panel

Roof vent (lounge & bedroom)

Powered roof vent (bath)

Key-activated slideroom master lock switch

Optional Equipment

- Skylight w/sliding screen, shade and vent
- **Interior Upgrade Package:** rope lighting, range backsplash, dash and beverage tray appliqué, BenchMark[®] w/Dream Dinette™ adjustable table (NA 28B), carpeted cab floor mats, 2 galley sink covers, range cover, raised-panel refrigerator door insert, 2 sofa throw pillows (NA 28B), picture, pleated day/night blinds in the lounge, dinette and bedroom
- Tinted, dual-glazed, thermo-insulated windows
- Satellite TV antenna system
- King-Dome[®] HD-ready in-motion satellite dish antenna system w/elevation sensing unit
- Powered roof vent (bedroom)

Kitchen

Laminate countertops

2-door refrigerator/freezer

3-burner range top w/storage below

Microwave oven w/vented range fan

Optional Equipment

- Cold water filtration system
- Stainless steel microwave/convection oven w/range fan

Bedroom

Queen bed w/innerspring mattress, bedspread, pillows and pillow shams

Optional Equipment

- Ideal Rest™ memory foam mattress
- Portable 19" LCD TV, DC
- Portable 15" LCD TV, DC

Bath

Curved textured glass shower door (30C)

Retractable, self-cleaning shower screen (28B)

Laminate countertop

Skylight

Flexible showerhead

Exterior

Ladder

Entrance w/screen door and step

Rear mud flaps

Porch light

Front running boards w/wheel lips

Premium high-gloss skin

Optional Equipment

- **Entertainment Center:** AM/FM, CD w/remote, DC and AC receptacles, 2 speakers, TV jack, lockable compartment, radio antenna, removable TV table
- Automatic entrance step
- Vinyl patio awning
- Acrylic patio awning (w/full-body paint)

Heating & Cooling System

13,500 BTU roof-mount, high-efficiency A/C

30,000 BTU low-profile, ducted furnace

Optional Equipment

- A/C heat pump

Electrical System

AC/DC load center, 45-amp. converter/charger

Service Center: 30-amp. 25' power cord, cable TV input, portable satellite dish hook-up

Battery disconnect system (coach)

Automatic dual-battery charge control

Auxiliary start circuit

Deep-cycle, Group 31 battery

Optional Equipment

- 4,000-watt Cummins Onan[®] MicroQuiet™ gas generator
- Additional deep-cycle, Group 31 battery
- 300-watt DC/AC inverter

Plumbing System

Service Center: city water hook-up w/diverter valve, drainage valves, 10' sewer hose

6-gallon water heater

TrueLevel™ holding-tank monitoring system

Winterization package: water heater bypass valve and siphon tube

Permanent-mount LP tank

Heated holding-tank compartment

On-demand water pump

Optional Equipment

- Exterior wash station w/pump switch
- 6-gallon LP water heater w/energy management system

Safety

Seat belts

Driver and passenger air bags

Child seat tether anchor (dinette)

LP, smoke and carbon monoxide detectors

10 BC fire extinguisher

Ground fault interrupter

High-mount brake lamps

Warranty⁶

12-month/15,000-mile basic warranty⁷

36-month/36,000-mile limited warranty on structure⁷

10-year limited parts-and-labor warranty on roof skin⁷

○ Optional

NA Not Available

1 The height of each model is measured to the top of the tallest standard feature and is based on the curb weight of a typically equipped unit. The actual height of your vehicle may vary by several inches depending on chassis or equipment variations. Please contact your dealer for further information.

2 The load capacity of your motor home is designated by weight, not by volume, so you cannot necessarily use all available space when loading your motor home.

3 Capacities are based on measurements prior to tank installation. Slight capacity variations can result due to installation applications.

4 Capacities shown are tank manufacturer's listed water capacity (W.C.) Actual filled LP capacity is 80% of listing due to overfilling prevention device on tank.

5 Actual towing capacity is dependent upon your particular loading and towing circumstances, which includes the GVWR, GAWR and GCWR as well as adequate trailer brakes. Please refer to the Operator's Manual of your vehicle for further towing information.

6 See separate chassis warranty.

7 See your dealer for complete warranty information.

Not all items available in combination. See dealer for details.

Winnebago Industries[®] continuing program of product improvement makes specifications, equipment, model availability and prices subject to change without notice. Comparisons to other motor homes are based on the most recent information available at printing.

Discover More on the Web

Want to see more of the Itasca Cambria? You'll find more pictures, in-depth info, floorplans and complete specs at Goltasca.com. You'll also see videos and highlights of key features, such as:



BenchMark®

 SMART STORAGE™

REST EASY®

 SMARTSPACE™

SIRIUS®

TRUE LEVEL™

 RV•RADIO

 SUPER STRUCTURE™

 Ideal Rest™



THE MOST RECOGNIZED
NAME IN MOTOR HOMES™

Goltasca.com

NYSE: WGO

Join the Itasca Family

Itasca owners simply have more fun. When you buy a Cambria, you can become a part of the Winnebago-Itasca Travelers Club. As a member, you'll meet other motor home enthusiasts, travel to interesting places with interesting people, and be the first to learn about new Itasca products. See what the WIT Club is all about at WITclub.com.



Seat belts are your most important hookup. Always buckle up.



©2009 Winnebago Industries, Inc.
Printed in USA

- Join the WIT Club
- Caravans and rallies
- Local and state activities
- RV travel and benefits

For Sales and Service Information Contact: