

Winnebago  
**VIEW**  
& **VIEW PROFILE**  
2010



View Profile  
ALMOND



## Winnebago VIEW & VIEW PROFILE

Power and efficiency. To those who believe you have to sacrifice one to get the other, let us introduce the 2010 Winnebago View® and View Profile. Built on a nimble Dodge®/Mercedes-Benz® Sprinter chassis and powered by a Mercedes-Benz 3.0L V6 turbodiesel engine, the View and View Profile are the embodiment of Winnebago Industries' revolutionary vision—a vision that leads the motor home industry with innovation. Inside, the View incorporates SmartSpace™ design to create streamlined, feature-filled floorplans, including full-wall slideouts on the 24A and 24K. The View Profile uses the same philosophy to create an easy-to-drive 24-foot motor home that lives larger than its size suggests. See the country from a new perspective in the 2010 Winnebago View or View Profile.

## Plenty to Love

The View interior is teeming with comfort, style and versatility, such as cab seats that swivel to face the living area (standard on 24A, 24P and available on 24K, 24J). The centrally located skylight creates an open and airy feel while providing added climate control with an easy-to-use vent. You'll find excellent sleeping accommodations with beds in the overhead bunk, Comfort Sofa Sleeper and BenchMark® dinette, depending on your floorplan.

Choose the available overhead entertainment center (NA 24A) and available 300-watt inverter to enjoy the 32" LCD TV when shoreline or generator power is not available. A stereo system with CD/DVD player comes standard, providing hours of entertainment on the road.



**Bunk** The standard bunk lifts up on gas struts to stay up and out of the way until needed. The available entertainment center includes a 32" TV and extra storage.



**GoWinnebago.com** Watch key feature videos, take interactive tours, see the latest promotional offers and a whole lot more at GoWinnebago.com.

## Comfort Sofa Sleeper

The sofa/sleeper you've always wanted is here. Never before has converting your sofa into a bed been so easy—or this comfortable.



1. By day, it's a plush sofa.



2. A hidden drawer stores bed linens.



3. At night, the sofa easily folds out into a bed.



4. The mattress quickly inflates and deflates using a built-in power source.

## Make it Yours

The galley makes quick work of meal preparation and cleanup with a three-burner range and a microwave/convection oven. A solid wood sink cover expands your countertop space and an available water filtration system delivers filtered cold water to the galley faucet.

The cab area also offers plenty of advanced features and custom options. It starts with the RV Radio®, which includes a CD player, weather band, remote and MP3 input. Add the Sirius® Plug-N-Play satellite radio system and receive a six-month complimentary subscription. The Plug-N-Play system includes a second docking port for your tow vehicle and an iPod interface connector that allows you to play and operate your iPod through the RV Radio.



**Full-Extension Slides** Drawers extend fully for easy access. It's part of the SmartSpace design philosophy that increases storage capacity and makes the most of the available space.



View 24K



**Touch Screen** An available new 6.5" touch screen incorporates the rearview monitor and controls the RV Radio. A handheld remote is also included.



**BenchMark** The BenchMark full comfort dinette, found on the 24K and 24J, offers innerspring cushions, hidden storage, and converts quickly into a comfortable bed.

# VIEW PROFILE

2010

24DL Timber Hill with Honey Cherry



## A New Kind of Motor Home

The View Profile raises the bar for Class C functionality with cab seats that turn to face the living area and other SmartSpace features designed to make you feel at home on the road. In fact, there is comfortable seating for up to six people for dinners, game night or just to watch TV. The large skylight provides an even more open atmosphere. The bedroom gives you another place to relax thanks to a slideout and a 19" LCD TV.

24DL Timber Hill with Honey Cherry



**Bedroom** The stylish View Profile bedroom features a slideout to create a spacious retreat with a walk-around queen-size bed.



**Sink** The sink is sized to accommodate large pots and pans. The faucet folds down allowing the sink cover to close, increasing your countertop space.

## See What's Cooking

RV galley design gets a fresh look in the View Profile. Using SmartSpace philosophy, the View Profile packs a full-featured kitchen, including a refrigerator/freezer, microwave oven and a two-burner range with hood, into a compact footprint that conserves space for the living area. Yet, you will find plenty of room to work thanks to flip-up covers for the sink and range. The attractive cabinetry even features curved elements to maximize storage.



View Profile 24DL

**Galley** Find everything you need to express your inner chef in this full-featured galley.

## Travel Ready

The View and View Profile boast several thoughtful conveniences that make your travels more enjoyable, such as electric entrance door steps, power locks, and power mirrors with defrost and integrated turn signals.

At the campsite you'll enjoy relaxing in the shade of the available awning. Liven up the party by choosing the available exterior speakers. They are connected to the coach stereo system, which you can control from your lawn chair via remote.

Personalize your View by selecting from standard graphics, available deluxe graphics or available full-body paint. The View Profile comes standard with full-body paint. Optional features include a rearview monitor system and an LP or diesel generator for plenty of A/C power on those hot summer days. Built-in cab window blinds come standard in the 24DL and are available in all other models.



**Hitch** The 5,000-lb. hitch<sup>5</sup> with 7-pin wiring is perfect for your tow vehicle.



**SMART STORAGE** An innovative exterior storage compartment on the 24J utilizes our Smart Storage™ design philosophy and expands to accommodate larger items.



**TRUEREVEL** TrueLevel™ uses sonar technology to measure tank levels without probes for accurate readings every time.



**Service Center** Color-coded labels and the QuickPort® service connection hatch (NA 24) or 24DL) make hookups a snap. The wash station makes cleanups easy and comes standard on the View Profile and is available on the View.



# Floorplans

Dimensions shown are for sleeping space only and may vary due to styling differences. Dashed lines denote overhead storage areas. Floorplans and specifications are also available online at [GoWinnebago.com](http://GoWinnebago.com).

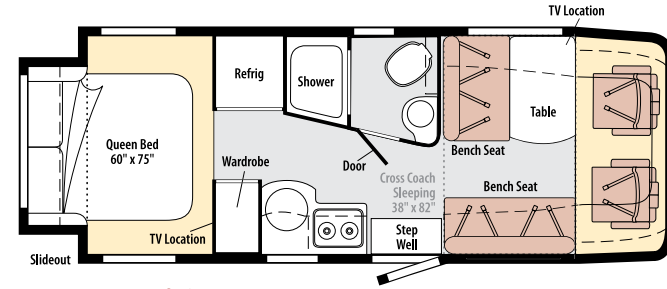

**View Profile 24DL**  
NEW

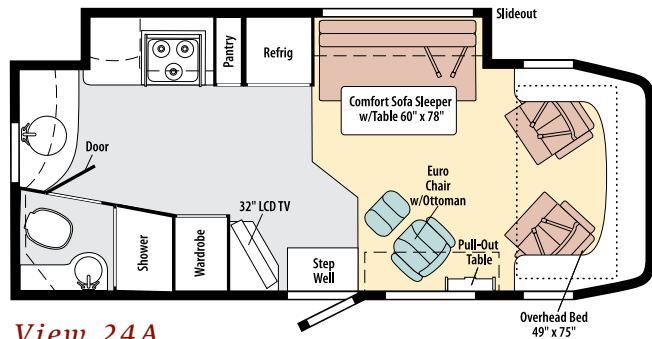

**View 24A**

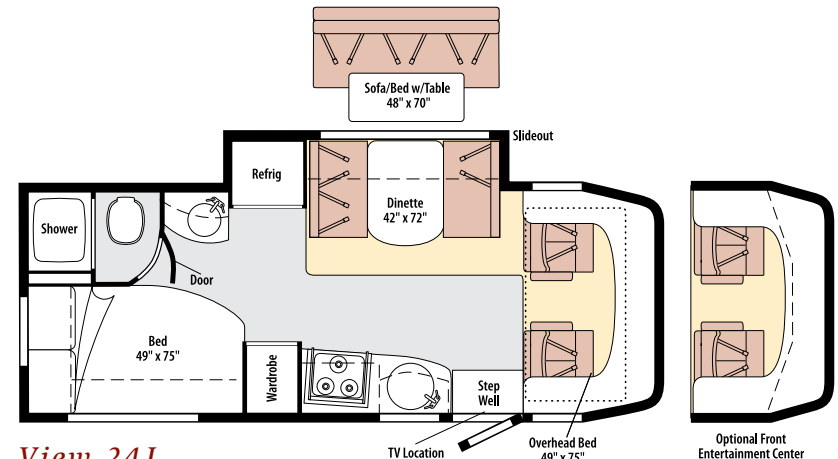

**View 24J**

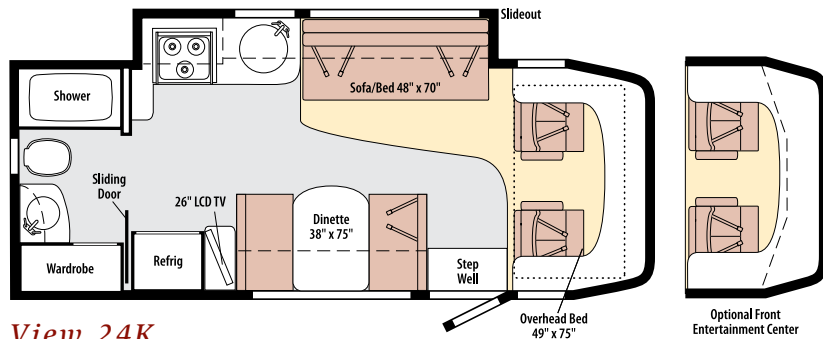

**View 24K**  
NEW

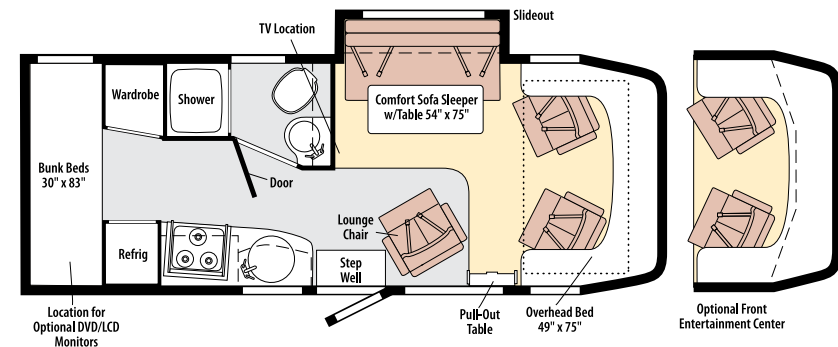

**View 24P**

# Specifications

Weights & Measures	View				View Profile
	24A	24K	24J	24P	24DL
Length	24'6"	24'6"	24'6"	24'6"	24'9"
Exterior Height <sup>1</sup>	10'11"	10'11"	10'11"	10'11"	10'7"
Exterior Width	7'6"	7'6"	7'6"	7'6"	7'6"
Exterior Storage <sup>2</sup> (cu. ft.)	26.6	33.3	36.3	30.8	19.8
Awning Length	15'	12'6"	10'	10'	12'
Interior Height	6'8"	6'8"	6'8"	6'8"	6'5"
Interior Width	7'3"	7'3"	7'3"	7'3"	7'3"
Freshwater Capacity w/Heater <sup>3</sup> (gal.)	37	35	35	39	35
Holding Tank Capacity - Black/Gray <sup>3</sup> (gal.)	33/27	33/27	31/38	28/27	32/32
LP Capacity <sup>4</sup> (gal.)	13	13	13	18	18
Fuel Capacity (gal.)	25.0	25.0	25.0	25.0	25.0
GCWR <sup>5</sup> (lbs.)	15,250	15,250	15,250	15,250	15,250
GVWR (lbs.)	11,030	11,030	11,030	11,030	11,030
GAWR - Front (lbs.)	4,410	4,410	4,410	4,410	4,410
GAWR - Rear (lbs.)	7,720	7,720	7,720	7,720	7,720
Wheelbase	170"	170"	170"	170"	170"



*View*



*View Profile*

## Dodge®/Mercedes-Benz® Sprinter Chassis

Mercedes-Benz 3.0L 6-cylinder, 154-hp turbo-diesel engine

Adaptive ESP® technology

5-speed automatic transmission w/tip shift

4-wheel ABS w/skid control

180-amp. alternator

Trailer Hitch<sup>5</sup>: 5,000-lb. drawbar/500-lb. maximum vertical tongue weight w/7-pin connector

Stainless steel wheel liners

24A	24K	24J	24P	24DL	<b>Optional Equipment</b> Stylized aluminum wheels
○	○	○	○	○	

## Cab Conveniences

**RV Radio<sup>®</sup>:** AM/FM stereo w/CD player, iPod/MP3 input, weather band and remote

**Cab Seats:** armrest, adjustable lumbar support, headrest and recline

Swivel/slide seat pedestal (24A, 24P & 24DL)

Slide seat pedestal (24K & 24J)

Power door locks w/remote

Power windows

Power mirrors w/defrost and turn signal indicators

Cruise control

Chassis/house battery radio power switch

Power steering w/tilt wheel

Sunvisors

Cab window blinds (24DL)

12-volt powerpoints

24A	24K	24J	24P	24DL	<b>Optional Equipment</b> Cab window blinds
○	○	○	○	○	
○	○	○	○	○	<b>Dash appliqué package</b>
○	○	○	○	○	<b>Sirius<sup>®</sup> Plug-N-Play satellite radio:</b> 6-month complimentary subscription, 2 docking ports and iPod interface connector
○	○	○	○	○	<b>Rearview monitor system w/one-way audio</b> (NA after July 2009 production)
○	○	○	○	○	<b>RV Radio/Rearview Monitor System:</b> 6.5" LCD touch screen color monitor, CD player, weather band, remote, iPod/ MP3 input, black and white rear camera w/one-way audio (available beginning w/August 2009 production)
○	○				<b>Swivel/slide seat pedestal</b>

## Interior

Front overhead bunk w/ladder and privacy curtain (NA 24DL)

Stereo System: AM/FM, alarm clock, CD/DVD player, input jack

19" LCD TV (24J, 24P & 24DL)

26" LCD TV (24K)

32" LCD TV (24A)

Satellite system ready

Monitor panel

Amplified digital TV antenna

Key-activated slideroom master lock switch

Cab divider curtain

**Skylight Roof Vent:** bar handle, sliding screen and shade (NA 24DL)

Skylight w/shade (24DL)

Powered roof vent (bath)

Powered ventilator fan (galley 24DL)

Day/night pleated shades (lounge, dinette and bedroom)

Mini blinds (galley and bath)

Tinted windows

24A	24K	24J	24P	24DL	<b>Optional Equipment</b> Entertainment center w/32" LCD TV w/remote and rope lighting (front overhead)
○	○	○	○	○	
○	○	○	○	○	<b>Roof vent w/powered ventilator fan (bath)</b>
			○		<b>RV digital satellite dish antenna w/elevation sensing unit</b>

## Galley

Laminate countertops

Microwave/convection oven (24J & 24P)

Microwave/convection oven w/range fan (24A & 24K)

Microwave oven (24DL)

3-burner range (NA 24DL)

2-burner range w/glass cover (24DL)

Vented range hood (24J, 24P & 24DL)

Norcold<sup>®</sup> refrigerator/freezer

Wood sink cover (NA 24DL)

Glass sink cover (24DL)

24A	24K	24J	24P	24DL	<b>Optional Equipment</b> Water filtration system (cold water)
○	○	○	○	○	

## Bath

Shower w/wall surround

Retractable self-cleaning shower door

Flexible showerhead

Skylight

## Bedroom

Angle-split mattress w/interior and exterior access to storage below (24J)

Mattress cover, pillows, pillow shams (24J)

Privacy curtain (24J, 24P & 24DL)

Bunk beds w/privacy curtains (24P)

19" LCD DC TV (24DL)

Memory foam mattress w/cover (24DL)

24A	24K	24J	24P	24DL	<b>Optional Equipment</b> 8.5" LCD monitor w/DVD player and headphone in each bunk
			○		

## Exterior

Automatic entrance door steps

Ladder (NA 24DL)

Porch light

Front and rear mud flaps

Premium high-gloss skin

Entrance door w/screen

24A	24K	24J	24P	24DL	<b>Optional Equipment</b> Electric patio awning
○	○	○	○	○	
○	○	○	○	○	<b>Electric patio awning w/metal wrap (full-body paint only)</b>
○	○	○	○	○	<b>Exterior speakers w/remote control extender</b>

## Heating and Cooling System

13,500 BTU roof-mounted air conditioner

25,000 BTU furnace (NA 24DL)

20,000 BTU furnace (24DL)

24A	24K	24J	24P	24DL	<b>Optional Equipment</b> A/C heat pump
○	○	○	○	○	

## Electrical System

**Service Center:** cable TV input, 30-amp. power cord, portable satellite dish hookup, QuickPort<sup>®</sup> (24A, 24K & 24P) service connection hatch

Auxiliary start circuit

Battery disconnect system (coach)

Automatic dual-battery charge control

LP generator prep kit

AC/DC load center, 45-amp. converter/charger

2 deep-cycle Group 24 RV batteries

24A	24K	24J	24P	24DL	<b>Optional Equipment</b> 3,200-watt Cummins Onan <sup>®</sup> diesel generator
○	○	○	○	○	
○	○	○	○	○	<b>3,600-watt Cummins Onan MicroQuiet<sup>™</sup> LP generator</b>
○	○	○	○	○	<b>Diesel generator prep kit</b>
○	○	○	○	○	<b>300-watt DC/AC inverter</b>

## Plumbing System

**Service Center** (NA 24DL): Colored labels, city water hookup/tank diverter fill, drainage valves

10' sewer hose

TrueLevel<sup>™</sup> holding-tank monitoring system

6-gallon LP water heater

LP Tank (24P & 24DL)

LP Tank w/remote fill w/power switches (24A, 24K, 24J)

**Winterization Package:** water heater bypass valve and siphon tube

On-demand water pump

**Exterior Wash Station:** pressurized city water hookup/tank diverter valve (24DL)

24A	24K	24J	24P	24DL	<b>Optional Equipment</b> Heated drainage system
○	○	○	○	○	
○	○	○	○	○	<b>Exterior wash station</b>
○	○	○	○	○	<b>6-gallon 120 VAC/LP water heater w/EMS</b>

## Safety

Dual airbags

Seat belts

LP, smoke and carbon monoxide detectors

10 BC fire extinguisher

Ground fault interrupter

Child seat tether anchor (24J & 24DL)

High-mount brake lamps

Daytime running lamps

Fog lamps

## Warranty<sup>6</sup>

12-month/15,000-mile basic warranty<sup>7</sup>

36-month/36,000-mile limited warranty on structure<sup>7</sup>

10-year limited parts-and-labor warranty on roof skin<sup>7</sup>

○ Optional

NA Not Available

- The height of each model is measured to the top of the tallest standard feature and is based on the curb weight of a typically equipped unit. The actual height of your vehicle may vary by several inches depending on chassis or equipment variations. Please contact your dealer for further information.
- The load capacity of your motor home is designated by weight, not by volume, so you cannot necessarily use all available space when loading your motor home.
- Capacities are based on measurements prior to tank installation. Slight capacity variations can result due to installation applications.
- Capacities shown are tank manufacturer's listed water capacity (W.C.). Actual filled LP capacity is 80% of listing due to overfilling prevention device on tank.
- Actual towing capacity is dependent upon your particular loading and towing circumstances, which includes the GVWR, GAWR and GCWR as well as adequate trailer brakes. Please refer to the Operator's Manual of your vehicle for further towing information.
- See separate chassis warranty.
- See your dealer for complete warranty information.

Not all items available in combination. See dealer for details.

Winnebago Industries<sup>®</sup> continuing program of product improvement makes specifications, equipment, model availability and prices subject to change without notice. Comparisons to other motor homes are based on the most recent information available at printing.

# Exteriors



**Garnet Metallic**  
STANDARD GRAPHICS



**Nutmeg Metallic**  
STANDARD GRAPHICS



**Charcoal**  
DELUXE GRAPHICS



**Sandstone**  
DELUXE GRAPHICS



**Autumnwood**  
FULL-BODY PAINT



**Opal**  
FULL-BODY PAINT



**Garnet Red**  
FULL-BODY PAINT



**Gold Platinum**  
FULL-BODY PAINT



**Vermillion**  
FULL-BODY PAINT



**Vintage**  
FULL-BODY PAINT



**Autumnwood**  
FULL-BODY PAINT



**Almond**  
FULL-BODY PAINT

VIEW

VIEW PROFILE

# Interior Décor

Choose from three fabric collections and two cabinet wood choices with hidden hinges.

MAIN

ULTRA-LEATHER

CARPET

ACCENT

BEDSPREAD

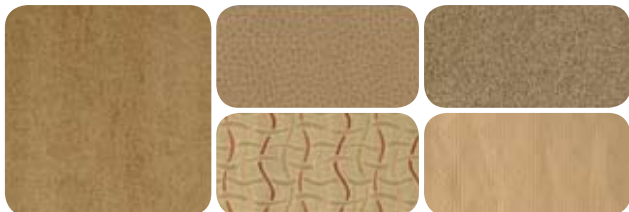

Beachcomber with available Briarwood UltraLeather™

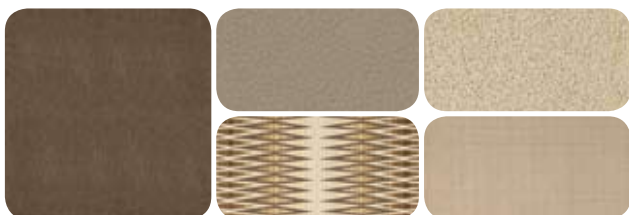

Edgecliff with available Putty UltraLeather

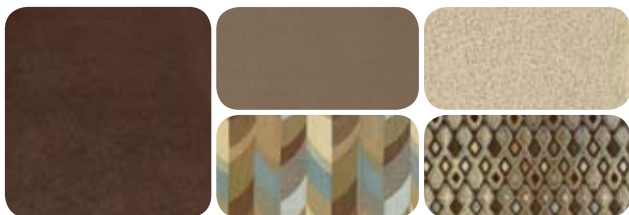

Timber Hill with available Bark UltraLeather



Honey Cherry



Belmont Maple



# Built by Winnebago Industries. Built to last.

Winnebago motor homes are built by Winnebago Industries, the company that defined motor homes. The company that built its reputation on quality construction. The company that transformed the motor home concept into a way of life.



Today, Winnebago Industries brings that reputation for quality and more than fifty years of RV innovation to the design and construction of every motor home. It's all a part of SuperStructure®, our exclusive system of proprietary structural components that instills in each motor home improved strength and durability.

**Solid Foundation** Steel and aluminum truss work provides a solid, flat foundation for the floor and sidewalls. Our engineers enhance the handling and stability by taking special care to properly distribute the weight of all components.



**Interlocking Joints** The floor, sidewalls and roof are all integrally connected using interlocking joints. This ensures the body is a cohesive unit with maximum strength and durability.

**Attention to Detail** Whether it's sending every View and View Profile through a high-pressure water tunnel to check for leaks or labeling individual wires and barcoding parts to save time and frustration during service, Winnebago Industries considers every detail to ensure your Winnebago motor home provides you with years of pleasure.

**Strong as Steel** Key appliances and cabinetry are secured to a metal substructure for added stability and safety.

**E-Coating** Winnebago Industries employs an automotive-style dip tank process to apply an advanced electro-deposition coating on critical steel components for corrosion protection.

**Thermo-Panel® Sidewalls** Invented by Winnebago Industries, Thermo-Panel construction combines a fiberglass panel, high-density block-foam insulation and aluminum support structures to create some of the most long-lasting, lightweight sidewalls in the industry.



Winnebago 1-year-old fiberglass roof



Competitor's 1-year-old rubber roof

**Fiberglass Roof** The View and View Profile feature a crowned, one-piece fiberglass roof, backed with a 10-year limited parts-and-labor roof skin warranty. Fiberglass offers superior strength, attractiveness and durability over the rubber roofs found on many competitive models which can chalk, streak and degrade over time. Fiberglass also provides increased puncture and tear resistance.



**GoWinnebago.com**  
Visit us on the web for more information on all of our motor homes, the latest product updates and a host of web-exclusive content.



**Take a Tour** We're proud of our process, state-of-the-art facilities and the people who make Winnebago Industries number one. We invite you to visit our complex in Forest City, Iowa, for a first-hand look at the dedication and technology behind every motor home we build.



**Recognized Quality** The Recreation Vehicle Dealer Association annually rates RV manufacturers and awards the Quality Circle Award to manufacturers that provide exceptional products, service and support. Winnebago Industries is proud to be the only manufacturer that has received this award every year since its inception.



**Committed to Service** We back our motor homes with the industry's best service after the sale:

- 12-month/15,000-mile basic limited warranty
- 36-month/36,000-mile warranty on structure
- 10-year standard limited parts-and-labor roof skin warranty
- Complimentary 24-hour roadside assistance program

- RV Technical Assistance Hotline
- RV Service Appointment Assistance
- Emergency Trip Interruption
- Emergency Message Service
- Nationwide Trip Routing
- Fee-Free Travelers Cheques



- TripSaver Fast Track Parts guarantees that in-stock warranty parts ship directly to your dealer within 24 hours
- National dealer service network



**WIT Club** Winnebago owners are like family. Joining the Winnebago-Itasca Travelers Club is a great way to meet and travel with other Winnebago enthusiasts. Members enjoy:

- Caravans and rallies
- Local and state group activities
- RV travel benefits

For Sales and Service Information Contact:



THE MOST RECOGNIZED  
NAME IN MOTOR HOMES™

NYSE listing: WGO

Printed in USA

Seat belts are your most important hookup. Always buckle up.  
© 2009 Winnebago Industries, Inc.