

2009 *Dorado* Dutchmen

BY FOUR WINDS INTERNATIONAL

KEY FEATURES *Fw*

- European curved cabinetry
- Optional high-definition satellite dish
- New slide-out battery tray (not available on Sprinters)
- LCD Televisions

- New black tank flush (not available on Sprinters)
- New 24SB Sprinter floorplan with Infiniss Leather sofa with air mattress hide-a-bed
- Back-up monitor now standard (24SA and 24SB only)
- New Full-Body paint schemes

FLOORPLANS *Fw*

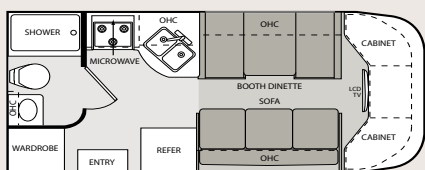

21BC

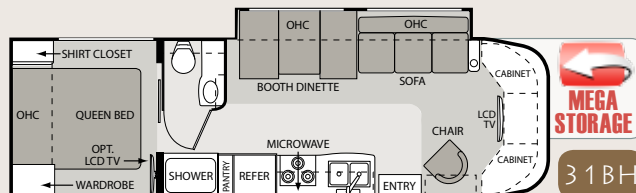

31BH

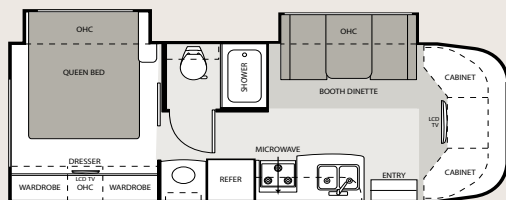

26BE

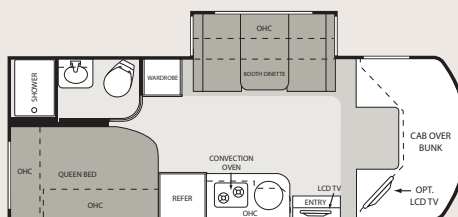

24SA

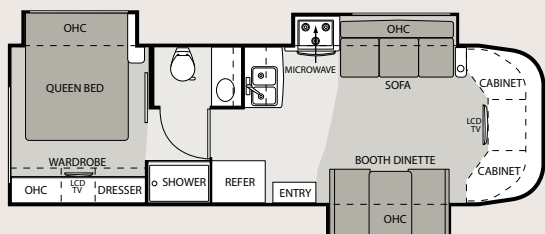

29BG

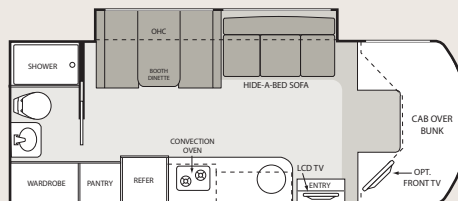

24SB

DORADO
SPRINTER

SPECIFICATIONS *Fw*

Model		21BC	26BE	29BG	31BH	24SA	24SB
WEIGHT RATING (LBS.)	Ford Chassis - Triton Engine	5.4L/V-8	6.8L/V-10	6.8L/V-10	6.8L/V-10	N/A	N/A
	Gross Vehicle (GVWR)	11,500	14,500	14,500	14,500	N/A	N/A
	Gross Combined (GCWR)	13,000	20,000	20,000	20,000	N/A	N/A
	Ford Chassis - Power Stroke Diesel Engine (opt)	N/A	6.0L/V-8	N/A	N/A	N/A	N/A
	Gross Vehicle (GVWR)	N/A	14,500	N/A	N/A	N/A	N/A
	Gross Combined (GCWR)	N/A	20,000	N/A	N/A	N/A	N/A
	Chevy Chassis - Vortec Engine	6.0L/V-8	6.0L/V-8	6.0L/V-8	6.0L/V-8	N/A	N/A
	Gross Vehicle (GVWR)	12,300	14,050	14,050	14,050	N/A	N/A
	Gross Combined (GCWR)	16,000	17,600	17,600	17,600	N/A	N/A
	Sprinter Chassis - Turbo Diesel Engine	N/A	N/A	N/A	N/A	3.0L/V-6	3.0L/V-6
	Gross Vehicle (GVWR)	N/A	N/A	N/A	N/A	11,030	11,030
	Gross Combined (GCWR)	N/A	N/A	N/A	N/A	14,530	14,530
MEASUREMENTS	Wheel Base (Ford/Chevy)	138"/139"	181"/182"	213"/214"	223"/224"	170"	170"
	Exterior Length (w/out ladder) (Ford/Chevy)	22'8"/23'7"	27'4"/28'3"	30'11"/31'10"	31'11"/32'10"	24'6"	24'10"
	Exterior Height (w/ AC)	10'7"	10'7"	10'7"	10'7"	10'10"	10'10"
	Exterior Width (without mirrors)	94"	94"	94"	94"	90"	90"
	Interior Height	80"	80"	80"	80"	80"	80"
	Awning Size	11'6"	18'	20'	16'	14'6"	14'6"
CAPACITIES	Fuel (gallons) (Ford/Chevy)	37/35	55/57	55/57	55/57	26.4	26.4
	LPG (pounds)	40.9	40.9	40.9	40.9	68.2	68.2
	Fresh Water (gallons)	39	33	33	40	40	42
	Waste Water (gallons)	26	25	25	22	38	34
	Gray Water (gallons)	26	33	23	22	34	38
	Water Heater (gallons)	6	6	6	6	6	6
	Furnace (BTUs)	25,000	25,000	25,000	25,000	25,000	25,000
	Exterior Storage Capacity (cubic feet) (Ford/Chevy)	4/4	16/12	24/24	96/96	56	40

2009 DUTCHMEN DORADO & SPRINTER STANDARD & OPTIONAL FEATURES

BODY CONSTRUCTION/ EXTERIOR	TC	SP
Fully welded tubular steel floor system	S	N/A
Fully welded tubular aluminum floor system with Tek-Modo floor decking	N/A	S
Curved sidewall design	S	N/A
Fully welded tubular aluminum roof and sidewall cage construction	S	S
Vacu-Bond laminated roof, walls and floors with high-density block foam insulation	S	S
Slick fiberglass exterior sidewalls	S	S
Exterior graphics package	S	S
Exterior graphics/partial paint packages	O	O
Full-body paint package with Gel-coat sidewalls	O	O
Premium one-piece TPO roof—Energy Star approved	S	S
Crown roof	S	S
One-piece fiberglass front and rear caps	S	S
Manual patio awning	S	S
Roof ladder	S	S
Exterior rear MEGA storage compartment (31BH only)	S	N/A
Seamless roto-cast storage compartments	S	S
Flush mount radius luggage doors	S	N/A
Side hinged slab luggage doors	N/A	S
Slide-out room awning	S	S
Automatic electric entrance step	O	S
Clear acrylic, entry grab handle	S	S
Outside Shower	O	S
AUTOMOTIVE/COCKPIT		
14,500 GVWR Ford 6.0L Power Stroke diesel engine with Torqshift transmission & Onan 3.6 LP generator (26BE only)	O	N/A
AM/FM dash radio with large buttons, CD player and weather band tuner; iPod and Sirius® satellite ready	S	S
Keyless entry (with convenience package option on 21BC, 26BE and 31BH only)	O	S
Power window and door locks	S	S
3-Point driver and passenger seat belts	S	S
Driver and passenger air bags	S	S
Upgrade dash insert with drink tray	O	N/A
Fiberglass running boards	S	S
Stainless steel wheel liners	S	S
Deluxe exterior mirrors	S	N/A

	TC	SP
Heated, remote exterior mirrors	O	S
Spare tire kit	O	S
3,500-lb. trailer hitch	N/A	S
5,000-lb. trailer hitch	S	N/A
Infiniss leather driver and passenger captain's chairs (black on Sprinter)	O	O
Power driver's seat (Ford chassis only)	O	N/A
Back-up monitor	O	S

INTERIOR		
80" interior ceiling height	S	S
Electric Euro-skylight	N/A	S
Residential linoleum (galley, bath and entry way)	S	S
Metal entry grab handle	S	S
Windshield privacy curtain	S	S
Cab-over bed ladder	N/A	S
13,500 BTU low-profile A/C in front	S	S
15,000 BTU low-profile A/C in front	O	N/A
Ceiling ducted A/C system	S	S
Fluorescent ceiling lighting	S	S
Directional reading lights	S	S
Cinnamon maple cabinetry	S	S
Honey Birdseye maple cabinetry	O	O
Cherry cabinetry	O	O
European style curved cabinetry with hidden hinges	S	S
Hardware with brushed nickel finish	S	S
Day/Night shades throughout	S	S
Soft touch vinyl ceiling	S	S
Booth dinette	S	S
Barrel chair (31BH only)	S	N/A
Leatherette Euro-recliner with ottoman (31BH only)	O	N/A
Fabric jackknife sofa (not available on 26BE)	S	N/A
Fabric/Infiniss Leather U-shape dinette IPO booth dinette (Sprinter 24SA only)	N/A	O
Infiniss leather U-shape dinette IPO booth dinette (Sprinter 24SA only)	N/A	O
Infiniss leather jackknife sofa (not available on 26BE)	O	N/A
Fabric hide-a-bed sofa (29BG only)	O	N/A
Infiniss leather hide-a-bed sofa with air mattress (31BH-with optional euro-recliner and ottoman, 29BG and Sprinters 24SB only)	O	S
Fabric jackknife sofa with pedestal table IPO booth dinette (not available on 21BC with Ford chassis)	O	N/A

	TC	SP
Infiniss leather jackknife sofa with pedestal table IPO booth dinette (not available on 21BC with Ford chassis)	O	N/A
Infiniss leather hide-a-bed sofa with air mattress and pedestal table IPO booth dinette (26BE and Sprinter 24SA only)	O	O
Fantastic fan	O	O

GALLEY		
Double door refrigerator with stainless steel door inserts	S	S
3-burner high-output cooktop with cover	S	N/A
European 2-burner high-output gas range top with glass cover	N/A	S
Stainless steel power range hood	S	S
Stainless steel convection microwave	S	S
Non-stainless steel convection oven (Canadian units only)	S	N/A
Laminate countertops	S	S
Solid surface countertop with sink covers	O	O
Flip-up countertop extension (not available on 21BC)	S	N/A
Large stainless steel single bowl sink with goose neck faucet	N/A	S
Large double bowl sink	S	N/A
Full extension drawer guides	S	S

ENTERTAINMENT & ACCESSORIES		
Front entertainment center with 32" LCD TV in cab-over	S	N/A
Front entertainment center with 26" LCD TV in cab-over with home theater system and DVD player	N/A	O
19" LCD TV over the door and coach stereo system with AM/FM, CD/DVD player and iPod ready	N/A	S
Portable 19" LCD TV in bedroom - can be removed and mounted to exterior hook-ups (not available on 21BC and Sprinter 24SB)	O	O
Home theater system with DVD player and radio tuner (with front entertainment center option on Sprinter units only)	O	O
Outside entertainment center with AM/FM stereo and CD player (not available on 21BC)	O	O
Outside entertainment center includes 26" LCD TV with AM/FM stereo, CD/DVD player with iPod ready jack and speakers (not available on 21BC and Sprinter 24SA)	O	O
TV antenna and booster	S	S
Cable TV prep	S	S
High-definition satellite	O	O
HD/DSS satellite prep	S	S

BEDROOM/BATHROOM	TC	SP
Queen-size innerspring mattress (not available on 21BC and Sprinter 24SB)	S	S
Bedsread and pillow shams (not available on 21BC and Sprinter 24SB)	S	S
Directional reading lights (not available on 21BC and Sprinter 24SB)	S	S
Power bath vent	S	S
China bowl toilet	S	S
Skylight in shower	S	S
Shower with curtain and curved curtain rod (21BC only)	S	N/A
Shower with pleated shower curtain (not available on 21BC)	S	N/A
Shower with glass door	O	S

SAFETY/CONVENIENCE		
Entry door with deadbolt lock	S	S
Telephone jack	S	S
System control center	S	S
Smoke, LPG, carbon monoxide detectors	S	S
Fire extinguisher	S	S
Slide-out battery tray	S	N/A
Convenience package: keyless entry and valve stem extenders	O	N/A

ELECTRICAL & PLUMBING		
Guardian RV Quietpac™ 40G generator (3600 watts) gas generator	O	N/A
Onan RV MicroQuiet™ 4.0 (4000 watts) gas generator	O	N/A
Onan 3.6 (3600 watts) LP generator (standard with Ford - Power Stroke diesel option on 26BE)	O	S
Onan 3.2 (3200 watts) Diesel generator	N/A	O
30 amp service with shore line power cord	S	S
Automatic shoreline-to-generator transfer switch	O	S
Battery disconnect switch	S	S
Emergency start switch	S	N/A
Auxiliary house battery	S	S
Second auxiliary house battery	O	N/A
6-gallon gas water heater	S	N/A
6-gallon gas/electric water heater	O	S
Black tank flush system	S	N/A
Water heater bypass system	S	S
Holding tanks with heat pads	O	O

TC=FOUR WINDS SIESTA SP=SIESTA SPRINTER



VEHICLE LOADING: Every effort has been made to provide the greatest number of options for the recreation vehicle owner. Along with these choices comes the responsibility to manage the loads that are imposed by the choices so that they remain within the manufacturer's specified chassis weight limits. Do not overload the recreation vehicle.

IMPORTANT: Towing capacity may vary by chassis model, floorplan, options and loading of the vehicle. This may result in a towing capacity which is less than the maximum capacity of the hitch. Do not exceed the vehicle's Gross

Combined Weight Rating (GCWR), or the hitch rating. A separate functioning brake system is required for any towed vehicle or trailer weighing more than 1,000 lbs. (450 KG) when fully loaded. Liquid capacities and weights are approximations only.

WARNING: This information is intended as a guide only. Weights of individual vehicles may vary. Consult your owner's manual and weight sticker affixed to each vehicle for complete loading, weighing, and towing instructions. Actual filled LP capacity is 80% of listing due to safety shut-off required on tank.

WARRANTY: This vehicle is provided with a one-year, 15,000-mile limited warranty and a three-year, 45,000-mile limited structural warranty. Chassis, component part and appliance manufacturers issue limited warranties covering those portions of the vehicle not covered by the limited warranties issued by Four Winds International. To learn what portions of the vehicle are excluded from coverage under the limited warranties issued by Four Winds International, please contact your selling dealership or Four Winds International directly, or review the warranty packet inside the vehicle.

Product information, specifications, and photography in this brochure were as accurate as possible at time of printing. Photographs may contain some features that are optional on your vehicle. Since we continually strive to improve our products, actual products may differ. The manufacturer reserves the right, at any time, to make changes in product design, materials, component specifications and pricing, without notice. All capacities are approximate and dimensions are nominal. Some features or options may be different or unavailable in Canada.