

FREEDOM EXPRESS &
FREEDOM EXPRESS 
by Coachmen



*A*lways dedicated to our customer's ultimate satisfaction, Coachmen is proud to introduce the new Freedom Express and Freedom Express LTZ Ultra-Lite Laminated Series travel trailers. Through state-of-the-art construction using extremely durable, yet lightweight materials, the Freedom Express can be easily towed by today's lighter duty vehicles. Add in our wide selection of family friendly floor plans and easy-to-use features, and you'll soon experience how every trip can become fun and relaxing with the Freedom Express.



Freedom Express LTZ 245RKS



There's no place like home, so why not take it with you into the great outdoors. From the tastefully decorated interior using easy-to-clean fabrics to the hardwood cabinets and no-slip floors, durable enough to withstand the rigors of family camping, the Freedom Express is designed for maximum livability without breaking the bank.

FULL BATHROOM

Attention to detail offers residential amenities such as a generous tub with surround and shelves, vanity with mirrored medicine cabinet and storage, foot-flush toilet and a skylight* to brighten the room. An exhaust fan and vent is also provided for maximum comfort.

SPACIOUS MASTER SUITE

Experience all the comforts of home with a TV that swivels for viewing in master suite or living room*, walk-around queen bed with storage and a nightstand area with outlets and reading lights. Residential-style doors for privacy are available in some models.

FUNCTIONAL FLOOR PLANS

Several options offer practical solutions for any size family or needs, including double bunks or a single bunk with a double bed. Each featuring under bed storage. Plus, the large dinette and sofa convert into additional sleeping space.

* Select Models

FREEDOM EXPRESS FEATURES

FREEDOM EXPRESS FEATURES

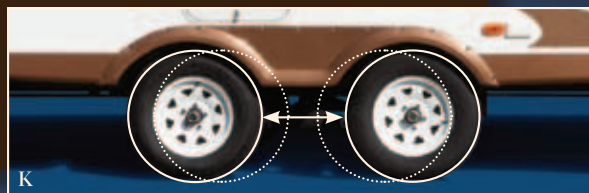
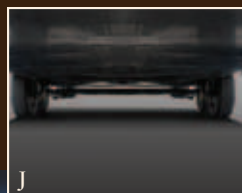
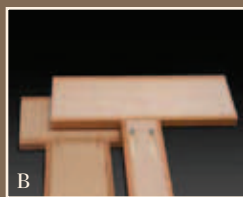

- A. Super Lube® hubs simplify routine bearing lubrication.
- B. Screwed cabinet fronts provide superior strength, Lumber Core construction insures cabinet integrity.
- C. Coleman® outdoor grill station – designed for outdoor use, can be used in its slide-out tray, or set on a nearby picnic table.*
- D. Beauflor® – Resilient flooring technology provides durable, stain resistant, no-slip floor covering.
- E. Beach, pet and kid clean up made simple and convenient with an outdoor wash station.*
- F. Pass-through storage provides 40 cubic feet of additional easy to access exterior storage.
- G. Convenient silverware drawer under the kitchen sink.
- H. Practical kitchen work area features 40/60 sink, hi-rise faucet, thermo-sealed countertops with ample prep space.
- I. Front entertainment tower boasts Jensen® brand electronics, 180° swivel, 12V DC, 19" LCD TV and hard slider doors for maximum privacy. (select models)
- J. Heated, fully enclosed underbelly extends camping season, protects plumbing and electrical systems and improves towing aerodynamics.
- K. Stable Ryd® spread axle design distributes weight over a 27% wider area, reducing tongue weight and improving handling and suspension characteristics.

- 1. Aerodynamic front profile – improves handling and fuel efficiency.
- 2. 24" Diamond plate road shield – protects fiberglass front from stones and road debris.
- 3. Super Lube® axle hubs – eliminates hub disassembly to repack bearings.
- 4. Stable-Ryd® spread axle design – provides optimum weight distribution and suspension damping for improved towing quality.**
- 5. Powder E-coated, welded I-beam frame – provides protection from the elements, precambered I-beam design minimizes stress to sidewalls.
- 6. Trussed cross members placed at 48" o.c. – minimizes weight while maximizing lateral strength.
- 7. Nova fully enclosed, heated underbelly adds protection, improves towing aerodynamics and extends camping season.**
- 8. Fully welded tubular aluminum floor frame – lightweight and rigid.

- 9. Full vacuum bond laminated floor structure - assuring strength, superior insulation, lightweight and a level surface.
- 10. Beauflor® - advanced resilient floor coverings with 7-year warranty, proven in cold temperatures, ideal for high traffic areas.
- 11. Aluminum-framed, vacuum-bonded sidewalls combine proven technology and materials to provide a dependable, lightweight shell.
- 12. Smooth exterior fiberglass skin, combines beauty with durability.
- 13. Breathable, fade resistant graphics and die-cuts eliminate the shrinking and bubbling often associated with exterior designs.
- 14. Tinted, safety glass windows reflect 45% of the suns rays, keeping the interior cool and comfortable.
- 15. Happijac SureTrac™ rack and pinion slide systems – simpler and more reliable than cable systems, without the adjustment issues.

- 16. Pass-through storage – easy access and large volume.
- 17. Crowned aluminum reinforced roof – combines lightweight with increased strength.
- 18. EDPM rubber roofing with a 12-year manufacturers warranty for peace of mind.



* Optional on LTZ ** Not available on LTZ

FREEDOM EXPRESS FEATURES

OPTIONS

Interior Package (IP)
Exterior Package (EP)
Power Package (PP)
Stow-N-Go™ door (select bunk models)
Entertainment tower (290BHS)

LIVING APPOINTMENTS

Mortise and tenon hardwood cabinet doors in Brazilian cherry with chocolate accents and arched overheads (IP)
Pocket-screwed cabinet construction
Oil-rubbed bronze hardware and hi-rise faucet
Seamless, sealed-edge designer countertops
Designer window treatments with upgraded pleated shades
BeauFlor® premium no-slip flooring
Large booth dinette
Jackknife sofa

GALLEY

Double-door refrigerator
Extra-deep 60/40 Stone-Cast® sink
Oil-rubbed bronze hardware and hi-rise faucet
Maximum counter space (galley slide models)
3-burner, high-output range with oven
Microwave with carousel
Range hood with 12V exhaust and light
Oversized dual-purpose pantry
Silverware drawer with removable tray
Exterior 10,000 BTU Coleman® deluxe slide-out grilling station

SLEEPING APPOINTMENTS

Evergreen® Sleep System mattress set
Queen bed with decorative headboard and designer bedspread in master suite
Mirrored closets and over-bed cabinets with integrated reading lights
Convenient nightstand areas with 110V outlets
Under bed storage front and rear*
Jackknife sofa, convertible dinette set
Various bunkhouse models
19" TV rotates 180° for bedroom viewing*
Wood privacy doors at master suite*

INTERIOR FEATURES

High-grade, designer-inspired interior fabrics
13.5 BTU ducted A/C
Ducted forced air furnace (IP)
6-gallon gas/electric DSI hot water heater
Winterization kit
Cable TV hookup (IP)
12V 19" LCD flat panel TV (IP)
AM/FM/CD player (IP)
12V AM/FM/CD/DVD stereo with auxiliary input (PP)
Four interior speakers, and two outside marine speakers
Medicine cabinet with bathroom mirror
Tub surround with built-in shelves and shower curtain
Foot-flush toilet
Skylight over tub
Exhaust vent with fan

ELECTRICAL

55 amp converter
30 amp power cord
Optic lense lighting package
GFI interior and exterior outlets
Color-coded wire harnesses

SAFETY AND SECURITY

LP leak alarm
Fire extinguisher
Smoke and CO detector
Tinted safety glass windows
Multiple egress windows
Entry door with deadbolt
Heavy-duty safety chains
4-wheel electric brakes
Breakaway switch
Spare tire with frame-mounted carrier
Manual slide room override
GFI outlets

EXTERIOR AND CONSTRUCTION

Frame engineered through FEA process
Integra-Lite™ chassis/floor design
Floor plan specific cambered design

Powder E-coated steel I-beam frame
Welded aluminum-framed, vacuum-bonded floor
Alumicage™ sidewall framing
Laminated vacuum-bonded sidewalls
Smooth fiberglass exterior skin
HappiJac Double Hat Rail™ rack and pinion 12V slide system

Crowned aluminum reinforced roof with seamless EDPM rubber membrane
Rain gutters with spouts
Enclosed heated underbelly
Tapered aluminum bottom skirting
High-gloss aerodynamic fender skirts
Stable Ryd® spread axle design
Super Lube® axle bearings
Low profile, under-slung axle design
Load range C radial tires
Patio awning (EP)
Deluxe power awning (PP)
Insulated, lockable-radius doors with hold backs
Insulated radius entrance door with screen door

Amber patio entrance light
Double entry step
Rigid polystyrene insulation
Openings treated with anti-wicking compound
Diamond-plated front stone guard
Four scissor-style stabilizer jacks (EP)
Four power stabilizer jacks (PP)
Heavy-duty front jack
Two 20 lb. propane bottles with cover
Dual battery rack over A-frame
Ample exterior compartments with pass-through storage
Exterior shower with hot and cold water
Deluxe swing-out exterior grab handle
Hi-capacity, roto-cast holding and fresh water tanks
TV antenna with amplifier
Front-lighted power jack (PP)
Bottle cover with easy valve access
Outdoor wash station (EP)
Deluxe swing-away grab handle

* Select Models



FREE ROADSIDE ASSISTANCE

Coachmen provides one year of free Travel Easy™ emergency roadside assistance for those who buy a new Coachmen RV. Administered by Coach-Net®, this service gives Coachmen owners 24/7 access to operational, technical and emergency road services, including towing, fuel delivery, jump starts, lockout service, tire changes, mobile mechanic and unlimited technical advice. So no matter where you go, we're ready to help!



BIG BENEFITS FOR NEW OWNERS

Owners club discounts and more — A free one-year membership in the Coachmen Owners Association comes with the purchase of any Coachmen product. This add-on value not only provides a host of travel services and campground discounts, but also a 24/7 online service that locates needed services while offering member savings at more than 180,000 merchants across the country. And, of course, the COA is an excellent way to share experiences with other Coachmen owners through rallies and caravans.

FOREST RIVER ENCOURAGES YOU TO BUY LOCALLY FROM YOUR HOMETOWN DEALER

Our dealers are as a rule, independently owned and operated businesses. Outside of those customers they personally sold products to, they are not contractually obligated to perform warranty service on Forest River products that were purchased elsewhere. There may be an occasion that you would be required to return to the point of purchase to satisfy warranty requirements.

Although many dealerships will eventually service products not purchased at their place of business, they will usually take care of their customers and other Forest River customers who are traveling away from their local dealer as they would their own.

Local purchases allow a customer to establish a relationship with a dealer close to home. This relationship provides the customer with a convenient location for service and support from a hometown professional.

The opportunity for a thorough PDI (Pre-delivery Inspection) and product orientation is an additional benefit of buying from your local dealer. Further providing the opportunity for refresher courses or the ability to get questions answered much more conveniently.

For our Canadian customers, there are also requirements which must be met to bring an RV purchased out of the country to their home. Although not insurmountable, these requirements may involve such things as additional inspections and certifications, taxes and fees. Your local Canadian dealer is a professional at meeting these requirements.

Forest River's goal is for all RV owners to fully enjoy their RV experience. In light of this goal, and considering the advantages of buying local, we encourage you to be thorough when determining what product to purchase and which dealer to purchase it from as both are key to your ultimate satisfaction and the realization of your dreams.



FOREST RIVER'S HALLMARK OF EXCELLENCE: PRE-DELIVERY INSPECTION FACILITIES

That's 20,000 square feet of quality assurance. The bare essentials for a premium product. Brought online in 2005, Forest River is proud of its state-of-the-art test facility. This beautiful building blends many of the old tried and true methods of testing our diverse types of RVs with new innovative ways of solving quality issues. Being centrally located to most Forest River manufacturing facilities, this 20,000 square foot PDI (Pre-delivery Inspection) test building gives immediate daily feedback to individual managers. This assures the production facilities that nothing has slipped by the plant's quality assurance personnel and the units are "green" and ready to ship.

FREEDOM EXPRESS FLOOR PLANS & SPECIFICATIONS

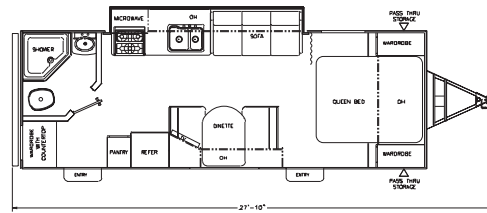

242RBS

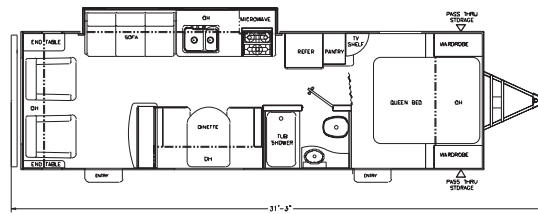

280RLS

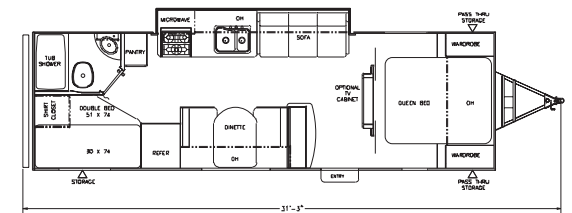

290BHS

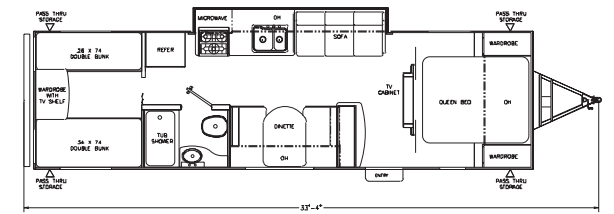

291QBS

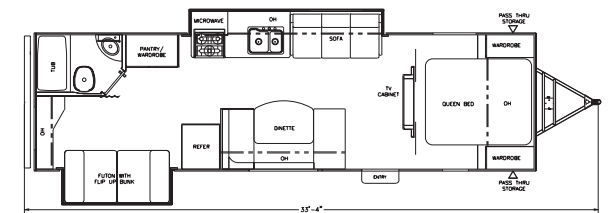

300BHS

SPECIFICATIONS	242RBS	280RLS	290BHS	291QBS	300BHS
UNLOADED WEIGHT	4713	5136	4947	5333	5781
HITCH WEIGHT	442	773	518	756	614
CARRYING CAPACITY	2229	2637	2571	2081	1219
EXTERIOR LENGTH	27'9"	31'3"	31'3"	33'3"	33'3"
EXTERIOR HEIGHT	10'3"	10'3"	10'3"	10'3"	10'4"
FRESH WATER GAL.	36	36	36	36	36
GREY WATER GAL.	34	34	34	34	34
WASTE WATER GAL.	32	32	32	32	32
LPG CAPACITY LBS.	40	40	40	40	40

FREEDOM EXPRESS

FLOOR PLANS, SPECIFICATIONS & FEATURES

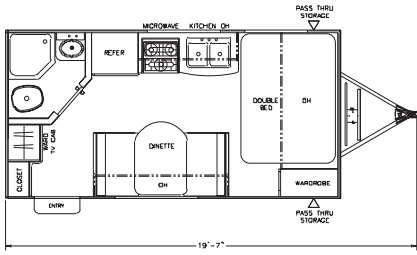

170RB

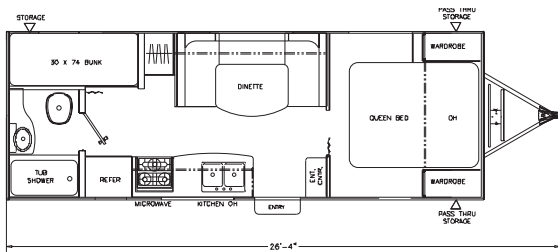

230BH

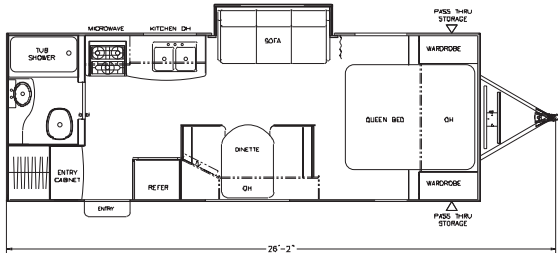

232RBS

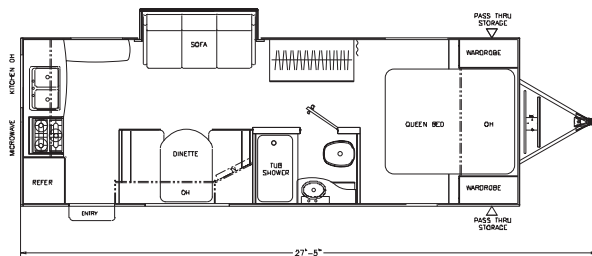

245RKS

INTERIOR AND DÉCOR

- Brazilian cherry woodgrain
- Sealed-edge countertops
- BeauFlor® rolled goods flooring (Venezia) (V)
- Soft valances throughout
- Mini-blinds throughout
- Pedestal dinette table
- 36" or 43" booth dinette
- Jackknife sofa
- Hardwood mortise & tenon cabinet door frames (V)
- Stile and rail cabinet front construction
- LP leak alarm
- Fire extinguisher
- Smoke alarm
- Carbon monoxide detector

GALLEY

- Microwave (V)
- 3-burner cooktop (V)
- Large single-door refrigerator (V)
- Power/lighted range hood (V)
- Black appliances
- Monitor panel (V)
- Oil-rubbed bronze hardware
- Silverware drawer under sink

SLEEPING

- Color coordinated comforter
- Decorative headboard (some models)
- Evergreen® sleep mattress

ELECTRICAL/HEATING/AC

- Furnace – forced air electric
- 55 amp power center
- Outside receptacle GFI
- Patio light
- Optic lense lighting package

BATH AND WATER

- Power bath vent
- 6 gallon gas/DSI hot water heater
- Water heater by-pass valve
- Demand water pump
- Decorative bath hardware
- Medicine cabinet
- Below floor low point drains
- Foot-flush toilet (V)
- Designer tub surround (V)

EXTERIOR/CONSTRUCTION

- 13.5 roof AC (V)
- Spare tire kit w/ spare tire (V)
- 4 stabilizer jacks (V)
- Double 20# LP tanks (V)
- Rubber roof
- Insulation - R11
- Laminated vacuum-bonded DS & ODS sidewalls w/aluminum framing insulation R7
- Gutter rail
- Deadbolt lock
- Tinted safety glass radius windows (V)
- Radius entrance door
- Radius baggage doors
- I-beam chassis construction
- Corrosion resistant powder E-coated frame
- Breakaway switch
- Electric r&p slide room (232, 245)
- Pass-through storage
- Single entry step
- Front diamond plate (V)
- Super Lube® axles (V)

OPTIONAL FEATURES

- Copper Verde décor
- Cocoa décor

CONVENIENCE PACKAGE

- Double-door refrigerator
- 6 gallon gas/electric/DSI hot water heater
- 3-burner range with oven
- Outside shower

ENTERTAINMENT PACKAGE

- AM/FM/CD player
- 2 outside speakers
- Cable jack at TV area
- TV antenna with booster

- Deluxe manual awning
- Outside sliding Coleman® grill
- Digital LCD TV
- Canadian compliance (Includes CSA, MEP fee. Required on models shipped to Canada)

(V) Value Package

SPECIFICATIONS	170RB	230BH	232RBS	245RKS
UNLOADED WEIGHT	2977	3795	3847	4052
HITCH WEIGHT	297	404	363	472
CARRYING CAPACITY	2423	2705	2790	2920
EXTERIOR LENGTH	19'7"	26'4"	26'2"	27'5"
EXTERIOR HEIGHT	10'2"	10'3"	10'3"	10'3"
FRESH WATER GAL.	36	36	36	36
GREY WATER GAL.	30	30	30	30
WASTE WATER GAL.	30	30	30	30
LPG CAPACITY LBS.	40	40	40	40

*A*fter 45 years as a leader in the RV industry,
Coachmen remains committed to manufacturing
quality, value-priced products that are consumer driven.
And with our recent acquisition by Forest River, America's largest
producer of towable RVs and a division of Berkshire Hathaway, when
you buy the Freedom Express you can be confident of your decision
for years to come.



Your local Freedom Express dealer:



Coachmen, P.O. Box 30, Middlebury, IN 46550
800.353.7383 www.coachmenrv.com

All specifications contained herein are based on the latest product information at time of printing. Coachmen reserves the right to make changes in colors, materials, equipment and specifications at any time without notice and assumes no responsibility for any errors in this brochure.