



Spruce

Lightweight Travel Trailers
and Fifth Wheels

For more product details and in-depth information, visit us on the web at www.kz-rv.com



318BHS



The Spree Travel Trailer is affordable, nicely equipped and built to take practically anything your kids can dish out.



Spree



**NEW
feature**

Standard **pull-out
trundle bed** adds even
more sleep space in the
318BHS bunkhouse floor-
plan. The kids will love it!



301FK



Travel Trailers

	210KS	240BHS	245KS	260FL	260RBS	261RKS	280RLS	289KS	301FK	310RLS	318BHS	323RLS	324BHS
UVW (Unloaded Vehicle Wt.)	4160	4650	4700	5400	5040	4960	5210	5370	5500	5750	5830	5580	5610
Dry Hitch Wt.	490	480	530	870	500	440	620	460	1140	540	640	650	610
Dry Axle Wt.	3670	4170	4170	4530	4540	4520	4590	4910	4360	5210	5190	4930	5000
NCC (Net Carrier Capacity)	1340	1850	1800	1400	1760	1840	1790	1630	1500	1550	1470	1420	1690
GVWR	5500	6500	6500	6800	6800	6800	7000	7000	7000	7300	7300	7000	7300
Interior Height	78"	78"	78"	78"	78"	78"	78"	78"	78"	78"	78"	78"	78"
Exterior Height	10'3"	10'3"	10'3"	10'9"	10'9"	10'9"	10'9"	10'3"	10'3"	10'9"	10'9"	10'9"	10'9"
Exterior Width	96"	96"	96"	96"	96"	96"	96"	96"	96"	96"	96"	96"	96"
Exterior Length	23'4"	28'3"	26'2"	28'10"	28'8"	28'9"	29'9"	30'6"	32'3"	33'2"	32'9"	32'5"	33'7"
Refrigerator (cu. feet)	6	6	6	6	6	6	6	6	6	6	6	6	6
Water Heater Cap. (gal. G/E w/DSI)	6	6	6	6	6	6	6	6	6	6	6	6	6
Fresh Water Cap. (gal.)	40	40	40	40	40	40	40	40	40	40	40	40	40
Waste Water Cap. (gal.)	32	32	32	32	32	32	32	32	32	32	32	32	32
Gray Water Cap. (gal.)	32	32	32	32	32	60	32	32	60	32	60	32	32
LP Gas Cap. (lbs.)	60	60	60	60	60	60	60	60	60	60	60	60	60
Furnace BTUs (1,000's)	20	20	20	20	20	20	25	25	30	30	30	30	30
Tire Size	15"	15"	15"	15"	15"	15"	15"	15"	15"	15"	15"	15"	15"
Awning	14'	16'	14'	13'	16'	15'	15'	15'	15'	13'	14'	16'	17'

Standard Features

- 13,500 Ducted BTU A/C
- Awning
- Microwave w/Turn Table
- 6 Cu. Double Door Refer
- Straight Axles
- Skylight Over Tub
- Tub Surround
- Porch Light on ODS
- Hitch Light
- Cable Hook-Up
- Oven
- Night Shades
- Black Glass Refer Front
- AM/FM CD Player
- Exterior Speakers
- 6 Gallon Gas/Electric DSI Water Heater
- 15" Radial Tires
- Sink Cover
- Exterior Shower
- Stabilizer Jacks (4xTT's & 2xFW's)
- Black Tank Flush System
- Tinted/Safety Windows
- Trash Bin
- Power Jacks on FW's
- Enclosed Pin Box on FW's

LX Package

- (All Standard Features)
- Aluminum Wheels
- Fiberglass Front Cap on TT only
- Assist Grab Handle
- Raised Panel Refer Door
- Foot Flush Flush Toilet
- LCD Flat Screen TV
- Posturest Mattress

Additional Options

- Countertop Extension (n/a on 210KS)
- Comfort Fan
- Outside Grill (n/a on 265RL)
- 15" LCD TV
- 26" LCD TV
- Side Ramp Door (289KS Only)
- Ramp Door Extension (289KS Only)
- Pull Down Screen Wall (289KS Only)
- Spare Tire, Carrier & Cover
- Air Bed Hide-A-Bed (260RBS, 280RLS, 301FK, 310RLS, 318BHS, 323RLS & 324BHS)
- Satellite Preparation
- Table and Four Chairs with Leaf (N/A on 210KS, 240BHS, 245KS, 260FL, 261RKS & 289KS)
- 15,000 BTU A/C
- Power Awning
- Jiffy Sofa with Flip Up Bunk (318BHS)
- Equa-Flex Suspension
- RVIA Seal
- State Seal (WA, OR or NE)
- Canadian Standards/CRVA



A Great Option – You can take your big toys along!

Shown with optional bedroom door ramp

The wide side-entry door ramp with extension makes loading and unloading a breeze.



The bed easily stows out of the way with gas assist lift arms.

Comfort and convenience are designed into this convertible sleep space/cargo bay. The bed is flanked by matching mirrored wardrobes with cargo-netted storage compartments above.



**Total
Aluminum
Frame**

Fifth Wheels

265RLS	305BHS
6310	7340
910	1230
5400	6110
1190	1460
7500	8800
91"	91"
11'9"	11'9"
96"	96"
28'2"	33'10"
6	6
6	6
40	40
32	32
32	32
60	60
25	30
15"	15"
12'	18'

PLEASE NOTE:
For your safety and satisfaction, each unit is weighed during final inspection. Chart reflects coaches as typically equipped. The options selected will affect the weight and carrying capacity.

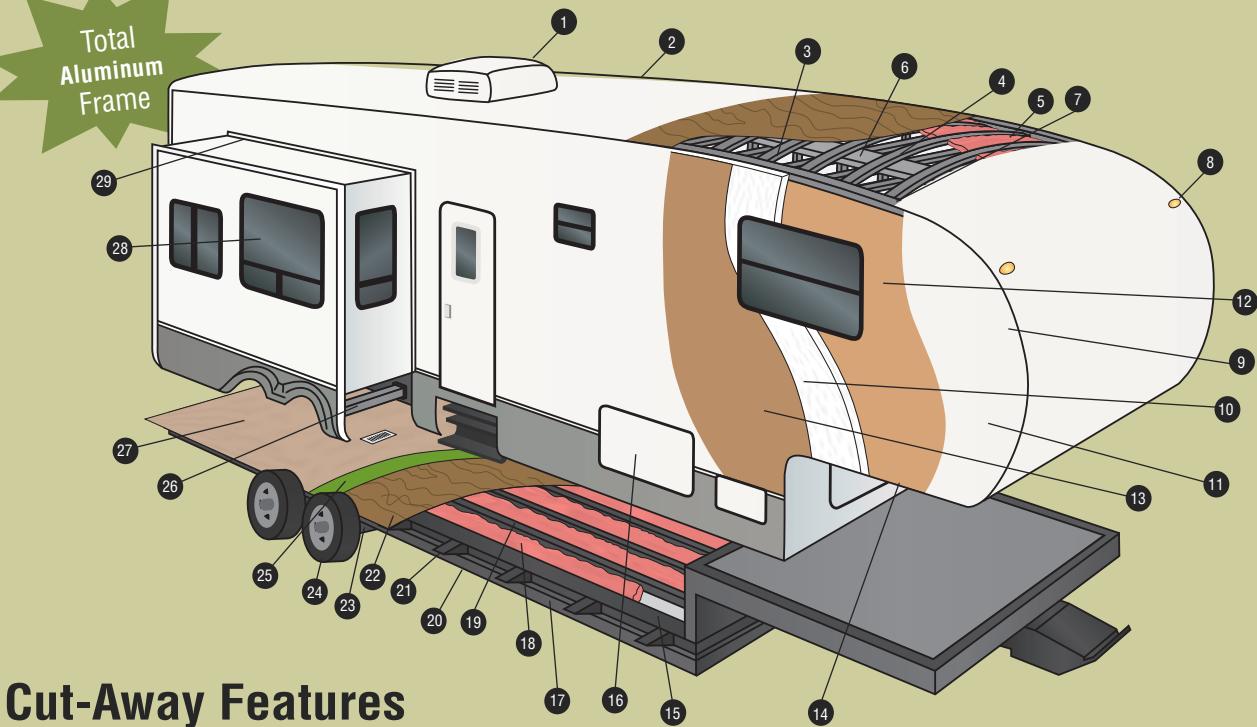

Cut-Away Features

- 1 13,500 BTU A/C
- 2 TPO Vinyl Roof
- 3 Vinyl Interior Ceiling Panel
- 4 4 1/2" Aluminum Truss Rafters, 16" O.C.
- 5 R-7 Batten Insulation
- 6 Insulated Ductwork
- 7 Heavy Duty Aluminum Headers
- 8 Exterior Clearance and Brake Lights
- 9 Aluminum Frame Front and End Walls
- 10 Expanded Polystyrene - R7
- 11 Fiberglass Exterior with Integrated Luan Backing
- 12 1/8" Luan Decorative Wall Board
- 13 1/8" Luan
- 14 3" Aluminum Stringer
- 15 Darco® Moisture Barrier
- 16 Large Capacity Pass-Thru Exterior Storage with Radius Doors Front and Side for Easy Access
- 17 Heavy Duty I-beam Frame Construction
- 18 R-7 Batten Insulation
- 19 2x2 Double Welded Aluminum Floor Joists, 16" O.C.
- 20 Heated & Enclosed Underbelly
- 21 Fully Welded Outriggers
- 22 Plywood Floor
- 23 Heavy Duty Leaf Springs
- 24 Heavy Duty Steel Wheels
- 25 Residential Style Carpet Pad
- 26 Rack and Pinion Electric Slide with Manual Override with Box Tube Slide Out Ram
- 27 Residential Carpet or Linoleum
- 28 Tinted Safety Glass Windows
- 29 Triple Sealed Slide Outs

Wall Cut-Away

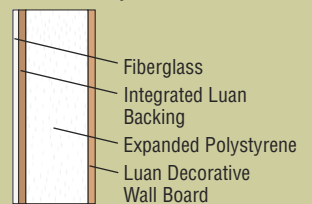

Four Distinctive Interior Selections

Adobe Décor



Earth Décor



Jade Décor



Passion Décor



Common Interior Décor Package



Cabinet Door



2-Tone Wood



Wall Panels



Countertops



Flooring



Carpet

Spree Travel Trailer Floorplans

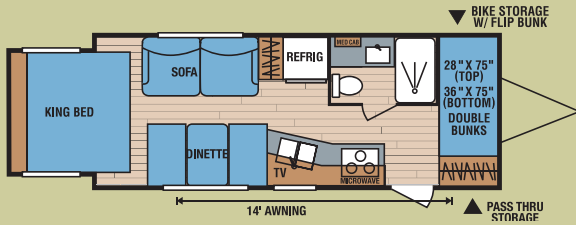

210KS • UVW 4160 • Dry Hitch Wt. 490 • NCC 1340 • Length 23'4"

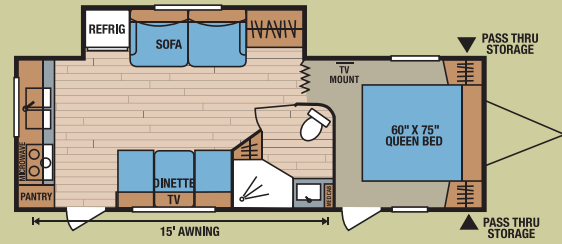

261RKS • UVW 4960 • Dry Hitch Wt. 440 • NCC 1840 • Length 28'9"

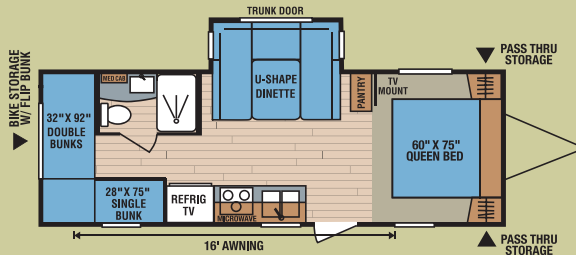

• see fold-up bed/flip-up sofa option

240BHS • UVW 4650 • Dry Hitch Wt. 480 • NCC 1850 • Length 28'3"

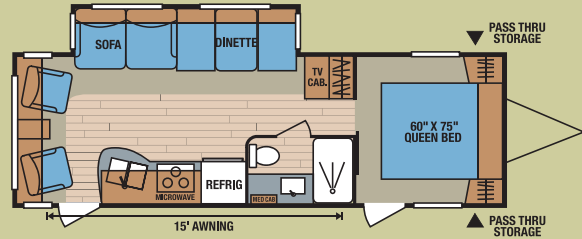

280RLS • UVW 5210 • Dry Hitch Wt. 620 • NCC 1790 • Length 29'9"

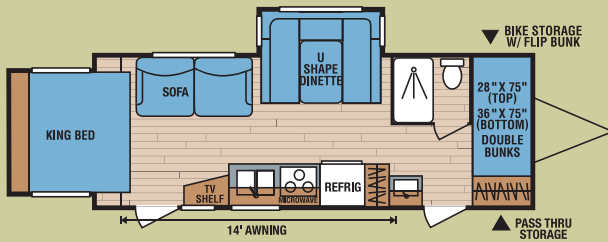

245KS • UVW 4700 • Dry Hitch Wt. 530 • NCC 1800 • Length 26'2"

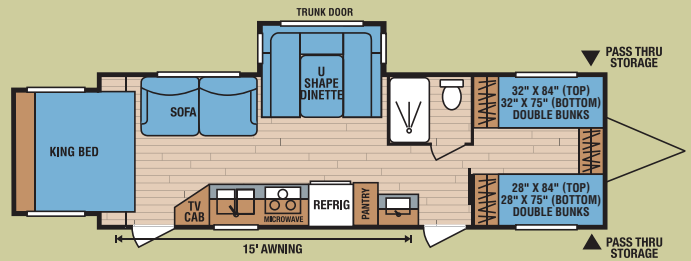

• see ramp door option

289KS • UVW 5370 • Dry Hitch Wt. 460 • NCC 1630 • Length 30'6"

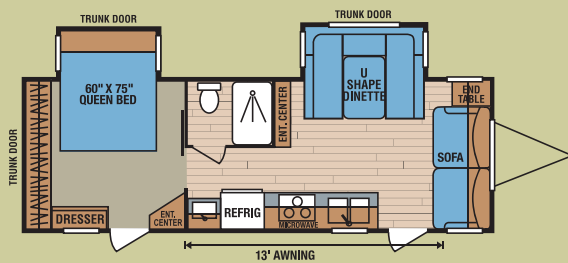

260FL • UVW 5400 • Dry Hitch Wt. 870 • NCC 1400 • Length 28'10"

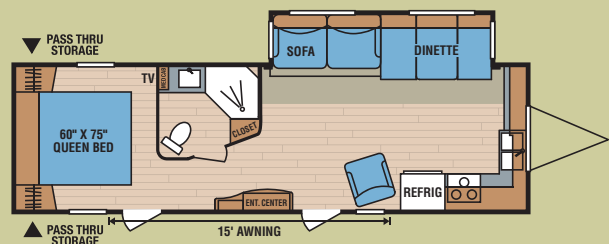

301FK • UVW 5500 • Dry Hitch Wt. 1140 • NCC 1500 • Length 32'3"

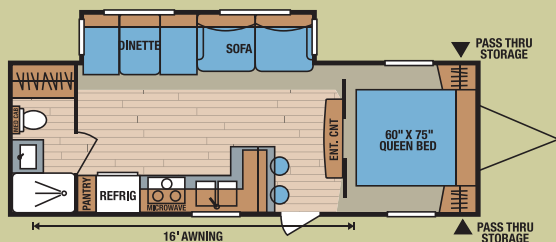

260RBS • UVW 5040 • Dry Hitch Wt. 500 • NCC 1760 • Length 28'8"

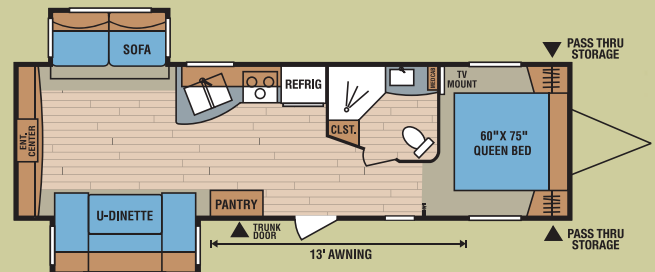

310RLS • UVW 5750 • Dry Hitch Wt. 540 • NCC 1550 • Length 33'2"

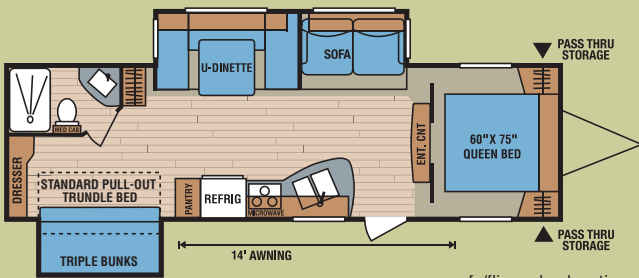

• see sofa/flip-up bunk option

318BHS • UVW 5830 • Dry Hitch Wt. 640 • NCC 1470 • Length 32'9"

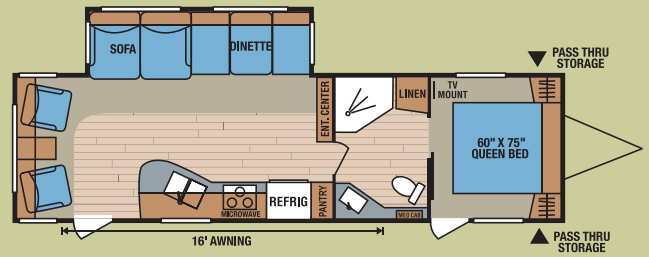

323RLS • UVW 5580 • Dry Hitch Wt. 650 • NCC 1420 • Length 32'5"

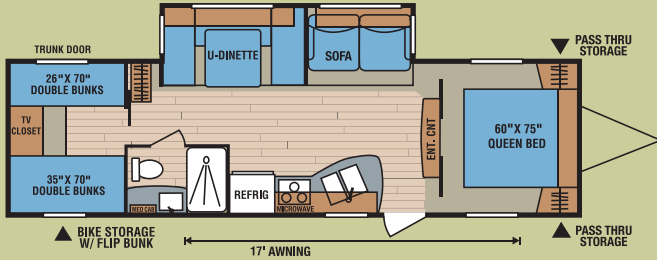

324BHS • UVW 5610 • Dry Hitch Wt. 610 • NCC 1690 • Length 33'7"

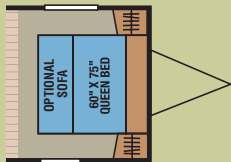

240BHS • Fold-Up Queen Bed w/ Flip-Up Sofa Opt.

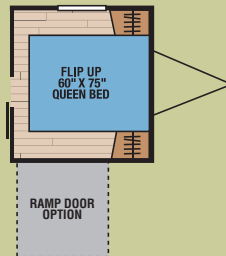

289KS • Ramp Door Opt.

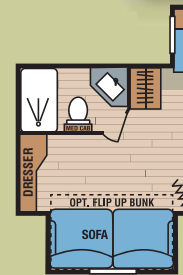

318BHS • Sofa/Flip-Up Bunk Opt.

Fifth Wheel Floorplans

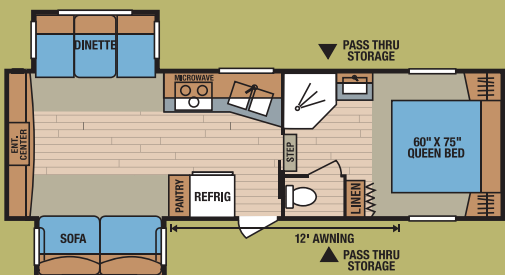

265RLS • UVW 6310 • Dry Hitch Wt. 910 • NCC 1190 • Length 28'2"

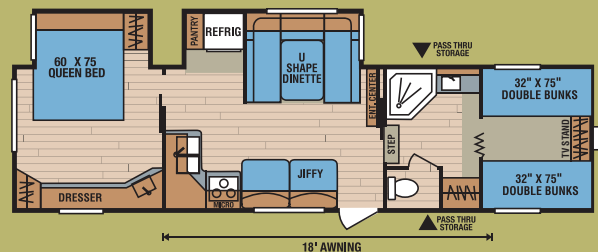

305BHS • UVW 7340 • Dry Hitch Wt. 1230 • NCC 1460 • Length 33'10"

Color Key:

Carpet ■ Cabinets ■ Comfort Areas ■ Countertops ■ Linoleum ■

2X2 WARRANTY – The KZ Recreational Vehicles 2x2 Warranty is a manufacturer's warranty. Each KZ product is warrantied to the original purchaser for twenty-four (24) months from the original date of purchase. Coverage includes appliances, components, construction and FULL structure. The appliances and other amenities are warranted by the individual manufacturers of those components, not KZ. Our warranty is also transferable within the first two (2) years for a small processing fee. For a copy of the warranty with full terms and conditions, ask your local KZ Dealer or visit our web site at <http://www.kz-rv.com>.

VEHICLE LOADING – Every effort has been made to provide the greatest number of options for the recreation vehicle owner. Each owner is responsible to select loads allowing the recreational vehicle to remain within the manufacturer's specified chassis weight limits. Do not overload the recreational vehicle.

UNLOADED VEHICLE WEIGHT (UVW) – The typical weight of this trailer as built at the factory. The UVW does not include cargo, LP gas, fresh water, options or dealer-installed accessories.

GROSS VEHICLE WEIGHT RATING (GVWR) – The maximum permissible weight of the trailer, including the UVW plus passengers, all cargo, personal items, fluids, options and dealer-installed accessories. The GVWR is equal to or greater than the sum of the UVW and the NCC.

NET CARRYING CAPACITY (NCC) – The maximum weight of all passengers, personal items, fresh water, food, tools, LP gas, other cargo and dealer-installed accessories* that can be carried by the trailer. NCC is equal to or less than GVWR minus UVW.

* The addition of options will decrease the NCC.

It is important for your safety and enjoyment that your tow vehicle be adequately sized and equipped to tow and handle the GVWR of the RV you select. Review weights and rating of your tow vehicle and consult a competent advisor for questions or advice. Whether you are new to RVing or a seasoned veteran, get a feel for the performance of your tow vehicle and the RV together before heading out on the roadways. When you tow an RV, you must drive differently than you do when driving a single vehicle. Practice hooking up, driving, backing up and braking in a safe environment or seek out professional instruction.

See specification chart. KZ affixes a weight label to each new RV which lists weight information for that vehicle.

NOTE: This information is intended as a guide only. Weights of individual vehicles are approximate. Consult your Owner's Manual for complete loading, weighing and towing instructions. All weights may vary.



0985 N 900 W • Shipshewana, IN 46565
E-Mail kz@kz-rv.com • www.kz-rv.com

Due to continual research and advances, manufacturer reserves the right to change specifications, design, price and equipment without notice, and assumes no responsibility for any error in this literature. Some items shown are not included as standard or optional equipment. ©2009KZ

8/15/09 50M

RVIA



One **less** thing
to **worry** about.

Worry-free protection against unexpected repairs for new or pre-owned travel trailers, fifth wheels and toy haulers

Comprehensive coverage

Professional claims administration with
over 25 years of experience

Protection throughout the United States and Canada

Special coverages

24-hour roadside assistance benefits

Trip interruption benefits

Service call benefits

Administered by:

United Service Protection Corp. • **United Service Protection Inc.** (in FL only)
P.O. Box 20899, St. Petersburg, FL 33742-0899 • Toll-Free: 1-800-685-3034
Florida License #60016000 • © Assurant, Inc. 2008

Dealer: