

# BULLET

PREMIER ULTRA LITE



**"The Bullet tows nicer than a lot of other travel trailers. When towing the Bullet, you can actually see an extra 30ft. further behind you than with other trailers! This allows you to keep track of vehicles behind you."**

- William with Star Fleet

## A New Era in Ultra Lites

### 295BHS

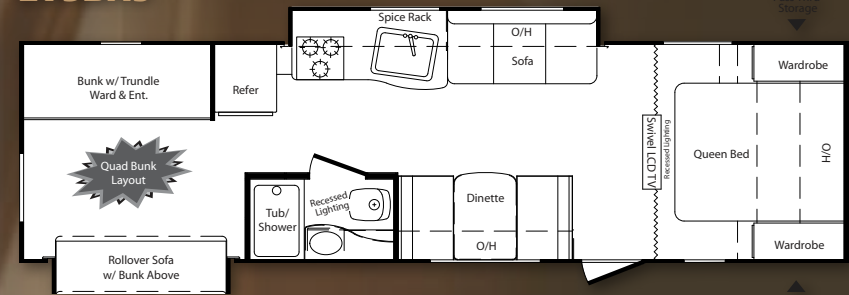

### 282BHS

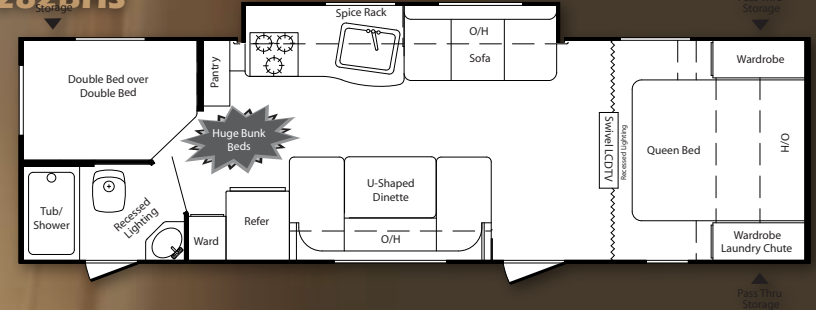

	282BHS	295BHS	288RLS	246RBS
<b>Shipping Weight</b>	5060	5620	TBD	TBD
<b>Carrying Capacity</b>	2520	2180	TBD	TBD
<b>Hitch</b>	580	800	TBD	TBD
<b>Exterior Length</b>	31' 4"	33' 4"	TBD	TBD
<b>Exterior Width</b>	8'	8'	TBD	TBD
<b>Exterior Height</b>	10' 3"	10' 5"	TBD	TBD
<b>Fresh Water</b>	41	41	TBD	TBD
<b>Waste Water</b>	30	30	TBD	TBD
<b>Grey Water</b>	30	30	TBD	TBD
<b>LPG Capacity</b>	40	40	TBD	TBD

Bullet | **the leader in towing comfort.**

www.keystonerv-bullet.com





In the 295BHS you will find an array of luxury features standard in the Bullet. The oversized sink, hidden spice rack, and large countertop makes meal preparation a breeze. When you are ready to unwind, take a seat on the upgraded pillow backed sofa or relax in your master bedroom with the Swivel Entertainment Center. Upscale furniture and real hardwood cabinet doors make this lightweight trailer a campers dream.



HEMLOCK

BLACKBERRY



With the ability to sleep 4-5 comfortably, the Bullet bunk room gives the kids a place of their own.



#### CONSTRUCTION STANDARDS

- Aluminum Framed Front & End Walls
- Laminated Gel-Coated Exterior Walls
- 2" Thick Laminated Aluminum Floor
- Radius Roof Transition
- In Frame Fresh, Grey, and Black Water Tanks
- 6" & 8" I-Beam with Welded Outriggers
- 1/4" ABS Enclosed Underbelly
- Darco Moisture Barrier
- One Piece Seamless Rubber Roof
- Wide-Stance Axle Placement
- E-Z Lube Axles
- Electric Brake System (4wheels)
- R-11 Floor
- R-7 Sidewall
- R-11 Roof
- Solid Bead Foam Block Insulation

#### EXTERIOR FEATURES

- Smart Vision
- Lightweight Fiberglass Front Cap
- Contoured Fender Skirts for Increased Air-Flow
- In Frame Dual Battery Rack
- Heated and Enclosed Underbelly
- Radius Entry Door w/Strut
- Stabilizer Jacks
- Drip Rail w/ Extended Down Spouts
- Oversized Exterior Pass Thru Storage w/ Lighting
- TV Antenna
- Outside Shower
- Electric Awning
- LP Quick Connect
- Amber Patio Light
- Exterior Speakers
- Outside Picnic Table
- Dual Propane Tanks w/Cover
- Tinted Safety Glass Windows
- Cable Hook-Up
- Heavy Duty Safety Chains
- Radial Tires
- LED Docking Lights

#### INTERIOR

- 78" Interior Height
- Swivel Rockers (Per Floor Plan)

- Pillow Back Furniture
- 13.5 Ducted A/C
- 30KBTU Furnace (For Heated Underbelly)
- 6 Gal. Gas/Electric Water Heater w/ 16.2 Gal./Hr. Quick Recovery
- DVD/CD/AM/FM Stereo w/ I-Pod Hook-up
- 19" LCD Flat Panel TV
- Swivel TV w/ Magazine Rack and Convenience Center (Per Floor Plan)
- Oversized Solid Wood Raised Panel Cabinet Doors
- Water Heater-By-Pass for Winterization
- Night Shades in Living Area

#### GOURMET KITCHEN

- 9" Deep Oversized Single Basin Sink
- High Rise Metal Faucet
- 6cu./ft. Double Door Refrigerator
- 17" Oven
- Microwave
- Spice Rack Valance
- 3 Burner High Output Range

#### BATHROOM

- Recessed "Bullet" Lighting
- Tub Surround
- Deluxe Curved Shower Curtain
- Power Vent Fan
- Solid Wood Medicine Cabinet
- Foot Flush Toilet

#### MASTER BEDROOM

- Upgraded Innerspring Mattress
- Roll Neck Pillows
- Mirrored Wardrobes
- Laundry Chute
- Recessed "Bullet" Lighting
- Under Bed Storage
- Full Blackout Window Treatments
- Individual Reading Lights

#### BUNK ROOMS

- Oversized Rollover Sofa w/Rear Storage
- Cable & TV Hookups
- Full Blackout Window Treatment
- Oversized Wardrobe w/ Rod (Some Floor Plans)



Product information is as accurate as possible as of the date of publication of this brochure. Features, floor plans, and specifications are subject to change without notice. Please also consult Keystone's web site at [keystone.com](http://keystone.com) for more current product information and specifications. Tow Vehicle Disclaimer: CAUTION: Owners of Keystone recreational vehicles are solely responsible for the selection and proper use of tow vehicles. All customers should consult with a motor vehicle manufacturer or their dealer concerning the purchase and use of suitable tow vehicles for Keystone products. Keystone disclaims any liability or damages suffered as a result of the selection, operation, use or misuse of a tow vehicle. KEYSTONE'S LIMITED WARRANTY DOES NOT COVER DAMAGE TO THE RECREATIONAL VEHICLE OR THE TOW VEHICLE AS A RESULT OF THE SELECTION, OPERATION, USE OR MISUSE OF THE TOW VEHICLE. 11/2009