

Monterey®



Beaver®

Different by Design.

EXTRAORDINARY

Monterey is back — and it's more powerful and luxurious than ever before. Step inside and prepare to be wowed by every thoughtful detail and decorative touch. In true Beaver style, the woodwork is stunning, with hardwood cabinetry, crown molding and beautiful slide-out fascia trim. Throughout the coach, you'll find designer carpet and ceramic tile flooring, and you have the option of a full-tile living area like the one shown here. The luxury extends to the cockpit, as you can see below. Ultraleather™ seats provide comfort on the road and relaxation at your destination. In the overhead cabinets, you'll find the home theater system, featuring a 32-inch LCD flatscreen TV. Now that you've had the first glimpse, are you ready to see more?







INSPIRING A highlight of the kitchen and dining area is the gleam of the polished radius solid surface countertops. The legless dinette extends from a full-length wall cabinet and is paired with two beautiful freestanding chairs.

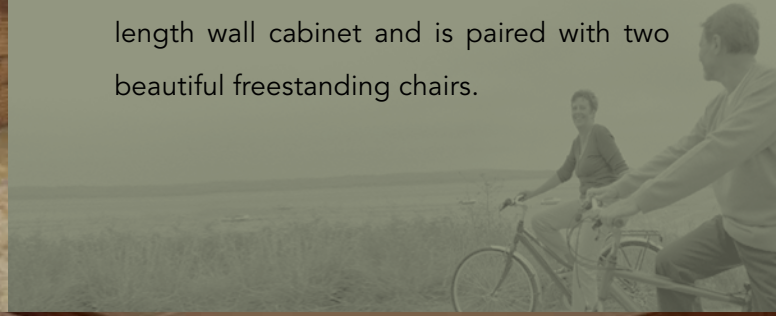



PLUSH

Just imagine unwinding
in style in the Monterey's

bedroom. The queen bed (king, on the Laguna 40 and Sunset 42) features a hardwood headboard with a padded fabric insert and decorative pillows. The Malibu 42, shown here, is a bath-and-a-half floorplan that features a full private bath beyond the bedroom. Highlights include the one-piece round shower with a reeded glass door (neo-angled with obscure glass door on Mission 40).





POWERFUL ENGINES

On the 2009 Monterey, you'll have the muscle of an ISC 360 Cummins® engine — or, on the 42-foot model, the remarkable Caterpillar®C-9 400 HP. Both are compliant with 2007 EPA standards and feature ACERT technology for reduced emissions, powerful performance and outstanding fuel economy.



SMART Behind the wheel, every button, switch and gauge is strategically positioned to give you the utmost control and peace of mind on the road. Cockpit highlights include rear vision with audio and an adjustable camera, an in-dash stereo with satellite radio and iPod connections and weather band, and optional GPS navigation. As you can see below, side-hinged baggage doors and an optional slide-out tray provide convenient access to items in the large pass-through storage bays.

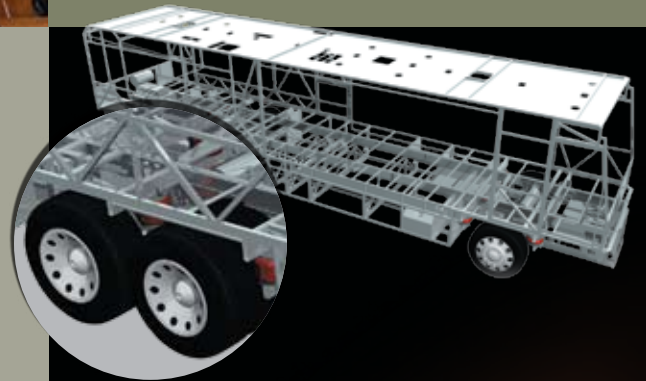

RR10R SERIES TAG AXLE

The Malibu 42 and Sunset 42 models feature 10 air bags and a tag axle with anti-lock brakes. It's all part of Beaver's commitment to overall performance and, most importantly, your safety.



5-LAYER LAMINATED GEL COAT FIBERGLASS SIDEWALLS (LEFT TO RIGHT)

- › Wallpaper
- › 1/8" luau
- › 1-1/2" x 1-1/2" square tubular aluminum frame
- › High-performance thermal insulation
- › High-gloss gel coat fiberglass exterior

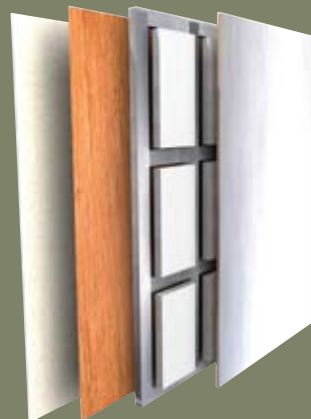

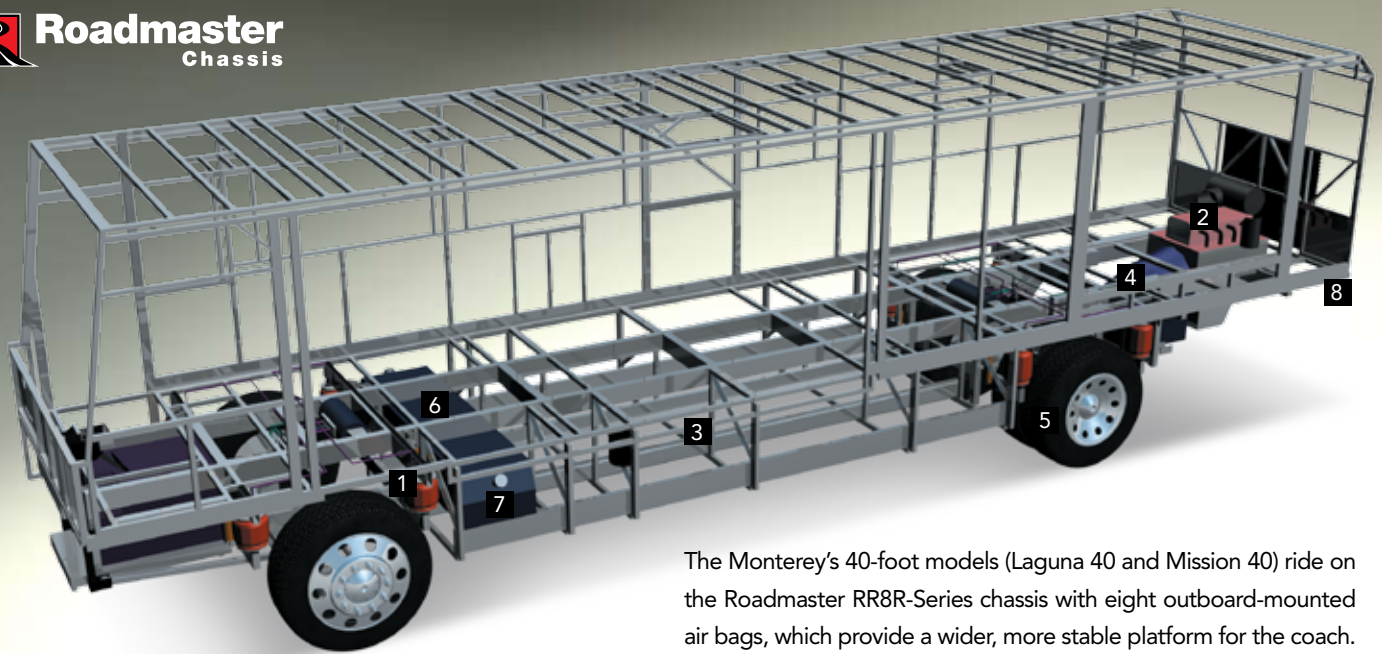

The Monterey's 40-foot models (Laguna 40 and Mission 40) ride on the Roadmaster RR8R-Series chassis with eight outboard-mounted air bags, which provide a wider, more stable platform for the coach.

- 1 The Cushion Air Glide suspension features 8 outboard-mounted gas-charged shocks and air bags.
- 2 The power of Cummins® is at the wheel of the 2009 Monterey. ISC 360 Cummins® engine – or, on the 42-foot model, the remarkable CAT® C9 400 HP.
- 3 Our exclusive raised rail design provides for larger full pass-through storage bays with flush floors.
- 4 Allison® 3000 MH 6-Speed World Transmission with electronic shifter. Our exclusive use of synthetic transmission fluid allows for up to three-year maintenance intervals for the Allison® transmission.
- 5 Automatic Traction Control (ATC) eliminates wheel slippage in slick conditions and heightens control. The Anti-Lock Braking System (ABS), with front disc brakes and rear drum brakes, gives you superior stopping power, especially on steep grades. Together, these sophisticated systems offer the very best safety on the road.
- 6 Aluminum Fuel Tank is lightweight and resists corrosion, unlike steel tanks.
- 7 Dual Fuel Fill allows you to fill the tank from either side of the coach for greater convenience and flexibility at the pump.
- 8 A 10,000 lb. tow hitch rating is the highest in its class. Prewired for supplemental braking system that works with your tow vehicle.

6-LAYER FLOORING

(TOP TO BOTTOM)

- › Carpet pad and carpeting or tile
- › Structurwood™ for added reliability
- › High-performance thermal insulation
- › 1-1/2" x 1-1/2" square tubular frame
- › 1/8" luaun
- › Waterproof Darco underbelly provides moisture barrier

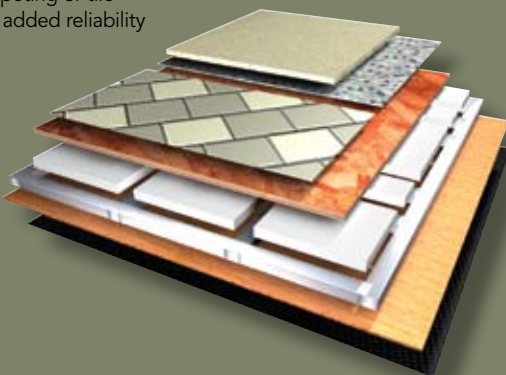

9-LAYER MOLDED FIBERGLASS ALL-SEASON FOAM INSULATED ROOF

(TOP TO BOTTOM)

- › One-piece 1/4" fiberglass roof is crowned for easy water runoff
- › Luaun backing
- › 2-1/2" thick tapered bead foam insulation
- › 1-1/2" x 3" aluminum I-beam superstructure on 16" centers filled with 3" fiberglass insulation
- › Vapor barrier
- › Structure foam provides added thermal barrier
- › 1/2" bead foam insulation
- › Foam padding for extra insulation
- › Easy-to-clean padded vinyl ceiling

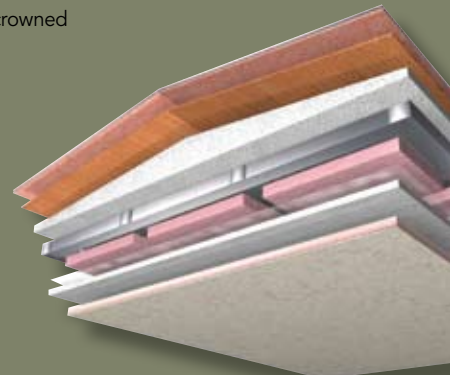



DRIFTSCAPE

ELEGANCE

The fine-tuned performance of the Monterey is matched by the exquisite beauty of its decors and the craftsmanship of its cabinetry. Choose the color that takes your breath away and combine it with one of our signature wood styles — to create a motor coach that's as distinctive as you are.

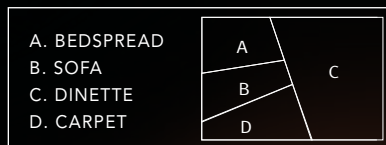

SANGRIA

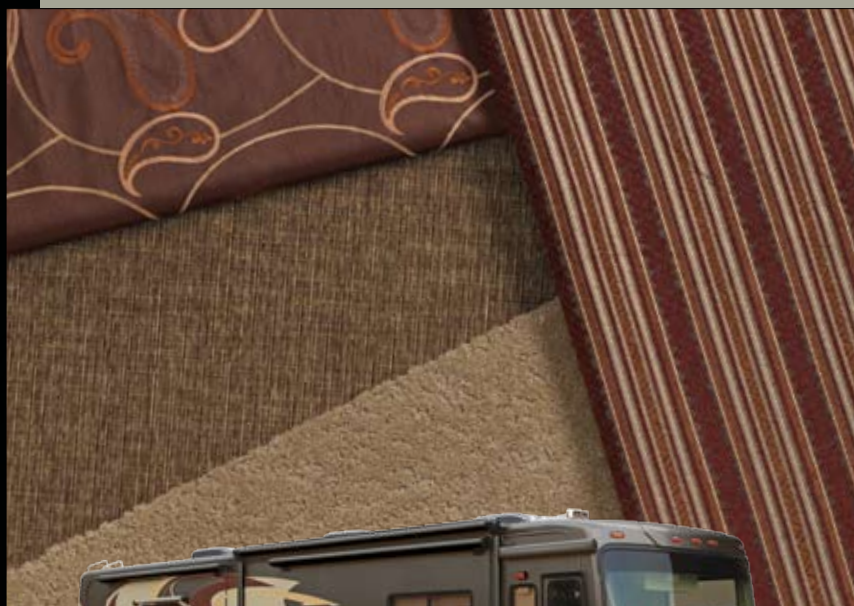

WARRANTIES

- › 12 Month/24,000 Mile basic limited warranty
- › 5 Year/50,000 Mile limited warranty on aluminum or steel frame structure of sidewall, roof, front and rear cap
- › 3 Year/50,000 Mile limited warranty on Roadmaster chassis





BALI NIGHT

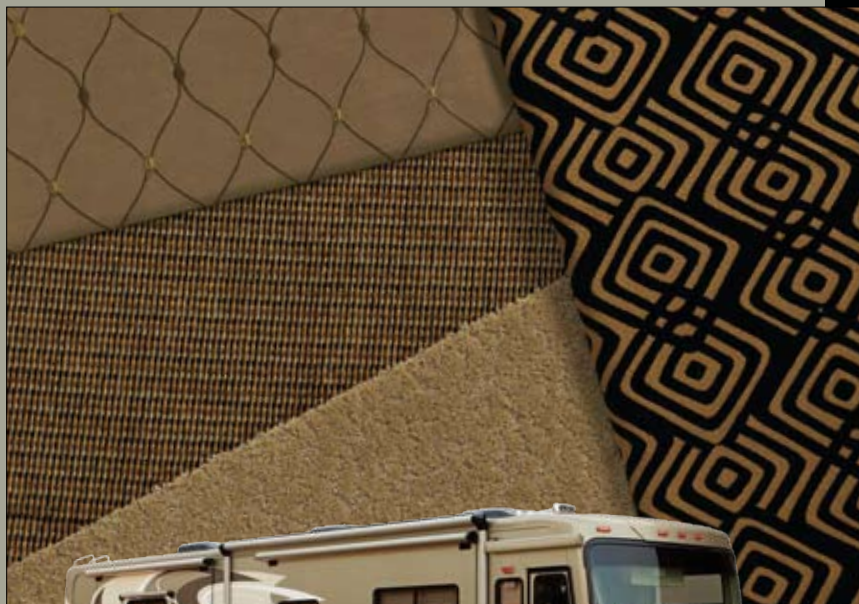

CRAFTSMANSHIP

The first thing you notice in a Beaver coach is the beautiful wood cabinetry and trim. Handcrafted from the world's finest woods, the details create a stunning effect — and a level of quality you won't find anywhere else.

SOPHISTICATION

Beaver owes its plush comfort to rich upholstery, textured carpeting, unique bedspread designs and beautifully coordinated accents. For 2009, our expert designers have assembled combinations for every taste — from bold and exotic to classic and traditional.



MEDIUM ALDER

LAGUNA 40

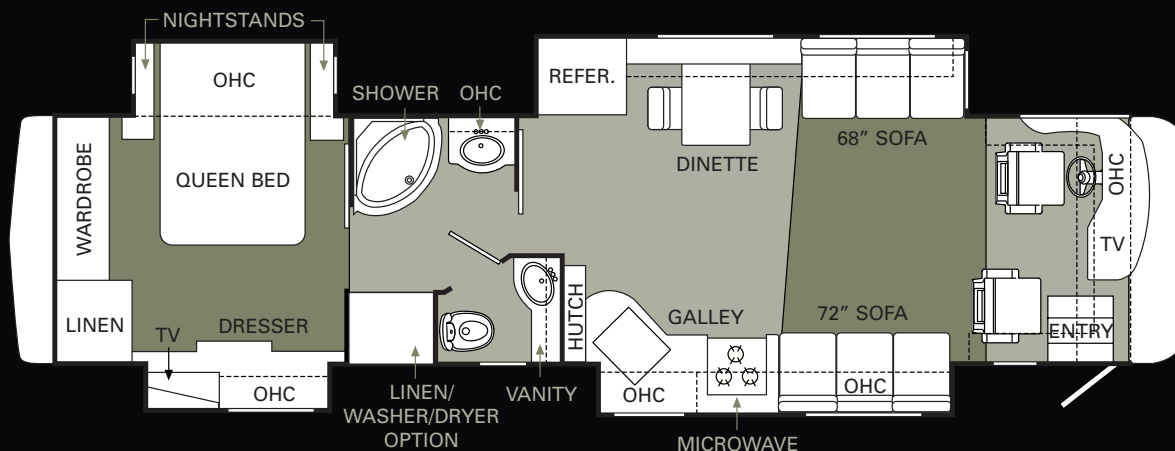

MISSION 40

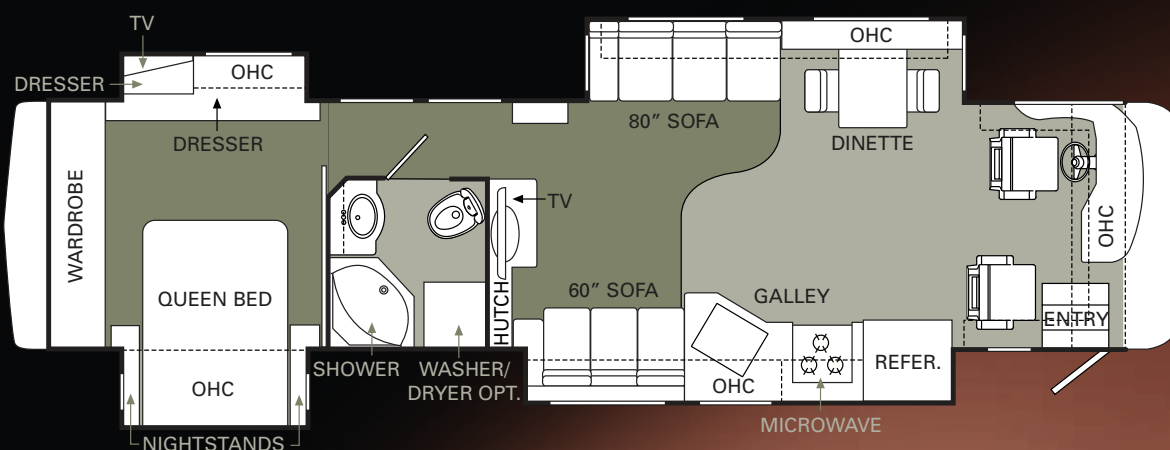

SPACIOUS

The 2009 Monterey is available in four spacious floorplans — each with quad slide-outs. Allow us to point out just a few of the highlights. The Mission 40 features a 37-inch LCD TV in a hutch, creating a cozy, residential-style living area. The Malibu 42 has a bath-and-a-half for increased privacy. And the Sunset 42 and Laguna 40 offer the added comfort of an optional king bed. Whichever you choose, you'll enjoy the unsurpassed lifestyle of a Beaver motor coach.



MALIBU 42

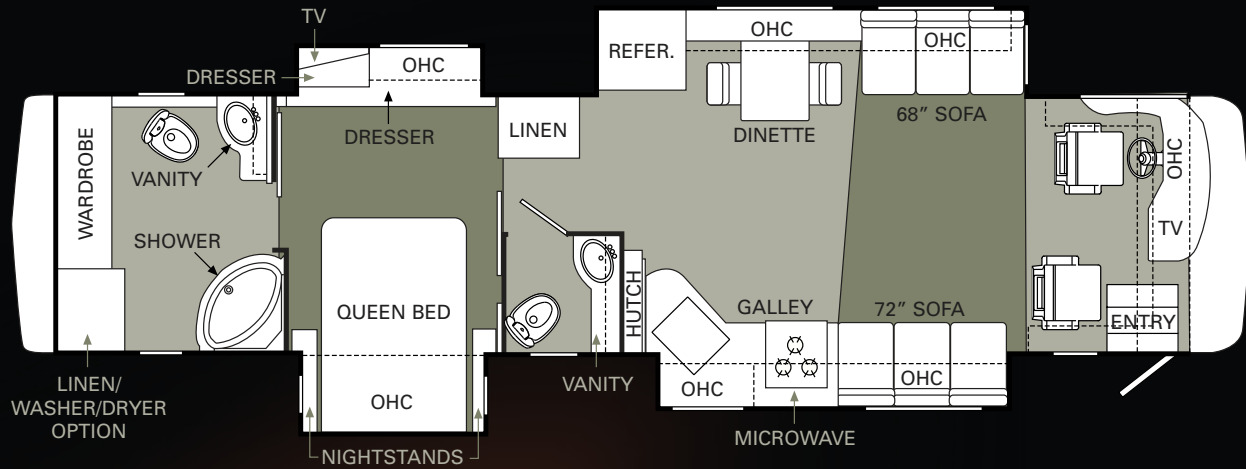

SUNSET 42

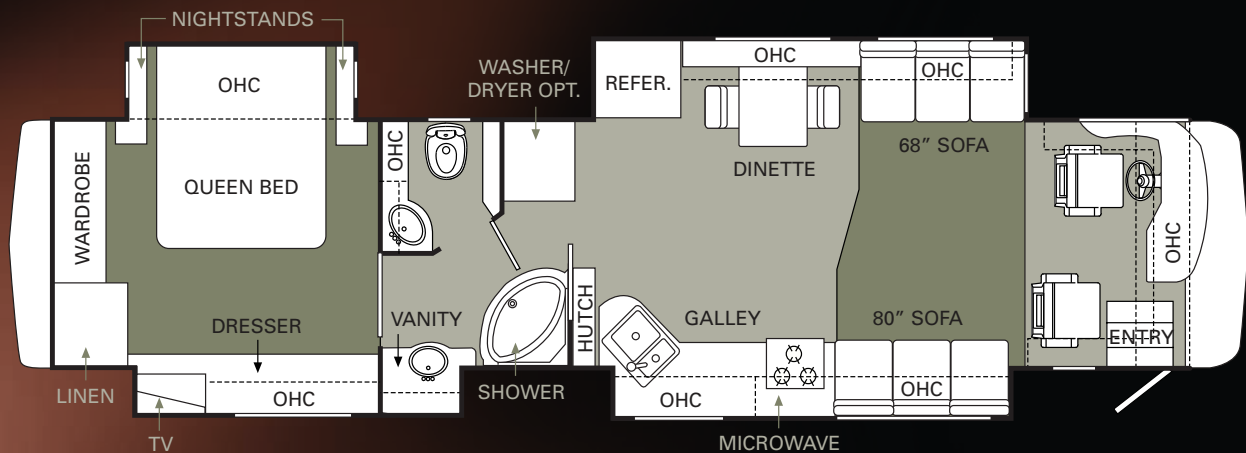

CARPET TILE

FLOORPLAN OPTIONS

- › Roadside Furniture: Fabric Hide-A-Bed with Air Mattress
- › Roadside Furniture: Ultraleather™ Easy Bed Sofa
- › Roadside Furniture: Ultraleather™ Hide-A-Bed with Air Mattress
- › Roadside Furniture: Ultraleather™ Booth Dinette Ensemble

- › Curbside Furniture: Fabric Hide-A-Bed with Air Mattress (N/A: Mission 40)
- › Curbside Furniture: Ultraleather™ Hide-A-Bed with Air Mattress (N/A: Mission 40)
- › Curbside Furniture: Ultraleather™ Easy Bed Sofa
- › Roadside: Wraparound Computer Desk with Ultraleather™ Euro-Recliner (N/A: Mission 40)

- › Queen Select Comfort Air Mattress
- › King Bed Select Comfort Air Mattress (Laguna 40, Sunset 42)
- › King Bed (Laguna 40, Sunset 42)

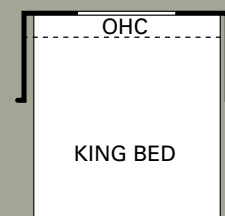
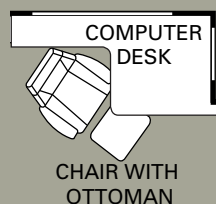
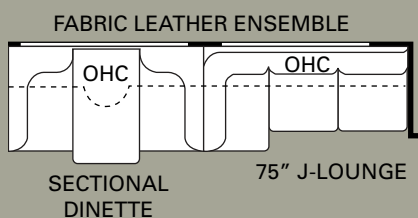



Due to continuous product improvement, please see the website for the latest in standards and options, specifications, and technical data. Go to www.beavermotorcoaches.com.

| | | LAGUNA 40 | MISSION 40 | MALIBU 42 | SUNSET 42 | |
|------------------------------|--|-----------|------------|-----------|-----------|--|
| WEIGHTS | Gross Vehicle Weight Rating (Lbs.) | 36,000 | 36,000 | 43,000 | 43,000 | |
| | Gross Combined Weight Rating ¹ (Lbs.) | 46,000 | 46,000 | 53,000 | 53,000 | |
| | Front Gross Axle Weight Rating (Lbs.) | 13,000 | 13,000 | 13,000 | 13,000 | |
| | Rear Gross Axle Weight Rating (Lbs.) | 23,000 | 23,000 | 20,000 | 20,000 | |
| | Tag Gross Axle Weight Rating (Lbs.) | 40,000 | 40,000 | 10,000 | 10,000 | |
| MEASUREMENTS | Wheelbase | 261" | 261" | 261" | 261" | |
| | Overall Length | 40' 8" | 40' 8" | 42' 8" | 42' 8" | |
| | Overall Height (12' 6" to Top of A/C) | 12' 8" | 12' 8" | 12' 8" | 12' 8" | |
| | Exterior Width | 100.5" | 100.5" | 100.5" | 100.5" | |
| | Interior Height (Carpet to Vinyl) | 84" | 84" | 84" | 84" | |
| TANK CAPACITIES ² | Gray Tank (Gal.) (Increased to 70 gal. ILO 56 gal.) | 62 | 62 | 62 | 62 | |
| | Black Tank (Gal.) (Decreased to 40 gal. ILO 56 gal.) | 42 | 42 | 42 | 42 | |
| | Fresh Tank (Gal.) | 100 | 100 | 100 | 100 | |
| | Fuel Tank (Gal.) | 100 | 100 | 100 | 100 | |
| | LP Tank (Gal.) | 39 | 39 | 39 | 39 | |

¹ Towing capacity is limited by GCWR; your vehicle's towing capacity is the difference between the GCWR and the actual vehicle weight, including all water, fuel, passengers and cargo. Your towed vehicle should be equipped with auxiliary brakes if the weight of the towed vehicle exceeds 1,000 lbs. Consult your owner's manual for further towing information.

² All tank capacities are estimated based upon calculations provided by the tank manufacturers and represent approximate capacities. The actual "usable capacity" may be greater or less than the estimated capacities based upon fabrication and installation of the tanks.

The actual overall length of the recreational vehicle may differ from that indicated in the brochure due to variances in the manufacturing process and/or installed components. The actual length may be greater or less than that indicated. Due to the large variety of options and floorplan arrangements available to our customers, actual weights for each unit can differ significantly. Beaver Motor Coaches provides a weight sticker on each unit we produce

which includes that unit's tank capacities and approximate weight. Consult your local Beaver Motor Coaches dealer for unit availability and further information.

The information printed in this brochure reflects product design, fabrication, and component parts at the date of printing. The manufacturer reserves the right, at any time, to make changes in product design or material or component specifications as its sole option, without notice. This includes the substitution of components of a different brand or trade name which will result in comparable performance.

All information printed in this brochure is subject to change after the date of printing. Some features shown or mentioned in this brochure are optional and may only be available in selected floorplans. Photographs may show props or decorations that are not standard equipment on Beaver Motor Coach models. Beaver Motor Coaches, the Beaver logo and its design, are registered trademarks. All other products and company names are trademarks and/or registered trademarks of their respective holders. While the color of the motorhome's exterior and the

interior fabrics depicted in this sales brochure are fair and reasonable depictions, the colors depicted may not be an exact match of the actual colors because of the variances in photo-processing and variances caused by inserting the photographs within the sales brochure.

Due to product improvements, changes during the model year and/or transcription errors that may occur, information represented within this brochure may not be accurate at the time of your purchase. If certain information is significant to your purchasing decision, please confirm the information with your dealer prior to submitting your order. Component part and appliance manufacturers issue limited warranties covering those portions of the recreational vehicle not covered by the Limited Warranties issued by Monaco Coach Corporation. To learn which specific component parts and appliances are excluded from the Limited Warranties issued by Monaco Coach Corporation, please contact your selling dealership or Monaco Coach Corporation directly, or review the warranty packet inside the recreational vehicle.



| | | | |
|----------------------------|--|--|---|
| BODY CONSTRUCTION | <ul style="list-style-type: none"> › Aluminum Framed Superstructure › Laminated Smooth Gel Coat Fiberglass Exterior Walls › Seamless One-Piece Molded Crowned Fiberglass Roof › Panaview™ 1-Piece Front Windshield › Interior Height 84" › Front and Rear Molded Fiberglass Cap › One-Piece Generator Access Door › Fiberglass Engine Cover | <ul style="list-style-type: none"> › Aluminum Framed Floor on Steel Trusses › Structurwood™ Flooring › Electric Flush-Floor Stepwell Cover › Foam Insulated Floor Framing with 3-Ply Underbelly › 17.5" Chrome Head Power-Heated Remote Mirrors › Side-Hinged Baggage Doors › Full-Length Mud Flap | <ul style="list-style-type: none"> › 3M Film Front Mask › Deluxe Full-Body Paint › Roof Ladder › Undercoating › Slide-Out Battery Tray (Malibu 42, Sunset 42) |
| CHASSIS/ENGINE/SUSPENSION | <ul style="list-style-type: none"> › Roadmaster Raised Rail Chassis RR8R (N/A: Malibu 42, Sunset 42) › Cummins® ISC 360 Engine with Allison® 3000 MH 6-Speed World Transmission and Electronic Shifter; Torque: 1050 lbs./ft.; Engine Displacement: 8.3L/506 cu. in. (Laguna 40, Mission 40) › Roadmaster Raised Rail Chassis RR10R (Malibu 42, Sunset 42) › CAT® C-9 400 Engine & Allison® 3000 MH 6-Speed Transmission with Electronic Shifter; Torque: 1250 lbs./ft.; Engine Displacement: 9.3L/567 cu. in. (Malibu 42, Sunset 42) › Aluminum Rear-Mounted Radiator with CAC Cooler › Chrome Exhaust Tip - Engine | <ul style="list-style-type: none"> › Dual Fuel Fill › 160 Amp Alternator › Rear Axle Ratio: 4.30:1 › Goodyear Radial Tires: 275/80R/22.5 › Polished Aluminum Wheels › 8 Gas Shocks and 8 Outboard-Mounted Air Bags (N/A: Malibu 42, Sunset 42) › 10 Gas Shocks and 10 Outboard-Mounted Air Bags (Malibu 42, Sunset 42) › Anti-Lock Braking System with Full Air Brakes (N/A: Malibu 42, Sunset 42) › Tag Axle with Anti-Lock Braking System (Malibu 42, Sunset 42) › Prewire for Supplemental Braking System › Automatic Traction Control | <ul style="list-style-type: none"> › Variable Geometry Turbo Exhaust (N/A: Malibu 42, Sunset 42) › Caterpillar® Variable Geometry Turbo Exhaust Brake (Malibu 42, Sunset 42) › Auto Slack Adjusters on Brakes › Transmission Temperature Gauge › Air Cleaner Restriction Indicator › Fuel and Water Separator › Remote Transmission Fill › Engine Block Heater › Automatic Hydraulic Leveling System › 10,000 Lb. Hitch Receiver with Dual Connector 4-Pin or 7-Pin |
| COCKPIT | <ul style="list-style-type: none"> › Automotive Dash with Roman Bronze Instrumentation Panel › Ultraleather™ Pilot and Co-Pilot Seats (Co-Pilot Seat with Powered Footrest) › Dash 12V Chassis Battery Gauge › CB Prep › In-Dash AM/FM/CD Stereo with Sirius-Ready Compatibility, iPod Control, | <ul style="list-style-type: none"> Aux-in-Connection, SD Card Slot and Weather Band › Rear Vision System with Audio and Adjustable Camera › Power Windshield and Manual Solar Screens with Blackout Shades on Driver and Passenger Windows › Adjustable Brake and Accelerator Pedals | <ul style="list-style-type: none"> › Audible Turn Signals › Roof-Mounted Dual Trumpet Air Horns › Carpeted Pilot and Co-Pilot Floor Mats › In-Dash Driver's Message Center |
| APPLIANCES AND ACCESSORIES | <ul style="list-style-type: none"> › Large Four-Door Refrigerator with Ice Maker › High-Output 3-Sealed Burner Cooktop without Oven › Removable Solid Surface Range Covers › Spacesaver Convection Microwave | <ul style="list-style-type: none"> › Home Theater System › 37" Flatscreen LCD TV in Living Area Hutch (Mission 40) › 32" Flatscreen LCD TV in Front Cockpit Overhead (N/A: Mission 40) › 19" LCD TV in Bedroom | <ul style="list-style-type: none"> › Exterior Hook-Ups for DSS Dish and Cable › Washer/Dryer Prep › Digital Satellite System Prep |
| | <ul style="list-style-type: none"> › High-Output 3-Sealed-Burner Range with Oven › Bedroom DVD Player with IR Repeater › 26" LCD Bedroom TV › Stack Washer/Dryer (Laguna 40, Sunset 42) › Combination Washer/Dryer | <ul style="list-style-type: none"> › 14 Cu. Ft. 2-Way Refrigerator with Water and Ice Dispenser in the Door › Stainless Steel Package (Includes Stainless Steel Refrigerator and Microwave) › Central Vacuum › R5 KVH In-Motion Satellite (Does Not Include Receivers) | <ul style="list-style-type: none"> › Fireplace (Mission 40) › Exterior Entertainment Center (26" LCD/AM/FM/CD Radio with Two Speakers) › Multi-Satellite HD KU/KA Dish (Does Not Include Receiver) |

STANDARD



OPTION



INTERIOR

- › Hardwood Cabinetry: Medium Alder
- › Heavy-Duty Ball Bearing Drawer Guides
- › Wood Cabinet Drawer Boxes
- › Refrigerator with Hardwood Inserts
- › Satin Nickel Cabinetry Hardware and Bath Accessories
- › Polished Radius Solid Surface Kitchen Countertop with Stainless Steel Sink with Two Sink Covers

- › Kitchen Backsplash: Corian® with Decorative Tile Inlay Accent
- › Corian® Solid Surface Countertops Throughout
- › Polished Solid Surface Bathroom Countertop with Integrated Sink
- › Ceramic Tile Kitchen, Entry and Bath
- › Designer Carpeting in Living Area and Bedroom

- › Hardwood Slide-Out Fascia with Decorative Corner Blocks and Center Block
- › Day/Night Pleated Blackout Shades in Living Area and Bedroom
- › Mini Blinds Kitchen and Bath
- › Soil Repellent on Fabric

- › Decors: Bali Night, Sangria, Driftscape
- › Full-Tile Living Room

FURNITURE

- › Queen Bed with Overhead Cabinet and Nightstands
- › Freestanding Dinette with Full-Length Wall Cabinet and Two Freestanding Chairs with Two Folding Chairs

- › Roadside Furniture: Fabric Easy Bed Sofa
- › Curbside Furniture: Fabric Easy Bed Sofa

- › Roadside Furniture: Fabric Hide-A-Bed with Air Mattress
- › Roadside Furniture: Ultraleather™ Easy Bed Sofa
- › Roadside Furniture: Ultraleather™ Hide-A-Bed with Air Mattress
- › Roadside Furniture: Ultraleather™ Booth Dinette Ensemble

- › Curbside Furniture: Fabric Hide-A-Bed with Air Mattress (N/A: Mission 40)
- › Curbside Furniture: Ultraleather™ Hide-A-Bed with Air Mattress (N/A: Mission 40)
- › Curbside Furniture: Ultraleather™ Easy Bed Sofa

- › Roadside: Wraparound Computer Desk with Ultraleather™ Euro-Recliner (N/A: Mission 40)
- › Queen Select Comfort Air Mattress
- › King Bed Select Comfort Air Mattress (Laguna 40, Sunset 42)
- › King Bed (Laguna 40, Sunset 42)

ELECTRICAL SYSTEMS & LIGHTS

- › 50-Amp 120V Distribution Panel and Power Cord
- › Battery Maintainer
- › Energy Management System
- › Onan® 8.0 kW Quiet Diesel Generator with Auxiliary Start Switch (N/A: Malibu 42, Sunset 42)
- › Onan® 10 kW Quiet Diesel Generator with Auxiliary Start Switch (Malibu 42, Sunset 42)

- › Four 6V Deep Cycle House Batteries
- › Two 12V Heavy-Duty Chassis Batteries
- › Battery Disconnect Switch at Front Door
- › Battery Boost Switch in Cockpit
- › 2000 Watt Inverter
- › Exterior Power Double Entry Step, with Lights
- › Lights in Outside Storage Compartments

- › Satin Nickel Decorative Lighting in Living Room, Dinette, Bath and Bedroom
- › Water Pump Switches in Service Bay, Bath, Private Bath and Galley
- › Convenience Center in Hallway

- › 50-Amp Electric Power Cord Reel

- › Solar Panel

STANDARD



OPTION



WE'RE HERE. ANYTIME, EVERY TIME

- Reach us anytime – literally – via our live customer support line.
- Drive in to one of our 350 Service Centers.
- Enjoy the first year free when you enroll in our Owner Advantage Roadside Assistance Program.



EMERGENCY ASSISTANCE
SALES • TECH • ROADSIDE

- See where it all begins with a tour of our facility in Oregon. Call 1-800-634-0855 to find out more.



| PLUMBING AND LP SYSTEMS | <ul style="list-style-type: none"> › Kitchen Under-Mounted Stainless Steel Sink with Single Lever Satin Nickel Faucet with Pullout Sprayer › Two Handle Satin Nickel Bath Faucet › 10 Gallon LP Gas/Electric Water Heater with Electronic Ignition › Central Water Filtration System › Demand Water System and Water Pump › Winterization Valving System › Water Heater Bypass Valving | | |
|-----------------------------------|---|--|--|
| | <ul style="list-style-type: none"> › China Toilet with Sprayer › China Toilet Electronic Silent Plus (Malibu 42) › Satin Nickel Shower Door Frame with Decorative Glass › No-Fuss Flush Holding Tank Rinsing System › Satin Nickel Shower Faucet with Slide Bar and Shut-Off Valve at Shower Head | | |
| HEATING, VENTS & AIR CONDITIONING | <ul style="list-style-type: none"> › Insulated Systems Compartment with Easy Access to Hook-Up › Shower inside Wet Bay with Hot/Cold Water › Gravity and Pressurized Water Fill › Contained Storage Area for Sewer Hose › One-Piece Round Shower with Reeded Glass Door (N/A: Mission 40) › One-Piece Neo-Angled Shower with Obscured Glass Door (Mission 40) | | |
| | <ul style="list-style-type: none"> › RV Sani-Con Holding Tank's Rinsing System › Water Hose Reel › Exterior Tank Monitor Gauge in Wet Bay › Neo-Angled Tub (N/A: Malibu 42) | | |
| WINDOWS, DOORS & AWNINGS | <ul style="list-style-type: none"> › Dual 13.5M BTU Roof Air Conditioner with Ducted Air, Heat Pumps, and Digital Thermostat Control (N/A: Malibu 42, Sunset 42) › Three 13.5M BTU Roof Air Conditioners with Wall Thermostat and Heat Pump (Malibu 42, Sunset 42) › Dual Zone Electronic Ignition Furnaces (One 31M BTU and One 20M BTU) › In-Floor Ducted Heating System › Kitchen and Bath Powered Attic Fan with Wall Control of Automatic Dome and Fan Power › 12V Heater in Wet Bay | | |
| | <ul style="list-style-type: none"> › Ceiling Fan in Bedroom › Dual 15M BTU Roof Air Conditioner with Ducted Air, Heat Pumps, and Digital Thermostat Control (N/A: Malibu 42, Sunset 42) › Two 15M BTU Roof Air Conditioners and One 13.5M BTU Roof Air Conditioner with Wall Thermostats and Heat Pumps (Malibu 42, Sunset 42) | | |
| SAFETY | <ul style="list-style-type: none"> › Radius Flush-Mounted Dual Pane Safety Glass Dark Tinted Slider Windows › Front Entry Door with Clear Glass, Removable Screen and Anti-Skid Steps › Automatic Front Door Awning › Eclipse Automatic Patio Awning › Roadside Slide-Out Living Room Window Awning with Metal Cover › Topper Slide-Out Awnings Living Area and Bedroom Slide-Outs with Metal Covers › Tinted Skylight in Bathroom with Protecta Glaze | | |
| | <ul style="list-style-type: none"> › Bedroom Window Awning › Keyless Entry › Backup Alarm › Fire Extinguisher › Deadbolt Lock on Entrance Door › 120V GFI Protected Circuit Kitchen, Bath and Exterior › LP Gas Detector › Smoke Detector › Carbon Monoxide Detector › Driver and Passenger Three-Point Seatbelts › Third Brake Safety Light › Egress Windows | | |

STANDARD ☐ OPTION ☐

WWW.BEAVERMOTORCOACHES.COM

Stay connected anytime — from wherever you are — with our website, www.beavermotorcoaches.com. It's your direct link to the latest news and updated information about your coach. Use it to find a nearby dealer or service center when you're on the road. And check the site regularly to get the latest schedule of rally and owner club events.





THE BEAVER LINE OF MOTOR COACHES:

MARQUIS® | PATRIOT® THUNDER | CONTESSA | MONTEREY®



BEAVER

Different by Design.

BEAVER MOTOR COACH

91320 Coburg Industrial Way, Coburg, OR 97408
www.beavermotorcoaches.com | (800) 634-0855

Monaco is traded on the New York Stock Exchange under the listing MNC.
© 2008, Monaco Coach Corporation Litho in USA | 0908 NPN:BROBMON