

THE 2008 INFERNO TOYHAULER





INFERNO

The idea was a simple one. Build a toyhauler that addresses all the needs, wants, and desires of today's modern RVer while staying true to the core elements of toyhauler culture: Luxury with utility, style with function, comfort with an aggressive edge. Essentially, build the next generation SURV for the fastest growing segment of the RV market.

KZ was up to the task and ready to put 30 years of RV building experience and craftsmanship behind the project. Identifying the need for this new toyhauler was only the first step towards creating something great, something unique. It would need to be bold. It would need to be innovative. It would need to set people's pants on fire. Enter INFERNO.



From the get go, Inferno was designed to acknowledge its differences from existing toyhaulers, with more attention to detail, a richer feature set, and innovative technologies never before seen in any RV.

The goal was to create a toyhauler to end all toyhaulers, a new prototype to set the

standard for all toyhaulers of the future, an RV to reset the industry and sound the call of change. Excessive? Maybe. But KZ was determined to bring this unit to market — Inferno needed to happen.

The product of months of conceptualization, design, and engineering (a little hot sauce too), Inferno hits the mark by re-imagining what a toyhauler should be. A merger of new ideas (like our EXss exterior sound system custom Alpine™ speaker box or the LED backlit Inferno front cap logo shield or reversible, dirt-resistant upholstery) with the rethinking of old (Loft access via stairs! Privacy in the bedroom!) led to the creation of the most aggressive, stylish, and fully-featured affordable toyhauler on the market today.

A simple idea has become a spectacular reality. On September 1, 2007, KZ's Plant 5 rolled out the first official Inferno unit — and they haven't stopped building them since. Mark your calendar.

The next generation of toyhaulers has begun.

The Inferno 4012SL, shown at left, features our unique privacy suite, which offers independent access to both bedroom and bathroom via beautiful, full-length glass doors.





PLAY HARD. INSIDE AND OUT.

Each Inferno is built around the needs of an active lifestyle. And when the action comes inside, Inferno is ready with all the creature comforts you'd find at home. The reversible cushioned U-dinette (shown above) is perfect for hosting a party or refueling your crew.

The woodworking skill of KZ's craftsmen really shows in Inferno's entertainment center (pictured at left) with a swing-arm mounted flat screen LCD TV and CD/DVD, a focal point which also features a built-in trophy shelf (with recessed lighting to show off your stuff).





The kitchen area offers a bar-top counter extension for feeding riders in a hurry to get to their toys. The custom hide-a-bed couch features Reversible Easy-Clean upholstery, providing both style and function — the cushions can be quickly flipped to a dirt-resistant surface (see photo opposite). Inferno has taken steps to make left access easier than ever via a new innovation we're calling "stairs".



Inferno offers the ultimate in privacy for the master bedroom suite with independent access to the bathroom (shown at right) from the living area. No more uninvited "guests" passing through in the middle of the night.



Set up base camp in style wherever you travel with Inferno. The upgraded custom Alpine™ speaker box driven EXss (exterior sound system) lets you listen to your favorite tracks as you make some of your own. Plenty of exterior storage gives you quick access to your gear. And Inferno's distinctive multi-mode, one-of-a-kind LED backlit logo shield provides a fiery glow after dark — light it up to let your crew know it's time to come home.



Inferno's Ramp Door is rated to 3000 lb. and D-rings keep your toys in place



Inferno is loaded with Skylights throughout



Removable Ladder provides easy roof access



Bold, custom Graphics are aggressive and stylish



Chrome accented LED Lighting runs cool but burns bright



Bronze-tinted Windows



Pulling either of these handles will bring you some joy



You'll see Inferno's custom LED backlit Logo Shield from miles away — switch the lights to "Inferno mode" for dramatic effect

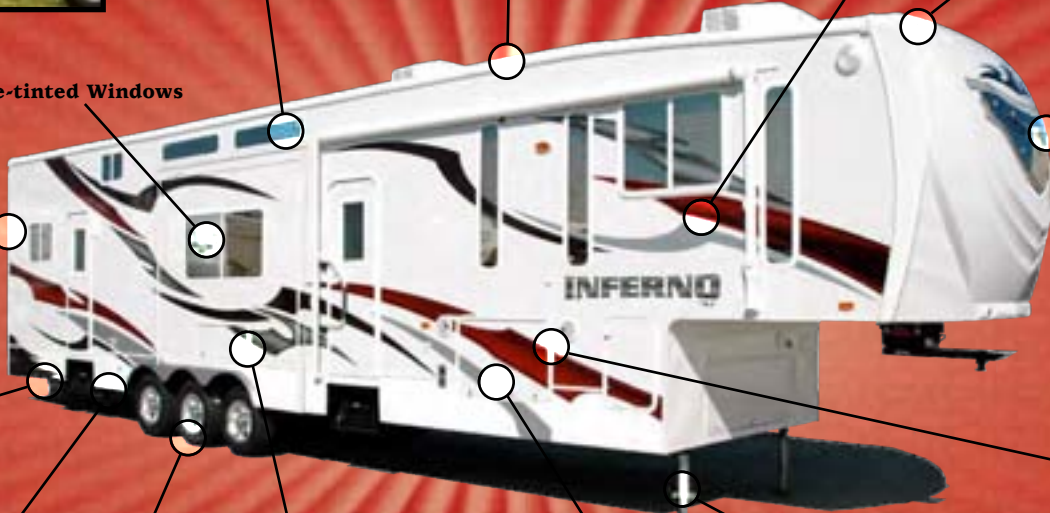

16" Aluminum Wheels with 6000 lb triple Axles



Hydraulic Front Landing Gear

Built-in standard Toy-Lok™ Security System locks down your toys so your ride is always there waiting for you



Under-body Storage Drawers extend for easy use



Crank up excessive sounds outside using Inferno's exclusive Alpine™ EXs (Exterior Sound System).



Tuff-Ply™ storage tray inserts let you put the drinks on ice

Plenty of pass-through Storage makes loading your Inferno a simple task

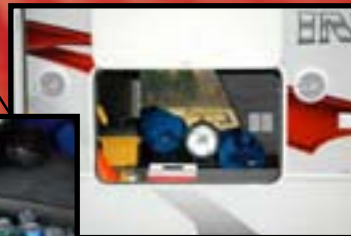

The Exterior Sound System Stereo controls, Power, and Cable Access are all easily accessed for exterior entertainment





Inferno's rear cargo area easily converts to additional entertainment space with a wall-mounted flip up table, collapsible bar stools, and refrigerated beverage dispenser with built-in tap (yet another Inferno exclusive feature).



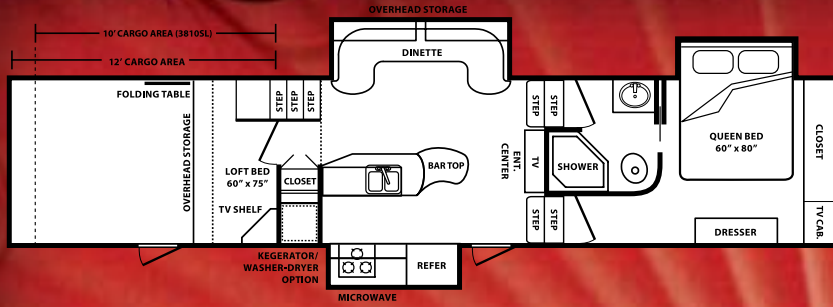

INFERNO 3810SL

| | | | |
|-------------|-------------|-------------------------|--------------------|
| GVWR: 18000 | UVWR: 11895 | CARRYING CAPACITY: 6105 | HITCH WEIGHT: 2450 |
|-------------|-------------|-------------------------|--------------------|

INFERNO 3812SL

| | | | |
|-------------|-------------|-------------------------|--------------------|
| GVWR: 18000 | UVWR: 12195 | CARRYING CAPACITY: 5805 | HITCH WEIGHT: 2510 |
|-------------|-------------|-------------------------|--------------------|

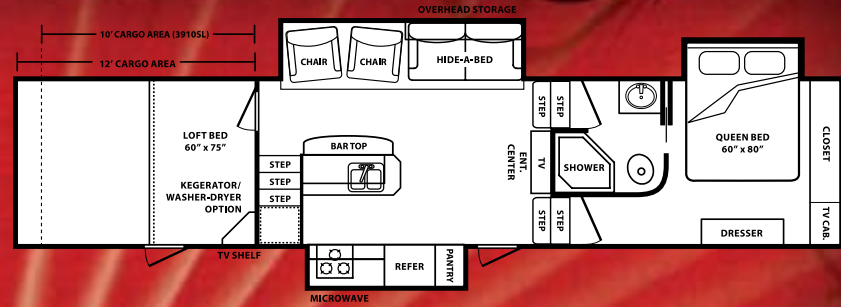

INFERNO 3910SL

| | | | |
|-------------|-------------|-------------------------|--------------------|
| GVWR: 18000 | UVWR: 13050 | CARRYING CAPACITY: 4950 | HITCH WEIGHT: 2915 |
|-------------|-------------|-------------------------|--------------------|

INFERNO 3912SL

| | | | |
|-------------|-------------|-------------------------|--------------------|
| GVWR: 18000 | UVWR: 13350 | CARRYING CAPACITY: 4650 | HITCH WEIGHT: 2995 |
|-------------|-------------|-------------------------|--------------------|

INFERNO

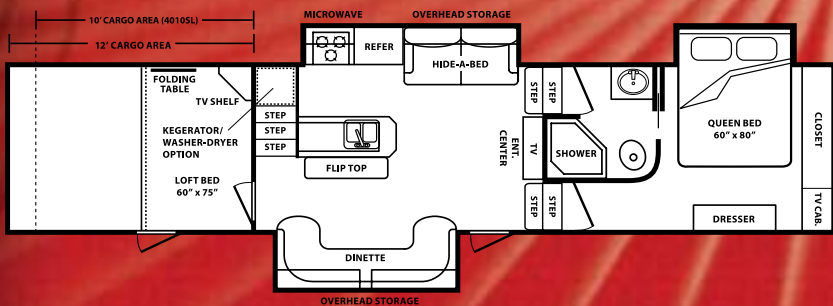

INFERNO 4010SL

| | | | |
|-------------|-------------|-------------------------|--------------------|
| GVWR: 18000 | UVWR: 13195 | CARRYING CAPACITY: 4805 | HITCH WEIGHT: 2915 |
|-------------|-------------|-------------------------|--------------------|

INFERNO 4012SL

| | | | |
|-------------|-------------|-------------------------|--------------------|
| GVWR: 18000 | UVWR: 13495 | CARRYING CAPACITY: 4505 | HITCH WEIGHT: 2995 |
|-------------|-------------|-------------------------|--------------------|

| | 4012SL | 4010SL | 3912SL | 3910SL | 3812SL | 3810SL |
|-------------------------|-----------|-----------|-----------|-----------|-----------|-----------|
| Exterior Ht. with A/C | 13'1" | 13'1" | 13'1" | 13'1" | 13'1" | 13'1" |
| Exterior Length | 42'5" | 40'5" | 42'5" | 40'5" | 39'9" | 37'9" |
| Exterior Width | 102" | 102" | 102" | 102" | 102" | 102" |
| Fresh Water Cap. (Gal.) | 110 | 110 | 110 | 110 | 110 | 110 |
| Black Water Cap. (Gal.) | 50 | 50 | 50 | 50 | 50 | 50 |
| Gray Water Cap. (Gal.) | 50 | 50 | 50 | 50 | 50 | 50 |
| LP Gas Capacity (gal.) | 60 | 60 | 60 | 60 | 60 | 60 |
| Furnace (BTU) | 35,000 | 35,000 | 35,000 | 35,000 | 35,000 | 35,000 |
| Axles (lb.) | (3) 6,000 | (3) 6,000 | (3) 6,000 | (3) 6,000 | (3) 6,000 | (3) 6,000 |
| Tire Size | 16" | 16" | 16" | 16" | 16" | 16" |

Standard Exterior Features:

- Aluminum Wheels (8 Lugs)
- Triple 6,000 lb. Axles
- 16" Tires
- Straight 12" I-Beam Frame
- Framed Garage Floor
- Beaver-Tail Rear Entry
- Spring-Assist Ramp Door
- 3,000-lb-Rated Rear Ramp Door
- Detachable Ladder
- Full Walk-on Roof
- Exclusive Front Fiberglass Cap
- Second Entry Door
- Aluminum Framed Fiberglass Laminated Sidewalls
- Aluminum Fender Skirts
- 110 Gal. Fresh Water Tank
- 50-Amp Detachable Power Cord
- Front and Rear LED Lights
- Exterior Storage Area Cable Jack
- 12V Deep Cycle Battery
- 12V Battery Disconnect
- Dual 30 lb. LP Bottles
- Fold-Out Entry-Assist Handle
- 5/8" Tongue-and-Groove Plywood Floor
- Pass-through Basement Storage
- TV Antenna with Booster
- White Clamp-Ring Windows
- New Dramatic Exterior Graphics
- Spare Tire and Hoist

VEHICLE LOADING – Every effort has been made to provide the greatest number of options for the recreational owner. Each owner is responsible to select loads allowing the recreational vehicle to remain within the manufacturer's specified chassis weight limits. Do not overload the recreational vehicle.

UNLOADED VEHICLE WEIGHT(UVW) – The typical weight of this trailer as built at the factory. The UVW does not include cargo, LP gas, fresh water, options or dealer-installed accessories.

GROSS VEHICLE WEIGHT RATING(GVWR) – The maximum permissible weight of the trailer, including the UVW plus passengers, all cargo, personal items, fluids, options and dealer-installed accessories. The GVRW is equal to or greater than the sum of the UVW and the NCC.

NET CARRYING CAPACITY(NCC) – The maximum weight of all passengers, personal items, fresh water, food, tools, LP gas, other cargo and dealer-installed accessories* that can be carried by the trailer. NCC is equal to or less than GVWR minus UVW.

* The addition of options will decrease the NCC.

It is important for your safety and enjoyment that your tow vehicle be adequately sized and equipped to tow and handle the GVWR of the RV you select. Review weights and rating of your tow vehicle and consult a competent advisor for questions or advice. Whether you are new to RVing or a seasoned veteran, get a feel for the performance of your tow vehicle and the RV together before heading out on the roadways. When you tow an RV, you must drive differently than you do when driving a single vehicle. Practice hooking up, driving, backing up and braking in a safe environment or seek out professional instruction.

See specification chart. KZ affixes a weight label to each new RV which lists weight information for that vehicle.

NOTE: This information is intended as a guide only. Weights of individual vehicles are approximate. Consult your Owner's Manual for complete loading, weighing and towing instructions. All weights may vary.

Standard Interior Features:

- Shower Skylight
- Exclusive Loft Stairs
- Dual-Entry Bath Deck
- Shaker-Style Cabinet Doors
- Custom Designed Valances
- Front Wardrobe Storage
- Hidden Shoe Storage In Front Wardrobe
- Control Panel
- Flush-Mount Overhead Cabinet Lighting
- Directional Lighting Above Sofa
- Counter top Extension
- Cabinets with Integrated Toe-Kick
- Sink Covers
- Stove Cover
- Trouble-Free Heating Ducts in Living Area
- Full-Length Mirror in Bedroom Hallway
- Two Full-Length Glass Doors to Bath Deck
- Night Shades on Bath and Hallway Door
- Security Rail on Overhead Loft
- Cabinet Storage in Loft
- Cable Jack in Loft
- Solid Wood Furnace Air Return Cover
- Ducted Air Conditioning throughout Unit Including Garage
- Swivel-Arm Mounted Flat-Screen LCD TV Entertainment Center
- Ultrasuede Bedspread
- Under-Bed Storage Area
- Solid Wood Slide-Out Fascia

Universal Package includes:

Central docking center, High Gloss Exterior, Bronze-Tint Safety Windows, 15,000 BTU Air Conditioner, Foot-Flush Pedal on Toilet, Water Heater Bypass, TV Antenna with Booster, Awning, Assist Handle, (2) Security Lights, Spare Tire, 12 Gal. Water Heater, Shower Skylight, Satellite Prep, 75 Amp. Converter, 50 Amp. Service, Black Tank Flush, Refrigerator Panel, One-Piece Neo-Angle Shower, Night Shades, Two-Tone Light Fixtures, Hide-A-Bed, LP Quick Disconnect, Microwave, 22" Oven, Pullout Residential Spray Faucet, Super-Lube Axles, Triple Entry Steps, Washer/Dryer Prep, Rear Cargo Lights, Cabinet Crown Mouldings, Prep for Second Air Conditioner in Bedroom, Exclusive Double-Entry Master Suite, Dimmer Lights in Dinette and Bedroom Slide-Outs.

Performance Package includes:

Trend-Setting Front Cap with Specialty Lighting, Hydraulic Front Landing Gear, Rear Electric Jacks, Inferno Front Cap, 8 ft.. Ramp Door, LCD TV, Hydraulic Slide System, Rear Loft, Tuff-Ply™ in Cargo area, Tuff-Ply™ Ramp Door, Diamond Plate Protection in Cargo Area, Fuel Tank with Pump, Generator Prep, Battery Quick-Disconnect, Interior CD/DVD Audio System, Tuff-Ply™ Exterior Basement Area, Reversible Easy-Clean Furniture, Air Conditioner Ducted to Cargo Area, Aluminum Wheels, Docking Lights, Cargo Work Station, Center-Latch Ramp Door, Toy-Lok™ System, Exclusive Loft Stairs, Fantastic Fan in Cargo Area, (9) D-Rings in Cargo Area, Heated and Enclosed Underbelly.

KZ PLANT 5:

KZ isn't new to building toy-haulers — in fact, we've been building them (and building them well) since 1999. But, in light of the way the toyhauler market has grown, we feel the time has come to publicly acknowledge what a dedicated manufacturing environment can do for an RV product line.

That's where KZ's Plant 5 comes in. You see, Plant 5 is where all the toyhauler action happens at KZ — the entire facility is devoted to building toyhaulers (and toyhaulers alone). That singular task is what guides our skilled craftsmen, engineers, designers, and sales team every day. They take pride in the innovative products built in Plant 5 and are constantly looking for new ways to enhance the active lifestyles of our toyhauling customers.

At KZ, Plant 5 is *the* toyhauler factory. And now it's our brand too.



THE TOYHAULER FACTORY. SINCE 1999.

An innovative leader in RV design and development, KZ's desire is to engineer affordable, high-value products that deliver customer satisfaction year after year. See for yourself why KZ has been awarded the Dealer Satisfaction Index six years in a row.



2X2 WARRANTY:

The KZ 2x2 Warranty is a manufacturer's warranty. Each KZ product is warrantied to the original purchaser for twenty-four (24) months from the original date of purchase. Coverage includes appliances, components, construction and FULL structure. Our warranty is also transferable within the first two (2) years for a small processing fee. For a copy of the warranty with full terms and conditions, ask your local KZ Dealer or visit our web site at:
<http://www.kz-rv.com>



INFERNO

KZ • 0985 N 900 W • Shipshewana, IN 46565
E-Mail kz@kz-rv.com • www.kz-rv.com

DEALER:

