

DAYBREAK BY DAMON

2009



DAMON

PROUDLY PRESENTS:

DAYBREAK

CLASS A MOTORHOMES



BURSTING WITH VALUE, STYLE, AND OTHER NICETIES

DAYBREAK

**A NEW DAY HAS DAWNED IN FAMILY-FRIENDLY,
MORE-FOR-YOUR-MONEY, CLASS-A MOTORHOME ENJOYMENT!**

Daybreak is what you've been longing for. And now it's here: Class-A motorhomes with every feature and benefit you have ever dreamed

of, for a price that won't cause nightmares. At Damon, you'll be riding on over 20 years of motorhome building experience.



WE'RE DAMON MOTOR COACH

With Damon, you get more innovative floorplans, better coach designs, higher quality standards, and a good reputation for support-after-the-sale.

The most popular motorhomes on the road and at campsites today are Damon products. It's value by design, especially at resale time.

AMAZINGLY-SOLID FEATURES



LOTS OF STORAGE

From pantry to closets, under bed and full basement exterior pass-through, DayBreak has more.

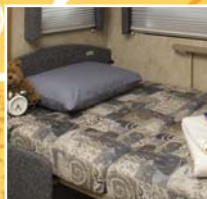

DREAM DINETTE

Damon's standard Dream Dinette is easier to set up and take down than any other design.



QUALITY FEATURES

Full extension ball bearing drawer guides also feature solid wood cabinet door and drawer fronts.



AN AMAZINGLY-AFFORDABLE MOTORHOME

Better quality and styling for your money is the Damon way. From creature comforts, like standard LCD TV in the kid's room (on 3576), to solid construction; Damon coaches are built to last—and designed for living!



MORE OF EVERYTHING, FOR LESS!

The amenities you see are impressive. But the value is designed in, and often overlooked. Large foam-lined air ducts allow better heating and cooling and are more efficient, ball bearing cabinet drawer guides are top quality, cabinet doors feature hidden hinges, window openings are framed in aluminum to prevent swelling and better sealing. And much more than meets the eye!



BRILLIANT STORAGE

Well-thought-out and well-built storage compartments abound on your Daybreak coach. This large under-bed storage is hidden but handy. You'll also appreciate a large pantry and closets, along with Daybreak's massive under floor, pass-through exterior storage feature.



BETTER CABINETRY

For the money, you get much more with Daybreak. Cabinet door fronts feature raised panels and have the look of high end storage. Even room dividers have wood pocket doors vs. cheap plastic accordion-style doors like those found on most coaches in this price category.

INTERIOR COLORS

Top-of-the-line fabrics and a stylish variety of interior decor choices are sure to please.

BRONZED BULLION



CARBON COIN



INCA TREASURE



Bathrooms feature all the luxuries of home.



A 26" LCD TV offers better picture quality and less glare. Floorplan model 3578 in Carbon Coin.



Our unique Dream Dinette easily converts into a bed.



Standard King bed for extra comfort (some models Queen).



A one-piece windshield offers a more panoramic view. Swivel captain's chairs are convenient.



This kitchen has Glazed Maple doors and drawers.



GLAZED MAPLE
Solid wood raised panel door and drawer fronts. Maple is optional.



CHERRY
Cherry is standard. Hinges are hidden on interior cabinet doors.

IF YOU CAN FIND A BETTER DESIGNED, MORE INNOVATIVE FLOORPLAN,

3270 DAYBREAK:

CHASSIS	WORKHORSE/FORD
WHEELBASE	216.5
OVERALL LENGTH	34'7"
OVERALL WIDTH	101"
OVERALL HEIGHT WITH AC	12'0"
GVWR	18,000/20,500
GCWR	22 K/26 K
FRESH WATER	65 (GAL.)
WATER HEATER	6 (GAL.)
GREY/BLACK WATER	47 (GAL.)
LP (LBS.)	81
SLEEPING CAPACITY	6
EXTERIOR STORAGE	163 (CU. FT.)
INTERIOR DRAWERS	10
INTERIOR DRAWER CAPACITY	8.5 (CU. FT.)
FUEL CAPACITY	75 (APPROX. GAL.)



3370 DAYBREAK:

CHASSIS	WORKHORSE/FORD
WHEELBASE	216.5
OVERALL LENGTH	33'7"
OVERALL WIDTH	101"
OVERALL HEIGHT WITH AC	12'0"
GVWR	21,200/20,500
GCWR	26 K
FRESH WATER	65 (GAL.)
WATER HEATER	6 (GAL.)
GREY/BLACK WATER	47/39 (GAL.)
LP (LBS.)	81
SLEEPING CAPACITY	5
EXTERIOR STORAGE	131 (CU. FT.)
INTERIOR DRAWERS	11
INTERIOR DRAWER CAPACITY	10 (CU. FT.)
FUEL CAPACITY	75 (APPROX. GAL.)



3575 DAYBREAK:

CHASSIS	WORKHORSE/FORD
WHEELBASE	242
OVERALL LENGTH	37'11"
OVERALL WIDTH	101"
OVERALL HEIGHT WITH AC	12'0"
GVWR	21,200/20,500
GCWR	26 K
FRESH WATER	65 (GAL.)
WATER HEATER	6 (GAL.)
GREY/BLACK WATER	47/39 (GAL.)
LP (LBS.)	81
SLEEPING CAPACITY	6
EXTERIOR STORAGE	220 (CU. FT.)
INTERIOR DRAWERS	17
INTERIOR DRAWER CAPACITY	14 (CU. FT.)
FUEL CAPACITY	75 (APPROX. GAL.)



BUILT RIGHT, THE WAY YOU'D DO IT!

You get more with Damon. Neoprene vibration dampening, all openings framed in aluminum, galvanized steel underbelly, heated holding tanks ducted from furnace, and more. All built to higher specifications!

ROOF:

- 1) Vinyl ceiling
- 2) Luan (wood)
- 3) Air cond. duct
- 4) Luan (wood)
- 5) TPO roofing
- 6) Insulation
- 7) Aluminum frame

SIDEWALLS:

- 1) Interior panel
- 2) 1-1/2" block foam insulation
- 3) Luan backer
- 4) Ext. fiberglass
- 5) Aluminum frame (tubing)

FLOOR:

- 1) Carpet
- 2) Padding
- 3) Structurwood flooring
- 4) Block foam
- 5) Galvanized metal
- 6) Steel frame



A FOUNDATION THAT'LL LAST FOR YEARS

How do 13" steel floor trusses for more pass through storage, steel firewall, bonded steel framing, bus-style storage doors, and more sound? Daybreak delivers solid value.



WITH MORE CREATURE COMFORTS THAN A DAYBREAK — BUY IT!

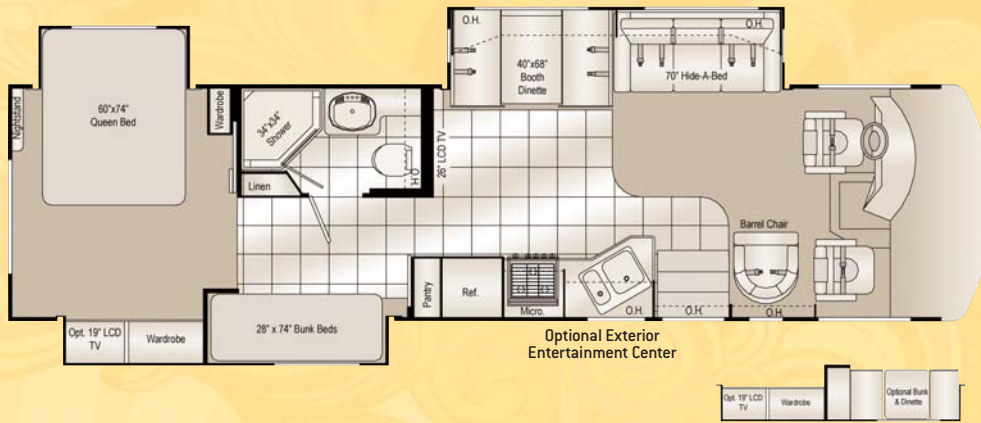

3576 DAYBREAK:

CHASSIS	WORKHORSE/FORD
WHEELBASE	228
OVERALL LENGTH	35'6"
OVERALL WIDTH	101"
OVERALL HEIGHT WITH AC	12'0"
GVWR	21,200/20,500
GCWR	26 K
FRESH WATER	65 (GAL.)
WATER HEATER	6 (GAL.)
GREY/BLACK WATER	47/39 (GAL.)
LP (LBS.)	81
SLEEPING CAPACITY	7
EXTERIOR STORAGE	131 (CU. FT.)
INTERIOR DRAWERS	15
INTERIOR DRAWER CAPACITY	10 (CU. FT.)
FUEL CAPACITY	75 (APPROX. GAL.)



3578 DAYBREAK:

CHASSIS	WORKHORSE/FORD
WHEELBASE	228
OVERALL LENGTH	36'6"
OVERALL WIDTH	101"
OVERALL HEIGHT WITH AC	12'0"
GVWR	21,200/20,500
GCWR	26 K
FRESH WATER	65 (GAL.)
WATER HEATER	6 (GAL.)
GREY/BLACK WATER	47/39 (GAL.)
LP (LBS.)	81
SLEEPING CAPACITY	6
EXTERIOR STORAGE	166 (CU. FT.)
INTERIOR DRAWERS	13
INTERIOR DRAWER CAPACITY	13.5 (CU. FT.)
FUEL CAPACITY	75 (APPROX. GAL.)



STANDARD GRAPHICS

Tasteful, yet contemporary standard graphics are made from high-end materials that will last and are less prone to fading over time. Bus style storage doors are also standard and are a high-end amenity. Leave it to Damon to deliver more for less!

OPTIONAL SILVER MIST PAINT EXTERIOR

This partial paint exterior upgrade enhances the look of your Daybreak coach. Upgraded gel-coat sidewalls and an exterior entertainment center are on some floorplans and black framed dual-pane windows are other great options you can add to a Daybreak coach.

STANDARD FEATURES & OPTIONAL EQUIPMENT

EXTERIOR

- Rear ladder
- Fiberglass front and rear caps
- Side-mounted patio awning
- Side-mounted awning over slideout(s)
- Radius corner domed TPO roof
- Easy-to-clean lighted rotocast storage compartments
- Full basement pass-through storage

CHASSIS

- Automatic leveling jacks with touch pad controls
- Front and rear mud flaps
- Trailer hitch (5,000 tow / 500 tongue lbs.)
- Emergency-start circuit
- Layer of neoprene vibration dampener

ENTRY

- Double electric exterior entrance step
- Battery access in stairwell

COCKPIT

- AM/FM radio with in-dash CD player
- Dash fans
- Tinted wrap around one piece windshield with privacy shade
- Side mount power mirrors with heat
- Reclining swivel "Faux Leather" captain's chairs
- 3-point, wall-mounted seat belts
- Sun visors
- 7" Backup monitor system with audio

LIVING AREA

- Sofa bed (N/A 3576)
- Hide-a-bed (N/A 3370)
- "Faux Leather" sofa (3370)
- Lambrequin window treatments
- Mini blinds throughout

- 26" Color LCD/TV with full-function remote with antenna, booster and co-ax connection
- Video package (DVD player and control center)

KITCHEN

- Refrigerator: flush-mount, double-door
- Refrigerator: raised panel hardwood front
- Microwave / convection oven with cooktop IPO oven (3370)
- Monitor panel with LPG readout
- Sink covers
- Solid-wood raised panel cabinet doors upper and lower
- Linoleum accented walk area
- Linoleum throughout
- Booth dinette (3270, 3575, 3576, 3578)
- U-Dinette (3370)
- Ball bearing drawer guides throughout

BEDROOM

- Upgrade innerspring mattress
- Bunk beds (3576)
- Bedspread and pillow shams with pillows
- 15" LCD color TV (3576)

BATHROOM

- Shower with surround
- Shower door
- Skylight in shower
- Power vent
- Foot flush porcelain toilet with sprayer
- Linoleum throughout bathroom

UTILITIES

- Air conditioners: 13,500-BTU ducted central (front and rear)
- Remote thermostatically controlled air conditioning
- Furnace: 30,000 BTU electronic ignition surface mount door (floor ducted)
- Water heater: 6-gallon gas with electronic ignition and surface mount door
- Water heater bypass kit
- Generator: Generac 5.0 kW Impact (30 amp service only)
- 60 amp converter
- Dual 6-volt auxiliary batteries
- Battery disconnect
- 30 amp/120 volt service
- Enclosed heated potable and holding tanks

- Black water tank flush
- Cable TV/satellite hookup inside storage area (all units)
- Pre-wired for roof-mounted satellite dish
- Exterior GFCI receptacle
- Carbon monoxide, propane gas and smoke detectors

OPTIONS

- Partial paint package
- Upgraded gel-coat wall
- Black framed dual-pane windows
- Exterior entertainment center with 26" LCD TV and speakers (most models)
- Reclining swivel Flexsteel "Faux Leather" captain's chairs
- "Faux Leather" sofa (3270, 3575, 3578)
- "Faux Leather" hide-a-bed (N/A 3370)
- Sofa bed IPO U-Dinette (3370)
- "Faux Leather" sofa IPO U-Dinette (3370)
- Day/night shades (except kitchen and at bunk beds)
- Refrigerator: large flush-mount, double-door
- Booth dinette (3370)
- Bunk/Dinette with children's activity center (3576)
- Extra Wardrobe IPO Bunk Beds (3576)
- 15" LCD color TV (3270, 3576)
- 19" LCD color TV (N/A 3270)
- Day/night shades
- Generator: Onan 5.5 kW Marquis Gold
- 50 amp/120 volt service (must choose Onan 5.5 generator)
- Exterior shower

YOUR LOCAL DAYBREAK DEALER:



Coach-Net rapid response SR RVIA Go RVing
Available on all 2009 Damon motorhomes



MORE DETAILS ONLINE Visit us online for more information about Damon products. Learn about each of Damon's Gas and Diesel Class-A models as well as the exciting new Avanti fuel-efficient clean diesel motorhome. You can take virtual tours, explore 360° viewable interiors, see additional features, and find more for less, at: **DAYBREAKRV.COM**



P.O. BOX 2888 • ELKHART, IN 46515 • CUSTOMER SERVICE: 800-860-3812 • SALES DEPARTMENT: 800-860-5658 • DAMONRV.COM

