



20' FLYING CLOUD TRAILER



FLYING CLOUD TRAILERS: 11 FLOORPLANS, 19' - 28'

When you're ready to take a break from the great outdoors, the Flying Cloud invites you inside with the flair of modern design. From fabrics to fixtures to cabinetry, the Flying Cloud line reflects your taste in clean, comfortable,

contemporary styling throughout. The rightsized travel trailer for any adventure, the Airstream Flying Cloud travel trailer combines light weight and ruggedness with total practicality. Innovative storage solutions and

▼ 20' Flying Cloud front to back view in Burnt Sienna interior



▲ 20' Flying Cloud galley

▲ 20' Flying Cloud bathroom

multi-function work spaces prevail throughout the living space, like underseat storage or the additional counter space available when the sink cover is in place.

Like all Airstream trailers, every inch of a Flying Cloud has a functional purpose, and not one of those inches was built for planned obsolescence. Count on the Airstream Flying Cloud to last far longer than its boxy competitors, all while enjoying less of an impact at the pump and better stability on the road.

So no matter if you're a first-time Airstreamer or seasoned veteran of the road, the Flying Cloud gets you on your way to your next adventure in contemporary style, luxurious comfort, and long-lasting value.



FLYING CLOUD TECHNICAL SPECIFICATIONS

	19	20	23	23FB	25FB	27FB	28
Exterior Length	19'2"	20'10"	23'	23'9"	25'11"	28'	27'11"
Width Exterior	8'	8'	8'	8'	8'-5.5"	8'5.5"	8'5.5"
Width Interior	7'7"	7'7"	7'7"	7'7"	8'1"	8'1"	8'1"
Height Exterior w/A/C	9'5"	9'5"	9'5"	9'5"	9'7"	9'7"	9'7"
Height Interior w/A/C	6'4.5"	6'4.5"	6'5"	6'5"	6'5"	6'5"	6'5"
Hitch Ball Height	17.75"	17.75"	17.75"	17.75"	17.75"	17.75"	17.75"
Hitch Weight w/o Options or Variable Weight	570	640	730	500	760	775	950
UBW (Unit Base Weight)	3,725	4,197	4,707	4,757	5,477	5,600	5,700
NCC (Net Carrying Capacity) w/o Options Fluids or Cargo	775	803	1,293	1,243	1,823	2,000	1,600
GVWR (Gross Vehicle Weight Rating)	4,500	5,000	6,000	6,000	7,300	7,600	7,300
Water Tank w/Drain Valve	23	23	30	39	39	39	39
Blackwater Tank (gal)	18	18	18	18	39	39	35
Graywater Tank (gal)	21	21	21	30	37	37	37
Water Heater (gal) w/Electronic Ignition	6	6	6	6	6	6	6
A/C w/Heat Pump & Electronic Controls	13,500	13,500	13,500	13,500	13,500	13,500	13,500
Furnace w/Electric Ignition (BTU)	16,000	18,000	18,000	18,000	25,000	25,000	30,000
LPG (lbs) (2-30# Steel Tanks)	60	60	60	60	60	60	60
Deep Cycle Group	2	2	2	2	2	2	2
Sleeping Capacity	4	4	5	4	4	4	5

DECORS
 STRATUS
 MIDNIGHT SUN
 BURNT SIENNA
 SEA GREEN

FLYING CLOUD FLOORPLANS

19' FLYING CLOUD BAMBI TRAILER

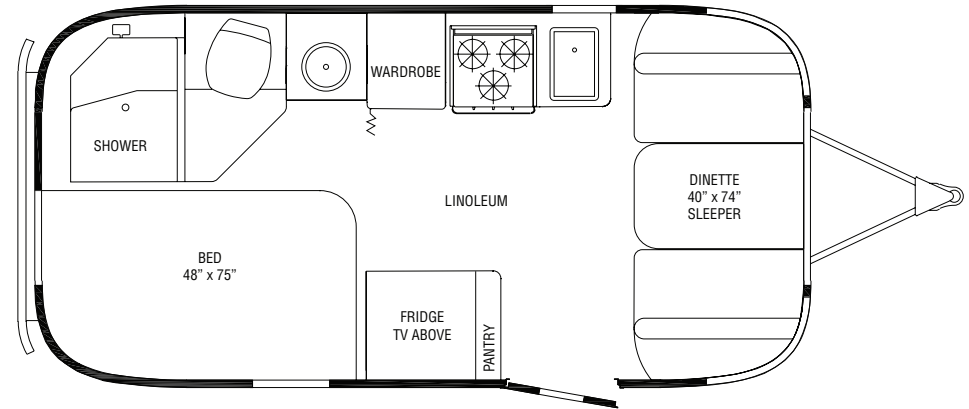

20' FLYING CLOUD TRAILER

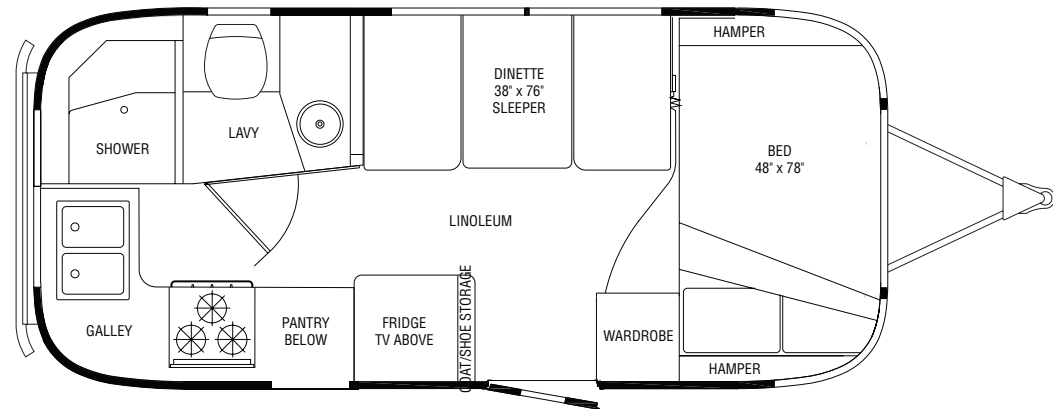

23' FB FLYING CLOUD TRAILER

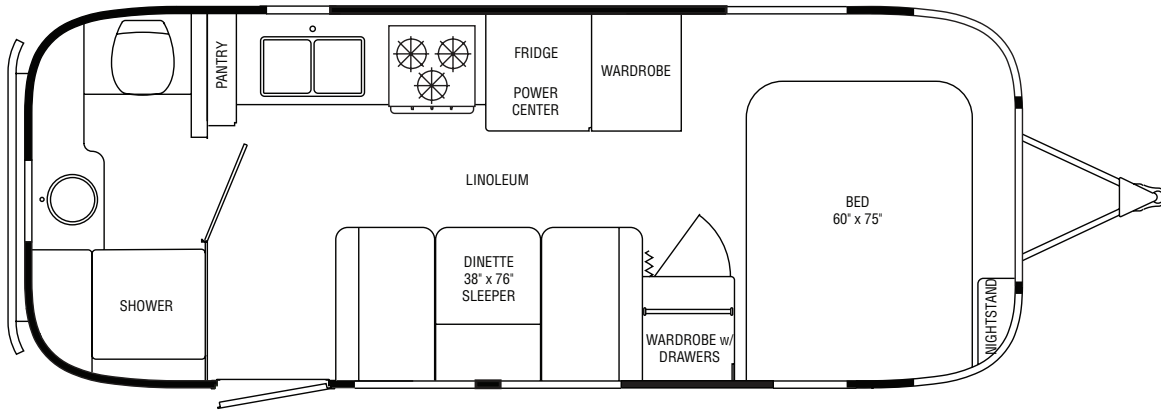

Please visit www.airstream.com to see a full set of model specifications, floorplans, features and options, and to find your nearest Airstream dealer.

23' FLYING CLOUD TRAILER

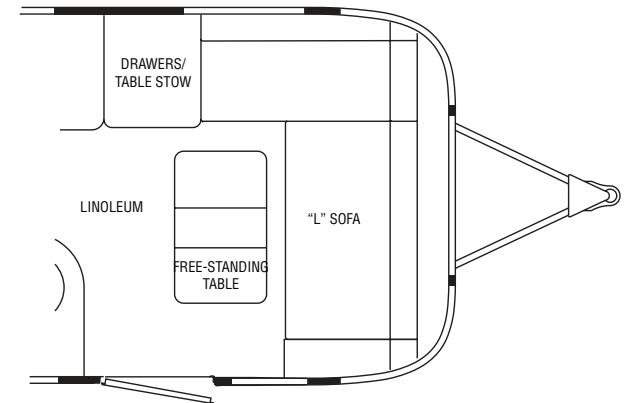
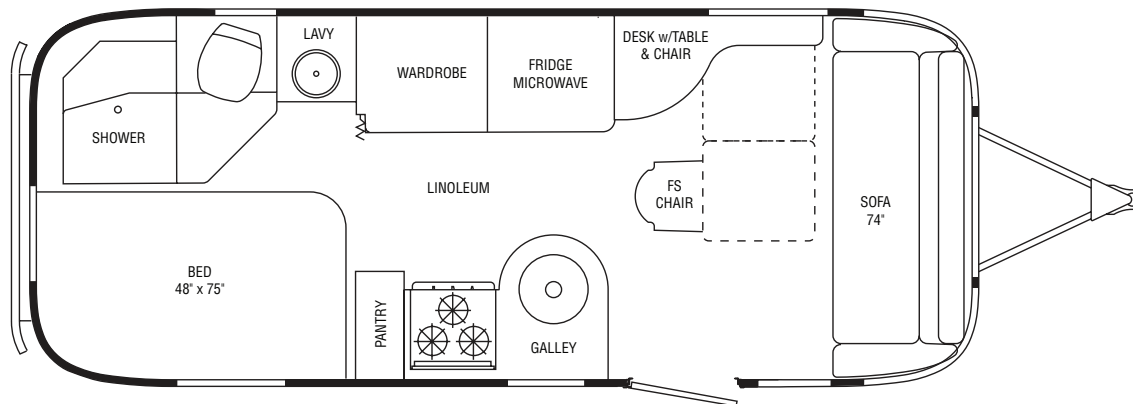

FLYING CLOUD FLOORPLANS (CONTINUED)

25' FB FLYING CLOUD TRAILER

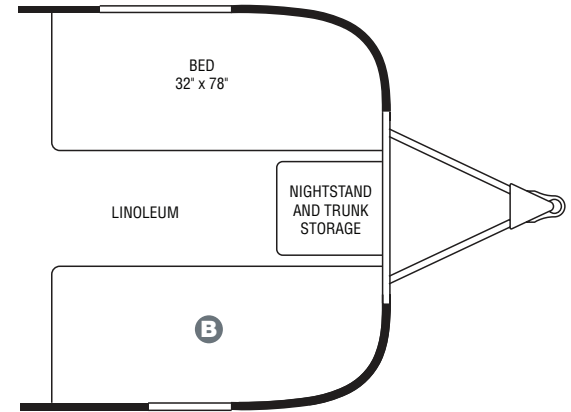
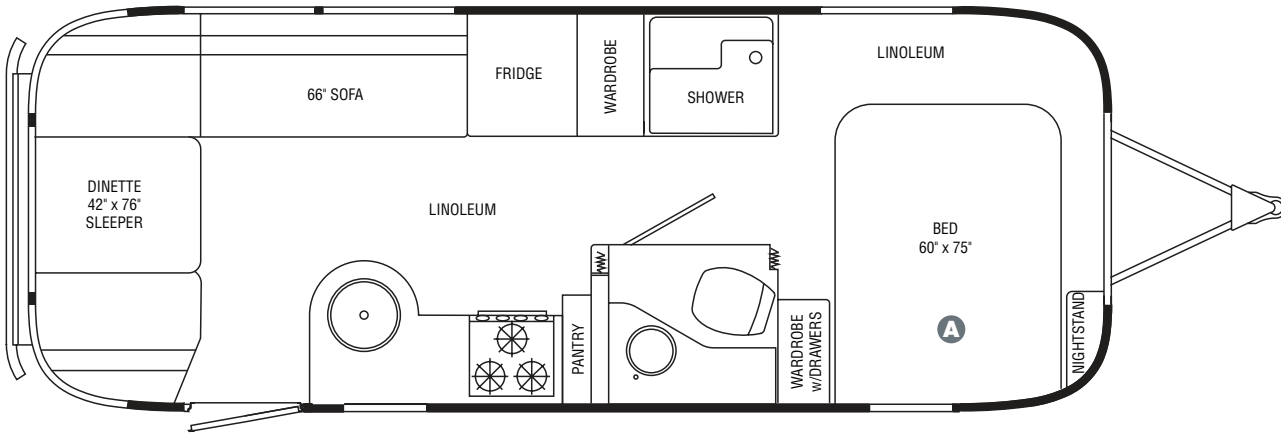

28' FLYING CLOUD TRAILER

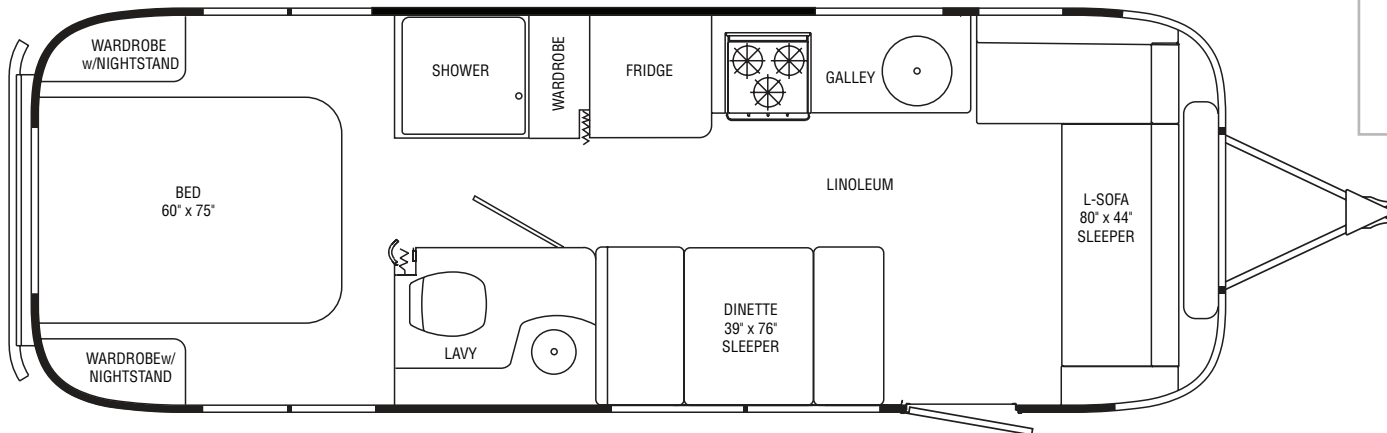

The 25' FB Flying Cloud offers two bedroom floorplan options:

- A** A queen size bed with wardrobe and nightstand
- B** Or two twin size beds with nightstand and trunk storage

27' FB FLYING CLOUD TRAILER

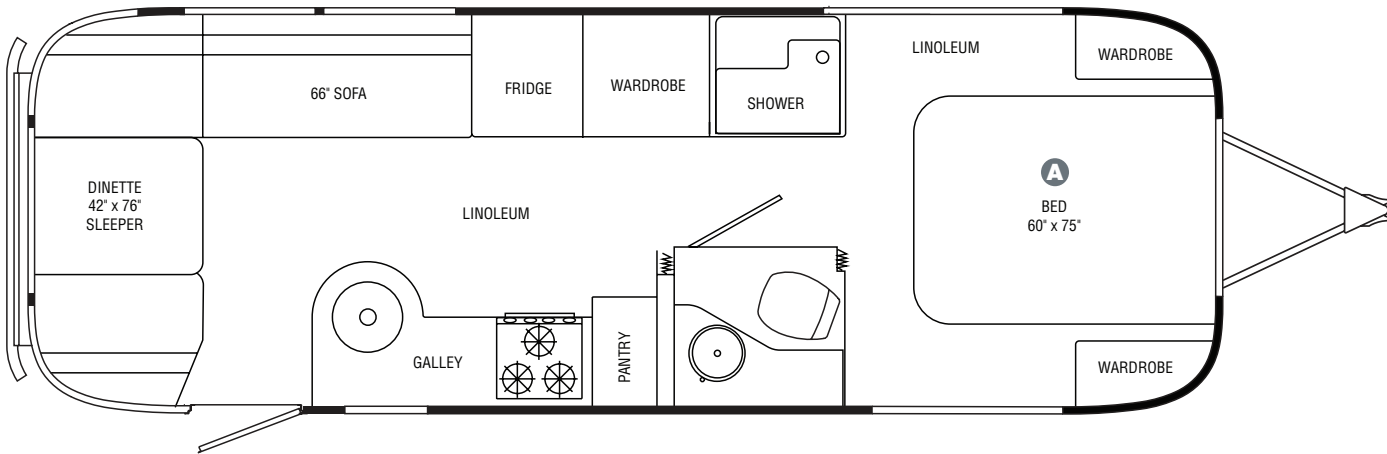

Please visit www.airstream.com to see a full set of model specifications, floorplans, features and options, and to find your nearest Airstream dealer.

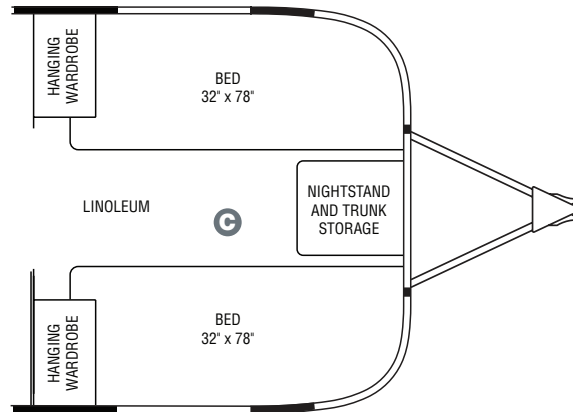
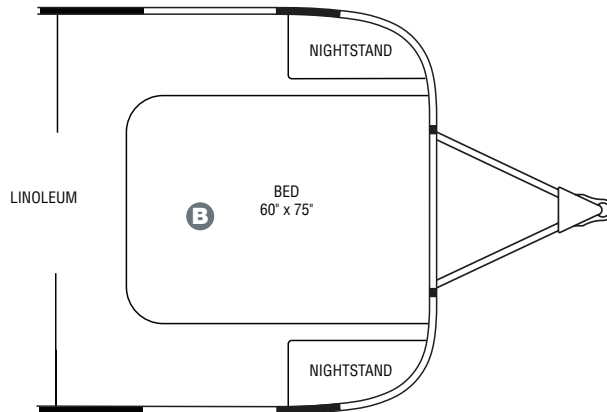

The 27' FB Flying Cloud offers three bedroom floorplan options:

- A** A queen size bed with two wardrobes
- B** A queen size bed with two nightstands, shown with optional panoramic windows
- C** Or two twin size beds with nightstand and trunk storage, shown with optional panoramic windows