

Augusta[®]
2009



HOLIDAY RAMBLER[®]

This is Living[®]



Augusta



Augusta[®]
2009

THE SPICE OF LIFE

Augusta embodies Holiday Rambler's legacy of universal appeal — tempting couples looking for a weekend escape or families looking to spend their next vacation in comfort and style. Augusta comes to you as three distinct offerings, the Augusta B-Plus, the Augusta Touring Sedan and the Augusta Sport. No matter which model you choose, you'll discover a variety of features, like a skylight and fixtures adorned with a cool brushed nickel finish. With three different models, two solid chassis you can depend on (Ford or Chevy) and a host of options like full body paint and heated power mirrors to choose from, Augusta brings both variety and spice to life. (Augusta B-Plus 293TS pictured.)







Augusta[®]
2009



WHERE LIVEABILITY AND DRIVEABILITY MEET.

From the driver's seat, gauges are easy to read and switches and buttons are easy to reach while the optional wood grain treatment adds a touch of warmth to the dash. Above the cockpit, a 26-inch LCD TV provides you with primetime entertainment anytime. This is where liveability and driveability meet.

213

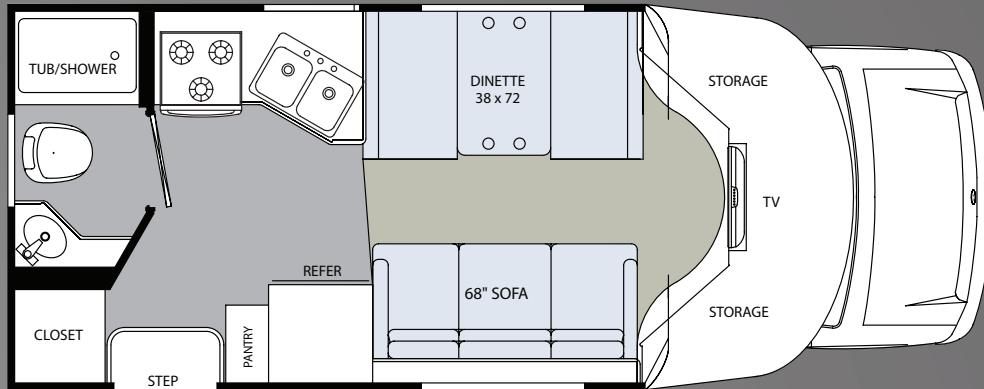

2355

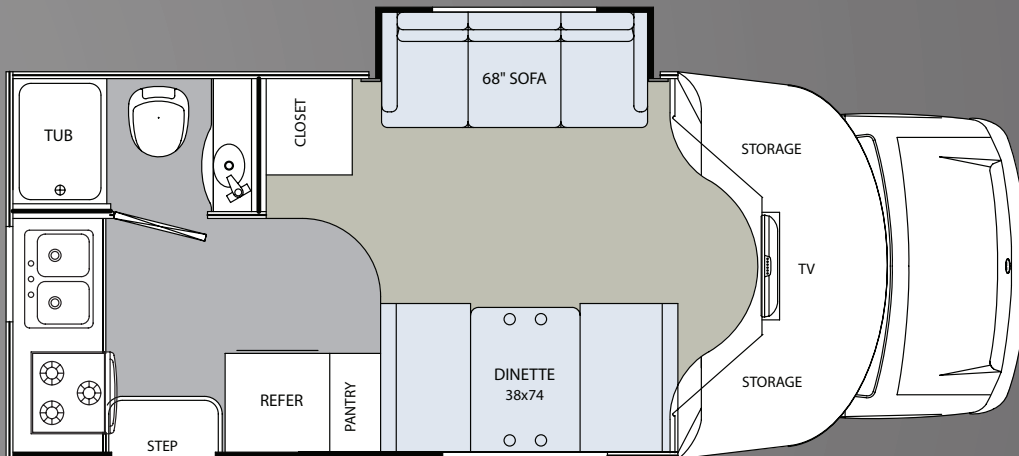

■ CARPET | ■ LINOLEUM

H O L I D A Y R A M B L E R . C O M

Log on to our website anytime, night or day. It's your link to everything Holiday Rambler, including product news and updates, club events, dealer and service center info and much more. Take it for a test drive today.





252DS

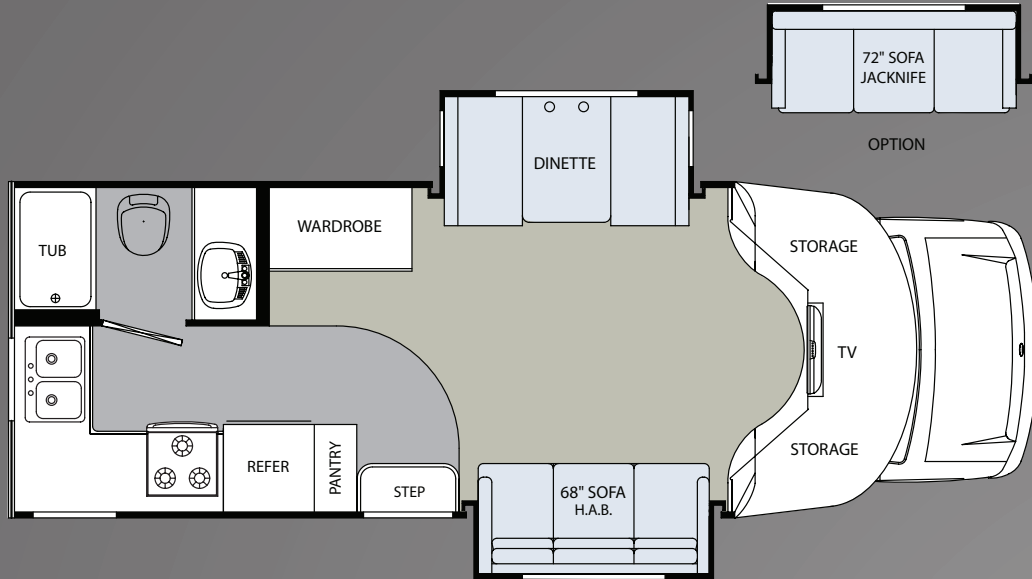

282

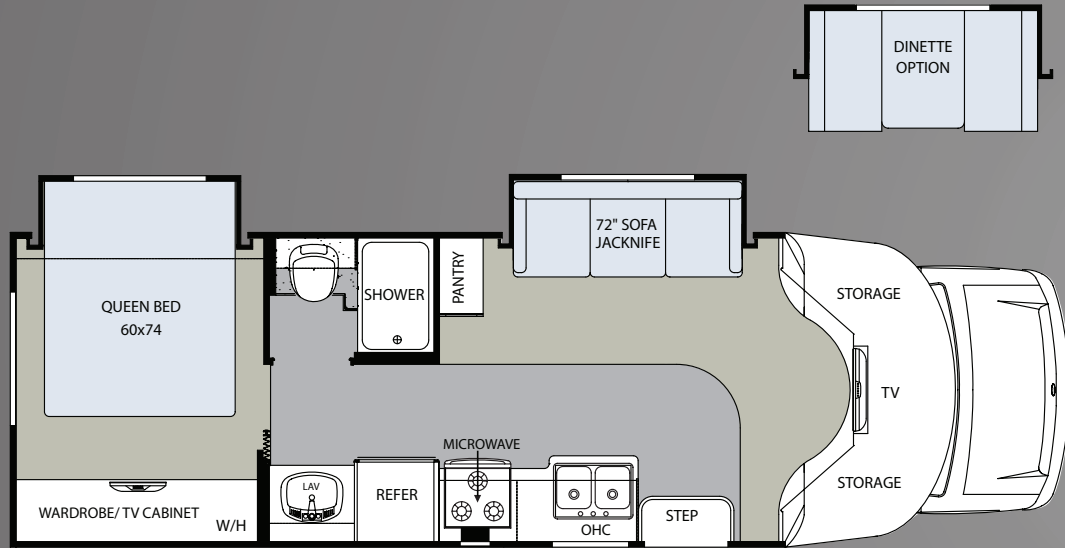

293TS

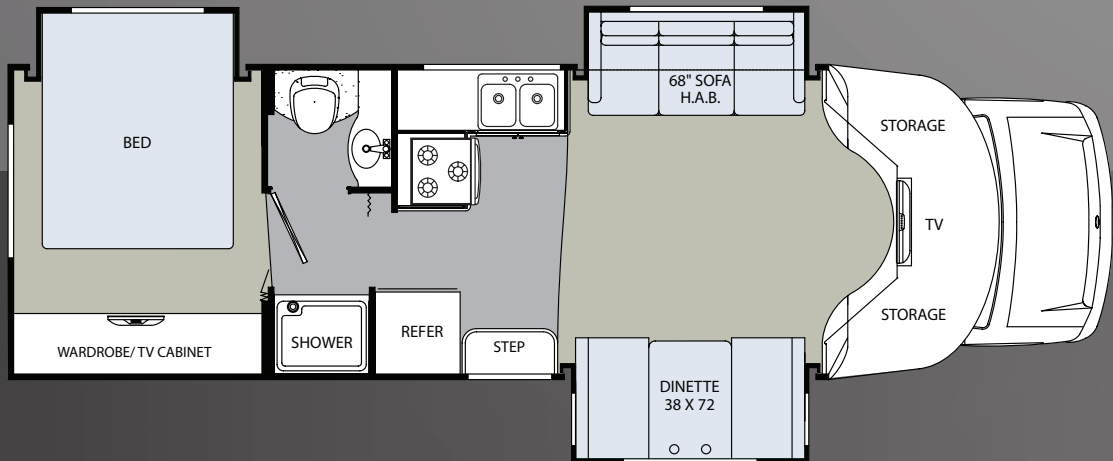

210 (AUGUSTA SPORT)

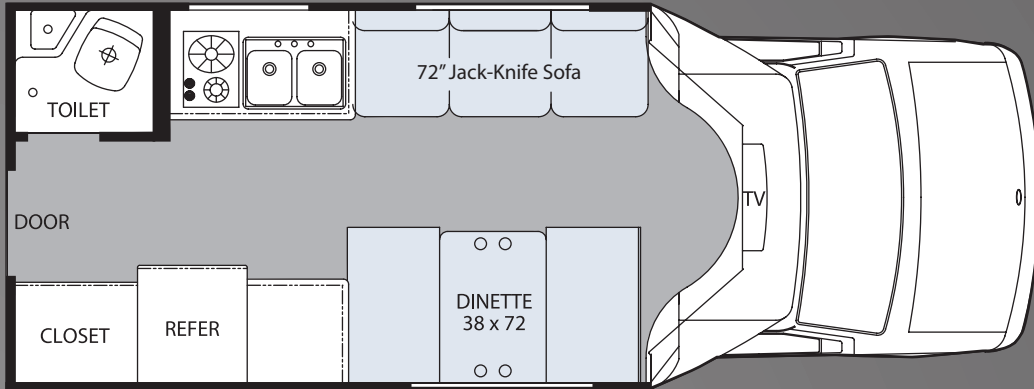

REPLACES PASSENGER SIDE SOFA



OPTION A - SOFA

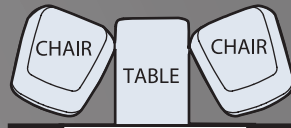

OPTION B - BARREL CHAIRS

210TS (AUGUSTA TOURING SEDAN)

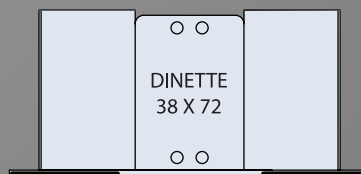
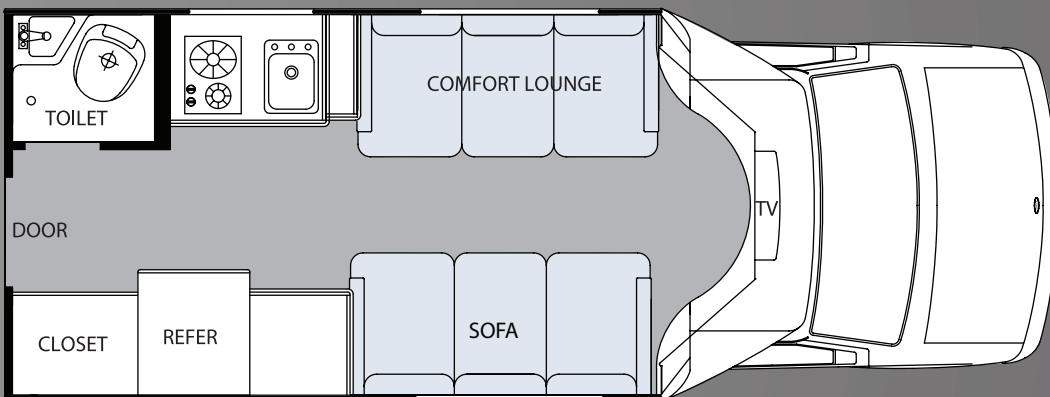

OPTION A - DINETTE

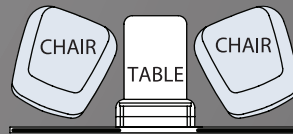

OPTION B - BARREL CHAIRS

■ CARPET | □ LINOLEUM



WE'RE HERE. ANYTIME, EVERY TIME.

- Reach us anytime — literally — via our live customer support line.
- Drive in to one of our 350 Service Centers.
- Enjoy the first year free when you enroll in our Owner Advantage Roadside Assistance Program.
- See where it all begins with a tour of our facility in Oregon. Call 1-800-634-0855 to find out more.



WEIGHTS AND MEASUREMENTS

	213	235S	252DS	282	293TS
Weights – Ford	6.8L	6.8L	6.8L	6.8L	6.8L
Gross Vehicle Weight Rating	11,500	11,500	14,500	14,500	14,500
Gross Combined Weight Rating*	18,500	18,500	20,000	20,000	20,000
Front Gross Axle Weight Rating	4,600	4,600	5,000	5,000	5,000
Rear Gross Axle Weight Rating	7,800	7,800	9,500	9,500	9,500
Weights – Chevy	6.0L	6.0L	6.0L	6.0L	6.0L
Gross Vehicle Weight Rating	12,300	12,300	14,050	14,050	14,050
Gross Combined Weight Rating**	16,000	16,000	17,600	17,600	17,600
Front Gross Axle Weight Rating	4,600	4,600	4,600	4,600	4,600
Rear Gross Axle Weight Rating	8,300	8,300	9,450	9,450	9,450
Measurements					
Wheelbase - Ford	138"	158"	194"	191"	198"
Wheelbase - Chevy	139"	159"	195"	192"	199"
Overall Length, Without Ladder & Spare Tire - Ford	21' 11"	22' 7"	26' 2"	28' 1"	29' 3"
Overall Length, Without Ladder & Spare Tire - Chevy	22' 10"	23' 6"	26' 8"	28' 7"	30' 2"
Overall Height, Including A/C	10' 8"	10' 8"	10' 8"	10' 8"	10' 8"
Interior Height	82"	82"	82"	82"	82"
Interior Width	95.5"	95.5"	95.5"	95.5"	95.5"
Exterior Width	99"	99"	99"	99"	99"
Tank Capacities					
Water Heater (gal.)	6	6	6	6	6
Grey Tank (gal.)	32	32	32	32	32
Black Tank (gal.)	32	27	27	27	27
Fresh Tank (gal.)	35	35	35	35	34
LP Tank (lb. / gal)	42 / 9.8	42 / 9.8	42 / 9.8	42 / 9.8	42 / 9.8
Fuel - Chevy / Ford (gal.)	35 / 37	35 / 37	57 / 55	57 / 55	57 / 55

AUGUSTA SPORT® AND AUGUSTA TOURING SEDAN® WEIGHTS AND MEASUREMENTS

	210		210
Weights – FORD		Weights – CHEVY	
Gross Vehicle Weight Rating	11,500	Gross Vehicle Weight Rating	12,300
Gross Combined Weight Rating***	18,500	Gross Combined Weight Rating***	16,000
Front Gross Axle Weight Rating	4,600	Front Gross Axle Weight Rating	4,600
Rear Gross Axle Weight Rating	7,800	Rear Gross Axle Weight Rating	8,300
Measurements		Tank Capacities	
Wheelbase - Ford	138"	Water Heater (gal.)	6
Wheelbase - Chevy	139"	Grey Tank (gal.)	23
Overall Length, Without Ladder & Spare Tire - Ford	21' 11"	Black Tank (gal.)	23
Overall Length, Without Ladder & Spare Tire - Chevy	22' 10"	Fresh Tank (gal.)	34
Overall Height, Including A/C	10' 8"	LP Tank (lb. / gal)	41 / 9.8
Interior Height	76"	Fuel - Ford / Chevy (gal.)	35 / 37
Interior Width	91"		
Exterior Width	94"		

* Towing capacity is limited by GCWR; your vehicle's towing capacity is the difference between the GCWR and the actual vehicle weight, including all water, fuel, passengers and cargo. Your towed vehicle should be equipped with auxiliary brakes if the weight of the towed vehicle exceeds 1,000 lbs. Consult your owner's manual for further towing information.

** All tank capacities are estimated based upon calculations provided by the tank manufacturers and represent approximate capacities. The actual "usable capacity" may be greater or less than the estimated capacities based upon fabrication and installation of the tanks.

*** Actual filled LP capacity is 80% of listing due to safety shut-off required on tank.

The actual overall length of the recreational vehicle may differ from that indicated in the brochure due to variances in the manufacturing process and/or installed components. The actual length may be greater or less than that indicated. Due to the large variety of options and floorplan arrangements available to our customers, actual weights for each unit can differ significantly. Holiday Rambler provides a weight sticker on each unit we produce which includes that unit's tank capacities and approximate weight. Consult your local Holiday Rambler dealer for unit availability and further information. The information printed in this brochure reflects product design, fabrication, and component parts at the date of printing. The manufacturer reserves the right, at any time, to make changes in product design or material or component specifications as its sole option, without notice. This includes the substitution of components of a different brand or trade name which will result in comparable performance. All information printed in this brochure is subject to change after the date of printing. Some features shown or mentioned in this brochure are optional and may only be available in selected floorplans. Photographs may show props or decorations that are not standard equipment on Holiday Rambler models. Holiday Rambler, the Holiday Rambler logo and its design, are registered trademarks. All other products and company names are trademarks and/or registered trademarks of their respective holders. While the color of the motorhome's exterior and the interior fabrics depicted in this sales brochure are fair and reasonable depictions, the colors depicted may not be an exact match of the actual colors because of the variances in photo-processing and variances caused by inserting the photographs within the sales brochure. Due to product improvements, changes during the model year and/or transcription errors that may occur, information represented within this brochure may not be accurate at the time of your purchase. If certain information is significant to your purchasing decision, please confirm the information with your dealer prior to submitting your order. Component part and appliance manufacturers issue limited warranties covering those portions of the recreational vehicle not covered by the Limited Warranties issued by Monaco Coach Corporation. To learn which specific component parts and appliances are excluded from the Limited Warranties issued by Monaco Coach Corporation, please contact your selling dealership or Monaco Coach Corporation directly, or review the warranty packet inside the recreational vehicle.

Augusta B-Plus®

2009



AUGUSTA B-PLUS STANDARDS

BODY CONSTRUCTION

- Fully Welded Tubular Aluminum Roof and Sidewall Construction
- Fully Laminated Roof, Walls and Floors w/ High-Density Block Foam Insulation
- One Piece TPO Roof
- One-Piece Fiberglass Rear Wall Surround with New Tail Lights
- Smooth White .070 Filon Plus Fiberglass Sidelwalls
- Aerodynamic Front Fiberglass Cap
- Exterior Storage Compartments
- Integrated Rear Bumper
- Locking Exterior Storage Doors
- Integrated Manual Entrance Step
- Rear Wheel Mud Flaps
- Slide-Out Battery Tray
- Automotive Step Well

FORD CHASSIS / ENGINE (GAS) / SUSPENSION

- Ford E350 Chassis (213, 235S)
- Ford E450 Chassis (252DS, 282, 293TS)
- 6.8L Triton® V-10 Gasoline Engine with Sequential Electronic Fuel Injection (SEFI), 305 HP @ 4,250 RPM / 420 lb.-ft. Torque @ 3250 RPM
- 5-Speed TorqShift® Automatic Transmission with Overdrive; In-tank Oil Cooler
- 115 Amp Alternator - Gas Engine
- Rear Axle Ratio 4.10:1 (E350 Chassis) (213, 235S)
- Rear Axle Ratio 4.56:1 (E450 Chassis) (252DS, 282, 293TS)
- Radial Tires
- Stainless Steel Wheel Covers
- Hellwig® Helper Springs (293TS)
- Rear Multi-Leaf Spring Suspension with Stabilizer Bar
- ABS Brake System
- One 12V Chassis Battery
- Emergency Start Circuit

FORD CHASSIS / ENGINE (DIESEL) / SUSPENSION

- 6.0L Power Stroke® V* Turbo Diesel, Direct Injection 235 HP @ 3,150 RPM / 440 lb.-ft. Torque @ 2,000 RPM Power Pilot Seat (252DS, 282, 293TS)
- 100 Amp Alternator - Diesel Engine (252DS, 282, 293TS)
- Rear Axle Ratio 4.10:1 (E450 Diesel Chassis) (252DS, 282, 293TS)

CHEVY CHASSIS / ENGINE (GAS) / SUSPENSION

- Vortec 6.0L V8 Sequential Fuel Injection (SFI), 300 HP @ 4,400 RPM, 360 lb.-ft. Torque @ 4,000 RPM
- 4-Speed Automatic, Heavy Duty Transmission, Electronically Controlled with Overdrive; Internal Transmission Oil Cooler
- 145 Amp Alternator
- Rear Axle Ratio 4.10:1
- Radial Tires
- Stainless Steel Wheel Covers
- Hellwig® Helper Springs (293TS)
- Rear Multi-Leaf Spring Suspension with Stabilizer Bar
- ABS Brake System
- One 12V Chassis Battery
- Emergency Start Circuit

COCKPIT

- Big Button AM / FM / Cassette / CD Radio, SIRIUS® Satellite Ready
- Dual Air Bags
- Multi-Positioned Sun Visors
- Reclining Captain's Chairs

APPLIANCES AND ACCESSORIES

- Flush-Mount, Single -Door Refrigerator
- 3-Burner Range Top
- Lighted Power Range Hood
- 26" LCD Color TV w/ Antenna Hookup in Cabover
- Satellite Dish Prep

INTERIOR

- Newport Cherry II Cabinetry
- Pedestal Dinette Table
- Fabric Covered Dinette Back, Side & Top
- Large Double Bowl Stainless Steel Kitchen Sink with Faucet
- Single Lever Satin Nickel Lavatory Faucet
- Laminate Countertops with Wood Edge - Kitchen & Dinette
- Sofa Table with Pedestal Legs (282)
- Pantry with Adjustable Shelves (N/A 293TS)
- Mini Blinds Throughout with Decorative Box Valances
- Bedsread, Pillows and Pillow Shams (282, 293TS)
- Carpet with Padding
- Windshield Privacy Curtain
- Hardware with Brushed Nickel Finish
- Soft-Touch Vinyl Ceiling

- Medicine Cabinet w/ Mirror (Bathroom)
- Residential Linoleum in Bath, Galley & Entryway

FURNITURE

- Queen Bed (282, 293TS)
- Sofa Table with Pedestal Legs (282)
- Booth Dinette (N/A 282)
- Plush Sofa with Residential Style Arms (N/A 252DS, 293TS)
- Fabric Hide-a-Bed Sofa (252DS, 293TS)

ELECTRICAL SYSTEMS AND LIGHTS

- 30 Amp 120V Distribution Panel
- Shore Line Power Cord
- Solid State 55 Amp 12V Power Converter
- Battery Disconnect Switch
- 12 V Auxiliary Battery
- Generator Prep
- Porch Light

PLUMBING AND LP SYSTEMS

- 6 Gallon Gas Water Heater
- 12V Water Pump
- City Water Hook-up
- Water Heater By-Pass Valve
- Tub/Shower with Curtain (213, 235S, 252DS)
- Tub/Shower with Surround & Glass Shower Door (282)
- Shower with Surround & Glass Door (293TS)

HEATING, VENTS AND AIR CONDITIONING

- Pre-Wire for Ducted A/C
- 12V Power Roof Vent

WINDOWS, DOORS AND AWNINGS

- White Trimmed Entrance Door
- Large Assist Grab Handle
- Radius Corner Slider Windows
- Skylight in Bathroom
- Topper Slide-Out Awnings (N/A 213)

SAFETY

- Fire Extinguisher
- Deadbolt Lock on Entrance Door
- GFI Protected Circuit, Exterior
- LP Gas Detector
- Smoke Detector
- Carbon Monoxide Detector
- 'Command Central' Systems Monitor / Switch Panel
- Pilot and Co-Pilot Three-Point Seat Belts

AUGUSTA B-PLUS OPTIONS

BODY CONSTRUCTION

- Rear Ladder
- Heated Power Mirrors
- Automatic Electric Entrance Step, Side Entrance Only
- Fiberglass Running Boards
- High-Gloss Gel-Coat fiberglass
- Trailer Hitch with Wire
- Lower Paint Package
- Full Body Paint Colors: Black Cherry, Champagne & Majestic Blue
- Touring Package (Includes Front Spoiler, Chrome Wheels, Fog Lights, Carbon Fiber Dash/Steering Wheel and Drink Tray)
- XL Package (Main Metal Wrap Awning IPO Option, Main or Box Awning, High Gloss Gel-Coat Fiberglass and Paint Protection)

FORD & CHEVY CHASSIS/ENGINE/SUSPENSION

- Hellwig® Helper Springs (N/A 282)
- 5000 lb. Hitch Receiver w/ Dual Connector 4-Pin or 7-Pin
- Spare Tire with Continental Tire Cover
- Canadian RV Certification
- Transport Canada MVSr (Also Requires RIVA)
- RVIA
- Stainless Steel Wheel Inserts

COCKPIT

- Big Button AM / FM / Cassette / CD Radio, SIRIUS® Satellite

- Ready, w/LCD Dash Mounted Back-up Monitor
- Woodgrain Dash Treatment, N/A w/Touring Package Selection
- Value Package (Includes Leatherette Driver/Passenger Seats, Sofa, TV Antenna, Hitch & Wire, Gas/Electric Water Heater, Half-Time Microwave, Day/Night Shades)

APPLIANCES AND ACCESSORIES

- Large Double-Door Refrigerator
- 3-Burner Range w/Oven
- Half-Time Microwave Oven
- Folding Range Cover (Black range cover N/A with Deluxe Décor Package)
- Stainless Steel Folding Range Cover (Available w/ Deluxe Décor Package Only)
- Sink Covers (2)
- 19" LCD Color TV - Bedroom (282, 293TS)
- Home Theater Surround Sound System w/ 5 Omni-Directional Speakers and Sub-Woofers
- TV Antenna / Booster / Jack, Cable Ready
- Telephone Jack
- Exterior Entertainment Center, CD Player Radio with Two Speakers (N/A 235S)

INTERIOR

- Decors: Honeycomb II, Tabasco & Timber Ridge (N/A w/ Deluxe Décor Package)
- Deluxe Décor Package Brass Ring (Solid Surface Countertops, Upgrade on Carpet, Linoleum, Faucets, Porcelain Toilet, Stainless Steel Appliances & Select Comfort

- Mattress
- Day / Night Shades
- Black High Gloss Plexi-Glass Refrigerator Front
- Raised Panel Refrigerator Front

FURNITURE

- Booth Dinette (282 Only)

ELECTRICAL SYSTEMS AND LIGHTS

- Onan 4.0 Kw Micro-Lite Generator w/ Auto Changeover
- Onan 3.6 Kw Micro-Lite Generator w/ Auto Changeover LP for Diesel (N/A 213, 235S)

PLUMBING AND LP SYSTEMS

- 6 Gallon Gas / Electric Water Heater with DSI
- Tub / Shower or Shower w/ ABS Surround (N/A 282, 293TS)

HEATING, VENTS AND AIR CONDITIONING

- 13,500 BTU Air Conditioner
- 15,000 BTU Air Conditioner
- Heat Pads for Holding Tanks
- Fantastic Fan
- Fantastic Fan w/ Rain Sensor

WINDOWS, DOORS AND AWNINGS

- Main Patio Awning (N/A 252DS, 293TS)
- Box Awning (252DS, 293TS)
- Dual Pane Windows



Augusta Sport[®]

2009

AUGUSTA SPORT STANDARDS

BODY CONSTRUCTION

- Aerodynamic Curved Wall Construction
- Laminated One Piece TPO Crowned Roof
- Aerodynamic Front Fiberglass Cap
- Smooth White .070 Filon Plus Fiberglass Sidewalls
- Large Storage Compartment
- Locking Exterior Storage Doors
- Deluxe Exterior Mirrors
- Integrated Manual Entrance Step
- Rear Wheel Mud Flaps
- Undercoating

FORD CHASSIS / ENGINE (GAS) / SUSPENSION

- Ford E350 Chassis
- 6.8L Triton[®] V-10 Gasoline Engine with Sequential Electronic Fuel Injection (SEFI), 305 HP @ 4,250 RPM / 420 lb. - ft. Torque @ 3,250 RPM
- 5-Speed TorqShift[®] Automatic Transmission with Overdrive; In-tank Oil Cooler
- 115 Amp Alternator - Gas Engine
- Rear Axle Ratio 4.10:1
- Radial Tires
- Stainless Steel Wheel Covers
- Rear Multi-Leaf Spring Suspension with Stabilizer Bar
- ABS Brake System
- Dash Heating and Air Conditioner System with Defroster
- One 12V Chassis Battery
- Emergency Start Circuit

CHEVY CHASSIS / ENGINE / SUSPENSION

- Vortec 6.0L V8 Sequential Fuel Injection (SFI), 300 HP @ 4,400 RPM, 360 lb. - ft. Torque @ 4,000 RPM
- 4-Speed Automatic, Heavy Duty Transmission, Electronically Controlled with Overdrive; Internal Transmission Oil Cooler
- 145 Amp Alternator
- Rear Axle Ratio 4.10:1
- Radial Tires
- Stainless Steel Wheel Covers
- Rear Multi-Leaf Spring Suspension with Stabilizer Bar
- ABS Brake System

- Dash Heating and Air Conditioner System w/ Defroster
- One 12V Chassis Battery
- Emergency Start Circuit

COCKPIT

- Dual Air Bags
- AM / FM / CD Radio
- Multi-Positioned Sun Visors
- Power Door Locks and Windows
- Factory Air Conditioning, Cruise Control and Tilt Steering Wheel
- Intermittent Windshield Wipers
- Map Light
- Reclining Captain's Chairs

APPLIANCES AND ACCESSORIES

- Flush-Mount, Single-Door Refrigerator
- 2-Burner Range Top

INTERIOR

- Newport Cherry II Cabinetry
- Comfort Lounge & Dinette
- Fabric Covered Dinette Back & Arched Top
- Large Double Bowl Stainless Steel Kitchen Sink w/ Gooseneck Faucet
- Satin Nickel Lavatory Faucet
- Laminated Countertops with Wood Grain Edging - Kitchen
- Laminated Dinette Table with Wood Grain Edging - Dinette
- Mortise & Tenon Overhead Cabinet Doors (Galley & Living Area)
- Heavy Duty Drawer Guides
- Mini Blinds Throughout with Decorative Fabric Covered Box Valances
- Windshield Privacy Curtain
- Hardware with Brushed Nickel Finish
- Vinyl Ceiling
- Spacious Wardrobe with Two Drawers
- Residential Linoleum Throughout

FURNITURE

- Plush Sofa with Arms

ELECTRICAL SYSTEMS AND LIGHTS

- 30 Amp 120V Distribution Panel
- Shore Line Power Cord
- Solid State 55 Amp 12V Power Converter
- Battery Disconnect Switch
- Command Central - Systems Monitor / Switch Panel
- 12 V Auxiliary Battery
- Generator Prep
- Porch Light - 2

PLUMBING AND LP SYSTEMS

- 6 Gallon Gas Water Heater
- 12V Water Pump
- City Water Hook-up
- Water Heater By-Pass Valve
- Shower with Curtain
- Shower Surround

HEATING, VENTS AND AIR CONDITIONING

- Pre-Wire for Ducted A/C
- 12V Power Roof Vent
- Furnace BTU's

WINDOWS, DOORS AND AWNINGS

- White Radius Entrance Door in Rear
- Exterior Grab Handle
- Radius Corner Slider Windows
- Skylight in Bathroom

SAFETY

- Fire Extinguisher
- Deadbolt Lock on Entrance Door
- GFI Protected Circuit, Exterior
- LP Gas Detector
- Smoke Detector
- Carbon Monoxide Detector
- Pilot and Co-Pilot Three-Point Seat Belts

AUGUSTA SPORT OPTIONS

BODY CONSTRUCTION

- Heated Power Mirrors
- Aluminum Running Boards
- 5,000 lb. Hitch Receiver w/Dual Connector 4-Pin or 7-Pin

FORD & CHEVY CHASSIS / ENGINE (GAS) / SUSPENSION

- Hellwig[®] Helper Springs
- Spare Tire with Vinyl Tire Cover
- Canadian RV Certification
- Transport Canada MVSR (Also Requires RIVA)
- Stainless Steel Wheel Inserts

COCKPIT

- Big Button AM / FM / Cassette / CD Radio, SIRIUS[®] Satellite Ready

- Big Button AM / FM / Cassette / CD Radio, SIRIUS[®] Satellite Ready, w/LCD Dash Mounted Back-up Monitor
- Throw-In Cab Mat with Matching Runner

APPLIANCES AND ACCESSORIES

- Large Double-Door Refrigerator
- Microwave Oven
- Sink Covers (2)
- 19" LCD TV
- TV Antenna / Booster / Jack, Cable Ready
- DVD Video Package

INTERIOR

- Decors: Honeycomb II, Tabasco & Timber Ridge
- Day / Night Shades
- Black High Gloss Plexi-Glass Refrigerator Front

FURNITURE

- 2 Barrel Chairs IPO Dinette
- Jackknife Sofa IPO Dinette

ELECTRICAL SYSTEMS AND LIGHTS

- 4.0 Kw Generator

PLUMBING AND LP SYSTEMS

- 6 Gallon Gas / Electric Water Heater with DSI

HEATING, VENTS AND AIR CONDITIONING

- 13,500 BTU High-Profile Air Conditioner
- Heat Pads for Holding Tanks

WINDOWS, DOORS AND AWNINGS

- Patio Awning

Augusta Touring Sedan®

2009



AUGUSTA TOURING SEDAN® STANDARDS

BODY CONSTRUCTION

- Aerodynamic Curved Wall Construction
- Aerodynamic Front Fiberglass Cap
- One Piece Rear Fiberglass Cap
- Laminated One Piece TPO Crowned Roof
- Gel-Coat Fiberglass Sidewalls
- Large Storage Compartments
- Locking Exterior Storage Doors
- Deluxe Heated Remote Breakaway Exterior Mirrors
- Integrated Manual Entrance Step
- Slide-Out Battery Tray
- Rear Wheel Mud Flaps
- Fiberglass Running Boards
- Diamond Shield® Paint Protection
- Full Body Paint (Black Cherry, Champagne & Majestic Blue)
- Front Air Dam w/ Fog Lights
- Hitch and Wire

FORD CHASSIS / ENGINE (GAS) /

SUSPENSION

- Ford E350 Chassis
- 6.8L Triton® V-10 Gasoline Engine with Sequential Electronic Fuel Injection (SEFI), 305 HP @ 4,250 RPM / 420 lb. - ft. Torque @ 3,250 RPM
- 5-Speed TorqShift® Automatic Transmission with Overdrive; In-Tank Oil Cooler
- 115 Amp Alternator - Gas Engine
- Rear Axle Ratio 4.10:1
- Radial Tires
- Stainless Steel Wheel Inserts
- Rear Multi-Leaf Spring Suspension with Stabilizer Bar
- ABS Brake System
- 5,000 lb. Hitch Receiver with Dual Connector 4-Pin or 7-Pin
- Dash Heating and Air Conditioner System with Defroster
- Spare Tire with Continental Tire Cover
- One 12V Chassis Battery
- Emergency Start Circuit

CHEVY CHASSIS / ENGINE / SUSPENSION

- Vortec 6.0L V8 Sequential Fuel Injection (SFI), 300 HP @ 4,400 RPM, 360 lb. - ft. Torque @ 4,000 RPM
- 4-Speed Automatic, Heavy Duty Transmission, Electronically Controlled with Overdrive; Internal Transmission Oil Cooler
- 145 Amp Alternator
- Rear Axle Ratio 4.10:1
- Radial Tires
- Stainless Steel Wheel Inserts
- Rear Multi-Leaf Spring Suspension with Stabilizer Bar
- ABS Brake System

- 5,000 lb. Hitch Receiver with Dual Connector 4-Pin or 7-Pin
- Dash Heating and Air Conditioner System with Defroster
- Spare Tire with Continental Tire Cover
- One 12V Chassis Battery
- Emergency Start Circuit

COCKPIT

- Dual Air Bags
- Big Button AM / FM / Cassette / CD Radio, SIRIUS® Satellite Ready
- Carbon Fiber Instrument Panel and Drink Tray
- Carbon Fiber / Leather Wrapped Steering Wheel (Ford Only)
- Color Coordinated Driver / Passenger Floor Mats w/ Throw Rug
- Multi-Positioned Sun Visors
- Power Windows and Door Locks
- Factory Air Conditioning, Cruise Control and Tilt Steering Wheel
- Intermittent Windshield Wipers
- Map Light
- Reclining Driver / Passenger Seats w/ Leather Inserts

APPLIANCES AND ACCESSORIES

- Flush-Mount, Single -Door Refrigerator
- Black High Gloss Plexi-Glass Refrigerator Front
- Ice Chest
- Microwave Oven
- 19" LCD TV
- TV Antenna / Booster / Jack, Cable Ready
- Surround Sound Home Theater Package
- Exterior Entertainment Center
- 2-Burner Range Top

INTERIOR

- Integrated Solid Surface Kitchen Sink
- Residential Style Sink Faucet w/ Pull-Out Sprayer
- Solid Surface Countertop - Kitchen
- Solid Surface Sink and Stove Covers
- Pull-Out Waste Basket and Two Wire Baskets
- Aircraft Style Cabinets
- Hidden Cabinet Door Hinges
- Whisper-Latch™ Cabinet Door Hardware
- Heavy Duty Drawer Guides
- Automotive Carpet Throughout
- Day / Night Shades with Decorative Box Valances
- Windshield Privacy Curtain
- Hardware with Brushed Nickel Finish
- Soft-Touch Vinyl Ceiling
- Stain Resistant Carpeting
- Decorative Mirror

FURNITURE

- Leather / Vinyl Comfort Lounge
- Fabric Jackknife Sofa w/ Throw Pillows

ELECTRICAL SYSTEMS AND LIGHTS

- 30 Amp 120V Distribution Panel
- 4.0 Kw Onan Micro-Lite Generator w/ Large Access Door
- Detachable Shore Line Power Cord
- Solid State 55 Amp 12V Power Converter
- Deluxe Fluorescent and Halogen Light Package
- Battery Disconnect Switch
- 12 V Auxiliary Battery
- Porch Light - 2

PLUMBING AND LP SYSTEMS

- 6 Gallon Gas / Electric Water Heater with DSI
- 12V Water Pump
- City Water Hook-up
- Exterior Spray Port w/ Hose
- Water Heater By-Pass Valve
- Shower with Curtain
- Shower Surround

HEATING, VENTS AND AIR CONDITIONING

- 13,500 BTU Low-Profile Air Conditioner
- Heat Pads for Holding Tanks
- Furnace BTU's

WINDOWS, DOORS AND AWNINGS

- Radius Entrance Door in Rear
- Lighted Acrylic Exterior Grab Handle
- Radius Corner Slider Windows
- Box Patio Awning
- Skylight in Bathroom

SAFETY

- Fire Extinguisher
- Deadbolt Lock on Entrance Door
- GFI Protected Circuit, Exterior
- LP Gas Detector
- Smoke Detector
- Carbon Monoxide Detector
- Command Central® Systems Monitor / Switch Panel
- Pilot and Co-Pilot Three-Point Seat Belts

AUGUSTA TOURING SEDAN® OPTIONS

FORD & CHEVY CHASSIS / ENGINE / SUSPENSION

- Hellwig® Helper Springs
- Polished Chrome Wheels (Steel Spare)
- Canadian RV Certification
- Transport Canada MVS (Also Requires RIVA)

COCKPIT

- Big Button AM / FM / Cassette / CD Radio, SIRIUS® Satellite Ready, w/LCD Dash Mounted Back-up Monitor

APPLIANCES AND ACCESSORIES

- Large Double-Door Refrigerator

INTERIOR

- Decors: Nickel

FURNITURE

- 2 Barrel Chairs IPO Jackknife Sofa (Curbside)
- Dinette IPO Jackknife Sofa (Curbside)

HEATING, VENTS AND AIR CONDITIONING

- Fantastic Fan with Rain Sensor

AUGUSTA®
2009



HOLIDAY RAMBLER®

This is Living

BEING DIFFERENT MAKES
ALL THE DIFFERENCE.

At Monaco Coach Corporation, we always strive to be the best. And that means thinking outside of the box. Giving you more of what you want in an RV. Programs like Monaco Financial Services and 24/7 emergency technical support. No other manufacturer can match Monaco's offerings. No one even comes close. Why not discover the difference yourself?

Visit www.monacodifferent.com

NAVIGATOR®



IMPERIAL™



SCEPTER®



ENDEAVOR®



AMBASSADOR®



NEPTUNE®



VACATIONER®



ADMIRAL®



ARISTA™



ATLANTIS®



AUGUSTA



TRAVELER®

