

IMPERIAL™
2009



HOLIDAY RAMBLER®

This is Living®



Imperial



A WARM WELCOME.

Yes, you've just stepped inside one of the most gracious interiors anywhere. Welcome to the 2009 Imperial. It greets you with plush furnishings, stunning woodwork and a combination of designer carpeting and sleek

ceramic tile. As you can see here, the Bali IV floorplan features a fabulous 46-inch LCD TV in the living area, creating a remarkably residential atmosphere. The Imperial also offers a wide range of exciting options this



year, including a recessed ceiling design and two styles of computer desk — one designed for used with a desktop and one that is ideal for a laptop. It's just more of the ways Imperial welcomes you home.

Imperial[™]
2009 | 

BALI IV

WINDERMERE

STAINED CHERRY







SEASONED WITH STYLE.

Every meal tastes better when it's prepared in the Imperial kitchen. To begin with, you're surrounded by exquisite style, from the Corian® countertops, to the tile backsplash design, to the beautiful cabinetry. Next, you'll love all the conveniences, starting with a four-door or optional residential refrigerator, making it easy to stock up on provisions. You'll also appreciate

the generous storage space and roomy work area, thanks to a roll-out countertop extension. And speaking of convenience, nothing beats the optional central vacuum system, shown below. The legless dinette (shown above) with cozy freestanding chairs is the perfect place to share a meal or catch up on correspondence.

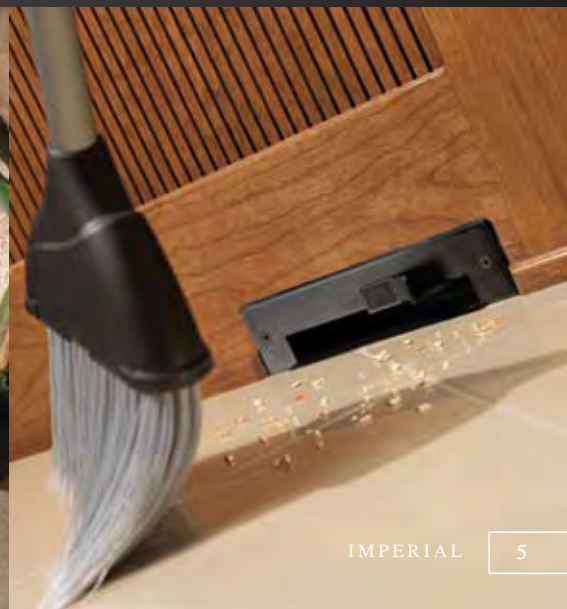



A GRIPPING EXPERIENCE.

Holiday Rambler is leading the way with more high-tech features to put you firmly in control while you're on the road. Highlights include color rear vision with an adjustable camera, the lighted VIP Smartwheel® and adjustable brake and accelerator pedals. You also have the option of GPS navigation and the exclusive SafetyCruise collision avoidance system. Additional options for your entertainment include the new in-dash stereo with a multi-disc CD changer and a Sirius satellite radio system.









RELAX AND REVIVE.

At the end of every day's adventure, the Imperial's private quarters await with impeccable style and luxury. Count on a good night's rest in the pillowtop queen bed, or choose the optional king bed for all the comforts of home. A 20" LCD TV with DVD player completes the experience. Another great

option is a washer/dryer — choose a combination model or the stackable option shown here. As you can see below, you'll be pampered beyond compare in the spacious bathroom. A new option this year is radiant floor heating, for cozy warmth throughout the living areas.





THE ROADMASTER DIFFERENCE

Turn the key of the 2009 Imperial and prepare to experience the incomparable performance of the Roadmaster S-Series semi-monocoque chassis. Roadmaster is the only chassis manufacturer with a 100 percent commitment to only producing chassis for luxury motorhomes. In fact, every Roadmaster chassis is custom built for the exact model and floorplan. That means you'll enjoy a smoother ride, superior front-to-rear balance and unbeatable strength and reliability. We encourage you to take a few minutes to learn more about the many features that put Roadmaster in a class by itself.



MASTERPIECE

The 2009 Imperial stands out in a crowd wherever you travel with its deluxe full-body paint and eye-catching graphics. The high-quality awning package features an automatic patio awning. And an exciting new option to liven up your destination is an exterior entertainment center with a 26" LCD TV and DVD player. As you can see below, an optional full pass-through storage tray and side-hinged baggage doors eliminate the hassles of retrieving items from the storage bays.



The 2009 Imperial features a mighty Cummins® ISL 425 HP engine. New this year is the option of extra muscle with the impressive ISM 500 HP engine.



5-LAYER FLOOR CONSTRUCTION

(top to bottom)

- Tile, or 1/2" carpet pad and carpeting
- Dyna-Span Flooring
- Decibel paper
- Dyna-Span Flooring
- Waterproof Darco underbelly

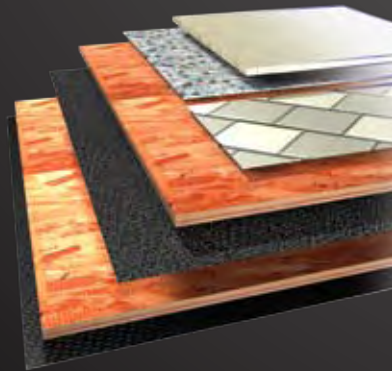

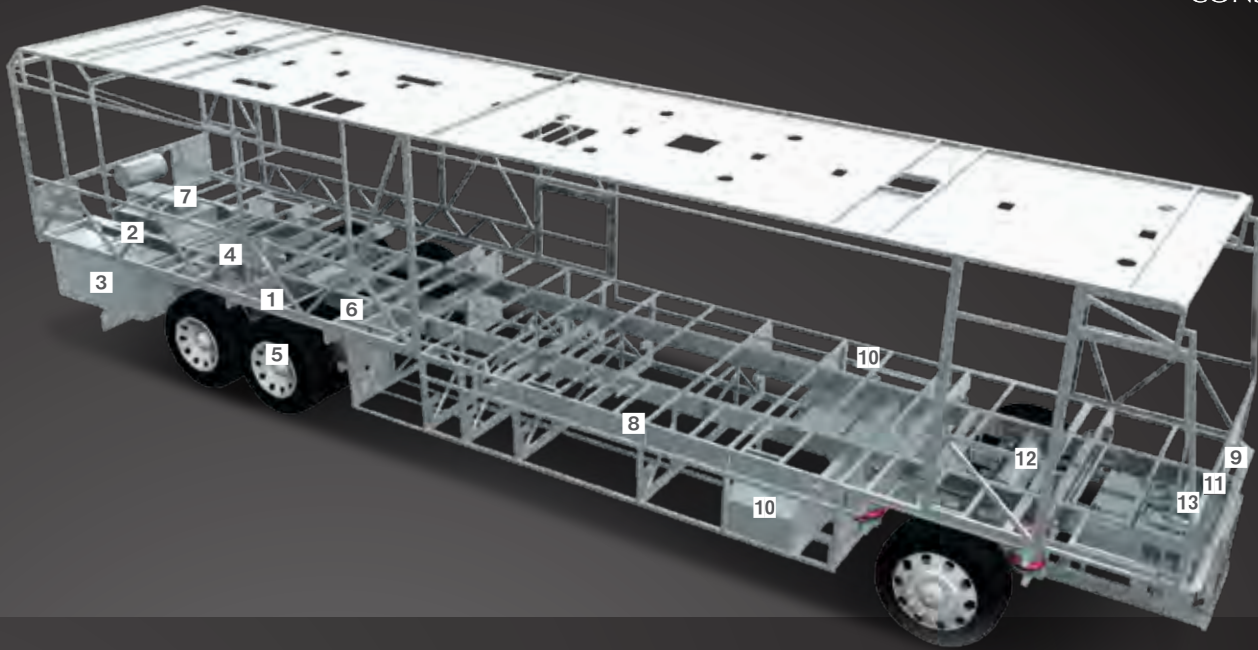

ROADMASTER S—SERIES SEMI-MONOCOQUE CHASSIS

- 1** For less vibration and smoother shifting, a unique rear axle tilt and three-point engine mounting system perfectly aligns the entire drivetrain.
- 2** A 10,000 lb. hitch with 7/4-way trailer plug offers powerful towing capacity.
- 3** The side-mounted aluminum radiator and intercooler reduce weight, are rust-resistant and deliver better heat transfer than steel cooling components. The cooling system exceeds all manufacturer requirements, while two fuel filters help ensure that the injectors remain clear and operate at peak performance.
- 4** Semi-Monocoque Design – Trussed superstructure distributes stress evenly throughout the entire chassis and adds strength to the sidewalls and bays. Rails are spaced 44" on center for a wider stance and unmatched strength.
- 5** A two-stage Jacobs engine brake, auto-slack adjusters, and the anti-lock braking system (ABS) with front disc and rear drum brakes all combine to give you superior stopping power — especially on steep grades. Automatic traction control (ATC) eliminates wheel slippage in slick conditions and heightens control.
- 6** The Cushion Air Glide suspension positions 10 Sachs shocks and 10 air bags, 8 of which are outboard mounted with auto leveling for greater stability, a smoother ride and the best handling in its class. The air bags are

placed approximately 7-1/2 feet apart, providing a wider and more stable platform. The active suspension automatically adjusts the pressure of the air bags as you drive and virtually eliminates nosediving and the side-to-side body sway associated with high wind conditions, curvy roads and emergency maneuvers.

- 7** You'll enjoy the peerless performance of the Cummins® ISL 425 HP diesel engine and Allison® 3000 MH 6-speed World Transmission with electronic shifter. Our exclusive use of synthetic transmission fluid allows for up to three-year maintenance intervals for the Allison® transmission.
- 8** The heavy-duty steel superstructure is the strongest you'll find anywhere, with a 3" x 8" x 1/4" frame rail and a steel rating of 60,000 PSI.
- 9** Steel Cage Firewall for extra protection.
- 10** Dual fuel fill allows you to fill the tank from either side of the coach, for greater convenience and flexibility at the pump.
- 11** The brake and accelerator pedals adjust at the touch of a button, for enhanced ergonomics and greater comfort.
- 12** Dual Ping Tanks with 3/4" air lines for quicker response and improved ride and handling.
- 13** The power steering box provides a 50-degree front wheel turn angle in both directions and returns the steering wheel back to its center position.

6-LAYER SIDEWALL CONSTRUCTION

(left to right)

- Laminated gel coat fiberglass outer wall
- Luaun paneling
- R 7.5 closed cel foam seals every nook and crevice
- Heavy-gauge tubular steel and 4" steel plate backers
- Luaun paneling; walls are Vac-U-Bonded together
- Decorative wall coverings



8-LAYER ROOF CONSTRUCTION

(top to bottom)

- One-piece 1/4" thick fiberglass roof, crowned for water runoff and seamlessly joined with front and rear end caps; non-skid walkways on outboard areas for added convenience
- Vapor barrier
- 3-1/2" tapered bead foam supports the crowned roof; the center tunnel houses wiring and air conditioner ducts
- 1/4" marine grade plywood sheeting
- Tubular steel framework
- R closed cel foam seals every nook and crevice
- Luaun and vinyl paneling are Vac-U-Bonded
- Sound-absorbing, easy-to-clean padded vinyl interior headliner

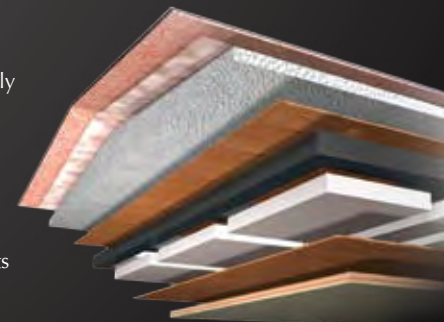



Imperial™
2009



BETTER
STAIN
PROTECTION

COLORS AND PATTERNS IN PERFECT HARMONY.

Leave it to Holiday Rambler to give you the most enticing choices of exterior colors and interior decors. Choose the one that fits your style — from boldly sophisticated to classic elegance. Then, put it all together with your favorite cabinetry selection, and you've created a masterpiece all your own.

Manufactured in, not added on. For added protection against stains, soil repellent is applied to virtually all upholstery fabric during the finishing process for superior coverage.*

*Brand and application of upholstery fabric protection may vary depending on date recreational vehicle was manufactured.



NATURAL OAK



STAINED OAK

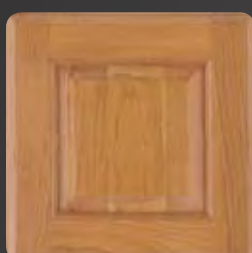

NATURAL CHERRY



STAINED CHERRY



NATURAL MAPLE



RUM RAISIN



DECADENT MIDNIGHT





LE: STARRY NIGHT

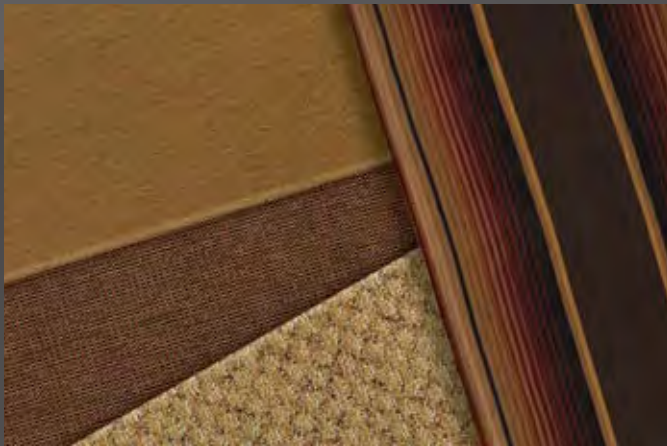
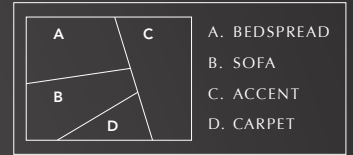

RL: KINGSBRIDGE



RL: BLACK PEARL



RL: WINDERMERE





BODY CONSTRUCTION: FEATURES

- Heavy-Duty Steel Superstructure with Steel Cage Cockpit Construction
- Seamless One-Piece Molded Crowned Fiberglass Roof
- All-Season Foam Insulated Roof
- Laminated Gel Coat Fiberglass Sidewalls
- Five-Layer Flooring with Two Layers of OSB Flooring
- Deluxe Full-Body Paint
- PanaviewTM 1-Piece Front Windshield
- Dual-Head Power-Controlled Heated Chrome Exterior Mirrors with Turn Indicator Lights
- Halogen Fog Lights
- Daytime Running Lights
- Recessed Side Docking Lights
- Roof-Mounted Dual Trumpet Air Horns
- Entry Step Storage
- Insulated Aluminum Baggage Doors with Power Locks
- Lined Pass-Through Storage Compartments
- Interlocking Aluminum Framed Slide-Out Houses
- Side-Hinged Baggage Doors with Electric Locks
- Rear Ladder
- Full-Length Holiday Rambler Mud Flap
- Electric Bay Door Latches

OPTIONS

- 3M Film Front Mask
- Storage Bay Slide-Out Tray, One Side
- Storage Bay Slide-Out Tray, Pass Through

CHASSIS/ENGINE/SUSPENSION: FEATURES

- Roadmaster S-Series Semi-Monocoque Chassis
- Cummins[®] ISL 425 HP Electronic Engine with Allison[®] 3000 MH 6-Speed World Transmission and Electronic Shifter
- Torque (@ 1,300 RPM) 1200 lbs./ft. Max. Net
- Dual Fuel Fill
- 200 Amp Alternator
- Rear Axle Ratio: 4.78:1
- Ignition Key on Steering Column
- Tires: 295/80R/22.5
- Remote Transmission Fill
- Polished Aluminum Wheels
- Full Cushion Air Glide Suspension with Ten Outboard-Mounted Air Bags and Ten Sachs Shock Absorbers
- Automatic Traction Control
- Anti-Locking Braking System with Front Disc Brakes and Rear Drum Brakes
- Tag Axle with Anti-Lock Braking System
- Two-Stage Jacobs Engine Brake
- Prewire for Supplemental Braking System
- Engine Block Heater with Switch on Dash
- Automatic Air Leveling System
- 10,000 Lb. Hitch Receiver and 7/4-Way Trailer Plug

OPTIONS

- Hydraulic Leveling System
- ISM 500 Engine
- Safety Cruise
- Tire Pressure and Temperature Monitoring System
- 15,000 Lb. Hitch with Non-Liftable Tag When Tow Vehicle Is Hooked Up
- Dual Leveling Systems (Air/Hydraulic)

COCKPIT: FEATURES

- AM/FM Stereo with Single CD Player
- Color Rear Vision System with Camera
- CB Radio Prep (Cable and Antenna)
- Electric Cockpit Blackout Shades with Manual Sunscreens and Slotted A-Pillars for Windshield Shade
- Dash HVAC Blend Air System with New HVAC Controller
- Driver's Seat Automatically Moves Forward When Roadside Slide-Out Is Engaged
- Adjustable Brake and Accelerator Pedals
- Lighted VIP Smartwheel[®] with Controls for Windshield Wipers, ICC and Cruise Control
- Six-Way Power UltraleatherTM Pilot and Co-Pilot Seats with Power Adjustable Lumbar and Co-Pilot Footrest
- Fiberglass Automotive Dash with Canyon Burlwood Instrumentation Panel; Black Gauges with White Lettering and Chrome Bezel

OPTIONS

- CB Radio
- In-Dash AM/FM Stereo with Multi-Disc CD Player
- GPS Navigation System
- Sirius Satellite Radio System (Requires Subscription)
- 3 Camera Rear Vision System

APPLIANCES AND ACCESSORIES: FEATURES

- Four-Door Refrigerator with Ice Maker and Raised Panel Doors
- Recessed High-Output 2-Burner Cooktop with Flush-Mounted Covers
- Convection Microwave with Touch Control
- TV Antenna with Booster
- Prep for Satellite Receiver
- 46" LCD TV in Living Area (Bali IV Only)
- 37" LCD TV in Living Area (Aruba Only)
- 32" Flatscreen LCD TV with Remote in Living Area (N/A: Aruba, Bali IV)
- 20" LCD TV with Remote in Bedroom
- Home Theater System with DVD Player
- Bedroom DVD Player
- Universal Remote System for Living Area TV

OPTIONS

- Combination Washer/Dryer
- Stackable Washer/Dryer
- 17 Cu. Ft. Four-Door Refrigerator with Raised Panel Doors
- Residential Refrigerator with Additional Batteries

- Stainless Steel Refrigerator
- Central Vacuum System
- 26" LCD TV with Remote in Bedroom
- 26" LCD TV in Living Area Overhead (N/A: Fiji IV, Nantucket)
- Drop-Down Exterior 32" LCD TV (N/A: Bali IV, Fiji IV)
- Electric TV Antenna
- KVH R6 In-Motion Digital Satellite System
- Multi-Satellite HD KU/KA Dish
- Exterior 26" LCD TV with Swing Arm

INTERIOR: FEATURES

- Stained or Natural Oak Cabinetry
- Dinette Wall Cabinet with Corian® Top
- Built-In Storage Area for Galley Countertop Covers
- Heavy-Duty Ball Bearing Drawer Guides
- Corian® Countertops Throughout
- Roll-Out Polished Solid Surface Galley Countertop Extension
- Corian® and Tile Backsplash in Galley
- Glass Splash Guard
- Day/Night Shades with Blackouts Throughout
- Mini Blinds in Galley and Bathroom
- Integrated Sinks in Vanity and Galley
- Hardwood Drawer under Bed
- Drawer Organizer in Galley
- Designer Carpeting in Living Area and Bedroom
- Ceramic Tile Flooring in Cockpit Area
- Raised Panel Door for Private Bath
- Bedspread, Pillow Shams and Decorative Pillows
- Nightstands with Corian® Countertops
- Foss Lined Cabinet Shelves
- Bedroom Dresser with Corian® Countertop and Integrated Hamper

OPTIONS

- Interior Decors: Rum Raisin, Decadent Midnight
- Ralph Lauren Decors: Kingsbridge, Black Pearl, Windermere
- Starry Night Luxury Edition Decor Package (Includes: Upgraded Fabrics Throughout; High-Gloss Full-Tile Floor in Living Area, Galley, and Vanity Area; Upgraded Recessed Ceiling Design in Living Area; Laminated Inserts in Overhead Cabinet Doors ILO Raised Panel; Backlit Glass Backsplashes in Galley and Vanity; Backlit Glass Splash Guard in Galley; Satin Nickel Hardware and Accents; Upgraded Slide-Out Fascia Trim and Valance Design with Matching Headboard Design; Luxury Edition Logos on Cab Seats and Exterior of Coach)

- Cabinetry Options: Stained or Natural Cherry, or Natural Maple
- Full-Tile Living Room Floor
- Laminated Plank Flooring in Galley and Bath, in Front of Washer/Dryer Cabinet, and Front Entry
- Recessed Ceiling in Living Area and Galley
- Ceiling Fan in Bedroom
- Solar Screens with Blackout Shades Throughout (Manual)
- Central Vacuum Parts Storage Tray under Bed When Central Vacuum Is Optioned

FURNITURE: FEATURES

- Legless Corian® Dinette Table with Two Dinette Chairs and Two Folding Chairs
- Roadside Furniture: Ultraleather™ Sofa with Drawer
- Curbside Furniture: Ultraleather™ J-Lounge with Drawer
- Queen Bed Pillowtop Mattress (60" x 80")

OPTIONS

- King Bed (72" x 80")
- Queen Air Mattress w/Digital Remote
- King Air Mattress w/Digital Remote
- Leather Hide-A-Bed Sofa with Air Mattress
- Leather Hide-A-Bed Sofa
- Fabric Hide-A-Bed Sofa with Air Mattress
- Fabric/Leather Hide-A-Bed Sofa with Air Mattress
- Fabric Rest Assured Sofa with Drawer
- Leather Rest Assured Sofa with Drawer
- Computer Desk with Leather Euro-Recliner and Ottoman
- Fabric/Leather Sectional Booth Dinette Ensemble
- Two Folding Chairs with Sectional Booth Dinette Ensemble



ELECTRICAL SYSTEMS AND LIGHTS: FEATURES

- 50 Amp 120V Distribution Panel
- 50 Amp Power Cord Reel
- Onan® 10.0 kW QD Generator on Power Slide-Out Tray with Auxiliary Start Switch and Automatic Temperature Start
- 2,800-Watt Pure Sine Wave Inverter with Auto Gen Start and Auto Temp Start
- Pilot and Co-Pilot Map Lights
- Lighted Utility Center
- Underhood Utility Light
- 120V Outlet in Private Bath
- 120V Receptacles in Outside Storage Compartment
- Lighted Exterior Storage Compartments
- Four 6V Deep Cycle House Batteries
- Two 12V Heavy-Duty Chassis Batteries
- Surge Guard Automatic Transfer Switch
- Multiplex 12V Wiring for Dash/Instrument Panel Gauges and Interior of Coach
- Decorative Lighting in Living Room, Dinette and Bath
- Cosmetic Vanity Lights in Bathroom
- Halogen Lighting in Ceiling Throughout
- Mood Lighting on Galley and Vanity Base
- Doorbell
- 12" Porch Light
- 120V Outlet on Passenger-Side Cab Armrest
- Shower Light

OPTIONS

- Solar Panel

PLUMBING AND LP SYSTEMS: FEATURES

- Central Water Filtration System in Service Bay
- Manabloc Water System for Entire Coach
- Insulated Systems Compartment with Easy Access to Hook-Up
- Demand Water System and Water Pump with Accumulator Tank
- Water Pump Switch in Galley, Bathroom and Service Bay
- China Toilet
- Super Service Center with Hot/Cold Water Faucet
- Black Holding Tank Rinsing System
- Single Lever Galley Faucet with Pullout Sprayer
- Power Water Hose Reel
- RV Sani-Con Tank Drainage System
- Insta-Hot® Water System
- Bathtub

OPTIONS

HEATING, VENTS AND AIR CONDITIONING: FEATURES

- Two Low-Profile Ducted 15M BTU Roof Air Conditioners and One 13.5M BTU Roof Air Conditioner with Wall Thermostats and Heat Pumps
- Electronic Air Conditioner/Heat Climate Control System
- Center Defroster Vents
- 12V Attic Fan in Bathroom and in Private Lavatory and Galley
- Aqua-Hot® Heating System
- Radiant Floor Heating in Living Area, Galley and Bath

OPTIONS

WINDOWS, DOORS AND AWNINGS: FEATURES

- Flush-Mounted Radius Dual Pane Safety Glass Dark Tinted Windows
- Front Entry Door with Air Seal, Removable Top Screen and Automatic Front Door Awning
- Keyless Remote Entry System with Pocket Remote
- Topper Awnings on Slide-Out Houses
- Window Awnings on All Slide-Out House Windows, except Galley Windows and Slide-Out Windows under Patio Awning
- Eclipse Automatic Patio Awning
- Adjustable Vertical Raised Windows
- One Large Awning at Sofa/Dinette Windows
- Carefree® Mirage Automatic Patio Awning

OPTIONS

SAFETY: FEATURES

- Backup Alarm
- Fire Extinguisher
- Deadbolt Lock on Entrance Door
- Lighted Interior and Exterior Grab Handles
- 120V GFI Protected Circuit (Galley, Bath and Storage Bay)
- LP Gas Detector
- Smoke Detector
- Carbon Monoxide Detector
- Integrated Pilot and Co-Pilot Three-Point Seatbelts
- Third Brake Safety Light
- Egress Windows
- Security Safe

OPTIONS

- Deluxe Security Alarm System
- Safety Cruise

Due to continuous product improvement, please see the website for the latest in standards and options, specifications, and technical data. Go to www.holidayrambler.com.

Weights*	Aruba	Bali IV	Fiji IV	Nantucket
Gross Vehicle Weight Rating	45,160	45,160	44,600	45,160
Gross Combined Weight Rating	55,160	55,160	54,600	55,160
Front Gross Axle Weight Rating	15,160	15,160	14,600	15,160
Rear Gross Axle Weight Rating	20,000	20,000	20,000	20,000
Tag Gross Axle Weight Rating	10,000	10,000	10,000	10,000
Measurements				
Wheelbase	286	286	278 1/4	286
Overall Length	44' 11"	44' 11"	44' 4"	44' 11"
Overall Height with A/C	12' 6"	12' 6"	12' 6"	12' 6"
Interior Height	84"	84"	84"	84"
Interior Width	96"	96"	96"	96"
Exterior Width	100.5"	100.5"	100.5"	100.5"
Tank Capacities** (Gal.)				
Gray Tank	70	70	70	70
Black Tank	40	40	40	40
Fresh Tank	100	100	100	100
LP Tank ***	25	25	25	25
Fuel Tank	130	130	130	130

* Towing capacity is limited by GCWR; your vehicle's towing capacity is the difference between the GCWR and the actual vehicle weight, including all water, fuel, passengers and cargo. Your towed vehicle should be equipped with auxiliary brakes if the weight of the towed vehicle exceeds 1,000 lbs. Consult your owner's manual for further towing information.

** All tank capacities are estimated based upon calculations provided by the tank manufacturers and represent approximate capacities. The actual "usable capacity" may be greater or less than the estimated capacities based upon fabrication and installation of the tanks.

*** Actual filled LP capacity is 80% of listing due to safety shut-off required on tank.

The actual overall length of the recreational vehicle may differ from that indicated in the brochure due to variances in the manufacturing process and/or installed components. The actual length may be greater or less than that indicated. Due to the large variety of options and floorplan arrangements available to our customers, actual weights for each unit can differ significantly. Holiday Rambler provides a weight sticker on each unit we produce which includes that unit's tank capacities and approximate weight. Consult your local Holiday Rambler dealer for unit availability and further information. The information printed in this brochure reflects product design, fabrication, and component parts at the date of printing. The manufacturer reserves the right, at any time, to make changes in product design or material or component specifications as its sole option, without notice. This includes the substitution of components of a different brand or trade name which will result in comparable performance. All information printed in this brochure is subject to change after the date of printing. Some features shown or mentioned in this brochure are optional and may only be available in selected floorplans. Photographs may show props or decorations that are not standard equipment on Holiday Rambler models. Holiday Rambler, the Holiday Rambler logo and its design, are registered trademarks. All other products and company names are trademarks and/or registered trademarks of their respective holders. While the color of the motorhome's exterior and the interior fabrics depicted in this sales brochure are fair and reasonable depictions, the colors depicted may not be an exact match of the actual colors because of the variances in photo-processing and variances caused by inserting the photographs within the sales brochure. Due to product improvements, changes during the model year and/or transcription errors that may occur, information represented within this brochure may not be accurate at the time of your purchase. If certain information is significant to your purchasing decision, please confirm the information with your dealer prior to submitting your order. Component part and appliance manufacturers issue limited warranties covering those portions of the recreational vehicle not covered by the Limited Warranties issued by Monaco Coach Corporation. To learn which specific component parts and appliances are excluded from the Limited Warranties issued by Monaco Coach Corporation, please contact your selling dealership or Monaco Coach Corporation directly, or review the warranty packet inside the recreational vehicle.



BED AND BATH OPTIONS

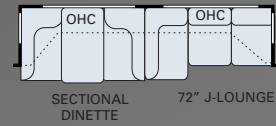
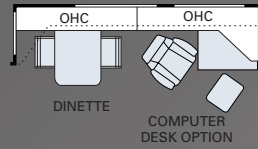
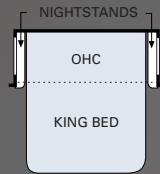
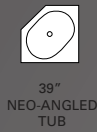

SLIDEOUT OPTIONS

Aruba

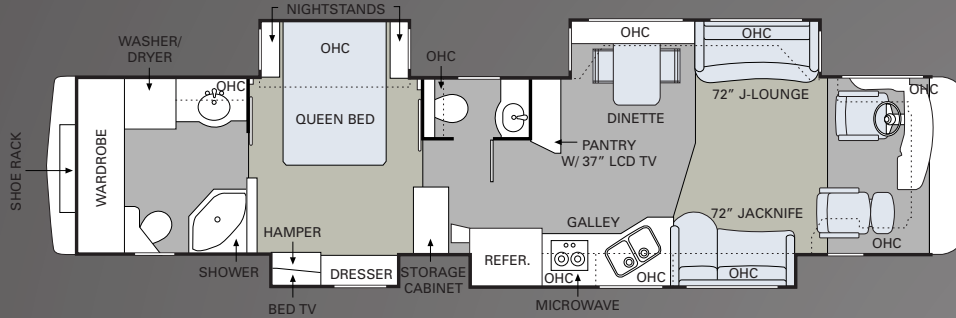

SLIDEOUT OPTIONS

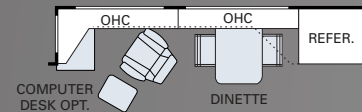
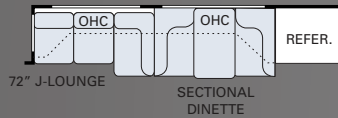

Bali IV

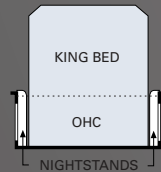
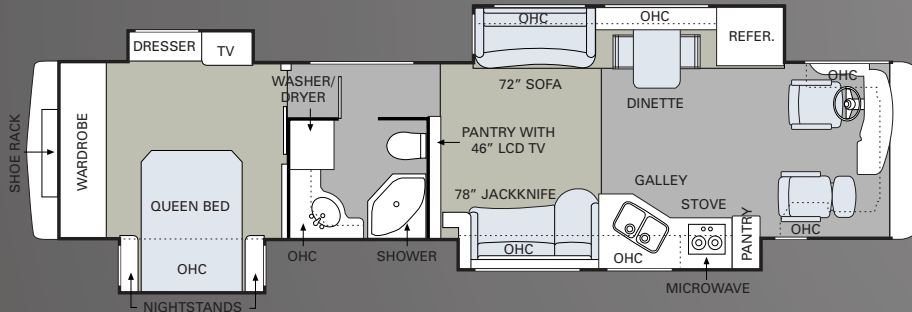

BED AND BATH OPTIONS

CARPET | TILE

H O L I D A Y R A M B L E R . C O M

Log on to our website anytime, night or day. It's your link to everything Holiday Rambler, including product news and updates, club events, dealer and service center info and much more. Take it for a test drive today.



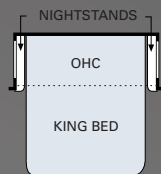

BED AND BATH OPTIONS

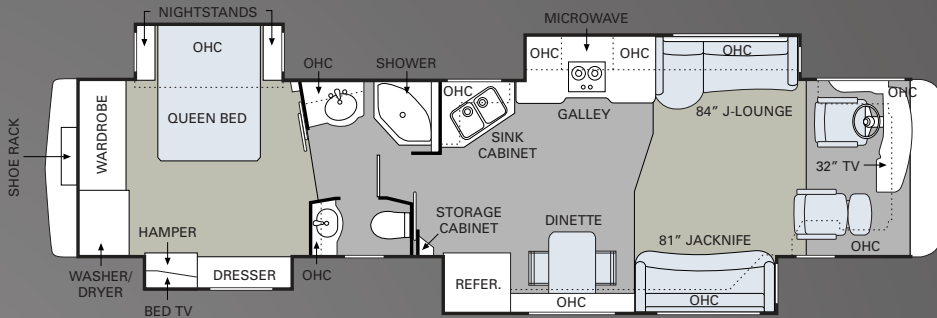

Fiji IV

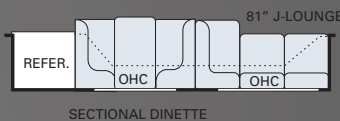
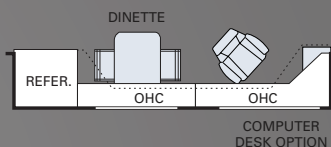

SLIDEOUT OPTIONS

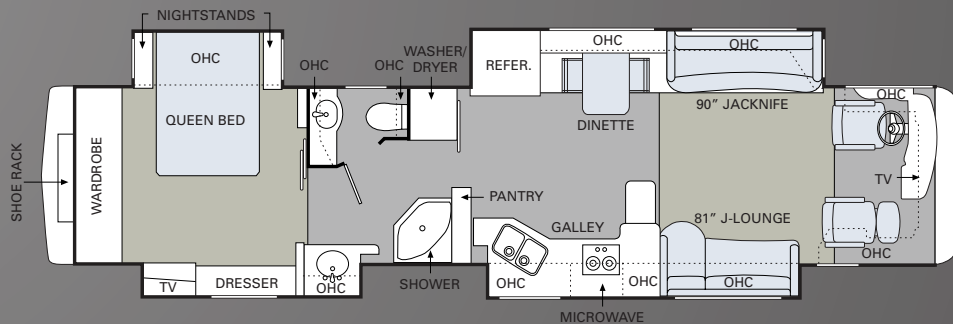

Nantucket



WE'RE HERE. ANYTIME, EVERY TIME.

- Reach us anytime — literally — via our live customer support line.
- Drive in to one of our 350 Service Centers.
- Enjoy the first year free when you enroll in our Owner Advantage Roadside Assistance Program.
- See where it all begins with a tour of our facility Oregon. Call 1-800-650-7337 or 1-800-634-0855 to find out more.



HOLIDAY RAMBLER®
This is Living®

BEING DIFFERENT MAKES
ALL THE DIFFERENCE.

Take a closer look, and you'll discover that Holiday Rambler, a brand of Monaco Coach Corporation, gives you more industry "bests" than any other RV manufacturer. Like the incomparable ride and handling of the Roadmaster Chassis. The convenience of our 350 service centers. The peace of mind of 24/7 roadside assistance. The value of Monaco Financial Services. And the online support of holidayrambler.com. At Holiday Rambler, we've built our reputation by listening to you — and answering to you. And that's the difference that's made us the best.

WARRANTIES

12 MONTH/24,000 MILE basic limited warranty

5 YEAR/50,000 MILE limited warranty on aluminum or steel frame structure of sidewall, roof, front and rear cap

3 YEAR/50,000 MILE limited warranty on Roadmaster chassis

Applies to certain models. See owner's manual for complete details.

NAVIGATOR®



IMPERIAL™



SCEPTER®



ENDEAVOR®



AMBASSADOR®



NEPTUNE®



VACATIONER®



ADMIRAL®



ARISTA™



ATLANTIS®



AUGUSTA

