

FOREST RIVER PRESENTS

# ROCKWOOD

TENT CAMPERS

ROCKWOOD TENT CAMPERS



FREEDOM SERIES • PREMIER SERIES • HIGH WALL SERIES

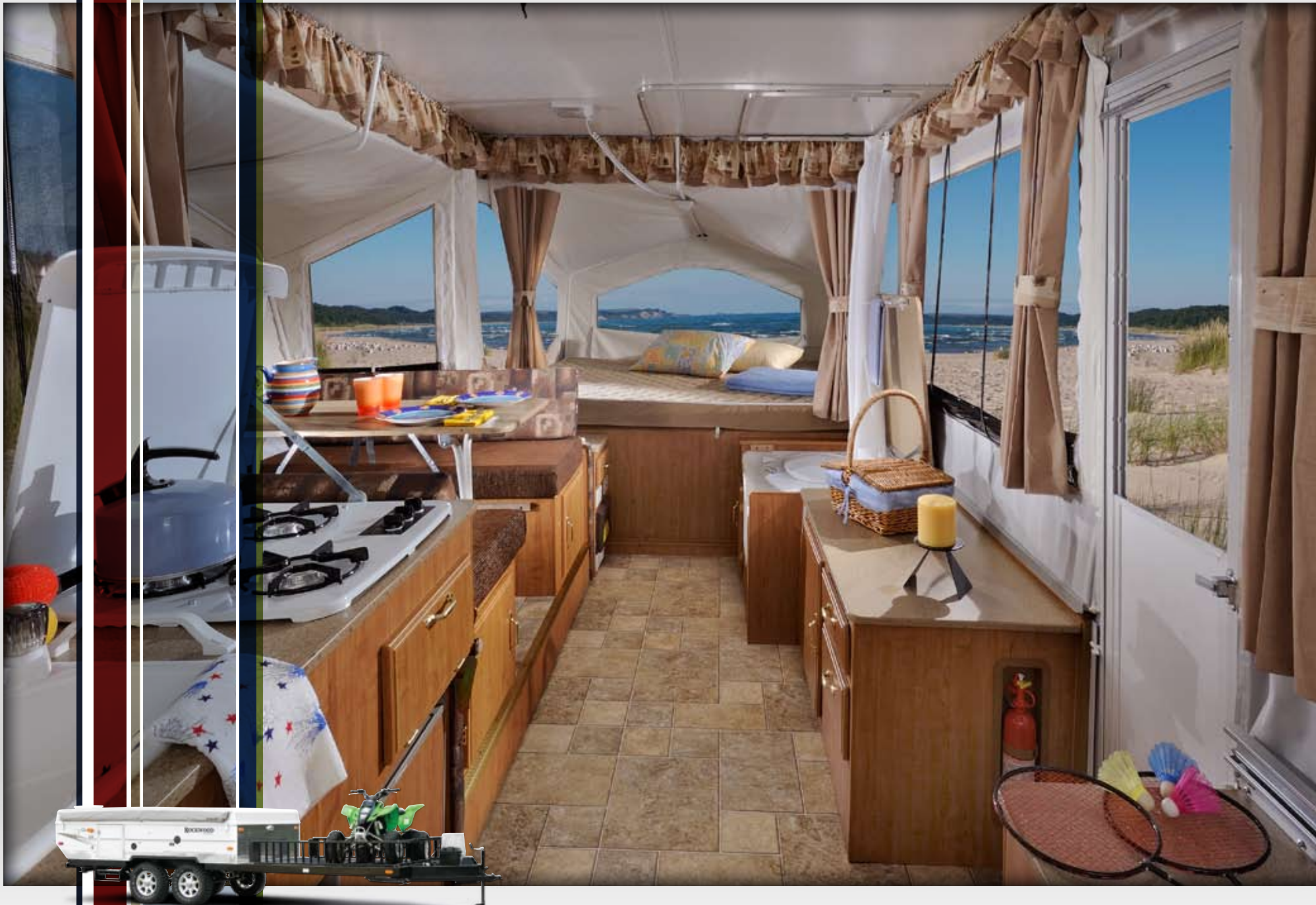

**ROCKWOOD FREEDOM • MODEL 232XRT**

# Rockwood Freedom

Yes, your camping, but that doesn't mean your comfort stays home. Residential living standards that make life easy make camping easy. Features like the heated mattresses so you remain warm at night, and metal drawer guides to keep drawers gliding open and shut, are simple amenities that add tremendously to the comfort of your vacation. It's your vacation. Do it right.



A



B



C



D



E



F



G



H



I

- A** Metal Drawer Guides
- B** Exterior Electric Plug  
*(Except 1640LTD)*
- C** Water Pump *(Std.)*
- D** Outside Grill with Work Table  
*(Std. on all Except LTD)*
- E** Under Floor 20 Gallon Water Tank  
*(Std. except LTD.)*
- F** Swing Down Galley  
*(Std. except LTD)*
- G** Spare Tire  
*(Std. with package B)*
- H** Heated Mattress *(Std. Opt.)*
- I** Marine Grade Plywood Bed Ends



**ROCKWOOD PREMIER · MODEL 2317**

# Rockwood Premier

The Rockwood Premier is the premier tent camper on the market today. It is loaded with features that make your camping experience more enjoyable. From the expansive sliding storage trunk for that extra cargo space, to a bunk light and air circulating fan, and the convenient hanging shirt bar to place your clothes are some of the basic features that really make your camper a Premier.



A



B



C



D



E



F



G



H

- A** Hanging Shirt Bar  
(Std. Premier & High Wall)
- B** Bunk Light and Fan  
(Std. Premier & High Wall)
- C** Standard Power Lift  
(Premier & High Wall)
- D** Outside Shower with Water  
Filtration System
- E** Port-a-Potty  
(Std. on Selected FPs)
- F** Water Filter  
(Std. with Hot Water Heater)
- G** Fantastic Fan  
(Std. Except LTD.)
- H** One-Piece Door  
(Std. Except LTD.)



**ROCKWOOD HIGH WALL · MODEL 296**

# Rockwood High Wall

Wanting to camp but don't want to "rough it?" Welcome to the Rockwood High Wall Series. We have designed this series for the camping family who wants the refinement of larger vacationing units in a light-weight camper. Ample counterspace, upgraded appliances and tasteful interiors make this camper a gorgeous option to experience.



A

A



B



C



D

- A** Beautiful hardwall shower with a residential-style flush toilet complete with a 12-gallon black water holding tank.
- B** Sliding Storage Trunk (Some Models)
- C** Exterior Speaker (STD. Premier & High Wall)
- D** AM/FM Stereo with CD Player (STD. Premier & High Wall)





# ROCKWOOD

## CONSTRUCTION

- 1) Three Stage Double Arm Lifter Posts
- 2) Fiberglass Vacuum Bonded Radius Roof w/ No Center Seam
- 3) Five-Piece Vinolon Supreme Tenting
- 4) E-Z Crank Down Stabilizer Jacks w/Sand Pads
- 5) Full Perimeter Aluminum Bed Frames
- 6) Plywood Bunk Ends
- 7) Seven-Way Pigtail Wiring
- 8) Under Floor 20 Gallon Fresh Water Tank (Ltd's 10 Gallon Above Floor)
- 9) Powder Coated Tubular Steel Frame
- 10) Powder Coated Rafter Poles and Bed Bows
- 11) Air Conditioner Reinforcing Laminated Into Roof
- 12) 13" Radial Tires on 12' Models (12" Radial Tires on 8' & 10' Models)
- 13) Easy Lube Axles
- 14) Smooth Fiberglass Vacuum Bonded Exterior
- 15) One-Piece Door (Except LTDs)

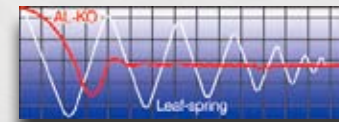

The UltrULube™ Hubs allow you to repack bearings quickly and easily without disassembly.

## AL-KO® AXLES AND EASY LUBE HUBS

**AL-KO Axles offer many advantages over conventional axles:**

- Fully Independent Wheel Suspension
- No Metal to Metal Contact and No Springs, Shackles, Hangers, or U-bolts to Break or Wear Out
- Lower Trailer Center of Gravity For Improved Stability

**Note:** Torsion Axles on Premiers and HWs only. Easy-Lube Hubs on all units except LTDs.

10

7

# Rockwood Popular Features

- A** Hanging Wardrobe
- B** Add-a-Room with Flaps
- C** Hanging Pantry
- D** Power Lift (*Opt. LTD. and Freedom*)
- E** Bike Rack (*Opt.*)



A



B



C



D



E

# ROCKWOOD HIGH WALL FLOORPLANS

## STANDARD FEATURES

- Double Pan Sink with High Rise Faucet
- 14" Tires with Aluminum Rims
- 3500 LBS Torsion Axles by AL-KO
- Easy-Lube Axles
- New Exterior Graphics
- Cream Interior with "Wood Look" Linoleum
- AM/FM Stereo with CD player
- Outside Speaker
- TV Outlet with Cable and Satellite Hook Up
- Three Burner Stove with Oven
- Microwave
- Hot Water Package (Incl. Water Filter, Outside Shower, DSI Six Gallon Hot Water Heater)
- 12 Gallon Black Water Holding Tank (Shower Models Only)
- Electric Water Pump
- Water Purifier
- Two-20 lb. Gas Bottles
- Diamond Plated Metal End Caps
- Stainless Steel Look Appliances and Sink
- Six Gallon Gray Water Holding Tank
- Bunk Light with Fan
- One-Piece Screen Door
- Electric Brakes
- Battery Box and Wiring Kit
- 12v Safety Switch
- Power Lift System
- Awning

## OPTIONS

- 13,500 BTU Air Conditioner
- Create-a-Breeze 3 Speed Fantastic Fan
- Heated Innerspring Mattresses
- 17,000 BTU Forced Air Furnace w/ Electric Ignition
- Screen Room
- Package A (Incl. Lined Privacy Curtain, Roof Valances, Patio Light, 110 Exterior Outlet)
- Package B (Incl. Spare Tire, Tire Bracket, Tire Cover, Step)
- Hanging Wardrobe
- Hanging Pantry
- Tire Pressure Monitoring System
- Power Front Jack
- Extra 4.0 cu. ft. Refrigerator



MODEL	HW256	HW258	HW276	HW296	HW316TH
G.V.W.R. (Gross Vehicle Weight Rating)	3873	3806	3766	4701	7404
Base/Dry Unit Weight	2910	2831	2876	3221	3676
Base/Dry Hitch Weight	373	306	266	301	404
Base/Dry Axle Weight	2537	2525	2610	2920	3272
Cargo Capacity	963	937	852	1217	2317
Box Size	12'	12'	14'	16'	14'
Trailer Size (Closed - w/ Hitch)	18' 6"	18' 6"	19' 4"	21' 4"	28' 4"
Height (Closed)	68"	68"	68"	68"	68"
Trailer Length (Open)	22' 6"	22' 6"	24' 9"	26' 9"	33' 9"

Model number of any particular unit does not necessarily reflect the overall length of the unit itself. Dry weight are estimates.

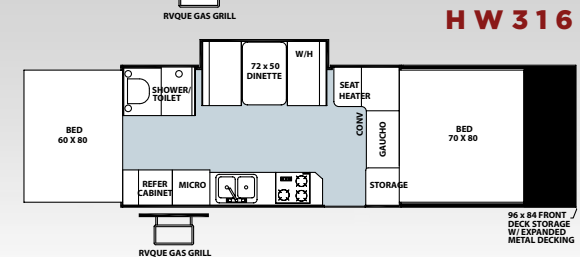
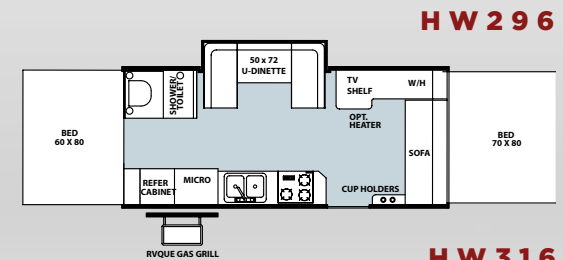
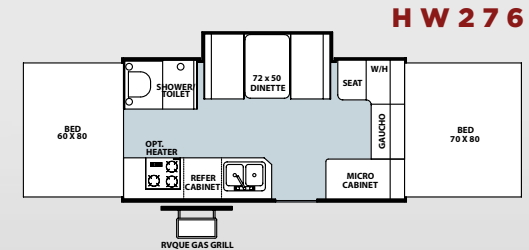
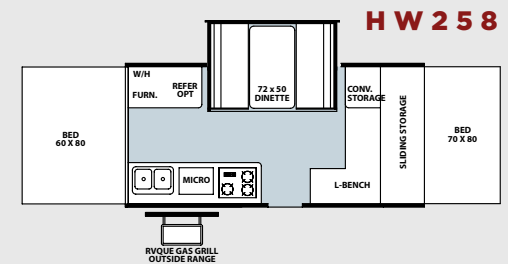
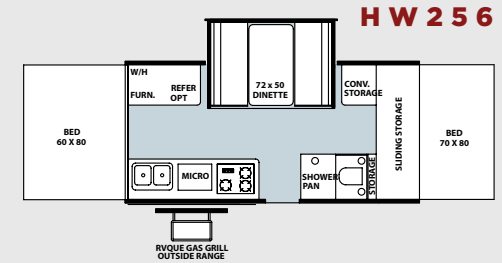

# ROCKWOOD FREEDOM · STANDARDS & OPTIONS

## FREEDOM/LTD STANDARD FEATURES

- Residential Kitchen Faucet w/ Electric Water Pump
- Soft Quilted-Top Bed Mattresses (4" High Density Foam)
- Outside Gas Grill (Optional on LTDs)
- Water-Pur Filtration System w/ All Shower Models
- Permanently Mounted 3 Burner Indoor Range w/ Range Cover (Except LTDs)
- Converter w/ Built in Battery Charger
- Electric Brakes (12' Models)
- Tinted Vinyl Windows
- Fold Over Galley with Upper and Lower Storage
- Exterior Work Table (Except LTDs)
- LP Leak Detector
- Automatic Safety Switch to Turn Off 12 Volt Current When Roof is Closed
- Large Built-In Icebox
- Drawer Guides
- One Piece Screen Door (Except LTD's)
- Port-a-Potty in 1910 Model
- Awning
- Battery Box (Except LTDs)

## FREEDOM/LTD CONSTRUCTION FEATURES

- Three Stage Double Arm Lifter Posts
- Fiberglass Vacuum Bonded Radius Roof w/ No Center Seam
- Five-Piece Vinolon Supreme Tenting

## ROCKWOOD FREEDOM/LTD SERIES

MODEL	1620	1910	1920BH	1950	1970	1980	2270	2280	2280BH	2318G	2405G	1640LTD	1940LTD	190XR	232XR	282TXR	291TXR
GVWR (Gross Vehicle Weight Rating)	2233	2838	2816	2605	2520	2512	2877	2971	3081	3059	2988	2049	2274	3723	3770	5327	5429
Base/Dry Unit Weight	1448	1753	1731	1669	1635	1627	1892	1986	2021	2158	2278	1347	1493	2161	2545	2991	3093
Base/Dry Hitch Weight	192	222	234	238	237	268	274	327	331	309	238	175	174	223	270	190	301
Base/Dry Axle Weight	1256	1531	1497	1431	1398	1359	1618	1659	1690	1849	2040	1172	1319	1938	2275	2801	2792
Cargo Capacity	766	1066	1066	917	866	866	966	966	1041	882	691	683	762	1543	1206	2317	2317
Box Size	8'	10'	10'	10'	10'	10'	12'	12'	12'	12'	14'	8'	10'	10'	12'	12'	12'
Trailer Size (Closed - w/ Hitch)	12'	15' 11"	17' 2"	14'	14'	14'	15' 11"	15' 11"	18' 8"	15' 11"	17' 11"	12'	14'	19' 3"	22' 1"	26' 3"	26' 3"
Height (Closed)	57"	57"	57"	57"	57"	57"	57"	57"	57"	57"	57"	57"	57"	62.5"	62.5"	62.5"	62.5"
Trailer Length (Open)	17'	20' 2"	20' 2"	20' 2"	20' 2"	20' 2"	22' 6"	22' 6"	22' 6"	22' 6"	24' 9"	17'	20' 2"	24'	27'	30' 3"	30' 3"

Model number of any particular unit does not necessarily reflect the overall length of the unit itself. Dry weight are estimates.

- E-Z Crank Down Stabilizer Jacks w/ Sand Pads
- Full Perimeter Aluminum Bed Frames
- Plywood Bunk Ends
- Seven-Way Pigtail Wiring
- Under Floor 20 Gallon Fresh Water Tank (LTDs 10 Gallon Above Floor)
- Automotive E-Coated Tubular Steel Frame
- One-Piece Undercoated Structurewood Floor
- Powder Coated Rafter Poles and Bed Bows
- Steel Air Conditioner Reinforcing Laminated Into Roof
- 13" Radial Tires on 12' Models (12" Radial Tires on 8' & 10' Models)
- Leaf-Spring Axle
- Main Door Operational in Closed Position
- 2,000 lb. Tongue Jack w/ Swivel Wheel
- Easy Lube Axles (Except LTDs)
- Seamless, High Density Polyethylene Wheel Wells
- Swing Level Galley With Storage

## FREEDOM POPULAR EXTRAS

- Create-A-Breeze Three Speed Fantastic Fan
- Thermostatically Controlled Heated Bed Mattresses
- 17,000 BTU Forced Air Furnace w/ Electric Ignition
- Large 1.9 Cubic Ft. Refrigerator
- Add-A-Room With Flaps
- Option Pkg. A (Incl. Lined Privacy Curtains, Roof Valances, Patio Light, 110 Exterior Outlet)

- Option Pkg. B (Incl. Spare Tire, Tire Bracket, Tire Cover, Step)
- Shower/Cassette Option (Model 2280, 2280BH 2318G Incl. Water Filtration System, Six Gallon Hot Water Heater, Demand Water Pump, and Cassette Toilet)
- Overhead Kitchen Pantry
- Power Lift System
- Bike Rack
- Air Conditioner Wiring Kit
- Electric Brakes (Standard on 12' Models)
- Dual 20 Lb. LP Bottles with Cover
- Tire Pressure Maintaining System
- Hot Water Package (2270, 2280, 2280BH)

## LTD STANDARD FEATURES

- Spare Tire
- Awning
- Roof Vent
- Privacy Curtains
- Rear Crank Down Stabilizer Jacks w/ Sand Pads
- Outside Recep. (1940 LTD only)
- Patio Light (1940 LTD only)
- Step

## LTD POPULAR EXTRAS

- Thermostatically Controlled Heated Bed Mattresses
- Large 1.9 Cubic Ft. Refrigerator
- 17,000 BTU Forced Air Furnace w/ Electronic Ignition
- Add-A-Room With Flaps
- Electric Brakes
- Outside Gas Grill
- Battery Box
- Power Lift

# ROCKWOOD FREEDOM FLOORPLANS

**1620**

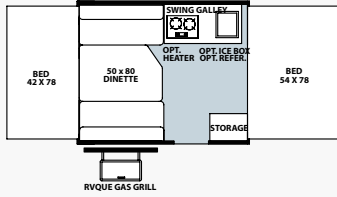

**1910**

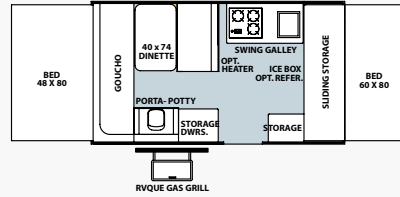

**1920BH**

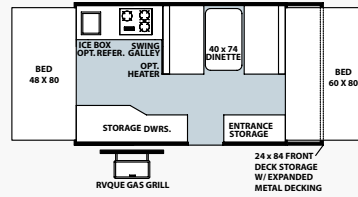

**1950**

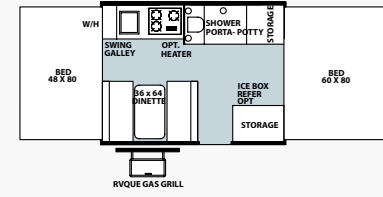

**1970**

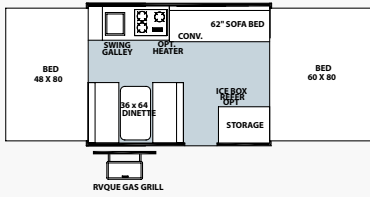

**1980**

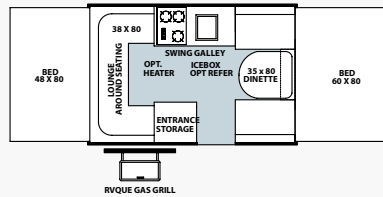

**2270**

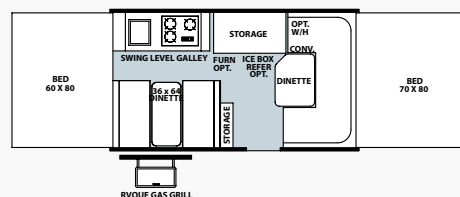

**2280**

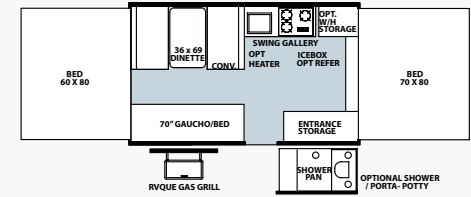

**2280BH**

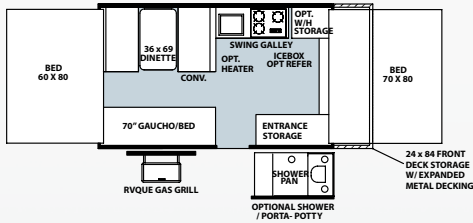

**2318G**

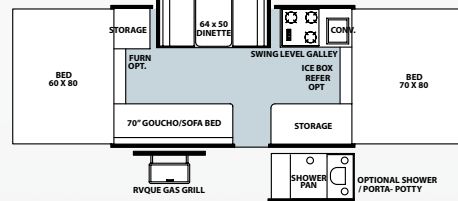

**1640LTD**

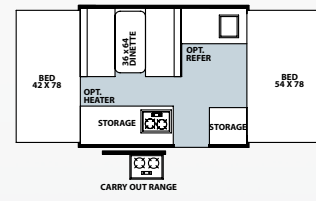

**1940LTD**

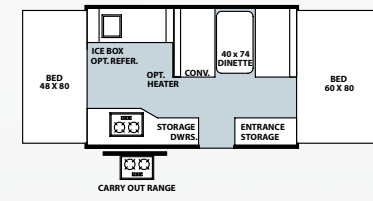

**190XR**

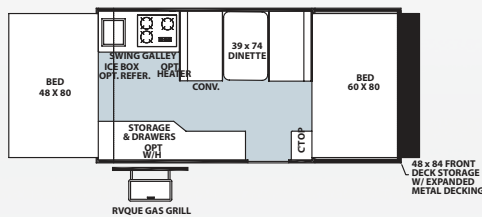

**232XR**

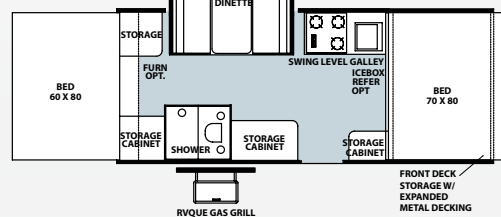

**282TXR**

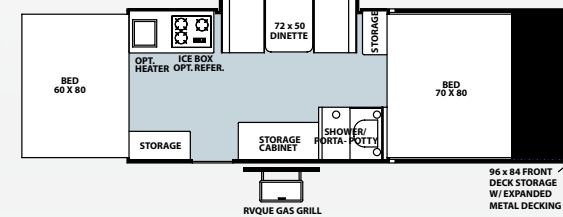

**291TXR**

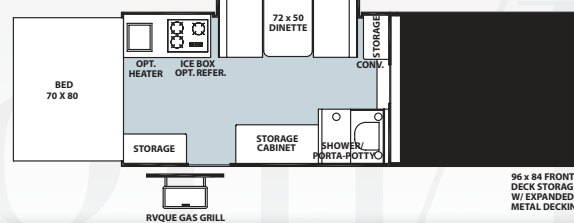

# ROCKWOOD PREMIER · STANDARDS & OPTIONS

## PREMIER STANDARD FEATURES

- Residential Style Kitchen Faucet w/ Electric Water Pump
- Larger Deeper Sinks
- Soft Quilted Top Innerspring Mattresses
- Outdoor Gas Grill w/ Worktable
- Sliding Storage Tray on All Front Trunk Models (Except 1904)
- Water-Pur Filtration System
- E-Z Crank-Down Stabilizer Jacks w/ Sand Pads
- Electric Brakes (12' Models)
- Residential Style Raised Panel Doors
- 3 Double Ceiling Lights w/ Jacks for Accessories
- Bunk Light w/ Fan
- Permanently Mounted 3-Burner Indoor Range w/ Stove Cover
- Free Standing Table - High Pressure Laminate
- Comfortable Family Style Dinette w/ 4" Reversible Cushions
- Large Clothes Bar
- LP Leak Detector
- Port-a-Potty 1904 and 2514G Models
- Drawer Guides
- Hot Water Pkg. - Incl. Water Filter, Outside Shower, Six Gallon Hot Water Heater, Demand Water Pump
- Swing Level Galley
- AM/FM Stereo w/ CD Player

- Outside Speaker
- Electric Lifter system
- Awning

## STANDARD CONSTRUCTION FEATURES

- Smooth Fiberglass Vacuum Bonded Exterior
- 3-Stage Double Arm Lifter Posts
- Fiberglass Vacuum Bonded Radius Roof w/ No Center Seam
- One Piece Screen Door
- Five Piece Sectionalized Vinolon Supreme Tenting
- Under Floor 20 Gallon Fresh Water Tank
- Black Water Holding Tank (Shower Models Only)
- Automotive E-Coated Tubular Steel Frame
- One Piece Undercoated Structurewood Floor
- 13" Radial Tires (12" Models)
- 7-Way Pigtail Plug
- Tent Permanently Attached on Bunk Ends and Slide Out
- Full Perimeter Aluminum Bed Frames
- Tinted Vinyl Windows
- Powder Coated Rafter Poles and Bed Bows
- Steel Air Conditioner Vent Reinforcing Laminated Into Roof
- Plywood Bunk Ends
- Easy Lube Axles
- Two-Tone Fabric Interiors
- Independent Torsion Axles

- Lower Door Operational in Closed Position
- 2000 lb. Tongue Jack w/ Swivel Wheel
- Seamless, High Density Polyethylene Wells
- Battery Box and Wiring Kit
- 20 lb. LP Bottle

## PREMIER POPULAR EXTRAS

- Create-A Breeze Three Speed Fantastic Fan
- Thermostatically Controlled Heated Mattresses
- 17,000 BTU Forced Air Furnace w/ Electric Ignition
- Extra-Large 2.5 Cubic Ft. Refrigerator
- Add-A-Room With Flaps
- Option Pkg. A (Incl. Lined Privacy Curtains, Roof Valances, Patio Light, 110 Exterior Outlet)
- Option Pkg. B (Incl. Spare Tire, Tire Bracket, Tire Cover, Step)
- Overhead Kitchen Pantry
- Hanging Wardrobe
- Bike Rack
- Air Conditioning Wiring Kit
- 13" Radial Tires (10' Models)
- Dual 20 lb. LP Bottles
- Power Front Jack
- Tire Pressure Monitoring System

## ROCKWOOD FREEDOM/LTD SERIES

MODEL	1904	1907	2307	2317G	2514G	2516G
GVWR (Gross Vehicle Weight Rating)	2953	2732	3258	3318	3263	3252
Base/Dry Unit Weight	1917	1796	2291	2445	2446	2473
Base/Dry Hitch Weight	247	221	298	358	303	292
Base/Dry Axle Weight	1670	1575	1993	2087	2143	2181
Cargo Capacity	1017	917	948	854	798	760
Box Size	10'	10'	12'	12'	12'	12'
Trailer Size (Closed - w/ Hitch)	15' 5"	14'	15' 11"	17' 11"	17' 11"	17' 11"
Height (Closed)	57"	57"	57"	61"	61"	61"
Trailer Length (Open)	20' 2"	20' 2"	20' 8"	23' 6"	23' 6"	23' 6"

Model number of any particular unit does not necessarily reflect the overall length of the unit itself. Dry weight are estimates.



# ROCKWOOD PREMIER · FLOORPLANS

**1904**

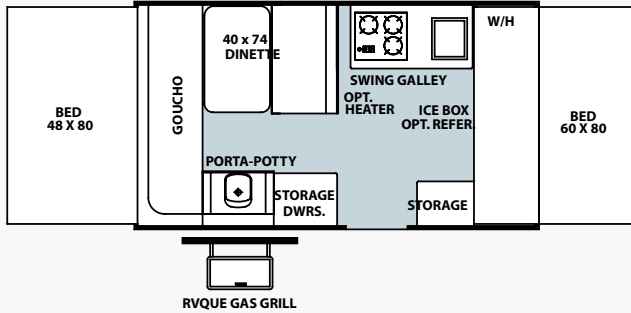

**1907**

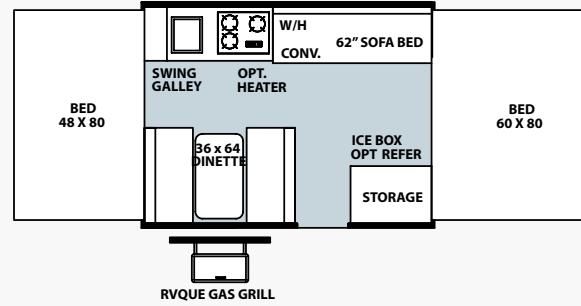

**2307**

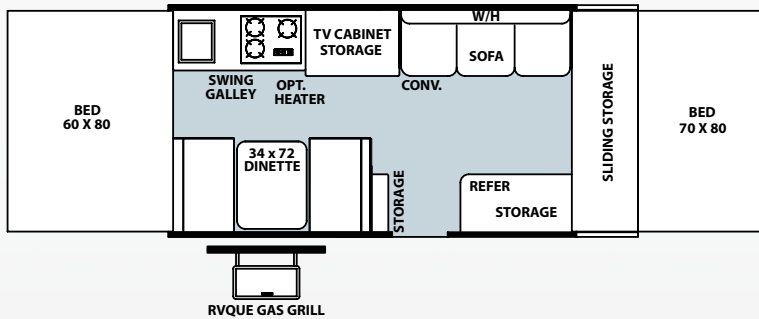

**2317**

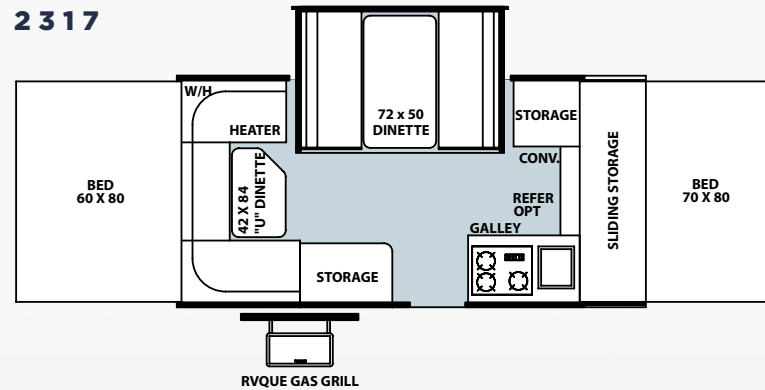

**2514 G**

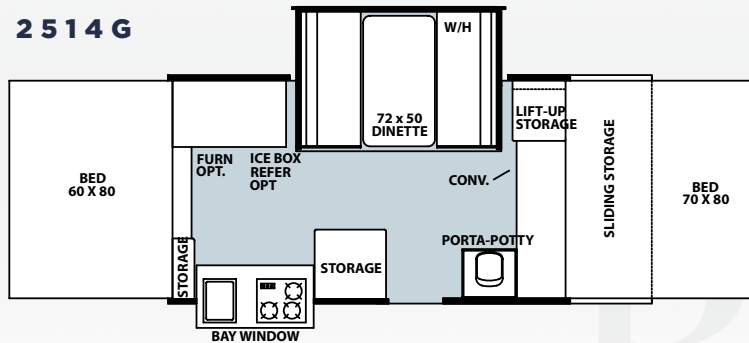

**2516 G**

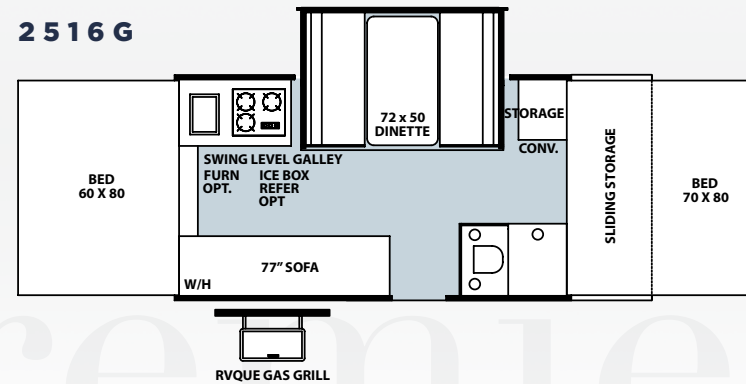

FOREST RIVER'S HALLMARK OF EXCELLENCE:  
**PRE-DELIVERY INSPECTION FACILITIES**

## PEACE OF MIND.

Forest River has yet another exclusive feature to offer: One year of free roadside assistance will be given to every 2009 Rockwood customer. This is just one more way to say "Thank you" and to ensure an enjoyable traveling experience.



## THAT'S 20,000 SQUARE FEET OF QUALITY ASSURANCE. THE BARE ESSENTIALS FOR A PREMIUM PRODUCT.

Brought online in 2005, Forest River is proud of its state-of-the-art test facility. This beautiful building blends many of the old tried and true methods of testing our diverse types of RVs with new innovative ways of solving quality issues. Being centrally located to most Forest River manufacturing facilities, this 20,000 square foot PDI (Pre-delivery Inspection) test building gives immediate daily feedback to individual managers. This assures the production facilities that nothing has slipped by the plant's quality assurance personnel and the units are "green" and ready to ship.

### YOUR ROCKWOOD DEALER

For details on Rockwood's complete warranty program, see your Rockwood dealer. When it comes to backing products with the same quality and commitment it does when it begins the manufacturing process, the only name you have to remember when you're looking for a recreational vehicle is Rockwood. Rockwood offers the following additional limited warranties to the original purchasers. Consult written warranty for details.

1. Five-year roof warranty, 2. Twenty-five-year floor warranty, 3. Five-year frame warranty, 4. Five-year tent warranty, 5. Five-year warranty on torsion axle suspension, 6. Limited life-time warranty of lifter system, 7. One-year bumper to bumper. Ask your dealer about the available lifetime structural warranty.



All specifications contained herein are based on the latest product information at time of printing. Forest River reserves the right to make changes in colors, materials, equipment and specifications at any time without notice and assumes no responsibility for any errors in this brochure.