

ADMIRAL[®]
2009



HOLIDAY RAMBLER[®]

This is Living[®]



Admiral





355FD | INFINITY | NEWPORT CHERRY



LET'S GET ROLLING.

There's a lot of country out there, and the 2009 Admiral is a great way to see it all and do it all. This popular motorhome boasts an impressive new exterior, with full-body paint and painted graphics. You'll find a wide range of beautiful details inside, including new raised panel cabinet doors, solid surface countertops and cozy Leatherette recliner cockpit seats. Select models offer the incomparable spaciousness of our exclusive PanaSuite full-wall slide-out on the driver's side. It's just a few of the ways the Admiral makes a great home on the road.



9-LAYER ROOF CONSTRUCTION

(top to bottom)

- One-piece peaked fiberglass roof
- Luaun backing
- Thick, tapered bead foam insulation
- Aluminum double I-beam superstructure filled with fiberglass insulation
- Vapor barrier
- Structure foam: thermal insulative barrier
- 1/2" bead foam insulation
- Foam padding for extra insulation
- Padded vinyl ceiling



When you purchase a Holiday Rambler, you can be sure the storage boxes are some of the strongest and most reliable you'll find anywhere. They feature our exclusive multi-layer construction to give you maximum insulation and to reduce the chance of warping, twisting or shifting.

4-LAYER SIDEWALL CONSTRUCTION

(right to left)

- Smooth gel coat fiberglass wall
- 1-1/2" thick foam insulation
- 1-1/2" x 1-1/2" square tubular aluminum frame
- Interior paneling



4-LAYER FLOOR CONSTRUCTION

(top to bottom)

- Structurwood™
- High-performance thermal insulation foam
- 1-1/2" aluminum tube
- Three-ply poly underbelly

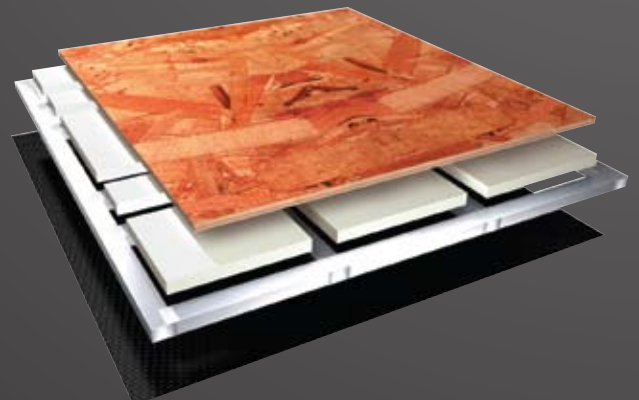

COLORS AND PATTERNS IN PERFECT HARMONY.

Leave it to Holiday Rambler to give you the most enticing choices of exterior colors and interior decors. Choose the one that fits your style — from boldly sophisticated to classic elegance. Then, put it all together with your favorite cabinetry selection, and you've created a masterpiece all your own.



NEWPORT CHERRY II



CHAMPAGNE SELECT



INFINITY



HONEY COMB III



ALPINE II



Manufactured in, not added on. For added protection against stains, soil repellent is applied to virtually all upholstery fabric during the finishing process for superior coverage.*

*Brand and application of upholstery fabric protection may vary depending on date recreational vehicle was manufactured.

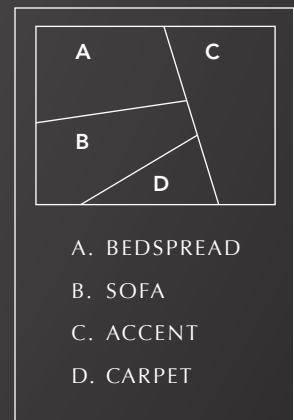



BODY CONSTRUCTION: FEATURES

- Laminated Sidewall Construction
- Steel Cage Cockpit Construction
- Smooth Gel Coat Fiberglass Exterior Walls
- Front Molded Fiberglass Caps
- Panaview™ 1-Piece Front Windshield
- Large Chrome Front Grille
- Rear Cap with Large Automotive Style Taillights
- Interior Height 84"
- One-Piece Interior Engine Cover
- Front-Mounted 17.5" Chrome Head Exterior Mirror with Power Control Heads and Heat
- Metal Fuel Door with Lock
- One-Piece Polyethylene Pass-Through Storage Compartment
- Side-Hinged Baggage Doors, All Door Locations
- Full-Body Paint with Painted Graphics, Awning with Metal Covers
- Rear Ladder
- Undercoating

OPTIONS

- Film Front Protection Mask
- Standard Run Savings Package: Film Front Protection Mask, Hardwood Raised Panel Doors on Refrigerator, 3-Camera Rear Vision System, Central Vacuum System, Front Living Room Area DVD Player, RV Sani-Con 2 System and 12V Heater in Wet Bay

FORD 20,500 LB. CHASSIS/ENGINE/SUSPENSION (30SFS ONLY): FEATURES

- 6.8L 3-Valve V-10 Gasoline Engine with Electronic Fuel Injection
- Engine Displacement: 6.8 Liters 415 Cu. In.
- Power: 362 HP, Torque: 457 lbs./ft.
- TorqShift 5-Speed Automatic Overdrive Transmission with Tow/Haul Mode
- Transmission Oil Temperature Gauge
- Fuel Tank Capacity 75 Gallon
- 130 Amp Alternator
- Rear Axle Ratio 5.38:1
- Stainless Steel Wheel Liners
- Leaf Spring Suspension
- Front and Rear Disc, 4-Wheel Anti-Lock Brakes
- Heavy-Duty Front Track Bar with Sachs® Shock Absorbers
- Fully Automatic Hydraulic Leveling System
- Prewire for Supplemental Braking System
- 5,000 Lb. Hitch Receiver with Dual Connector 4-Pin or 7-Pin
- SmartStructure II

WORKHORSE 20,700 LB. CHASSIS/ENGINE/SUSPENSION (30SFS ONLY): FEATURES

- 8.1L V-8 Gasoline Engine with Electronic Fuel Injection
- Engine Displacement: 8.1 Liters 496 Cu. In.
- Power: 340 HP, Torque: 455 lbs./ft.
- 6-Speed Automatic Transmission with Overdrive
- Fuel Tank Capacity 75 Gallon
- 145 Amp Alternator
- Rear Axle Ratio 5.13:1
- Stainless Steel Wheel Liners
- Leaf Spring Suspension
- ABS Brake System
- Fully Automatic Hydraulic Leveling System
- Prewire for Supplemental Braking System
- 5,000 Lb. Hitch Receiver with Dual Connector 4-Pin or 7-Pin
- SmartStructure II

FORD 22,000 LB. CHASSIS/ENGINE/SUSPENSION (N/A: 30SFS AND 33SFS): FEATURES

- 6.8L 3-Valve V-10 Gasoline Engine with Electronic Fuel Injection
- Engine Displacement: 6.8 Liters 415 Cu. In.
- Power: 362 HP, Torque: 457 lbs./ft.
- TorqShift 5-Speed Automatic Overdrive Transmission with Tow/Haul Mode
- Transmission Oil Temperature Gauge
- Fuel Tank Capacity 75 Gallon
- 130 Amp Alternator
- Rear Axle Ratio 5.38:1
- Wheel/Rims Polished Aluminum Wheels
- Leaf Spring Suspension
- Front and Rear Disc, 4-Wheel Anti-Lock Brakes
- Heavy-Duty Front Track Bar with Sachs® Shock Absorbers
- Fully Automatic Hydraulic Leveling System
- Prewire for Supplemental Braking System
- 5,000 Lb. Hitch Receiver with Dual Connector 4-Pin or 7-Pin
- SmartStructure II

WORKHORSE 22,000 LB. CHASSIS/ENGINE/SUSPENSION (N/A: 30SFS): FEATURES

- 8.1L V-8 Gasoline Engine with Electronic Fuel Injection
- Engine Displacement: 8.1 Liters 496 Cu. In.
- Power: 340 HP, Torque: 455 lbs./ft.
- 6-Speed Automatic Transmission with Overdrive
- Fuel Tank Capacity 75 Gallon
- 145 Amp Alternator
- Rear Axle Ratio 5.86:1
- Aluminum Wheels
- Leaf Spring Suspension
- ABS Brake System
- Fully Automatic Hydraulic Leveling System
- Prewire for Supplemental Braking System
- 5,000 Lb. Hitch Receiver with Dual Connector 4-Pin or 7-Pin
- SmartStructure II

COCKPIT: FEATURES

- Fiberglass Automotive Dash with Vinyl Covering, Oxford Burl Instrumentation Panel
- In-Dash AM/FM/CD Stereo Radio with Sirius-Ready Compatibility, Aux-in-Connection, SD Card Slot and Weather Band
- Front Power Sunvisors
- Rear Vision System Prep
- Leatherette Pilot and Co-Pilot Cockpit Recliner Seats
- Carpeted Driver and Passenger Floor Mats

OPTIONS

- Sirius Satellite Radio Tuner with Antenna
- Single Camera LCD Rear Vision System
- 3-Camera LCD Rear Vision System with Cameras in Exterior Mirrors
- Interior Solar Privacy Screens
- GPS Navigation System
- Six-Way Power Pilot Seat (Required Option)
- Driver-Side Door with Electric Window

APPLIANCES AND ACCESSORIES: FEATURES

- Large Double-Door Refrigerator
- High-Output 3-Burner Cooktop without Oven
- Bi-Fold Range Cover
- Spacesaver Convection Microwave with Touch Control
- 26" LCD Stereo Color TV with Remote Control in Cockpit Overhead (N/A: 33SDD, 34SBD)
- 32" LCD Stereo Color TV with Remote Control on Living Room Wall (33SDD, 34SBD Only)
- 19" Bedroom Widescreen LCD TV
- Curbside: Exterior Hook-Ups for DSS Dish, Cable, 110V Outlet, with Hatch Door to Exterior
- Digital Satellite System Prep
- Curbside: Exterior Gas Line Hook-Up Prep for LP Accessories

OPTIONS

- Large Double-Door Refrigerator with Ice Maker 10 Cu. Ft.
- Large Four-Door Refrigerator with Ice Maker (N/A with Pantry) (N/A: 30SFS and 33SFS)

- High-Output Three-Burner Range with Oven
- Washer/Dryer Prep (34SBD and 36PCT Only)
- Combination Washer/Dryer (Requires Washer/Dryer Prep Option) (34SBD and 36PCT Only)
- Central Vacuum System
- Front Living Room Area DVD Player
- Bedroom DVD Player
- 26" LCD Pull-Out TV with Stereo, CD Player, DVD Player and Sub Woofer inside Storage Bay

INTERIOR: FEATURES

- Raised Panel Cabinet Doors
- Black ABS Refrigerator Insert
- Wallpaper Border Kitchen and Bath
- Heavy-Duty Ball Bearing Drawer Guides
- Wood Cabinet Drawer Boxes
- Solid Surface Kitchen Countertop with Solid Surface Edge Treatment and Backsplash
- Kitchen Countertop Extension with Two Drawers Below and 110V Outlet (34SBD Only)
- Large Kitchen Countertop Pullout Extension with Drawers Below (36PCT Only)
- All Other Countertops (except Kitchen Laminated with Wood Grain Rubber Edge Treatment)
- Kitchen Pantry next to Refrigerator with Full-Height Wire Roll-Out Storage (N/A with Four-Door Refrigerator Option) (N/A: 30SFS)
- Carpeting with Pad in Living Area and Bedroom
- Soft Touch Padded Vinyl Ceiling
- Wood Grain Crown Molding in Bedroom and Living Area
- Wood Slide-Out Fascia with Wood Inserts
- Satin Nickel Cabinetry Hardware and Bath Accessories

- Hardwood Framed Pocket Doors with Flat Panel Insert, Slide-Bolt Door Latch (N/A: 33SDD, 35SFD)
- Blackout Day/Night Pleated Shades in Living Area and Bedroom

OPTIONS

- Decors: Honey Comb III, Alpine II, and Infinity
- Wood Choice: Newport Cherry II, Champagne Select
- Hardwood Raised Panel Doors on Refrigerator IPO Black ABS Refrigerator Insert

FURNITURE: FEATURES

- Queen Bed with Nightstands (60"X 74" – 30SFS, 33SFS, 34SBD) (60"X 80" – 33SDD, 35SFD, 36PCT)
- Arched Back Wood Booth Dinette, with Side-Sliding Dinette Tabletop (33SDD, 34SBD, 36PCT Only)
- Freestanding Dinette with Two New-Style Freestanding Chairs and Two Folding Chairs (30SFS, 33SFS, 35SFD Only)
- Roadside: New Style Fabric Comfort Lounge Sofa
- Curbside: New Style Fabric Love Seat Sofa (35SFD Only)
- New Style Leatherette Swivel-Rocker Barrel Chair (N/A: 30SFS, 33SDD and 35SFD)

OPTIONS

- Roadside: Fabric Hide-A-Bed Sofa with Air Mattress
- Roadside: Leatherette Hide-A-Bed Sofa with Air Mattress
- Roadside: Leatherette Ensemble Booth Dinette Includes Leatherette Hide-A-Bed Sofa Selection with Air Mattress; Forward-Facing Seatbelts at Booth Dinette Not Available with This Option (33SDD, 34SBD and 36PCT Only)
- Curbside: New Style Leatherette Love Seat Sofa IPO Fabric Love Seat Sofa (35SFD Only)
- Curbside: One Leatherette Euro-Recliner with Ottoman; Wall-Mounted Table IPO Sofa (35SFD Only)
- Curbside: New Style Leatherette Swivel Recliner IPO Swivel Rocker Barrel Chair (33SFS and 34SBD Only)
- Curbside: Leatherette Euro-Recliner with Ottoman IPO Leatherette Swivel Rocker Barrel Chair (N/A: 30SFS, 33SDD and 35SFD)
- Hallway Bunks with Two Fold-Down DVD Players with Game Hook-Ups and Light at Each Bunk; Two Wireless IR Headphones and Bunk Ladder (34SBD Only)
- Narrowed Arched Back Wood Booth Dinette, with Side-Sliding Dinette Tabletop (N/A: 33SDD, 34SBD and 36PCT)
- Freestanding Dinette with Two New-Style Freestanding Chairs and Two Folding Chairs (33SDD, 34SBD and 36PCT Only)



ELECTRICAL SYSTEMS AND LIGHTS: FEATURES

- 30 Amp 120V Distribution Panel and Cord (30SFS Only)
- 50 Amp 120V Distribution Panel and Cord (N/A: 30SFS)
- 60 Amp Electronic 12V Power Converter
- Onan® 4.0 kW Generator (30SFS Only)
- Onan® 5.5 kW Gas Generator (N/A: 30SFS)
- Two 6V House Batteries
- Battery Disconnect Switches
- Exterior Power Entry Step with Light
- Water Pump Switch in Service Bay Area and Convenience Center
- Lights in Outside Storage Compartments
- Underhood Utility Light
- Two Recessed Ceiling Map Lights above Cockpit Seats
- Hallway Convenience Center

- Decorative Satin Nickel Lighting: Living Room Wall Light, Dinette Overhead Light and Bath Vanity Light

OPTIONS

- 50 Amp Energy Management System (N/A: 30SFS)
- 600 Watt Inverter (N/A: 30SFS)

PLUMBING AND LP SYSTEMS: FEATURES

- Two-Hole Kitchen Hi-Rise Faucet with Soap Dispenser
- Central Water Filtration System
- Stainless Steel Bath Lavatory Bowl
- Satin Nickel Bath Lavatory Faucet
- Demand Water System and Water Pump
- 10-Gallon LP Gas/Electric Water Heater with Electronic Ignition, DSI
- Winterization Valving System
- Water Heater Bypass Valve
- China Toilet with Sprayer
- Holding Tank Rinsing System
- Insulated Systems Compartment with Easy Access to Hook-Up
- Shower inside Wet Bay with Hot/Cold Water and Shower Head with Shut-Off
- Gravity and Pressurized Water Fill (N/A: 35SFD)

- Contained Storage Area for Sewer Hose
- Shower Faucet with Shower Hose and Head with Shut-Off

OPTIONS

- RV Sani-Con 2 System
- Bathtub Option IPO Shower; ABS Surround with New Shower Doors

HEATING, VENTS AND AIR CONDITIONING: FEATURES

- Dual 13.5M BTU Air Conditioner with Ducted Air (N/A: 30SFS)
- Single 13.5M BTU Air Conditioner with Ducted Air (30SFS Only)
- 31M BTU Electronic Ignition Furnace (30SFS Only)
- 35M BTU Electronic Ignition Furnace (N/A: 30SFS)
- Electronic Dash AC/Heat Climate Control System
- Kitchen 12V Roof Vent
- Bath 12V Roof Vent

OPTIONS

- Dual 15M BTU Air Conditioner with Heat Pumps IPO 13.5 (N/A: 30SFS)

- Single 15M BTU Air Conditioner with Heat Pump IPO 13.5 (30SFS Only)
- Kitchen Powered Attic Fan with Wall Control of Automatic Dome and Fan Power
- Bath Powered Attic Fan with Wall Control of Automatic Dome and Fan Power
- 12V Heater in Wet Bay, Heat Pad on Fresh Tank

WINDOWS, DOORS AND AWNINGS: FEATURES

- Radius Flush-Mounted Dual Pane Windows Safety Glass Dark Tinted
- Rear Wall Bedroom Window (33SDD, 34SBD, 35SFD and 36 PCT)
- Bathroom Window (35SFD and 36PCT Only)
- 30" Wide Radius Entrance Door with Clear Glass, Roller Shade, Screen Door and Anti-Skid Steps
- Topper Slide-Out Awnings Living Area and Bedroom
- Protecta Glaze Tinted Plexiglas® Skylight in Bathroom
- Awning Rail

OPTIONS

- Patio Awning with Metal Cover
- Eclipse Poly-Weave Automatic Patio Awning with Metal Cover
- Poly-Weave Window Awnings Living Area Slide-Out House Windows
- Poly-Weave Side Window Awning Bedroom (N/A: 34SBD and 35SFD)

SAFETY: FEATURES

- Fire Extinguisher
- Deadbolt Lock on Entrance Door
- 120V GFI Protected Circuit, Kitchen, Bath and Exterior
- LP Gas Detector
- Smoke Detector
- Carbon Monoxide Detector
- Pilot and Co-Pilot Three-Point Seatbelts
- Third Brake Safety Light
- Egress Windows

Weights* (Ford 20,500 Lb. Chassis)	30SFS	33SFS	33SDD	34SBD	35SFD	36PCT
Gross Vehicle Weight Rating	20,500	N/A	N/A	N/A	N/A	N/A
Gross Combined Weight Rating	25,500	N/A	N/A	N/A	N/A	N/A
Front Gross Axle Weight Rating	7,500	N/A	N/A	N/A	N/A	N/A
Rear Gross Axle Weight Rating	13,500	N/A	N/A	N/A	N/A	N/A
Weights* (Workhorse 20,700 Lb. Chassis)						
Gross Vehicle Weight Rating	20,700	N/A	N/A	N/A	N/A	N/A
Gross Combined Weight Rating	25,700	N/A	N/A	N/A	N/A	N/A
Front Gross Axle Weight Rating	7,500	N/A	N/A	N/A	N/A	N/A
Rear Gross Axle Weight Rating	13,500	N/A	N/A	N/A	N/A	N/A
Weights* (Ford 22,000 Lb. Chassis)						
Gross Vehicle Weight Rating	N/A	N/A	22,000	22,000	22,000	22,000
Gross Combined Weight Rating	N/A	N/A	26,000	26,000	26,000	26,000
Front Gross Axle Weight Rating	N/A	N/A	7,500	7,500	7,500	7,500
Rear Gross Axle Weight Rating	N/A	N/A	14,500	14,500	14,500	14,500
Weights* (Workhorse 22,000 Lb. Chassis)						
Gross Vehicle Weight Rating	N/A	22,000	22,000	22,000	22,000	22,000
Gross Combined Weight Rating	N/A	26,000	26,000	26,000	26,000	26,000
Front Gross Axle Weight Rating	N/A	8,000	8,000	8,000	8,000	8,000
Rear Gross Axle Weight Rating	N/A	14,500	14,500	14,500	14,500	14,500
Measurements						
Wheelbase	190"	228"	208"	228"	228"	228"
Overall Length	31'-0"	34'-3"	34'-3"	35'-2"	36'-1"	36'-9"
Overall Height, Including A/C	12'-6"	12'-9"	12'-9"	12'-9"	12'-9"	12'-9"
Interior Height	84"	84"	84"	84"	84"	84"
Interior Width	96"	96"	96"	96"	96"	96"
Exterior Width	100.5"	100.5"	100.5"	100.5"	100.5"	100.5"
Tank Capacities** (Gal.)						
Water Heater	10	10	10	10	10	10
Gray Tank	54	54	57	55	57	60
Black Tank	45	45	40	42	42	40
Fresh Tank	80	80	80	80	80	80
LP Tank***	20	20	21	20	20	24

* Towing capacity is limited by GCWR; your vehicle's towing capacity is the difference between the GCWR and the actual vehicle weight, including all water, fuel, passengers and cargo. Your towed vehicle should be equipped with auxiliary brakes if the weight of the towed vehicle exceeds 1,000 lbs. Consult your owner's manual for further towing information.

** All tank capacities are estimated based upon calculations provided by the tank manufacturers and represent approximate capacities. The actual "usable capacity" may be greater or less than the estimated capacities based upon fabrication and installation of the tanks.

*** Actual filled LP capacity is 80% of listing due to safety shut-off required on tank.

The actual overall length of the recreational vehicle may differ from that indicated in the brochure due to variances in the manufacturing process and/or installed components. The actual length may be greater or less than that indicated. Due to the large variety of options and floorplan arrangements available to our customers, actual weights for each unit can differ significantly. Holiday Rambler provides a weight sticker on each unit we produce which includes that unit's tank capacities and approximate weight. Consult your local Holiday Rambler dealer for unit availability and further information. The information printed in this brochure reflects product design, fabrication, and component parts at the date of printing. The manufacturer reserves the right, at any time, to make changes in product design or material or component specifications as its sole option, without notice. This includes the substitution of components of a different brand or trade name which will result in comparable performance. All information printed in this brochure is subject to change after the date of printing. Some features shown or mentioned in this brochure are optional and may only be available in selected floorplans. Photographs may show props or decorations that are not standard equipment on Holiday Rambler models. Holiday Rambler, the Holiday Rambler logo and its design, are registered trademarks. All other products and company names are trademarks and/or registered trademarks of their respective holders. While the color of the motorhome's exterior and the interior fabrics depicted in this sales brochure are fair and reasonable depictions, the colors depicted may not be an exact match of the actual colors because of the variances in photo-processing and variances caused by inserting the photographs within the sales brochure. Due to product improvements, changes during the model year and/or transcription errors that may occur, information represented within this brochure may not be accurate at the time of your purchase. If certain information is significant to your purchasing decision, please confirm the information with your dealer prior to submitting your order. Component part and appliance manufacturers issue limited warranties covering those portions of the recreational vehicle not covered by the Limited Warranties issued by Monaco Coach Corporation. To learn which specific component parts and appliances are excluded from the Limited Warranties issued by Monaco Coach Corporation, please contact your selling dealership or Monaco Coach Corporation directly, or review the warranty packet inside the recreational vehicle.



EXCLUSIVE HYDRAULIC

FULL-WALL SLIDE
PANAsuite

30SFS

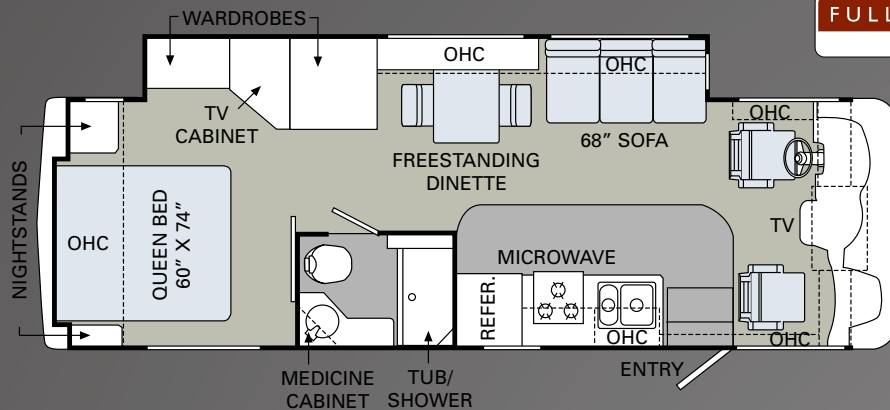

EXCLUSIVE HYDRAULIC

FULL-WALL SLIDE
PANAsuite

33SFS

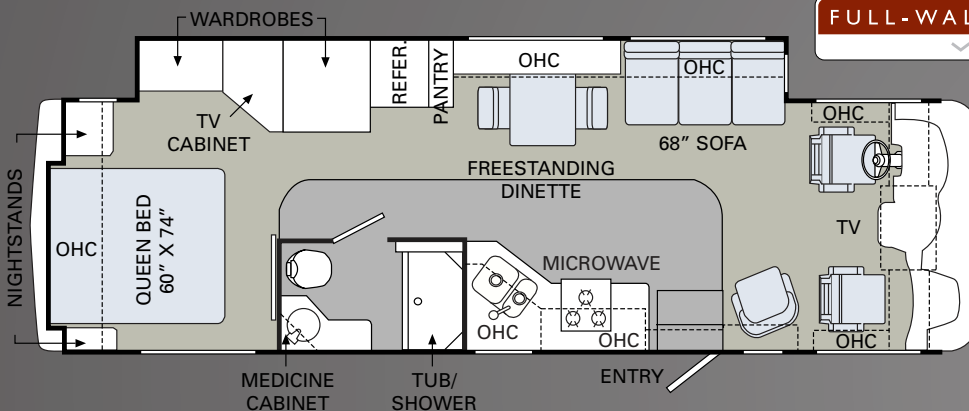

33SDD

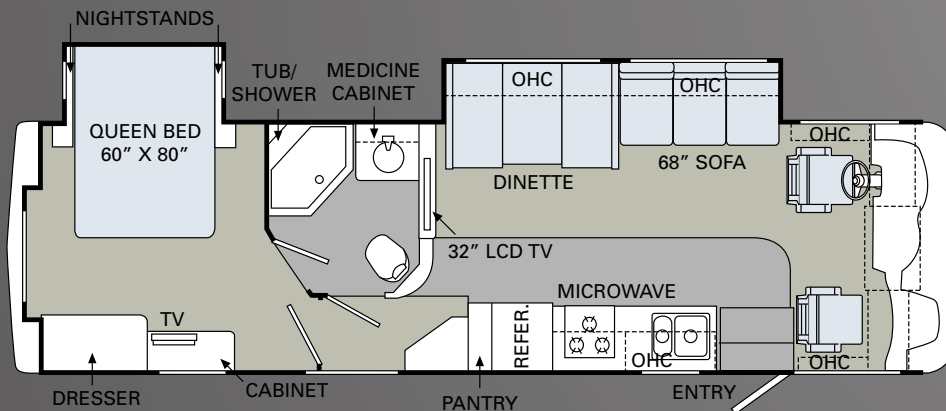

H O L I D A Y R A M B L E R . C O M

Log on to our website anytime, night or day. It's your link to everything Holiday Rambler, including product news and updates, club events, dealer and service center info and much more. Take it for a test drive today.



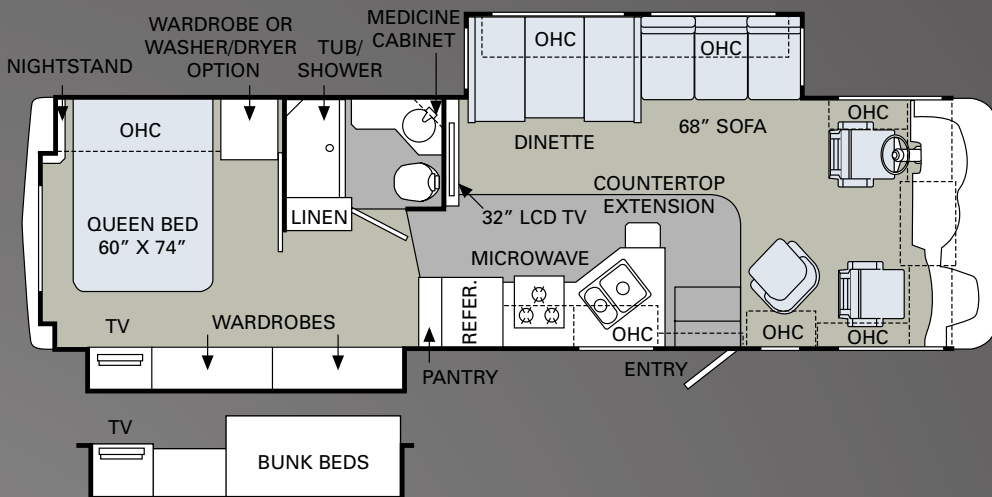

34SBD

EXCLUSIVE HYDRAULIC

FULL-WALL SLIDE

▼ PANASUITE

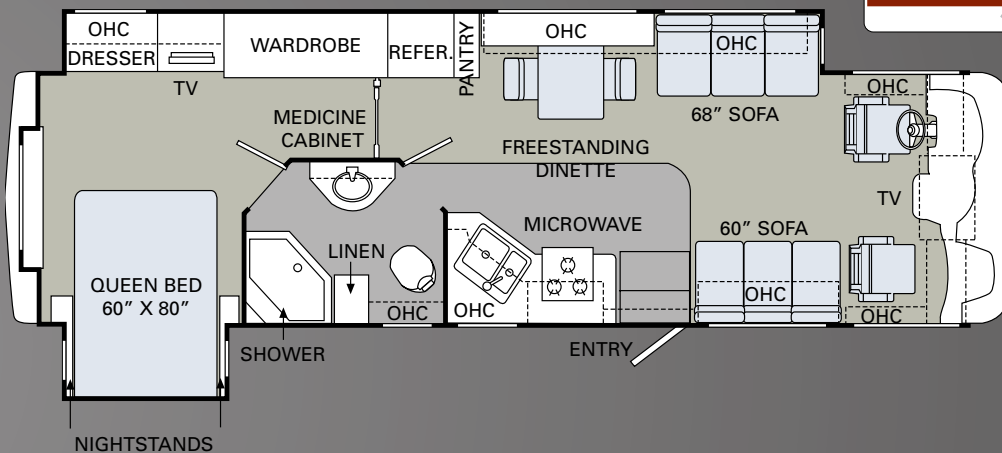

35SFD

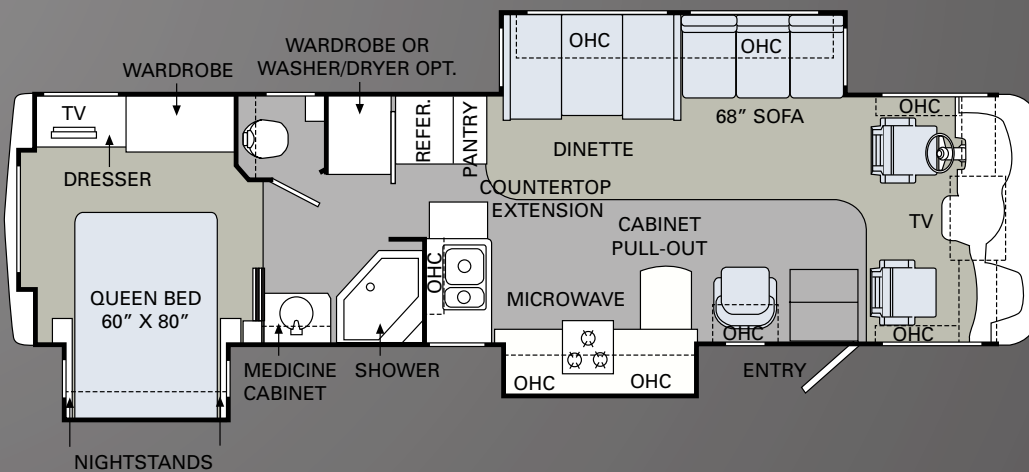

36PCT

■ CARPET | □ TILE



WE'RE HERE. ANYTIME, EVERY TIME.

- Reach us anytime — literally — via our live customer support line.
- Drive in to one of our 350 Service Centers.
- Enjoy the first year free when you enroll in our Owner Advantage Roadside Assistance Program.
- See where it all begins with a tour of one of our facilities in Indiana or Oregon. Call 1-800-650-7337 or 1-800-634-0855 to find out more.

ADMIRAL®
2009



HOLIDAY RAMBLER®

This is Living®

BEING DIFFERENT MAKES ALL THE DIFFERENCE.

Take a closer look, and you'll discover that Holiday Rambler, a brand of Monaco Coach Corporation, gives you more industry "bests" than any other RV manufacturer. Like the incomparable ride and handling of the Roadmaster Chassis. The convenience of our 350 service centers. The peace of mind of 24/7 roadside assistance. The value of Monaco Financial Services. And the online support of holidayrambler.com. At Holiday Rambler, we've built our reputation by listening to you — and answering to you. And that's the difference that's made us the best.

WARRANTIES

12 MONTH/24,000 MILE basic limited warranty

5 YEAR/50,000 MILE limited warranty on aluminum or steel frame structure of sidewall, roof, front and rear cap

Applies to certain models. See owner's manual for complete details.

NAVIGATOR®



IMPERIAL™



SCEPTER®



ENDEAVOR®



AMBASSADOR®



NEPTUNE®



VACATIONER®



ADMIRAL®



ARISTA™



ATLANTIS®



AUGUSTA

