

Work and Play

Ultra and Ultra “Eagles Nest”

By Forest River Inc.

Ultra Light.....

Ultra Cool.....



* Hot New Designer Interior Fabrics

* Abundant Overhead Cabinet Storage

* “L” Shaped Kitchen gives the comforts of home

New for this year is the Ultra Product Line. You will find new and innovative ideas along with new décor packages. Also bringing modern looks and comforts not seen in the past. In this line up we have tried to target lighter trucks while still maximizing carrying capacities.



(above) 25' – 23' - 21' UL... gives lots of room for sleeping as well as Toys, also all ½ Ton towable



7'x16' depending on how it is equipped is around 3600lb. It is designed for the small SUV's



With the Electric Bed in the up position and Sofa folded there is room for toys and the other stuff you may want to carry



With the Electric Bed and the Sofa in the sleeping position there is room for up to 4 people



The 5th Wheel, 27' UL is ½ Ton towable, with plenty of storage for personal stuff as well as “Toys”, so you don’t feel like you have to leave anything at home



“ Now you see it “



“ Now you don't ”

MODEL 18ULL

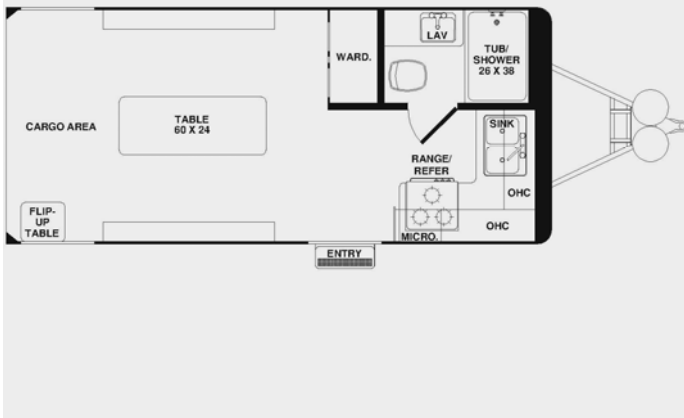

Introducing the Ultra Eagles Nest

The new **“Flush Pop-Up Roof”** with **“Drop Down Canvas”** makes a great second story **“Observation Deck or Bedroom With Couch that Folds Down into a 52”x74” Bed”** with the same floor plan as the ever popular 18LT only wider

MODEL 25UL



MODEL 23UL



MODEL 21UL



MODEL 27UL



MODEL 18ULL



MODEL 16UL

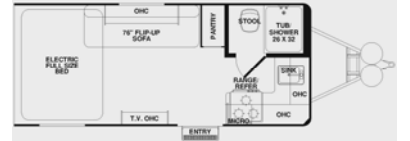

	16UL	18ULL	21UL	23UL	25UL	27UL
Exterior Length (Box)	20'	18'6"	21' 6"	23' 6"	25' 6"	29'
Length W/ Hitch	25'2"	23'2"	26'	28'	30'	29'
Exterior Width	7'	8'6"	8' 6"	8' 6"	8' 6"	8'6"
Exterior Height (A/C)	10'11"	12'6"	10' 11"	10' 11"	10' 11"	11'6"
Interior Height	7 ft	6' 6"	7 ft	7 ft	7 ft	7' 7"
Interior Width	82"	98 1/2"	98 1/2"	98 1/2"	98 1/2"	98 1/2"
Dry Weight	4009 lb	6180 lb	5698 lb	6210 lb	6385 lb	7625 lb
GVWR	7000 lb	9846 lb	9200 lb	9200 lb	9200 lb	10000 lb
Tongue Weight	527 lb	1046 lb	671 lb	806 lb	1162 lb	1996 lb
Cargo Carrying C	3000 lb	3000 lb	3000 lb	3000 lb	3000 lb	3000 lb
Fresh Water	80 gal	80 gal	80 gal	80 gal	80 gal	80 gal
Grey Tank	38 gal	38 gal	38 gal	38 gal	38 gal	38 gal
Black Tank	26 gal	26 gal	38 gal	38 gal	38 gal	38 gal
Furnace BTU Rating	16,000	20,000	20,000	20,000	20,000	20,000
A/C	11,000	15,000	15,000	15,000	15,000	15,000
Cargo Length - RS/CS	11' 7"/ NA	10'6"/ NA	7'3"/10'6"	9'3"/11'10"	11'3"/13'10"	8'11"/10'11"
Area Between Wheel	NA	84"	84"	84"	84"	84"



Forest River, Inc 3010 College Avenue, Goshen, IN 46528
 Mail: Forest River c/o Work and Play P.O. Box 3030 Elkhart, IN 46515
 Phone; 574-533-5934 Fax; 574-535-2036
www.forestriverinc.com www.forestriveraccessories.com



As Work and Play constantly strives to improve our product, all specifications listed in this informative brochure are subject to change without notice or obligation. Photos may show optional equipment which is not included in the purchase price of the unit. Review a current model on your dealer's lot today. **CONSULT YOUR LOCAL DEALER FOR WARRANTY INFORMATION.**