

# Cherokee

*The best value for your family.*

Cherokee

by Forest River



*Presented by Forest River*

## Bunk Bed Travel Trailers



Kitchens w/Snack Bars



Loft Bunk with Closets and Entertainment Center



Bunk Room Sofa with Overhead Bunk

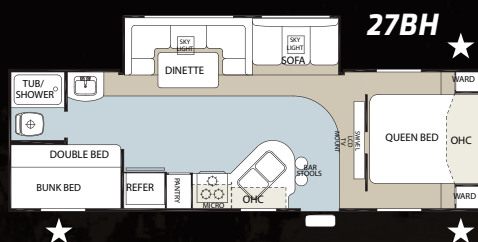

27BH	
Hitch Weight (lbs.)	927
Axle Weight (lbs.)	4808
Ship Weight (lbs.)	5735
GVWR w/Brakes (lbs.)	7927
Exterior Length	31'5"
Exterior Height w/ AC	11'9"
Bedroom Interior Height	84"
Furnace BTU	30
Grey Capacity (gal.)	41
Black Capacity (gal.)	31
Fresh Capacity (gal.)	50
Dinette Size	U-Shape
Sofa Size	58"
Awning Size	21'

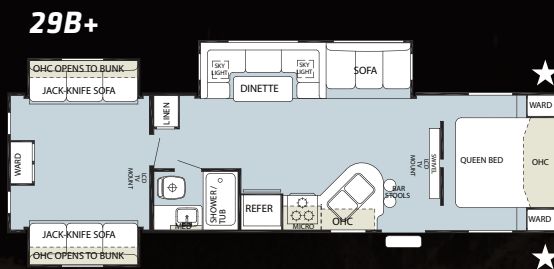

29B+	
Hitch Weight (lbs.)	1074
Axle Weight (lbs.)	6924
Ship Weight (lbs.)	7998
GVWR w/Brakes (lbs.)	11234
Exterior Length	35'10"
Exterior Height w/ AC	11'9"
Bedroom Interior Height	84"
Furnace BTU	30
Grey Capacity (gal.)	41
Black Capacity (gal.)	41
Fresh Capacity (gal.)	50
Dinette Size	U-Shape
Sofa Size	58"
Awning Size	TBA

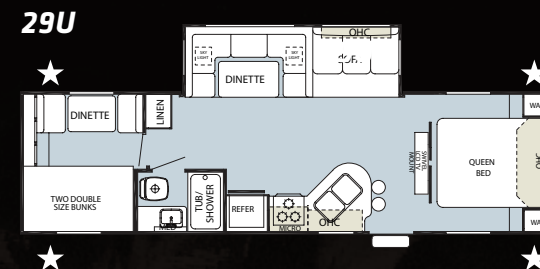

29U	
Hitch Weight (lbs.)	TBA
Axle Weight (lbs.)	TBA
Ship Weight (lbs.)	TBA
GVWR w/Brakes (lbs.)	TBA
Exterior Length	TBA
Exterior Height w/ AC	TBA
Bedroom Interior Height	TBA
Furnace BTU	TBA
Grey Capacity (gal.)	TBA
Black Capacity (gal.)	TBA
Fresh Capacity (gal.)	TBA
Dinette Size	TBA
Sofa Size	TBA
Awning Size	TBA

★ = OUTSIDE STORAGE

# Bunk Bed Travel Trailers



Skylights Over Dinettes



Hanging and Overhead Closets



Snack Bars w/Stools

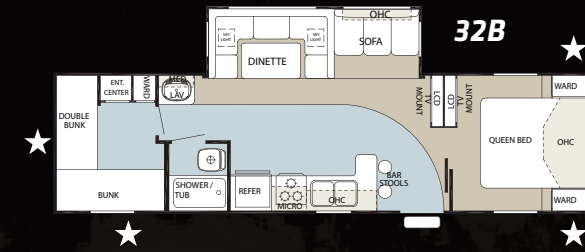
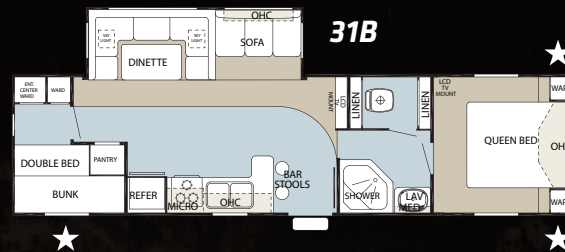
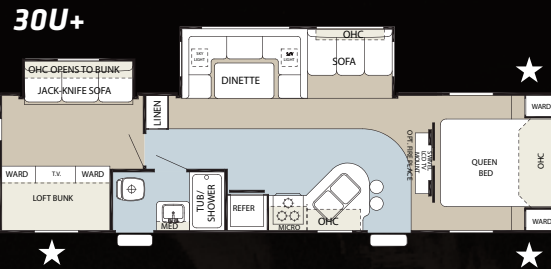

30U+	
Hitch Weight (lbs.)	1064
Axle Weight (lbs.)	6719
Ship Weight (lbs.)	7783
GVWR w/Brakes (lbs.)	11224
Exterior Length	35'10"
Exterior Height w/ AC	11'9"
Bedroom Interior Height	84"
Furnace BTU	30
Grey Capacity (gal.)	41
Black Capacity (gal.)	41
Fresh Capacity (gal.)	50
Dinette Size	U-Shape
Sofa Size	58"
Awning Size	21'

31B	
Hitch Weight (lbs.)	714
Axle Weight (lbs.)	6714
Ship Weight (lbs.)	7428
GVWR w/Brakes (lbs.)	10874
Exterior Length	37'5"
Exterior Height w/ AC	11'9"
Bedroom Interior Height	84"
Furnace BTU	30
Grey Capacity (gal.)	41
Black Capacity (gal.)	41
Fresh Capacity (gal.)	50
Dinette Size	U-Shape
Sofa Size	58"
Awning Size	21'

32B	
Hitch Weight (lbs.)	967
Axle Weight (lbs.)	6074
Ship Weight (lbs.)	7041
GVWR w/Brakes (lbs.)	11127
Exterior Length	34'10"
Exterior Height w/ AC	11'9"
Bedroom Interior Height	84"
Furnace BTU	30
Grey Capacity (gal.)	41
Black Capacity (gal.)	41
Fresh Capacity (gal.)	50
Dinette Size	U-Shape
Sofa Size	58"
Awning Size	21'

★ = OUTSIDE STORAGE

## Living Area Travel Trailers



Sunset Gold Bedroom



7' Interior Height w/Panoramic Views



Onyx Slide-Out

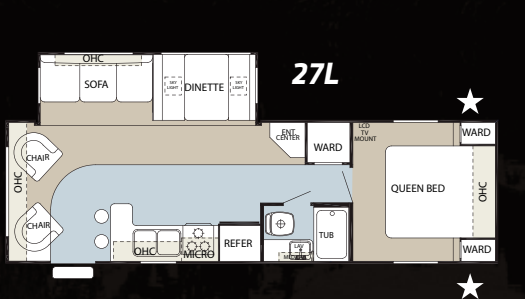

27L		30F		30L	
Hitch Weight (lbs.)	710	Hitch Weight (lbs.)	900	Hitch Weight (lbs.)	690
Axle Weight (lbs.)	6110	Axle Weight (lbs.)	6630	Axle Weight (lbs.)	6660
Ship Weight (lbs.)	6820	Ship Weight (lbs.)	7530	Ship Weight (lbs.)	7350
GVWR w/Brakes (lbs.)	10870	GVWR w/Brakes (lbs.)	11060	GVWR w/Brakes (lbs.)	10850
Exterior Length	31'5"	Exterior Length	35'4"	Exterior Length	35'4"
Exterior Height w/ AC	11'9"	Exterior Height w/ AC	11'9"	Exterior Height w/ AC	11'9"
Bedroom Interior Height	84"	Bedroom Interior Height	84"	Bedroom Interior Height	84"
Furnace BTU	30	Furnace BTU	30	Furnace BTU	30
Grey Capacity (gal.)	41	Grey Capacity (gal.)	41	Grey Capacity (gal.)	41
Black Capacity (gal.)	41	Black Capacity (gal.)	41	Black Capacity (gal.)	41
Fresh Capacity (gal.)	50	Fresh Capacity (gal.)	50	Fresh Capacity (gal.)	50
Dinette Size	44"	Dinette Size	44"	Dinette Size	44"
Sofa Size	68"	Sofa Size	68"	Sofa Size	68"
Awning Size	21'	Awning Size	21'	Awning Size	21'

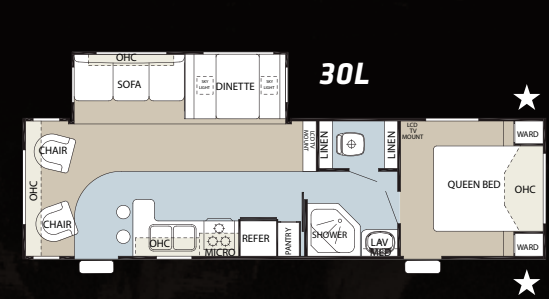
★ = OUTSIDE STORAGE

## Park Trailers



*39 KB Rear Bedroom*



*Super Slide in Woodland Green*



*U-Shaped Dinette and Love Seat in 39 Park*



*Neo Angle Shower, Vanity,  
Med. Cab.*



*Cherry Wood  
Entertainment Center*



*Kitchen with Std. Residential Refrigerator*



*Bedroom in 39 Park*

# Park Trailers



Kitchens w/ Snack Bars



SuperSlide and Entertainment Center in Onyx

## 40DL

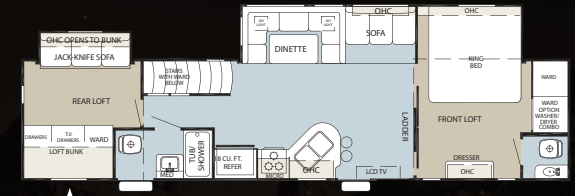

Hitch Weight (lbs.)	1362	Furnace BTU	30
Axle Weight (lbs.)	9894	Grey Capacity (gal.)	71
Ship Weight (lbs.)	11256	Black Capacity (gal.)	71
GVWR w/Brakes (lbs.)	11522	Fresh Capacity (gal.)	50
Exterior Length	42'1"	Dinette Size	U-Shape
Exterior Height w/ AC	13'6"	Sofa Size	58"
Bedroom Interior Height	80"	Awning Size	21'

### Option D

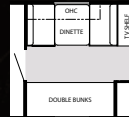

### Option E

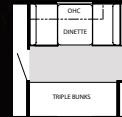

### Option F

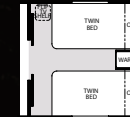

## 39H



Hitch Weight (lbs.)	1050	Furnace BTU	30
Axle Weight (lbs.)	9474	Grey Capacity (gal.)	71
Ship Weight (lbs.)	10524	Black Capacity (gal.)	71
GVWR w/Brakes (lbs.)	11210	Fresh Capacity (gal.)	50
Exterior Length	44'2"	Dinette Size	U-Shape
Exterior Height w/ AC	11'6"	Sofa Size	58"
Bedroom Interior Height	84"	Awning Size	21'

## 39L

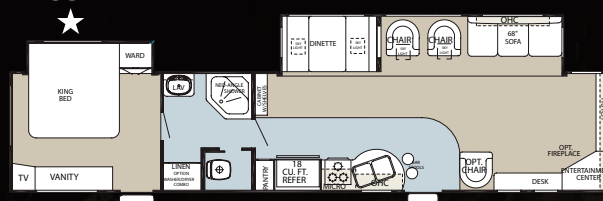

Hitch Weight (lbs.)	1305	Furnace BTU	30
Axle Weight (lbs.)	8465	Grey Capacity (gal.)	41
Ship Weight (lbs.)	9770	Black Capacity (gal.)	41
GVWR w/Brakes (lbs.)	11465	Fresh Capacity (gal.)	50
Exterior Length	43'7"	Dinette Size	44"
Exterior Height w/ AC	11'6"	Sofa Size	68"
Bedroom Interior Height	84"	Awning Size	21'

## 39Park

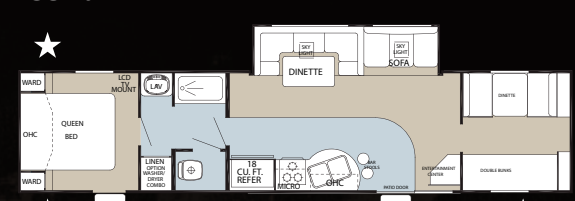

Hitch Weight (lbs.)	1096	Furnace BTU	30
Axle Weight (lbs.)	6331	Grey Capacity (gal.)	41
Ship Weight (lbs.)	7427	Black Capacity (gal.)	41
GVWR w/Brakes (lbs.)	11256	Fresh Capacity (gal.)	50
Exterior Length	40'1"	Dinette Size	U-Shape
Exterior Height w/ AC	11'10"	Sofa Size	58"
Bedroom Interior Height	84"	Awning Size	21'

★ = OUTSIDE STORAGE

# Park Trailers



Large Living Areas



Sunset Gold Slide-Out



Showers, Vanities and Medicine Cabinets

## Option A

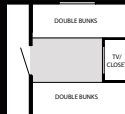

## Option B



## Option C

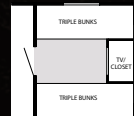

### 39BS

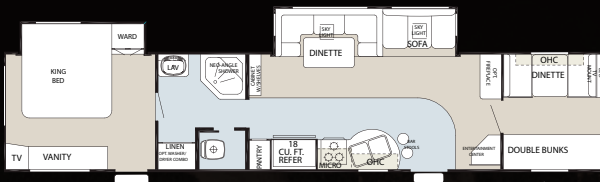

### 39DB

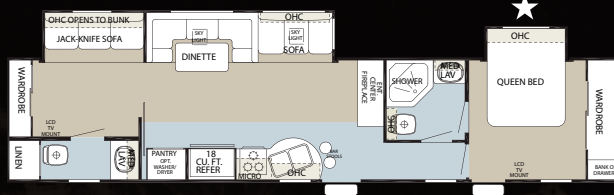

### 39KB

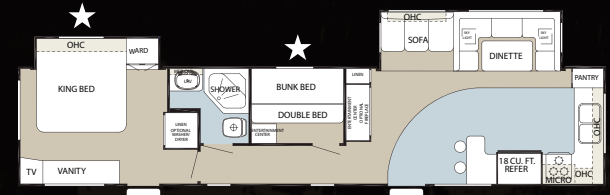

39BS		39DB	
Hitch Weight (lbs.)	1292	Furnace BTU	30
Axle Weight (lbs.)	8131	Grey Capacity (gal.)	41
Ship Weight (lbs.)	9423	Black Capacity (gal.)	41
GVWR w/Brakes (lbs.)	11452	Fresh Capacity (gal.)	50
Exterior Length	43'7"	Dinette Size	U-Shape
Exterior Height w/ AC	11'6"	Sofa Size	58"
Bedroom Interior Height	84"	Awning Size	21'

39DB		39KB	
Hitch Weight (lbs.)	1282	Furnace BTU	30
Axle Weight (lbs.)	8742	Grey Capacity (gal.)	82
Ship Weight (lbs.)	10024	Black Capacity (gal.)	71
GVWR w/Brakes (lbs.)	11420	Fresh Capacity (gal.)	50
Exterior Length	43'7"	Dinette Size	U-Shape
Exterior Height w/ AC	11'6"	Sofa Size	58"
Bedroom Interior Height	84"	Awning Size	21'

39KB		39KB	
Hitch Weight (lbs.)	1743	Furnace BTU	30
Axle Weight (lbs.)	7768	Grey Capacity (gal.)	41
Ship Weight (lbs.)	9511	Black Capacity (gal.)	41
GVWR w/Brakes (lbs.)	11903	Fresh Capacity (gal.)	50
Exterior Length	43'7"	Dinette Size	U-Shape
Exterior Height w/ AC	11'6"	Sofa Size	58"
Bedroom Interior Height	84"	Awning Size	21'

★ = OUTSIDE STORAGE

# Bunk Fifth Wheels

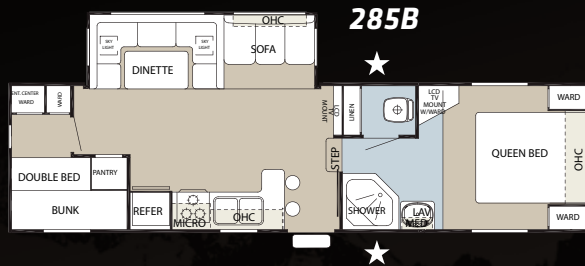

Style

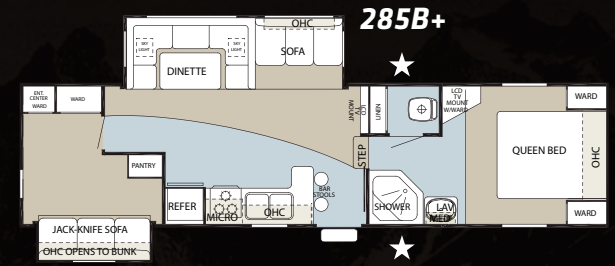

Functionality

285B	
Hitch Weight (lbs.)	1400
Axle Weight (lbs.)	6400
Ship Weight (lbs.)	7800
GVWR w/Brakes (lbs.)	11560
Exterior Length	30'3"
Exterior Height w/ AC	12'5"
Bedroom Interior Height	76"
Furnace BTU	30
Grey Capacity (gal.)	41
Black Capacity (gal.)	41
Fresh Capacity (gal.)	50
Dinette Size	U-Shape
Sofa Size	58"
Awning Size	18'

285B+	
Hitch Weight (lbs.)	1474
Axle Weight (lbs.)	7470
Ship Weight (lbs.)	8944
GVWR w/Brakes (lbs.)	11634
Exterior Length	33'7"
Exterior Height w/ AC	12'5"
Bedroom Interior Height	76"
Furnace BTU	30
Grey Capacity (gal.)	41
Black Capacity (gal.)	41
Fresh Capacity (gal.)	50
Dinette Size	U-Shape
Sofa Size	58"
Awning Size	18'

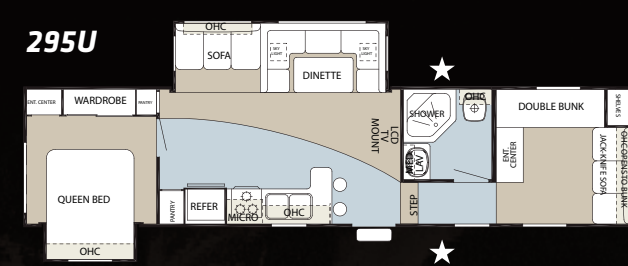
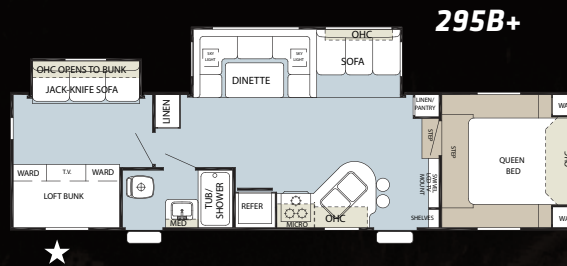
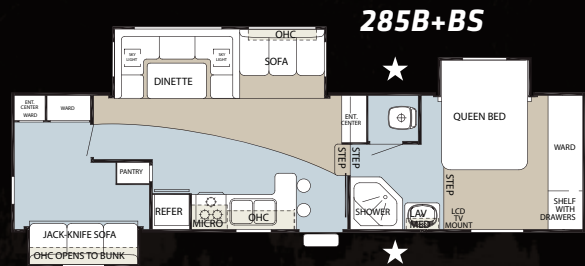

285B+BS	
Hitch Weight (lbs.)	1872
Axle Weight (lbs.)	7369
Ship Weight (lbs.)	9214
GVWR w/Brakes (lbs.)	12032
Exterior Length	33'10"
Exterior Height w/ AC	12'5"
Bedroom Interior Height	67"
Furnace BTU	30
Grey Capacity (gal.)	41
Black Capacity (gal.)	41
Fresh Capacity (gal.)	50
Dinette Size	U-Shape
Sofa Size	58"
Awning Size	18'

295B+	
Hitch Weight (lbs.)	1504
Axle Weight (lbs.)	7566
Ship Weight (lbs.)	9070
GVWR w/Brakes (lbs.)	11624
Exterior Length	34'4"
Exterior Height w/ AC	12'5"
Bedroom Interior Height	67"
Furnace BTU	30
Grey Capacity (gal.)	41
Black Capacity (gal.)	41
Fresh Capacity (gal.)	50
Dinette Size	U-Shape
Sofa Size	58"
Awning Size	21'

295U	
Hitch Weight (lbs.)	1705
Axle Weight (lbs.)	8061
Ship Weight (lbs.)	9766
GVWR w/Brakes (lbs.)	11905
Exterior Length	36'4"
Exterior Height w/ AC	12'5"
Bedroom Interior Height	84"
Furnace BTU	30
Grey Capacity (gal.)	41
Black Capacity (gal.)	41
Fresh Capacity (gal.)	50
Dinette Size	U-Shape
Sofa Size	58"
Awning Size	21'

★ = OUTSIDE STORAGE



# Living Room Fifth Wheels



Living Area w/Picture Window



Dinette in Ostrich

255S		
Hitch Weight (lbs.)	1190	Furnace BTU
Axle Weight (lbs.)	5130	Grey Capacity (gal.)
Ship Weight (lbs.)	6320	Black Capacity (gal.)
GVWR w/Brakes (lbs.)	8190	Fresh Capacity (gal.)
Exterior Length	26'10"	Dinette Size
Exterior Height w/ AC	12'5"	Sofa Size
Bedroom Interior Height	76"	Awning Size

275KBS		
Hitch Weight (lbs.)	1660	Furnace BTU
Axle Weight (lbs.)	8215	Grey Capacity (gal.)
Ship Weight (lbs.)	9875	Black Capacity (gal.)
GVWR w/Brakes (lbs.)	1820	Fresh Capacity (gal.)
Exterior Length	35'	Dinette Size
Exterior Height w/ AC	12'5"	Sofa Size
Bedroom Interior Height	76"	Awning Size

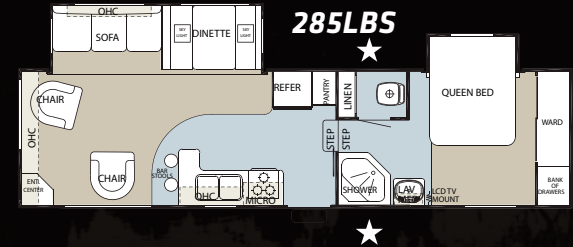
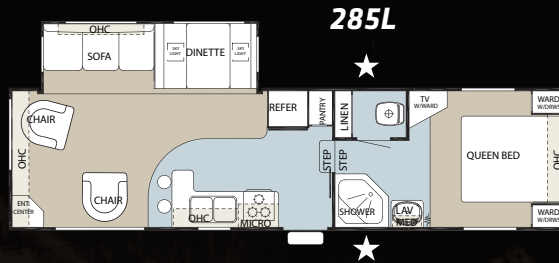
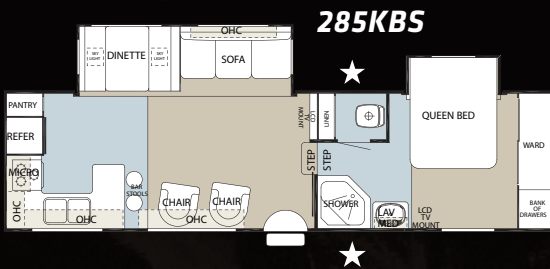

285KBS		
Hitch Weight (lbs.)	1560	Furnace BTU
Axle Weight (lbs.)	7106	Grey Capacity (gal.)
Ship Weight (lbs.)	8666	Black Capacity (gal.)
GVWR w/Brakes (lbs.)	11720	Fresh Capacity (gal.)
Exterior Length	32'6"	Dinette Size
Exterior Height w/ AC	12'5"	Sofa Size
Bedroom Interior Height	76"	Awning Size

285L		
Hitch Weight (lbs.)	1766	Furnace BTU
Axle Weight (lbs.)	6792	Grey Capacity (gal.)
Ship Weight (lbs.)	8558	Black Capacity (gal.)
GVWR w/Brakes (lbs.)	11926	Fresh Capacity (gal.)
Exterior Length	33'3"	Dinette Size
Exterior Height w/ AC	12'5"	Sofa Size
Bedroom Interior Height	76"	Awning Size

285LBS		
Hitch Weight (lbs.)	TBA	Furnace BTU
Axle Weight (lbs.)	TBA	Grey Capacity (gal.)
Ship Weight (lbs.)	8879	Black Capacity (gal.)
GVWR w/Brakes (lbs.)	1105	Fresh Capacity (gal.)
Exterior Length	33'3"	Dinette Size
Exterior Height w/ AC	12'5"	Sofa Size
Bedroom Interior Height	76"	Awning Size

★ = OUTSIDE STORAGE

## Construction Cutaway

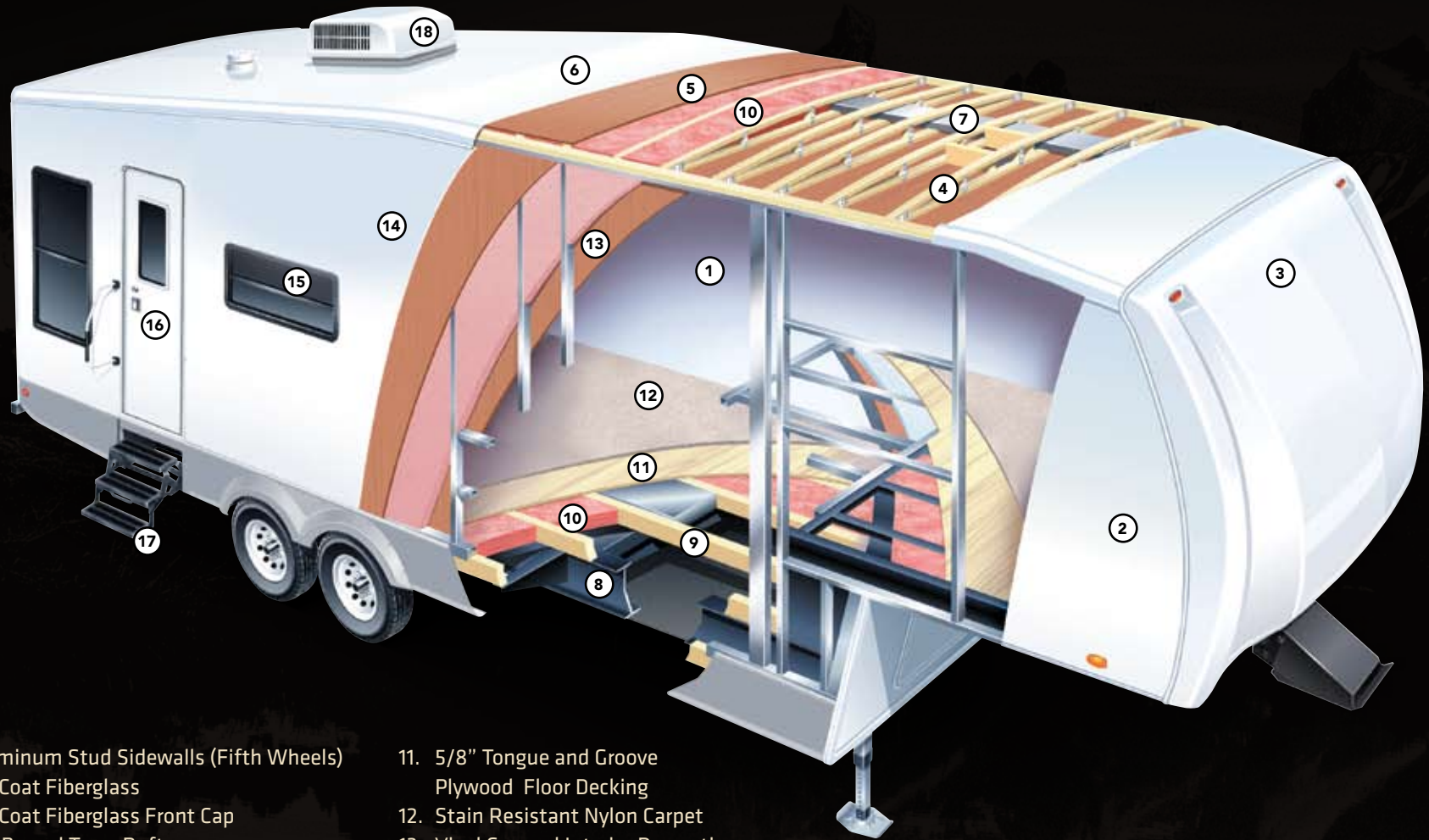

- |   |   |
|---|---|
| 1. Aluminum Stud Sidewalls (Fifth Wheels) | 11. 5/8" Tongue and Groove Plywood Floor Decking    |
| 2. Gel Coat Fiberglass                    | 12. Stain Resistant Nylon Carpet                    |
| 3. Gel Coat Fiberglass Front Cap          | 13. Vinyl Covered Interior Decorative Wall Board    |
| 4. 2x5 Bowed Truss Rafters                | 14. Fiberglass Positive Pressure Laminated Sidewall |
| 5. 3/8" OSB Roof Deck                     | 15. Tinted Radius Automotive Style Windows          |
| 6. One Piece Polymer Roof Sheathing       | 16. 30" Radius Entry Door                           |
| 7. Insulated A/C Ductwork                 | 17. Triple Fold Down Entry Step                     |
| 8. Steel I-Beam Frame                     | 18. 13.5 BTU Roof Air Conditioner                   |
| 9. 2x3 Floor Joists                       |   |
| 10. Rolled Fiberglass Insulation          |   |

## Standards and Options

### WINDOWS

- Tinted Windows
- Mini-Blinds on All Windows
- Hard Window Valances & Lambrequins
- Screens in Egress Windows

### BEDROOM

- Residential Style Mattress
- Reverse Sham Bedspread
- Bedroom Carpet (FW)
- Finished Bed Bases
- Night Stands on Both Sides of the Bed (TT)

### KITCHEN

- Acrylic Sink
- High-Rise Faucet
- Self-Edged Countertops and Tabletops
- Decorative Clock
- Wallpaper Décor Border
- Bar Stools
- Granite Looking Countertops
- Breakfast Bar

### SLIDE OUT

- Skylights Over Dinette & Sofa (FW, TT)
- Flush Floor Slide Out
- 44" Dinette in Slide Outs
- Taller 5 ft. 11 in. Slide Rooms (FW)
- One Piece Slide Out Side Walls
- Two Double Coat Hanger Hooks
- U shaped dinettes with sliding table top (All Bunkhouse Models)

### CABINETS

- Solid Cherry Wood Crowned Style Doors
- Rounded Styled Cabinets – Kitchen & Living Room Overheads
- Solid Cherry Wood Drawer Fronts
- Large Overhead Cabinet in Slide Out
- High Grade Cabinet Handles

### BATHROOM

- Residential Cherry Wood Framed Medicine Cabinet
- Acrylic Bath Sinks
- Shower with Glass Enclosure (Some Models)
- Colored Shower Curtain
- Linoleum in Bath Area

### APPLIANCES

- Oven with 3 Burner High Output Cooktop
- Double Door Refrigerator
- Carousel High Output Microwave
- TV Antenna with Power Booster
- Satellite Ready
- Cable Hookups
- 13.5 Air Conditioner w/ Quick Cool Vent
- Water Heater By-Pass
- AM/FM/CD stereo system with MP3/iPod hookup
- LCD Bracket and TV Ready
- 6 Gallon Gas/Electric DSI Turbo Water Heater STD.

### EXTERIOR

- Radius Luggage Doors
- 30 lb. LP Bottles
- Double and Triple Deep Drop Steps
- Diamond Plate Stone Shield (TT)
- Awning Drip Rail and Down Spouts
- Patio Awning
- Radius Rolled & Painted Bottom Metal
- Large Pass-Through Storage
- Walk-On One-Piece Rubber Roof
- Exterior Speakers
- Stabilizing Jacks
- 30" Radius Entry Door
- Radius Entry Steps

### CONSTRUCTION FEATURES

- 3/8" Walkable Roof Decking
- Radius Truss Roof Rafters

- 5/8" Tongue and Groove Plywood Floor
- 2" x 3" Floor Joists
- Powder Coated, Rust Resistant Frame
- R7 Fiberglass Insulation
- Linoleum Front to Back
- Roto Cast (Seamless) Holding Tanks
- Polypropylene Stain Resistant Carpets

### OPTIONS

- RVQue Prep (and Grill)
- High Gloss Gel Coat Sidewall
- Wrap Around Gel Coat Cap
- Spare Tire w/Carrier and Cover
- Range Cover
- 10 Gallon DSI Turbo Water Heater
- Safety Glass
- Plank Wood Linoleum
- Skylight Over Tub
- Flat Screen TV
- Side Entrance Ramp Door
- Two 30 lb. LP Bottles with Auto Changeover (TT)
- Aluminum Wheels (FW only 27' and Up)
- Exterior Automotive Paint
- 40" Plywood Drawer Under Booth Dinette
- Fantastic Fan in Bathroom with Clear Cover
- 10,000 Gallon Full Water Filter System
- Black Tank Flush System
- Scare Light



Convenience



Accessibility



Convenience

## Cherokee Interior Colors

Onyx



Woodland Green

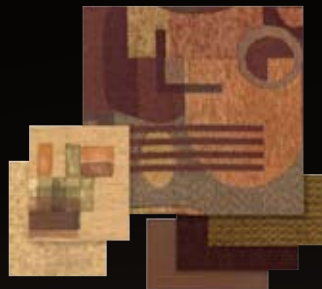

Cabinetry



Wall Panels



Sunset Gold



Counter top



Linoleum Floor

\* Some photos shown with optional carpets

## Peace of Mind.



Forest River has yet another exclusive feature to offer: One year of free roadside assistance will be given to every 2009 Flagstaff customer. This is just one more way to say "Thank you" and to ensure an enjoyable traveling experience.



YOUR CHEROKEE DEALER

FOREST RIVER ENCOURAGES YOU TO

# BUY LOCALLY

FROM YOUR HOMETOWN DEALERSHIP.

Forest River, Inc. strongly encourages our retail customers to purchase from their local dealership whenever possible due to the following factors:

- \* Our Dealers are as a rule, independently owned and operated businesses. Outside of those customers they personally sold products to, they are not contractually obligated to perform warranty service on Forest River products that were purchased elsewhere. There may be an occasion that you would be required to return to the point of purchase to satisfy warranty requirements.
- \* Although many dealerships will eventually service products not purchased at their place of business, they will usually take care of their customers and other Forest River customers who are traveling away from their local dealer as they would their own.
- \* Local purchases allow a customer to establish a relationship with a dealer close to home. This relationship provides the customer with a convenient location for service and support from a "home town" professional.
- \* The opportunity for a thorough PDI (Pre Delivery Inspection) and product orientation is an additional benefit of buying from your local dealer. Further providing the opportunity for refresher courses or the ability to get questions answered much more conveniently.
- \* For our Canadian customers, there are also requirements which must be met to bring an RV purchased out of the country to their home. Although not insurmountable, these requirements may involve such things as additional inspections and certifications, taxes and fees. Your local Canadian Dealer is a professional at meeting these requirements.

Forest River's goal is for all RV Owners to fully enjoy their RV experience. In light of this goal, and considering the advantages of buying local, we encourage you to be thorough when determining what product to purchase and which dealer to purchase it from as both are key to your ultimate satisfaction and the realization of your dreams.



Forest River, Inc.  
402 Lehman Avenue, Topeka, IN 46571  
Sales Department: 260.593.2539  
Service Department: 260.593.2428  
[www.forestriverinc.com](http://www.forestriverinc.com)  
[www.forestriveraccessories.com](http://www.forestriveraccessories.com)