

Jay Flight™

2009 Travel Trailers and Park Trailers by Jayco®



2009 Jay Flight 2009 Travel Trailers and Park Trailers by Jayco®



Jayco

AMERICA'S MOST LIVEABLE RVs.



JAY FLIGHT



JAY FLIGHT G2



JAY FLIGHT BUNGALOW

Jay Flight™

2009 Travel Trailers and Park Trailers by Jayco®

Leading the Way to Family Fun



For three years in a row, Jay Flight travel trailers by Jayco have been the top selling travel trailers in North America and Jayco's top selling RV. Jay Flight's success can be traced to its durable construction, family-friendly design and numerous amenities—making it an affordable value for a family of any size.



JAY FLIGHT

Jay Flight travel trailers sleep up to 10 people and range in length from just over 22 feet to almost 36 feet. The Jayco Jay Flight is towable* by most ½ ton trucks and SUVs and is more popular than ever.



JAY FLIGHT G2

Jay Flight G2 is the second generation of Jayco's most popular travel trailers and offers more standard amenities than other RVs in its class. The Jay Flight G2 sleeps up to 10 with a length range of 23 feet to almost 34 feet.



JAY FLIGHT BUNGALOW

More spacious than a traditional travel trailer and less expensive than building on-site, the Bungalow park trailer is ideal for a long-term stay at your favorite spot. The Bungalow offers a variety of floorplans sleeping up to 10 people.





Built For Liveability

Protection from the Elements

Jay Flight travel trailers and park trailers are constructed with high quality materials using production techniques perfected over the past 40 years. The seamless one-piece rubber roof **1** and .024" aluminum siding **2** will keep your Jay Flight looking good for years to come and protect your resale value.

Designed for Convenience

Many features on the Jay Flight are designed to make travel more enjoyable and liveable such as an attractive Carefree® electric patio awning **3** (G2 models), easy-care carpet **4** and high-quality carpet pads **5** which provide enhanced durability and comfort.

Value Defined

The Jay Flight G2 Customer Value Package offers features such as central air conditioning **6**, ABS tub surround, bathroom power vent, Multi-Media Premium Sound System™ w/DVD, microwave oven with carousel, tub/shower skylight and water heater bypass system (G2 and Bungalow).



A Strong Foundation

The Jayco I-Class™ structural steel chassis frame **7** protects against warping, while the R-7 fiberglass insulation **8**, 2"x3" longitudinal floor joists on 16"-18" centers, and 2" wall studs on 16" centers **9** provide the Jay Flight with additional strength.

Expandability

With the push of a button, Jayco's V-Tec™ flush-floor slideout systems increase living space for added comfort, and liveability. The large, lockable storage compartments **10** keep bulky outdoor equipment close at hand but out of sight, and the pass-through design allows easy access to items from either side.

* Jay Flight models may be towed by most SUVs. Consult with your authorized automobile vehicle manufacturer and vehicle owner's manual. Certain optional equipment may be required and other restrictions may apply. Do not exceed the recommended towing capacity of your vehicle.

Jay Flight™

2009 Travel Trailers by Jayco®



26BH | BLUE

Everything You Need in One Great Choice

With its large selection of floorplans and a variety of options and prices, Jay Flight is the most liveable choice in travel trailers for families of different needs, sizes and destinations. Easy on the budget and on the road, this family friendly travel trailer is the first step to many memorable adventures. The fully equipped kitchen, comfortable furniture and easy-to-care-for floors mean spending less time taking care of your Jay Flight and more time taking care of what's important.





Little touches make the bathroom a refreshing change from the ordinary, such as the two overhead lighting fixtures, sleek cabinetry and radius shower curtain track.



Relaxation comes easy in the cozy bedroom designed with plenty of storage and a queen innerspring mattress.

LIVEABILITY FEATURES



The pass-through design of the large, lockable storage compartments allows easy access to items from either side.



Microwave oven with carousel is available with the Customer Value Package.



Jay Flight's E-Z Lube® axles with removable caps make maintenance a snap.

Jay Flight™ G2

2009 Travel Trailers by Jayco®



Pack More Enjoyment Into Every Moment

Perfect for a long week or a quick weekend, the Jay Flight G2 travel trailers come standard with more residential-style features than ever before. Outside of spending quality time with your family, you'll find that enjoyment will come with all the little things such as new nickel hardware, a wooden message center, overhead cabinetry for extra storage in all super slide models, radius-corners on most kitchen and bathroom countertops, and the J-steel™ convertible sofa.





Cooking is easier thanks to the three-burner range and oversized oven, adjustable temperature control refrigerator and acrylic sink with high-rise faucet.



The Jayco J-Cube™ layout with bunks and entertainment area means everyone can declare their own space and enjoy a little “me” time.



The welcoming bedroom features a 312-coil innerspring queen mattress, beautiful cabinetry and convenient reading lights.

32BHDS | WHEAT



Jayco's U-Shape dinette gives enough space at meal time or for a round of cards (select models only).

Jay Flight™ Bungalow

2009 Park Trailers by Jayco®



Relax and Stay Awhile

Bring all the comforts of home to your favorite vacation spot with the Jay Flight Bungalow park trailer. With spacious and comfortable living space, the Bungalow is ideal for a long-term summer stay at the lake or in the mountains. More permanent and homelike than a traditional travel trailer, the Jay Flight Bungalow is less expensive than on-site building, allowing you to spend more time and resources on more important things, such as family. With open 40-foot floorplan designs, ample living and storage space, and residential amenities, you'll feel right at home.





40BHS | CINNAMON



Feel right at home with the 84" living room ceiling height, free-standing dinette table and chairs and the residential-style fireplace.



The kitchen includes a residential-style refrigerator, freestanding 4-burner gas range with oven, 30" microwave and a pair of bar stools.

LIVEABILITY FEATURES



Step outside through the wide patio door with vertical blinds.



The 312-coil innerspring pillowtop mattress will ease you into sleep's sweet slumber.



Residential-style 110V refrigerator provides 18 cu. ft. of storage plus an icemaker.



The medicine cabinet with mirror and custom cabinetry make the bathroom comfortable and pleasant.

STANDARDS AND OPTIONS

BUNGALOW
JAY FLIGHT G2
JAY FLIGHT

STANDARD BATHROOM EQUIPMENT

ABS garden tub	•
Bar and towel ring	•••
Bathroom exhaust fan	•
Glass shower door (select models)	••
Large sink in bathroom	•••
Marine toilet with foot flush	••
Medicine cabinet w/mirror	•••
Residential 6-panel passage door	••
Shower curtain with curved shower track (select models)	••
Theftford porcelain stool with foot pedal	•
Toilet paper holder	•••
Vinyl flooring	•••
Washer/dryer prep for stackable unit	•

STANDARD BEDROOM EQUIPMENT

312-coil innerspring pillowtop mattress (60x80)	•
312-coil innerspring mattress w/1" padding	••
Bedroom roof vent	••
Bi-fold privacy door (select models)	••
Carpeting w/padding (select models)	••
Quilted bedspread (select models)	•
Shirt wardrobe in bedroom	••
Sliding pocket-style door (select models)	••
Stereo speakers (2)	•
TV shelf	•••
Underbed storage, bed lifts easily on gas struts	•••

STANDARD CONSTRUCTION FEATURES

.024" aluminum exterior skin	•••
½" plywood dinette, bed and bunk platforms	•••
102" wide	•
2" x 3" longitudinal floor joists on 16"-18" centers	•••
⅝" tongue and groove plywood main floor decking	•••
81" living room ceiling height	••
84" living room ceiling height	•
Atrium front profile with fiberglass cap	•
Detachable hitch	•
Electric-powered slideout (all slideout models)	•••
Fully-decked roof with 3/8" plywood	•••
I-Class® Cambered structural steel I-Beam frame	•••
One-piece, seamless rubber roof material	•••
Poly Flex™ one-piece underbelly covering	•••
R-7 fiberglass insulation in sidewall, roof and floor	•••
Roof rafters constructed of residential style tapered 4½" trusses	•••
Wall studs on 16" centers	•••

STANDARD EXTERIOR EQUIPMENT

15" radial tires	•••
60" patio door (36BHS and Bungalow)	••
Amber patio light w/inside switch	•••
Big Easy™ entrance step w/ 10" deep treads (select models)	•••
Black tinted, radius-cornered awning style windows	•••
Bumper w/drain hose carrier and end caps	•••
Carefree® patio awning	•
Chrome hub caps	•
Durable fender skirts	•••
Exterior speakers, high-output marine grade (2)	••
E-Z Lube® axles	••
Foldable, exterior grab handle	•
Front window w/flush-mounted stone guard (select models)	•
Galvanized steel wheel wells (insulated on non-slide models)	••
Lockable, radius cornered baggage doors w/heavy-duty grab handle	•••
Painted bottom radius skirting	•••
Propane gas bottle cover made of molded ABS	•
Radius-cornered fiberglass entrance door w/screen door	•••
Rain guttering molded w/drip spouts	•••
Scare light (door side only)	•
Stabilizer jacks (2 pairs)	•
White plastic grab handle	••

BUNGALOW
JAY FLIGHT G2
JAY FLIGHT

STANDARD HEAT, POWER & WATER EQUIPMENT

10-gal. gas/electric water heater	••
110V G.F.C.I. protected exterior receptacle	•••
12V demand water pump	•••
12V electrical system w/deluxe 110V 45 amp power converter	••
12V electrical system w/deluxe 110V 45-80 amp power converter	•
2nd A/C prep	•
30-amp. power cord	••
40,000 BTU furnace	•
50-amp power cord w/ second A/C prep - detachable cord	••
6-gal. gas/electric DSI auto-ignition water heater	•
6-gal. gas water heater	•
A/C chill grill	•••
ABS holding tanks	•••
Auto-ignition furnace with wall thermostat	•••
Double 20-lb. propane gas bottles w/ regulator	•
Fireplace with decorative trim	•
Hook-up for city water	•••
In-floor ducted heat	•••
Outside shower	•••
Systems monitor panel	•••
Water system winterization kit	•••

STANDARD INTERIOR EQUIPMENT

19" LCD HDTV in living area	•
Bar stools (2)	•
Bedroom and living room ceiling paddle fans (12V)	•
Cable and satellite TV prepped	••
Cable TV hookup with RG6 coax cabling	•
Carpeting w/padding	•••
Crank-up HDTV antenna with signal booster	•••
Decorative nickel lighting over sofa and dinette	••
Fabric-covered box valances w/lambrequin legs	••
Free standing table with (4) chairs	•
Hardwood message center (select models)	••
Hide-a-bed sofa (air mattress)	•
J-Steel™ convertible sofa	••
Manchester Oak cabinetry	••
Northridge Maple cabinetry	•
Overhead cabinetry in slideout above sofa w/etched glass	••
Plank floor-look linoleum	•
Pleated night shades throughout	••
Residential furniture, designed and made by Jayco®	•••
Rocker recliners (1 or 2 on select models)	••
Roof-mounted antenna for radio	••
Swivel rocker(s) (1 or 2 on select models)	•
Vertical blind at patio door	•
Wall lights in slideout	••
Wallpaper border	••

STANDARD KITCHEN EQUIPMENT

18 cu. ft. residential-style 110V refrigerator with ice maker	•
20" free standing 4 burner gas range with oven	•
3-burner range w/9,000-BTU SuperBurner™ and piezo igniter	••
60/40 deep dish acrylic residential-style sink	•
Access doors to the dinette booth	••
Acrylic residential-style sink	••
Dream Dinette™ mechanism, raises and lowers dinette table top (select models)	•
Extra large picture window at dinette	•••
Large pedestal dinette table	•
Microwave with built-in hood over the range	•
Mixing high-rise faucet	•••
Oversized oven	•
Raised-paneled doors and drawers on overhead cabinetry and refrigerator	••
Range hood w/light and exhaust fan	••
Spice rack built-in under kitchen sink (select models)	•
Sponge holder under sink	•••
Waste basket	•

BUNGALOW
JAY FLIGHT G2
JAY FLIGHT

STANDARD SAFETY EQUIPMENT

Breakaway switch	•••
Carbon monoxide alarm	•••
Deadbolt lock on entrance door	•••
Dual hitch safety chains	•••
Fire extinguisher	•••
Multiple egress windows	•••
Propane alarm	•••
Smoke alarm	•••
Tinted safety glass windows	•••

OPTIONS

20 gal. electric water heater	•
2nd A/C in bedroom	•
Awning slideout (2)	•
Awning slideout (3)	•
Comfort package: ABS shower surround; oven; stabilizer jacks (stab jacks only available on: 19BH, 26BH, 22FB)	•
CSA standards	•••
Customer Value Package	•••
Customer Value Package w/ 15,000 BTU central A/C	••
Enclosed, insulated and heated underbelly	•••
Extendable dinette (select models)	••
Free-standing table w/ 4 chairs (select models)	•
Front diamond plate	••
Hide-a-bed (select models)	•
J-Cube™ futon sofa ILO lower bunk (30BHDS)	•
Linoleum floor in living area (select models)	••
Maxistor™ Door (select models)	•
No patio awning	•
Plus package: 30 lb propane gas bottles (2) w/ABS cover; 6 gal. gas/electric DSI auto ignition water heater; outside shower; raised panel kitchen overhead doors	•
Portable outside gas grill	•••
Quad bunk ILO standard bunk/dinette (36BHS only)	•
Rear queen bed (40BHS)	•
Roof ladder	•••
Satellite kit	••
Second rocker recliner chair (40FER)	•
Sofa ILO swivel chairs (2) (31RKS only)	•
Spare tire	•
Spare tire and tire carrier	•
Spare tire and tire carrier w/vinyl tire cover	•
Stabilizer jacks (4)	•
Thermal pane tinted safety glass windows	•
Trundle bed ILO futon (select models)	•
Water purification system	•

CUSTOMER VALUE PACKAGE

30" microwave oven with carousel	•
A/C Central 13,500 BTU with wall thermostat with louvered-directional ceiling vents	••
A/C Central 15,000 BTU with wall thermostat with louvered-directional ceiling vents	•
ABS tub surround	•••
Bathroom power vent	••
Bi-fold cover for range	•
Carefree® patio awning	•
Carefree® Travl'r 12 volt electric patio awning	•
Double 30-lb. propane gas bottles w/regulator	•••
Microwave oven with carousel	••
Multi-Media Sound System™ AM/FM/CD/DVD stereo with MP3 and iPod® input jack	•
Multi-Media Premium Sound System™ AM/FM/CD/DVD stereo with MP3 and iPod® input jack	••
Quilted bedspread	••
Shirt wardrobe in bedroom	•
Sink cover/cutting board (1)	•
Sink cover/cutting board (2)	•
Tub/shower skylight	•••
Water heater bypass system	•••



A LEGACY OF CRAFTSMANSHIP

Jayco's dedicated production team includes Amish craftsmen who build with well-honed woodworking techniques passed down for generations and skilled seamstresses who produce our upholstery, bedding and draperies with great attention to detail.

COLOR OPTIONS



Blue



Cinnamon



Wheat

1. Drapery 2. Main Upholstery 3. Bedspread 4. Wallpaper 5. Wood 6. Vinyl 7. Countertop 8. Carpet

SPECIFICATIONS		Exterior Length	Exterior Height (with A/C)	Interior Height	Unloaded Vehicle Weight	Dry Hitch Weight (lbs.)	Gross Vehicle Weight Rating (lbs.)	Cargo Carrying Capacity (lbs.)	Fresh Water Capacity (gal.) (Includes water heater)	Gray Wastewater Capacity (gal.)	Toilet/Black Wastewater Capacity (gal.)
	Floorplan										
Jay Flight Travel Trailer	19BH	22' 5"	130"	81"	3,730	450	6,000	2,270	37	32.5	32.5
	22FB	26' 5"	127"	81"	4,145	470	6,000	1,855	37	32.5	32.5
	24FBS	26' 11"	133"	81"	4,865	530	7,000	2,135	31	32.5	32.5
	24RKS	28' 3"	127"	81"	4,885	605	7,000	2,115	59	32.5	32.5
	25BHS	28' 11"	133"	81"	5,845	745	8,180	2,335	46	32.5	32.5
	26BH	29' 1"	129"	81"	4,445	580	7,500	3,055	37.2	32.5	32.5
	28BHS	30' 6"	127"	81"	5,145	725	7,500	2,355	59	32.5	32.5
	30BHDS	33' 11"	134"	81"	7,020	725	9,000	1,980	46	32.5	32.5
	30BHS	32' 6"	137"	81"	6,300	1,020	9,000	2,700	46	32.5	32.5
Jay Flight G2 Travel Trailer	36BHS	37' 11"	133"	81"	7,555	1,045	9,500	1,945	50	32.5	32.5
	23FB	26' 5"	127"	81"	4,480	530	6,500	2,020	37	32.5	32.5
	25RKS	28' 4"	134"	81"	6,149	745	8,180	2,031	46	65	32.5
	26BHS	28' 11"	135"	81"	6,215	725	8,180	1,965	46	32.5	32.5
	27BH	29' 1"	127"	81"	4,860	620	7,500	2,640	37	32.5	32.5
	28RBS	31' 2"	134"	81"	6,470	800	8,500	2,030	46	32.5	32.5
	28RBDL	31' 2"	134"	81"	6,445	780	8,500	2,055	46	32.5	32.5
	29BHS	30' 6"	127"	81"	5,400	800	7,500	2,100	59.2	32.5	32.5
	29FBS	32' 6"	134"	81"	6,810	735	9,000	2,190	46	65	32.5
	29RLS	33' 7"	134"	81"	6,925	815	9,000	2,075	46	65	32.5
	31BHDS	33' 11"	134"	81"	7,315	800	9,200	1,885	46	32.5	32.5
	31BHS	32' 6"	134"	81"	6,900	1,025	9,000	2,100	46	32.5	32.5
	31RKS	33' 8"	134"	81"	6,815	830	9,000	2,185	46	65	32.5
32BHDS	35' 6"	134"	81"	7,800	850	9,750	1,950	46	32.5	32.5	
32FKS	33' 11"	134"	81"	7,660	1,135	9,750	2,090	46	65	32.5	
32RLS	35' 6"	133"	81"	7,170	950	9,200	2,030	46	65	32.5	
Bungalow Park Trailer	40BHS	40' 11"	137"	84"	10,380	1,600	11,700	1,320	50	65	32.5
	40FER	40' 11"	137"	84"	10,104	1,640	11,700	1,596	50	65	32.5
	40FLR	40' 11"	137"	84"	9,950	1,595	11,700	1,750	50	65	32.5

It is important for your safety and enjoyment that your tow vehicle be adequately sized and equipped to tow and handle the GVWR of the RV you select. Review weights and rating of your tow vehicle and consult a competent advisor for questions or advice. Whether you are new to RVing or a veteran, get a feel for the performance of your tow vehicle and the RV together before heading out on the roadways. When you tow an RV, you must drive differently than you do when driving a single vehicle. Practice hooking up, driving, backing up and braking in a safe environment or seek out professional instruction. Jayco affixes a weight label to each RV which lists weight information for that vehicle. See specification chart above.

Unloaded Vehicle Weight (UUV): Sometimes referred to as "Dry Weight," UUV means the typical weight of this trailer as built at the factory. The UUV, as used in product literature and other promotional materials, does not include cargo, fresh water, propane, options or dealer-installed accessories.

Gross Vehicle Weight Rating (GVWR): GVWR means the maximum permissible weight of the trailer, including the UUV plus passengers, personal items, all cargo, fluids, options, and dealer-installed accessories. The GVWR is equal to or greater than the sum of the UUV and the CCC.

Cargo Carrying Capacity (CCC): CCC means the maximum weight of all passengers, personal items, food, fresh water, propane, tools, other cargo and dealer-installed accessories that can be carried by the trailer. CCC is equal to or less than GVWR minus UUV. The addition of options will decrease the CCC.

Hitch Weight (HW): The hitch weight, as used in product literature and other promotional materials, does not include cargo, fresh water, propane gas, options or dealer-installed accessories. The addition of these types of items will either add to or subtract from the stated hitch weight.

JAY FLIGHT G2

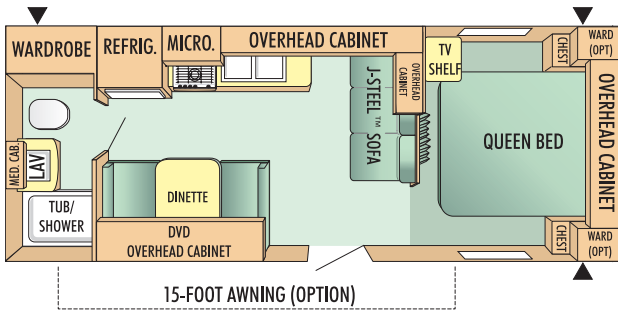

23FB

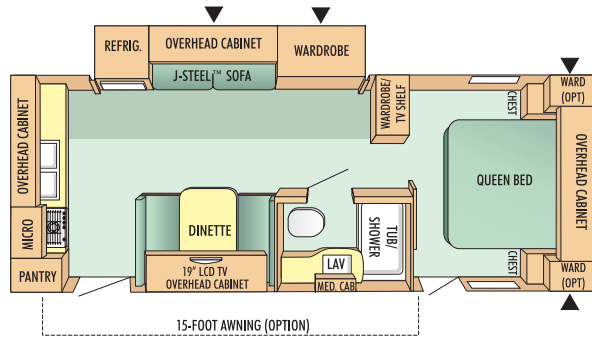

25RKS

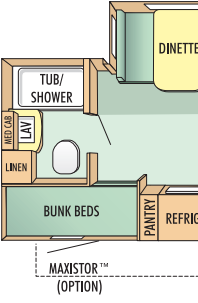
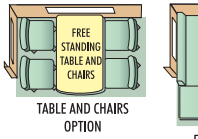

26BHS

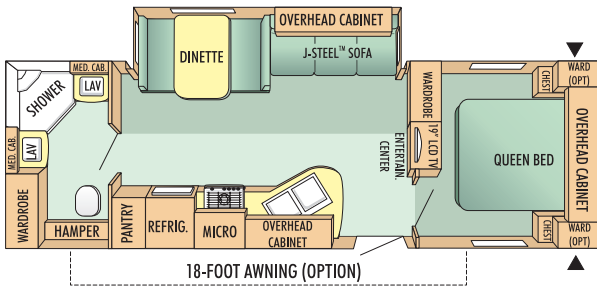
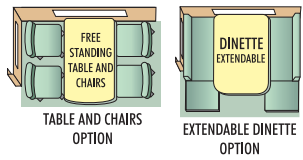

28RBDL

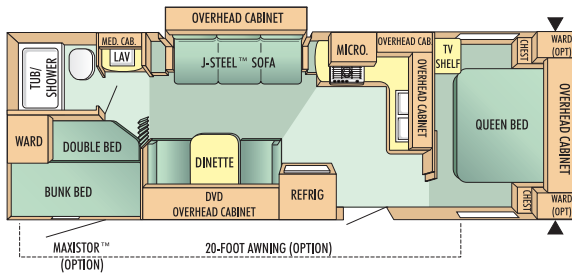

29BHS

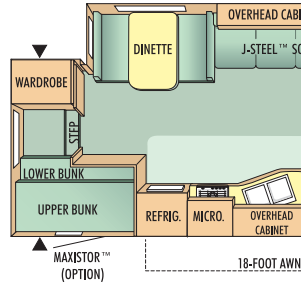
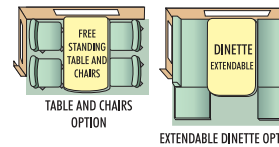

29FBS

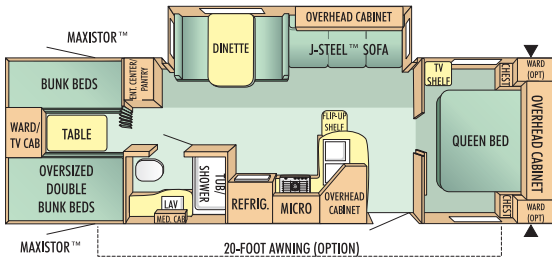
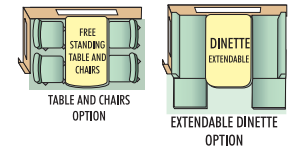

31BHS

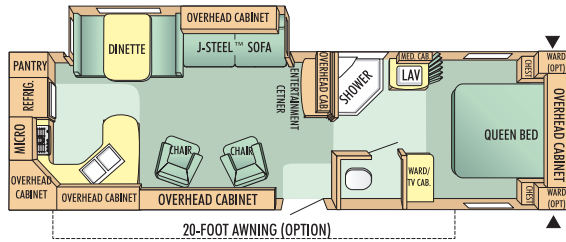
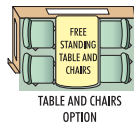

31RKS

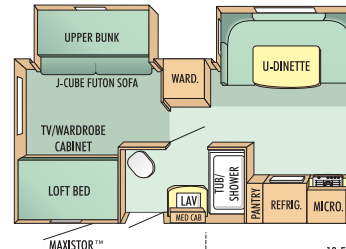
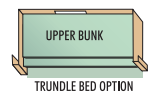
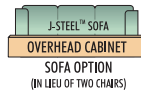

32BHDS

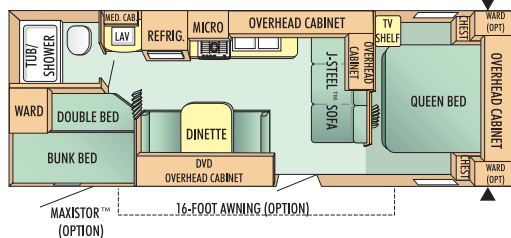
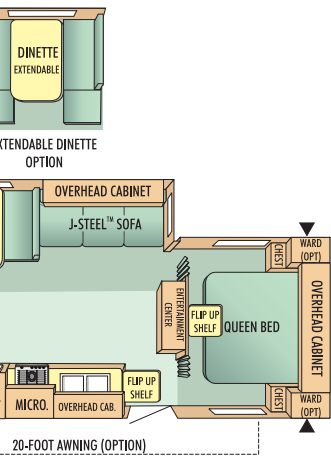

27BH

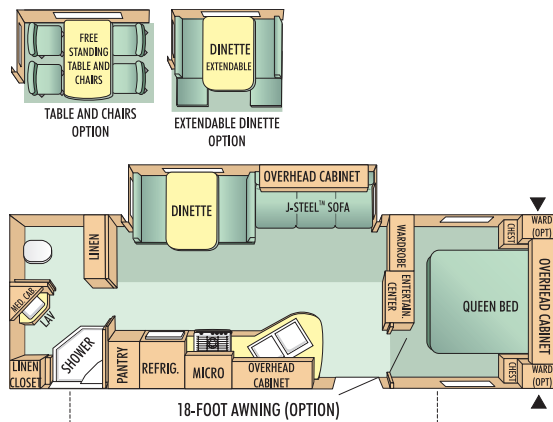

28RBs

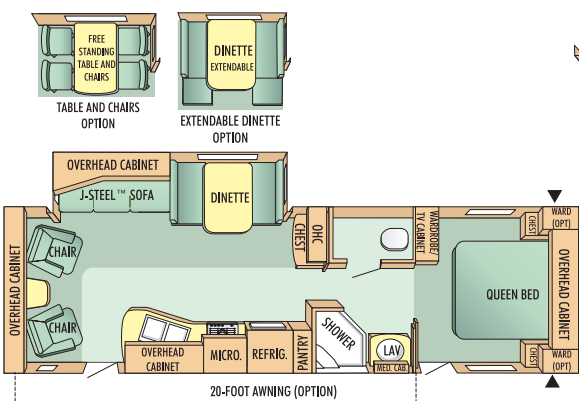
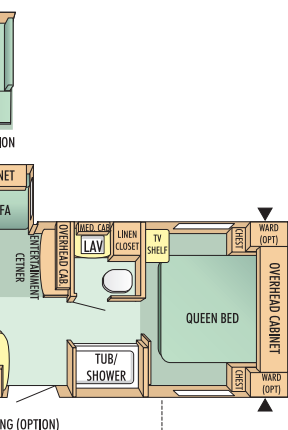

29RLs

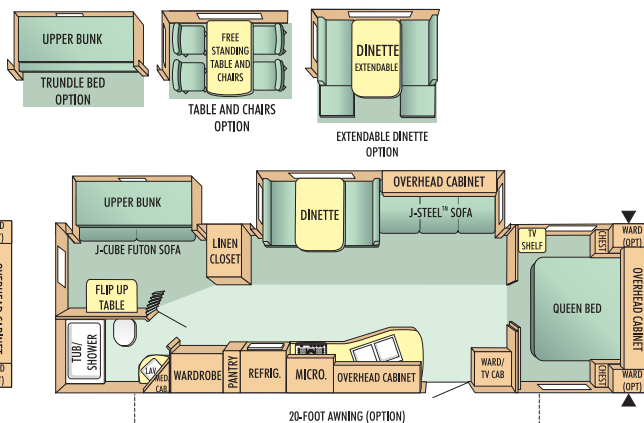

31BHDS

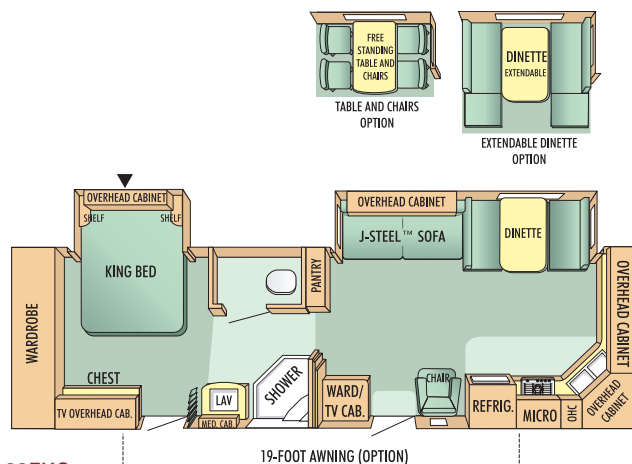
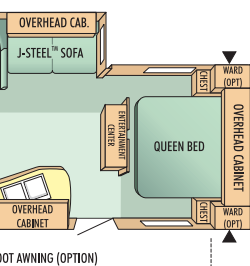

32FKS

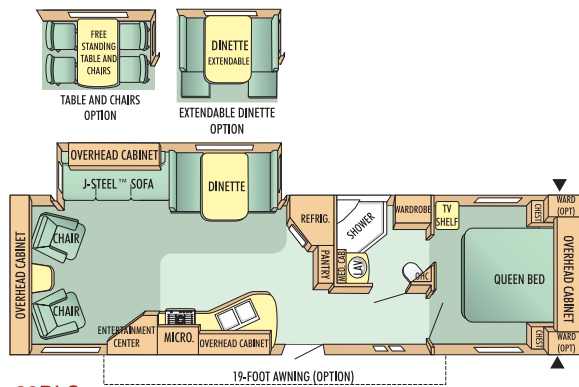

32RLs

LEGEND

▲ = Outside Storage Compartments LAV. = Bathroom Sink MICRO. = Microwave OHC. = Overhead Cabinets REFRIG. = Refrigerator WARD. = Wardrobe

JAY FLIGHT

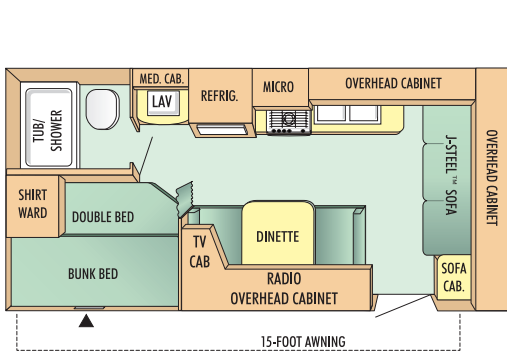

19BH

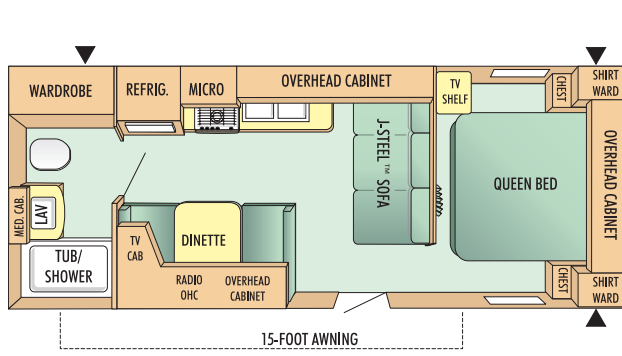

22FB

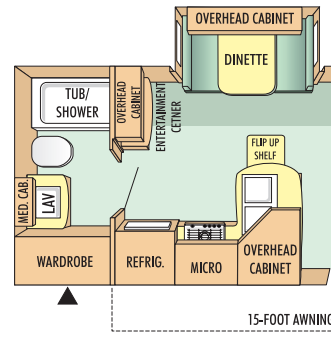

24FBS

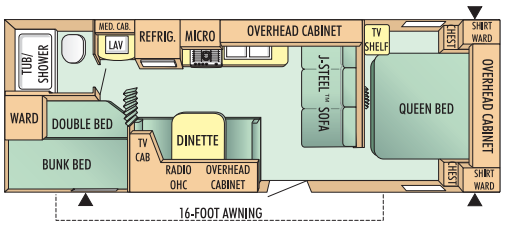

26BH

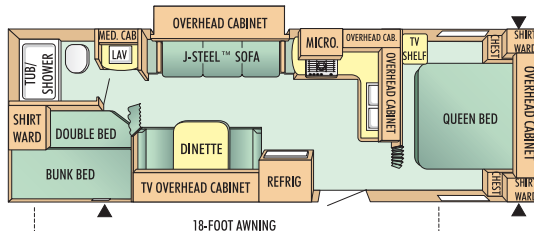

28BHS

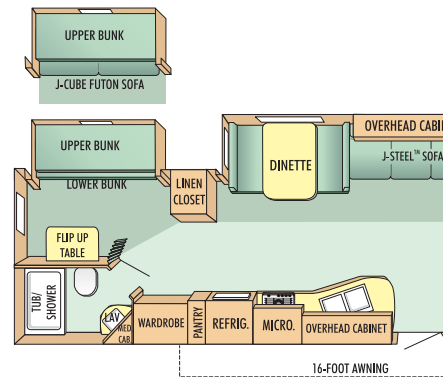

30BHDS

BUNGALOW

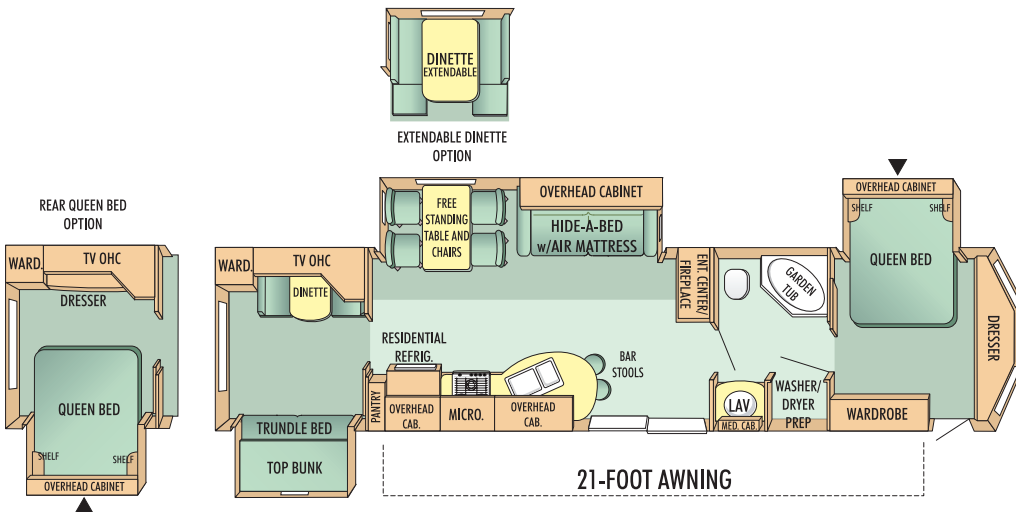

40BHS

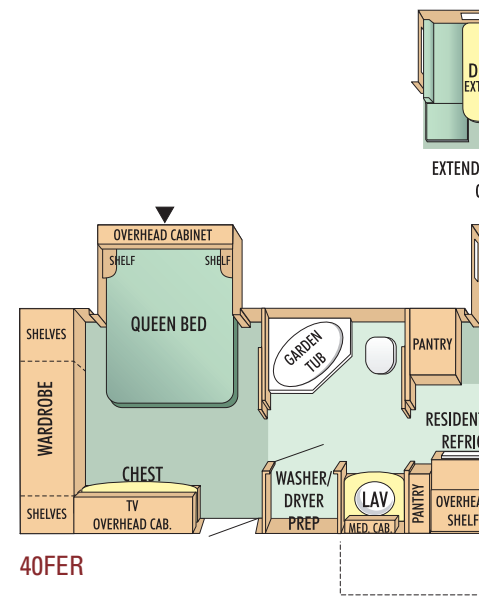

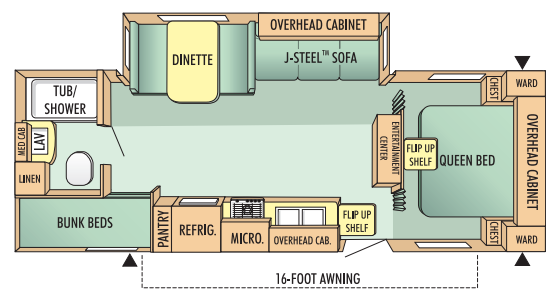
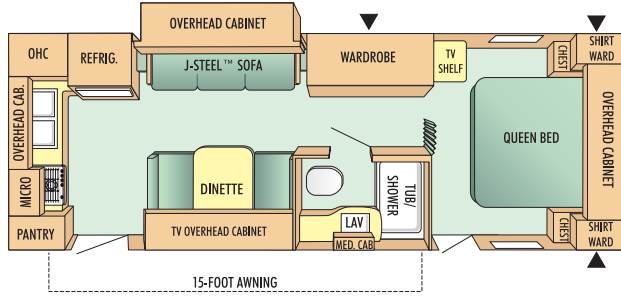
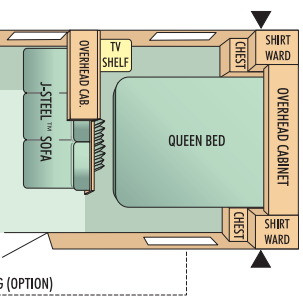

24RKS

25BHS

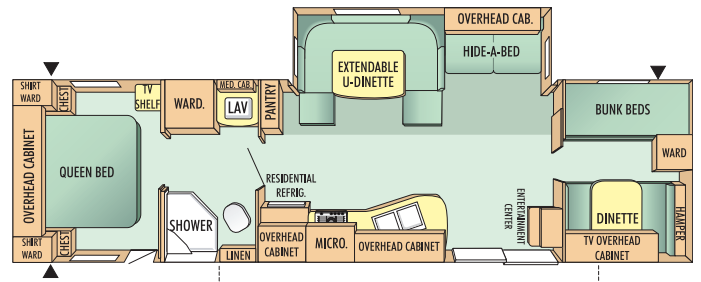
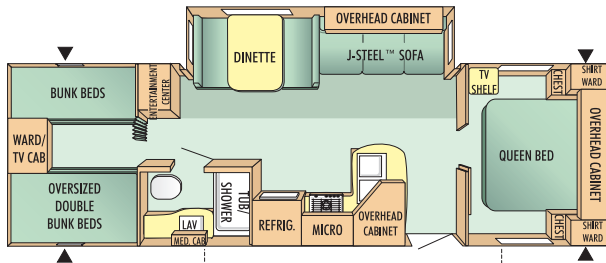
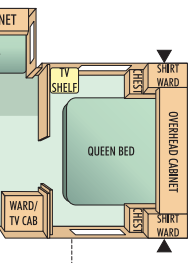

30BHS

36BHS



EXTENDABLE DINETTE OPTION

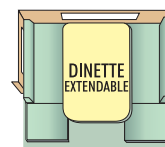

EXTENDABLE DINETTE OPTION

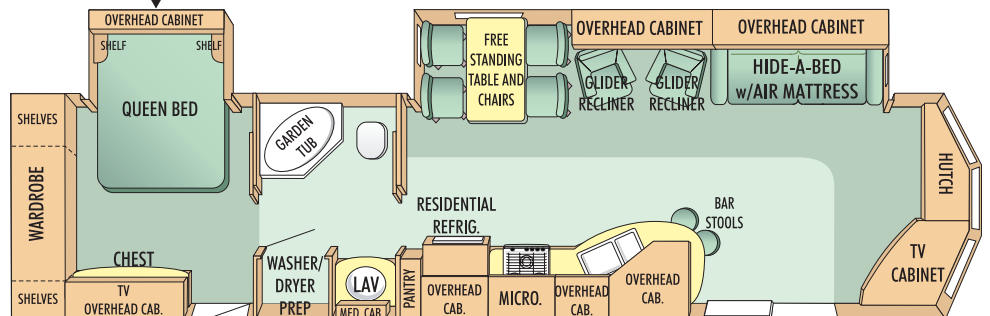
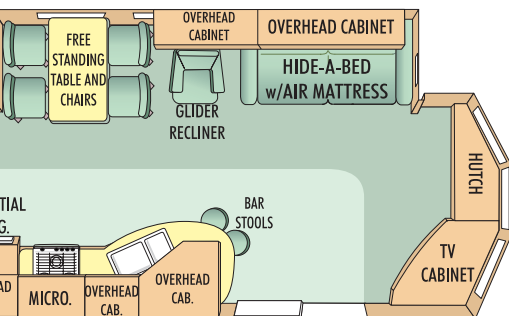

40FLR

21-FOOT AWNING

LEGEND



SECOND GLIDER RECLINER OPTION

▲ = Outside Storage Compartments LAV. = Bathroom Sink MICRO. = Microwave OHC. = Overhead Cabinets REFRIG. = Refrigerator WARD. = Wardrobe



AMERICA'S MOST **LIVEABLE** RVs.

IT'S ALWAYS BEEN ABOUT "LIVEABILITY"

Lloyd Bontrager went into the RV manufacturing business in 1968 to improve the camping trailer lifter system. He knew that a better lifter system would mean a more "liveable" camping experience for his family and so many others.

More than forty years later, and now the largest family-owned RV manufacturer in the world, this priority still rings true at Jayco. As we work to continue building "America's Most Liveable RVs", we do it with one goal in mind—to improve the RV experience and help make "family time" truly memorable.



We Back What We Build

The Jayco Co-Pilot Warranty is a manufacturer's limited warranty. It comes from the people who build Jayco recreation vehicles to the people who buy them. Each Jayco is warranted to the original purchaser for twenty-four (24) months or twenty-four thousand (24,000) miles (mileage limitation applies to motorized products only), whichever occurs first, from the original date of purchase against defects in materials and workmanship. Jayco's limited warranty is not transferable. Go ahead and compare the Jayco warranty with other manufacturers' warranties. You'll find it's the best in the business!

For a copy of the limited warranty with full terms and conditions, ask your local Jayco dealer.



Why a Local Jayco Dealer is Important to You

Establishing a solid relationship with your local Jayco dealer is a key component in the enjoyment of your new Jayco. By purchasing from a local dealer, you will have a convenient location for sales, parts and service support.

Jayco dealers are required to deliver all products at the site of the sale to ensure a full product orientation and walkthrough at the time of delivery. It's a good way to become familiar with your Jayco and to meet the service, parts and warranty staff members who will be assisting you. If you live in Canada, there are regulations that must be met when buying a Jayco RV. Your local Canadian dealer is a professional at meeting these requirements and regulations. There simply is no substitute for a good relationship with your local Jayco dealer.

Your Jayco Dealer

A large, empty white rounded rectangular box intended for a customer to write down their local Jayco dealer's name and contact information.

Customer First Roadside Assistance

Travel worry-free in your Jay Flight™ with Jayco's Customer First Roadside Assistance program, yours at no cost during your first year of ownership. This program is offered through Coach-Net®, the largest RV emergency road service in the country, and gives you immediate access to dependable roadside assistance and support services with a simple phone call.

- **Free** jump starts
- **Free** tire changes
- **Free** fuel delivery
- **Free** lockout service
- **Free** travelers checks
- Toll-free nationwide service appointment assistance
- 24-hour toll-free emergency message service
- **Free** custom trip routing and full color map service
- **Free** dispatch of on-site mechanical service
- \$2,000 trip interruption reimbursement



Jayco proudly sponsors Tread Lightly!®, a nonprofit organization whose mission is to empower generations to enjoy the outdoors responsibly through education and restoration.



From RV insurance to extended warranties, JayPlus has it covered. Ask your Jayco dealer about our exclusive JayPlus program today.



As a Jayco owner, you can be part of the Jayco Jafari International Travel Club. Ask your dealer about the Jafari "flight" in your area, write Jayco or visit our website.

Jayco, Inc., P.O. Box 460, Middlebury, IN 46540, www.jayco.com 

See dealer for further information and prices. All information in this brochure is the latest available at the time of publication approval. Jayco reserves the right to make changes and to discontinue models without notice or obligation. Photos in this brochure may show optional equipment and props for photography purposes. RVs built for sale in Canada may differ to conform to Canadian codes. E-Z Lube is a registered trademark of the Dexter Axle Company. Carefree is a registered trademark of Carefree of Colorado. Dolby and the double-D symbol are registered trademarks of Dolby Laboratories. ©2009 Jayco, Inc. 09-JFLT-PL 0309-20K Printed in U.S.A.