

# Jayco ZX



OCTANE ZX



# Bring it.

## With the Octane ZX, you can really bring all of your favorite things.



*The Octane ZX toy hauler offers comfortable, roomy living space combined with abundant room to store off-road toys. Perfect for those who live for adventure, the Octane ZX is designed for flexibility. With the flip of a switch, the cargo area transforms easily into a comfortable living space that features electric queen beds.*





**Bring your ATVs, motorcycles or side-x-sides off the beaten path for adventure. Bring the comfort of home—right down to the premier stereo system and ample garage. Bring plenty of friends, with sleeping room for at least seven. And Octane ZX is towable by most ½ ton trucks and large SUVs,\* so bringing it all is easy.**

*\*Consult with your authorized automobile vehicle owner's manual.*



2009  
**OCTANE ZX™**



# 2009 OCTANE ZX™

## Kick It.

After a day of riding, come back and relax in the Octane ZX. Turn on a movie, play some video games or turn in for the night. With the Octane ZX, you don't have to give up comfort or features to get a great toy hauler.



Cook a meal for friends or a late night snack in Octane's kitchen.



Catch some much needed sleep in the bedroom that offers plenty of storage for clothes and other gear.



## 2009 Octane ZX Floorplans

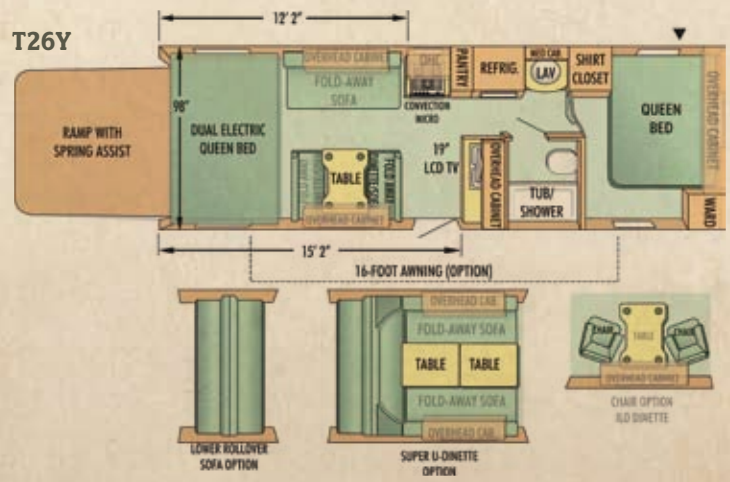
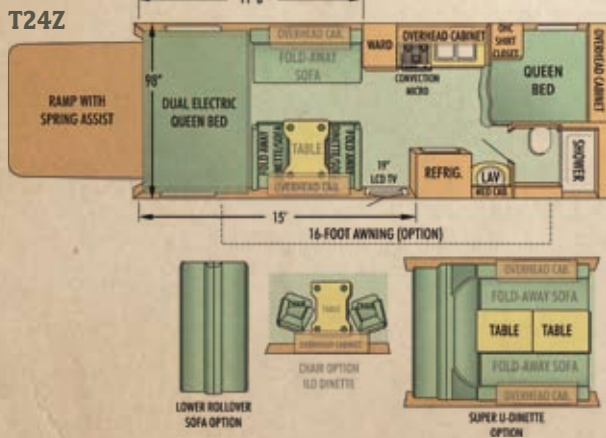





T29M | JAVA

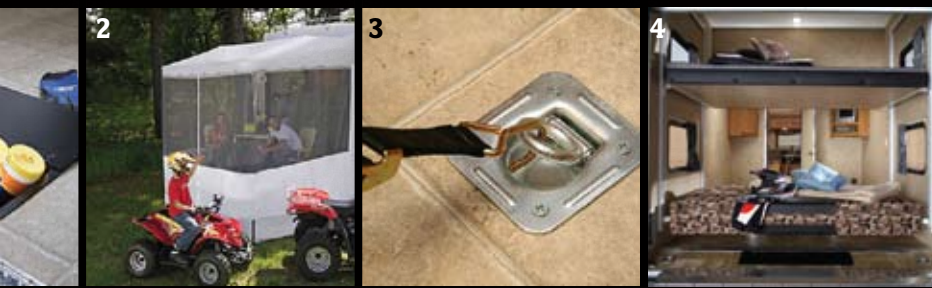

1. An in-ramp tool box keeps tools and other maintenance items out of the way, making room for toys and living space.
2. It's easy to extend living space with the optional screened-in patio room.
3. Octane ZX's tie-down D-rings are rated for 2,500 pounds and keep your toys stationary during travel.
4. Dual electric queen beds lower over the cargo area to create additional sleeping. Made of high-strength laminate, the beds allow for a higher clearance when the beds are lifted.

T29A

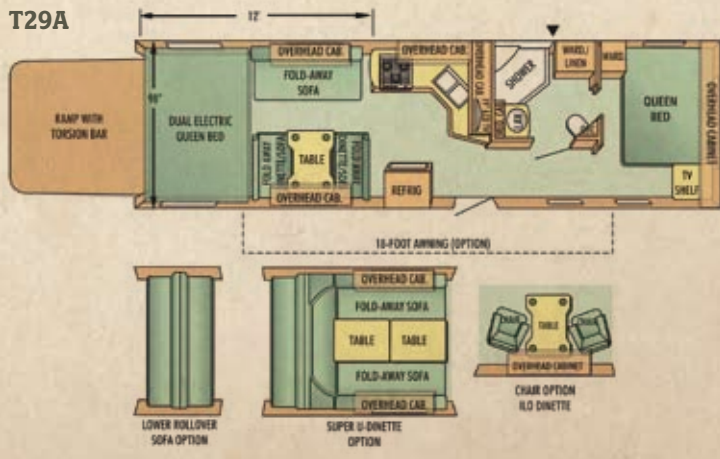

T29M

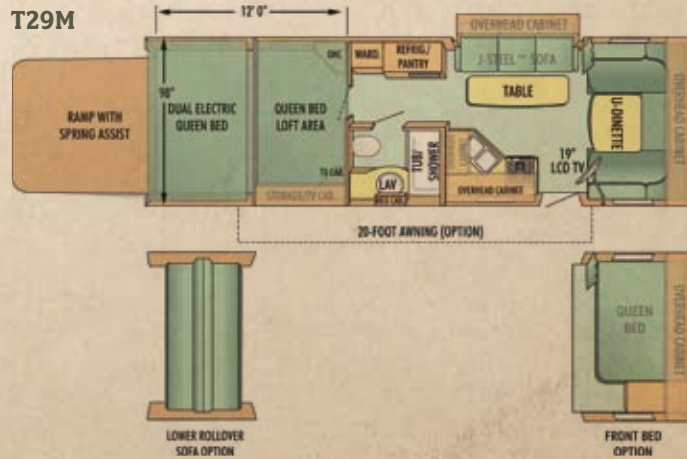



# STANDARDS AND OPTIONS

## STANDARD BATHROOM EQUIPMENT

ABS tub/shower surround
Magazine rack
Marine toilet with foot flush
Medicine cabinet with mirror
Residential 6-panel passage door
Round lavatory sink
Shower curtain with clear panel
Toilet paper holder
Towel holder

## STANDARD BEDROOM EQUIPMENT

A/C ducts in front bedroom (select models)
Pull curtain closure (select models)
Quilted bed mat (select models)

## STANDARD CONSTRUCTION FEATURES

2" unitized, laminated floor construction
102" wide body
3/8" decking on roof
98" interior width
Aerodynamic roof line
Double battery tray on A-frame
One-piece, seamless rubber roof
PolyFlex™ one-piece underbelly cover
R-7 insulation in roof and sidewalls
Roof rafters constructed of residential-style tapered 4½" trusses
Steel backers welded onto frame to mount D-rings
Structurwood™ main floor decking
Welded tubular aluminum floor frame

## STANDARD EXTERIOR EQUIPMENT

2,000 lb. capacity tongue jack
Aluminum rims
Cable and satellite TV prepped
Diamond-plated panel on front
Doorside lights (2)
Double, retractable entrance step
Electric brakes
E-Z Lube® axles
Fiberglass, radius cornered entrance door with screen door
High-intensity rear ramp lights (2)
Leaf spring axles
Lockable, radius-cornered baggage doors with heavy-duty grab handle
Mill-finished aluminum fender skirts
Molded ABS cover for propane gas bottle
Patio lights (2) with inside switch
Rain guttering molded with drip spouts
Rear ramp lights (2)
Roof ladder
Sony® marine grade exterior speakers (2)
Spare tire and carrier

## SPECIFICATIONS AND MEASUREMENTS

FLOORPLANS	T24Z	T26Y	T29A	T29M
<b>EXTERIOR LENGTH</b>	28' 8"	30' 7"	33' 7"	33' 7"
<b>EXTERIOR HEIGHT (W.A/C)</b>	145"	145"	148"	148"
<b>INTERIOR HEIGHT</b>	99"	99"	99"	105"
<b>UNLOADED VEHICLE WEIGHT (LBS.)</b>	6,560	6,975	7,450	7,870
<b>DRY HITCH WEIGHT (LBS.)</b>	895	975	1,155	1,140
<b>GROSS VEHICLE WEIGHT RATING (LBS.)</b>	10,250	10,900	11,950	11,950
<b>CARGO CARRYING CAPACITY (LBS.)</b>	3,690	3,925	4,500	4,080
<b>FRESH WATER (GAL.) INCLUDES WATER HEATER</b>	112	112	102	102
<b>GRAY WASTEWATER (GAL.)</b>	35	35	35	35
<b>TOILET/BLACK WASTEWATER (GAL.)</b>	48.5	35	35	35

It is important for your safety and enjoyment that your tow vehicle be adequately sized and equipped to tow and handle the GVWR of the RV you select. Review weights and rating of your tow vehicle and consult a competent advisor for questions or advice. Whether you are new to RVing or a veteran, get a feel for the performance of your tow vehicle and the RV together before heading out on the roadways. When you tow an RV, you must drive differently than you do when driving a single vehicle. Practice hooking up, driving, backing up and braking in a safe environment or seek out professional instruction. Jayco affixes a weight label to each RV, which lists weight information for that vehicle. See specification chart above.

## STANDARD INTERIOR EQUIPMENT

19" LCD HDTV
Brushed nickel hardware
Crank-up HDTV antenna with signal booster
Cupholders in dinette
Deep-lipped overhead cabinetry
Driveable wheel wells
Fabric-covered box valances with lambrequin legs
Garage vent ports
High-intensity 12V lighting package
iPod® charger and holder
Linoleum flooring throughout
Manchester Oak cabinetry
Multi-directional louvered central A/C vents
Pedestal-legged table
Pleated night shades
Raised panel cabinet doors in living area
Roll-over, fold-away sleeper/dinette and sleeper/sofa
Satellite receiver/DVD player shelf

## STANDARD KITCHEN EQUIPMENT

3-burner range with 9,000 BTU SuperBurner™ and piezo igniter
Cover for sink/cutting board (1)
Deep residential-style sink
Granite-look countertops
Mixing high-rise faucet
Overhead range hood with light and exhaust fan (select models)

## STANDARD POWER, WATER AND HEAT

110V G.F.C.I. protected exterior receptacles (2)
12V demand water pump
12V electrical system with deluxe 110V 45 amp power converter
30 amp electric service
A/C chill grill
Automatic transfer switch with generator or generator prep
Battery disconnect switch
Double 30 lb. propane bottles with regulator
Furnace with wall thermostat, auto-ignition
Generator prep with 21 gallon gas tank
Hookup for city water
Monitor panel for all systems
Outside shower
Sewer hose storage compartment
Water heater bypass system
Water system winterization kit

## STANDARD RAMP AND CARGO EQUIPMENT

7' ramp, 2,500 lb. capacity
7'10" door/ramp, 2,500 lb. capacity
96" wide ramp door opening
Anti-slip, non-skid flooring on ramp door
Beaver tail transition ramp
Cam style latches and keyed locks on ramp door

## INTERIOR COLOR OPTIONS



1. Drapery 2. Bedspread 3. Upholstery 4. Main

**Unloaded Vehicle Weight (UVW):** Sometimes referred to as "Dry Weight," UVW means the typical weight of this trailer as built at the factory. The UVW, as used in product literature and other promotional materials, does not include cargo, fresh water, propane, options or dealer-installed accessories.

**Gross Vehicle Weight Rating (GVWR):** GVWR means the maximum permissible weight of the trailer, including the UVW plus passengers, personal items, all cargo, fluids, options and dealer-installed accessories. The GVWR is equal to or greater than the sum of the UVW and the CCC.

Clothes hangers (2)
Flush floor-mounted tie-down rings anchored to frame, 2,500 lb. capacity each
Hinge spring assist, radius-cornered door
Retractable electric beds
Welded steel storage compartment in garage floor

## STANDARD SAFETY EQUIPMENT

Breakaway switch
Carbon monoxide alarm
Fire extinguisher
Lock and dead bolt on entrance door
Multiple egress windows
Propane alarm
Smoke alarm
Tinted safety glass windows

## OPTIONS

4,000 watt generator
Customer Value Package
Customer Value Package with 15,000 BTU A/C
Duracell Power Package with air compressor, power jump pack & 300 watts A/C power
Electric queen bunk bed with rollover sofa
Electric queen bunk bed with rollover sofa with Super U Dinette (select models)
Free-standing table with 2 chairs ILO dinette
Fuel station
Patio screen room and rear awning
Queen bed ILO U-Dinette (select models)
Retractable screen wall
Roll-up cargo carpet
Satellite kit
Sony® Xplod® subwoofer & amplifier
ToyLok® retractable security cable
Transition ramps (2)

## CUSTOMER VALUE PACKAGE

6 gallon gas/electric DSI water heater
A/C Central (13,500 or 15,000 BTU) with wall thermostat
Bathroom power vent
Bathroom skylight
Carefree® Travl'r 12V electric patio awning
Convection microwave
Large double door refrigerator
Range cover
Sony® Stereo System (4 speakers), Sony® CD Receiver and iPod® and MP3 input jack
Stabilizer jacks (4)
Water purification system

## A LEGACY OF CRAFTSMANSHIP

Jayco's dedicated production team includes Amish craftsmen who build with well-honed woodworking techniques passed down for generations and skilled seamstresses who produce our upholstery, bedding and draperies with great attention to detail.



**Cargo Carrying Capacity (CCC):** CCC means the maximum weight of all passengers, personal items, food, fresh water, propane, tools, other cargo and dealer-installed accessories that can be carried by the trailer. CCC is equal to or less than GVWR minus UVW. The addition of options will decrease the CCC.

**Hitch Weight (HW):** The hitch weight, as used in product literature and other promotional materials, does not include cargo, fresh water, propane gas, options or dealer-installed accessories. The addition of these types of items will either add to or subtract from the stated hitch weight.



# Designed to Hold Its Own.

Jayco ZX toy haulers are built tough with high-end materials so you can go where you want to go ... when you want to go.

## Protection From the Elements

Our seamless one-piece rubber roof **1** covers 3/8" Structurwood® decking, 4 1/2" wooden rafters **2**, and R-7 fiberglass insulation. It offers superior protection from rain, heat and noise—and the one-piece rubber roof comes with a 12-year warranty.

## A Firm Foundation

Our 2" laminated floor construction includes bead foam insulation and 3/8" Structurwood® flooring **3** to create a firm foundation for adventure.

## Convenience and Comfort

Design features like lockable storage compartments **4**, tinted safety glass windows **5**, central air conditioning **6**, a Carefree® Travel'r 12V electric patio awning **7** and retractable entrance steps **8** make life comfortable and convenient.



## Lightweight and Durable

Our sidewall construction features R-7 fiberglass insulation **9** and 2-inch wall studs on 16-inch centers **10**.

## Keeping Cargo Safe

The ramp door features an anti-slip, non-skid floor **11** and radius-cornered ramp door with spring-hinge assist system **12**. With a 2,500 pound capacity, the wide ramp makes it easy to load and unload large toys. Ten flush-floor mounted D-rings anchored to the frame hold 2,500 pounds each, ensuring toys will remain safely in place during journeys.



## Impressive Sound Capabilities

Nothing gets you more inspired to ride than listening to music on Octane's Sony® stereo (a) with iPod® adapter/charger and four Sony® Xplod® speakers (b). The Octane's exclusive sound system allows for a premium sound experience wherever you want—indoor or outdoor (e). If you're the type who likes to take it up a notch, add the optional Sony® Xplod® subwoofer (c) and amplifier (d).





AMERICA'S MOST LIVEABLE RVs.

## IT'S ALWAYS BEEN ABOUT "LIVEABILITY"

Lloyd Bontrager went into the RV manufacturing business in 1968 to improve the camping trailer lifter system. He knew that a better lifter system would mean a more "liveable" camping experience for his family and so many others.

More than forty years later, and now the largest family-owned RV manufacturer in the world, this priority still rings true at Jayco. As we work to continue building "America's Most Liveable RVs," we do it with one goal in mind—to improve the RV experience and help make "family time" truly memorable.



## We Back What We Build.



The Jayco Co-Pilot Warranty is a manufacturer's limited warranty. It comes from the people who build Jayco recreation vehicles to the people who buy them. Each Jayco is warranted to the original purchaser for twenty-four (24) months or twenty-four thousand (24,000) miles (mileage limitation applies to motorized products only), whichever occurs first, from the original date of purchase against defects in materials and workmanship. Jayco's limited warranty is not transferable. Go ahead and compare the Jayco warranty with other manufacturers' warranties. You'll find it's the best in the business!

For a copy of the limited warranty with full terms and conditions, ask your local Jayco dealer.



Jayco proudly sponsors Tread Lightly!®, a nonprofit organization whose mission is to empower generations to enjoy the outdoors responsibly through education and restoration.



From RV insurance to extended warranties, JayPlus has it covered. Ask your Jayco dealer about our exclusive JayPlus program today.



As a Jayco owner, you can be part of the Jayco Jafari International Travel Club. Ask your dealer about the Jafari "flight" in your area, write Jayco or visit our website.

Your Jayco Dealer

## Why a Local Jayco Dealer is Important to You

Establishing a solid relationship with your local Jayco dealer is a key component in the enjoyment of your new Jayco. By purchasing from a local dealer, you will have a convenient location for sales, parts and service support.

Jayco dealers are required to deliver all products at the site of the sale to ensure a full product orientation and walkthrough at the time of delivery. It's a good way to become familiar with your Jayco and to meet the service, parts and warranty staff members who will be assisting you. If you live in Canada, there are regulations that must be met when buying a Jayco RV. Your local Canadian dealer is a professional at meeting these requirements and regulations. There simply is no substitute for a good relationship with your local Jayco dealer.

## Customer First Roadside Assistance

Travel worry-free in your toy hauler with Jayco's Customer First Roadside Assistance program, yours at no cost during your first year of ownership. This program is offered through Coach-Net®, the largest RV emergency road service in the country, and gives you immediate access to dependable roadside assistance and support services with a simple phone call.

- **Free** jump starts
- **Free** tire changes
- **Free** fuel delivery
- **Free** lockout service
- **Free** travelers checks
- Toll-free nationwide service appointment assistance
- 24-hour toll-free emergency message service
- **Free** custom trip routing and full color map service
- **Free** dispatch of on-site mechanical service
- \$2,000 trip interruption reimbursement