

Coach House[®] Motor Homes

Platinum

F O R D E - 4 5 0 S U P E R D U T Y C H A S S I S



Platinum II

M E R C E D E S 3 5 0 0 S P R I N T E R C H A S S I S



Our Story

COACH HOUSE BUILDS AN R.V. LIKE NO OTHER

Engineered to industry-leading standards in performance, convenience and design, the Coach House® Platinum® redefines the luxury touring motorhome lifestyle. Whether you're on the journey of a lifetime through the Rockies with your better half, a day trip to the zoo with your grandkids, or tailgating with your fun-loving friends, the reliable Platinum gets you there and back comfortably, safely and in style. ■ The Platinum and Platinum II are downsized Class C motorhomes (also known as "Class B-plus"), yet they provide plenty of room for full-sized living. Every Platinum boasts at least 6-foot, 3-inch ceilings, a private bathroom with a stand-up shower, and plenty of special-purpose storage space throughout for food, clothes, travel gear and vacation toys. An array of distinctive Platinum models on two different chassis offer you a wide choice of

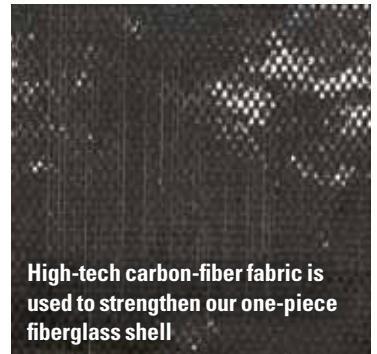

versatile, functional floor plans to flow with your R.V. lifestyle.



IT ALL STARTS WITH THE SHELL

One of the most important features of the Platinum motorhome is the patented one-piece hand-laid fiberglass body (shown at left). The superstructure is reinforced with carbon fiber and designed to prevent water leaks and rattles and to give you years of trouble-free enjoyment. Most RV

bodies consist of many pieces joined together, and where they are joined represents a potential for failure. Our one-piece shell is stronger, more durable, quieter and safer than multi-piece designs, and its aerodynamic shape improves fuel efficiency.

FORD POWER OR MERCEDES EFFICIENCY

Coach House realizes that the most important part of a recreational vehicle is the chassis, or foundation. We offer our customers their choice of a big, brawny Ford E-450 Super Duty chassis in the Platinum line, or a refined, high-tech Mercedes 3500 Diesel Sprinter chassis in the Platinum II line. Whether you value power or efficiency more highly, we think you will agree that these are the two best platforms available for a downsized luxury motorhome. And



PLATINUM II:
Fuel-efficient
Mercedes Sprinter
chassis, powered by a
Mercedes-Benz diesel



Well-equipped kitchens are standard across the Platinum line

whichever chassis you choose, your Platinum has been approved and inspected by Ford or Mercedes and carries the RVIA seal, indicating that it meets all current motorhome codes and standards.

HOME AWAY FROM HOME

All the amenities of home are at your fingertips in the Coach House Platinum. Road warrior chefs can create a quick snack or a gourmet meal, thanks to the well designed and thoughtful layout of the functional and well-equipped galley. Corian solid-surface countertops, recessed

stainless-steel sink and cover, abundant storage, 3-way refrigerator and LP-gas stove are just a few of the conveniences you'll find in this remarkable vehicle. The

Platinum's full bathroom features a stand-up shower, porcelain commode and medicine cabinet. The motorized sofa-bed converts from daytime entertaining to nighttime slumbering at the touch of a button.

PEACE OF MIND – GUARANTEED

Our warranty policies can be summed up simply: We stand behind our vehicles. Period! Every component of a Platinum motorhome is covered by warranty: The Coach House conversion and the drivetrain are covered for 3 years or 36,000 miles, whichever comes first. The appliances and fixtures are covered by their respective manufacturers for varying terms. Warranty service is available nationwide at the repair facility of your choice, or at the Coach House plant in Nokomis, Florida.



Warranty service is always available at the Coach House plant

FAMILY-OWNED AND MADE IN THE U.S.A. SINCE 1985

Ruben Gerzeny and sons David and Steve have been designing, engineering and building motorhomes in the Venice, Florida, area since 1985, when the first Coach House van conversion rolled out of a converted warehouse. Their decades of R.V. manufacturing experience, attention to the smallest details, and "build-it-right, build-it-to-last" philosophy come together in the design and construction of every Coach House

Platinum motorhome. Known for their fair and honest business

practices, the Gerzeny family goes the extra mile to satisfy their customers' concerns before and after the purchase. ■

PLATINUM:
Ford E-450 Super Duty chassis, capable of hauling a combined 22,000 pounds (GCWR)



David and Steve Gerzeny

Platinum

FORD E-450 SUPER DUTY: POWER AND CONTROL

Merge with highway traffic. Tow a car or boat. Fear no hill. The Platinum's Ford E-450 Super Duty chassis, featuring a 6.8-liter V-10 Triton engine and 5-speed TorqShift transmission and rear suspension stabilizers, provides power and smoothness on the open road. The Platinum's maneuverability and easy handling will give any driver confidence behind the wheel.



220

OUR MOST COMPACT, ECONOMICAL MODEL



COACH HOUSE PLATINUM 220TB (shown with optional Basic full-body paint in Candy Apple)

220 TB Galley with pull-out pantry (Decor: Lakeside Cherry)



220 TB Twin Bed (no slideout)

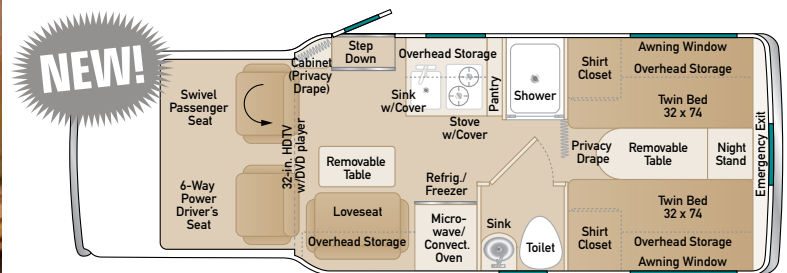

220 TB Twin beds with shirt cabinets (Decor: Lakeside Cherry)



SMALL ON THE OUTSIDE, BIG ON THE INSIDE

221XL



COACH HOUSE PLATINUM 221XL (shown with optional Premier full-body paint in Mosaic Blue)

221XL SD Power sofa-bed in the "up" position (Decor: Honey Maple)



221XL SD Power sofa-bed in the sleeping position (Decor: Honey Maple)



221XL SD Side Dinette with slideout

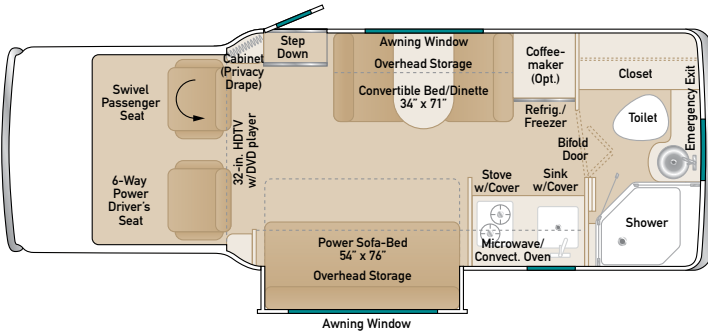

221XL SD Looking back from cab (Decor: Honey Maple)



221XL SD Side dinette (Decor: Honey Maple)



232XL LIVE LARGE IN A SMALLER MOTORHOME



COACH HOUSE PLATINUM 232XL (shown with optional Basic full-body paint in Candy Apple)



232XL FS Looking forward from double bed (Decor: Lakeside Cherry)



232XL FS Permanent double bed (Decor: Lakeside Cherry)



232XL FS View from front of coach (Decor: Lakeside Cherry)

232XL FD Front Dinette with two slideouts

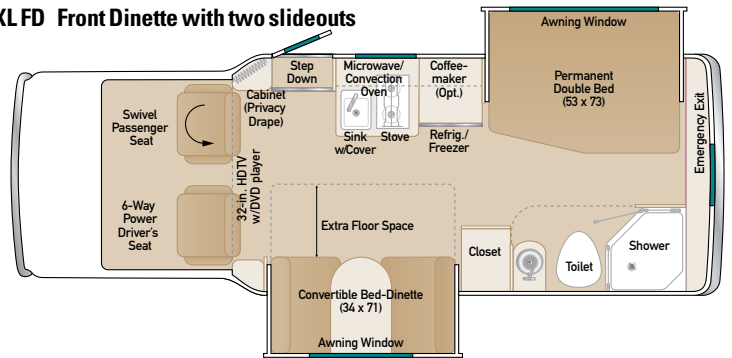

232XL FS Front Sofa with two slideouts

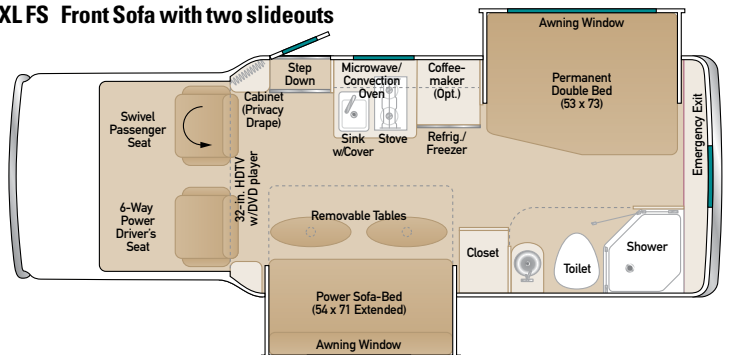

ENTERTAIN IN THE WIDE-OPEN SPACES

261XL



COACH HOUSE PLATINUM 261XL (shown with optional Premier full-body paint in Autumn Copper)



261XL DT View from front showing twin beds (Decor: Lakeside Cherry)



261XL ST Removable tables



261XL QD Kitchen

261XL QD Queen Dinette with slideout

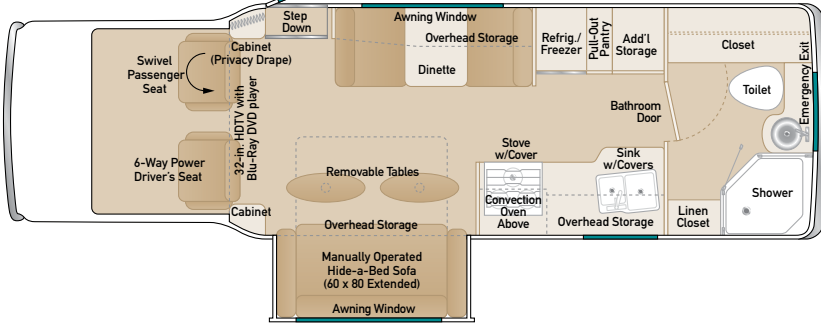

261XL QD Open living space with slideout extended (Decor: Lakeside Cherry)

261XL ST Sofa Twin with slideout

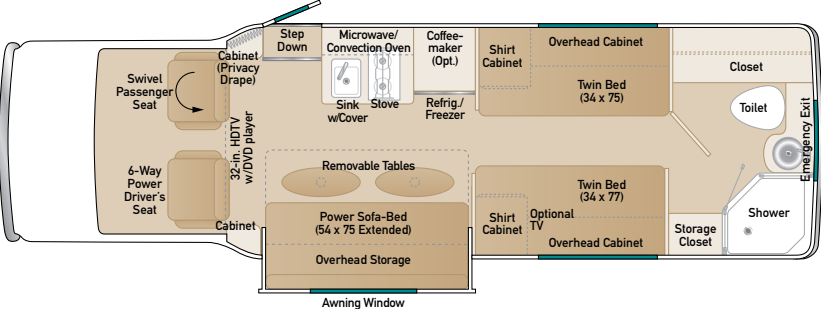

261XL DT Dinette Twin with slideout

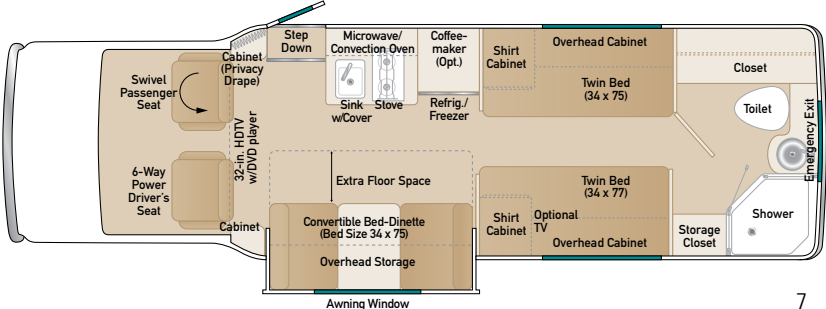

271XL

FULL-SIZE LUXURY IN A DOWNSIZED COACH



COACH HOUSE PLATINUM 271XL (shown with optional Premier full-body paint in Mosaic Blue)



271XL FS Kitchen (Decor: Lakeside Cherry)



271XL FD View forward with optional bedroom TV (Decor: Lakeside Cherry)



271XL FS Rear twin beds (Decor: Lakeside Cherry)

271XL FD Front Dinette with slideout

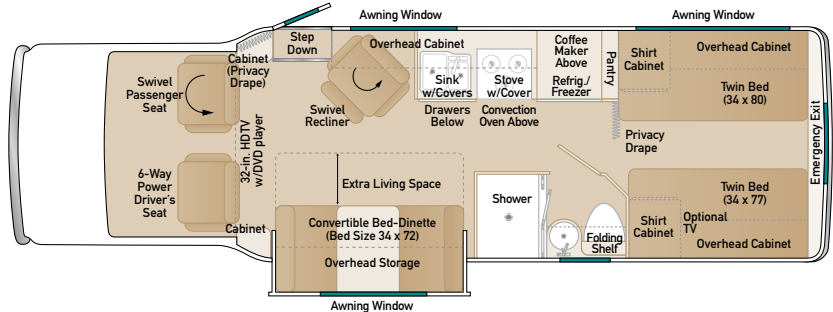

271XL FS Front Sofa with slideout

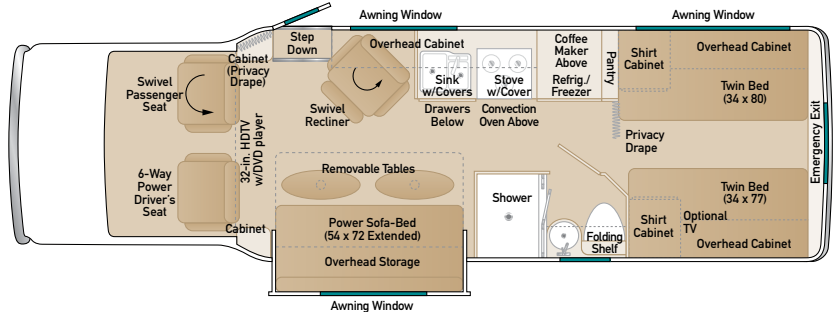

THE ULTIMATE IN LUXURY AND SPACIOUSNESS

272XL



COACH HOUSE PLATINUM 272XL (shown with optional Basic full-body paint in Mosaic Blue)



272XL FS Bedroom with wardrobe, drawers and TV (Decor: Honey Maple)



272XL FS View from the front with power recliner (Decor: Honey Maple)

272XL FD Front Dinette with two slideouts

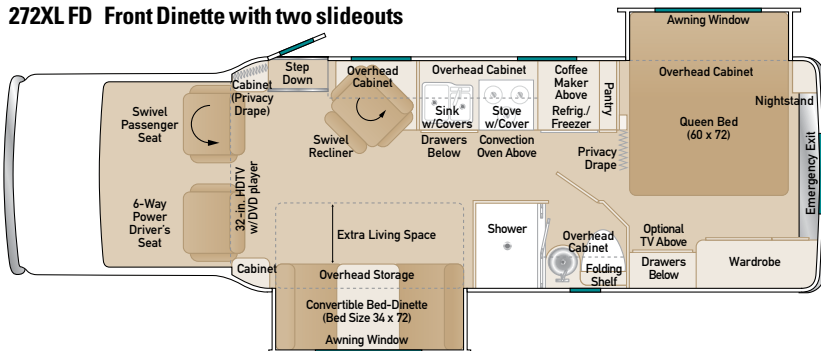

272XL FS Front Sofa with two slideouts

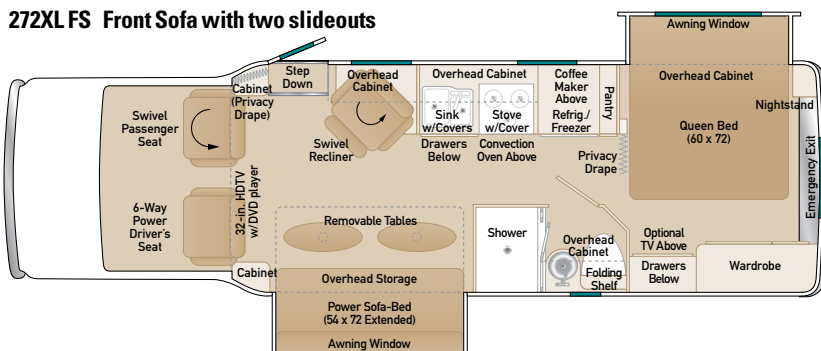

272XL FS Power sofa (Decor: Honey Maple)

Platinum II

MERCEDES 3500: EFFICIENCY AND STYLE

The Platinum II is built on a Sprinter chassis powered by a 3.0L V-6 CRD diesel Mercedes-Benz engine that delivers up to 20 mpg. This chassis features: A unibody design forming a single load-bearing structure; 16-inch wheels; dual-circuit hydraulic brake system; maintenance-free front wheel bearing assemblies; independent front suspension; and reinforced leaf springs.



EUROPEAN STYLING FOR THE AMERICAN HIGHWAY

240



COACH HOUSE PLATINUM 240 (shown with optional Premier full-body paint in Mosaic Blue)

240 & 241XL DT Rear twin beds (Decor: Lakeside Cherry)



240 & 241XL Kitchen (Decor: Honey Maple)



241XL

SPORTY AND SPACIOUS WITH A SLIDEOUT

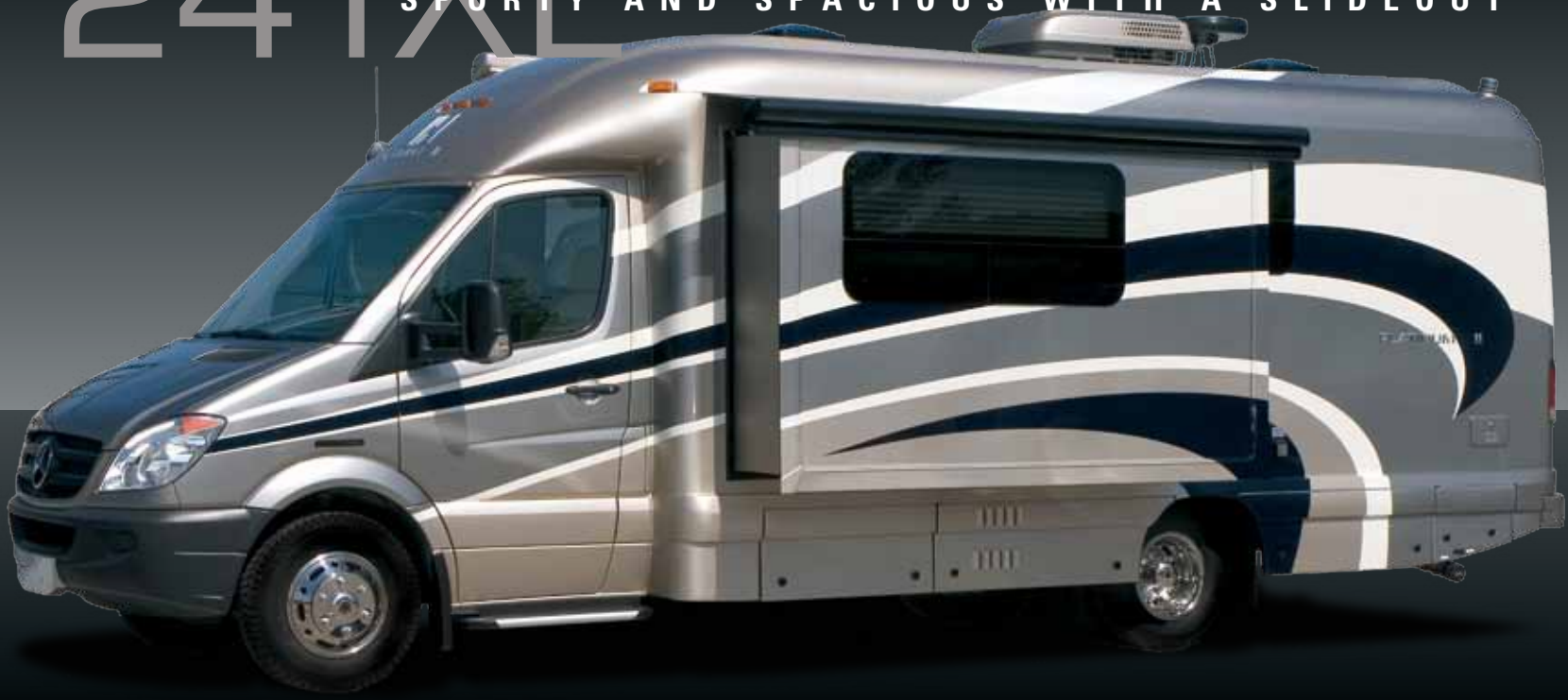

COACH HOUSE PLATINUM 241XL (shown with optional Premier full-body paint in Mosaic Blue)



241XL QD View from front (Decor: Honey Maple)



241XL QD View from the rear (Decor: Honey Maple)



240 & 241XL QD Island queen bed (Decor: Honey Maple)



240 & 241XL FS & FD Enclosed bathroom with stand-up shower (Decor: Honey Maple)

Platinum II

FLOOR PLANS FOR MERCEDES 3500 CHASSIS

240 DRT Dinette Rear Twin • 241XL DRT Dinette Rear Twin with slideout

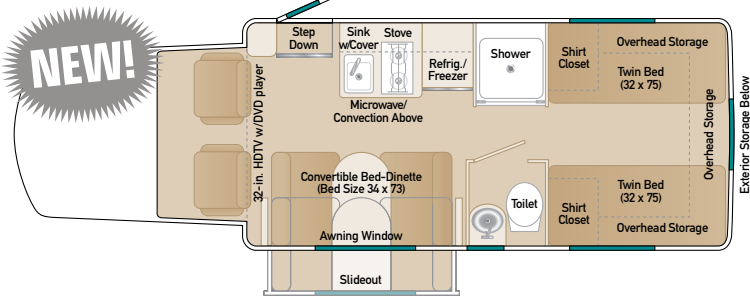

240 SRT Sofa Rear Twin • 241XL SRT Sofa Rear Twin with slideout

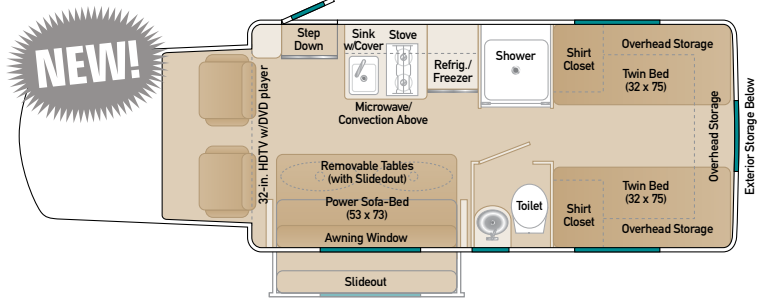

240 DQ Dinette Queen • 241XL DQ Dinette Queen with slideout

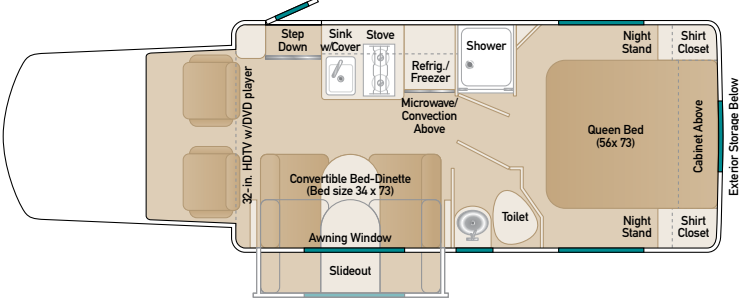

240 SQ Sofa Queen • 241XL SQ Sofa Queen with slideout

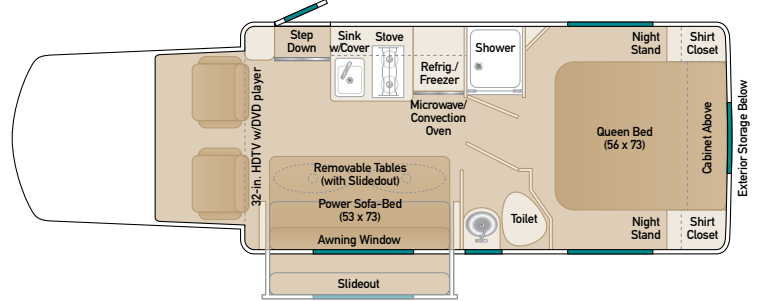

240 DT Dinette Twin • 241XL DT Dinette Twin with slideout

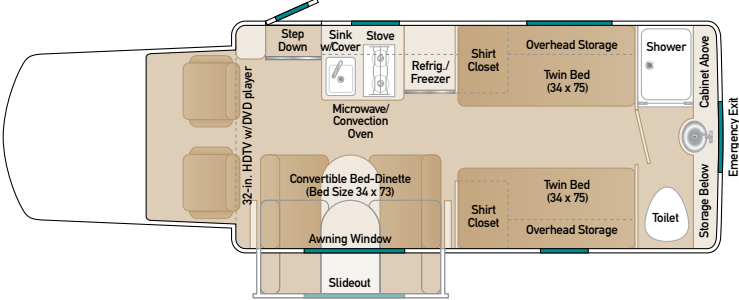

240 ST Sofa Twin • 241XL ST Sofa Twin with slideout

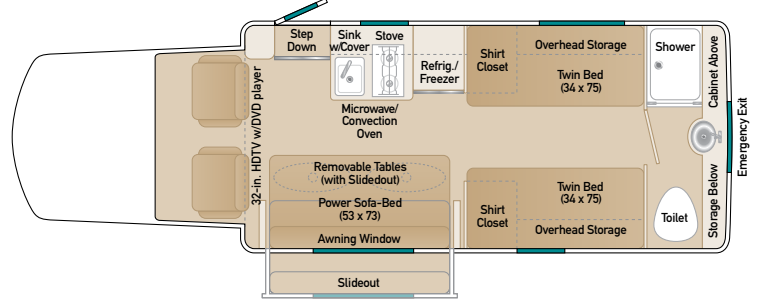

240 FD Front Dinette • 241XL FD Front Dinette with slideout

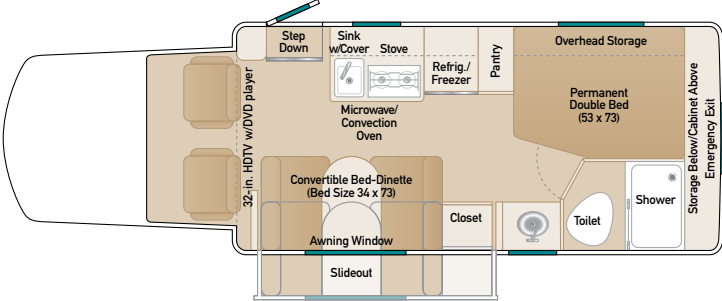

240 FS Front Sofa • 241XL FS Front Sofa with slideout

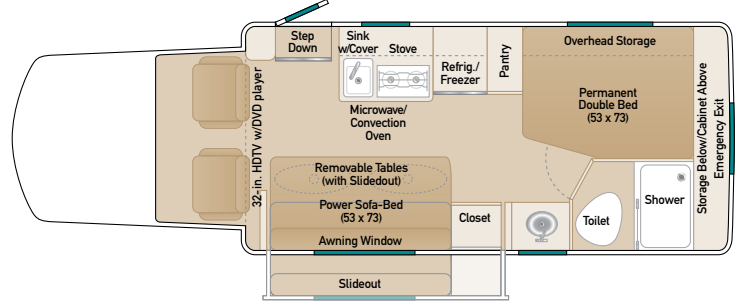

240 DS Dinette Sofa • 241XL DS Dinette Sofa with slideout



240 SS Sofa/Sofa • 241XL SS Sofa/Sofa with slideout

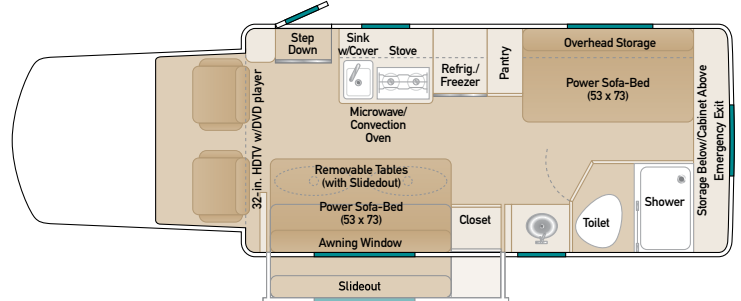

PAINT AND DECOR SELECTIONS

EXTERIOR PAINT

WHITE PAINT WITH VINYL ACCENTS



BASIC PAINT — CANDY APPLE



BASIC PAINT — MOSAIC BLUE



DELUXE PAINT — SUNSET



DELUXE PAINT — GRANITE



PREMIER PAINT — AUTUMN COPPER



PREMIER PAINT — MOSAIC BLUE



CABINETS, UPHOLSTERY, COUNTERTOPS

**LAKESIDE CHERRY CABINETS /
ARLEQUIN UPHOLSTERY**

CABINETS



OPTIMA LEATHER



UPHOLSTERY



CORIAN COUNTERTOPS



**HONEY MAPLE CABINETS /
TRAVIS UPHOLSTERY**

CABINETS



OPTIMA LEATHER



UPHOLSTERY



CORIAN COUNTERTOPS



FEATURES AND SPECIFICATIONS

● = Standard ○ = Optional
 — = Not available or not applicable

FORD 158"			FORD 176"			MERCEDES	
220	221XL	232XL	261XL	271XL	272XL	240	241XL

INTERIOR FEATURES

Two color choices: Lakeside Cherry or Honey Maple	●	●	●	●	●	●	●
Expansive overhead storage	●	●	●	●	●	●	●
Large wardrobe closet	●	●	●	●	●	●	●
Corian solid-surface counter tops	●	●	●	●	●	●	●
32-inch flat-panel HD TV w/swing arm	●	●	●	●	●	●	●
Blu-Ray DVD player	●	●	●	●	●	●	●
Duo day-night shade system	●	●	●	●	●	●	●
HD TV antenna	●	●	●	●	●	●	●
Front privacy drape on overhead track	●	●	●	●	●	●	●
Premium-grade carpet and floor coverings	●	●	●	●	●	●	●
6-way power driver's seat, swivel front passenger seat	●	●	●	●	●	—	—
Swivel front driver and passenger seats	—	—	—	—	—	●	●
Mirror in bathroom	●	●	●	●	●	●	●
Medicine cabinet	●	●	●	●	●	●	●
Separate 6-ft 2-in. stand-up shower	●	●	●	●	●	●	●
Lavatory sink	●	●	●	●	●	●	●
Fire extinguisher	●	●	●	●	●	●	●
Premium wood-grain or metallic dashboard kit	●	●	●	●	●	—	—
Leather-touch upholstery	●	●	●	●	●	●	●
Bose Surround Sound for front TV	○	○	○	○	○	○	○
Flat-panel HD TV in bedroom (some models)	○	—	○	○	○	○	○
Rear view mirror w/compass and outside temperature	○	○	○	○	○	○	○

EXTERIOR FEATURES

Patented one-piece body with carbon-fiber reinforcement	●	●	●	●	●	●	●
Electric entrance step with light	●	●	●	●	●	●	●
Class III trailer hitch	●	●	●	●	●	●	●
Exterior storage compartments	●	●	●	●	●	●	●
Spare tire	●	●	●	●	●	—	—
1.5-inch square-tube steel or aluminum floor frame	●	●	●	●	●	—	—
4-inch channel aluminum floor frame	—	—	—	—	—	●	●
Stainless steel wheel simulators	●	●	●	●	●	●	●
Exterior hot and cold shower	●	●	●	●	●	●	●
Full-size entry door with screen	●	●	●	●	●	●	●
Cable TV jack	●	●	●	●	●	●	●
HWH hydraulic slideout	—	●	—	●	—	—	●
Two HWH hydraulic slideouts	—	—	●	—	—	●	—
HWH automatic hydraulic leveling system	—	○	○	○	○	●	—
Equalizer system stabilizer	○	—	—	—	—	—	○
MOR/ryde rear suspension	—	●	●	●	●	●	—
Hellwig rear suspension kit	—	—	—	—	—	●	●
Awning windows (frameless in Platinum II)	●	●	●	●	●	●	●
Rear skid wheels	—	—	—	●	●	●	●
White exterior paint (vinyl graphics)	●	●	●	●	●	●	●
Full-body paint (Basic, Deluxe or Premier)	○	○	○	○	○	○	○
Legless power awning	○	○	○	○	○	○	○
"Safety-Plus" steering control arm	○	○	○	○	○	—	—

HEATING AND COOLING

15,000-Btu ducted roof air conditioner with heat pump	●	●	●	●	●	●	●
30,000-Btu auto LP gas furnace	●	●	●	●	●	●	●
Two Fantastic roof vents with thermostat & rain sensor	●	●	●	●	●	●	●
Heavy-duty insulation R-18	●	●	●	●	●	●	●
Heated holding tanks	○	○	○	○	○	○	○

GALLEY FEATURES

Two- or three-burner LP gas stove (depends on floorplan)	●	●	●	●	●	●	●
Stainless-steel range hood	●	●	●	●	●	●	●
Convection/Microwave oven	●	●	●	●	●	●	●
Recessed kitchen sink w/cover	●	●	●	●	●	●	●
6-cu.-ft. three-way refrigerator	●	●	●	●	●	●	●
Coffeemaker	●	●	●	●	●	●	●
Spacious pantry (n/a on some floorplans)	●	—	—	●	●	●	—

FEATURES AND SPECIFICATIONS

● = Standard ○ = Optional
 — = Not available or not applicable

FORD 158"			FORD 176"			MERCEDES	
220	221XL	232XL	261XL	271XL	272XL	240	241XL

SELF-SUPPORTING SYSTEMS

All-weather interior plumbing	●	●	●	●	●	●	●
Concealed 68-lb. propane tank	●	●	●	●	●	●	●
6-gallon electric/engine-assist water heater w/bypass valve	●	●	●	●	●	—	—
Propane on-demand water heater	—	—	—	—	—	●	●
Porcelain flush toilet	●	●	●	●	●	●	●
Demand fresh water system	●	●	●	●	●	●	●
City water connection	●	●	●	●	●	●	●
Universal utility compartment	●	●	●	●	●	●	●

ELECTRICAL

110v/12v 45-amp converter/charger	●	●	●	●	●	●	●
Ample 110v electrical outlets	●	●	●	●	●	●	●
4.0kw Onan Micro-quiet generator	●	●	●	●	●	—	—
3.6kw LPG Micro-quiet generator	—	—	—	—	—	●	●
Interior LED light package	●	●	●	●	●	●	●
Carbon monoxide, LP gas and smoke detectors	●	●	●	●	●	●	●
Emergency start switch	●	●	●	●	●	●	●
Auxiliary coach battery under hood (room for two)	—	—	—	—	—	●	●
Two auxiliary coach batteries on slideout tray (room for three)	●	●	●	●	●	—	—
Additional auxiliary coach battery	○	○	○	○	○	○	○
Auxiliary battery disconnect	●	●	●	●	●	●	●
30-foot shore power cord	●	●	●	●	●	●	●
Exterior 110v outlet	●	●	●	●	●	●	●
Porch, compartment and entry lights	●	●	●	●	●	●	●
Navigation system (Mercedes) or Sync system (Ford)	○	○	○	○	○	○	○
Power inverter (800-watt)	●	●	●	●	●	●	●
Power inverter (1,800-watt)	○	○	○	○	○	○	○
Automatic satellite dish (stationary, no receiver)	○	○	○	○	○	○	○
In-motion satellite dish (no receiver)	○	○	○	○	○	○	○
Color back-up video camera and monitor	○	○	○	○	○	○	○
Solar battery charger	○	○	○	○	○	○	○

DIMENSIONS

Wheelbase	158"	158"	158"	176"	176"	176"	170"	170"
Overall length	23' 2"	23' 2"	23' 2"	26' 10"	26' 10"	26' 10"	25' 9"	25' 9"
Overall width	8' 0"	8' 0"	8' 0"	8' 0"	8' 0"	8' 0"	8' 0"	8' 0"
Overall width with slideout(s) extended	—	10' 4"	11' 8"	10' 4" / 10' 9"	10' 4"	12' 5"	—	10' 0"
Overall height including A/C	10' 5"	10' 5"	10' 5"	10' 5"	10' 5"	10' 5"	10' 8"	10' 8"
Interior headroom	6' 3"	6' 3"	6' 3"	6' 3"	6' 3"	6' 3"	6' 4"	6' 4"
GVWR (max. weight of loaded vehicle) (.lbs)	14,500	14,500	14,500	14,500	14,500	14,500	11,030	11,030
GCWR (max. weight of loaded vehicle plus tow) (.lbs)	22,000	22,000	22,000	22,000	22,000	22,000	15,250	15,250
Rear axle ratio	4.56:1	4.56:1	4.56:1	4.56:1	4.56:1	4.56:1	4.18:1	4.18:1
Interior storage (cubic feet; varies by floor plan)	47.7	42.3	27.9	83.6	44.2	61.8	52.0	52.0
Exterior storage (cubic feet; varies by floor plan)	9.7	13.3	13.3	15.0	13.7	15.0	22.7	22.7

TANK CAPACITIES

Fuel tank (gallons)	55	55	55	55	55	55	26.4	26.4
Fresh water tank (gallons)	28	28	28	32	38	38	25	25
Grey water tank (gallons)	30	30	28	30	25	25	28	28
Black water tank (gallons)	25	25	25	25	20	20	25	25
Propane tank (pounds/gallons)	68/15	68/15	68/15	68/15	68/15	68/15	68/15	68/15

FORD CHASSIS FEATURES

Ford E-450 Super Duty Chassis (158-in. wheelbase for 220, 221XL and 232XL; 176-inch wheelbase for 261XL, 271XL and 272XL) with 6.8-liter Triton V-10 engine; automatic 5-speed TorqShift transmission with tow/haul mode; power steering; power windows; power door locks; keyless remote entry; power side mirrors; 55-gallon fuel tank; 4-wheel anti lock disc brakes; spare tire and rim; air conditioning; cruise control; AM/FM/CD stereo; tilt steering wheel; intermittent wipers; front chrome bumper and grill; aero halogen headlamps; light and convenience group; driver and passenger airbags. MOR/ryde rear suspension kit.

MERCEDES CHASSIS FEATURES

Mercedes-Benz Sprinter 3500 Chassis (170-in. wheelbase), 3.0L V6 diesel with adaptive ESP, 188HP and 325 foot-pounds of torque. Electronically controlled 5-speed transmission; 180-amp alternator; four-wheel ABS disc brakes; power-assisted rack-and-pinion steering; in-dash AM/FM/CD player; keyless entry; power windows; power door locks; 26.4-gallon fuel tank; driver/passenger airbag supplemental restraint system; air conditioning; cruise control; tilt steering wheel; intermittent wipers; front chrome grill; halogen head lamps; auxiliary transmission oil cooler. Hellwig rear suspension kit.

© 2013 Coach House Inc. Patent No. D449,797. Photos may show optional features available only at extra cost. Due to continual product improvement, features, options and specifications may change at any time without notice.

COACH HOUSE PRODUCT LINEUP

FORD E-450 CHASSIS (158-INCH WHEELBASE)



FORD E-450 CHASSIS (176-INCH WHEELBASE)

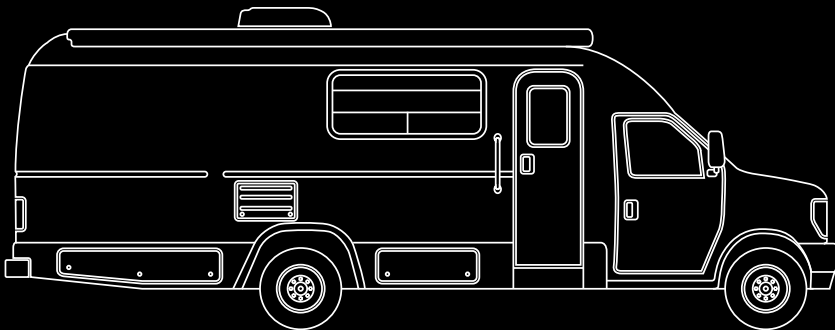

MERCEDES 3500 CHASSIS (170-INCH WHEELBASE)



PLATINUM MODELS

FORD 158-INCH CHASSIS

- 220 TB Twin Beds
- 221XL SD Side Dinette with Slideout
- 232XL FD Front Dinette with Dual Slideouts
- 232XL FS Front Sofa with Dual Slideouts

FORD 176-INCH CHASSIS (ALL HAVE SLIDEOUTS)

- 261XL DT Side Dinette / Twin Beds
- 261XL ST Power Sofa / Twin Beds
- 261XL QD Queen Dinette
- 271XL FS Power Sofa / Twin Beds
- 271XL FD Dinette / Twin Beds
- 272XL FS Power Sofa / Rear Queen Bed
- 272XL FD Dinette / Rear Queen Bed

PLATINUM II MODELS

MERCEDES 3500 SPRINTER CHASSIS (XL = WITH SLIDEOUT)

- 240 DRT (241XL DRT) Dinette / Rear Twin Beds
- 240 SRT (241XL SRT) Power Sofa / Rear Twin Beds
- 240 DQ (241XL DQ) Dinette / Queen Bed
- 240 SQ (241XL SQ) Power Sofa / Queen Bed
- 240 FD (241XL FD) Dinette / Rear Double Bed
- 240 FS (241XL FS) Power Sofa / Rear Double Bed
- 240 DS (241XL DS) Dinette / Rear Power Sofa
- 240 SS (241XL SS) Power Sofa / Rear Power Sofa
- 240 DT (241XL DT) Dinette / Twin Beds
- 240 ST (241XL ST) Power Sofa / Twin Beds

Buy Direct

THE COACH HOUSE BUYING EXPERIENCE

Coach House® Platinum® motorhomes are sold only at our factory in Venice, Florida, south of Tampa (see map). We offer numerous buyer incentives, including a "Buy-n-Fly" program, personal factory tours,



generous trade-in allowances, on-the-spot financing for qualified buyers, and detailed instruction how to operate and care for your R.V. No middle-men, no pressure, no gimmicks — it's a great way to buy a motorhome. Call today to find out more.



3480 TECHNOLOGY DRIVE · NOKOMIS, FL 34275
(941) 485-0984 · TOLL-FREE 1-800-235-0984
coachhouserv.com · info@coachhouserv.com
facebook.com/coachhouserv

