

*Shasta*  
Since 1961

PHOENIX

Shasta - Phoenix Fifth Wheel



Advanced Profile Design



Nothing Else Even Comes Close





## Features & Benefits

- More Living Space, a Bigger Bathroom and Bigger Slide Rooms
- 16" On Center Aluminum Superstructure with Added Insulation
- Smooth Comfortable Ride Provided with a Trailair Pin Box
- Luxurious Furniture Like You'd Have at Home
- Barrel Ceilings that Dramatically Increase Headroom Throughout
- Full LED Lighting Both Interior and Exterior





Your Private Suite Is Ready





35BL Bunk Loft - 50" Wide x 28" High x 84" Long



PHOENIX LUXURY



Experience luxuries you'd expect at a much higher price. Like surprising extra head room and expansiveness in the bedroom, with an opulent comforter and two pillow shams. Built-in drawers under the bed. An area that's ready for a washer and dryer. And in the gorgeous bathroom, generous storage for all your towels and toiletries – and housing the largest vanity in its class. Oil rubbed bronze hardware and towel bars. A roomy Super Shower, a porcelain toilet, a glass vessel bowl sink, and solid surface countertops. The road can be tiring. This is your private suite for R&R.





# Construction And Exterior Features



Extruded Aluminum Ladder and LED Clearance Lights

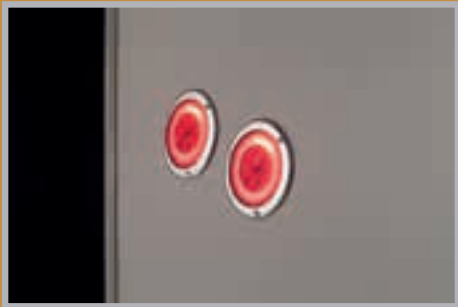

Recessed LED Taillights



Extruded Aluminum Bumper Cover

## 1. Aluminum Framework 16" On Center

Phoenix gets its strength from the frame of the wall, NOT the lamination!

## 2. Gusset Type Construction

Mechanically fastened "L" Brackets join the studs and are designed for strength and stability.

## 3. Flex Foil Insul-Wrap

Thin lightweight reflective material provides resistance against 3 types of heat flow: Conduction, Convection and Radiation, reflecting up to 95% of radiant energy! Flex Foil is wrapped on all sides of your Phoenix including the slide rooms!

## 4. Rolled Insulation

Residential style spun fiberglass insulation is used in between the frame and expanded to its fullest capacity. We double layer the insulation in both the floor and roof!

## 5. True Gel Coat Sidewall Exterior

"True" High Gloss Gel Coat exteriors are truly the best, of the best in fiberglass exteriors. Only "True" Gel Coat is the thickest and retains its color as it ages.





Rolled Edge Roof Line Prevents Pooling And Leaking.

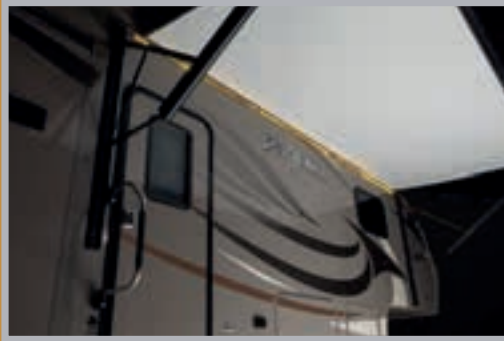

Power awning that features both white and amber colored LED lighting.



Automotive Rubber Sealed Windows



LED Hitch Light



Trail Air Pin Box Option



Easy Opening Slam Latch Baggage Doors



4 & 6 Point Auto Level Option

# Standards

## Construction

- 100" Wide Body
- Power Front Jacks
- 13.5 BTU AC
- Rack and Pinion Slide Mechanisms with Override
- Centrally Controlled Docking Station for EZ Hookups
- Battery Disconnect
- Black Tank Flush
- Fully Enclosed and Heated Underbelly, Cable Driven Gate Valves (in Docking Station)
- Aluminum Wheels
- Slam Latch Compartment Doors on Drivers Side
- 110-V Outside Receptacle
- 5-Sided Aluminum Cage Construction
- 16"-On-Center, Mechanically Fastened Superstructure
- 3/8" Roof Decking for a Full Walk-On Roof
- 5/8" Plywood Floor Decking
- Radius Cathedral Style Rafters
- Full Fiberglass Painted Front Cap
- Double-Layered, Staggered-Seam Luan Walls
- Color Infused, High-Gloss, Exterior Fiberglass Walls
- 10"-12" I-Beam Frame, Depending on Floor Plan
- Fully-Enclosed and Insulated Underbelly with Forced Air Heat
- Super Stance Axles for Stable Towing
- Gel Glass Exterior
- Oversized Windows for Maximum Light
- 30" Radius Entry Door with Friction Hinge
- Large Best-In-Class Pass-Through Storage Area

- Power Awning with 2-Way LED (White/Amber)
- 34,000-BTU Furnace
- LP Quick Disconnect
- 4" Rolled-Edge Roof with 3" Rain Gutters
- 10-Gal. Gas/Elec. DSI Atwood Water Heater with Quick Recovery
- (2) 30-LB. LP Bottles

## Living Room

- Oversized, Tinted Safety Glass Windows for Maximum Light
- Slow Rise Roller Shades with Wood Window Trim
- Recessed Lighting in Slide Room and Under Cabinets
- LED Feature Accent Lighting
- Residential Grade Carpeting in Slide Outs and Bedroom
- Designer Care Free Flooring
- La-Z-Boy Furniture for Supreme Comfort
- AM/FM/CD/DVD Player with Auxiliary Jack and Bluetooth Capability for Easy MP3 Connectivity
- Cable and Satellite Hookups

## Kitchen

- Microwave
- Large 23" Oven with Range Hood
- Oil Rubbed Bronze Hardware Throughout
- High Rise Faucet with Pull Out Sprayer
- Stonecast Deep Bowl Sink
- Upscale Hard Wood Glazed Doors with Raised Panels
- Full-Extension Ball Bearing Drawer Guides for Many Years of Trouble-Free Use
- Best-In-Class Pantry Space

## Bathroom

- Glass Vessel Bowl Sink with Oversized Counter Top
- Phoenix 30" X 48" Super Spa Shower in most Floor Plans
- Upscale, Heavy Glass Triple Slide Shower Door
- Porcelain Toilet
- Abundant Cabinet Storage Space for Towels and Toiletries

## Bedroom

- 60" X 80" Phoenix Pillowtop Mattress
- Luxurious Comforter
- (2) Overstuffed Pillows and Accent Pillow
- Washer/Dryer Prep on Bedroom Slide Models
- Dresser with Drawers
- Extra Under-Bed Storage Drawers
- Flush Floor Bedroom Deck and Barrelled Ceilings for Extreme Headroom in a Super Mid-Profile

## Wings of Flight Package (Mandatory)

- Flex Foil Wrap Extreme Weather Insulation
- Solid Surface Countertops (Kitchen Galley & Island)
- 8 Cu. Ft. Refrigerator
- Power Awning with 2 Way LED Light Strip
- Power Rear Jacks
- 16" Wheels and E-Load Tires
- 50 Amp Service
- Fireplace



# Options

## Exterior Upgrades

- Trail Air Pin Box
- RVQ Grill
- 4-Point Auto Level
- 6-Point Auto Level (35BH & 35BL Only)

## Interior Upgrades

- Theater Seating IPO 2 Recliners (Required on 35BH)
- LED Flat Screen TV
- Booth Dinette IPO Free-Standing Dinette
- Fantastic Fan in Front Bedroom
- 13.5 Cu. Ft. Refrigerator (Select Models)
- Fantastic Fan in Bunk Area (28BH & 35BH)
- Fantastic Fan in Main Bathroom
- Fantastic Fan in 2nd Bath

## Heating/Cooling/Electrical

- 15K BTU A/C IPO 13.5 BTU A/C
- 2nd 13.5K Low Profile In Bedroom

# Exterior Features



1. Our large outdoor kitchens feature solid surface countertops, hardwood doors and drawers and LED lighting.
2. Best in class pass through and front storage compartments are ready for all of your extra-large gear!
3. Super Stance Axles provide the stability you will feel while towing your Phoenix. Coupled with the Trailair Pin Box it is a second to none towing experience!
4. Large 30" Friction Hinge entry doors are another standard feature of your Phoenix! Extra-large grab handles make for an easy entry into your new Phoenix.

# Floorplans

28RL

OVERALL LENGTH: 32'  
DRY WEIGHT: 8,911 LBS.

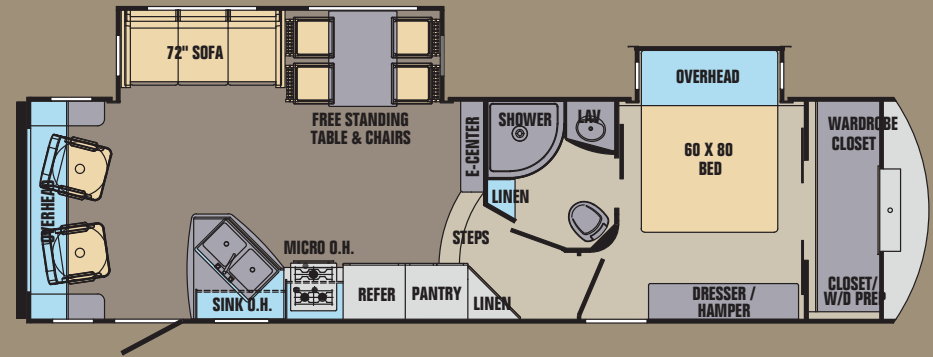

32RE

OVERALL LENGTH: 33' 11"  
DRY WEIGHT: 9,120 LBS.

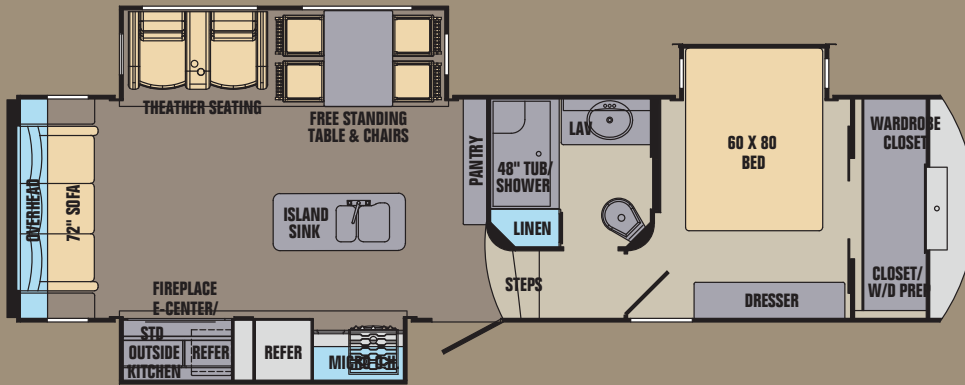

34RD

OVERALL LENGTH: 35' 11"  
DRY WEIGHT: 10,417 LBS.

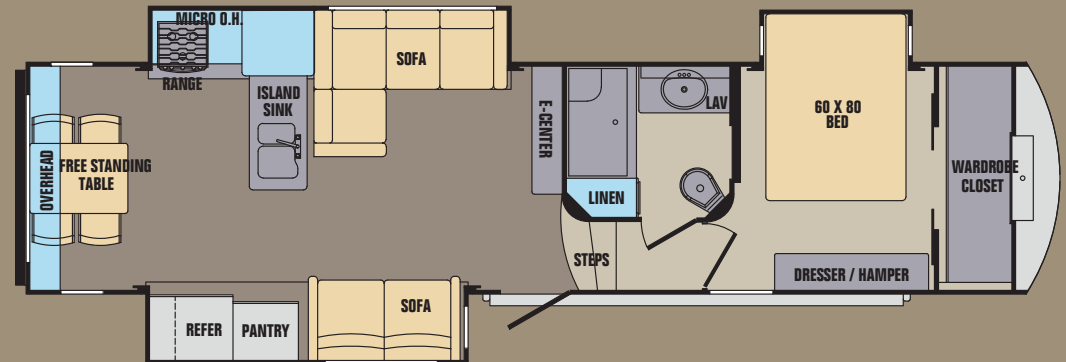

35BH

OVERALL LENGTH: 39' 10"  
DRY WEIGHT: 11,964 LBS.

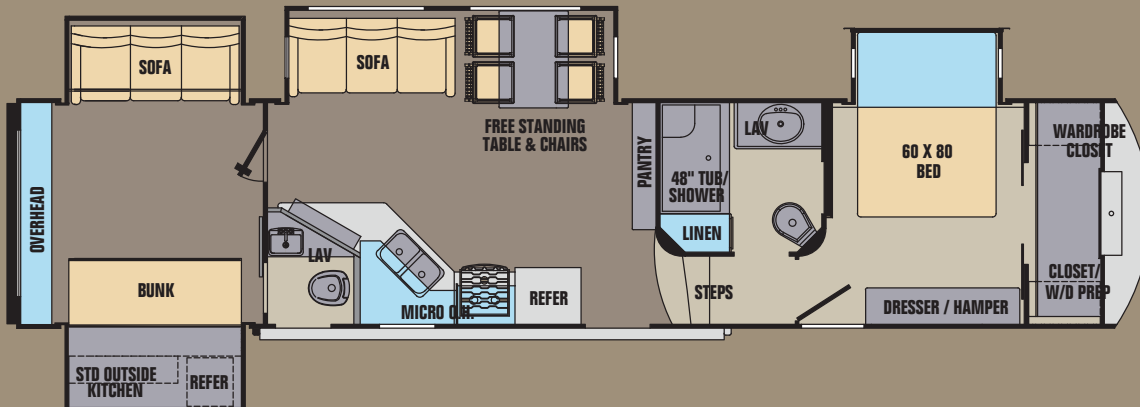



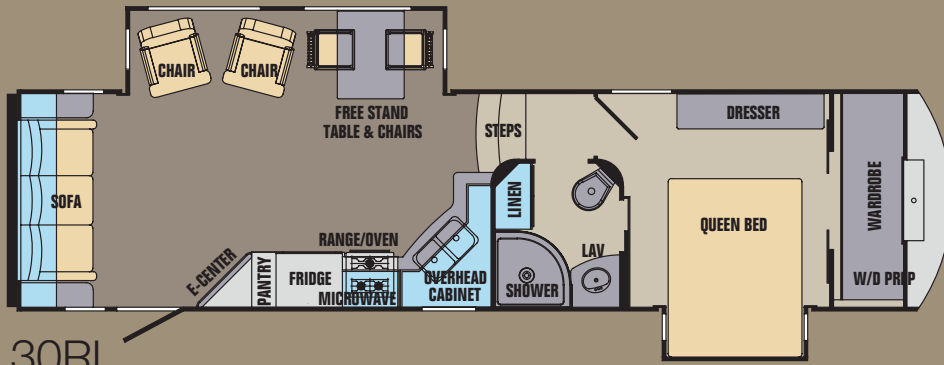

30RL

OVERALL LENGTH: 33' 11"  
DRY WEIGHT: 9,163 LBS.

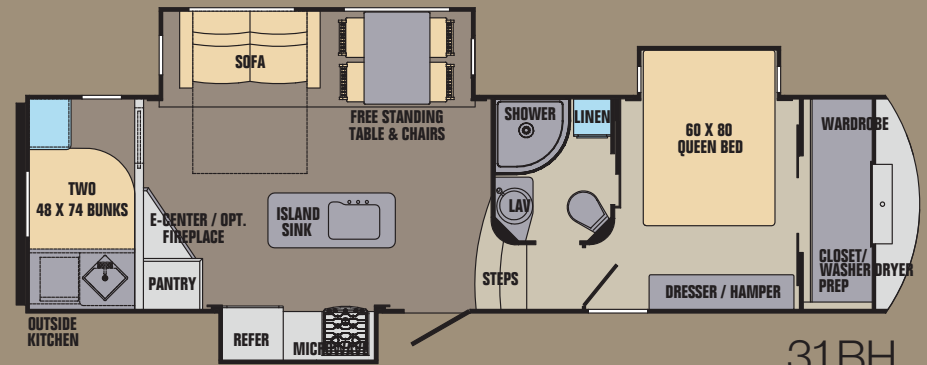

31BH

OVERALL LENGTH: 32' 11"  
DRY WEIGHT: 9,658 LBS.

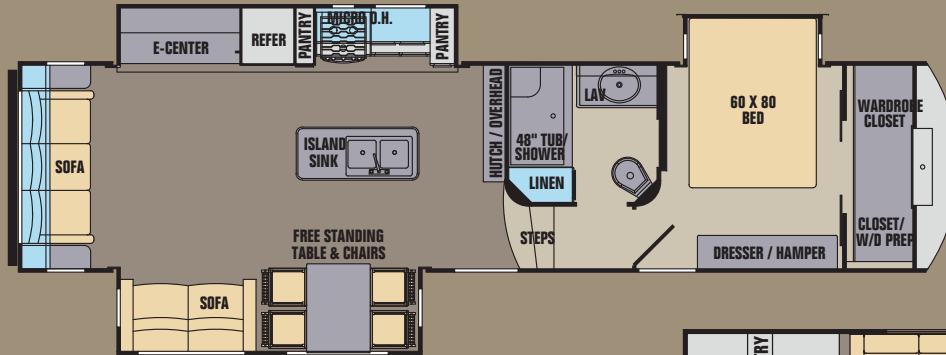

33CK

OVERALL LENGTH: 35' 11"  
DRY WEIGHT: 10,161 LBS.

34RK

OVERALL LENGTH: 34' 11"  
DRY WEIGHT: 10,930 LBS.

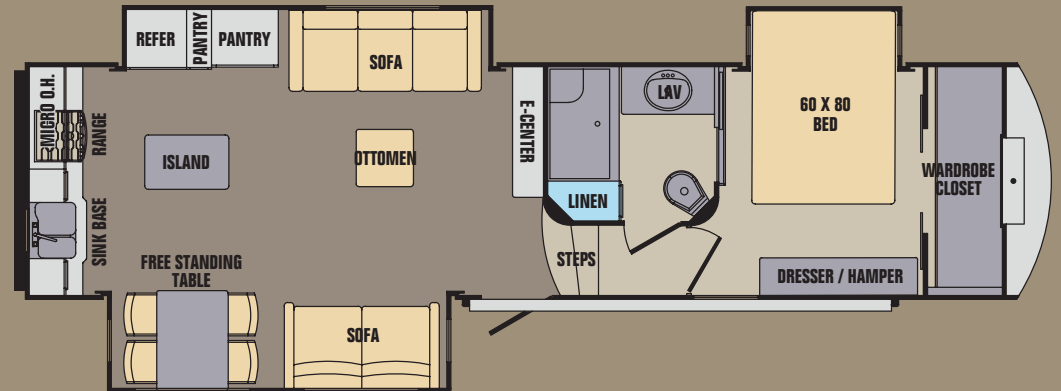

35BL

OVERALL LENGTH: 40'  
DRY WEIGHT: 12,196 LBS.

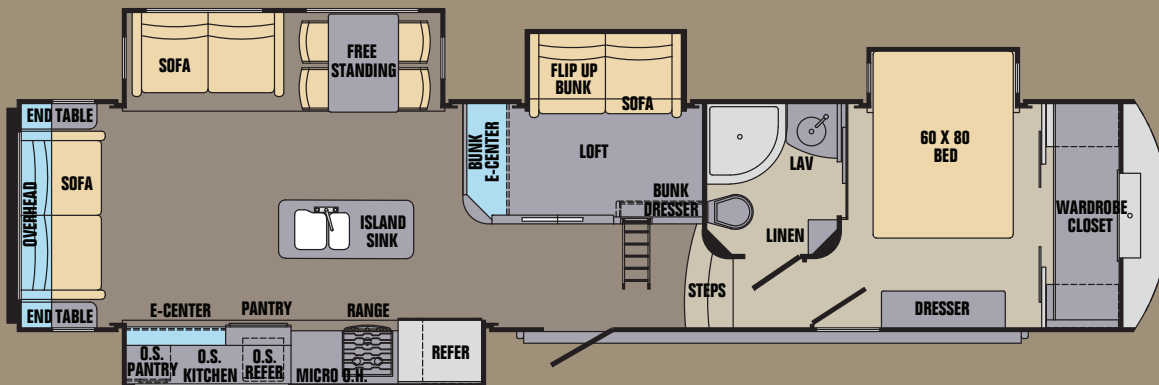

FLOOR PLAN	SPF 28RL	SPF 30RL	SPF 31BH	SPF 32RE	SPF 33CK	SPF 34RD	SPF 34RK	SPF 35BH	SPF 35BL
Hitch Weight (lbs.)	1,873	1,857	1,953	1,443	2,088	2,361	1,911	1,966	2,801
UVW	8,911	9,163	9,658	9,120	10,161	10,417	10,930	11,964	12,196
GVWR	12,214	12,198	12,294	11,784	14,029	14,302	13,911	13,907	14,742
CCC	3,303	3,035	2,636	2,664	3,868	3,885	2,981	1,943	2,546
Exterior Length	32'	33' 11"	32' 11"	33' 11"	35' 11"	35' 11"	34' 11"	39' 10"	40'
Width	100"	100"	100"	100"	100"	100"	100"	100"	100"
Exterior Height w/ A/C	12' 7"	12' 7"	12' 7"	12' 7"	12' 7"	12' 8"	12' 8"	12' 10"	12' 10"
Main Slide Room Height	6'	6'	6'	6'	6'	6'	6'	6'	6'
Fresh Water Tank Cap. (gal.)	50	50	50	50	50	50	50	50	50
Grey Water Tank Cap. (gal.)	45	90	45	90	90	90	90	90	90
Black Water Tank Cap. (gal.)	45	45	45	45	45	45	45	90	45
Awning	20'	19'	15'	15'	15'	15'	15'	18'	18'
Furnace (BTU's)	34K	34K	34K	34K	34K	34K	34K	34K	34K
Water Heater Capacity (gal.)	10	10	10	10	10	10	10	10	10
LP	60	60	60	60	60	60	60	60	60

**GVWR (Gross Vehicle Weight Rating)** - is the maximum permissible weight of the unit when fully loaded. It includes all weights, inclusive of all fluids, cargo, optional equipment and accessories. For safety and product performance do NOT exceed the GVWR.

**GAWR (Gross Axle Weight Rating)** - is the maximum permissible weight, including cargo, fluids, optional equipment and accessories that can be safely supported by a combination of all axles.

**UVW (Unloaded Vehicle Weight)\*** - is the typical weight of the unit as manufactured at the factory. It includes all weight at the unit's axle(s) and tongue or pin and LP Gas. The UVW does not include cargo, fresh potable water, additional optional equipment or dealer installed accessories. \*Estimated Average based on standard build optional equipment.

**CCC (Cargo Carrying Capacity)\*\*** - is the amount of weight available for fresh potable water, cargo, additional optional equipment and accessories. CCC is equal to GVWR minus UVW. Available CCC should accommodate fresh potable water (8.3 lbs per gallon). Before filling the fresh water tank, empty the black and gray tanks to provide for more cargo capacity. \*\* Estimated average based on standard build optional equipment

Each Forest River RV is weighed at the manufacturing facility prior to shipping. A label identifying the unloaded vehicle weight of the actual unit and the cargo carrying capacity is applied to every Forest River RV prior to leaving our facilities.

The load capacity of your unit is designated by weight, not by volume, so you cannot necessarily use all available space when loading your unit.

All information contained in this brochure is believed to be accurate at the time of publication. However, during the model year, it may be necessary to make revisions and Forest River, Inc., reserves the right to make all such changes without notice, including prices, colors, materials, equipment and specifications as well as the addition of new models and the discontinuance of models shown in this brochure. Therefore, please consult with your Forest River, Inc., dealer and confirm the existence of any materials, design or specifications that are material to your purchase decision.

©Copyright 2015 Shasta, a Division of Forest River Inc - All Rights Reserved.



Forest River, Inc. encourages our customers to purchase their Forest River products from a local dealership whenever possible for the following reasons:

- 1) Forest River, Inc. dealers are independently owned and operated businesses so priority service and scheduling is at their discretion and is often provided to customers that purchased their unit at that dealership.
- 2) Purchasing locally allows customers to establish meaningful relationships with a dealer, enhancing the RV experience through assistance with product questions, user tips or RV regulations for your state or country, and much more!
- 3) Canadian customers must meet requirements to bring an RV purchased out of the country to their home. These requirements may involve additional inspections and certifications, taxes and fees. Your local Canadian Dealer is a professional at meeting these requirements.
- 4) Scheduling timely warranty repairs and adjustments through a local dealership provides far greater flexibility and convenience to you, the customer!

It is the goal of Forest River, Inc. that all of our RV owners fully enjoy the RV experience and that customer satisfaction meets or exceeds their expectations!



#### PRE-DELIVERY INSPECTION FACILITY

20,000 square feet of quality assurance. The bare essentials for a premium product. This state-of-the-art facility gives immediate daily feedback to production for quality assurance in every unit built.



**Learn More**  
Scan this barcode using a QR Reader on your smart phone to learn more about Forest River.



A Berkshire Hathaway company.

Your Shasta Phoenix Dealer: