

# STELLAR

Towhauulers







Model 33SSG shown in Platinum Birch Wood Option

### Stellar Toyhaulers - The name says it well!

Stellar design, function and quality, built by Eclipse RV, whose experience proves a track record of credibility. Stellar Toyhaulers offers affordable floorplans, to luxury widebody floorplans, all with you in mind. Stellar offers exclusive features for unrivaled comfort and functionality. Enjoy your adventure with the Stellar Trailer and Fifth Wheel built with you in mind.



Model 28DBG



Model 27DBLG

# STELLAR Metal

## Optional Upgrades

	18CB	19SB	21FS	23SB	23FiB	24FB	25FB	27FS
100 Gal Fresh Water	NA	✓	STD	✓	STD	STD	STD	STD
A/C Living Room - 13.5K BTU	✓	✓	STD	✓	STD	STD	STD	STD
A/C Living Room - 15K BTU	✓	✓	NA	✓	NA	NA	NA	NA
A/C 15K BTU IPO 13.5K	NA	NA	✓	NA	✓	✓	✓	✓
A/C Ducting	NA	NA	✓	NA	✓	✓	STD	STD
Add A Wall	✓	✓	✓	✓	✓	✓	✓	✓
Aluminum Wheels - 15"	✓	✓	✓	✓	✓	✓	✓	✓
Aluminum Wheels - 15" Deluxe	NA	NA	✓	✓	✓	✓	✓	✓
Black Tank Flush	✓	✓	✓	✓	✓	✓	✓	✓
Bunk Ladder	✓	✓	✓	✓	✓	✓	✓	✓
Carpet Kit	✓	✓	✓	✓	✓	✓	✓	✓
Chair - One Extra	NA	✓	✓	NA	✓	NA	NA	NA
Chairs - 2 IPO Sofa w/ Bay Wdw	✓	NA	NA	✓	NA	✓	✓	✓
Chairs - 2 IPO Sofa	NA	✓	✓	NA	✓	NA	NA	NA
CSA Canada	✓	✓	✓	✓	✓	✓	✓	✓
Dinette IPO Sofa w/ Bay Wdw	✓	NA	NA	✓	NA	✓	✓	✓
Dinette IPO Sofa	NA	✓	✓	NA	✓	NA	NA	NA
Drive-on Metal Wheel Well	✓	✓	✓	✓	✓	✓	✓	✓
DVD Player	✓	✓	✓	✓	✓	STD	✓	✓
Electric Awning w/ Light	✓	✓	✓	✓	✓	✓	✓	✓
Electric Bed (One)	NA	✓	✓	NA	✓	NA	NA	NA
Electric Bed / Dinette	✓	NA	NA	✓	NA	✓	✓	✓
Exterior TV Bracket & Hookups	✓	✓	✓	✓	✓	✓	✓	✓
Front Power Jack	✓	✓	✓	✓	✓	✓	✓	✓
Front & Rear Fiberglass	✓	✓	✓	✓	✓	✓	✓	✓
Fuel Station - 36 Gal	✓	✓	✓	✓	✓	STD	✓	✓
Generator - 4.0 ONAN w/ Transfer Switch	✓	✓	✓	✓	✓	STD	✓	✓
Generator - Portable	NA	✓	NA	✓	NA	NA	NA	NA
Heated Enclosed Tanks	✓	✓	✓	✓	✓	✓	✓	✓
LED Lights - Interior	✓	✓	✓	✓	✓	✓	✓	✓
LED Light Bar	✓	✓	✓	✓	✓	✓	✓	✓
LP Tanks - Dual 30 LBS	✓	✓	✓	✓	✓	✓	✓	✓
Medicine Cabinet - Wood/Mirror	NA	✓	NA	✓	NA	✓	NA	✓
Medicine Cabinet - Plastic/Mirror	✓	NA	✓	NA	✓	NA	NA	✓
Pleated Shades	✓	✓	✓	✓	✓	✓	✓	✓
Porcelain Toilet	✓	✓	✓	✓	✓	✓	✓	✓
Ramp Door Patio Fence	✓	✓	✓	✓	✓	✓	✓	✓
Roadside LED Flood Lights (2)	✓	✓	✓	✓	✓	✓	✓	✓
Skylight Over Tub	NA	NA	✓	NA	✓	✓	✓	✓
Slide-Out Living Room (Doorside)	NA	NA	NA	NA	NA	NA	NA	✓
Solar Panel - 10 Watt	✓	✓	✓	✓	✓	✓	✓	✓
Solar Panel - 160 Watt	✓	✓	✓	✓	✓	✓	✓	✓
Spare Tire & Carrier	✓	✓	✓	✓	✓	✓	✓	✓
Stabilizer Jacks - Front	✓	✓	✓	✓	✓	✓	✓	✓
Stell-A-Lounge	✓	NA	NA	✓	NA	✓	✓	✓
Thermo Pane Windows	✓	✓	✓	✓	✓	✓	✓	✓
Tie-Downs - 2 Extra	✓	✓	✓	✓	✓	✓	✓	✓
TV Antenna	✓	✓	✓	✓	✓	STD	✓	✓
TV Bedroom	NA	✓	✓	✓	✓	✓	✓	✓
TV Living Room	✓	✓	✓	✓	✓	STD	✓	✓
TV Living Room, X-Large	✓	✓	✓	✓	✓	✓	✓	✓
USB Charger	✓	✓	✓	✓	✓	✓	✓	✓
Walk on Roof w/ Folding Ladder	✓	✓	✓	✓	✓	✓	✓	✓
Winterize	✓	✓	✓	✓	✓	✓	✓	✓

## Standard Features

- 102" Body Design
- 15" Chrome Wheels
- Awning
- Cabinets Screwed Together
- Double Radius Entry Door Step
- Deluxe Futon on Electric Bed (Where Applicable)
- Electric Beds (2) (18CB, 23SB, 24FB, 25FB, 27FS)
- Exterior Shower
- Floors - 2" Framed
- Fold Up Sofa's w/ Skirting - Steel (2)
- Insulation: R-7
- LED Flood Lights: Door Side (2), Rear (2)
- LED Running Lights
- Lights: Porch & Hitch
- LP Tanks - (2) 20 LBS (18CB, 19SB - 1 TANK)
- Mini Blinds
- Oven / Microwave / Range Hood
- Pillow Top Mattress w/ Bedspread (N/A on 18CB)
- Powder Coated Chassis
- Pull Out Faucet (N/A on 18CB, 19SB)
- Radius Entry Door
- Ramp Door - 7", Vacuum Bonded
- Refrigerator - Large, Double Door
- Rubber Roof - Seamless, 1-Piece
- Self-Adjusting Brakes
- Stabilizer Jacks - Rear (2)
- Stainless Steel Galley Sink
- Stereo AM/FM CD w/ Outside Speakers
- Tie Downs
- Tinted Windows, X-Large
- Water Heater - Gas DSI, 6 Gal

## Available Floorplans

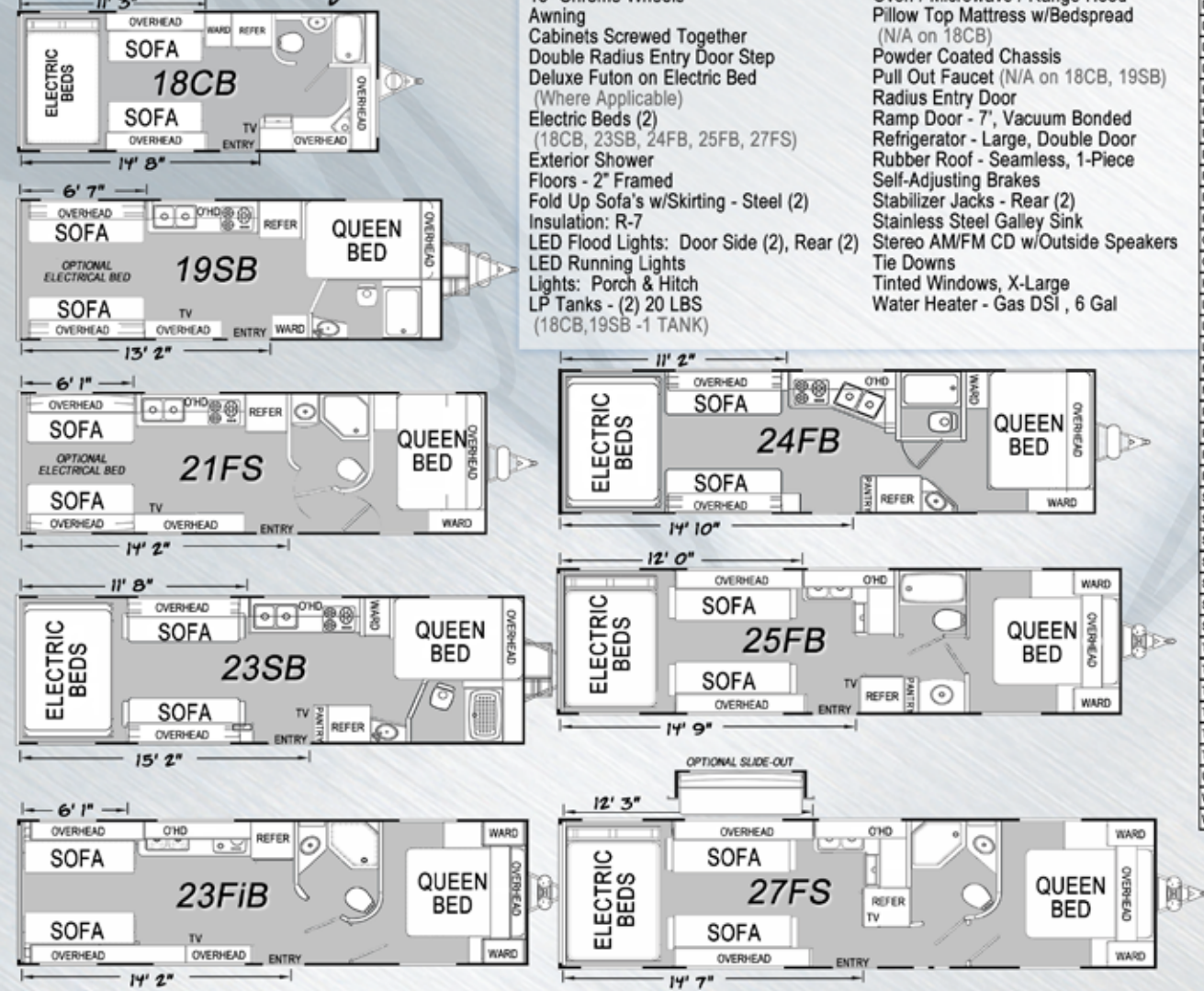

# STELLAR

The Leader in Toyhaulers

### Interior Fabric Options



### Interior Wood Options:





Optional Upgrades

	18CBG	19SBG	21FSG	23SCG	23FIBG	24FBG	25FBG	27FSG
100 Gal Fresh Water	NA	✓	STD	✓	STD	STD	STD	STD
A/C Living Room - 13.5K BTU	✓	✓	STD	✓	STD	STD	STD	STD
A/C Living Room - 15K BTU	✓	✓	NA	✓	NA	NA	NA	NA
A/C 15K BTU IPO 13.5K	NA	NA	✓	NA	✓	✓	✓	✓
A/C Ducting	NA	NA	✓	NA	✓	✓	STD	STD
Add A Wall	✓	✓	✓	✓	✓	✓	✓	✓
Aluminum Wheels - 15"	✓	✓	✓	✓	✓	✓	✓	✓
Aluminum Wheels - 15" Deluxe	NA	NA	✓	✓	✓	✓	✓	✓
Black Tank Flush	✓	✓	✓	✓	✓	✓	✓	✓
Bunk Ladder	✓	✓	✓	✓	✓	✓	✓	✓
Carpet Kit	✓	✓	✓	✓	✓	✓	✓	✓
Chair - One Extra	NA	✓	✓	NA	✓	NA	NA	NA
Chairs - 2 IPO Sofa w/Bay Wdw	✓	NA	NA	✓	NA	✓	✓	✓
Chairs - 2 IPO Sofa	NA	✓	✓	NA	✓	NA	NA	NA
CSA Canada	✓	✓	✓	✓	✓	✓	✓	✓
Deluxe Fender Skirts	✓	✓	✓	✓	✓	✓	✓	✓
Dinette IPO Sofa w/Bay Wdw	✓	NA	NA	✓	NA	✓	NA	NA
Dinette IPO Sofa	NA	✓	✓	NA	✓	NA	NA	NA
Drive-on Metal Wheel Well	✓	✓	✓	✓	✓	✓	✓	✓
DVD Player	✓	✓	✓	✓	✓	STD	✓	✓
Electric Awning w/Light	✓	✓	✓	✓	✓	✓	✓	✓
Electric Bed (One)	NA	✓	✓	NA	✓	NA	NA	NA
Electric Bed / Dinette	✓	NA	NA	✓	NA	✓	✓	✓
Exterior TV Bracket & Hookups	✓	✓	✓	✓	✓	✓	✓	✓
Front Power Jack	✓	✓	✓	✓	✓	✓	✓	✓
Fuel Station - 36 Gal	✓	✓	✓	✓	✓	STD	✓	✓
Generator - 4.0 ONAN w/Transfer Switch	✓	✓	✓	✓	✓	STD	✓	✓
Generator - Portable	NA	✓	NA	✓	NA	NA	NA	NA
Gray Exterior	✓	✓	✓	✓	✓	✓	✓	✓
Heated Enclosed Tanks	✓	✓	✓	✓	✓	✓	✓	✓
LED Lights - Interior	✓	✓	✓	✓	✓	✓	✓	✓
LED Light Bar	✓	✓	✓	✓	✓	✓	✓	✓
LP Tanks - Dual 30 LBS	✓	✓	✓	✓	✓	✓	✓	✓
Medicine Cabinet - Wood/Mirror	NA	✓	NA	✓	NA	✓	NA	NA
Medicine Cabinet - Plastic/Mirror	✓	NA	NA	✓	NA	NA	NA	NA
Pleated Shades	✓	✓	✓	✓	✓	✓	✓	✓
Ramp Door Patio Fence	✓	✓	✓	✓	✓	✓	✓	✓
Roadside LED Flood Lights (2)	✓	✓	✓	✓	✓	✓	✓	✓
Skylight Over Tub	NA	NA	✓	NA	✓	✓	✓	✓
Slide-Out Living Room (Doorside)	NA	NA	NA	NA	NA	NA	NA	✓
Solar Panel - 10 Watt	✓	✓	✓	✓	✓	✓	✓	✓
Solar Panel - 160 Watt	✓	✓	✓	✓	✓	✓	✓	✓
Spare Tire & Carrier	✓	✓	✓	✓	✓	✓	✓	✓
Stabilizer Jacks - Front	✓	✓	✓	✓	✓	✓	✓	✓
Stell-A-Lounge	✓	NA	NA	✓	NA	✓	✓	✓
Thermo Pane Windows	✓	✓	✓	✓	✓	✓	✓	✓
Tie-Downs - 2 Extra	✓	✓	✓	✓	✓	✓	✓	✓
TV Antenna	✓	✓	✓	✓	✓	STD	✓	✓
TV Bedroom	NA	✓	✓	✓	✓	✓	✓	✓
TV Living Room	✓	✓	✓	✓	✓	✓	✓	✓
TV Living Room - X-Large	✓	✓	✓	✓	✓	✓	✓	✓
USB Charger	✓	✓	✓	✓	✓	✓	✓	✓
Walk on Roof w/Folding Ladder	✓	✓	✓	✓	✓	✓	✓	✓
Winterize	✓	✓	✓	✓	✓	✓	✓	✓

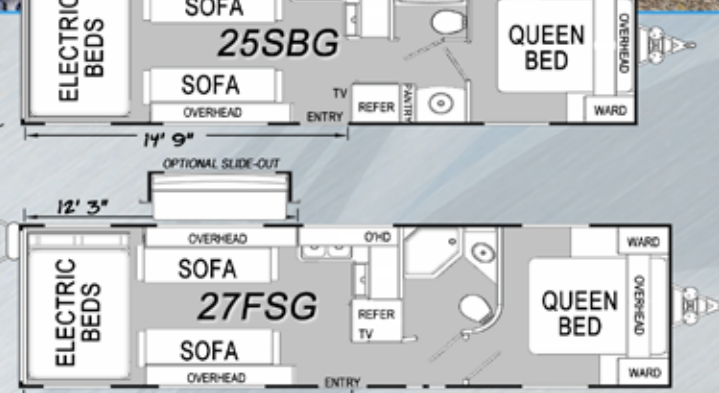
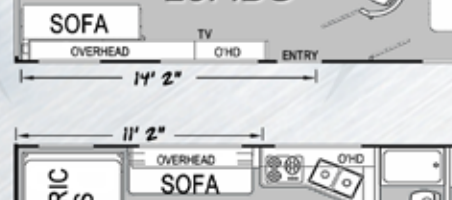
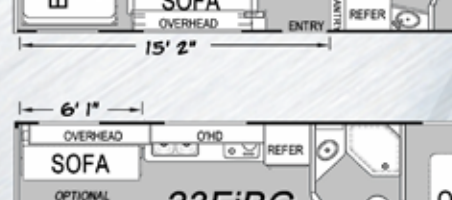
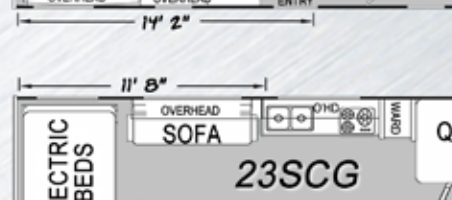
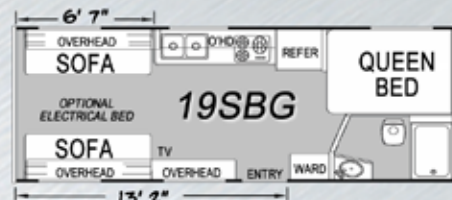
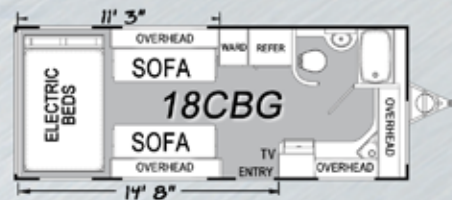

Standard Features

- 102" Body Design
- 15" Chrome Wheels
- Awning
- Cabinets Screwed Together
- Deluxe Futon on Electric Bed (Where Applicable)
- Double Radius Entry Door Step
- Electric Beds (2) (18CBG, 23SCG, 24FBG, 25FBG, 27FSG)
- Exterior Shower
- Fiberglass-Laminated, Aluminum-Framed Walls
- Floors - Aluminum Framed, Vacuum Bonded
- Fold Up Sofa's w/Skirting - Steel (2)
- Insulation: R-22 / R-11 EPS Foam
- LED Flood Lights: Door Side (2), Rear (2)
- LED Running Lights
- Lights: Porch & Hitch
- LP Tanks - (2) 20 LBS (18CBG, 19SBG - 1 Tank)
- Mini Blinds
- Oven / Microwave / Range Hood
- Pillow Top Mattress w/Bedsread (N/A on 18CBG)
- Powder Coated Chassis
- Pull Out Faucet (N/A on 18CBG, 19SBG)
- Radius Entry Door
- Ramp Door - 7', Vacuum Bonded
- Refrigerator - Large, Double Door
- Rubber Roof - Seamless, 1-Piece
- Self-Adjusting Brakes
- Stabilizer Jacks - Rear (2)
- Stainless Steel Galley Sink
- Stereo AM/FM CD w/Outside Speakers
- Tie Downs
- Tinted Windows, X-Large
- Water Heater - Gas DSI, 6 Gal

Available Floorplans

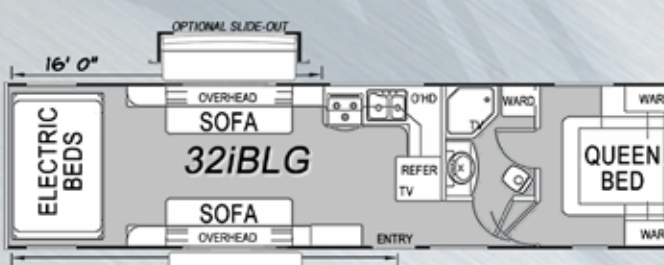
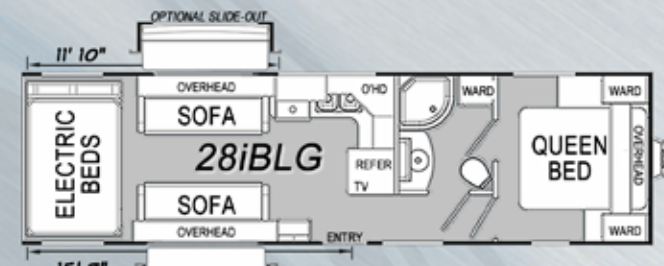
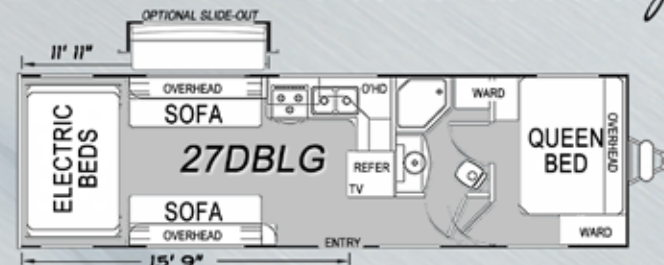

Standard Features

- 102" Wide Body Design
- 15" Aluminum Wheels
- 6,000 LB Axles w/Grease Zerk Fittings
- A/C 13.5K BTU Awning
- Carpet Kit
- Deluxe Aluminum Fender Skirts
- Double Radius Entry Door Step
- Fiberglass-Laminated, Aluminum-Framed Walls
- Floors - Aluminum Framed, Vacuum Bonded
- Folding Entry Door Assist Handle
- Fold-Up Sofa's w/Skirting (2)
- Full Weld Z Outriggers
- Insulation: R-22 / R-11 EPS Foam
- Key Hook / Cork Board
- LED Flood Lights: Door Side (2), Rear (2)
- LED Interior Lights
- LED Light Bar
- LED Running Lights
- Lights: Step / Hitch
- LP Tanks - Dual 30 LBS
- Microwave w/Range Hood, Oven
- Pillow Top Mattress w/Bedsread, Shams
- Pleated Shades
- Powder Coated Chassis
- Pressure Washer
- Radius Entry Door
- Ramp Door - 7', Vacuum Bonded
- Refrigerator - Large, Double Door
- Rubber Roof - Seamless, 1-Piece
- Self-Adjusting Brakes
- Stabilizer Jacks - High Clearance (4)
- Stainless Steel Galley Sink w/Pull-Out Faucet
- Stereo AM/FM CD/DVD w/Outside Speakers
- Tie Downs
- Tinted Windows, X-Large
- TV Antenna w/Cable Hook-Up
- TV Living Room
- USB Charger
- Water Heater - Gas DSI, 6 Gal
- Water Purification System

Optional Upgrades

	27DBLG	28iBLG	32iBLG	32KSG
150 Gal Fresh Water	✓	✓	✓	✓
50 Amp Service	NA	✓	✓	✓
A/C 15K BTU IPO 13.5K *	✓	✓	✓	✓
A/C Bedroom - 13.5K BTU	NA	✓	✓	✓
Add A Wall *	✓	✓	✓	✓
Aluminum Wheels - 15" Deluxe *	✓	✓	✓	✓
Aluminum Wheels - 16" Deluxe	✓	✓	✓	NA
Black Tank Flush *	✓	✓	✓	✓
Carpet Kit - Upgraded	✓	✓	✓	✓
Ceiling Fan	✓	✓	✓	✓
Chairs - 2 IPO Sofa w/Bay Wdw	✓	✓	✓	✓
Chairs - Two Extra	NA	NA	✓	NA
CSA Canada	✓	✓	✓	✓
Dinette IPO Sofa w/Bay Wdw	✓	✓	✓	NA
Drive-on Metal Wheel Well	✓	✓	✓	NA
Electric Awning w/Light *	✓	✓	✓	✓
Electric Bed / Dinette	✓	✓	✓	✓
Electric Beds (2) w/Bunk Ladder	✓	✓	✓	✓
Exterior TV Bracket & Hookups	✓	✓	✓	✓
Frameless Windows	✓	✓	✓	✓
Front Power Jack *	✓	✓	✓	✓
Fuel Station - 36 Gal *	✓	✓	✓	✓
Fuel Station - 51 Gal Split	✓	✓	✓	✓
Generator - 4.0 ONAN w/Transfer Switch *	✓	✓	✓	✓
Generator - 5.5 ONAN w/Transfer Switch	NA	✓	✓	✓
Gray Exterior	✓	✓	✓	✓
Heated Enclosed Tanks	✓	✓	✓	✓
Kicker Stereo System w/Touchscreen *	✓	✓	✓	✓
Ramp Door Patio Fence	✓	✓	✓	✓
Rear Table & Legs	NA	NA	✓	✓
Refrigerator - X-Large	✓	✓	✓	✓
Roadside LED Flood Lights (2)	✓	✓	✓	✓
Skylight Over Shower	✓	✓	✓	✓
Slide-Out Living Room (Doorside)	NA	✓	✓	✓
Slide-Out Living Room (Roadside)	✓	✓	✓	STD
Solar Panel - 10 Watt	✓	✓	✓	✓
Solar Panel - 160 Watt	✓	✓	✓	✓
Solid Surface Galley Top w/Covers *	✓	✓	✓	✓
Spare Tire & Carrier *	✓	✓	✓	✓
Stell-A-Lounge *	✓	✓	✓	✓
Thermo Pane Windows	✓	✓	✓	✓
Tie-Downs - 2 Extra	✓	✓	✓	NA
TV Bedroom *	✓	✓	✓	✓
TV Living Room - X-Large *	✓	✓	✓	✓
TV Living Room - 2X-Large	✓	✓	✓	✓
TV Living Room - 3X-Large	NA	NA	NA	✓
Walk on Roof w/Folding Ladder	✓	✓	✓	✓
Water Heater - Gas DSI / Electric, 10 Gal	✓	✓	✓	✓
Winterize	✓	✓	✓	✓
<b>Abyss Package</b>	Included Items Denoted with *			
<b>Stellar Premier Package *</b>	Custom LP Tank Cover, Deluxe Aluminum Rims, Electric Tongue Jack, Front/Rear Fiberglass Caps			
<b>Gold Package</b>	Glass Lazy Bowl w/Deluxe Faucet, Solid Surface Lazy Top (Must include Solid Surface Galley Opt) - Black or Brown Countertops Available			

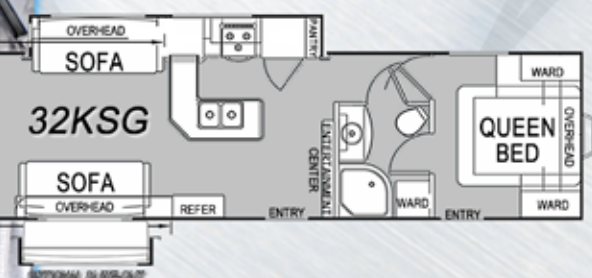





Optional Upgrades

	28DBG	32DBG
150 Gallon Fresh Water	✓	✓
50 Amp Service	✓	✓
7,000 lbs. Axles IPO Std	✓	✓
A/C 15K BTU IPO 13.5K	✓	✓
A/C Bedroom - 13.5K BTU	✓	✓
Add A Wall	✓	✓
Black Tank Flush	✓	✓
Ceiling Fan	✓	✓
Central Vacuum System	✓	✓
Chairs - 2 IPO Sofa w/Bay Wdw	✓	✓
CSA Canada	✓	✓
Dinette IPO Sofa w/Bay Wdw	✓	✓
Drive-on Metal Wheel Well	✓	✓
Electric Awning w/Light	✓	✓
Electric Bed / Dinette	✓	✓
Electric Beds (2) w/Bunk Ladder	✓	✓
Exterior TV Bracket & Hookups	✓	✓
Fuel Station - 36 Gal	✓	✓
Fuel Station - 51 Gal Split	✓	✓
Frameless Windows	✓	✓
Generator - 4.0 ONAN w/Transfer Switch	✓	✓
Generator - 5.5 ONAN w/Transfer Switch	✓	✓
Gray Exterior	✓	✓
Heated Enclosed Tanks	✓	✓
Kicker Stereo System w/Touchscreen	✓	✓
Ramp Door Patio Fence	✓	✓
Rear Fiberglass Cap	✓	✓
Rear Table & Legs	NA	✓
Refrigerator - X-Large	✓	✓
Roadside LED Flood Lights (2)	✓	✓
Skylight over Shower	✓	✓
Slide-Out Living Room (Roadside)	✓	✓
Slide-Out Wardrobe	✓	✓
Solar Panel - 10 Watt	✓	✓
Solar Panel - 160 Watt	✓	✓
Solid Surface Galley Top w/Covers	✓	✓
Spare Tire & Carrier	✓	✓
Stell-A-Lounge	✓	✓
Thermo Pane Windows	✓	✓
Tie-Downs - 2 Extra	✓	✓
TV Bedroom	✓	✓
TV Living Room - X-Large	✓	✓
Walk on Roof w/Folding Ladder	✓	✓
Water Heater - Gas DSI / Electric, 6 Gal	✓	✓
Water Heater - Gas DSI, 10 Gal	✓	✓
Winterize	✓	✓

Available Floorplans

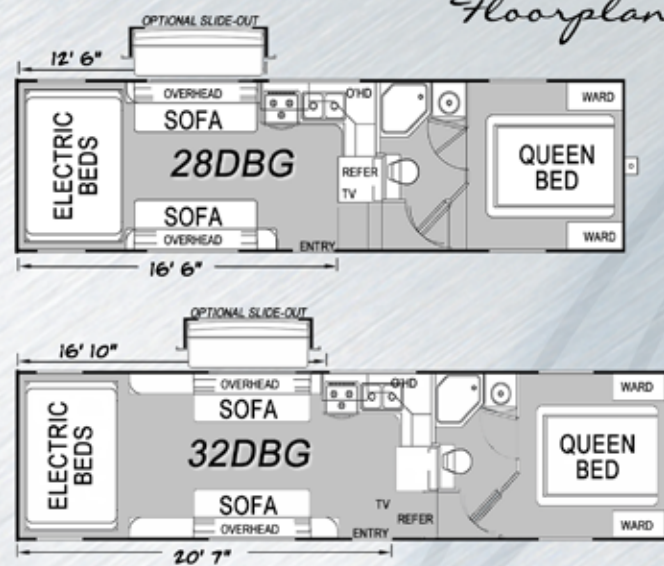

Standard Features

- 102" Wide Body Design
- 16" Deluxe Aluminum Wheels
- 6,000 Lb Axles w/Grease Zerk Fittings
- A/C 13.5K BTU
- Awning
- Carpet Kit
- Deluxe Aluminum Fender Skirts
- Fiberglass-Laminated, Aluminum-Framed Walls
- Floors - Aluminum Framed, Vacuum Bonded
- Fold-Up Sofa's w/Skirting (2)
- Folding Entry Door Assist Handle
- Front Fiberglass Cap
- Furnace - 30K BTU
- Insulation: R-22 / R-11 EPS Foam
- Key Hook / Cork Board
- LED Flood Lights: Door Side (2), Rear (2)
- LED Interior Lights
- LED Light Bar
- LED Running Lights
- Lights: Step / Hitch
- LP Tanks - Dual 30 LBS
- Medicine Cabinet w/Crown Molding
- Microwave w/Range Hood, Oven
- Pillow Top Mattress w/Bedsread, Shams
- Pleated Shades
- Powder Coated Chassis
- Pressure Washer
- Refrigerator - Large, Double Door
- Radius Entry Door
- Ramp Door - 7', Vacuum Bonded
- Rubber Roof - Seamless, 1-Piece
- Self-Adjusting Brakes
- Stabilizer Jacks - Rear, High Clearance (2)
- Stainless Steel Galley Sink w/Pull-Out Faucet
- Stereo AM/FM CD/DVD w/Outside Speakers
- Tie Downs
- Tinted Windows, X-Large
- Triple Radius Entry Door Step
- TV Antenna w/Cable Hook-Up
- TV Living Room
- USB Charger
- Water Heater - Gas DSI, 6 Gal
- Water Purification System

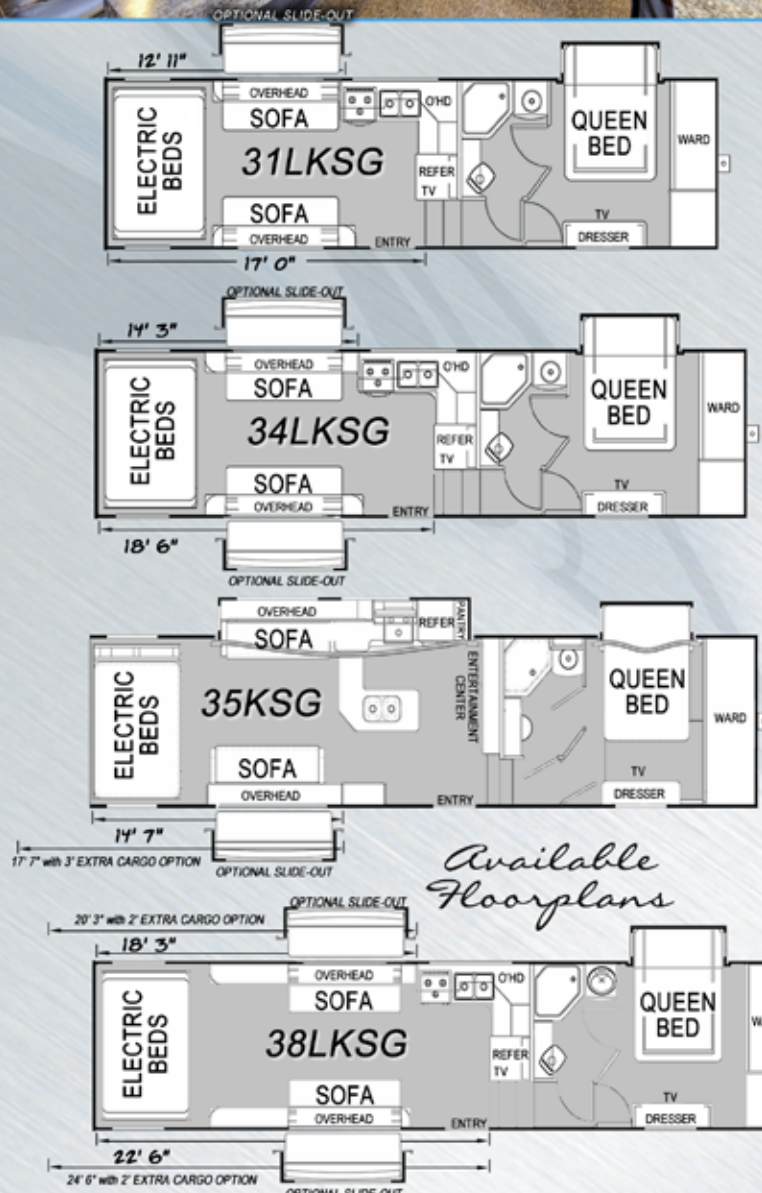

Standard Features

- 102" Wide Body Design
- 16" Deluxe Aluminum Wheels
- 6,000 Lb Axles W/ Grease Zerk Fittings
- A/C 13.5K BTU
- Awning
- Carpet Kit
- Ceiling Fan
- Deluxe Aluminum Fender Skirts
- Dual 30 Lbs LP Bottles
- Fiberglass-Laminated, Aluminum-Framed Walls
- Floors - Aluminum Framed, Vacuum Bonded
- Folding Entry Door Assist Handle
- Fold-Up Sofa's w/Skirting (2)
- Front & Rear Fiberglass Caps
- Full Turning Radius
- Furnace - 30K BTU
- Glass Enclosed Shower
- In-Floor Storage
- Key Hook / Cork Board
- LED Flood Lights: Door Side (2), Rear (2), Road Side (2)
- LED Interior Lights
- LED Light Bar
- LED Running Lights
- Lights: Step / Hitch
- Medicine Cabinet w/Crown Molding
- Microwave w/Range Hood, Oven
- Pillow Top Mattress w/Bedsread, Shams
- Pleated Shades
- Powder Coated Chassis
- Radius Entry Door
- Ramp Door - 7.5', Vacuum Bonded
- Refrigerator - Large, Double Door
- Self-Adjusting Brakes
- Stabilizer Jacks - Rear, High Clearance (2)
- Stainless Steel Galley Sink w/Pull Out Faucet
- Stereo AM/FM CD/DVD w/Outside Speakers
- Tie Downs
- Tinted Windows, X-Large
- Triple Radius Entry Door Step
- TV Antenna w/Cable Hook-Up
- TV Living Room
- USB Charger
- Water Heater - Gas DSI, 6 Gal
- Water Purification System

Optional Upgrades

	31LKSG	34LKSG	35KSG	38LKSG
150 Gallon Fresh Water	✓	✓	✓	✓
2' of Extra Cargo	NA	NA	NA	✓
3' of Extra Cargo	NA	NA	NA	NA
A/C 15K BTU IPO 13.5K *	✓	✓	✓	✓
A/C Bedroom - 13.5K BTU *	✓	✓	✓	✓
Add A Wall *	✓	✓	✓	✓
Black Tank Flush *	✓	✓	✓	✓
Central Vacuum System	✓	✓	✓	✓
Chair - One Extra	NA	✓	NA	✓
Chairs - 2 Extra	NA	NA	NA	✓
Chairs - 2 IPO Sofa w/Bay Wdw	✓	✓	✓	✓
CSA Canada	✓	✓	✓	✓
Dinette IPO Sofa w/Bay Wdw	✓	✓	NA	✓
Double Stell-A-Lounge *	✓	✓	✓	✓
Electric Awning w/Light *	✓	✓	✓	✓
Electric Beds (2) w/Bunk Ladder, H-Clear.	✓	✓	✓	✓
Electric Bed / Dinette	✓	✓	✓	✓
Electric Ramp Door Lift	✓	✓	✓	✓
Exterior TV Bracket & Hookups	✓	✓	✓	✓
Folding Ladder *	✓	✓	✓	✓
Frameless Windows	✓	✓	✓	✓
Fuel Station - 36 Gal *	✓	✓	✓	✓
Fuel Station - 51 Gal Split	✓	✓	✓	✓
Generator - 5.5 ONAN w/Transfer Switch *	✓	✓	✓	✓
Gray Exterior	✓	✓	✓	✓
Heated Enclosed Tanks	✓	✓	✓	✓
Kicker Stereo System w/Touchscreen *	✓	✓	✓	✓
Ramp Door Patio Fence	✓	✓	✓	✓
Rear Table & Legs	NA	✓	✓	✓
Refrigerator - X-Large	✓	✓	✓	✓
Slide-Out Living Room (Doorside)	NA	✓	✓	✓
Slide-Out Living Room (Roadside)	✓	✓	STD	✓
Solar Panel - 10 Watt	✓	✓	✓	✓
Solar Panel - 160 Watt	✓	✓	✓	✓
Solid Surface Galley Top w/Covers *	✓	✓	✓	✓
Spare Tire & Carrier *	✓	✓	✓	✓
Thermo Pane Windows	✓	✓	✓	✓
Tie-Downs - 2 Extra	✓	✓	NA	✓
TV Bedroom - X-Large *	✓	✓	✓	✓
TV Living Room - X-Large *	✓	✓	✓	✓
TV Living Room - 2X-Large	✓	✓	✓	✓
TV Living Room - 3X-Large	NA	NA	✓	NA
Water Heater - Gas DSI / Electric, 6 Gal	✓	✓	✓	✓
Water Heater - Gas DSI, 10 Gal	✓	✓	✓	✓
Water Heater - Gas DSI / Electric, 10 Gal	✓	✓	✓	✓
Winterize	✓	✓	✓	✓
<b>Abyss Package</b>	Included Items Denoted with *			
<b>Gold Package</b>	Glass Lavvy Bowl w/Deluxe Faucet, Solid Surface Lavvy Top (Must Include Solid Surface Galley Opt) - Black or Brown Countertops Available			

Available Floorplans

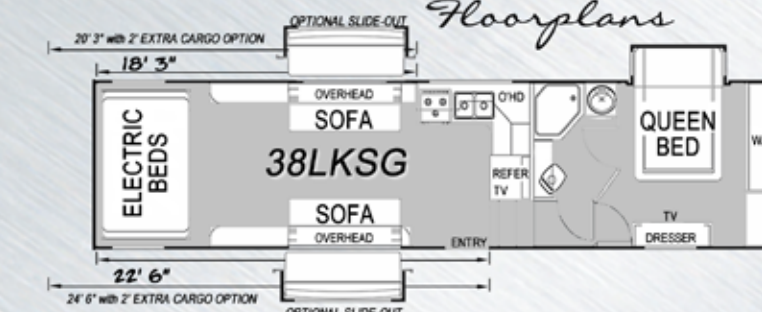



*Optional Upgrades*

	33SSG	36TXSG	40TXSG
150 Gallon Fresh Water	✓	✓	✓
1800W Inverter	✓	✓	✓
2nd Electric Awning w/Light	NA	✓	✓
3' of Extra Cargo/Garage	NA	✓	NA
4' of Extra Cargo/Garage	✓	NA	NA
6 Point Electric Leveling	✓	✓	✓
Chairs - 2 Extra	✓	✓	✓
CSA Canada	✓	✓	✓
Electric Bed / Dinette	✓	✓	✓
Electric Fireplace	✓	✓	✓
Electric Ramp Door Lift	✓	✓	✓
Frameless Windows	✓	✓	✓
Gray Exterior	✓	✓	✓
Half Bath (33SSG Req, Extra Cargo Opt)	✓	✓	✓
Loft Bed (33SSG Req, Extra Cargo Opt)	✓	✓	STD
Onan Energy Command 30 Auto-Start	✓	✓	✓
Ramp Door Patio Fence	✓	✓	✓
Refrigerator - X-Large (2)	NA	NA	✓
Solar Panel - 10 Watt	✓	✓	✓
Solar Panel - 160 Watt	✓	✓	✓
Thermo Pane Windows	✓	✓	✓
Tie-Downs - 2 Extra	NA	NA	✓
TV Bedroom - X-Large	✓	✓	✓
TV Rear - X-Large (Inside/Outside Bracket)	✓	✓	✓
Washer/Dryer Ready	✓	✓	✓
Water Heater - Gas DSI / Electric, 10 Gal	✓	✓	✓
Winterize	✓	✓	✓

**Gold Package**  
Glass Lazy Boat w/Deluxe Faucet, Solid Surface Lazy Top (Must Include Solid Surface Galley Opt) - Black or Brown Countertops Available

*Standard Features*

- 102" Wide Body Design
- 16" Deluxe Aluminum Rims
- 50 AMP Service
- A/C Bedroom - 13.5K BTU
- A/C Living Room - 15K BTU
- Add-A-Wall
- Black Tank Flush
- Built-In Air Compressor
- Carpet Kit
- Central Vacuum System
- Decorative Slide Treatments
- Deluxe Aluminum Fender Skirts
- Deluxe Futon on Electric Bed
- Double J Sofa w/ Dual Recliners (40TXSG only)
- Double J Sofa w/ Single Recliner (33SSG, 36TXSG)
- Dual Windows Cargo Area
- Electric Awning w/Light
- Electric Bed - 2nd Gen Queen Size
- Enclosed Under Belly
- TV Bedroom - X-Large
- Entry Swing-Out Assist Handle
- Exterior Shower
- Floors - Aluminum Framed, Vacuum Bonded

- Folding Side Ladder
- Front & Rear Gray Fiberglass Caps
- Front Cap Lights
- Fuel Station - 51 Gal Split
- Furnace - 30K BTU
- Generator - 5.5 ONAN w/Transfer Switch
- Heavy Duty Flooring in Garage
- In-Floor Storage
- Interior Grab Handle - Wood
- Key Hook / Cork Board / Magazine Rack
- Kicker Stereo System w/Touchscreen
- LED Flood Lights: Door Side (2), Rear (2), Road Side (2)
- LED Interior Lights
- LED Light Bar
- LED Running Lights
- Lights: Step / Hitch
- LP Tanks - Dual 30 LBS
- Medicine Cabinet w/Crown Molding
- Microwave w/Range Hood, Oven
- Outside Speakers
- Pleated Shades
- Powder Coated Chassis
- Radius Entry Door
- Ramp Door - 7.5', Vacuum Bonded
- Refrigerator - X-Large, Double Door
- Rubber Roof - Seamless, 1-Piece
- Self-Adjusting Brakes
- Shower - Glass Enclosed
- Sliding Glass Door (40TXSG only)
- Solid Surface Galley Top w/Covers
- Spare Tire w/Carrier
- Stabilizer Jacks - Electric, Front/Rear
- Stell-A-Lounge w/Table
- Storage - Oversized w/Slam Latches
- Tie Downs
- Tinted Windows, X-Large
- Triple Radius Entry Door Step
- TV Antenna w/ Cable Hook-Up
- TV Living Room - 3X-Large w/Remote
- TV Swing Out Bracket - Living Room
- USB Charger
- Walk On Roof
- Water Heater - Gas DSI, 10 Gal
- Water Purification System



Ramp Door  
Patio Fence  
Option



Gray Exterior  
Option Shown



**BUY LOCALLY**

Eclipse Recreational Vehicles Inc. strongly encourages our retail customer to purchase from their local dealership whenever possible.

- Our Dealers are as a rule, independently owned and operated businesses. Outside of those customers they personally sold products to, they are not contractually obligated to perform warranty service of Eclipse products that were purchased elsewhere. There may be an occasion that you would be required to return to the point of purchase to satisfy warranty requirements.
- Although many dealerships will eventually service products not purchased at their place of business, they will usually take care of their customers and other Eclipse customers who are traveling away from their local dealer as they would their own.
- Local purchases allow a customer to establish a relationship with a dealer close to home. This relationship provides the customer with a convenient location for service and support from a local dealer.
- The opportunity for a thorough inspection (PDI) and product orientation is an additional benefit of buying from your local dealer, further providing the opportunity for refresher courses and the ability to get questions answered much more conveniently.
- For our Canadian customer, there are also requirements which must be met to bring an RV purchased out of the country to their home. Although not insurmountable, these requirements may involve such things as additional inspections and verifications. Your local Canadian Dealer is a professional at meeting these requirements.

Eclipse Recreational Vehicles, Inc.'s goal is for all RV Owners to fully enjoy their RV experience. In light of this goal, and considering the advantages of buying local, we encourage you to be thorough when determining what product to purchase and which dealer to purchase it from, as both are key to your ultimate satisfaction and the realization of our dreams.



Cummins Onan  
RV QG 6500 EVAP  
Optional  
5.5 ONAN  
Generator

Optional  
Fuel Station

Optional  
Drive-on Metal  
Wheel Well



Metal	GVWR	Dry Weight	Hitch Weight	Axle Weight	Exterior Height	O.A. Length	Fresh Water	Gray Water	Black Water	LP Capacity
18CB	7500	TBD	TBD	TBD	11'-6"	25'-0"	54 Gal.	40 Gal.	40 Gal.	20#
19SB	7500	5540	660	4880	11'-6"	26'-1"	54 Gal.	50 Gal.	50 Gal.	20#
21FS	9900	6550	880	5670	11'-8"	27'-9"	104 Gal.	50 Gal.	50 Gal.	40#
23SB	9900	6575	720	5855	11'-6"	30'-1"	54 Gal.	50 Gal.	50 Gal.	40#
23FiB	9900	6428	913	5515	11'-8"	29'-3"	104 Gal.	50 Gal.	50 Gal.	40#
24FB	9900	6700	1020	5680	11'-8"	29'-3"	104 Gal.	50 Gal.	50 Gal.	40#
25FB	9900	7010	1010	6000	11'-8"	30'-8"	104 Gal.	50 Gal.	50 Gal.	40#
27FS	9900	6940	915	6025	11'-8"	31'-10"	104 Gal.	50 Gal.	50 Gal.	40#

### Pro-Lite

18CBG	7500	TBD	TBD	TBD	11'-6"	25'-0"	54 Gal.	40 Gal.	40 Gal.	20#
19SBG	7500	5240	680	4560	11'-6"	26'-1"	54 Gal.	50 Gal.	50 Gal.	20#
21FSG	9900	6120	890	5230	11'-8"	27'-9"	104 Gal.	50 Gal.	50 Gal.	40#
23SCG	9900	5960	690	5270	11'-6"	30'-1"	54 Gal.	50 Gal.	50 Gal.	40#
23FiBG	9900	6140	970	5170	11'-8"	29'-3"	104 Gal.	50 Gal.	50 Gal.	40#
24FBG	9900	6450	1040	5410	11'-8"	29'-3"	104 Gal.	50 Gal.	50 Gal.	40#
25FBG	9900	6760	1080	5680	11'-8"	30'-8"	104 Gal.	50 Gal.	50 Gal.	40#
27FSG	9900	6808	985	5823	11'-8"	31'-10"	104 Gal.	50 Gal.	50 Gal.	40#

### Wide Lite

27DBLG	9900	7230	1025	6205	11'-8"	32'-2"	104 Gal.	50 Gal.	50 Gal.	60#
28iBLG	9900	7280	1060	6220	11'-8"	33'-4"	104 Gal.	50 Gal.	50 Gal.	60#
32iBLG	13000	8495	1390	7105	11'-8"	37'-4"	104 Gal.	50 Gal.	50 Gal.	60#
32KSG	13500	9390	1470	7920	12'-1"	37'-4"	104 Gal.	50 Gal.	50 Gal.	60#

### Wide Lite 5th Wheel

28SBG	11900	8915	2015	6900	12'-9"	31'-6"	126 Gal.	40 Gal.	40 Gal.	60#
28DBG	11900	8755	2035	6720	12'-9"	31'-6"	126 Gal.	40 Gal.	40 Gal.	60#
32SBG	13500	9385	2255	7130	12'-9"	35'-6"	126 Gal.	40 Gal.	40 Gal.	60#
32DBG	13500	9180	2160	7020	12'-9"	35'-6"	126 Gal.	40 Gal.	40 Gal.	60#

### Wide Body 5th Wheel

31LKSG	14000	10490	2810	7680	13'	34'-11"	126 Gal.	50 Gal.	40 Gal.	60#
34LKSG	15000	11280	3590	7690	13'	36'-5"	126 Gal.	50 Gal.	40 Gal.	60#
35KSG	16500	12540	3260	9280	13'	39'-8"	126 Gal.	50 Gal.	40 Gal.	60#
38LKSG	17000	11785	3790	7960	13'	40'-5"	126 Gal.	50 Gal.	40 Gal.	60#

### Garage 5th Wheel

33SSG	16500	12515	2910	9605	13'	39'-6"	130 Gal.	50&40 Gal.	40 Gal.	60#
36TXSG	18000	13360	2560	10800	13'	41'-0"	130 Gal.	40&40 Gal.	45 Gal.	60#
40TXSG	18000	13980	3100	10880	13'	43'-4"	130 Gal.	40&40 Gal.	45 Gal.	60#

Fiberglass-Laminated, Aluminum-Framed

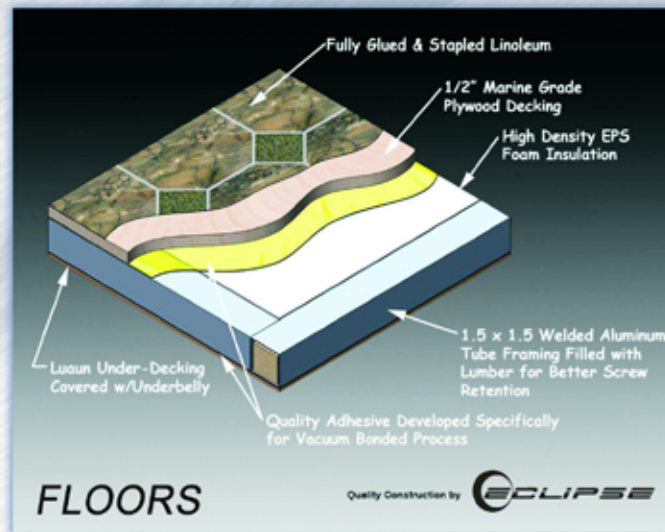
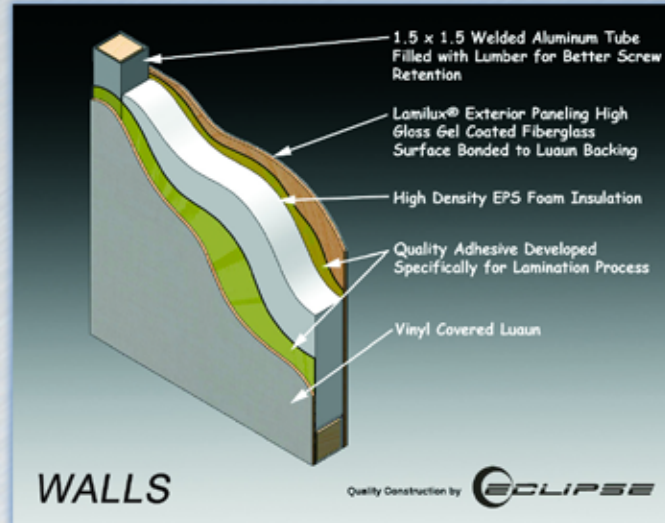

Aluminum Framed, Vacuum Bonded

# Eclipse RV Sponsoring the HOTTEST Off-Road Superstars!

**STELLAR**

**2 JEREMY MCGRATH**  
facebook.com/eclipserv

**STELLAR**

**MOTOCROSS**

**RACING**

**ROCKSTAR**

**STELLAR**

**Makita**

www.eclipservmfg.com

www.utvwolfpack.com





# STELLAR

Manufactured by Eclipse Recreational Vehicles, Inc.  
3016 Kansas Ave., #14  
Riverside, CA 92507  
(951) 684-6868  
[www.EclipseRVMfg.com](http://www.EclipseRVMfg.com)



All product data, graphics and photography in this brochure were as accurate as possible at press time. Subsequent refinements during the model year may be evident in the actual product. Eclipse RV, Inc. reserves the right to change prices, colors, materials, equipment and specifications without notice - as well as to add, modify or discontinue models shown in promotional materials and/or on its website. Unloaded vehicle weight and carrying capacities will vary upon optional equipment.

*Your Local Eclipse Dealer is:*