

SABRE AND SABRE LITE FIFTH WHEEL STANDARD FEATURES AND OPTIONS

EXTERIOR

- Painted aerodynamic fiberglass front cap with LED hitch lighting
- High gloss gelcoat fiberglass sidewalls (Enhanced filon fiberglass sidewalls standard on Sabre Lite)
- LED lights standard throughout
- EQUA FLEX rubberized suspension system
- "Correct Track" axle alignment system
- Frameless windows 80% tint (Optional on Sabre Lite)
- Battery disconnect switch
- 2 – 30 lb. LP tanks
- 30" entry door
- Fold-away entry handle
- Exterior roof ladder
- Under carriage spare tire carrier (bumper mount standard on Sabre Lite)
- Universal docking station with winterization and hot water heater bypass valve/black tank flush
- Low point drain valves/hot and cold exterior spray hose
- 10 gallon DSI gas/electric hot water heater with quick recovery (6 gallon standard on Sabre Lite)
- Heated and enclosed underbelly
- Slam-latch baggage doors
- Electric awning with adjustable arms and LED lights
- Marine grade outside speakers
- Electric powered front and rear stabilizer jacks
- JT strong arm stabilizers front jacks only (N/A Sabre Lite)
- Axles with Super Lube bearing system
- Nitrous filled steel belted radial tires with roadside assistance
- Aluminum wheels with E-rated tires
- Accessory hitch standard (N/A on Sabre Lite)
- 55 AMP power converter with smart fan cooling
- 50 AMP service detachable power cord wired and framed for second A/C (Optional on Sabre Lite)
- Aluminum "Tread Lite" entry steps

INTERIOR

- 48" HD flat panel TV (40" HD flat panel TV standard on Sabre Lite)
- CD/DVD/AM/FM blue tooth stereo system
- Electric fireplace (Optional on Sabre Lite)
- 35,000 BTU furnace with automatic ignition
- 15,000 BTU air conditioner ducted throughout
- Hand rubbed solid maple cabinet doors
- Full extension ball bearing drawer glides

- Solid core cabinet stiles pre-drilled and screwed cabinetry
- Hardwood slide-out fascia
- Hardwood step treads to bedroom (Congoleum step treads standard on Sabre Lite)
- Congoleum wood plank flooring with cold crack warranty
- Residential style window treatments
- Day/Night shades (Night shades standard on Sabre Lite)
- Residential style tri-fold hide-a-bed sofa
- Wall hugger theatre seats (Swivel rocker recliner standard on Sabre Lite)
- Residential Shaw nylon carpet with R2X TM with pad
- Electric slides with individual switches
- Digital thermostat

KITCHEN

- Hand rubbed solid maple cabinet doors
- Solid surface countertops with sink covers (Laminated countertops standard on Sabre Lite)
- Stainless steel appliances (N/A on Sabre Lite)
- Deep 50/50 stainless kitchen sink
- Residential size overhead cabinets
- Residential style kitchen faucet with pullout sprayer
- Residential style microwave
- Residential style pantry (N/A on Sabre Lite)
- 8 cubic ft. double door refrigerator
- 22" oven
- Free standing dinette (chairs include seat storage on most models)

BATHROOM

- Residential 30" x 48" one-piece fiberglass shower on most Sabre models (Neo radius corner shower standard on Sabre Lite)
- Skylight over shower
- Waterproof shower light
- Power vent fan
- Residential style medicine cabinet
- Heat duct and A/C vent in bathroom
- Extra large lav top with stainless steel sink
- Porcelain toilet with foot flush and power flush jets

BEDROOM

- Black label pillowtop mattress
- Residential bedspread with two pillow shams
- Large under bed storage
- Bedroom heat registers
- Closeable A/C vents
- Bedroom speakers
- TV and cable prep
- Large wardrobe closet with extra shoe shelf storage (N/A on Sabre Lite)
- Washer and dryer prep on most models
- Bed side night stands on all models (N/A on King Bed Option)

CONSTRUCTION

- 5-sided welded aluminum substructure
- Laminated aluminum main floor on Sabre Lite only
- Residential roof trusses 16" OC
- 3/8" thick walk-on roof decking
- One-piece roof membrane with 12 year warranty
- Insulation values – walls (R-9) roof and floor (R-28) (Walls (R-9) roof and floor (R-14) on Sabre Lite)

SABRE OPTIONS

- 4-point electric auto leveling
- Dual pane windows (frameless)
- Trailair rota flex rubberized pin box
- 2nd A/C 13.5 bedroom
- King size bed (bedslide models only)
- Night roller shades in living area
- Two leather rocker recliners IPO theatre seating
- 6-panel woodgrain refrigerator door
- 12 cubic side-by-side refrigerator (360 QB)
- Tri-fold sleeper sofa IPO lower bunk (360 QB)

SABRE LITE OPTIONS

- Electric fireplace
- Trailair rota flex rubberized pin box
- 50 AMP service with A/C prep
- 2nd A/C 13.5 bedroom (Req 50 AMP option)
- Solid surface countertops
- Dual pane windows (non-frameless)
- Frameless windows

UVW (Unloaded Vehicle Weight)* – is the typical weight of the unit as manufactured at the factory. It includes all weight at the unit's axle(s) and tongue or pin and LP Gas. The UVW does not include cargo, fresh potable water, additional optional equipment or dealer installed accessories.

*Estimated Average based on standard build optional equipment

CCC (Cargo Carrying Capacity)** – is the amount of weight available for fresh potable water, cargo, additional optional equipment and accessories. CCC is equal to GVWR minus UVW. Available CCC should accommodate fresh potable water (8.3 lbs per gallon). Before filling the fresh water tank, empty the black and gray tanks to provide for more cargo capacity.

** Estimated average based on standard build optional equipment

FREE MEMBERSHIP
to Forest River Owners' Group

www.forestriverfrog.com



Learn More
Scan this barcode using a QR Reader on your smart phone to learn more about Forest River.



A Berkshire Hathaway company.

YOUR LOCAL DEALER IS:

All information contained in this brochure is believed to be accurate at the time of publication. However, during the model year, it may be necessary to make revisions and Forest River, Inc., reserves the right to make all such changes without notice, including prices, colors, materials, equipment and specifications as well as the addition of new models and the discontinuance of models shown in this brochure. Therefore, please consult with your Forest River, Inc., dealer and confirm the existence of any materials, design or specifications that are material to your purchase decision. © 2015 Sabre, a Division of Forest River, Inc., a Berkshire Hathaway Company. All Rights Reserved.



SABRE • 2412 CENTURY DRIVE • GOSHEN, INDIANA 46528 • 574.642.3697 • LIT NO. SBR - 01/091515



B U I L T F O R T H E O P E N R O A D



SABRE FLOORPLANS



295CK

See definitions on back cover

UVW	CC	HITCH	LENGTH	HEIGHT	AXLES	FRESH WATER	GRAY WATER	WASTE WATER
9,932	3,828	1,760	35' 0"	12' 10"	6,000	50	84	42



315RE

UVW	CC	HITCH	LENGTH	HEIGHT	AXLES	FRESH WATER	GRAY WATER	WASTE WATER
10,309	3,546	1,855	38' 2"	12' 10"	6,000	50	84	42



330CK

UVW	CC	HITCH	LENGTH	HEIGHT	AXLES	FRESH WATER	GRAY WATER	WASTE WATER
10,309	3,561	1,870	36' 10"	12' 10"	6,000	50	84	42



335TB

UVW	CC	HITCH	LENGTH	HEIGHT	AXLES	FRESH WATER	GRAY WATER	WASTE WATER
TBD	TBD	TBD	37' 11"	12' 10"	6,000	50	84	42

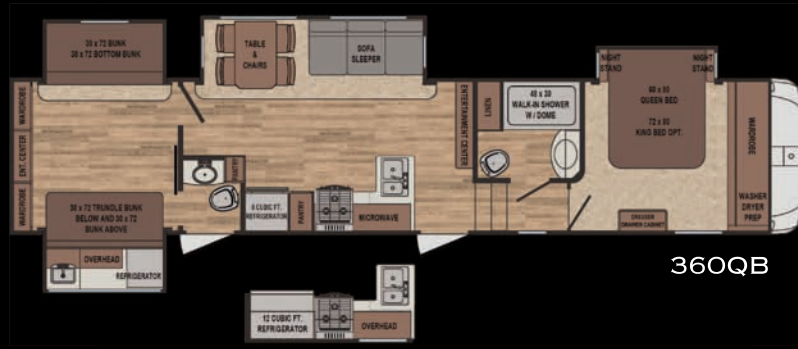

360QB

UVW	CC	HITCH	LENGTH	HEIGHT	AXLES	FRESH WATER	GRAY WATER	WASTE WATER
12,264	3,236	1,952	41' 10"	12' 10"	7,000	50	48	48



BUILT FOR THE OPEN ROAD

Every Sabre fifth wheel we build combines luxury, style and affordability without ever sacrificing quality. Built on America's most popular floor plans, along with the longest list of standard features, we are committed to providing the best fifth wheel value in the industry today. Luxurious living areas, residential kitchen appointments and all the comforts of home make Sabre the clear choice when it's time to head for the great outdoors.



EXPRESSO



SANDSTONE



PEWTER

SABRE FLOORPLAN



365MB

UVW	CC	HITCH	LENGTH	HEIGHT	AXLES	FRESH WATER	GRAY WATER	WASTE WATER
12,994	2,506	2,390	42' 5"	12' 10"	7,000	50	84	42

SABRE LITE FLOORPLANS



25RL

UVW	CC	HITCH	LENGTH	HEIGHT	AXLES	FRESH WATER	GRAY WATER	WASTE WATER
7,224	4,256	1,320	28' 8"	12' 7"	5,200	31	42	42



28RL

UVW	CC	HITCH	LENGTH	HEIGHT	AXLES	FRESH WATER	GRAY WATER	WASTE WATER
8,439	3,346	1,625	32' 6"	12' 7"	5,200	42	42	42



29RE

UVW	CC	HITCH	LENGTH	HEIGHT	AXLES	FRESH WATER	GRAY WATER	WASTE WATER
8,864	2,626	1,330	33' 0"	12' 7"	5,200	42	42	42